



STATE OF FLORIDA
DEPARTMENT OF ENVIRONMENTAL PROTECTION
ONSITE SEWAGE TREATMENT AND DISPOSAL
SYSTEM (OSTDS)

PERMIT NO: 25-0454
DATE PAID: 5/22/25
FEE PAID: 260.00
RECEIPT #: 221528

APPLICATION FOR CONSTRUCTION PERMIT

APPLICATION FOR:

☐ New System ☒ Existing System ☐ Holding Tank ☐ Innovative
☐ Repair ☐ Abandonment ☐ Temporary ☐

APPLICANT: Steve Stewart CCF Properties EMAIL: StewartSamanthaJ@gmail.com
AGENT: _____ TELEPHONE: 904 4972300
MAILING ADDRESS: 11169 Cedar Creek Farms Rd Glen St Mary FL 32040

TO BE COMPLETED BY APPLICANT OR APPLICANT'S AUTHORIZED AGENT. SYSTEMS MUST BE CONSTRUCTED BY A PERSON LICENSED PURSUANT TO 489.105 (3) (m) OR 489.552, FLORIDA STATUTES. IT IS THE APPLICANT'S RESPONSIBILITY TO PROVIDE DOCUMENTATION OF THE DATE THE LOT WAS CREATED OR PLATTED (MM/DD/YY) IF REQUESTING CONSIDERATION OF STATUTORY GRANDFATHER PROVISIONS.

PROPERTY INFORMATION

OSTDS REMEDIATION PLAN? ☐ Y ☐ N

LOT: 125 BLOCK: _____ SUBDIVISION: mobile home park PLATTED: _____

PROPERTY ID #: 25-35-15-00210-00 ZONING: _____ I/M OR EQUIVALENT: ☐ Y ☐ N

PROPERTY SIZE: 1.97 ACRES WATER SUPPLY: ☒ PRIVATE PUBLIC ☐ $\leq 2000 \text{ GPD}$ ☐ $> 2000 \text{ GPD}$

IS SEWER AVAILABLE AS PER 381.0065, FS? ☒ Y ☐ N DISTANCE TO SEWER: _____ FT

PROPERTY ADDRESS: 125 SW Endeavor Court Lake City, FL 32024

DIRECTIONS TO PROPERTY: Take US-90 west to 125 SW Endeavor Ct on Left first M.H. on Left.

BUILDING INFORMATION

☒ RESIDENTIAL ☐ COMMERCIAL

Unit No.	Type of Establishment	No. of Bedrooms	Building Area Sqft	Commercial/Institutional System Design Table I, Chapter 62-6, FAC
1	Mobile Home	2	840	2 Br 2 Bath like for like
2				
3				
4				

☐ Floor/Equipment Drains ☐ Other (Specify) _____

SIGNATURE: Steve Stewart DATE: 5/16/25

DEP 4015, 06-21-2022 (Obsoletes previous editions which may not be used)
Incorporated 62-6.004, FAC

* Replacing Existing 2bed 2bath Mobile home

25-0454

STATE OF FLORIDA
DEPARTMENT OF HEALTH
APPLICATION FOR ONSITE SEWAGE DISPOSAL SYSTEM CONSTRUCTION PERMIT

Permit Application Number 21-0080

CCF Properties LLC

PART II - SITEPLAN

Scale: 1 inch = 40 feet.

↑N

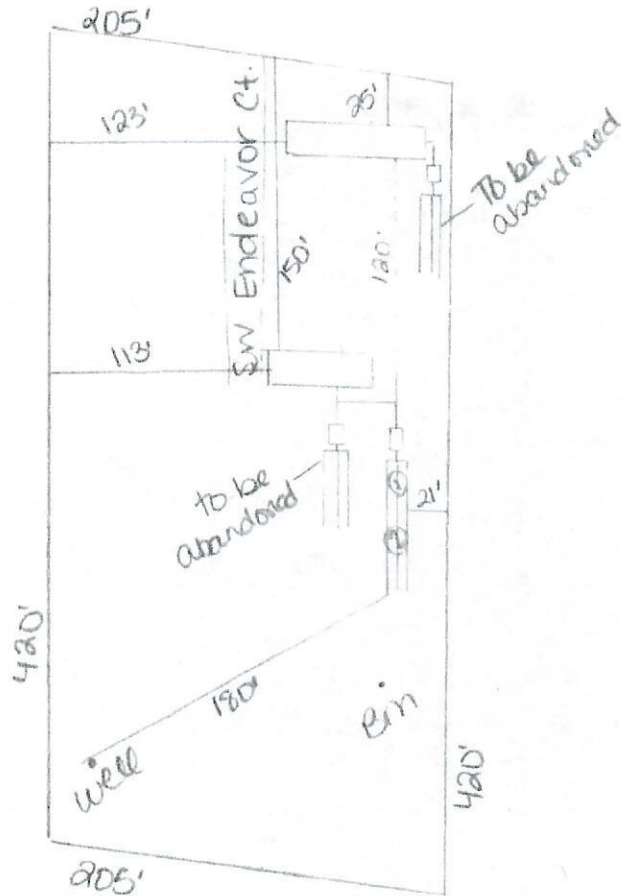

Notes: _____

Site Plan submitted by: William D. Bishop II MASTER CONTRACTOR
Plan Approved ☒ Not Approved _____ Date 3-10-21
By Kuh R Columbin 3/10/21 County Health Department

ALL CHANGES MUST BE APPROVED BY THE COUNTY HEALTH DEPARTMENT