



STATE OF FLORIDA
DEPARTMENT OF ENVIRONMENTAL PROTECTION
ONSITE SEWAGE TREATMENT AND DISPOSAL
SYSTEM (OSTDS)

56
PERMIT NO. 23-1697
DATE PAID: 10/30/23
FEE PAID: 310.00
RECEIPT #: 2063240

APPLICATION FOR CONSTRUCTION PERMIT

APPLICATION FOR:

☒ New System ☐ Existing System ☐ Holding Tank ☐ Innovative
☐ Repair ☐ Abandonment ☐ Temporary ☐

APPLICANT: DELTA OMEGA PROPERTIES INC

EMAIL: NFLSEPTICTANK@COMCAST.NET

AGENT: ROBERT FORD III- NORTH FLORIDA SEPTIC TANK INC

TELEPHONE: 386-755-6372

MAILING ADDRESS: 741 SE STATE ROAD 100, LAKE CITY FL 32025

TO BE COMPLETED BY APPLICANT OR APPLICANT'S AUTHORIZED AGENT. SYSTEMS MUST BE CONSTRUCTED BY A PERSON LICENSED PURSUANT TO 489.105(3)(m) OR 489.552, FLORIDA STATUTES. IT IS THE APPLICANT'S RESPONSIBILITY TO PROVIDE DOCUMENTATION OF THE DATE THE LOT WAS CREATED OR PLATTED (MM/DD/YY) IF REQUESTING CONSIDERATION OF STATUTORY GRANDFATHER PROVISIONS.

PROPERTY INFORMATION

OSTDS REMEDIATION PLAN? Y / N]

LOT: 3 BLOCK: PH 1 SUBDIVISION: CROSSWINDS PLATTED: _____

PROPERTY ID #: 24-4S-16-03117-103 ZONING: _____ I/M OR EQUIVALENT: [Y / N]

PROPERTY SIZE: 0.88 ACRES WATER SUPPLY: ☒ PRIVATE PUBLIC ☐ <=2000GPD ☐ >2000GPD

IS SEWER AVAILABLE AS PER 381.0065, FS? [Y / N] DISTANCE TO SEWER: _____ FT

PROPERTY ADDRESS: 735 SW CHESTERFIELD CIR, LAKE CITY FL

DIRECTIONS TO PROPERTY: _____

BUILDING INFORMATION

☒ RESIDENTIAL

☐ COMMERCIAL

Unit No.	Type of Establishment	No. of Bedrooms	Building Area Sqft	Commercial/Institutional System Design Table I, Chapter 62-6, FAC
1	<u>NEW HOME</u>	<u>4</u>	<u>1618</u>	
2				
3				
4				

[] Floor/Equipment Drains [] Other (Specify) _____

SIGNATURE: _____

DATE: 10-2-2023

DEP 4015, 06-21-2022 (Obsoletes previous editions which may not be used)

Incorporated 62-6.004, FAC



STATE OF FLORIDA
DEPARTMENT OF HEALTH
ONSITE SEWAGE TREATMENT AND DISPOSAL
SYSTEM

PERMIT #: **12-SC-2790662**
APPLICATION #: **AP2003340**
DATE PAID: **10/13/23**
FEE PAID: **31000**
RECEIPT #:
DOCUMENT #: **PR2013258**

CONSTRUCTION PERMIT FOR: OSTDS New

APPLICANT: DELTA**23-0697 OMEGA PROPERTIES

PROPERTY ADDRESS: 735 SW CHESTERFIELD Lake City, FL 32024

LOT: 3 BLOCK: SUBDIVISION: Crosswinds Phase I

PROPERTY ID #: 03117-103 [SECTION, TOWNSHIP, RANGE, PARCEL NUMBER]
[OR TAX ID NUMBER]

SYSTEM MUST BE CONSTRUCTED IN ACCORDANCE WITH SPECIFICATIONS AND STANDARDS OF SECTION 381.0065, F.S., AND CHAPTER 64E-6, F.A.C. DEPARTMENT APPROVAL OF SYSTEM DOES NOT GUARANTEE SATISFACTORY PERFORMANCE FOR ANY SPECIFIC PERIOD OF TIME. ANY CHANGE IN MATERIAL FACTS, WHICH SERVED AS A BASIS FOR ISSUANCE OF THIS PERMIT, REQUIRE THE APPLICANT TO MODIFY THE PERMIT APPLICATION. SUCH MODIFICATIONS MAY RESULT IN THIS PERMIT BEING MADE NULL AND VOID. ISSUANCE OF THIS PERMIT DOES NOT EXEMPT THE APPLICANT FROM COMPLIANCE WITH OTHER FEDERAL, STATE, OR LOCAL PERMITTING REQUIRED FOR DEVELOPMENT OF THIS PROPERTY.

SYSTEM DESIGN AND SPECIFICATIONS

T [400] GALLONS / GPD Aerobic Unit Treatment CAPACITY
A [] GALLONS / GPD N/A CAPACITY
N [] GALLONS GREASE INTERCEPTOR CAPACITY [MAXIMUM CAPACITY SINGLE TANK:1250 GALLONS]
K [] GALLONS DOSING TANK CAPACITY [] GALLONS @ [] DOSES PER 24 HRS #Pumps []

D [282] SQUARE FEET Drainfield SYSTEM
R [] SQUARE FEET N/A SYSTEM

A TYPE SYSTEM: [X] STANDARD [] FILLED [] MOUND []
I CONFIGURATION: [X] TRENCH [] BED []

F LOCATION OF BENCHMARK: Fence board E. across the street.

I ELEVATION OF PROPOSED SYSTEM SITE [36.00] [INCHES / FT] [ABOVE / BELOW] BENCHMARK/REFERENCE POINT

E BOTTOM OF DRAINFIELD TO BE [48.00] [INCHES / FT] [ABOVE / BELOW] BENCHMARK/REFERENCE POINT

D FILL REQUIRED: [6.00] INCHES EXCAVATION REQUIRED: [0.00] INCHES

O The system is sized for 3 bedrooms with a maximum occupancy of 6 persons (2 per bedroom), for a total estimated flow of 300 gpd.
T ***System will be 50% minimum nitrogen reducing ATU as required by BMAP restriction in code, using a 24" water table
H separation. Nitrogen reducing NSF-245 certified aerobic treatment unit required." Maintenance contract and operating
E permitting/fee also required.
R -Operating permit fee and application / 2yr singed maintenance entity contract agreement w/ owner required prior to final approval.

SPECIFICATIONS BY: Robert Ford TITLE: Master Contractor

APPROVED BY: Dustin W Jones TITLE: Environmental Specialist II Columbia CHD

DATE ISSUED: 10/11/2023 EXPIRATION DATE: 04/11/2025

DEP 4015, 06-21-2022 (Obsoletes previous editions which may not be used)
Incorporated 62-6.004, FAC



Columbia County Property Appraiser Jeff Hampton | Lake City, Florida | 386-758-1083

PARCEL: 24-4S-16-03117-103 (15214) | TIMBERLAND 80-89 (5500) | 0.88 AC

LOT 3 CROSSWINDS S/D PHASE 1. QC 1152-452

DELTA OMEGA PROPERTIES INC

2023 Working Values

Owner: 3454 SW CR 242
LAKE CITY, FL 32024
Site: 735 SW CHESTERFIELD CIR, LAKE CITY
Sales Info: NONE

Mkt Lnd	\$0	Appraised	\$395
Ag Lnd	\$395	Assessed	\$395
Bldg	\$0	Exempt	\$0
XFOB	\$0	county:	\$395
Just \$28,000		city:	\$0
		other:	\$0
		school:	\$395
		Total Taxable	

NOTES:



Columbia County, FL

This information was derived from data which was compiled by the Columbia County Property Appraiser Office solely for the governmental purpose of property assessment. This information should not be relied upon by anyone as a determination of the ownership of property or market value. No warranties, expressed or implied, are provided for the accuracy of the data herein, its use, or its interpretation. Although it is periodically updated, this information may not reflect the data currently on file in the Property Appraiser's office.

GrizzlyLogic.com

23-069

FLOOR PLAN
SCALE: 1/8" = 1'-0"
GENERAL NOTES:

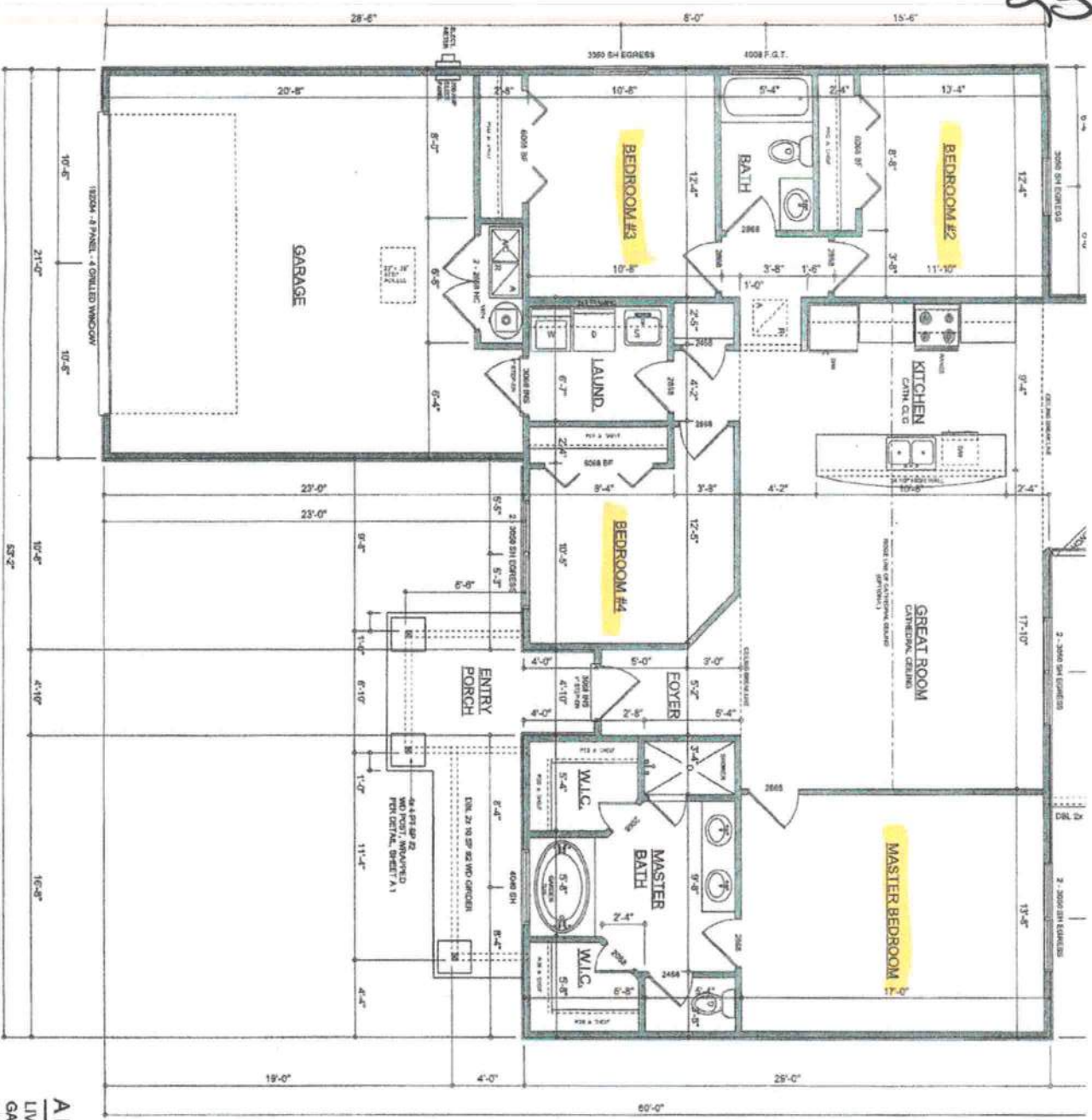

Robert W. Zide
10-20-2023

AREA SUMMARY

LIVING AREA	1,618	S.F.
GARAGE AREA	461	S.F.
ENTRY PORCH AREA	106	S.F.
COVERED PORCH AREA	140	S.F.
TOTAL AREA	2,325	S.F.

	W. M. CONSTRUCTION & ASSOCIATES, INC. 425 NW COMMERCIAL DR. STE. 100 LAKE CITY, FL 32005 (386) 758-6406 www.wmconstruction.com	MODEL 1618 FOR: LOT 3, CROSSWINDS PROJECT ADDRESS: COLUMBIA COUNTY, FLORIDA RHETT SMITHEY LAKE CITY, FLORIDA	DIMENSIONED SCALE: TYPICAL WALL SCALE:
	JOB NUMBER 20230914		
	SHEET NUMBER		

63077

