



STATE OF FLORIDA
DEPARTMENT OF ENVIRONMENTAL PROTECTION
ONSITE SEWAGE TREATMENT AND DISPOSAL
SYSTEM (OSTDS)

PERMIT NO. 24-0404
DATE PAID: 5/17/24
FEE PAID: 160.00
RECEIPT #: 2071410

APPLICATION FOR CONSTRUCTION PERMIT

APPLICATION FOR:

☐ New System ☒ Existing System ☐ Holding Tank ☐ Innovative
☐ Repair ☐ Abandonment ☐ Temporary ☐

APPLICANT: Ray Kline

EMAIL: busluste@outlook.com

AGENT: Elite Metal Manufacturing

TELEPHONE: 386-364-0777

MAILING ADDRESS: 2134 Herlong St., Ft. White, FL

TO BE COMPLETED BY APPLICANT OR APPLICANT'S AUTHORIZED AGENT. SYSTEMS MUST BE CONSTRUCTED BY A PERSON LICENSED PURSUANT TO 489.108(3) (a) OR 489.552, FLORIDA STATUTES. IT IS THE APPLICANT'S RESPONSIBILITY TO PROVIDE DOCUMENTATION OF THE DATE THE LOT WAS CREATED OR PLATTED (MM/DD/YY) IF REQUESTING CONSIDERATION OF STATUTORY GRANDFATHER PROVISIONS.

PROPERTY INFORMATION

OSTDS REMEDIATION PLAN? ☐ Y / ☐ N

LOT: _____ BLOCK: _____ SUBDIVISION: _____ PLATTED: _____

PROPERTY ID #: 07-6S-17-03816-323 ZONING: _____ I/M OR EQUIVALENT: ☐ Y / ☐ N

PROPERTY SIZE: 9.76 ACRES WATER SUPPLY: ☒ PRIVATE PUBLIC ☐ ☐ <2000GPD ☐ >2000GPD

IS SEWER AVAILABLE AS PER 381.0065, FS? ☐ Y / ☐ N DISTANCE TO SEWER: _____ FT

PROPERTY ADDRESS: 2134 Herlong St., Ft. White, FL 32038

DIRECTIONS TO PROPERTY: Head east on SW Herlong St, Turn left at the 1st cross street onto SW Tustenuggee Ave, Slight right to stay on SW Tustenuggee Ave, Turn left onto US-41 N/US-441 N

Turn left onto US-41 N/US-441 N, Turn right onto NE Franklin St, Turn left onto NE Taylor Ave

BUILDING INFORMATION

☒ RESIDENTIAL ☐ COMMERCIAL

Unit No	Type of Establishment	No. of Bedrooms	Building Area Sqft	Commercial/Institutional System Design Table I, Chapter 62-6, FAC
1	<u>detached accessory</u>	<u>0</u>	<u>1200</u>	
2				
3				
4				

☐ Floor/Equipment Drains ☐ Other (Specify) _____

SIGNATURE: Ray Kline

DATE: Apr 18, 2024

KR

24-0404

SITE PLAN

759.79

Each Square or 20' Is Equal To 100 Ft.

Parcel Number: - - -

HERLONG STREET

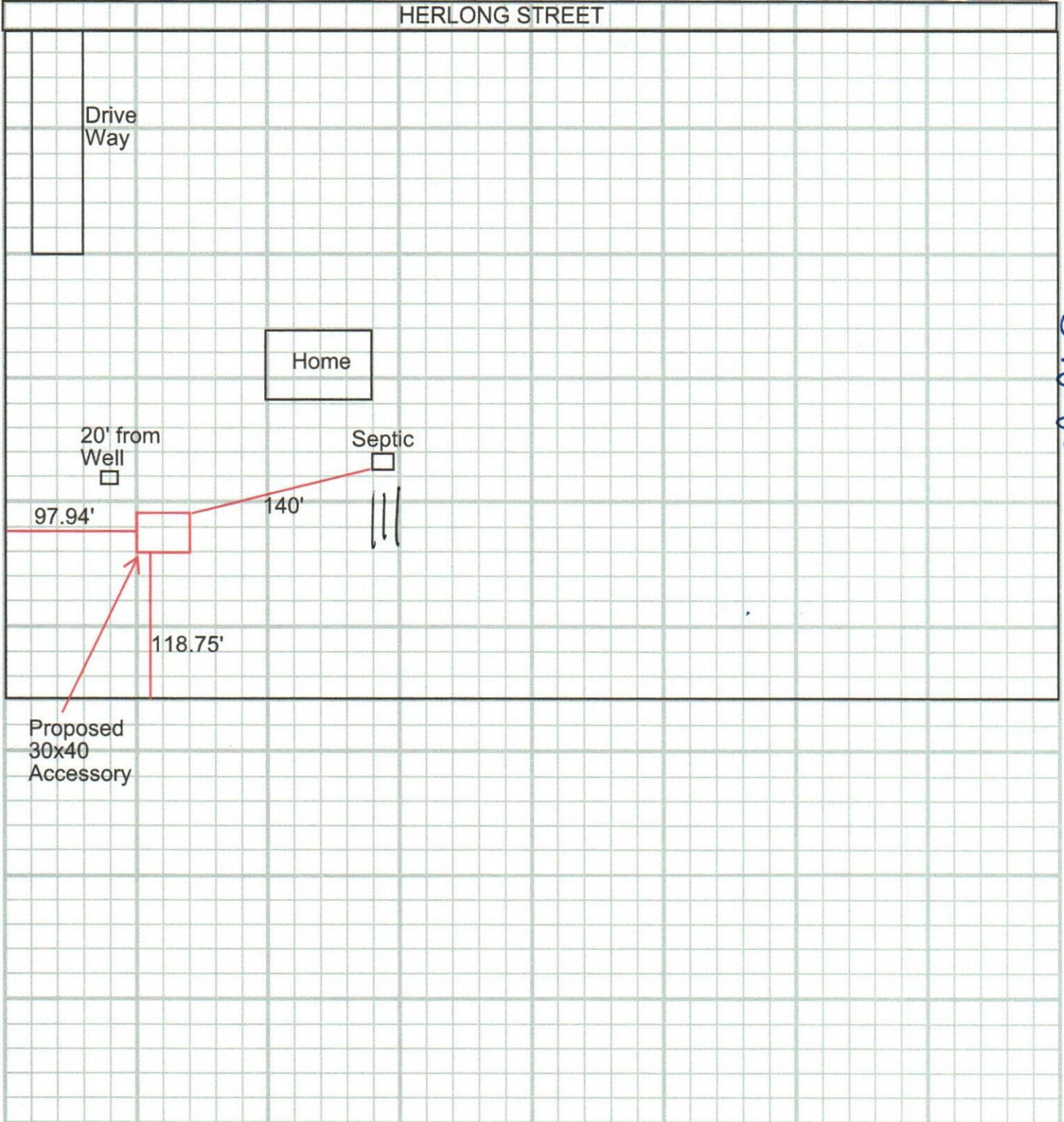

548.82

Property Owner: Ray Kline

Address: 2134 Herlong St

Name of Preparer (if different than above): _____

Zoning: _____

THIS PLOT IS TRUE AND ACCURATE TO THE BEST OF MY KNOWLEDGE:

(Signature of Applicant or Agent) Frances Allen

DATE: 5-15-24

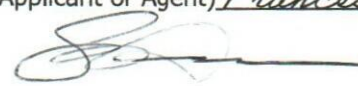
 ESZ Columbia 5/21/24