

7/12-8/12 PITCH - 18" OH

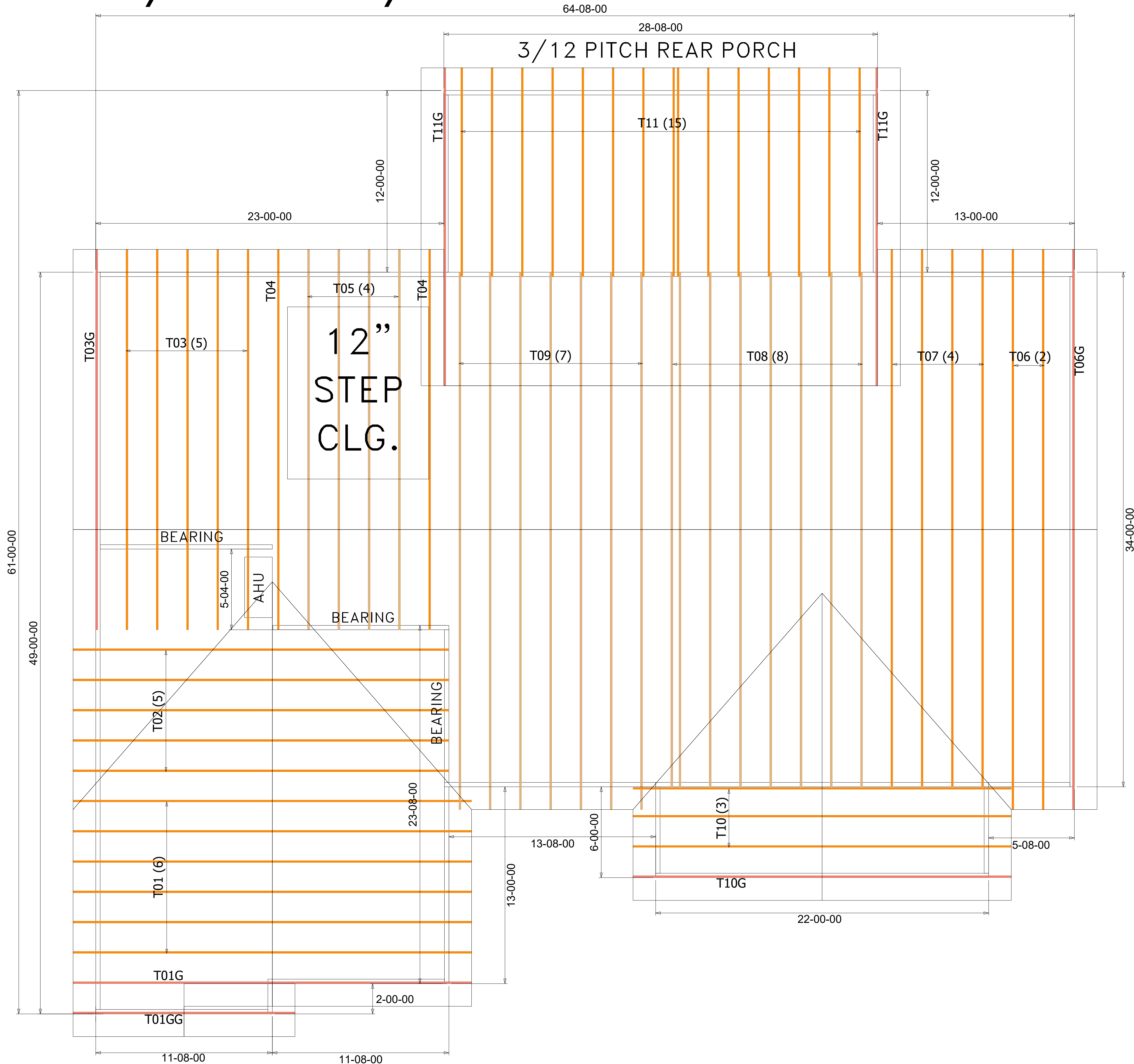

WARNING
Backcharges Will Not Be Accepted
Regardless of Fault Without Prior
Notification By Customer Within 48
Hours And Investigation By
Builders FirstSource.
NO EXCEPTIONS.

IMPORTANT
This Drawing Must Be Approved And
Returned Before Fabrication Will
Begin. For Your Protection Check All
Dimensions And Conditions Prior To
Approval Of Plan.
SIGNATURE BELOW INDICATES ALL
NOTES AND DIMENSIONS HAVE
BEEN ACCEPTED.

By _____ Date _____

FINAL LAYOUT FOR PRODUCTION

Initial: _____ Date: _____
Requested Delivery Date: _____

ROOF LOADING: TCLL: 20 FLOOR LOADING: TCLL: 20
TCDL: 10 TCDD: 10
BCLL: 0 BCDD: 0
BCDL: 10 BCDL: 10
DURATION: 1.25 DURATION: 1.00

5 PSF TCDD + 5 PSF BCDL USED TO RESIST UPLIFT

ENCLOSED
EXPOSURE CATEGORY B
OCCUPANCY CATEGORY II
WIND LOAD 130 MPH
WIND IMPORTANCE FACTOR 1.00

ROOF PITCH: 7/12-8/12-3/12
CEILING PITCH: FLAT
TOP CHORD SIZE: 2 X 4
BOTTOM CHORD SIZE: 2 X 4
OVERHANG LENGTH: 18"
END CUT: PLUMB
CANTILEVER: N/A
TRUSS SPACING: 24"
BUILDING CODE:FBC 2023

| BEARING HEIGHT SCHEDULE |
|-------------------------|
| |
| |
| |

| | |
|------------------|---------------|
| BUILDER: | |
| Giebeig Homes | |
| MODEL: | CUSTOM |
| ELEV: | GABLE |
| ADDRESS: | TBD |
| LOT / BLOCK: | N/A |
| SUBDIVISION: | TOLAR RES. |
| CITY: | Lake City |
| DRAWN BY: | Holloway, Kim |
| JOB # : | 4894002 |
| DATE: 10/12/2025 | SCALE: N.T.S. |

| REVISIONS: |
|------------|
| |
| |
| |
| |



Summations of limited excerpts of the Code, ANSI/TPI 1-2014, and BCSI, and associated commentary, are provided within the truss submittal package in the Builders FirstSource Component Truss Responsibility and Liability Disclosure. These critical excerpts include, among other elements, critical safety information as well as specific Scope-of-Work assignments (and limitations of the same) for the Owner, Contractor, Building Designer, Truss Designer, and Truss Manufacturer. It is essential that ALL parties to the design and use of the Trusses review and become familiar with the information provided in the Builders FirstSource Component Truss Responsibility and Liability Disclosure, as well as the referenced sources, prior to performing work on the associated project.