

Corporate Office:
631 SE Industrial Circle
Lake City, FL 32056
Mailing: PO BOX 2254 Lake City, FL 32056

Main Number: 386-961-0006
Fax Number: 386-961-0008
tubularbuildingsystems@gmail.com



Sales Order Form

Buyers Name(s) KEVIN SHIPLEY 2 OF 2 Date 4/26/2022
Address 810 SW CHESTERFIELD CIR County COLUMBIA Dealer BAM LC
City LAKE CITY ST FL Zip 32024 Order Received & Verified By TBS

Phone (386) 365-8142 Alternate (918) 760-6750
e-mail KMSHIPLEY1@GMAIL.COM Cell _____

Installation Site 160 SW BRAHMAN GLN FORT WHITE, 32038 Terms of Sale ☐ Cash/ Check ☐ Financed ☒ Credit/Debit Card
(if different from above)

Roof Style: ☐ Regular ☐ Boxed Eave ☒ Vertical NOTE: Frame 1ft shorter than roof length

Size Width: 30 Length: 26 Leg Height: 9

Installation ☐ Ground ☒ Concrete ☐ Asphalt ☐ Other Permits ☒ Yes ☐ No Power Available ☐ Yes ☒ No

Color Roof: WHITE Sides: WHITE Trim: BLACK

X	Base	<input checked="" type="checkbox"/> 5' OC - 140 MPH	Standard	\$4,395.00	"J" Trim	
	Base	<input type="checkbox"/> 4' OC - 170 MPH	Optional		Connection Fee: Side to Side	
9'	Leg Height			\$345.00	PRICE MATCH FIVE STAR	-\$584.00
2	Enclose Each Side			\$750.00	Miscellaneous:	
2	Enclose Each End			\$3,540.00	Miscellaneous:	
	Vertical Sides				4' Center Option - Add 5% of the overall cost of the b	
	Vertical Ends				A. Sales Total	\$11,096.00
1	Standard 36" x 80" Walk-in Door - No Window			\$350.00	B. Surcharge	Rate 30.0% \$3,328.80
	Upgrade Door	<input type="checkbox"/> Diamond <input type="checkbox"/> 9 Lite			C. Sales Tax (A & B X Sales Tax Rate)	Rate 6.0% \$865.49
2	Standard Window- 24" X 36" - Mill Finish			\$400.00	D. Additional Tax Over \$5,000 (25,50,75)	\$50.00
	Upgrade Window	<input type="checkbox"/> White Grid			E. Subtotal (A + B + C + D)	\$15,340.29
2	Garage Door: Size (10X8)	<input type="checkbox"/> Chain Drive		\$1,900.00	F. Deposit (A & B X Deposit Rate)	Rate 15% \$2,163.72
	Garage Door: Size (WXH)	<input type="checkbox"/> Chain Drive			G. Total Less Deposit (E - F)	\$13,176.57
	Garage Door: Size (W'XH')	<input type="checkbox"/> Chain Drive			H. Plans - Site Specific \$700.00/ Wet Seal \$100/Digital F	\$0.00
	Frameout - Window				I. Lift Rental Fee / Material Handling Fee \$400.00	\$0.00
	Frameout - Door				J. Labor Fee	
	Frameout- Garage Door:	<input type="checkbox"/> Square <input type="checkbox"/> 45 Degree			K. Balance Due To Tubular Building Systems	\$13,176.57
	Header for Side Entrance				L. Additional Money Down (Collect From Dealer)	
	Side Frameout - Square				M. Collect Money From: <input type="checkbox"/> Dealer <input checked="" type="checkbox"/> Customer	\$13,176.57
	Side Frameout- 45* (Plus Side Closed Price)				*If Collecting From Dealer Collect L / M *If Collecting From Customer Collect M & then L from Dealer	

SPECIAL INSTRUCTIONS:

LEAD TIME ESTIMATES GIVEN ARE FROM THE TIME THE SITE IS READY FOR INSTALL, LEAD TIMES ARE NOT GUARANTEED

Notice to Buyer: This contract includes cost of installation at the address of buyer stated above upon the receipt of the full purchase price.
The buyer is responsible for properly preparing the site for installation, obtaining any required permits and all other Terms and Conditions.
Buyer hereby acknowledges by his or her signature below to having read and understood, including without limitation, any conditions of
site preparation, permits, warranties and additional charges and responsibilities. PAYMENT DUE AT TIME OF INSTALL.
Florida installations are made by Tubular Building Systems, LLC. CBC 1262211
**SITE SPECIFIC ENGINEERING IS NON-REFUNDABLE
**ALL CUSTOMERS WITH A REMAINING BALANCE OF \$15,000 OR MORE WILL BE REQUIRED TO PAY HALF OF THAT BALANCE @ THE TIME OF SCHEDULING

Tubular Building Systems
accepts the following for
payment:

Visa, Discover, Master Card,
American Express, Check, Cash &
Wire Transfer

Buyers Signature *Kevin Shipley* Date 4/26/2022
Dealer Signature *Adam Porter* Date 4/26/2022

Customer Name

SHIPLEY 2042

Date

4/26/2022

Dealer Name

BAM

Location

LC

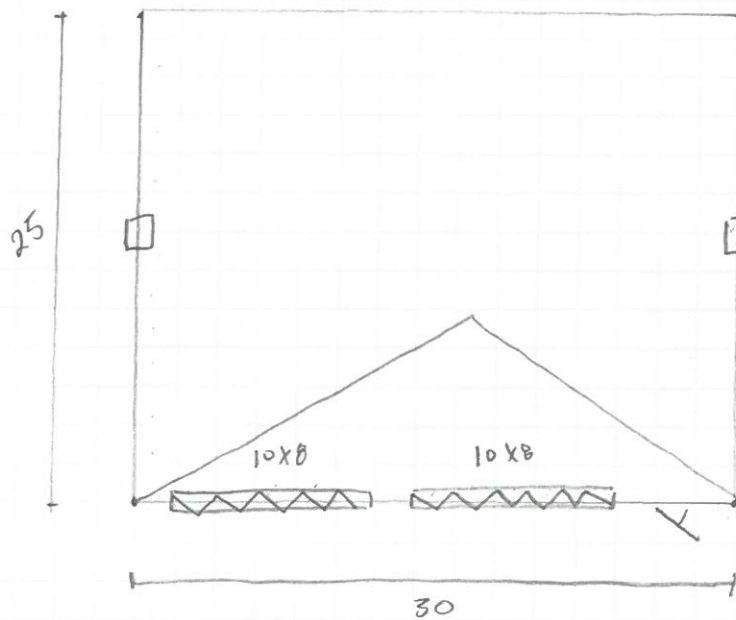

Sketch Legend

Window



Garage Door



Walk-in Door



Roof Type

Check One

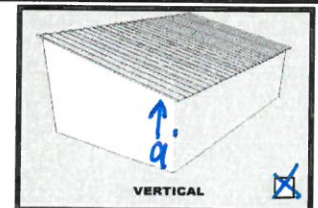
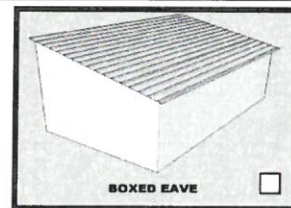
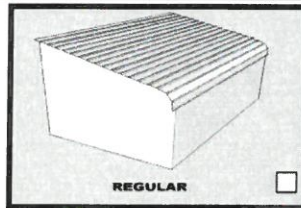

Lean-To Type

Check One

