

DATE 08/10/2004

Columbia County Building Permit

PERMIT

This Permit Expires One Year From the Date of Issue

000022171

APPLICANT DENISE HINGSON PHONE 386.590.6831

ADDRESS 729 NW PARNELL AVENUE LAKE CITY FL 32055

OWNER BOBBY & DENISE HINGSON PHONE 386.590.6931

ADDRESS 729 NW PARNELL AVENUE LAKE CITY FL 32055

CONTRACTOR STACY BECKHAM PHONE 352.745.2739

LOCATION OF PROPERTY 41-N TO BAUGHN RD.L, TO STOP SIGN PARNELL AVENUE, L, TO
BOTTOM OF DIP ON L, BEFORE REBEL ROAD.

TYPE DEVELOPMENT M/H & UTILITY ESTIMATED COST OF CONSTRUCTION .00

HEATED FLOOR AREA TOTAL AREA HEIGHT .00 STORIES

FOUNDATION WALLS ROOF PITCH FLOOR

LAND USE & ZONING A-3 MAX. HEIGHT 35

Minimum Set Back Requirments: STREET-FRONT 30.00 REAR 25.00 SIDE 25.00

NO. EX.D.U. 0 FLOOD ZONE XPP DEVELOPMENT PERMIT NO.

PARCEL ID 28-2S-16-01772-066 SUBDIVISION PINE HILLS ADDITION

LOT 16 BLOCK B PHASE UNIT TOTAL ACRES 1.00

000000375 N IH0000512 Denise L Hingson

Culvert Permit No. Culvert Waiver Contractor's License Number Applicant/Owner/Contractor

18"X32"MITERED 04-0795-N BLK RK N

Driveway Connection Septic Tank Number LU & Zoning checked by Approved for Issuance New Resident

COMMENTS: 1 FOOT ABOVE ROAD

PRE M/H OKAYED AS PER D.PRITCHARD.

Check# or Cash 1129

FOR BUILDING & ZONING DEPARTMENT ONLY

(footer/Slab)

Temporary Power Foundation Monolithic

 date/app. by date/app. by date/app. by

Under slab rough-in plumbing Slab Sheathing/Nailing

 date/app. by date/app. by date/app. by

Framing Rough-in plumbing above slab and below wood floor

 date/app. by date/app. by date/app. by

Electrical rough-in Heat & Air Duct Peri. beam (Lintel)

 date/app. by date/app. by date/app. by

Permanent power C.O. Final Culvert

 date/app. by date/app. by date/app. by

M/H tie downs, blocking, electricity and plumbing Pool

 date/app. by date/app. by date/app. by

Reconnection Pump pole Utility Pole

 date/app. by date/app. by date/app. by

M/H Pole Travel Trailer Re-roof

 date/app. by date/app. by date/app. by

BUILDING PERMIT FEE \$.00 CERTIFICATION FEE \$.00 SURCHARGE FEE \$.00

MISC. FEES \$ 200.00 ZONING CERT. FEE \$ 50.00 FIRE FEE \$ 11.34 WASTE FEE \$ 24.50

FLOOD ZONE DEVELOPMENT FEE \$ CULVERT FEE \$ 25.00 TOTAL FEE 310.84

INSPECTORS OFFICE CLERKS OFFICE

NOTICE: IN ADDITION TO THE REQUIREMENTS OF THIS PERMIT, THERE MAY BE ADDITIONAL RESTRICTIONS APPLICABLE TO THIS PROPERTY THAT MAY BE FOUND IN THE PUBLIC RECORDS OF THIS COUNTY. AND THERE MAY BE ADDITIONAL PERMITS REQUIRED FROM OTHER GOVERNMENTAL ENTITIES SUCH AS WATER MANAGEMENT DISTRICTS, STATE AGENCIES, OR FEDERAL AGENCIES.

"WARNING TO OWNER: YOUR FAILURE TO RECORD A NOTICE OF COMMENCEMENT MAY RESULT IN YOUR PAYING TWICE FOR IMPROVEMENTS TO YOUR PROPERTY. IF YOU INTEND TO OBTAIN FINANCING, CONSULT WITH YOUR LENDER OR AN ATTORNEY BEFORE RECORDING YOUR NOTICE OF COMMENCEMENT."

This Permit Must Be Prominently Posted on Premises During Construction

PLEASE NOTIFY THE COLUMBIA COUNTY BUILDING DEPARTMENT AT LEAST 24 HOURS IN ADVANCE OF EACH INSPECTION. IN ORDER THAT IT MAY BE MADE WITHOUT DELAY OR INCONVENIENCE, PHONE 758-1008. THIS PERMIT IS NOT VALID UNLESS THE WORK AUTHORIZED BY IT IS COMMENCED WITHIN 6 MONTHS AFTER ISSUANCE.

The Issuance of this Permit Does Not Waive Compliance by Permittee with Deed Restrictions.

PERMIT APPLICATION / MANUFACTURED HOME INSTALLATION APPLICATION

For Office Use Only

Zoning Official BLK 06.08.04

Building Official PK 8-10-01

AP# 0407-85

Date Received 7/30/04

By G

Permit # 22171

Flood Zone X per plot

Development Permit N/A

Zoning A-3

Land Use Plan Map Category A-3

Comments

Pre-Inspection is OK/DP

- ☒ Site Plan with Setbacks shown ☐ Environmental Health Signed Site Plan ☒ Env. Health Release
☒ Need a Culvert Permit ☒ Need a Waiver Permit ☒ Well letter provided ☒ Existing Well

- Property ID 33-25-16-D772-D66 Must have a copy of the property deed
 - New Mobile Home _____ Used Mobile Home ☒ Year 1984
 - Subdivision Information Pine Hills Addition, Lot 116, Block B
 - Applicant STACY BECKNAM Phone # 352.745.2739
 - Address PO BOX 2442 LAKE CITY, FL
 - Name of Property Owner (Jr) Bobby W. & Denise L. Hingson Phone # 386-590-6832
 - 911 Address 729 NW Parnell Ave., Lake City, FL 32055
 - Name of Owner of Mobile Home Bobby W. Hingson, Jr. Phone # 386-590-6831
 - Address 729 NW Parnell Ave., Lake City, FL 32055
 - Relationship to Property Owner Self
 - Current Number of Dwellings on Property 1
 - Lot Size 1.00 148x300 Total Acreage 1 acre
 - Explain the current driveway culvert permit NEEDED
 - Driving Directions Hwy 41 North past I-10 to Baughn Rd, (L) on Baughn to stop sign (Parnell Ave), (L) to bottom of dip, on (L) before Rebel Rd.
 - Is this Mobile Home Replacing an Existing Mobile Home NO
 - Name of Licensed Dealer/Installer STACY BECKNAM Phone # 352.745.2739
 - Installers Address PO. BOX 2442, LAKE CITY, FL 32056
 - License Number IH 0000512 (Installation Decal #) 220005
- = CLK # 1129 . 1/2 Sri NW # 375

PERMIT NUMBER

CONFIRM

PERMIT WORKSHEET

Installer Stacy Beckman License # THD000512

Address of home being installed 729 NW Parnell Ave.
Lake City, FL 32055

Manufacturer East Length x width 14' x 16' / 52

NOTE: if home is a single wide fill out one half of the blocking plan
if home is a triple or quad wide sketch in remainder of home

I understand Lateral Arm Systems cannot be used on any home (new or used) where the sidewall ties exceed 5 ft 4 in.

Installer's initials SB

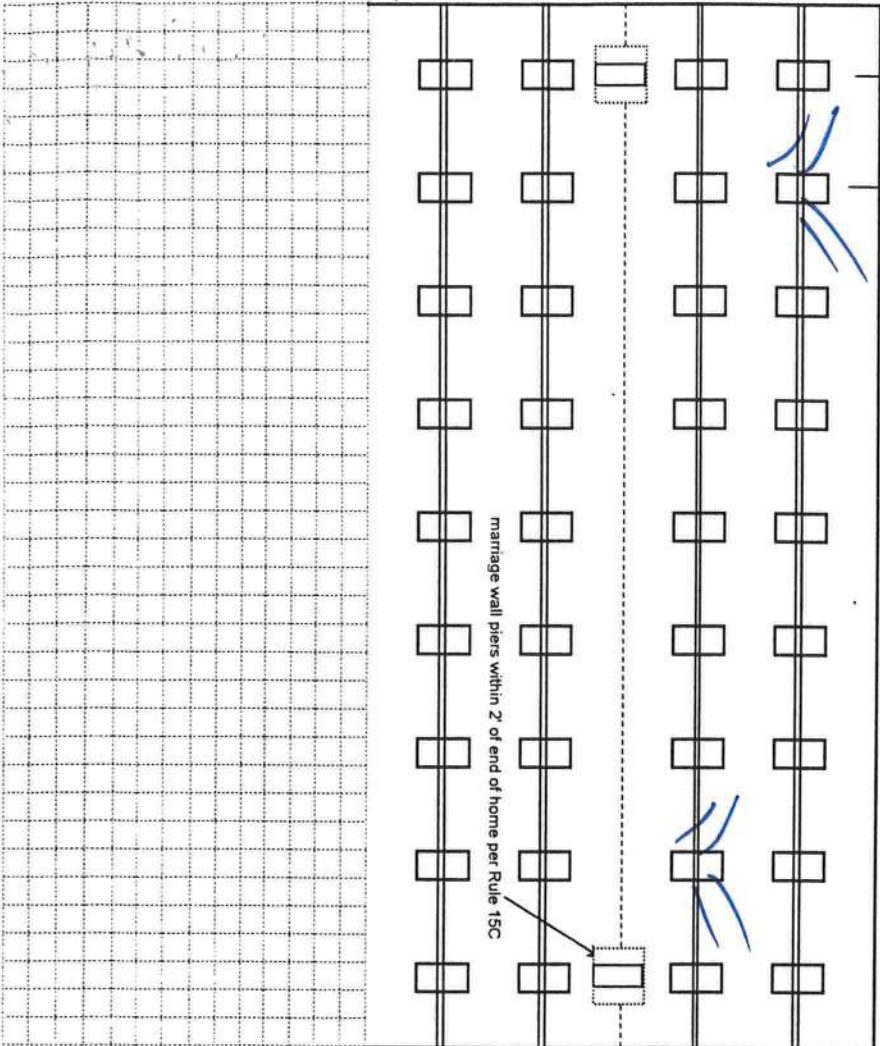

New Home ☐ Used Home ☒

Home installed to the Manufacturer's Installation Manual ☐

Home is installed in accordance with Rule 15-C ☐

Single wide ☒ Wind Zone II ☐ Wind Zone III ☐

Double wide ☐ Installation Decal # 228005

Triple/Quad ☐ Serial # E5485142FB2947GA

PIER SPACING TABLE FOR USED HOMES

Load bearing capacity (sq in)	16" x 16" (256)	18 1/2" x 18 1/2" (342)	20" x 20" (400)	22" x 22" (484)*	24" x 24" (576)*	26" x 26" (676)
1000 psf	3'	4'	5'	6'	7'	8'
1500 psf	4'6"	6'	7'	8'	8'	8'
2000 psf	6'	8'	8'	8'	8'	8'
2500 psf	7'6"	8'	8'	8'	8'	8'
3000 psf	8'	8'	8'	8'	8'	8'
3500 psf	8'	8'	8'	8'	8'	8'

* Interpolated from Rule 15C-1 pier spacing table.

PIER PAD SIZES

I-beam pier pad size

Perimeter pier pad size

Other pier pad sizes (required by the mfg.)

Draw the approximate locations of marriage wall openings 4 foot or greater. Use this symbol to show the piers.

List all marriage wall openings greater than 4 foot and their pier pad sizes below.

POPULAR PAD SIZES

Pad Size	Sq in
16 x 16	256
16 x 18	288
18.5 x 18.5	342
16 x 22.5	360
17 x 22	374
13 1/4 x 26 1/4	348
20 x 20	400
17 3/16 x 25 3/16	441
17 1/2 x 25 1/2	446
24 x 24	576
26 x 26	676

ANCHORS

4 ft 5 ft

FRAME TIES

within 2' of end of home spaced at 5' 4" oc

TIEDOWN COMPONENTS

OTHER TIES

Longitudinal Stabilizing Device (LSD)
Manufacturer East
Longitudinal Stabilizing Device w/ Lateral Arms
Manufacturer East

Sidewall Longitudinal Marriage wall Shearwall
Number 20

complete

POCKET PENETROMETER TEST

The pocket penetrometer tests are rounded down to 1500 psf or check here to declare 1000 lb. soil without testing.

X 1500 X 1500 X 1500

POCKET PENETROMETER TESTING METHOD

1. Test the perimeter of the home at 6 locations.
2. Take the reading at the depth of the footer.
3. Using 500 lb. increments, take the lowest reading and round down to that increment.

X 1500 X 1500 X 1500

TORQUE PROBE TEST

The results of the torque probe test is 200 inch pounds or check here if you are declaring 5" anchors without testing. A test showing 275 inch pounds or less will require 4 foot anchors.

Note: A state approved lateral arm system is being used and 4 ft. anchors are allowed at the sidewall locations. I understand 5 ft anchors are required at all centerline tie points where the torque test reading is 275 or less and where the mobile home manufacturer may requires anchors with 4000 lb. holding capacity.

Installer's initials

ALL TESTS MUST BE PERFORMED BY A LICENSED INSTALLER

Installer Name

Date Tested

Electrical

Connect electrical conductors between multi-wide units, but not to the main power source. This includes the bonding wire between multi-wide units. Pg. 151

Plumbing

Connect all sewer drains to an existing sewer tap or septic tank. Pg. 151

Connect all potable water supply piping to an existing water meter, water tap, or other independent water supply systems. Pg. 151

Site Preparation

Debris and organic material removed Swale Pad Other

Fastening multi wide units

Floor: Type Fastener: Length: Spacing: Walls: Type Fastener: Length: Spacing: Roof: Type Fastener: Length: Spacing: For used homes a min. 30 gauge, 8" wide, galvanized metal strip will be centered over the peak of the roof and fastened with galv. roofing nails at 2" on center on both sides of the centerline.

Gasket (weatherproofing requirement)

I understand a properly installed gasket is a requirement of all new and used homes and that condensation, mold, mildew and buckled marriage walls are a result of a poorly installed or no gasket being installed. I understand a strip of tape will not serve as a gasket.

Installer's initials

Type gasket

Installed: Between Floors Yes Between Walls Yes Bottom of ridgebeam Yes

Weatherproofing

The bottomboard will be repaired and/or taped. Yes Pg. 151 Siding on units is installed to manufacturer's specifications. Yes Fireplace chimney installed so as not to allow intrusion of rain water. Yes

Miscellaneous

Skirting to be installed. Yes No Dryer vent installed outside of skirting. Yes N/A Range downflow vent installed outside of skirting. Yes N/A Drain lines supported at 4 foot intervals. Yes Electrical crossovers protected. Yes Other:

Installer verifies all information given with this permit worksheet is accurate and true based on the

manufacturer's installation instructions and/or Rule 15C-1 & 2

Installer Signature

Date

CUSTOMER COPY

NOT FOR RECORDING

Prepared by and return to: Lenvil H. Dicks
P.O. Box 1
Lake City, FL 32056-0001

AGREEMENT FOR DEED

1. THIS AGREEMENT is entered into this 16th day of June, 2004, by and between Lenvil H. Dicks, a single man not residing on the property described herein, whose address is P.O. Box 1 Lake City, Florida 32056 ("Seller") and BOBBY W. HINGSON AND DENISE L. HINGSON, his wife, ("Buyer"), who is/are residents of the State of Florida and who directs that all mail be sent to 16527 156th Street, McAlpin, FL 32062.

2. AGREEMENT TO CONVEY. Provided that Buyer makes the payments and performs the other covenants required to be performed by the Buyer hereunder (collectively, the "Buyer's Obligations"), Seller agrees to convey to Buyer in fee simple by General Warranty Deed, free of all liens and encumbrances except Permitted Encumbrances (as hereinafter defined), the real property and any improvements thereon located in Columbia County, Florida, and more particularly described as follows (the "Property"):

Lot 16, Block B, Pine Hills Addition, a subdivision as recorded in Plat Book 6, Pages 36-36A, Columbia County, Florida, subject to Restrictions recorded in O. R. Book 0742, Page 0501, and Amendment of Deed of Restrictions recorded in O. R. Book 0803, Page 2377, Columbia County, FL, and subject to Power Line Easement.

Includes Well, Septic and Power Pole.

3. PURCHASE PRICE. In consideration of the Seller's covenants and agreements hereunder, Buyer hereby agrees to pay to the Seller the sum of Seventeen Thousand and 00/100 DOLLARS (\$ 17,000.00) (the "Purchase Price") to be paid by Buyer to Seller at Seller's address set forth above, or as necessary, to the escrow agent specified below, or at such other address as Seller shall designate, as follows:

Down Payment of Five Hundred and 00/100 DOLLARS (\$500.00) the receipt of which is hereby acknowledged by Seller ; And the balance of Sixteen Thousand Five Hundred and 00/100 DOLLARS (\$16,500.00) with interest thereon at the rate of thirteen percent (13 %) per annum in one hundred eighty (180) consecutive monthly installments in the amount of Two Hundred Eight and 76/100 DOLLARS (\$208.76) each, payable on the 15th day of each calendar month commencing on July 15, 2004.

4. SPECIAL TERMS AND CONDITIONS. A portion of a dedicated retention pond is located on the North edge of this lot.

N WITNESS WHEREOF, Buyer and Seller have executed this Agreement on the day and year first above written.

Nanci Nettles
witness

NANCI NETTLES
Suzanne Davis
witness
SUZANNE DAVIS

LENVIL H. DICKS

LENVIL H. DICKS

SELLER

STATE OF FLORIDA
COUNTY OF COLUMBIA

I HEREBY CERTIFY that on this day, before me, an officer duly authorized in the State aforesaid and in the County aforesaid to take acknowledgements, personally appeared LENVIL H. DICKS, to me known to be the person described in and who executed the foregoing instrument and he acknowledged before me that he executed the same, and did not take an oath.

WITNESS my hand and official seal in the County and State aforesaid this 16TH day of June, A.D. 2004



Nanci Nettles

Notary Public, State of Florida

Darlene R. Barrs
Signature of Witness

Darlene R. Barrs
Printed Name of Witness

Kathy Scapp
Signature of Witness

Kathy Scapp
Printed Name of Witness

BOBBY W. HINGSON
BUYER

DENISE L. HINGSON
BUYER

STATE OF FLORIDA
COUNTY OF Hamilton

I HEREBY CERTIFY that on this day, before me, an officer duly authorized in the State aforesaid and in the County aforesaid to take acknowledgements, personally appeared BOBBY W. HINGSON AND DENISE L. HINGSON, to me known to be the persons described in and who executed the foregoing instrument and they acknowledged before me that they executed the same, and did not take an oath.

WITNESS my hand and official seal in the County and State aforesaid this 25th day of June, A.D. 2004



Darlene R. Barrs

Notary Public, State of Florida

Darlene R. Barrs



STATE OF FLORIDA
DEPARTMENT OF HEALTH

APPLICATION FOR ONSITE SEWAGE DISPOSAL SYSTEM CONSTRUCTION PERMIT

Permit Application Number

04-0795X

PART II - SITE PLAN

Scale: Each block represents 5 feet and 1 inch = 50 feet.

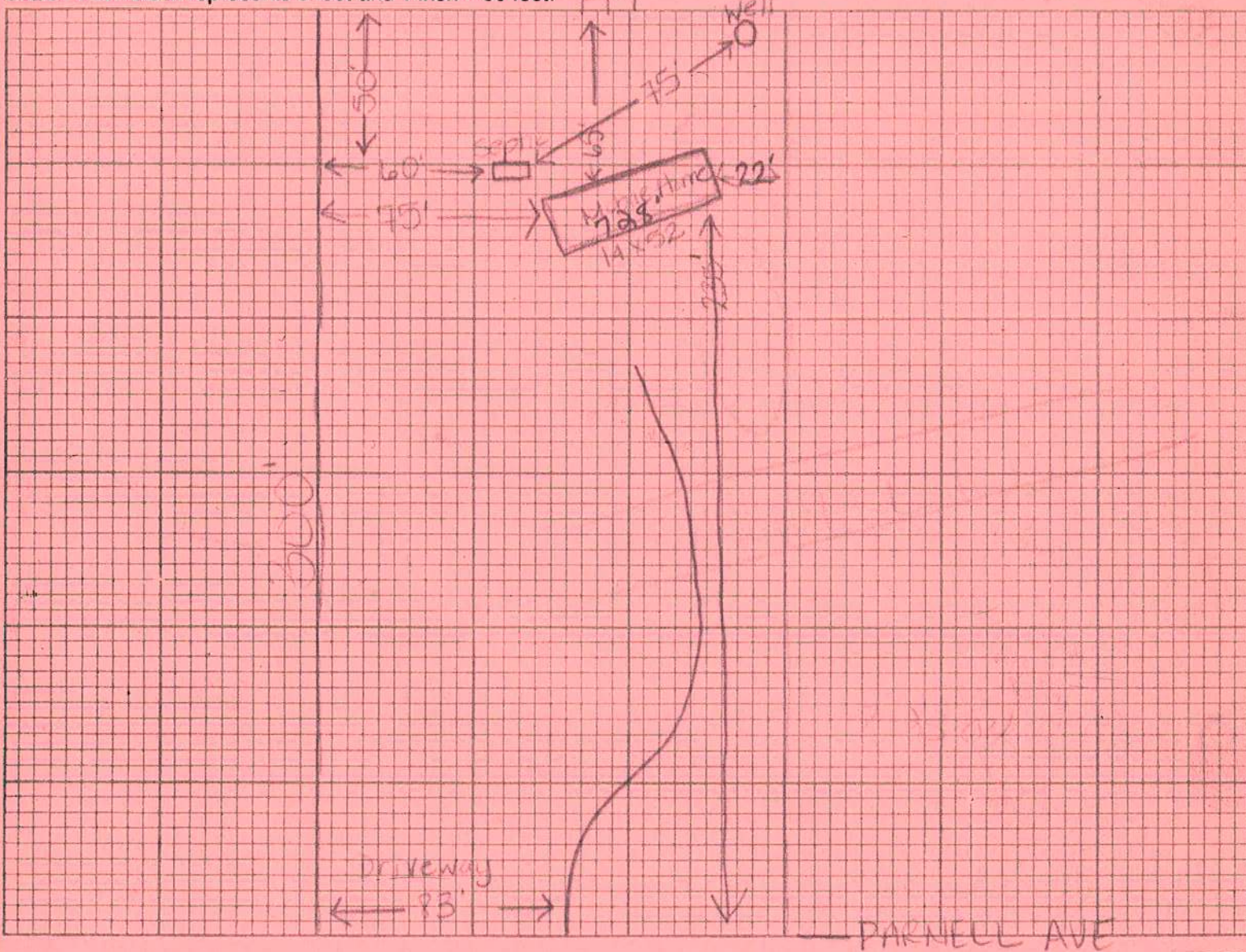

Notes:

Site Plan submitted by: Denise H. Hengen

Signature

Title

Plan Approved ☒

Not Approved ☐

Date 7-23-01

By [Signature] County Health Department

ALL CHANGES MUST BE APPROVED BY THE COUNTY HEALTH DEPARTMENT

LETTER OF AUTHORIZATION

Date: 7/29/04

Columbia County Building Department
P.O. Box 1529
Lake City, FL 32056

I Stacy Beckham, License No. 2H000512 do hereby
Authorize Danise Hinson to pull and sign permits on my
behalf.

Sincerely,

[Signature]

Sworn to and subscribed before me this 30th day of July, 2004.

Notary Public: [Signature]

My commission expires: _____

Personally Known ✓

Produced Valid Identification: _____



Columbia County Building Department Culvert Permit

Culvert Permit No.
000000375

DATE 08/10/2004 PARCEL ID # 28-2S-16-01772-066
APPLICANT DENSE HINGSON PHONE 386.590.6832
ADDRESS 729 NW PARNELL AVENUE LAKE CITY FL 32055
OWNER BOBBY & DENISE HINGSON PHONE 386.590.6832
ADDRESS _____ FL _____
CONTRACTOR STACY BECKHAM PHONE 352.745.2739
LOCATION OF PROPERTY 41-N PAST I-10 TO BAUGHN ROAD, L, TO STOP SIGN, PARNELL AVE., L TO
BOTTOM OF DIP, ON L, BEFORE REBEL ROAD.

SUBDIVISION/LOT/BLOCK/PHASE/UNIT PINE HILLS 16 B

SIGNATURE Denise Hingson

INSTALLATION REQUIREMENTS



Culvert size will be 18 inches in diameter with a total length of 32 feet, leaving 24 feet of driving surface. Both ends will be mitered 4 foot with a 4 : 1 slope and poured with a 4 inch thick reinforced concrete slab.

INSTALLATION NOTE: Turnouts will be required as follows:

- a) a majority of the current and existing driveway turnouts are paved, or;
- b) the driveway to be served will be paved or formed with concrete.

Turnouts shall be concrete or paved a minimum of 12 feet wide or the width of the concrete or paved driveway, whichever is greater. The width shall conform to the current and existing paved or concreted turnouts.



Culvert installation shall conform to the approved site plan standards.



Department of Transportation Permit installation approved standards.



Other _____

ALL PROPER SAFETY REQUIREMENTS SHOULD BE FOLLOWED
DURING THE INSTALLATION OF THE CULVERT.

135 NE Hernando Ave., Suite B-21
Lake City, FL 32055
Phone: 386-758-1008 Fax: 386-758-2160

Amount Paid 25.00



District No. 1 - Ronald Williams
District No. 2 - Dewey Weaver
District No. 3 - George Skinner
District No. 4 - Jennifer Flinn
District No. 5 - James Montgomery

2271

BOARD OF COUNTY COMMISSIONERS • COLUMBIA COUNTY



DATE 8.31.04

PERMIT # 2271

APPLICATION FOR CULVERT WAIVER

APPLICANT:

DENISE HINGSON

MAILING ADDRESS:

729 NW PANNEL AVENUE
LAKE CITY, FL 32055

PHONE#:

386.590.6831

OWNER OF PROPERTY:

DENISE HINGSON

STREET ADDRESS OR LOCATION OF PROPERTY:

41-NTU 3rd Ave
L, JO STOP SIGN: PANNEL AVENUE, L, JO BOTTOM 7 SIP
ON L, BEFORE REBEL ROAD

I HEREBY CERTIFY THAT I UNDERSTAND AND WILL FULLY COMPLY WITH THE DECISION OF THE COLUMBIA COUNTY PUBLIC WORKS DEPT. IN CONNECTION WITH THE HEREIN PROPOSED APPLICATION.

SIGNED:

Denise Hingson
(applicant)

I HEREBY CERTIFY THAT I HAVE EXAMINED THIS APPLICATION AND DETERMINED THAT THE CULVERT WAIVER IS:

☒ APPROVED

☐ NOT APPROVED

FEE:

0

SIGNED:

[Signature]
PUBLIC WORKS DEPT.

COMMENTS:

CULVERT

DATE:

8.10.04

NOT NEEDED DRIVEWAY IN
PLACE MEETS COUNTY APPROVAL

APPROPRIATE FIRST THURSDAY AT 7:00 P.M.
AND THIRD THURSDAY AT 7:00 P.M.

NO CHARGE: Originally
PAID FOR CULVERT PERMIT
8.10.04

District No. 1 - Ronald Williams
District No. 2 - Dewey Weaver
District No. 3 - George Skinner
District No. 4 - Jennifer Flinn
District No. 5 - James Montgomery

22171

BOARD OF COUNTY COMMISSIONERS • COLUMBIA COUNTY



IF THESE PEOPLE CALL, PLEASE TELL THEM
I WILL BE EVALUATING THEIR REQUEST, AND WILL
BE CALLING THEM IN A COUPLE OF DAYS.
30 DAY LETTER

THANKS,
JK

TO WHOM IT MAY CONCERN:

FINANCIAL HARDSHIPS: Applicants experiencing financial hardships, may by signing this form, receive a thirty day (30) extension for the installation of a culvert. Permission to connect to electrical service will be granted during this extended period on a temporary basis only. Failure to install a culvert during the allotted time period may result in the electrical service being disconnected.

I hereby certify that I am fully aware that I have thirty (30) days from this date signed by me in order to fully comply with the Columbia County Culvert Policy.

Applicant Signature: Denise L. Hingson date: 8/19/04

Date Power Called In: _____

Expiration Date: _____

Location: * Hwy 41 N to Baughn Rd,
(L) to stop sign (Parnell) (L) to
bottom of "dip", on (L) before
Rebel Rd - green mailbox, says "Hingson"
729 NW Parnell Rd Ave.

BOARD MEETS FIRST THURSDAY AT 7:00 P.M.

AND THIRD THURSDAY AT 7:00 P.M.

466-0158-home / 590-6832-cell

P. O. BOX 1529

LAKE CITY, FLORIDA 32056-1529

PHONE 755-4100

District No. 1 - Ronald Williams
District No. 2 - Dewey Weaver
District No. 3 - George Skinner
District No. 4 - Jennifer Flinn
District No. 5 - James Montgomery

22171

BOARD OF COUNTY COMMISSIONERS • COLUMBIA COUNTY

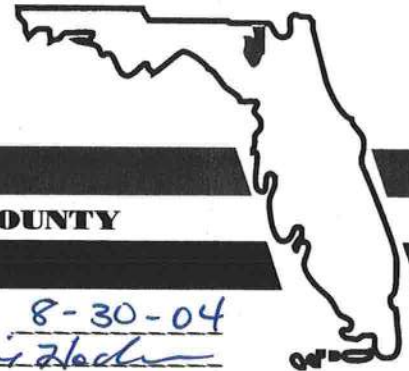

A copy of this letter was picked up from this office on 8-30-04
by Denise L. Hingson. Notorized by Laurie Hodson
on 8-30-04. SEAL



30 DAY LETTER

TO WHOM IT MAY CONCERN:

FINANCIAL HARDSHIPS: Applicants experiencing financial hardships, may by signing this form, receive a thirty day (30) extension for the installation of a culvert. Permission to connect to electrical service will be granted during this extended period on a temporary basis only. Failure to install a culvert during the allotted time period may result in the electrical service being disconnected.

I hereby certify that I am fully aware that I have thirty (30) days from this date signed by me in order to fully comply with the Columbia County Culvert Policy.

Applicant Signature: Denise L. Hingson date: 8/19/04

Date Power Called In: 8.26.04

Expiration Date: 9-26-04

Location: * Hwy 41 N to Baughn Rd,
(L) to stop sign (Parnell) (L) to
bottom of "dip", on (L) before
Rebel Rd - green mailbox, says "Hingson"
729 NW Parnell Rd Ave.

BOARD MEETS FIRST THURSDAY AT 7:00 P.M.

AND THIRD THURSDAY AT 7:00 P.M.

466-0158-home / 590-6832-cell
P. O. BOX 1529 ▼ LAKE CITY, FLORIDA 32056-1529 ▼ PHONE 755-4100