

COLUMBIA COUNTY PERMIT WORKSHEET

page 1 of 2

These worksheets must be completed and signed by the installer.
Submit the originals with the packet.

Installer Robert Sheppard License # IH1025386

911 Address where home is being installed. 13398 N US 441
LAKE CITY FL 32055

Manufacturer Flashed Length x width 24x88

NOTE: if home is a single wide fill out one half of the blocking plan
if home is a triple or quad wide sketch in remainder of home

I understand Lateral Arm Systems cannot be used on any home (new or used)
where the sidewall ties exceed 5 ft 4 in.

Installer's initials RS

Typical pier spacing 2' 6" 0

lateral

longitudinal

Show locations of Longitudinal and Lateral Systems
(use dark lines to show these locations)

marriage wall piers within 2' of end of home per Rule 15C

New Home ☐ Used Home ☒

Home installed to the Manufacturer's Installation Manual ☒

Home is installed in accordance with Rule 15-C ☐

Single wide ☐ Wind Zone II ☒ Wind Zone III ☐

Double wide ☒ Installation Decal # 2789

Triple/Quad ☐ Serial # SHS1 WGA 40847626A
SHS1 WGA 40847626B

PIER SPACING TABLE FOR USED HOMES

Load bearing capacity	Footer size (sq in)	16" x 16" (256)	18 1/2" x 18 1/2" (342)	20" x 20" (400)	22" x 22" (484)*	24" x 24" (576)*	26" x 26" (676)
1000 psf		3'	4'	5'	6'	7'	8'
1500 psf		4' 6"	6'	7'	8'	8'	8'
2000 psf		6'	8'	8'	8'	8'	8'
2500 psf		7' 6"	8'	8'	8'	8'	8'
3000 psf		8'	8'	8'	8'	8'	8'
3500 psf		8'	8'	8'	8'	8'	8'

* interpolated from Rule 15C-1 pier spacing table.

PIER PAD SIZES

I-beam pier pad size 17x25

Perimeter pier pad size 17x25

Other pier pad sizes (required by the mfg.) 17x25

Draw the approximate locations of marriage wall openings 4 foot or greater. Use this symbol to show the piers.

List all marriage wall openings greater than 4 foot and their pier pad sizes below.

Opening Pier pad size

Opening	Pier pad size

TIEDOWN COMPONENTS

Longitudinal Stabilizing Device (LSD)
Manufacturer Oliver 1101V
Longitudinal Stabilizing Device w/ Lateral Arms
Manufacturer Oliver 1101V

POPULAR PAD SIZES

Pad Size	Sq In
16 x 16	256
16 x 18	288
18.5 x 18.5	342
16 x 22.5	360
17 x 22	374
13 1/4 x 26 1/4	348
20 x 20	400
17 3/16 x 25 3/16	441
17 1/2 x 25 1/2	446
24 x 24	576
26 x 26	676

ANCHORS

4 ft ☒ 5 ft ☐

FRAME TIES

within 2' of end of home
spaced at 5' 4" oc ☒

OTHER TIES

Number
Sidewall 24
Longitudinal 4
Marriage wall 6
Shearwall 4

POCKET PENETROMETER TEST

The pocket penetrometer tests are rounded down to 1500 psf or check here to declare 1000 lb. soil _____ without testing.

X 1800X 1700X 1700

POCKET PENETROMETER TESTING METHOD

1. Test the perimeter of the home at 6 locations.
2. Take the reading at the depth of the footer.
3. Using 500 lb. increments, take the lowest reading and round down to that increment.

X 1800X 1700X 1700

TORQUE PROBE TEST

The results of the torque probe test is 295 inch pounds or check here if you are declaring 5' anchors without testing _____. A test showing 275 inch pounds or less will require 5 foot anchors.

Note: A state approved lateral arm system is being used and 4 ft. anchors are allowed at the sidewall locations. I understand 5 ft anchors are required at all centerline tie points where the torque test reading is 275 or less and where the mobile home manufacturer may requires anchors with 4000 lb holding capacity.

RS Installer's initials

ALL TESTS MUST BE PERFORMED BY A LICENSED INSTALLER

Installer Name

Robert Sheppard

Date Tested

10-29-12

Electrical

Connect electrical conductors between multi-wide units, but not to the main power source. This includes the bonding wire between multi-wide units. Pg. 29

Plumbing

Connect all sewer drains to an existing sewer tap or septic tank. Pg. 29

Connect all potable water supply piping to an existing water meter, water tap, or other independent water supply systems. Pg. 29

Site Preparation

Debris and organic material removed ☒
Water drainage: Natural _____ Swale _____ Pad ☒ Other _____

Fastening multi wide units

Floor: Type Fastener: lags Length: 5" Spacing: 16"
Walls: Type Fastener: screws Length: 4" Spacing: 16"
Roof: Type Fastener: lags Length: 6" Spacing: 16"
For used homes a min. 30 gauge, 8" wide, galvanized metal strip will be centered over the peak of the roof and fastened with galv. roofing nails at 2" on center on both sides of the centerline.

Gasket (weatherproofing requirement)

I understand a properly installed gasket is a requirement of all new and used homes and that condensation, mold, mildew and buckled marriage walls are a result of a poorly installed or no gasket being installed. I understand a strip of tape will not serve as a gasket.

Installer's initials

RS

Type gasket Foam
Pg. 22

Installed:

Between Floors Yes ☒
Between Walls Yes ☒
Bottom of ridgebeam Yes ☒

Weatherproofing

The bottomboard will be repaired and/or taped. Yes ☒ Pg. _____
Siding on units is installed to manufacturer's specifications. Yes ☒
Fireplace chimney installed so as not to allow intrusion of rain water. Yes ☒

Miscellaneous

Skirting to be installed. Yes _____ No ☒
Dryer vent installed outside of skirting. Yes _____ N/A ☒
Range downflow vent installed outside of skirting. Yes _____ N/A ☒
Drain lines supported at 4 foot intervals. Yes ☒
Electrical crossovers protected. Yes ☒
Other: _____

Installer verifies all information given with this permit worksheet is accurate and true based on the

Installer Signature

Robert SheppardDate 10-31-12

SITE PLAN EXAMPLE / WORKSHEET

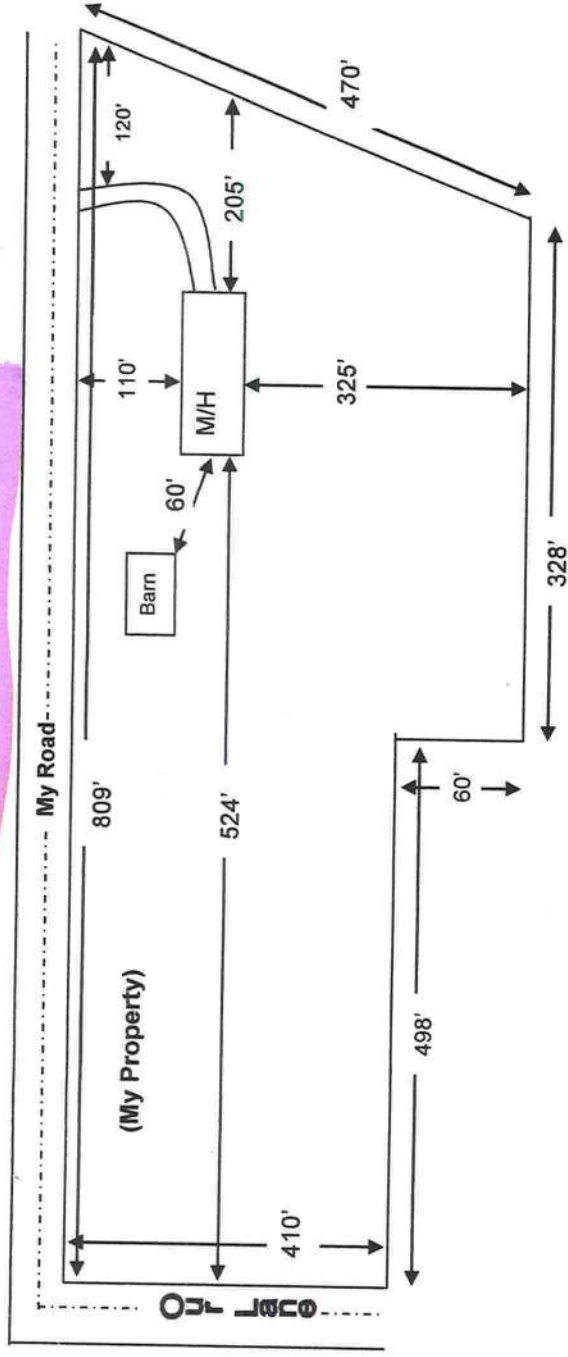

Use this example to draw your own site plan. Show all existing buildings and any other homes on this property and show the distances between them, Also show where the roads or roads are around the property. This site plan can also be used for the 911 Addressing department if you include the distance from the driveway to the nearest property line.

