

PRODUCT APPROVAL SPECIFICATION

20454

Location: _____ **SHEET** **Project Name:** _____

As required by Florida Statute 553.842 and Florida Administrative Code 9B-72, please provide the information and the product approval number(s) on the building components listed below if they will be utilized on the construction project for which you are applying for a building permit on or after April 1, 2004. We recommend you contact your local product supplier should you not know the product approval number for any of the applicable listed products. More information about statewide product approval can be obtained at www.floridabuilding.org

Category/Subcategory	Manufacturer	Product Description	Approval Number(s)
A. EXTERIOR DOORS			
1. Swinging			
2. Sliding			
3. Sectional			
4. Roll up			
5. Automatic			
6. Other			
B. WINDOWS			
1. Single hung			
2. Horizontal Slider			
3. Casement			
4. Double Hung			
5. Fixed			
6. Awning			
7. Pass-through			
8. Projected			
9. Mullion			
10. Wind Breaker			
11. Dual Action			
12. Other			
C. PANEL WALL			
1. Siding			
2. Soffits			
3. EIFS			
4. Storefronts			
5. Curtain walls			
6. Wall louver			
7. Glass block			
8. Membrane			
9. Greenhouse			
10. Other	Mitsubishi C.A.	Alpollic side panels for fuel canopy	FL12087
D. ROOFING PRODUCTS			
1. Asphalt Shingles			
2. Underlayments			
3. Roofing Fasteners			
4. Non-structural Metal	Metal Works LLC	3"x10" Deck pans for fueling canopy	07-0924.04
5. Built-Up Roofing			
6. Modified Bitumen			
7. Single Ply Roofing Sys			
8. Roofing Tiles			
9. Roofing Insulation			
10. Waterproofing			
11. Wood shingles /shakes			
12. Roofing Slate			

Category/Subcategory (cont.)	Manufacturer	Product Description	Approval Number(s)
13. Liquid Applied Roof Sys			
14. Cements-Adhesives – Coatings			
15. Roof Tile Adhesive			
16. Spray Applied Polyurethane Roof			
17. Other			
E. SHUTTERS			
1. Accordion			
2. Bahama			
3. Storm Panels			
4. Colonial			
5. Roll-up			
6. Equipment			
7. Others			
F. SKYLIGHTS			
1. Skylight			
2. Other			
G. STRUCTURAL COMPONENTS			
1. Wood connector/anchor			
2. Truss plates			
3. Engineered lumber			
4. Railing			
5. Coolers-freezers			
6. Concrete Admixtures			
7. Material			
8. Insulation Forms			
9. Plastics			
10. Deck-Roof			
11. Wall			
12. Sheds			
13. Other			
H. NEW EXTERIOR ENVELOPE PRODUCTS			
1.			
2.			

The products listed below did not demonstrate product approval at plan review. I understand that at the time of inspection of these products, the following information must be available to the inspector on the jobsite; 1) copy of the product approval, 2) the performance characteristics which the product was tested and certified to comply with, 3) copy of the applicable manufacturers installation requirements.

I understand these products may have to be removed if approval cannot be demonstrated during inspection.

Contractor or Contractor's Authorized Agent Signature

5988 Collins Rd Jacksonville, FL 32244

Location

02/02/04 – 2 of 2

Print Name

Date

Effective April 1, 2004

[DCA HOME](#) | [ABOUT DCA](#) | [DCA PROGRAMS](#) | [CONTACT DCA](#)

[BCIS Home](#) | [Log In](#) | [User Registration](#) | [Hot Topics](#) | [Submit Surcharge](#) | [Stats & Facts](#) | [Publications](#) | [FBC Staff](#) | [BCIS Site Map](#) | [Links](#) | [Search](#)

Product Approval

USER: Public User

[Product Approval Menu](#) > [Product or Application Search](#) > [Application List](#) > **Application Detail**

- ▶ COMMUNITY PLANNING
- ▶ HOUSING & COMMUNITY DEVELOPMENT
- ▶ EMERGENCY MANAGEMENT
- ▶ OFFICE OF THE SECRETARY

FL #	FL12087								
Application Type	New								
Code Version	2007								
Application Status	Approved								
Comments									
Archived									
Product Manufacturer	Mitsubishi Chemical America								
Address/Phone/Email	401 Volvo Parkway Chesapeake, VA 23320 (757) 382-5768 bill@alpolic.com								
Authorized Signature	William Yannetti bill@alpolic.com								
Technical Representative	William Yannetti								
Address/Phone/Email	401 Volvo Parkway Chesapeake, VA 23320 bill@ALPOLIC.com								
Quality Assurance Representative	William Yannetti								
Address/Phone/Email	401 Volvo Parkway Chesapeake, VA 23320 bill@ALPOLIC.com								
Category	Panel Walls								
Subcategory	Products Introduced as a Result of New Technology								
Compliance Method	Test Report								
Testing Lab	National Certified Testing Laboratories-York								
Quality Assurance Entity	Southwest Research Institute-Department of Fire Technology								
Quality Assurance Contract Expiration Date	08/09/2011								
Validated By	Steven M. Urlich, PE								
	<input checked="" type="checkbox"/> Validation Checklist - Hardcopy Received								
Certificate of Independence	FL12087_R0_COI_nctl_cert_of_independence.PDF								
Referenced Standard and Year (of Standard)	<table> <thead> <tr> <th>Standard</th><th>Year</th></tr> </thead> <tbody> <tr> <td>TAS201</td><td>1994</td></tr> <tr> <td>TAS202</td><td>1994</td></tr> <tr> <td>TAS203</td><td>1994</td></tr> </tbody> </table>	Standard	Year	TAS201	1994	TAS202	1994	TAS203	1994
Standard	Year								
TAS201	1994								
TAS202	1994								
TAS203	1994								
Equivalence of Product Standards									
Certified By									

Product Approval Method Method 1 Option B

Date Submitted 02/03/2009
 Date Validated 07/08/2009
 Date Pending FBC Approval 07/11/2009
 Date Approved 08/11/2009

Summary of Products

FL #	Model, Number or Name	Description
12087.1	ALPOLIC /ALPOLIC fr using the ACCU-TRACR SYSTEM by Altech Panel Systems,L.L.C.	ALPOLIC /ALPOLIC fr using the ACCU-TRACR SYSTEM by Altech Panel Systems,L.L.C.
Limits of Use Approved for use in HVHZ: Yes Approved for use outside HVHZ: Yes Impact Resistant: Yes Design Pressure: +50/-50 Other:		Installation Instructions FL12087_R0_II_NCTL_TAS_201,202,203_Test_Report.pdf FL12087_R0_II_noa_06-0531.12.pdf FL12087_R0_II_noa_06-0531.13.pdf Verified By: National Certified Testing Laboratories-York Test Reports FL12087_R0_TR_NCTL_TAS_201,202,203_Test_Report.pdf

[Back](#) [Next](#)

*Department of Community Affairs
 Florida Building Code Online
 Codes and Standards
 2555 Shumard Oak Boulevard
 Tallahassee, Florida 32399-2100
 (850) 487-1824, Fax (850) 414-8436
 © 2000-2010 The State of Florida. All rights reserved.*

[Privacy Statement](#) | [Copyright Statement](#) | [Accessibility Statement](#) | [Plug-in Software](#) | [Customer Service Survey](#) | [Contact Us](#)

Product Approval Accepts:





Building Code Compliance Office

Product Information

Product Information for N.O.A. 07-0924.04

NOA	07-0924.04
File Classification	High velocity hurricane zone
Category	Awning - Canopies
Subcategory	Unknown / Unselected
Material	Steel
Applicant	Metalworks, LLC
Status	File Approved
Expiration_Date	May/15/2013
Impact_Rate	[None]
Maximum_Design_Pressure_Positive	0
Maximum_Design_Pressure_Negative	0
Description	0.038" (min.) Galvalume 3" Deep x 16" Wide Panel for Canopy



BUILDING CODE COMPLIANCE OFFICE (BCCO)
PRODUCT CONTROL DIVISION

MIAMI-DADE COUNTY, FLORIDA
METRO-DADE FLAGLER BUILDING

140 WEST FLAGLER STREET, SUITE 1603
MIAMI, FLORIDA 33130-1563
(305) 375-2901 FAX (305) 375-2908

NOTICE OF ACCEPTANCE (NOA)

www.miamidade.gov

MetalWorks, LLC
2545 Monroe Drive, Suite E
Gainesville, Georgia 30507

SCOPE:

This NOA is being issued under the applicable rules and regulations governing the use of construction materials. The documentation submitted has been reviewed by Miami-Dade County Product Control Division and accepted by the Board of Rules and Appeals (BORA) to be used in Miami Dade County and other areas where allowed by the Authority Having Jurisdiction (AHJ).

This NOA shall not be valid after the expiration date stated below. The Miami-Dade County Product Control Division (In Miami Dade County) and/or the AHJ (in areas other than Miami Dade County) reserve the right to have this product or material tested for quality assurance purposes. If this product or material fails to perform in the accepted manner, the manufacturer will incur the expense of such testing and the AHJ may immediately revoke, modify, or suspend the use of such product or material within their jurisdiction. BORA reserves the right to revoke this acceptance, if it is determined by Miami-Dade County Product Control Division that this product or material fails to meet the requirements of the applicable building code.

This product is approved as described herein, and has been designed to comply with the High Velocity Hurricane Zone of the Florida Building Code.

DESCRIPTION: 0.038' (min.) Galvalume 3" deep x 16' wide Panel for Canopy

APPROVAL DOCUMENT: Drawing No. D1, sheets 1 through 5 of 5, titled "20 ga. (0.038" min.) Galvalume 16" x 3" Deck Pans", prepared by Carlos F. Castillo, P.E., dated December 01, 2007, signed and sealed by Carlos F. Castillo, P.E. on December 16, 2007, bearing the Miami-Dade County Product Control Revision stamp with the Notice of Acceptance number and the expiration date by the Miami-Dade County Product Control Division.

MISSILE IMPACT RATING: None

LABELING: Each panel shall bear a permanent label with the manufacturer's name or logo, city, state and the following statement: "Miami-Dade County Product Control Approved", unless otherwise noted herein.

RENEWAL of this NOA shall be considered after a renewal application has been filed and there has been no change in the applicable building code negatively affecting the performance of this product.

TERMINATION of this NOA will occur after the expiration date or if there has been a revision or change in the materials, use, and/or manufacture of the product or process. Misuse of this NOA as an endorsement of any product, for sales, advertising or any other purposes shall automatically terminate this NOA. Failure to comply with any section of this NOA shall be cause for termination and removal of NOA.

ADVERTISEMENT: The NOA number preceded by the words Miami-Dade County, Florida, and followed by the expiration date may be displayed in advertising literature. If any portion of the NOA is displayed, then it shall be done in its entirety.

INSPECTION: A copy of this entire NOA shall be provided to the user by the manufacturer or its distributors and shall be available for inspection at the job site at the request of the Building Official.

This NOA revises & renews NOA # 03-0325.01 & consists of this page 1, evidence submitted pages E-1 & E-2 & approval document mentioned above.

The submitted documentation was reviewed by Helmy A. Makar, P.E., M.S.



Helmy A. Makar
01/17/2008

NOA No. 07-0924.04
Expiration Date: 05/15/2013
Approval Date: 01/17/2008
Page 1

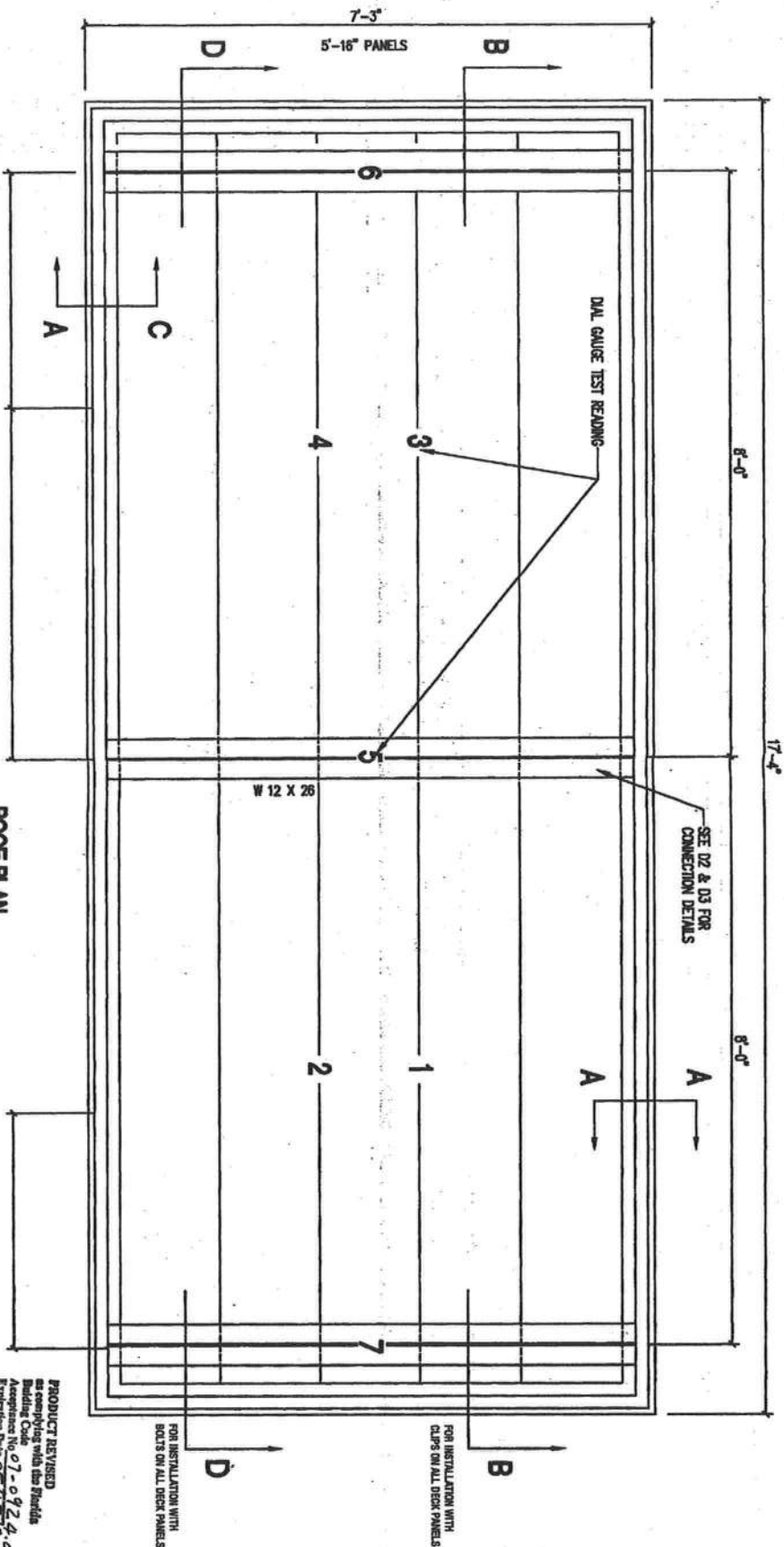

ROOF PLAN
SCALE: 3/4" = 1'-0"

PRODUCT REVISED
as completed with the Florida
Building Code
Acceptance No. 07-0924.04
Expiration Date 05/15/2013
By: *Heather H. Miller*
Division

REVISIONS			
NO.	DESCRIPTION	DATE	BY



MetalWorks, LLC
2545 Monroe Drive, Suite E
Gainesville, GA 30607
Phone: 770-532-6311

CARLOS F. CASTILLO, P.E.
State of Florida Structural Engineer
Certificate #11885
3000 Highway 17 South
Bartow, FL 33830
Phone: 813-997-7233

CF
11/11/11

TITLE
20 GA. (0.038" MIN.) GALVALUME
16" X 3" DECK PANELS

DESIGNED BY: **BGH**
SCALE: **3/4" = 1'-0"**
DATE: **12/1/07**
CHECKED BY: **D1**
SHEET: **1** OF: **5**

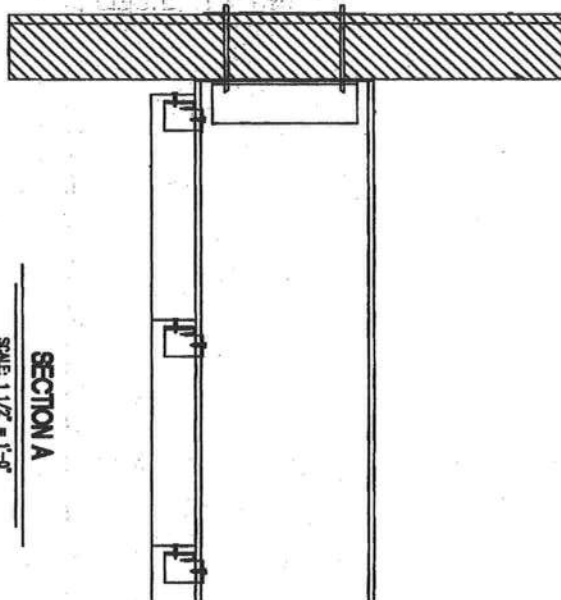

SECTION A

SCALE: 1 1/2" = 1'-0"

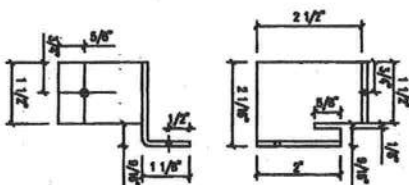

18ga. STEEL "DECK PAN RIB-CLIP"
EACH SIDE W/((1) 12-24 x 1 1/4"
HHH TEK/5 BOLTED TO STRINGER AND
(1) 12-14 x 3/4" HHH TRAXX/3
FASTENER THRU DECK PAN RIBS.

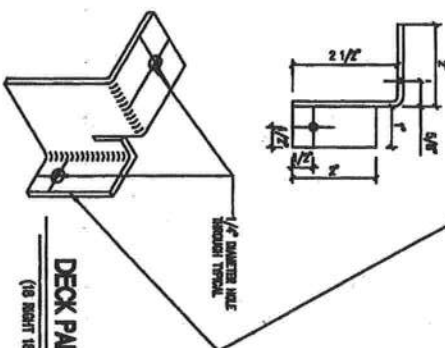

DECK PAN RIB CLIP

(18 BOLT TO LEFT BEAD)

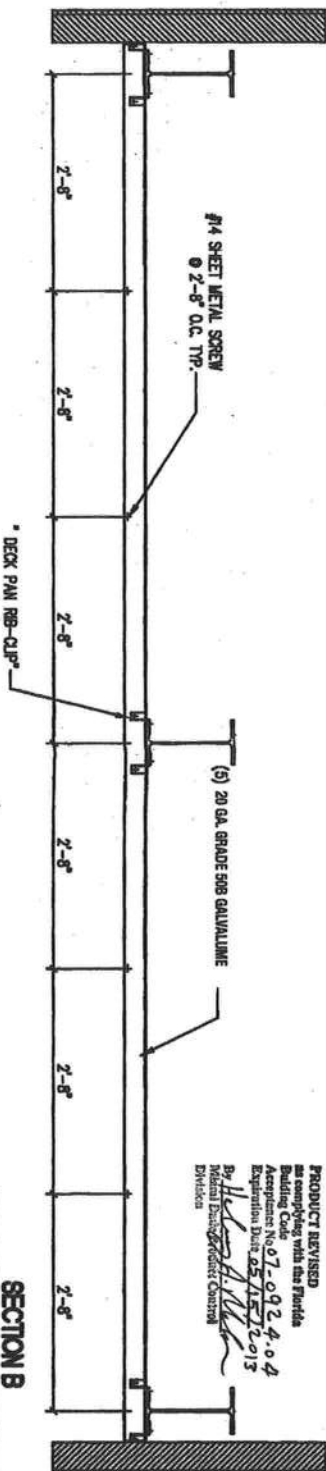

SECTION B

SCALE: 3/4" = 1'-0"

PRODUCT REVISED
as exemplified with this Florida
Building Code
Acceptance No. 07-0924-0-4
Expiration Date 05/15/2013
By: *[Signature]*
Division

REVISIONS	DATE	BY	CHK
1			
2			
3			
4			
5			
6			
7			
8			
9			
10			



MetalWorks, LLC
2545 Monroe Drive, Suite E
Gainesville, GA 30507
Phone 770-532-6311

CARLOS F. CASTILLO, P.E.
State of Florida Structural Engineer
Certificate #10000
3000 Highway 17 South
Baton Rouge, LA 70802
Phone 813-597-7233

[Signature]
12/1/07

TITLE	DESIGNED BY	CHECKED BY
20 GA. (0.036" MIN.) GALVALUME 16" X 3" DECK PAN RIBS FOR CLIP CONNECTIONS	BGH	DATE 12/1/07
APPROVED BY	DATE	REVISIONS
		D1
		2
		5

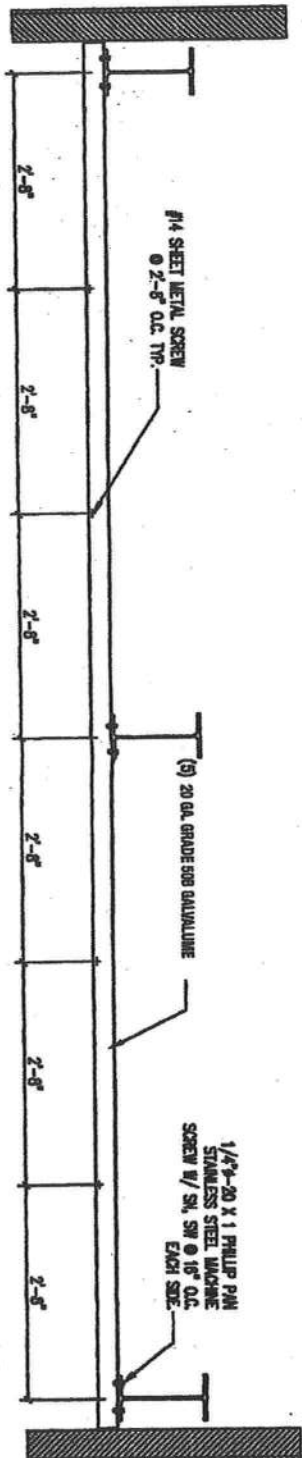
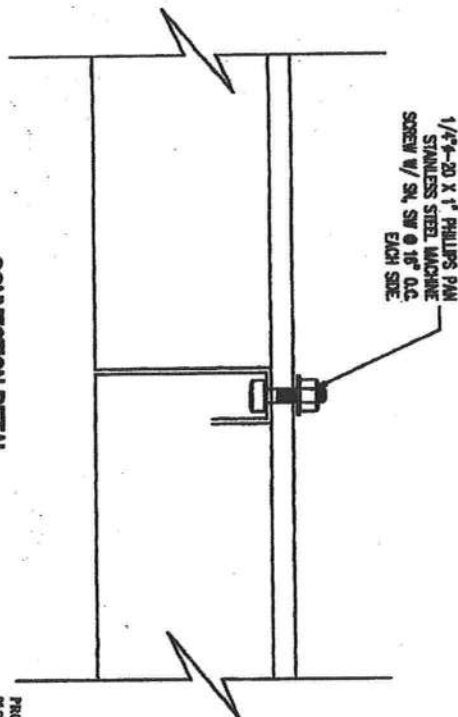
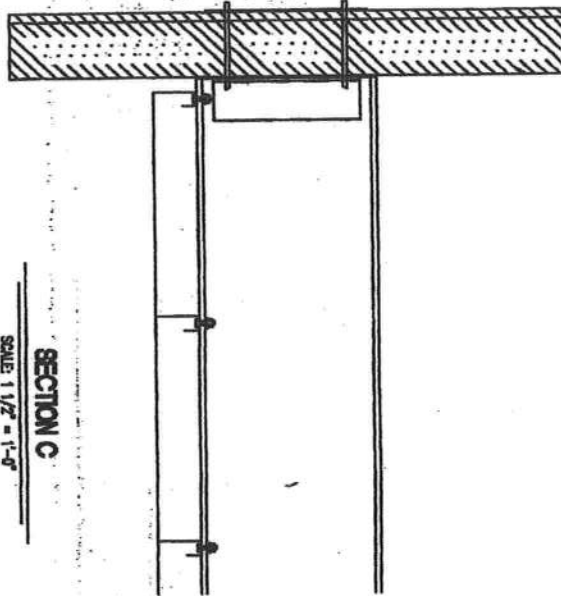

PRODUCT REVISED
 as complying with the Florida
 Building Code
 Acceptance No: 07-0924-04
 Expiration Date: 05/15/2013

By: William A. Webb
 District Underwriter
 Division

[illegible]

MetalWorks, LLC
2545 Monroe Drive, Suite E
Gainesville, GA 30507
Phone: 770-532-6311

CARLOS F. CASTILLO, P.E.
State of Florida Structural Engineer
Certificate #11885
3000 Highway 17 South
Bartow, FL 33830
Phone/Fax 813-597-7233

12/11/2017

**20 GA. (0.038" MIN.) GALVALUME
16" X 3" DECK PANS
FOR BOLTS CONNECTIONS**

ISSUED BY	DATE
BGH	12/1/07
SCALE	
$3/4" = 1'-0"$	
JOB NUMBER	ISSUED DATE
00122	D1
3	5

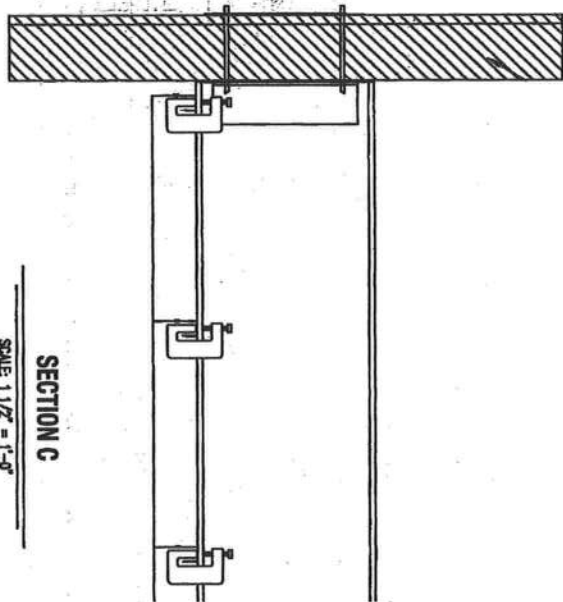

SECTION C
SCALE 1 1/2" = 1'-0"

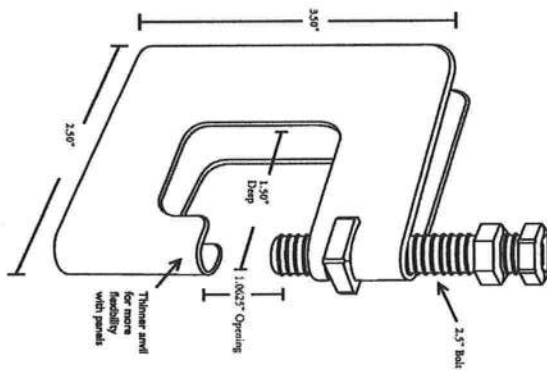

- Made from 12 Gauge Galvanized Steel
- 5/16" - 18 x 2 1/2" Pinned Square Nut
- 5/16" - 18 Pinned Square Nut
- 5/16" - 18 Pinned Hex Head Lock Nut
- Rounded edges, safe and easy to handle
- No left or right - fits either side

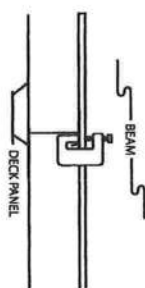

Typical Application



Lap Detail

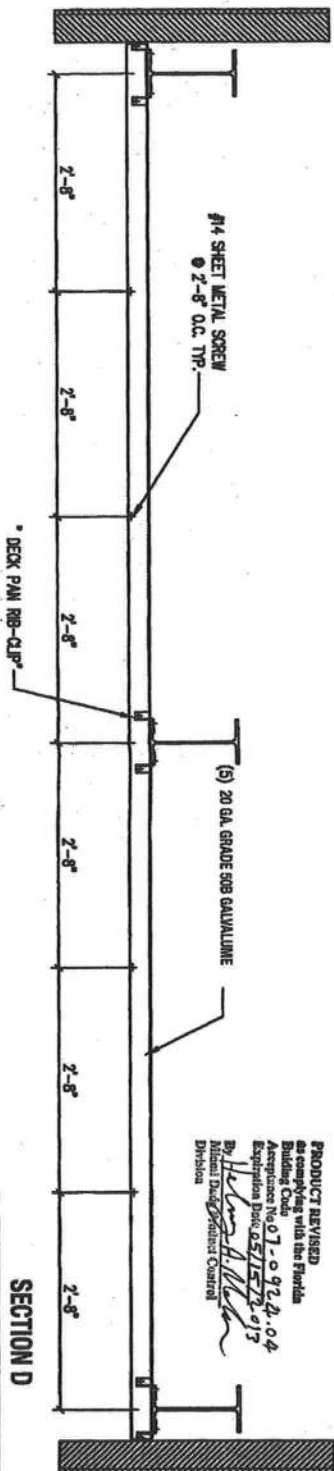

SECTION D
SCALE 3/4" = 1'-0"

PRODUCT REVISED
as compared with the Florida
Building Code
Acceptance No. 07-0924.04
Expiration Date 05/15/2013
By: *Heather H. H. H.*
Division

REFERENCES			
1.	20 GA. (4038" MIN.) GALVALUME	DESIGNED BY	DATE
2.	18" X 3" DECK PANS	SCALE	12/1/07
3.	FOR DECK CLIP CONNECTIONS	BY	D1
4.		DATE	
5.		DATE	
6.		DATE	
7.		DATE	
8.		DATE	
9.		DATE	
10.		DATE	
11.		DATE	
12.		DATE	
13.		DATE	
14.		DATE	
15.		DATE	
16.		DATE	
17.		DATE	
18.		DATE	
19.		DATE	
20.		DATE	
21.		DATE	
22.		DATE	
23.		DATE	
24.		DATE	
25.		DATE	
26.		DATE	
27.		DATE	
28.		DATE	
29.		DATE	
30.		DATE	
31.		DATE	
32.		DATE	
33.		DATE	
34.		DATE	
35.		DATE	
36.		DATE	
37.		DATE	
38.		DATE	
39.		DATE	
40.		DATE	
41.		DATE	
42.		DATE	
43.		DATE	
44.		DATE	
45.		DATE	
46.		DATE	
47.		DATE	
48.		DATE	
49.		DATE	
50.		DATE	
51.		DATE	
52.		DATE	
53.		DATE	
54.		DATE	
55.		DATE	
56.		DATE	
57.		DATE	
58.		DATE	
59.		DATE	
60.		DATE	
61.		DATE	
62.		DATE	
63.		DATE	
64.		DATE	
65.		DATE	
66.		DATE	
67.		DATE	
68.		DATE	
69.		DATE	
70.		DATE	
71.		DATE	
72.		DATE	
73.		DATE	
74.		DATE	
75.		DATE	
76.		DATE	
77.		DATE	
78.		DATE	
79.		DATE	
80.		DATE	
81.		DATE	
82.		DATE	
83.		DATE	
84.		DATE	
85.		DATE	
86.		DATE	
87.		DATE	
88.		DATE	
89.		DATE	
90.		DATE	
91.		DATE	
92.		DATE	
93.		DATE	
94.		DATE	
95.		DATE	
96.		DATE	
97.		DATE	
98.		DATE	
99.		DATE	
100.		DATE	

MetaWorks, LLC
2545 Monroe Drive, Suite E
Gainesville, GA 30607
Phone: 770-532-6311

CARLOS P. CASTILLO, P.E.
State of Florida, Structural Engineer
Certificate #10000
3000 Highway 17 South
Burrton, FL 33840
Phone: 813-997-7233

12/1/07

20 GA. (4038" MIN.) GALVALUME
18" X 3" DECK PANS
FOR DECK CLIP CONNECTIONS

DESIGNED BY
BGH
SCALE
3/4" = 1'-0"
DATE
12/1/07
BY
D1
DATE
12/1/07



1. Steel Deck Shall Be Galvalume 20ga. (.038 Min.) ASTM A792-94 GR. 50B

- B. Panel with Bolted Connections (Comply with Details of Sheet Number 3)
 Maximum Allowable Bending Moment of Panel at Support = 833 ft.-lbs.
 Maximum Allowable Bending Moment of Panel Between Supports = 537 ft.-lbs.
 EI Value of Panel = 10.7×10^{-6} lbs. - in.²
 Maximum Allowable Deflection of Panel = $L/160$
 Maximum Support Reaction = 897 lbs. (For Two $\frac{1}{4}$ " - 20 x 1" Phillip Pan Stainless Steel Machine Screws with SN and SW Per Support as Shown on Sheet Number 3).

- c. Panel with Deck Clip Connections (Comply with Details of Sheet Number 4)
Maximum Allowable Bending Moment of Panel at Supports = 933 ft.-lbs.
Maximum Allowable Bending Moment of Panel Between Supports = 537 ft.-lbs.
EI Value of Panel = 10.7×10^{-6} lbs. - in.²
Maximum Allowable Deflection of Panel = $L/180$
Maximum Support Reaction = 897 lbs. (For Two Deck Clips per Support as Shown on Sheet Number 4)

2. The Above Allowables of the Clipped and Bolted Connections Panels are Based on a 16" Wide Panel Loading. To Get the Wind Load Pressure per Square Foot, Multiple Panel Load Times 12/16.
3. This Panel Should Be Used Only in the Construction of Open Canopies.
4. Each Actual Canopy Project Shall Be Constructed Using the Same Panel Cross Section and Support Details at Stringers and Interlocking Seams as Shown on This Approval. The Design of the Panel Span Shall Be in Compliance With All of the Above Allowables.

1. Canopies Shall Be Designed In Compliance with the Florida Building Code, 2004 and According to Wind Provisions of ASCE 7-02.

- Design Pressure = Comply with the Panel Specifications
Shown Above.
- Test Pressure = +190/-175 psf
Design Pressure = Comply with the Panel Specifications
Shown Above.
- Deck Clip Connection – Test Pressure = +190/-175 psf
Design Pressure = Comply with the Panel Specifications
Shown Above.
- Live Load Test Pressure = 30 psf.

PRODUCT REVISED
as complying with the Florida
Building Code
Acceptance No. 07-0924-04
Expiration Date 08/15/2015
By Heather M. Mc
Millard Spahr Products Control
Division

ORDERED BY	DATE
BGH	12/1/07
SCALE	FORMING NAME
3/4" = 1'-0"	D01
JOB NUMBER	
5	5