

45

Columbia County Property Appraiser

CAMA updated: 10/15/2012

2012 Tax Year

Parcel: 30-7S-17-10058-673

[<< Next Lower Parcel] [Next Higher Parcel >>]

[Tax Collector] [Tax Estimator] [Property Card]

[Parcel List Generator]

[Interactive GIS Map] [Print]

Search Result: 1 of 1

Owner & Property Info

Owner's Name	SMITH KATHY C		
Mailing Address	363 SW MAPLETON ST FT WHITE, FL 32038		
Site Address	363 SW MAPLETON ST		
Use Desc. (code)	SINGLE FAM (000100)		
Tax District	3 (County)	Neighborhood	30717
Land Area	1.000 ACRES	Market Area	02
Description	NOTE: This description is not to be used as the Legal Description for this parcel in any legal transaction.		
LOT 83 SANTA FE RIVER PLANTATIONS REPLAT OF LOT 38. ORB 441-211, 728-475, 982-2239.			

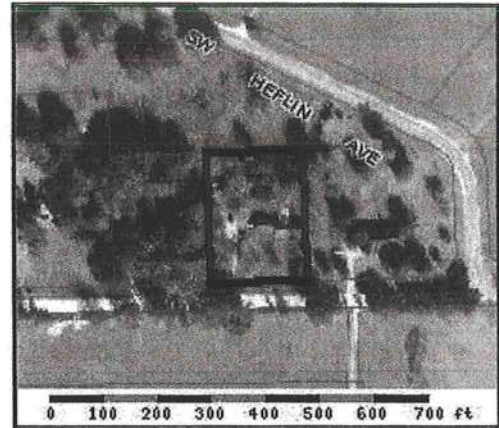

Property & Assessment Values

2012 Certified Values		
Mkt Land Value	cnt: (0)	\$17,714.00
Ag Land Value	cnt: (1)	\$0.00
Building Value	cnt: (1)	\$93,344.00
XFOB Value	cnt: (5)	\$5,730.00
Total Appraised Value		\$116,788.00
Just Value		\$116,788.00
Class Value		\$0.00
Assessed Value		\$116,788.00
Exempt Value	(code: HX H3 WX)	\$50,500.00
Total Taxable Value	Cnty: \$66,288 Other: \$66,288 Schl: \$91,288	

2013 Working Values

NOTE:
2013 Working Values are NOT certified values and therefore are subject to change before being finalized for ad valorem assessment purposes.

[Show Working Values]

Sales History

[Show Similar Sales within 1/2 mile]

Sale Date	OR Book/Page	OR Code	Vacant / Improved	Qualified Sale	Sale RCode	Sale Price
4/28/2003	982/2239	WD	I	Q		\$122,500.00
4/30/1990	728/475	WD	V	Q		\$5,100.00

Building Characteristics

Bldg Item	Bldg Desc	Year Blt	Ext. Walls	Heated S.F.	Actual S.F.	Bldg Value
1	SINGLE FAM (000100)	1990	CEDAR (12)	1517	2327	\$92,163.00
Note: All S.F. calculations are based on exterior building dimensions.						

Extra Features & Out Buildings

Code	Desc	Year Blt	Value	Units	Dims	Condition (% Good)
0166	CONC,PAVMT	0	\$800.00	0000400.000	16 x 25 x 0	(000.00)
0120	CLFENCE 4	1993	\$2,880.00	0000640.000	0 x 0 x 0	(000.00)
0169	FENCE/WOOD	0	\$1,050.00	0000140.000	0 x 0 x 0	(000.00)
0294	SHED WOOD/	0	\$600.00	0000080.000	8 x 10 x 0	(000.00)

0296	SHED METAL	1993	\$400.00	0000080.000	8 x 10 x 0	(000.00)
Land Breakdown						
Lnd Code	Desc	Units	Adjustments	Eff Rate	Lnd Value	
000100	SFR (MKT)	1 AC	1.00/1.00/1.00/1.00	\$17,714.70	\$17,714.00	
Columbia County Property Appraiser				CAMA updated: 10/15/2012		

1 of 1

DISCLAIMER

This information was derived from data which was compiled by the Columbia County Property Appraiser Office solely for the governmental purpose of property assessment. This information should not be relied upon by anyone as a determination of the ownership of property or market value. No warranties, expressed or implied, are provided for the accuracy of the data herein, it's use, or it's interpretation. Although it is periodically updated, this information may not reflect the data currently on file in the Property Appraiser's office. The assessed values are NOT certified values and therefore are subject to change before being finalized for ad valorem assessment purposes.