



Order Summary

dba: RENEWAL BY ANDERSEN OF FLORIDA

Legal Name: JLM Windows, LLC | License # CGC1527613
997 West Kennedy Blvd. Ste A-18 | Orlando, FL 32810
Phone: 407-803-4723 | Fax: 407-386-8262 | concierge@rbafra.com
Measure Tech: Todd Chambers, (512)731-8229

KAY SUMMERLIN

1199 Sw Troy St
Lake City, FL 32025
H: (386)466-4940 | C:

ID#	ROOM	SIZE	DETAILS
-----	------	------	---------

JOB

101	frt door	0"	0"	Misc: Misc, provia order 7502308, Provia Door with storm door. Construction: None Material: None
-----	----------	----	----	---

PRODUCTS: 1 WINDOWS: 0 PATIO DOORS: 0 SPECIALTY: 0 MISC: 1

Updated 6/17/21

JOB NOTES

Estimated Duration:

FLOORPLAN - 1ST FLOOR

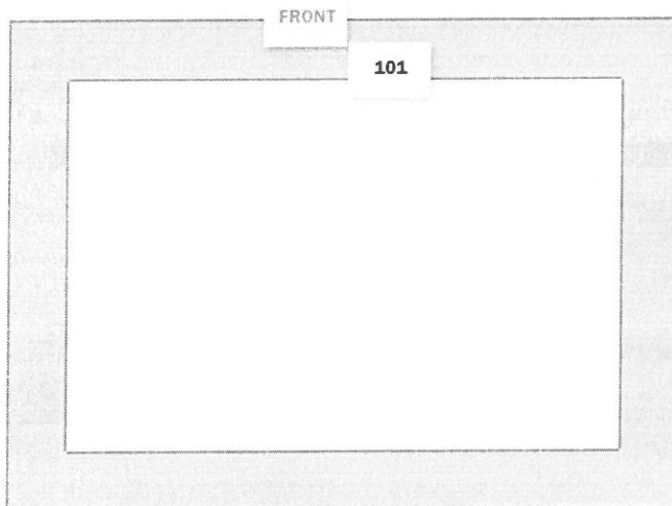

UNIT NOTES

101 Provia Door with storm door.

JOB PHOTOS

YOUR PROFESSIONAL-CLASS PRODUCT

Legacy 20-Gauge Smooth Steel Entry Door with Clear Glass



SIZING

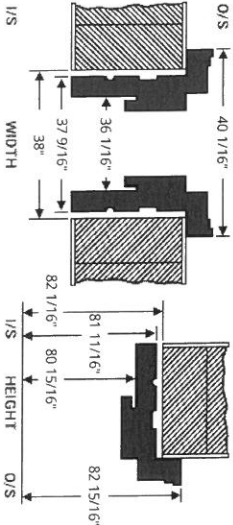

HANDING

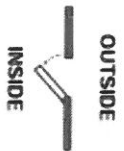

ENERGY

ENERGY PERFORMANCE RATINGS

U-Factor (U.S./h·ft²·°F) 0.24
Solar Heat Gain Coefficient 0.09

ADDITIONAL PERFORMANCE RATINGS

Visible Transmittance 0.15



DPV/L: 55/55, NAME: N1011565.12-R3



QUOTE INFORMATION

Job: Summerlin
Tag: Screen
Order #7502308

DETAILS

- Legacy Single Entry Door in Framesaver Frame**
- Certified Windload Rating (FL#12463.9)
- 36" x 80" Nominal Size
- Unit Size: 37 9/16" x 81 11/16"
- Frame Depth: 4 9/16"
- 2" Standard Brickmold - Shipped Unattached With Storm Door - Sized to Fit on Brickmold Left Hand Inswing - Inside Looking Out
- Entry Door**
- 2 Panel 230 Style 20-Gauge Smooth Steel Door
- Comfortech DLA
- Prime Only Inside and Outside
- Hardware**
- All Hardware in Satin Nickel Finish
- Georgian Lockset
- Thumbturn Deadbolt
- Frame**
- Prime Only Inside Frame
- Mill Finish ZAC Auto-Adjusting Threshold (6 3/8" Depth)
- Satin Nickel Ball Bearing Hinges
- Security Plate

DocuSigned by:
Kay Summerlin
7FAE9E1EAAC4B...

YOUR PROFESSIONAL-CLASS PRODUCT

Spectrum Series Storm Door - Model 291 Full View

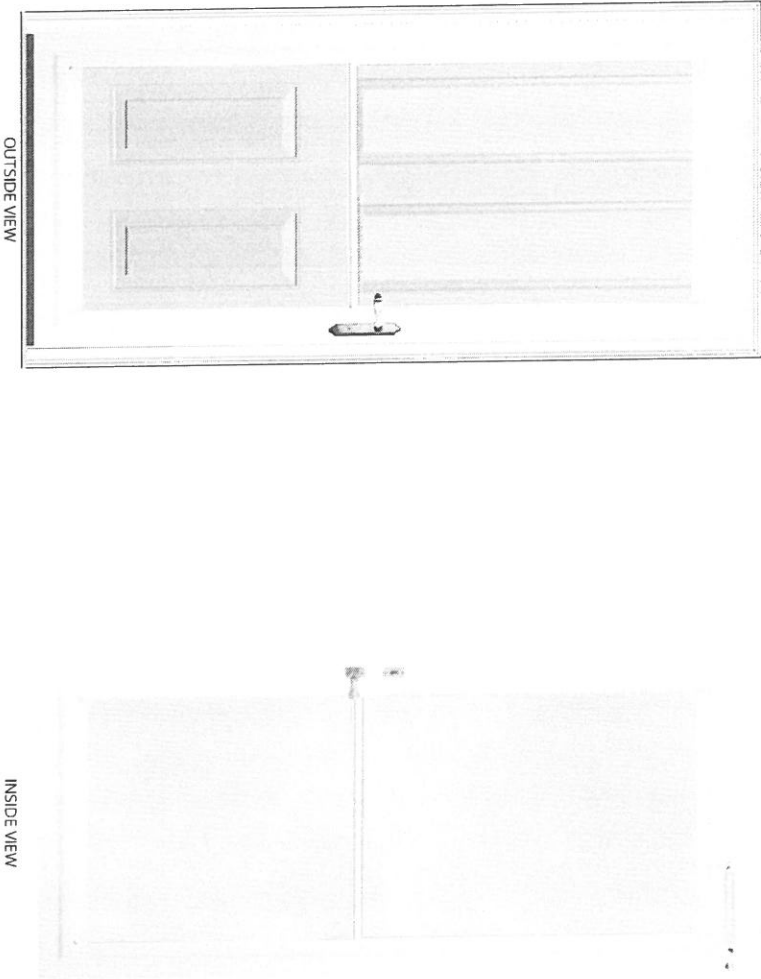

SIZING

Custom Opening Size: 36" x 80"
Minimum Opening Size: 35 3/4" x 79 13/16"
Maximum Opening Size: 36 1/8" x 80 11/16"
Unit Size (Inside Z-Bar): 35 5/8" x 79 3/4"
Tip-to-Tip (Outside Z-Bar): 36 13/16" x 80 1/4"
Slab Size: 35 1/8" x 79 1/8"

HANDING

Hinge on the Left
Outside Looking In

ENERGY

ENERGY PERFORMANCE RATINGS

U-Factor (U.S.I-P) Solar Heat Gain Coefficient
1.04 0.86

ADDITIONAL PERFORMANCE RATINGS

Visible Transmittance Total UV
0.90 0.73

QUOTE INFORMATION

Job: Summerlin
Order #7502308



877.389.0835
2150 State Route 39
SugarCreek, OH 44681

DETAILS

Spectrum 291 Full View
36" x 80" Standard Size
Snow Mist White
Slimline Z-Bar
Non Pre-Hung
Color Matched Piano Hinge
Hinge on Left (Viewed from Outside)
Stop Strip - Three Sides
1-1/2" Color Matched Bottom Expander
Satin Nickel Windsor Handleset (DH241)
Assign a Random Key Number
Handleset Prep at Standard Location (39") on Right (Viewed from Outside)
Color Matched Easy-Set Heavy Duty Closer (DH306-01)
Clear Glass
Two Screens

INFORMATION AND WARNINGS

The Stop Strip 3 Sides option is only necessary for use with a FusionFrame combo unit install.

DocuSigned by:
Kay Summerlin
7FAEF9E1EAAC4C6...

NOTICE OF COMMENCEMENT

Clerk's Office Stamp

Tax Parcel Identification Number:

10-45-14-02853-002(1243)

THE UNDERSIGNED hereby gives notice that improvements will be made to certain real property, and in accordance with Section 713.13 of the Florida Statutes, the following information is provided in this NOTICE OF COMMENCEMENT.

1. Description of property (legal description): beg of SW cor of NW 1/4, Run N 30c Ft. E 244 Ft. S 330 Ft. W 264 Ft. to P.O. E x the W 64 Ft 10-45-14
a) Street (job) Address: 1199 SW Troy St
2. General description of improvements: replacing windows and/or doors
3. Owner information or Lessee information if the Lessee contracted for the improvements:
a) Name and address: SCHULTZ, LAYNE & SUMMERLIN KAY C 1199 SW TROY STREET, LAKE CITY, 32024
b) Name and address of fee simple titleholder (if other than owner)
c) Interest in property: owner
4. Contractor Information:
a) Name and address: Renewal By Andersen 997 W Kennedy Blvd
b) Telephone No.: 813 537 2143
c) Address: Atlantic Fl 32810
5. Surety Information (if applicable, a copy of the payment bond is attached):
a) Name and address:
b) Amount of Bond:
c) Telephone No.:
6. Lender:
a) Name and address:
b) Phone No.:
7. Person within the State of Florida designated by Owner upon whom notices or other documents may be served as provided by Section 713.13(1)(a)7., Florida Statutes:
a) Name and address:
b) Telephone No.:
8. In addition to himself or herself, Owner designates the following person to receive a copy of the Lienor's Notice as provided in Section 713.13(1)(b), Florida Statutes:
a) Name: OF
b) Telephone No.:
9. Expiration date of Notice of Commencement (the expiration date will be 1 year from the date of recording unless a different date is specified):

WARNING TO OWNER: ANY PAYMENTS MADE BY THE OWNER AFTER THE EXPIRATION OF THE NOTICE OF COMMENCEMENT ARE CONSIDERED IMPROPER PAYMENTS UNDER CHAPTER 713, PART I, SECTION 713.13, FLORIDA STATUTES, AND CAN RESULT IN YOUR PAYING TWICE FOR IMPROVEMENTS TO YOUR PROPERTY; A NOTICE OF COMMENCEMENT MUST BE RECORDED AND POSTED ON THE JOB SITE BEFORE THE FIRST INSPECTION. IF YOU INTEND TO OBTAIN FINANCING, CONSULT YOUR LENDER OR AN ATTORNEY BEFORE COMMENCING WORK OR RECORDING YOUR NOTICE OF COMMENCEMENT.

STATE OF FLORIDA
COUNTY OF COLUMBIA

10. [Signature]
Signature of Owner or Lessee, or Owner's or Lessee's Authorized Officer/Director/Partner/Manager
Kay Summerlin
Printed Name and Signatory's Title/Office

The foregoing instrument was acknowledged before me, a Florida Notary, this 1 day of June, 2021 by:

Kay Summerlin as owner for
(Name of Person) (Type of Authority) (name of party on behalf of whom instrument was executed)

Personally Known OR Produced Identification OR Type OR Produced Identification

Notary Signature

Notary Stamp or Seal:



Jestine Whitaker
NOTARY PUBLIC
STATE OF FLORIDA
Comm# GG967194
Expires 3/9/2024



Order Summary

dba: RENEWAL BY ANDERSEN OF FLORIDA

Legal Name: JLM Windows, LLC | License # CGC1527613
997 West Kennedy Blvd. Ste A-18 | Orlando, FL 32810
Phone: 407-803-4723 | Fax: 407-386-8262 | concierge@rbafla.com
Measure Tech: Chris Sundstrom,

KAY SUMMERLIN & LAYNE SCHULTETUS

1199 Sw Troy St
Lake City, FL 32025
H: (386)466-4940 | C:

FLOORPLAN - 1ST FLOOR

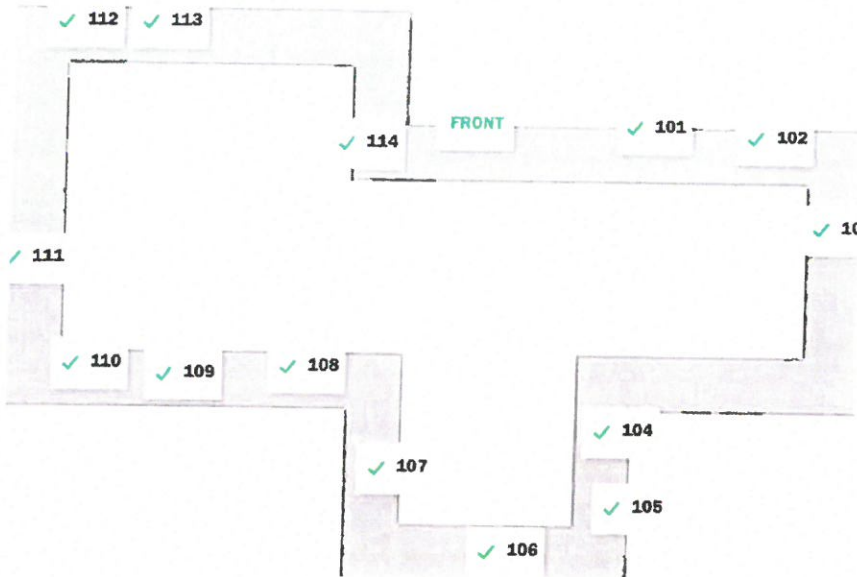

UNIT NOTES

- 101 Blinds are easy to remove
- 102 Blinds easy to remove
- 103 Blinds easy to remove, exterior is j channel
- 104 1 hour added to remove and put back up blinds
- 108 Exterior is j channel
- 109 Exterior is j channel
- 110 Drywall varies, exterior is j channel
- 111 Drywall varies
- 112 Drywall lose and chipped around corner bead and varies in size, flat stock if needed
- 113 Drywall lose and chipped around corner bead and varies in size, flat stock if needed

JOB PHOTOS



Order Summary

dba: RENEWAL BY ANDERSEN OF FLORIDA

Legal Name: JLM Windows, LLC | License # CGC1527613
 997 West Kennedy Blvd. Ste A-18 | Orlando, FL 32810
 Phone: 407-803-4723 | Fax: 407-386-8262 | concierge@rbafila.com
 Measure Tech: Chris Sundstrom,

KAY SUMMERLIN & LAYNE SCHULTETUS

1199 Sw Troy St
 Lake City, FL 32025
 H: (386)466-4940 | C:

ID#	ROOM	SIZE		DETAILS
JOB				
101	Room 1	31" 30-3/16"	58" 58-7/16"	Window: Double-Hung (DG), 1:1, Flat Sill, Base Frame, Modern Checkrail, Exterior Canvas, Interior Canvas Glass: All Sash: High Performance SmartSun Glass, No Pattern Hardware: Canvas Screen: Fiberglass, Full Screen Grille Style: No Grille Misc: None Construction: None Material: 2.25" x 5/8" L-Trim, (12 ft), Canvas (2)
102	Room 1	31" 30-1/4"	58" 58-7/16"	Window: Double-Hung (DG), 1:1, Flat Sill, Base Frame, Modern Checkrail, Exterior Canvas, Interior Canvas Glass: All Sash: High Performance SmartSun Glass, No Pattern Hardware: Canvas Screen: Fiberglass, Full Screen Grille Style: No Grille Misc: None Construction: None Material: 2.25" x 5/8" L-Trim, (12 ft), Canvas (2)
103	R2	31" 30-1/8"	58" 58-7/16"	Window: Double-Hung (DG), 1:1, Flat Sill, Base Frame, Modern Checkrail, Exterior Canvas, Interior Canvas Glass: All Sash: High Performance SmartSun Glass, No Pattern Hardware: Canvas Screen: Fiberglass, Full Screen Grille Style: No Grille Misc: None Construction: None Material: 2.25" x 5/8" L-Trim, (12 ft), Canvas (2)
104	Sun	61" 61-1/8"	58" 58-5/16"	Window: Gliding, Double, 1:1, Active / Passive, Base Frame, Exterior Canvas, Interior Canvas Glass: All Sash: High Performance SmartSun Glass, No Pattern Hardware: Canvas Screen: Fiberglass, Full Screen Grille Style: No Grille Misc: None Construction: Additional hours for unplanned work * (1) Material: F-Trim, (12 ft), Canvas (2), Glider Clips (8)
105	Sun	61" 61-1/16"	58" 58-7/16"	Window: Gliding, Double, 1:1, Active / Passive, Base Frame, Exterior Canvas, Interior Canvas Glass: All Sash: High Performance SmartSun Glass, No Pattern Hardware: Canvas Screen: Fiberglass, Full Screen Grille Style: No Grille Misc: None Construction: Additional hours for unplanned work * (1) Material: F-Trim, (12 ft), Canvas (2), Glider Clips (8)



Order Summary

dba: RENEWAL BY ANDERSEN OF FLORIDA

Legal Name: JLM Windows, LLC | License # CGC1527613
 997 West Kennedy Blvd. Ste A-18 | Orlando, FL 32810
 Phone: 407-803-4723 | Fax: 407-386-8262 | concierge@rbafila.com
 Measure Tech: Chris Sundstrom,

KAY SUMMERLIN & LAYNE SCHULTETUS

1199 Sw Troy St
 Lake City, FL 32025
 H: (386)466-4940 | C:

ID#	ROOM	SIZE		DETAILS
106	Sun	93"	58"	Window: Gliding, Triple, 1:2:1, Base Frame, Exterior Canvas, Interior Canvas Glass: Sash 1: High Performance SmartSun Glass, No Pattern, Tempered Glass, Sash 2: High Performance SmartSun Glass, No Pattern, Sash 3: High Performance SmartSun Glass, No Pattern Hardware: Canvas, Standard Color Extra Lock Screen: Fiberglass, Full Screen Grille Style: No Grille Misc: None Construction: Additional hours for unplanned work * (1) Material: F-Trim, (12 ft), Canvas (3), Glider Clips (8)
107	Sun	61"	58"	Window: Gliding, Double, 1:1, Active / Passive, Base Frame, Exterior Canvas, Interior Canvas Glass: All Sash: High Performance SmartSun Glass, No Pattern Hardware: Canvas Screen: Fiberglass, Full Screen Grille Style: No Grille Misc: None Construction: Additional hours for unplanned work * (1) Material: F-Trim, (12 ft), Canvas (2), Glider Clips (8)
108	nook	61"	58"	Window: Gliding, Double, 1:1, Active / Passive, Base Frame, Exterior Canvas, Interior Canvas Glass: All Sash: High Performance SmartSun Glass, No Pattern Hardware: Canvas Screen: Fiberglass, Full Screen Grille Style: No Grille Misc: None Construction: None Material: F-Trim, (12 ft), Canvas (2), Glider Clips (8)
109	master	31"	58"	Window: Double-Hung (DG), 1:1, Flat Sill, Base Frame, Modern Checkrail, Exterior Canvas, Interior Canvas Glass: All Sash: High Performance SmartSun Glass, No Pattern Hardware: Canvas Screen: Fiberglass, Full Screen Grille Style: No Grille Misc: None Construction: None Material: 2.25" x 5/8" L-Trim, (12 ft), Canvas (2)
110	master	31"	58"	Window: Double-Hung (DG), 1:1, Flat Sill, Base Frame, Modern Checkrail, Exterior Canvas, Interior Canvas Glass: All Sash: High Performance SmartSun Glass, No Pattern Hardware: Canvas Screen: Fiberglass, Full Screen Grille Style: No Grille Misc: None Construction: None Material: 2.25" x 5/8" L-Trim, (12 ft), Canvas (2)



Order Summary

dba: RENEWAL BY ANDERSEN OF FLORIDA

Legal Name: JLM Windows, LLC | License # CGC1527613
997 West Kennedy Blvd. Ste A-18 | Orlando, FL 32810
Phone: 407-803-4723 | Fax: 407-386-8262 | concierge@rbafila.com
Measure Tech: Chris Sundstrom,

KAY SUMMERLIN & LAYNE SCHULTETUS

1199 Sw Troy St
Lake City, FL 32025
H: (386)466-4940 | C:

ID#	ROOM	SIZE		DETAILS
111	m bath	23"	35"	Window: Double-Hung (DG), 1:1, Flat Sill, Base Frame, Modern Checkrail, Exterior Canvas, Interior Canvas Glass: All Sash: High Performance SmartSun Glass, No Pattern Hardware: Canvas Screen: Fiberglass, Full Screen Grille Style: No Grille Misc: None Construction: None Material: 2.25" x 5/8" L-Trim, (12 ft), Canvas (1)
112	gar	31"	58"	Window: Double-Hung (DG), 1:1, Flat Sill, Base Frame, Modern Checkrail, Exterior Canvas, Interior Canvas Glass: All Sash: High Performance SmartSun Glass, No Pattern Hardware: Canvas Screen: Fiberglass, Full Screen Grille Style: No Grille Misc: None Construction: None Material: 2.25" x 5/8" L-Trim, (12 ft), Canvas (2)
113	gar	31"	58"	Window: Double-Hung (DG), 1:1, Flat Sill, Base Frame, Modern Checkrail, Exterior Canvas, Interior Canvas Glass: All Sash: High Performance SmartSun Glass, No Pattern Hardware: Canvas Screen: Fiberglass, Full Screen Grille Style: No Grille Misc: None Construction: None Material: 2.25" x 5/8" L-Trim, (12 ft), Canvas (2)
114	form din	23"	58"	Window: Double-Hung (DG), 1:1, Flat Sill, Base Frame, Modern Checkrail, Exterior Canvas, Interior Canvas Glass: All Sash: High Performance SmartSun Glass, No Pattern Hardware: Canvas Screen: Fiberglass, Full Screen Grille Style: No Grille Misc: None Construction: None Material: 2.25" x 5/8" L-Trim, (12 ft), Canvas (2)

PRODUCTS: 14 WINDOWS: 14 PATIO DOORS: 0 SPECIALTY: 0 MISC: 0

Updated 6/1/21