



STATE OF FLORIDA  
DEPARTMENT OF HEALTH  
ONSITE SEWAGE TREATMENT AND DISPOSAL  
SYSTEM  
APPLICATION FOR CONSTRUCTION PERMIT

22-0072  
PERMIT NO. \_\_\_\_\_  
DATE PAID: 1-26-22  
FEE PAID: 310.00  
RECEIPT #: API 788 945

APPLICATION FOR:

☒ New System ☐ Existing System ☐ Holding Tank ☐ Innovative  
☐ Repair ☐ Abandonment ☐ Temporary ☐ \_\_\_\_\_

APPLICANT: Terry Williams (845) 505-8065

AGENT: Raymond Howard Septic

TELEPHONE: 590-4884

MAILING ADDRESS: 22694 CR 49 O'Brien

TO BE COMPLETED BY APPLICANT OR APPLICANT'S AUTHORIZED AGENT. SYSTEMS MUST BE CONSTRUCTED BY A PERSON LICENSED PURSUANT TO 489.105(3)(m) OR 489.552, FLORIDA STATUTES. IT IS THE APPLICANT'S RESPONSIBILITY TO PROVIDE DOCUMENTATION OF THE DATE THE LOT WAS CREATED OR PLATTED (MM/DD/YY) IF REQUESTING CONSIDERATION OF STATUTORY GRANDFATHER PROVISIONS.

PROPERTY INFORMATION

LOT: \_\_\_\_\_ BLOCK: \_\_\_\_\_ SUBDIVISION: \_\_\_\_\_ PLATTED: \_\_\_\_\_

PROPERTY ID #: 03-75-17-09879-003 ZONING: \_\_\_\_\_ I/M OR EQUIVALENT: [ Y / N ]

PROPERTY SIZE: 5 ACRES WATER SUPPLY: ☒ PRIVATE PUBLIC ☐  $\leq 2000$  GPD ☐  $> 2000$  GPD

IS SEWER AVAILABLE AS PER 381.0065, FS? [ Y / N ] DISTANCE TO SEWER: \_\_\_\_\_ FT

PROPERTY ADDRESS: 192 SE Old Bellamy Road High Springs

DIRECTIONS TO PROPERTY: \_\_\_\_\_

BUILDING INFORMATION

☒ RESIDENTIAL ☐ COMMERCIAL

Unit No	Type of Establishment	No. of Bedrooms	Building Area Sqft	Commercial/Institutional System Design Table 1, Chapter 64E-6, FAC
---------	-----------------------	-----------------	--------------------	--

1	<u>MH</u>	<u>3</u>	<u>1680</u>	<u>56x30</u>
2				
3				
4				

☐ Floor/Equipment Drains ☐ Other (Specify) \_\_\_\_\_

SIGNATURE: Barry H. H.

DATE: 1/22/2022

1900

1901

1902

1903

1904

1905

1906

1907

1908

1909

1910

1911

1912

1913

1914

1915

1916

1917

1918

1919

1920

1921

1922

1923

1924

1925

1926

1927

1928

1929

STATE OF FLORIDA  
DEPARTMENT OF HEALTH  
APPLICATION FOR CONSTRUCTION PERMIT

Permit Application Number

22.0072

PART II - SITEPLAN

Scale: Each block represents 10 feet and 1 inch = 40 feet.

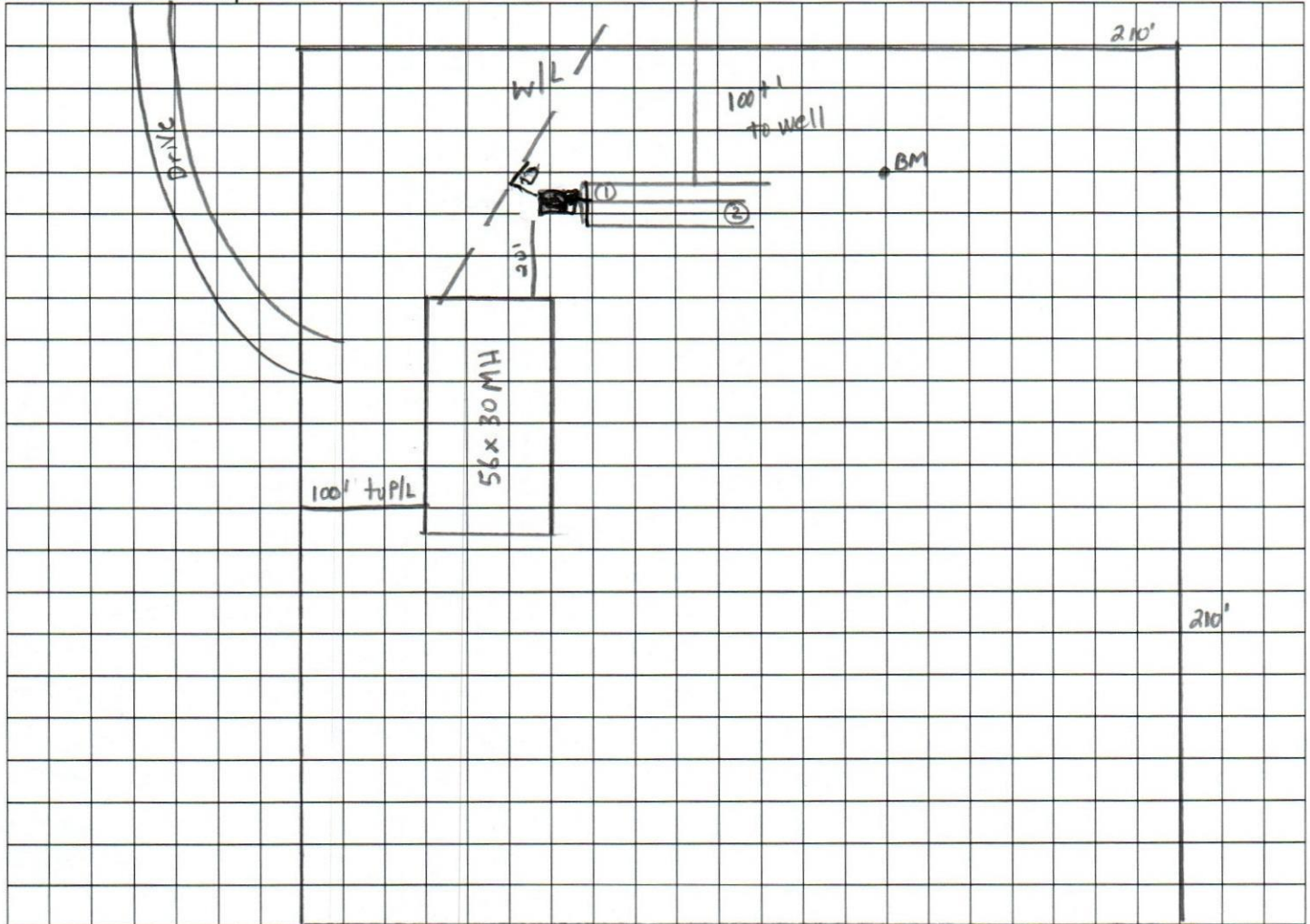

Notes:

not actual property lines

1 acre of 5

Site Plan submitted by:

Randy HLO

1/24/2022

Plan Approved

Not Approved

Date 1/28/22

By

[Signature]

ES2 Columbia

County Health Department

ALL CHANGES MUST BE APPROVED BY THE COUNTY HEALTH DEPARTMENT

