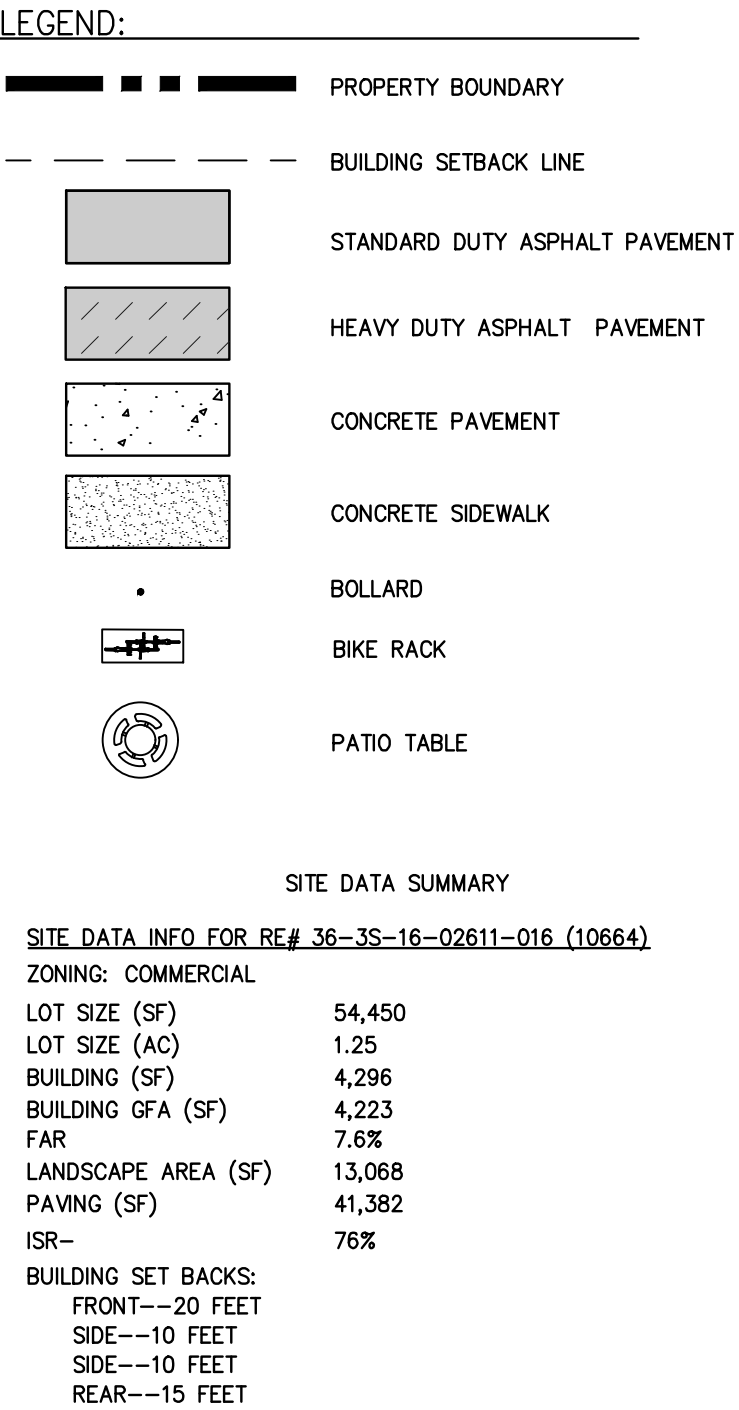
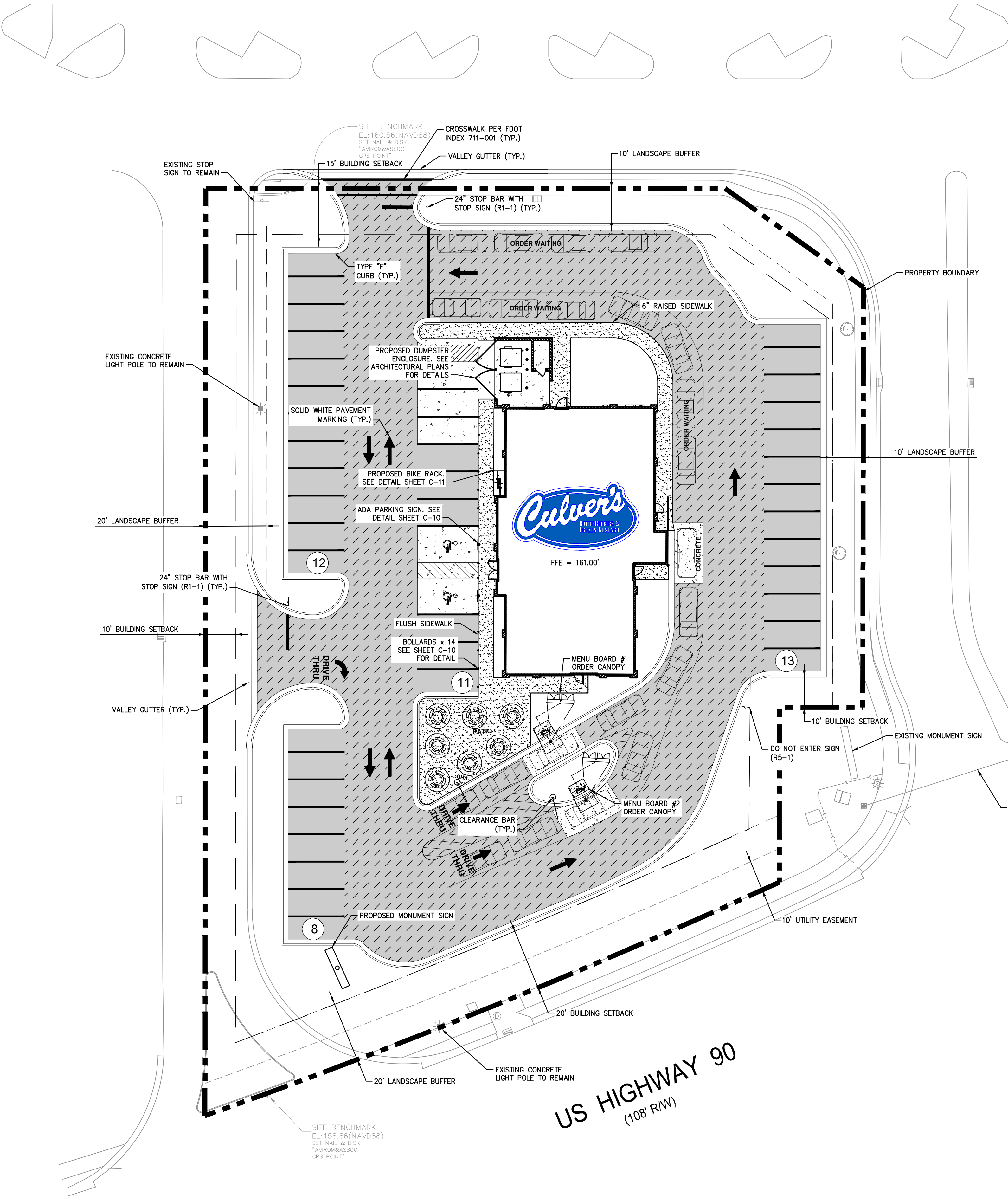

[illegible]

PARKING CALCULATIONS – REQUIRED

SIT DOWN/WALK IN RESTAURANT:
BUILDING FOOTPRINT: 1 SPACE PER 3 SEATS
86 PUBLIC ROOM SEATS
 $86 / 3 = 29$ PARKING SPACES REQUIRED

STANDARD PARKING SPOTS = 42 SPACES
HANDICAP PARKING STALLS = 2 SPACES
TOTAL = 44 SPACES

GENERAL NOTES:

1. ALL ELEMENTS THAT ARE PLACES OF PUBLIC ACCOMMODATIONS AND COMMERCIAL FACILITIES ON THE SITE (INCLUDING ACCESSIBLE ROUTES AND PARKING) SHALL MEET THE REQUIREMENTS OF "FLORIDA AMERICANS WITH DISABILITIES ACCESSIBILITY IMPLEMENTATION ACT", THE CURRENT ADA STANDARDS FOR ACCESSIBLE DESIGN, FLORIDA ACCESSIBILITY CODE FOR BUILDING CONSTRUCTION AND THE FAIR HOUSING ACT, WHEN APPLICABLE.
2. ALL ASPHALT REMOVAL SHALL HAVE SAW-CUT EDGES.
3. ALL TRAFFIC CONTROL SIGNAGE, CONES AND PROTECTIVE BARRIERS SHALL BE PROVIDED BY AND INSTALLED BY THE CONTRACTOR.
4. NO EXISTING WELLS LOCATED ON-SITE

THE PRESENCE OF GROUNDWATER SHOULD BE ANTICIPATED ON THIS PROJECT. CONTRACTOR'S BID SHALL INCLUDE CONSIDERATION FOR ADDRESSING THIS ISSUE.

Always call 811 two full business days before you dig to have underground utilities located and marked.

Sunshine811.com

Kimley»»Horn
© 2022 KIMLEY-HORN AND ASSOCIATES, INC.
12740 GRAN BAY PARKWAY WEST, SUITE 2350
JACKSONVILLE, FLORIDA 32256
PHONE: 904-828-3900
WWW.KIMLEY-HORN.COM REGISTRY No. 35106

OVERALL SITE PLAN

SHEET NUMBER
C-06