

PROPOSED
DRIVEWAY

Parcel 25-35-15-00213-004

S.88°19'59"W. 210.00'(F)

N
↑

1/4" = 15'

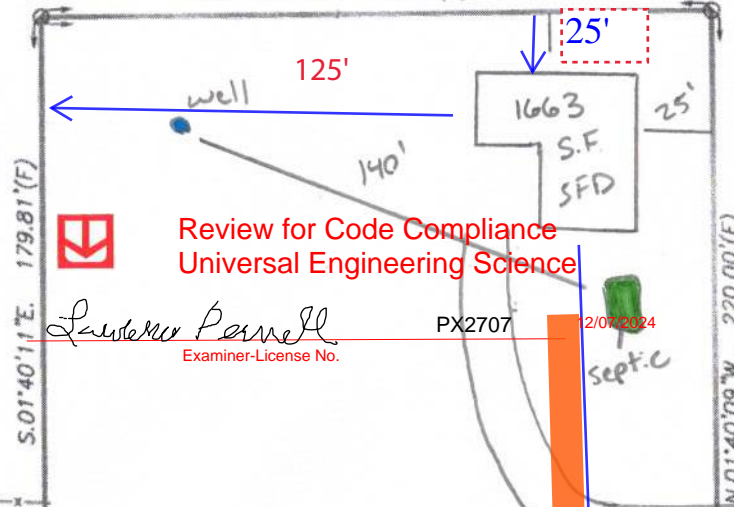

OTHER LANDS OF
DEWEY AND MARY JANE WEAVER
TAX PARCEL NO.
25-35-15-00213-001
ORB 1405, PAGE 1007
NOT A PART

FAMILY PATH

4" CM. S.88°31'52"W. 444.56'(F)
NW CORNER OF
LANDS DESCRIBED
IN ORB 942,
PAGE 809.

NE CORNER OF
LANDS DESCRIBED
IN ORB 942,
PAGE 809.

S.01°01'44"E
40.00'(F)

SW MAYO ROAD
N.88°19'56"E. 154.70'(F)
(PUBLIC R/W, GRADED ROAD BED)

SW MAYO ROAD
(PUBLIC R/W, THIS PORTION PAVED)

N.88°43'11"

4" CM.