

ck 41440

PERMIT APPLICATION / MANUFACTURED HOME INSTALLATION APPLICATION

**For Office Use Only** (Revised 7-1-15) Zoning Official LN Building Official JMS

AP# 1808-86 Date Received 8/28/18 By UH Permit # 37209

Flood Zone X Development Permit \_\_\_\_\_ Zoning A-3 Land Use Plan Map Category A

Comments \_\_\_\_\_

---

FEMA Map# \_\_\_\_\_ Elevation \_\_\_\_\_ Finished Floor 1' above road River \_\_\_\_\_ In Floodway \_\_\_\_\_

☒ Recorded Deed or ☐ Property Appraiser PO ☒ Site Plan ☐ EH # 18-0575 ☒ Well letter OR

☐ Existing well ☐ Land Owner Affidavit ☒ Installer Authorization ☐ FW Comp. letter ☒ App Fee Paid

☐ DOT Approval ☐ Parent Parcel # \_\_\_\_\_ ☐ STUP-MH \_\_\_\_\_ ☒ 911 App

☐ Ellisville Water Sys ☒ Assessment owned ☐ Out County ☐ In County ☒ Sub VF Form

- Property ID # 00-00-00-01417-000 Subdivision THREE RIVERS ESTATES Lot# 57 unit?
- New Mobile Home ☒ Used Mobile Home \_\_\_\_\_ MH Size 28x68 Year 2018
  - Applicant PAUL BARNEY Phone # 386-209-0906
  - Address 466 SW DEP J. DAVIS LN, LAKE CITY, FL 32024
  - Name of Property Owner JOSEPH <sup>frances</sup> GIARDINA Phone# 352-219-4737
  - 911 Address 238 SW Richmond Way, Fort White, FL 32038
  - Circle the correct power company - FL Power & Light - Clay Electric  
(Circle One) - Suwannee Valley Electric - Duke Energy
  - Name of Owner of Mobile Home JOSEPH GIARDINA Phone # 352-219-4737  
Address 534 SW BOBBAT LN, FT. WHITE, FL 32038
  - Relationship to Property Owner SELF
  - Current Number of Dwellings on Property 0
  - Lot Size 100' X 400' Total Acreage 0.918
  - Do you : Have Existing Drive or Private Drive or need Culvert Permit or Culvert Waiver (Circle one)  
(Currently using) (Blue Road Sign) (Putting in a Culvert) (not need a Culvert)
  - Is this Mobile Home Replacing an Existing Mobile Home NO
  - Driving Directions to the Property SR 47 TO FT WHITE (US-27) T/R TO UTAH T/L THEN RIGHT FOLLOW SW UTAH TO SW ONTARIO TERR T/L TO SW DRAKE PL T/R TO SW RICHMONT WAY - HARD LEFT TO SITE ON RIGHT - LOT 57 T/L LK
  - Name of Licensed Dealer/Installer PAUL E ALBRIGHT Phone # 386-365-5314
  - Installers Address 199 SW THOMAS TERR, LAKE CITY, FL 32024
  - License Number 1H 1025039 Installation Decal # 51750

UH-spoke to Paul 9-12-18

\$409.41

# PERMIT NUMBER

## PERMIT WORKSHEET

Installer Paul E. McBRIDE License # 1H1005238  
 Installer Mobile Phone # 386-365-8549  
 Address of home being installed 780 SW Richmond Way, Fort White, FL 32038  
 Manufacturer Little Oak Length x width 28 x 68/72

NOTE: If home is a single wide fill out one half of the blocking plan if home is a triple or quad wide sketch in remainder of home

I understand Lateral Arm Systems cannot be used on any home (new or used) where the sidewall ties exceed 5 ft 4 in.

Installer's initials PM

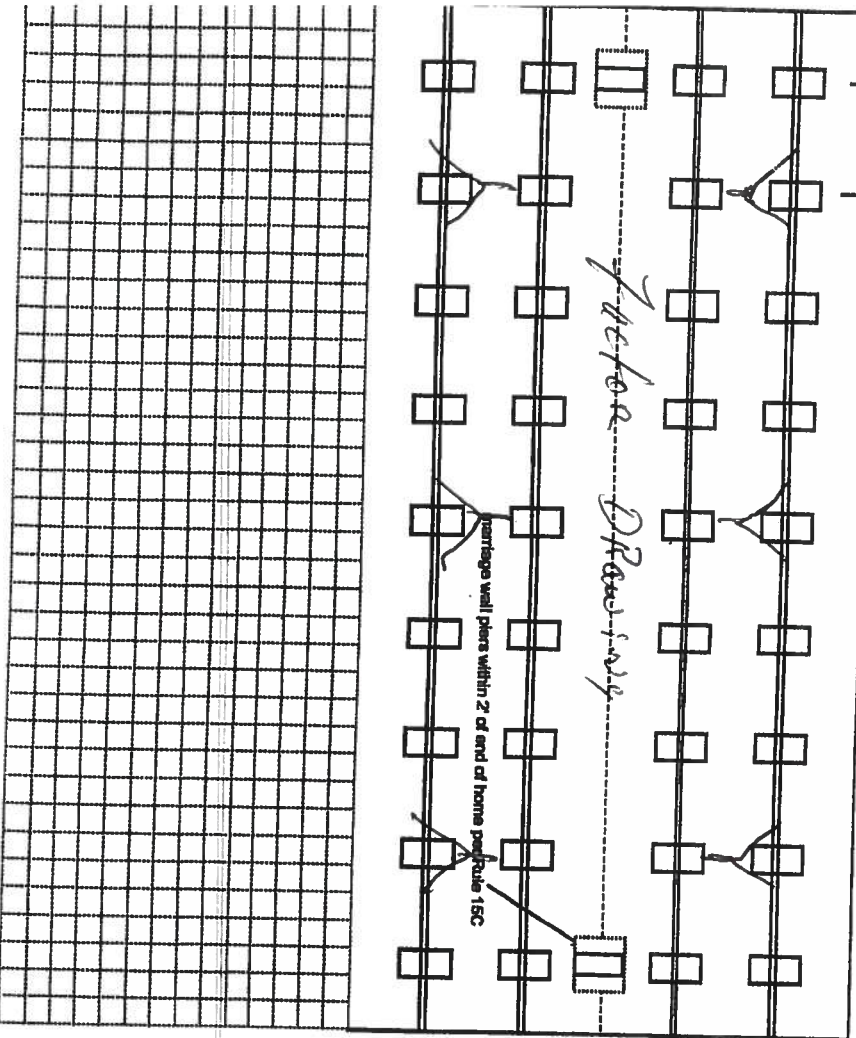

New Home ☒ Used Home ☐

Home installed to the Manufacturer's Installation Manual ☒  
 Home is installed in accordance with Rule 15-C ☒

Single wide ☐ Wind Zone II ☒ Wind Zone III ☐  
 Double wide ☒ Installation Decal # 51750

Triple/Quad ☐ Serial # LOH6A 21732392 A/B

Roof System: Typical ☐ Hinged ☐

PIER SPACING TABLE FOR USED HOMES

Load bearing capacity (sq in)	16' x 16" (256)	18 1/2" x 18 1/2" (342)	20' x 20" (400)	22' x 22" (484)	24' x 24" (576)	26' x 26" (676)
1000 dsf	3'	4'	5'	6'	7'	8'
1500 dsf	4' 6"	6'	7'	8'	8'	8'
2000 dsf	6'	8'	8'	8'	8'	8'
2500 dsf	7' 6"	8'	8'	8'	8'	8'
3000 dsf	8'	8'	8'	8'	8'	8'
3500 dsf	8'	8'	8'	8'	8'	8'

\* Interpolated from Rule 15C-1 pier spacing table.

PIER PAD SIZES

I-beam pier pad size 17x22 (4' 10")  
 Perimeter pier pad size 16x14  
 Other pier pad sizes (required by the mfg.) 17x25

Draw the approximate locations of marriage wall openings 4 foot or greater. Use this symbol to show the piers.

List all marriage wall openings greater than 4 foot and their pier pad sizes below.

Opening	Pier pad size
<u>14</u>	<u>23x32</u>
<u>4</u>	<u>17x25</u>
<u>4</u>	<u>17x25</u>

ANCHORS

4 ft Center  
 5 ft Center

FRAME TIES

OTHER TIES

TIEDOWN COMPONENTS

Longitudinal Stabilizing Device (LSD) Drive  
 Manufacturer Drive  
 Longitudinal Stabilizing Device w/ Lateral Arms Drive  
 Manufacturer Drive

Side wall 16  
 Longitudinal Marriage wall 16  
 Shear wall 3

Number 16

within 2' of end of home spaced at 5' 4" oc 16ft

POCKET PENETROMETER TEST

The pocket penetrometer tests are rounded down to \_\_\_\_\_ psf or check here to declare 1000 lb. soil without testing.

X 1500

X 1500

X 1500

POCKET PENETROMETER TESTING METHOD

1. Test the perimeter of the home at 6 locations.
2. Take the reading at the depth of the footer.
3. Using 500 lb. increments, take the lowest reading and round down to that increment.

X 1500

X 1500

X 1500

TORQUE PROBE TEST

The results of the torque probe test is 285 inch pounds or check here if you are declaring 5' anchors without testing \_\_\_\_\_. A test showing 275 inch pounds or less will require 5 foot anchors.

Note: A state approved lateral arm system is being used and 4 ft. anchors are allowed at the sidewall locations. I understand 5 ft anchors are required at all centerline the points where the torque test reading is 275 or less and where the mobile home manufacturer may requires anchors with 4000 lb holding capacity.

PCP Installer's initials

ALL TESTS MUST BE PERFORMED BY A LICENSED INSTALLER

Installer Name

Paul C. Murphy

Date Tested

Electrical

Connect electrical conductors between multi-wide units, but not to the main power source. This includes the bonding wire between multi-wide units. Pg. 284

Plumbing

Connect all sewer drains to an existing sewer tap or septic tank. Pg. 284

Connect all potable water supply piping to an existing water meter, water tap, or other dependent water supply systems. Pg. 284

Site Preparation

Debris and organic material removed \_\_\_\_\_ Swale \_\_\_\_\_ Pad \_\_\_\_\_ Other \_\_\_\_\_  
Water drainage: Natural

Fastening multi wide units

Floor: Type Fastener: lags Length: 6" Spacing: 24"  
Walls: Type Fastener: screws Length: 4" Spacing: 24"  
Roof: Type Fastener: lags Length: 6" Spacing: 24"  
For used homes a min. 30 gauge, 8" wide, galvanized metal strip will be centered over the peak of the roof and fastened with galv. roofing nails at 2" on center on both sides of the centerline.

Gasket (weatherproofing requirement)

I understand a properly installed gasket is a requirement of all new and used homes and that condensation, mold, mildew and buckled marriage walls are a result of a poorly installed or no gasket being installed. I understand a strip of tape will not serve as a gasket.

Installer's Initials

PCP

Type gasket Pg. Factor 1 was failed

Installed:

Between Floors Yes ✓  
Between Walls Yes ✓  
Bottom of ridgebeam Yes ✓

Weatherproofing

The bottomboard will be repaired and/or taped. Yes ✓ Pg. \_\_\_\_\_  
Siding on units is installed to manufacturer's specifications. Yes ✓  
Fireplace chimney installed so as not to allow intrusion of rain water. Yes ✓

Miscellaneous

Skirting to be installed. Yes \_\_\_\_\_ No \_\_\_\_\_  
Dryer vent installed outside of skirting. Yes \_\_\_\_\_ N/A ✓  
Range downflow vent installed outside of skirting. Yes \_\_\_\_\_ N/A ✓  
Drain lines supported at 4 foot intervals. Yes \_\_\_\_\_  
Electrical crossovers protected. Yes ✓  
Other: Beading missing

Installer verifies all information given with this permit worksheet is accurate and true based on the manufacturer's installation instructions and or Rule 15C-1 & 2

Installer Signature

Paul C. Murphy

Date



# SONIC

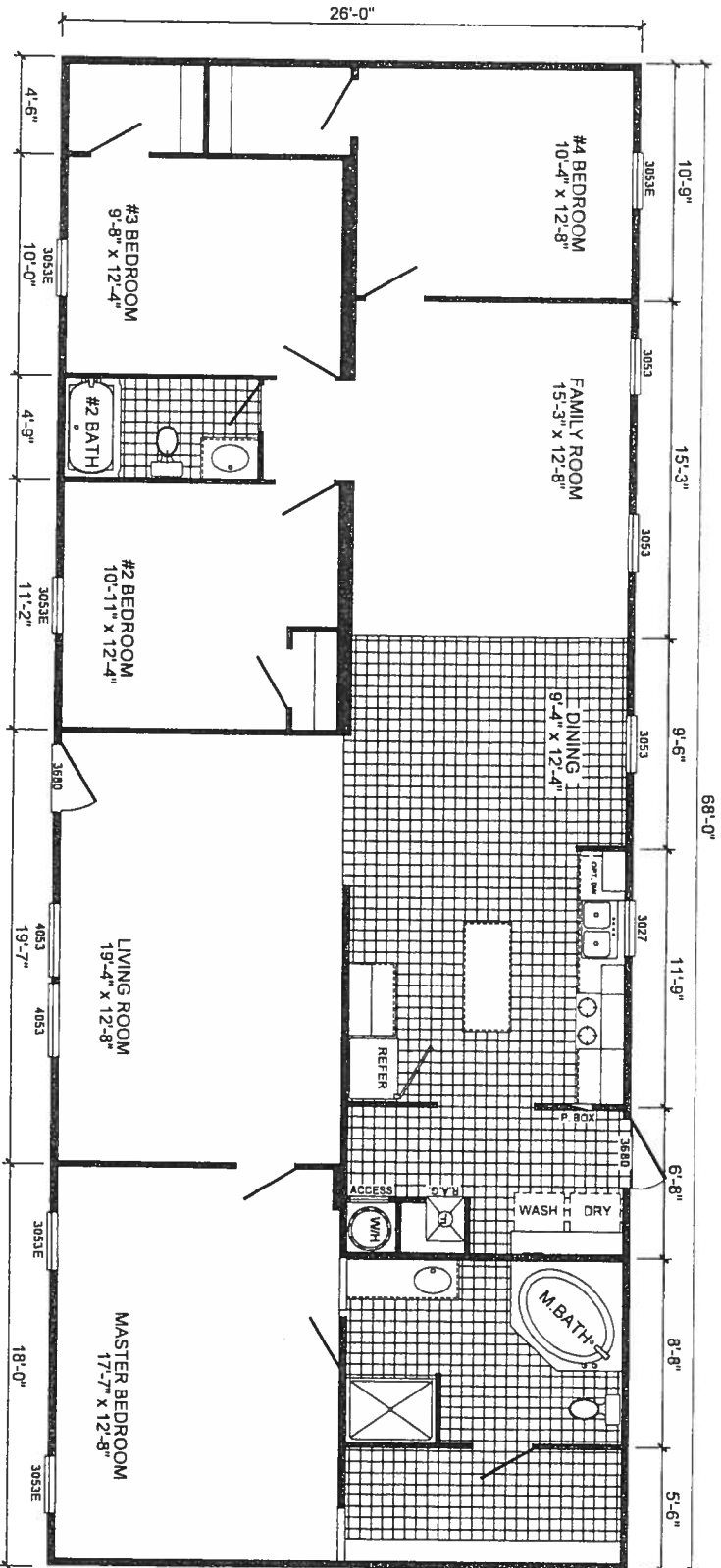
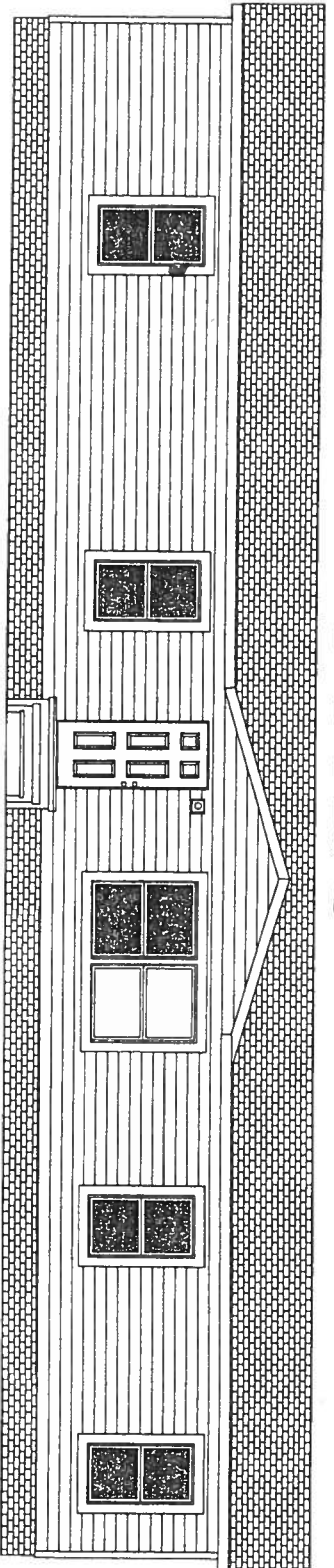

**L-2684B-RUNNER**  
**4-BEDROOM / 2-BATH**  
**28 x 72 - Approx. 1768 Sq. Ft.**

Date 11-11-2014  
 \* All room dimensions include closets and square footage figures are approximate.



**OLIVER TECHNOLOGIES, INC.**  
**FLORIDA INSTALLATION INSTRUCTIONS FOR THE**  
**MODEL 1101 "V" SERIES ALL STEEL FOUNDATION SYSTEM**  
**MODEL 1101"V" (STEPS 1-15)**  
**LONGITUDINAL ONLY: FOLLOW STEPS 1-9**  
**FOR ADDING LATERAL ARM : Follow Steps 10-15**  
**FOR CONCRETE APPLICATIONS: Follow Steps 16-19**

ENGINEERS STAMP

ENGINEERS STAMP

1. **SPECIAL CIRCUMSTANCES:** If the following conditions occur - **STOP! Contact Oliver Technologies at 1-800-284-7437 :**  
a) Pier height exceeds 48"    b) Length of home exceeds 76' c) Roof eaves exceed 16" d) Sidewall height exceed 96"  
e) Location is within 1500 feet of coast

**INSTALLATION OF GROUND PAN**

2. Remove weeds and debris in an approximate two foot square to expose firm soil for each ground pan (C) .  
3. Place ground pan (C) directly below chassis I-beam . Press or drive pan firmly into soil until flush with or below soil.  
**SPECIAL NOTE:** The longitudinal "V" brace system serves as a pier under the home and should be loaded as any other pier. It is recommended that after leveling piers, and one-third inch (1/3") before home is lowered completely on to piers, complete steps 4 through 9 below then remove jacks.

**INSTALLATION OF LONGITUDINAL "V" BRACE SYSTEM**

**NOTE: WHEN INSTALLING THE LONGITUDINAL SYSTEM ONLY, A MINIMUM OF 2 SYSTEMS PER FLOOR SECTION IS REQUIRED. SOIL TEST PROBE SHOULD BE USED TO DETERMINE CORRECT TYPE OF ANCHOR PER SOIL CLASSIFICATION. IF PROBE TEST READINGS ARE BETWEEN 175 & 275 A 5 FOOT ANCHOR MUST BE USED. IF PROBE TEST READINGS ARE BETWEEN 276 & 350 A 4 FOOT ANCHOR MAY BE USED. USE GROUND ANCHORS WITH DIAGONAL TIES AND STABILIZER PLATES EVERY 5'4" . VERTICAL TIES ARE ALSO REQUIRED ON HOMES SUPPLIED WITH VERTICAL TIE CONNECTION POINTS (PER FLORIDA REG.) .**

4. Select the correct square tube brace (E) length for set - up (pier) height at support location. (The 18" tube is always used as the bottom part of the longitudinal arm). Note: Either tube can be used by itself, cut and drilled to length as long as a 40 to 45 degree angle is maintained.

PIER HEIGHT  
(Approx. 45 degrees Max.)

1.25" ADJUSTABLE  
Tube Length

1.50" ADJUSTABLE  
Tube Length

7 3/4" to 25"	22"	18"
24 3/4" to 32 1/4"	32"	18"
33" to 41"	44"	18"
40" to 48"	54"	18"

5. Install (2) of the 1.50" square tubes (E {18" tube} ) into the "U" bracket (J), insert carriage bolt and leave nut loose for final adjustment.  
6. Place I-beam connector (F) loosely on the bottom flange of the I-beam.  
7. Slide the selected 1.25" tube (E) into a 1.50" tube (E) and attach to I-beam connectors (F) and fasten loosely with bolt and nut.  
8. Repeat steps 6 through 7 to create the "V" pattern of the square tubes loosely in place. The angle is not to exceed 45 degree and not below 40 degrees.  
9. After all bolts are tightened, secure 1.25" and 1.50" tubes using four(4) 1/4"-14 x 3/4" self-tapping screws in pre-drilled holes.

**INSTALLATION OF LATERAL TELESCOPING TRANSVERSE ARM SYSTEM**

**THE MODEL 1101 "V" (LONGITUDINAL & LATERAL PROTECTION) ELIMINATES THE NEED FOR MOST STABILIZER PLATES & FRAME TIES.**

**NOTE: THE USE OF THIS SYSTEM REQUIRES VERTICAL TIES SPACED AT 5'4".**

**FOUR FOOT (4') GROUND ANCHOR MAY BE USED EXCEPT WHERE THE HOME MANUFACTURER SPECIFIES DIFFERENT.**

10. Install remaining vertical tie-down straps and 4' ground anchors per home manufacturer's instructions. **NOTE:** Centerline anchors to be sized according to soil torque condition. Any manufacturer's specifications for sidewall anchor loads in excess of 4,000 lbs. require a 5' anchor per Florida Code.  
11. **NOTE:** Each system is required to have a frame tie and stabilizer attached at each lateral arm stabilizing location. This frame tie & stabilizer plate needs to be located within 18" from of center ground pan.  
12. Select the correct square tube brace (H) length for set-up lateral transverse at support location. The lengths come in either 60" or 72" lengths. (With the 1.50" tube as the bottom tube, and the 1.25" tube as the inserted tube.)  
13. Install the 1.50 transverse brace (H) to the ground pan connector (D) with bolt and nut.  
14. Slide 1.25" transverse brace into the 1.50" brace and attach to adjacent I-beam connector ( I ) with bolt and nut.  
15. Secure 1.50" transverse arm to 1.25" transverse arm using four (4) 1/4" - 14 x 3/4" self-tapping screws in pre-drilled holes.



**OLIVER TECHNOLOGIES, INC.**  
**1-800-284-7437**

Telephone 931-796-4555  
Fax 931-796-8811  
www.olivertechnologies.com

## INSTALLATION USING CONCRETE RUNNER / FOOTER

16. A concrete runner, footer or slab may be used in place of the steel ground pan.
- The concrete shall be minimum 2500 psi mix
  - A concrete runner may be either longitudinal or transverse, and must be a minimum of 8" deep with a minimum width of 16 inches longitudinally or 18 inches transverse to allow proper distance between the concrete bolt and the edge of the concrete (see below).
  - Footers must have minimum surface area of 441 sq. in. (i.e. 21" square), and must be a minimum of 8" deep.
  - If a full slab is used, the depth must be a 4" minimum at system bracket location, all other specifications must be per local jurisdiction. Special inspection of the system bracket installation is not required.. Footers must allow for at least 4" from the concrete bolt to the edge of the concrete.

**NOTE: The bottom of all footings, pads, slabs and runners must be per local jurisdiction.**

### LONGITUDINAL: (Model 1101 LC "V")

17. When using Part # 1101-W-CPCA (wetset), simply install the bracket in runner/footer **OR** When installing in cured concrete use Part # 101-D-CPCA (dryset). The 1101 (dryset) CA bracket is attached to the concrete using (2) 5/8"x3" concrete wedge bolts (Simpson part # S162300H 5/8" X 3" or Powers equivalent). Place the CA bracket in desired location. Mark bolt hole locations, then using a 5/8" diameter masonry bit, drill a hole to a minimum depth of 3". Make sure all dust and concrete is blown out of the holes. Place wedge bolts into drilled holes, then place 1101 (dry set) CA bracket onto wedge bolts and start wedge bolt nuts. Take a hammer and lightly drive the wedge bolts down by hitting the nut (making sure not to hit the top of threads on bolt). The sleeve of concrete wedge bolt needs to be at or below the top of concrete. Complete by tightening nuts.

### LATERAL: (Model 1101 TC "V")

18. For wet set (part # 1101-W-TACA) installation simply install the anchor bolt into runner/footer. For dry set installation (part # 1101-D-TACA) mark bolt hole locations, then using a 5/8" diam. masonry bit, drill a hole to a minimum depth of 3". Make sure all dust and concrete is blown out of the hole. Place wedge bolts (Simpson part #S162300H 5/8" X 3" or Powers equivalent) into (D) concrete dry transverse connector and into drilled hole. If needed, take a hammer and lightly drive the wedge bolts down by hitting the nut (making sure not to hit the top of threads on bolt), then remove the nut. The sleeve of concrete wedge bolt needs to be at or below the top of concrete.
19. When using part # 1101 CVW (wetset) or 1101 CVD (dryset), install per steps 17 & 18.

### Notes:

- LENGTH OF HOUSE IS THE ACTUAL BOX SIZE
- = STABILIZER PLATE AND FRAME TIE LOCATION (needs to be located within 18 inches of center of ground pan or concrete)
- ☐ = LOCATION OF LONGITUDINAL BRACING ONLY
- ☐ = TRANSVERSE & LONGITUDINAL LOCATIONS

## REQUIRED NUMBER AND LOCATION OF MODEL 1101 "V" OR 1101 C "V" BRACES FOR UP TO 4/12 ROOF PITCH

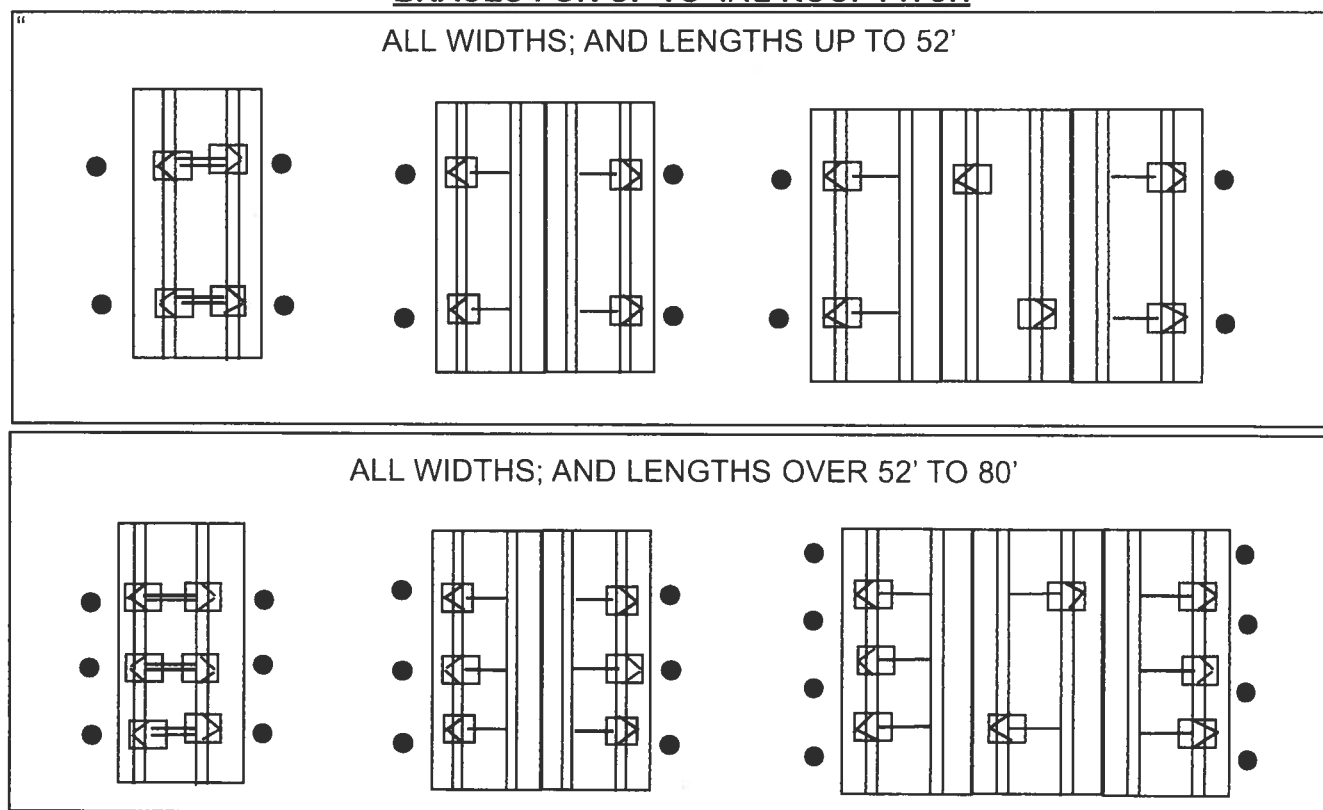

HOMES WITH 5/12 ROOF PITCH REQUIRE: PER FLORIDA REGULATIONS

6 systems for home lengths up to 52' and 8 systems for homes over 52' and up 80'. One stabilizer plate and frame tie required at each lateral bracing system.

Florida approved 4' ground anchors may be used in all locations except where home manufacturers specifications for sidewall straps are in excess of 4,000 lbs. These locations require a 5' anchor. Per Florida Code.

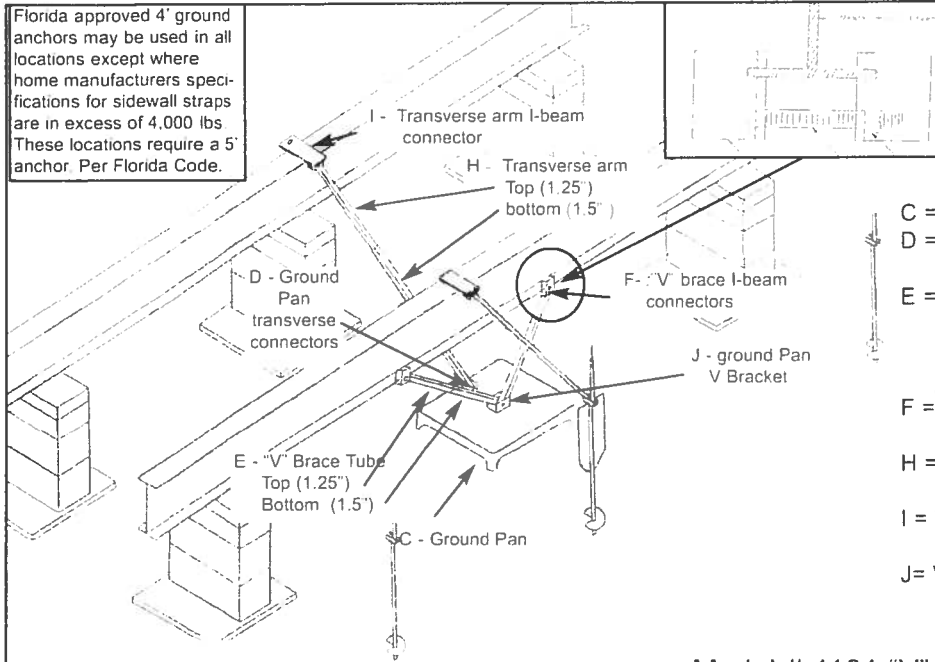

- C = GROUND PAN
- D = GROUND PAN CONNECTOR
- U BRACKETS TRANSVERSE
- E = TELESOPING V BRACE
- TUBE ASSEMBLY W/ 1.5 BOT-
- TOM TUBE AND 1.25 TUBE
- INSERT
- F = "V" BRACE I-BEAM CONNec-
- TORS ASSEMBLY
- H = TELESOPING TRANSVERSE
- ARM ASSEMBLY
- I = TRANSVERSE ARM I-BEAM
- CONNECTOR
- J = V PAN BRACKET

Model # 1101 "V"

Longitude dry  
concrete bracket  
part # 1101 D-CPCA

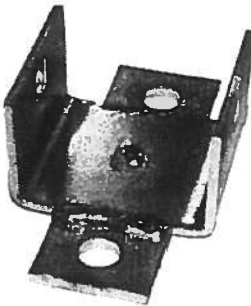

Wet bracket part #  
1101 W-CPCA not  
shown

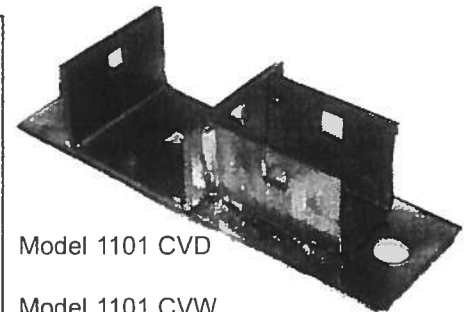
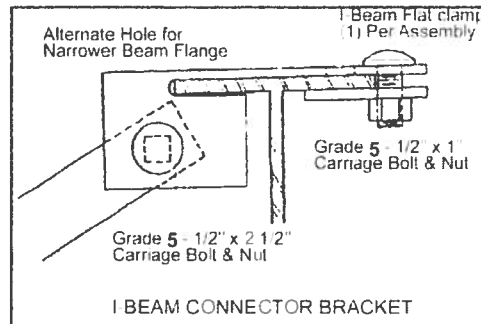

Model 1101 CVD

Model 1101 CVW  
not shown

Florida approved 4' ground  
anchors may be used in all  
locations except where home  
manufacturers specifications  
for sidewall straps are in  
excess of 4,000 lbs. These  
locations require a 5' anchor.  
Per Florida Code.

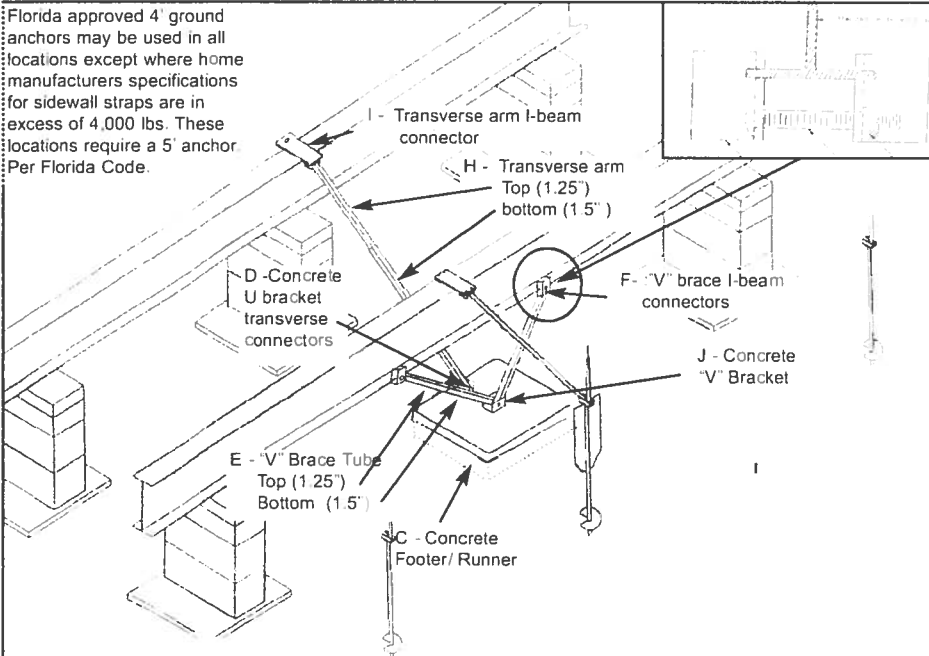

- C = CONCRETE FOOTER/RUNNER
- D = CONCRETE U BRACKET TRANSVERSE
- CONNECTOR (connects with grade 5 -1/2" x 2
- 1/2" carriage bolt & nut)
- E = TELESOPING V BRACE
- TUBE ASSEMBLY W/ 1.5 BOT-
- TOM TUBE AND 1.25 TUBE
- INSERT
- F = "V" BRACE I-BEAM CONNECTOR ASSEMBLY
- (connects with grade 5 - 1/2" x 4" carriage bolt & nut)
- H = TELESOPING TRANSVERSE ARM
- ASSEMBLY
- I = TRANSVERSE ARM I-BEAM CONNECTOR
- (connects with grade 5 -1/2" x 2 1/2" carriage bolt & nut)
- J = CONCRETE "V" BRACKET (connects with
- grade 5 - 1/2" x 4" carriage bolt & nut)

Model # 1101 C "V"



OLIVER TECHNOLOGIES, INC.  
1-800-284-7437

Telephone 931-796-4555  
Fax: 931-796-8811  
www.olivertechnologies.com



License Number: IH / 1025239 / 1 Name: PAUL E. ALBRIGHT

Order #: 3334	Label #: 51750	Manufacturer: <u>Live oak</u>	(Check Size of Home)
Homeowner: <u>Giardine</u>	Year Model: <u>2018</u>		Single _____
Address: <u>SW Richmond Way</u>	Length & Width: <u>28 X 68-72</u>		Double <input checked="" type="checkbox"/> _____
City/State/Zip: <u>Fort White</u>	Type Longitudinal System: <u>6</u>		Triple _____
Phone #:	Type Lateral Arm System: <u>6</u>		HUD Label #:
Date Installed:	New Home: <input checked="" type="checkbox"/> Used Home: _____		Soil Bearing / PSF: <u>1500</u>
Installed Wind Zone:	Data Plate Wind Zone:		Torque Probe / in-lbs: <u>285</u>
			Permit #:

Note:

STATE OF FLORIDA  
INSTALLATION CERTIFICATION LABEL

51750

LABEL #

DATE OF INSTALLATION

PAUL E. ALBRIGHT

NAME

IH / 1025239 / 1

3334

LICENSE #

ORDER #

CERTIFIES THAT THE INSTALLATION OF THIS MOBILE HOME IS  
IN ACCORDANCE WITH FLORIDA STATUTES 320.8249, 320.8325  
AND RULES OF THE HIGHWAY SAFETY AND MOTOR VEHICLES.

INSTRUCTIONS

PLEASE WRITE DATE OF  
INSTALLATION AND AFFIX  
LABEL NEXT TO HUD LABEL.  
USE PERMANENT INK PEN  
OR MARKER ONLY.  
COMPLETE INFORMATION  
ABOVE AND KEEP ON FILE  
FOR A MINIMUM OF 2 YEARS.  
YOU ARE REQUIRED TO  
PROVIDE COPIES WHEN  
REQUESTED.

District No. 1 - Ronald Williams  
District No. 2 - Rusty DePratter  
District No. 3 - Bucky Nash  
District No. 4 - Everett Phillips  
District No. 5 - Tim Murphy

**BOARD OF COUNTY COMMISSIONERS • COLUMBIA COUNTY**

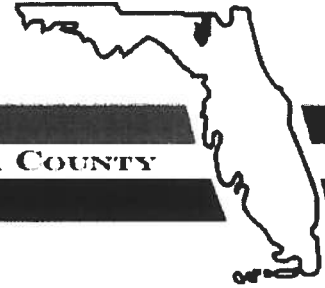

**Address Assignment and Maintenance Document**

To maintain the county wide Addressing Policy you must make application for a 9-1-1 Address at the time you apply for a building permit. The established standards for addressing and posting numbers to all principal buildings, dwellings, businesses and industries are contained in Columbia County Ordinance 2001-9. The addressing system is to enable Emergency Services Agencies to locate you in an emergency, and to assist the United States Postal Service and the public in the timely and efficient provision of services to residents and businesses of Columbia County

Date/Time Issued: **9/12/2018 2:51:03 PM**  
Address: **238 SW RICHMOND Way**  
City: **FORT WHITE**  
State: **FL**  
Zip Code **32038**

Parcel ID **01417-000**

REMARKS: Address for proposed structure on parcel.

**NOTICE: THIS ADDRESS WAS ISSUED BASED ON LOCATION AND ACCESS INFORMATION RECEIVED FROM THE REQUESTER. SHOULD, AT A LATER DATE, THE LOCATION AND/OR ACCESS INFORMATION BE FOUND TO BE IN ERROR OR CHANGED, THIS ADDRESS IS SUBJECT TO CHANGE.**

Address Issued By: **Signed:/ Matt Crews**

Columbia County GIS/911 Addressing Coordinator

**COLUMBIA COUNTY  
911 ADDRESSING / GIS DEPARTMENT**

263 NW Lake City Ave., Lake City, FL 32055 Telephone: (386) 758-1125  
Email: [gis@columbiacountyfla.com](mailto:gis@columbiacountyfla.com)

*John Price 9.5.2018*

This Instrument Prepared by & return to:  
Name: **TRISH LANG, an employee of**  
**Integrity Title Services, LLC**  
Address: **343 NW Cole Terrace, #101**  
**Lake City, FL 32855**  
**File No. 18-04040TL**

Inst: 201842017379 Date: 08/21/2018 Time: 11:24AM  
Page 1 of 2 B: 1367 P: 213, P.D.Witt Cason, Clerk of Court  
Columbia County, Fl: 60  
Deputy Clerk Due Stamp Deed: 66.50

Parcel I.D. #: **R01417-000**

SPACE ABOVE THIS LINE FOR PROCESSING DATA

SPACE ABOVE THIS LINE FOR RECORDING DATA

**THIS WARRANTY DEED** Made the 15th day of August, A.D. 2018, by **LESLIE W BAILEY, JR.**,  
**CONVEYING NON-HOMESTEAD PROPERTY**, hereinafter called the grantor, to **JOSEPH GIARDINA and**  
**FRANCES GIARDINA, HUSBAND AND WIFE**, whose post office address is **534 SW BOBCAT LANE, FORT**  
**WHITE, FL 32038**, hereinafter called the grantees:

Wherever used herein the terms "grantor" and "grantees" include all the parties to this instrument, singular and plural, the heirs, legal representatives and assigns of individuals, and the successors and assigns of corporations. It heresee the context so initials or requires.

**Witnesseth:** That the grantor, for and in consideration of the sum of \$10.00 and other valuable consideration, receipt whereof is hereby acknowledged, does hereby grant, bargain, sell, alien, remise, release, convey and confirm unto the grantees all that certain land situate in **COLUMBIA County, State of Florida**, viz:

**See Exhibit "A"**

**Together** with all the tenements, hereditaments and appurtenances thereto belonging or in anywise appertaining.

**To Have and to Hold** the same in fee simple forever.

And the grantor hereby covenants with said grantees that he is lawfully seized of said land in fee simple; that he has good right and lawful authority to sell and convey said land, and hereby fully warrants the title to said land and will defend the same against the lawful claims of all persons whomsoever, and that said land is free of all encumbrances, except taxes accruing subsequent to December 31, 2018.

In Witness Whereof, the said grantor has signed and sealed these presents, the day and year first above written.

Signed, sealed and delivered in the presence of:

*Ann M. Larkey*  
Witness Signature  
**ANN M. LARKEY**  
Printed Name

*Dania W. Strong*  
Witness Signature  
**Dania W. Strong**  
Printed Name

*Leslie W. Bailey, Jr.* L.S.  
**LESLIE W BAILEY, Jr.**  
Address:  
**4101 SKYLAND DRIVE, KINGSPORT, TN 37664**

STATE OF TENNESSEE  
COUNTY OF SULLIVAN

The foregoing instrument was acknowledged before me this 15th day of August, 2018, by **LESLIE W BAILEY, Jr.**, who is known to me or who has produced driver's license as identification



*Dania W. Strong*  
Notary Public  
My commission expires 2/28/2021

Exhibit "A"

Lot 57, THREE RIVERS ESTATES UNIT NO. 22, as per plat thereof recorded in Plat Book 6, Page 16, of the Public Records of Columbia County, Florida.

Being previously deeded described as follows:

Lot 239, Sec. 25, more particularly known as Lot 57 Unit 22 of 3 Rivers Estates, Inc., said Unit 22 better described as follows: Begin at the SE corner of the NW 1/4 of Sec. 25, Twp. 6S, Rge. 15E, Columbia County, Florida, & run S 25°27' E 72.24 ft.; thence N 28°01' W 5081.90 ft. to a point on the southwesterly R/W line of Fla. Power Corp.'s Ft. White to Silver Springs 230 KV Power line; thence S 53°24' E along said southwesterly R/W 2950.06 ft. to the north line of Sec. 25; thence S 88°35' W along said north line 82.82 ft. to the NE corner of the NW (1/4); thence S 1°33' E along the east line of said NW 1/4 a distance of 2661.77 ft. to the point of beginning, being a part of a subdivision of a part of the NW 1/4 of Sec. 25 & a part of the SW 1/4 of Sec. 24, Twp. 6S, Rge. 15E, Columbia County, Florida.

1	2	3	4	5	6	7	8	9	10	11	12	13	14	15	16	17	18	19	20	21	22	23	24	25	26	27	28	29	30	31	32	33	34	35	36	37	38	39	40
---	---	---	---	---	---	---	---	---	----	----	----	----	----	----	----	----	----	----	----	----	----	----	----	----	----	----	----	----	----	----	----	----	----	----	----	----	----	----	----

1
2
3
4
5
6
7
8
9
10
11
12
13
14
15
16
17
18
19
20
21
22
23
24
25
26
27
28
29
30
31
32
33
34
35
36
37
38
39
40
41
42
43
44
45
46
47
48
49
50
51
52
53
54
55
56
57
58
59

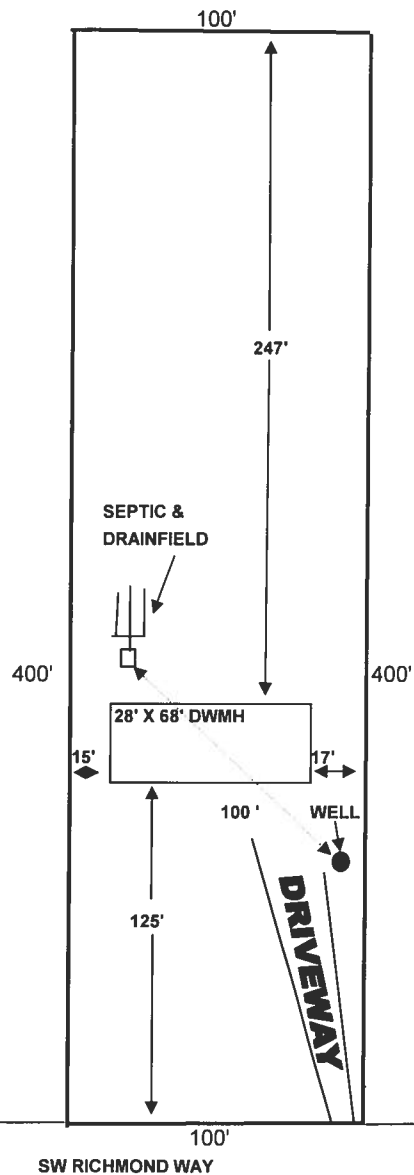

BUYER GIARDINA PARCEL ID# 00-00-00-01417-000 DATE DRAWN 28-Aug  
 ACREAGE 0.918 DEALER: FREEDOM HOMES 386-752-5355



COLUMBIA COUNTY BUILDING DEPARTMENT  
135 NE Hernando Ave, Suite B-21, Lake City, FL 32055  
Phone: 386-758-1008 Fax: 386-758-2160

# MOBILE HOME INSTALLERS AGENT AUTHORIZATION

I, PAUL E ALBRIGHT, give this authority and I do certify that the below  
Installers Name

referenced person(s) listed on this form is/are under my direct supervision and control and  
is/are authorized to purchase permits, call for inspections and sign on my behalf.

Printed Name of Authorized Person	Signature of Authorized Person	Agents Company Name
PAUL BARNEY	<i>Paul Barney</i>	FREEDOM HOMES
LINDA PENHALIGON	<i>Linda Penhaligon</i>	FREE DOM HOMES

I, the license holder, realize that I am responsible for all permits purchased, and all work done  
under my license and I am fully responsible for compliance with all Florida Statutes, Codes, and  
Local Ordinances.

I understand that the State Licensing Board has the power and authority to discipline a license  
holder for violations committed by him/her or by his/her authorized person(s) through this  
document and that I have full responsibility for compliance granted by issuance of such permits.

*Paul E Albright*  
License Holders Signature (Notarized)

TH1025239  
License Number

11-8-17  
Date

## NOTARY INFORMATION:

STATE OF: Florida COUNTY OF: SUWANNEE

The above license holder, whose name is PAUL E ALBRIGHT,  
personally appeared before me and is known by me or has produced identification  
(type of I.D.) \_\_\_\_\_ on this 8 day of NOVEMBER, 2017.

*Paul A Barney*  
NOTARY'S SIGNATURE

(Seal/Stamp)



PAUL A BARNEY  
MY COMMISSION # GG 040180  
EXPIRES: October 19, 2020  
Bonded Thru Budget Notary Services



## MOBILE HOME INSTALLATION SUBCONTRACTOR VERIFICATION FORM

APPLICATION NUMBER 1808-84 CONTRACTOR Paul Albright PHONE \_\_\_\_\_

THIS FORM MUST BE SUBMITTED PRIOR TO THE ISSUANCE OF A PERMIT

In Columbia County one permit will cover all trades doing work at the permitted site. It is **REQUIRED** that we have records of the subcontractors who actually did the trade specific work under the permit. Per Florida Statute 440 and Ordinance 89-6, a contractor shall require all subcontractors to provide evidence of workers' compensation or exemption, general liability insurance and a valid Certificate of Competency license in Columbia County.

Any changes, the permitted contractor is responsible for the corrected form being submitted to this office prior to the start of that subcontractor beginning any work. Violations will result in stop work orders and/or fines.

ELECTRICAL 1074	Print Name <u>WHITTINGTON ELECTRIC</u> License #: <u>EC13002957</u> Qualifier Form Attached <input type="checkbox"/>	Signature <u>[Signature]</u> Phone #: <u>386 972 1700</u>
MECHANICAL/ A/C <u>1669</u>	Print Name <u>STYLECREST</u> License #: <u>CAC1817658</u> Qualifier Form Attached <input type="checkbox"/>	Signature <u>[Signature]</u> Phone #: <u>850-769-1453</u>

Qualifier Forms cannot be submitted for any Specialty License.

Specialty License	License Number	Sub-Contractors Printed Name	Sub-Contractors Signature
MASON			
CONCRETE FINISHER			

F. S. 440.103 Building permits; identification of minimum premium policy.--Every employer shall, as a condition to applying for and receiving a building permit, show proof and certify to the permit issuer that it has secured compensation for its employees under this chapter as provided in ss. 440.10 and 440.38, and shall be presented each time the employer applies for a building permit.

Revised 10/30/2015

PAT LYNCH  
LYNCH DRILLING CORP  
P O Box 934  
Branford, FL 32008  
(386)935-1076

DATE 9-10-18

CUSTOMER Freedom Homes  
Joseph Giardina  
SW Richmond way  
Fl. white, FL 32038

LOCATION Parcel# 00-00-00-01417-000

WE WILL CONSTRUCT A 4" WATER WELL COMPLETE WITH 4" WATER WELL STEEL CASING, 1HP SUBMERSIBLE PUMP WITH 1 1/4" DROP PIPE, AND AN 85 GALLON CAPTIVE AIR TANK (21.9 GALLON DRAWDOWN).

WELL WILL BE COMPLETE AT THE WELL SITE, WE DO NOT INCLUDE ELECTRICAL NOR PLUMBING CONNECTIONS FROM THE WELL TO THE HOME AND/OR POWER POLE.

ANY VARIATIONS OF THE ABOVE ARE SUBJECT TO APPROVAL FROM THE CUSTOMER AND/OR CONTRACTOR PRIOR TO COMMENSMENT OF THE INDIVIDUAL JOB.

THANK YOU

NOT RESPONSIBLE FOR THE QUALITY OF WATER

New Columbia



STATE OF FLORIDA  
DEPARTMENT OF HEALTH  
ONSITE SEWAGE TREATMENT AND DISPOSAL  
SYSTEM  
APPLICATION FOR CONSTRUCTION PERMIT

PERMIT NO. 18-0575  
DATE PAID: 6/29/18  
FEE PAID: 315.50  
RECEIPT #: 1350467

APPLICATION FOR:

☒ New System    ☐ Existing System    ☐ Holding Tank    ☐ Innovative  
☐ Repair    ☐ Abandonment    ☐ Temporary    ☐

APPLICANT: LESLIE W BAILEY JR (BUYER JOSEPH GIARDINA)

AGENT: ROBERT W FORD JR DBA NORTH FLORIDA SEPTIC TANK, INC

TELEPHONE: 386-755-6372

MAILING ADDRESS: 741 SE STATE ROAD 100 LAKE CITY FL 32025

TO BE COMPLETED BY APPLICANT OR APPLICANT'S AUTHORIZED AGENT. SYSTEMS MUST BE CONSTRUCTED BY A PERSON LICENSED PURSUANT TO 489.105(3)(m) OR 489.552, FLORIDA STATUTES. IT IS THE APPLICANT'S RESPONSIBILITY TO PROVIDE DOCUMENTATION OF THE DATE THE LOT WAS CREATED OR PLATTED (MM/DD/YY) IF REQUESTING CONSIDERATION OF STATUTORY GRANDFATHER PROVISIONS.

PROPERTY INFORMATION

LOT: 57 BLOCK: NA SUBDIVISION: THREE RIVERS ESTATES UNIT 22 PLATTED: NA

PROPERTY ID #: 00-00-00-01417-000 ZONING: NA I/M OR EQUIVALENT: ☐ No ☐

PROPERTY SIZE: 0.918 ACRES WATER SUPPLY: ☒ PRIVATE PUBLIC ☐  $\leq 2000$  GPD ☐  $> 2000$  GPD

IS SEWER AVAILABLE AS PER 381.0065, FS? ☐ No ☐ Distance to sewer: NA FT

PROPERTY ADDRESS: RICHMOND WAY

DIRECTIONS TO PROPERTY: GO 47S TO FT. WHITE GO THROU LIGHT THEN TURN ON WILLISON SPRINGS RD.  
RIGHT GO TO NEWARK RIGHT GO DOWN TO MONTANA RIGHT THEN TO RICHMOND RIGHT PROPERTY ON RIGHT

BUILDING INFORMATION

☒ RESIDENTIAL ☐ COMMERCIAL

Unit No	Type of Establishment	No. of Bedrooms	Building Area Sqft	Commercial/Institutional System Design Table 1, Chapter 64E-6, FAC
1	M/H 28/72	4	1768	
2				
3				
4				

☐ Floor/Equipment Drains ☐ Other (Specify) \_\_\_\_\_

SIGNATURE: Robert W Ford Jr

DATE: 06-26-2018

DH 4015, 08/09 (Obsoletes previous editions which may not be used)  
Incorporated 64E-6.001, FAC

Page 1 of 4

STATE OF FLORIDA  
DEPARTMENT OF HEALTH  
APPLICATION FOR CONSTRUCTION PERMIT

Permit Application Number 18-0575

PART II - SITEPLAN

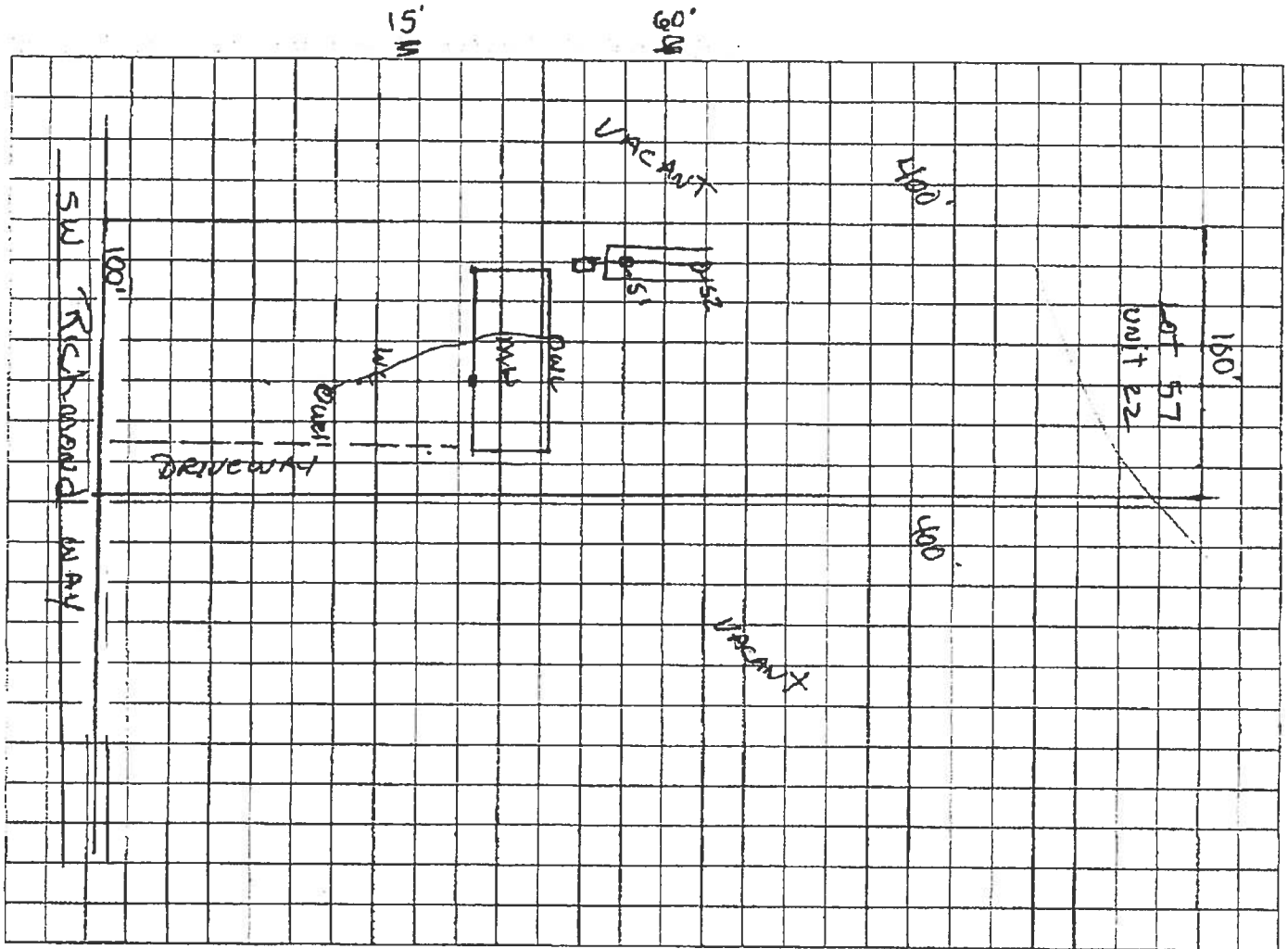

Notes: Joseph Gardina  
Lot 57 U-2 Three Rivers  
00-00-00-01417-000

Site Plan submitted by: Robert W. Ford DATE: 6/26/18

Plan Approved X

Not Approved

Date 8/29/18

By [Signature] FS II Columbia

County Health Department

ALL CHANGES MUST BE APPROVED BY THE COUNTY HEALTH DEPARTMENT