

MANUFACTURED BY:

Martinez Carports LLC
3402 SW Cypress Lake Rd.,
Lake City, FL

ENGINEERED BY:



A&A ENGINEERING
CIVIL - STRUCTURAL
6036 Renaissance Place, Toledo, OH 43623
Tel. 419-592-1083 • Fax. 419-592-0955
www.a-a-engineering.com

DRAWING INFORMATION

PROJECT: 30'-0" WIDE BUILDINGS
LOCATION: STATE OF FLORIDA
PROJECT NO.: 219-20-0922
SHEET TITLE:

COVER SHEET

SHEET NO.: 1 / 11

DRAWN BY: A.W. DATE: 1/19/21

CHECKED BY: OAA DATE: 1/19/21

LEGAL INFORMATION

- ANY DUPLICATION OF THIS DRAWING IN WHOLE OR
PART IS STRICTLY FORBIDDEN, ANYONE DOING SO WILL
BE RESPONSIBLE UNDER THE FULL EXTENT OF THE LAW.
- DRAWINGS ARE VALID UP TO DATE OF DEFORMATION.

SEAL:



STAMP EXPIRY: FEB 28, 2023
DATE SIGNED: JAN 20, 2021

DRAWING INDEX

PREVAILING CODE: FBC 2020 - 7TH EDITION COVER SHEET

USE GROUP: (FBC 2019) SCHEDULES & MEMBER -
RISK CATEGORY: U (CARPORTS, BARN) SECTIONS

1. DEAD LOAD (D) D = 4 PSF FRAME SECTIONS & DETAILS 3
2. ROOF LIVE/SNOW LOAD (Lr) Lr = 20 - 61 PSF SPACING SCHEDULES - 4
(AS PER SNOW LOAD SEE TABLE 4) PURLIN & GIRT SCHEDULES 5

3. SNOW LOAD (S) GROUND SNOW LOAD Pg = 20 - 90 PSF SHEATHING OPTIONS 6
IMPORTANCE FACTOR Is = 0.8 SIDE WALL FRAMING
THERMAL FACTOR Ct = 12 & OPENINGS 7-A, 7-B
EXPOSURE FACTOR Ce = 10 END WALL FRAMING
ROOF SLOPE FACTOR Cs = 1.0 & OPENINGS 8-A, 8-B

4. WIND LOAD (W) BASIC WIND SPEED Vwt = 105 - 180 MPH CORNER BRACING DETAILS 9
EXPOSURE C DESIGN CATEGORY D OPTIONAL LEAN-TO ADDITION 10
IMPORTANCE FACTOR Ie = 1.00 FOUNDATION OPTIONS 11-A TO 11-D

5. STRUCTURAL TUBE TS2 1/2"X2 1/2" - 14GA. IS EQUIVALENT TO TS2 1/4"X2 1/4" - 12GA AND EITHER ONE MAY BE USED IN LIEU OF THE OTHER.

6. STEEL SHEATHING SHALL BE 29GA. CORRUGATED GALV. OR PAINTED STEEL - MAIN RIB HT. 3/4" (FY=80KSI) OR EQ.

7. ALL STRUCTURAL LIGHT GAUGE TUBING AND CHANNELS SHALL BE GRADE 50 STEEL.

8. ALL DESIGN CRITERIA MUST BE INCREASED TO THE NEXT HIGHER INCREMENT BASED ON THE TABLES ON PAGE 4. NO INTERPOLATION IS ALLOWED.

LOAD COMBINATIONS:
1. D + (Lr OR S)
2. D + (0.6W OR ±0.7E)
3. D + 0.75 (0.6W OR ±0.7E) + 0.75 (Lr OR S)
4. 0.6D + (0.6W OR ±0.7E)

**REGULAR / A-FRAME
30'-0" WIDE**

CARPORT STYLE BUILDINGS

DESIGN CRITERIA

1. ALL CONSTRUCTION SHALL BE PROVIDED IN ACCORDANCE WITH IBC 2019, OSHA, AISC 360, AISI 100, ASCE 7-16, AWS D1.3 CODES AND ALL APPLICABLE LOCAL REQUIREMENTS.
2. BASE CONNECTIONS SHALL BE PROVIDED AS SHOWN ON FOUNDATION DETAILS SHEET.
3. ALL MATERIALS IDENTIFIED BY MANUFACTURER NAME MAY BE SUBSTITUTED WITH MATERIAL EQUAL OR EXCEEDING ORIGINAL.
4. ALL SHOP CONNECTIONS SHALL BE WELDED CONNECTIONS.
5. ALL FIELD CONNECTIONS SHALL BE #12" SD5 (ESR-2196 OR EQ).
6. STEEL SHEATHING SHALL BE 29GA. CORRUGATED GALV. OR PAINTED STEEL - MAIN RIB HT. 3/4" (FY=80KSI) OR EQ.
7. ALL STRUCTURAL LIGHT GAUGE TUBING AND CHANNELS SHALL BE GRADE 50 STEEL.
8. STRUCTURAL TUBE TS2 1/2"X2 1/2" - 14GA. IS EQUIVALENT TO TS2 1/4"X2 1/4" - 12GA AND EITHER ONE MAY BE USED IN LIEU OF THE OTHER.
9. ALL DESIGN CRITERIA MUST BE INCREASED TO THE NEXT HIGHER INCREMENT BASED ON THE TABLES ON PAGE 4. NO INTERPOLATION IS ALLOWED.

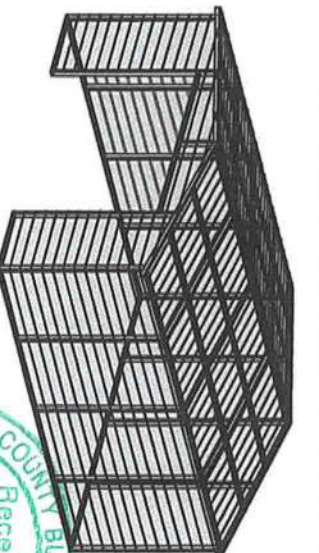
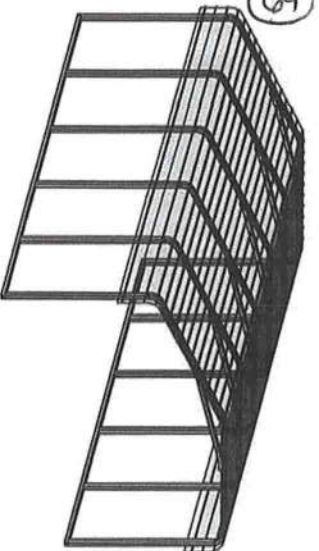

DRAWING INDEX

PREVAILING CODE: FBC 2020 - 7TH EDITION COVER SHEET

USE GROUP: (FBC 2019) SCHEDULES & MEMBER -
RISK CATEGORY: U (CARPORTS, BARN) SECTIONS

1. DEAD LOAD (D) D = 4 PSF FRAME SECTIONS & DETAILS 3
2. ROOF LIVE/SNOW LOAD (Lr) Lr = 20 - 61 PSF SPACING SCHEDULES - 4
(AS PER SNOW LOAD SEE TABLE 4) PURLIN & GIRT SCHEDULES 5

3. SNOW LOAD (S) GROUND SNOW LOAD Pg = 20 - 90 PSF SHEATHING OPTIONS 6
IMPORTANCE FACTOR Is = 0.8 SIDE WALL FRAMING
THERMAL FACTOR Ct = 12 & OPENINGS 7-A, 7-B
EXPOSURE FACTOR Ce = 10 END WALL FRAMING
ROOF SLOPE FACTOR Cs = 1.0 & OPENINGS 8-A, 8-B

4. WIND LOAD (W) BASIC WIND SPEED Vwt = 105 - 180 MPH CORNER BRACING DETAILS 9
EXPOSURE C DESIGN CATEGORY D OPTIONAL LEAN-TO ADDITION 10
IMPORTANCE FACTOR Ie = 1.00 FOUNDATION OPTIONS 11-A TO 11-D

5. STRUCTURAL TUBE TS2 1/2"X2 1/2" - 14GA. IS EQUIVALENT TO TS2 1/4"X2 1/4" - 12GA AND EITHER ONE MAY BE USED IN LIEU OF THE OTHER.

6. STEEL SHEATHING SHALL BE 29GA. CORRUGATED GALV. OR PAINTED STEEL - MAIN RIB HT. 3/4" (FY=80KSI) OR EQ.

7. ALL STRUCTURAL LIGHT GAUGE TUBING AND CHANNELS SHALL BE GRADE 50 STEEL.

8. ALL DESIGN CRITERIA MUST BE INCREASED TO THE NEXT HIGHER INCREMENT BASED ON THE TABLES ON PAGE 4. NO INTERPOLATION IS ALLOWED.

LOAD COMBINATIONS:
1. D + (Lr OR S)
2. D + (0.6W OR ±0.7E)
3. D + 0.75 (0.6W OR ±0.7E) + 0.75 (Lr OR S)
4. 0.6D + (0.6W OR ±0.7E)

CUSTOMER INFORMATION

OWNER:
ADDRESS:

DESIGN LOADS

GROUND SNOW:
ROOF LIVE LOAD:
BASIC WIND SPEED:

BUILDING INFORMATION

WIDTH:
LENGTH:
HEIGHT:
FRAME TYPE:
ENCLOSURE TYPE:
☐ A-FRAME
☐ REGULAR
☐ FULL
☐ PARTIAL
☐ OPEN

CERTIFICATION VALIDITY

DATE OF PLANS: MAY 14 2021
EXPIRATION: MAY 14 2021
CERTIFICATION ON THESE DRAWINGS IS
VALID FOR ONE YEAR FROM DATE OF ISSUE

TABLE 2.1: MEMBER PROPERTIES

NO.	LABEL	PROPERTY	DETAIL NO.
1	COLUMN POST	2.5" X 2.5" X 14GA TUBE W/ 2.25" X 2.25" X 12GA TUBE INSERT	11
2	ROOF BEAM	2.5" X 2.5" X 14GA TUBE	1
3	BASE RAIL	2.5" X 2.5" X 14GA TUBE	1
4	PEAK BRACE	2.5" X 2.5" X 14GA TUBE	1
5	KNEE BRACES	2.5" X 1.5" 14GA CHANNEL	4
6	CONNECTOR SLEEVE	2.25" X 2.25" X 12GA TUBE	2
7	BASE ANGLE	2" X 2" X 3" LG. 3/16" ANGLE	10
8	PURLIN	4.25" X 1.5" X 18GA / 14GA HAT CHANNEL	5
9	GIRT	4.25" X 1.5" X 18GA / 14GA HAT CHANNEL	5
10	SHEATHING	29 GA CORRUGATED SHEET	8
11	END WALL POST	2.5" X 2.5" X 14GA TUBE	1
12	DOOR POST	2.5" X 2.5" X 14GA TUBE	1
13	SINGLE HEADER	2.5" X 2.5" X 14GA TUBE	1
14	DOUBLE HEADER	DBL. 2.5" X 2.5" X 14GA TUBE	1
15	SERVICE DOOR / WINDOW FRAMING	2.5" X 2.5" X 14GA TUBE	1
16	ANGLE BRACKET	2" X 2" X 2" LG. 14GA ANGLE	7
17	STRAIGHT BRACKET	2" X 2" X 4" LG. 14GA PLATE	6
18	PB SUPPORT	2.5" X 2.5" X 14GA TUBE	1
19	DIAGONAL BRACE	2" X 2" X 14 GA TUBE	3
20	GABLE BRACE	2" X 2" X 14 GA TUBE	3
21	DB BRACKET	2.25" X 2.25" X 6" X 14GA ANGLE	9
22	TRUSS SPACER	2.5" X 2.5" X 14GA TUBE	1
23	ALL FASTENERS	#12 X 1" SELF-DRILL SCREWS (ESR-2196 OR EQ) W/ NEOPRENE/STEEL WASHER	

TABLE 2.2: SHEATHING FASTENER SCHEDULE

LOCATION	CORNER PANELS	SIDE LAPS	EDGE LAPS	ELSEWHERE
SPACING	9" C/C	MIN 1	4 1/2" C/C	9" C/C

FASTENER TYPE: #12X1" SELF-DRILL SCREWS (ESR-2196 OR EQ) W/ NEOPRENE/STEEL WASHER
 *SEE TYP. SHEATHING FASTENER SCHEDULE DIAGRAM ON PAGE 6.

TABLE 2.3: GAUGE THICKNESS

GAUGE	29	18	14	12
THICKNESS (IN)	0.0135	0.049	0.083	0.109

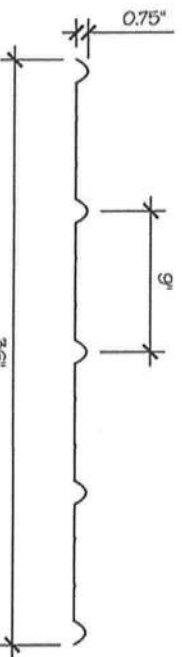
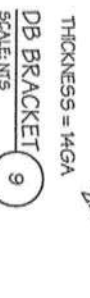
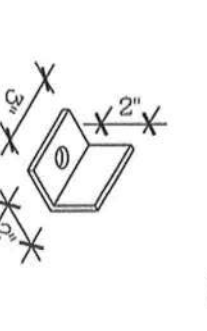
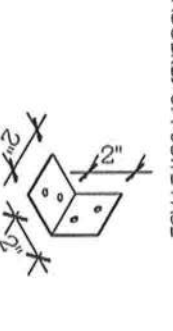
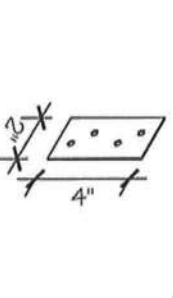
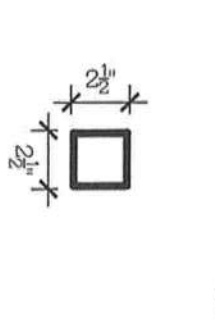
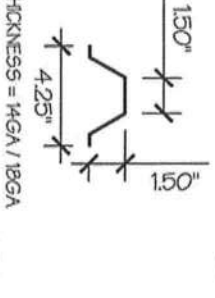
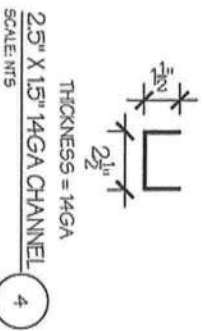
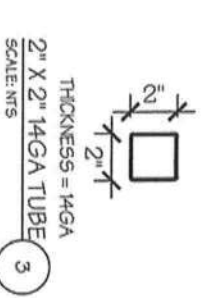
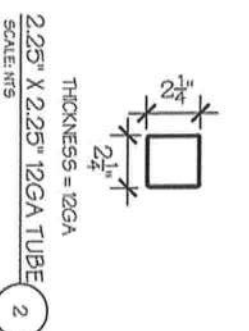
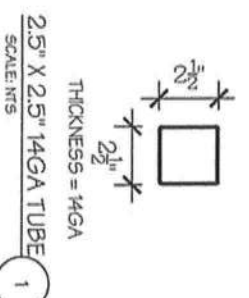
29 GA CORRUGATED SHEATHING 8
SCALE: NTS

Martinez Carports LLC

3402 SW Cypress Lake Rd.,
Lake City, FL

ENGINEERED BY:



A&A ENGINEERING

CIVIL • STRUCTURAL

6036 Beaufort Place, Toledo, OH 43623
Tel: 419-592-1985 • Fax: 419-592-4055
www.aandengineering.com

DRAWING INFORMATION

PROJECT: 30'-0" WIDE BUILDINGS

LOCATION: STATE OF FLORIDA

PROJECT NO.: 219-20-0922

SHEET TITLE:

SCHEDULES &
MEMBER SECTIONS

SHEET NO.: 2 / 11

DRAWN BY: A.W. DATE: 1/19/21

CHECKED BY: O.A. DATE: 1/19/21

LEGAL INFORMATION

- ANY DUPLICATION OF THIS DRAWING IN WHOLE OR PART IS STRICTLY PROHIBITED AND WILL BE PROSECUTED UNDER THE FULL PENALTY OF THE LAW.
 - DRAWINGS ARE VALID UP TO DATE OF DELETION.

SEAL:

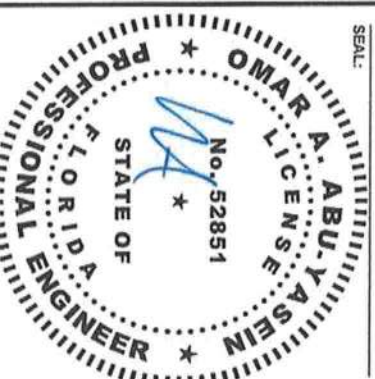
STAMP EXPIRY: FEB 28, 2023
DATE SIGNED: JAN 20, 2021

MANUFACTURED BY:

Martinez Carports LLC
3402 SW Cypress Lake Rd.,
Lake City, FL

ENGINEERED BY:



A&A ENGINEERING
CIVIL - STRUCTURAL
6036 Renaissance Place, Toledo, OH 43623
Tel: 419-292-1583 • Fax: 419-292-4855
www.aandengineering.com

DRAWING INFORMATION

PROJECT: 30'-0" WIDE BUILDINGS

LOCATION: STATE OF FLORIDA

PROJECT NO.: 219-20-0922

SHEET TITLE:

FRAME SECTIONS & DETAILS

SHEET NO.: 3 / 11

DRAWN BY: A.W. DATE: 1/19/21

CHECKED BY: OAA DATE: 1/19/21

LEGAL INFORMATION

- ANY DUPLICATION OF THIS DRAWING IN WHOLE OR PART IS STRICTLY FORBIDDEN, ANYONE DOING SO WILL BE RESPONSIBLE FOR THE FULL EXTENT OF THE LAW.
- DRAWINGS ARE VALID UP TO DATE OF DEPICTION.

SEAL:

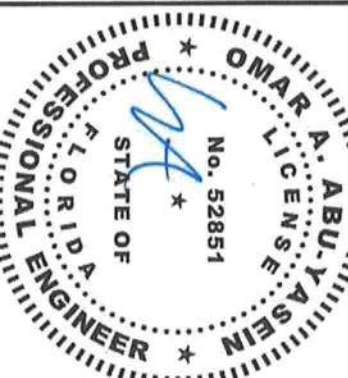

STAMP EXPIRY: FEB 28, 2023

DATE SIGNED: JAN 20, 2021

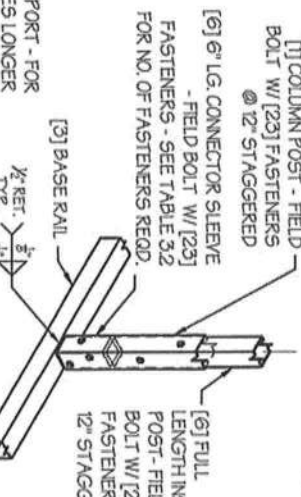
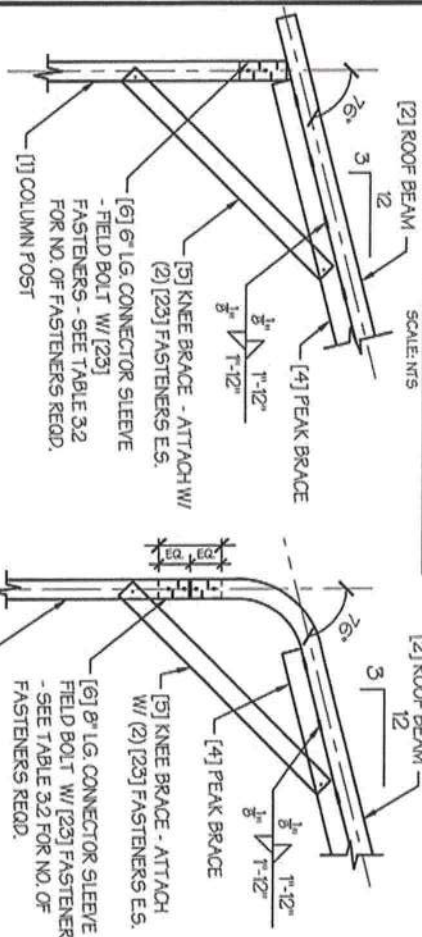
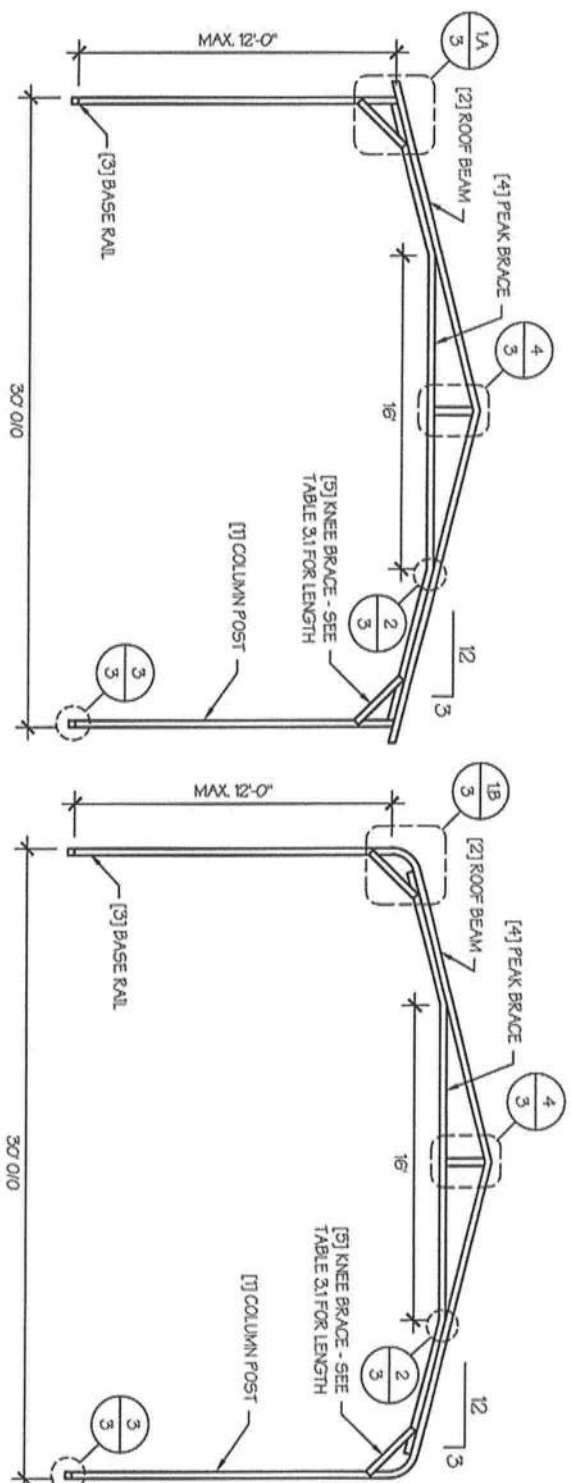

TABLE 3.1: KNEE BRACE SCHEDULE

EAVE HEIGHT	KNEE BRACE LENGTH
□ UP TO 8'	24"
□ 9 TO 12'	36"

TABLE 3.2 FASTENER SCHEDULE

WIND SPEED (MPH)	NO. OF FASTENERS
□ 105 TO 125	4
□ 130 TO 155	6
□ 160 TO 180	8

NOTE: COLUMN POST MAY BE ADJUSTED ±1" FOR LEVELING.
MANUFACTURER IS NOT RESPONSIBLE FOR LEVELING OF GROUND
AND/OR CONCRETE SURFACE PROVIDED BY OTHERS.

MANUFACTURED BY:

Martinez Carports LLC
3402 SW Cypress Lake Rd.,
Lake City, FL



A&A ENGINEERING
CIVIL • STRUCTURAL
6036 Reservoir Pkwy., Toledo, OH 43623
Tel. 419.292.1983 • Fax. 419.292.0535
www.aandengineering.com

ENGINEERED BY:

DRAWING INFORMATION
PROJECT: 30'-0" WIDE BUILDINGS
LOCATION: STATE OF FLORIDA
PROJECT NO.: 219-20-0922
SHEET TITLE:
SPACING SCHEDULES
& ENCLOSURE NOTES

SHEET NO.: 4 / 11
DRAWN BY: A.W. DATE: 1/19/21
CHECKED BY: OAA DATE: 1/19/21
LEGAL INFORMATION
- ANY DUPLICATION OF THIS DRAWING IN WHOLE OR
PART IS STRICTLY PROHIBITED. ANYONE DOING SO WILL
BE PROSECUTED UNDER THE FULL EXTENT OF THE LAW.
- DRAWINGS ARE VALID UP TO DATE OF EXPIRATION.

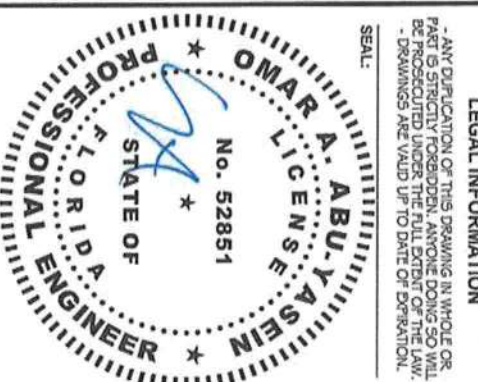

STAMP EXPIRY: FEB 28, 2023
DATE SIGNED: JAN 20, 2021

TABLE 4: FRAME SPACING CHART / SCHEDULE

EAVE HEIGHT = UP TO 6'-0"	GROUND SNOW / ROOF LIVE LOAD (PSF)	■ ENCLOSED BUILDINGS										■ OPEN BUILDINGS									
		WIND SPEED (MPH)										WIND SPEED (MPH)									
		105	115	130	140	155	165	180	105	115	130	140	155	165	180						
■ EAVE HEIGHT = UP TO 6'-0"	30 / 20	60	60	54/60	54	48	42/48	36/42	54	48/54	42/48	42	36/42	36	30						
	40 / 27	48/60	48/60	42/60	42/54	48	42/48	36/42	48	48	42/48	42	36/42	36	30						
	50 / 34	40/54	40/54	40/54	40/48	40/48	40/48	36/42	40/42	40/42	40/42	36	36/42	36	30						
	60 / 41	36/48	36/48	36/48	36/48	36/42	36/42	36/42	36	36	36	30	30	36	30/36						
	70 / 47	32/42	32/42	32/36	32/36	32/36	32/36	32/36	30	30	30	24	24	30	24						
	80 / 54	30/36	30/36	30/36	30/36	30/36	30/36	30/36	30	30	30	30	30	30	24						
	90 / 61	30/36	30/36	30	30	30	30	30	24	24	24	24	24	24	24						
■ EAVE HEIGHT = 7'-0" TO 9'-0"	30 / 20	60	60	54/60	54	48	42/48	36/42	54	48/54	42/54	42/48	36/42	36/42	30/36						
	40 / 27	48/60	48/60	42/60	48/54	48	42/48	36/42	48	48	42/48	42/48	36/42	36/42	30/36						
	50 / 34	40/54	40/54	40/54	40/48	40/48	40/48	36/42	40/42	40/42	40/42	36/42	36/42	36	30/36						
	60 / 41	36/48	36/42	36/42	36/42	36/42	36/42	36/42	36	36	36	36	36	36	30/36						
	70 / 47	32/36	32/36	32/36	32/36	32/36	30	30	30	30	30	30	30	30	24						
	80 / 54	30	30	30	30	30	30	30	24	24	24	24	24	24	24						
	90 / 61	24	24	24	24	24	24	24	18	18	18	18	18	18	18						
■ EAVE HEIGHT = 10'-0" TO 12'-0"	30 / 20	60	60	54/60	54	48	42/48	36/42	54	48/54	42/54	42/48	36/42	36/42	30/36						
	40 / 27	48/60	48/60	42/60	48/54	48	42/48	36/42	48	48	42/48	42/48	36/42	36/42	30/36						
	50 / 34	40/54	40/54	40/54	40/48	40/48	40/48	36/42	40/42	40/42	40/42	36/42	36/42	36	30/36						
	60 / 41	36/48	36/42	36/42	36/42	36/42	36/42	36/42	36	36	36	36	36	36	30/36						
	70 / 47	32/36	32/36	32/36	32/36	32/36	30	30	30	30	30	30	30	30	24						
	80 / 54	24	24	24	24	24	24	24	24	24	24	24	24	24	24						
	90 / 61	18	18	18	18	---	---	---	18	18	---	---	---	---	---						

- NOTES:
- FRAME SPACINGS ARE IN UNITS OF INCHES (IN).
 - WHERE TWO VALUES ARE SHOWN, THE HIGHER VALUE CAN ONLY BE USED FOR VERTICAL SHEATHING.
 - SNOW LOADS AND ROOF LIVE LOADS ARE IN POUNDS PER SQUARE FOOT (PSF). WIND SPEED IS 3 SEC. GUST IN MILES PER HOUR (MPH).
 - FOR VALUES THAT LIE BETWEEN TWO CELLS, THE HIGHER (MORE STRINGENT) VALUE HAS TO BE USED. INTERPOLATION BETWEEN CELLS IS NOT ALLOWED.

ENCLOSURE CLASSIFICATION:

- ENCLOSED BUILDING = ALL 4 WALLS FULLY ENCLOSED WITH DOORS/WINDOWS = USE ENCLOSED BUILDING SPACING CHART.
- OPEN BUILDING = ALL 4 WALLS FULLY OPEN = USE OPEN BUILDING SPACING CHART.
- 3FT PARTIALLY ENCLOSED = BOTH END-WALLS FULLY OPEN, WITH BOTH SIDE-WALLS ONLY 3FT ENCLOSED = USE OPEN BUILDING SPACING CHART.
- PARTIALLY ENCLOSED = BOTH END-WALLS FULLY OPEN, WITH BOTH SIDE-WALLS ENCLOSED MORE THAN 3FT = START WITH OPEN BUILDING SPACING CHART AND THEN REDUCE SPACING BY 6".
- 3 SIDE ENCLOSED = ALL WALLS ARE ENCLOSED EXCEPT FOR 1 END-WALL = START WITH ENCLOSED BUILDING SPACING + THE OPEN END FRAME MUST HAVE EITHER A GABLED END OR HAVE DOUBLED WELDED LEGS & ROOF.
- FOR ALL SHEATHING ENCLOSURES NOT LISTED ABOVE, REFER TO SHEET 5 FOR SPACING AND DESIGN REQUIREMENTS.

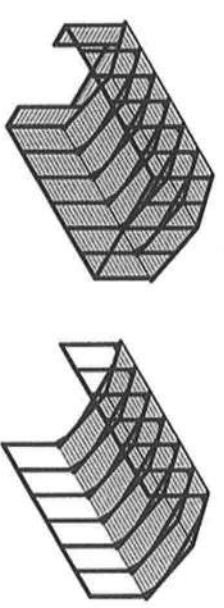

TYP. ENCLOSED BUILDING SCALE: NTS
TYP. OPEN BUILDING SCALE: NTS

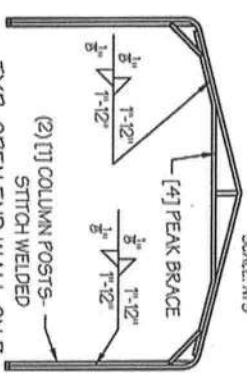

TYP. OPEN END WALL ON 3
SIDE ENCLOSED BUILDING
SCALE: NTS

- GENERAL NOTES:
- THE MAX BUILDING LENGTH FOR ENCLOSED BUILDINGS IS 50'-0". THIS CAN BE INCREASED BY ADDING A DOUBLE FRAME AT THE CENTER TO BREAK THE LENGTH OF THE BUILDING.
 - BUILDINGS WITH PARTIALLY ENCLOSED END WALLS NEED TO HAVE SIDE WALL BRACING TO SUPPORT THE PARTIALLY ENCLOSED END WALL. (SEE FIGURE A ON SHEET 5).

TABLE 5.1: PURLIN SPACING SCHEDULE

GROUND SNOW / ROOF LIVE LOAD (PSF)	18GA. HAT CHANNEL PURLIN										16GA. HAT CHANNEL PURLIN									
	WIND SPEED (MPH)										WIND SPEED (MPH)									
	105	115	130	140	155	165	180	190	200	210	105	115	130	140	155	165	180	190	200	210
30 / 20	54	46	42	36	30	24	24	24	24	24	36	30	24	18	15	12	12	12	12	12
40 / 27	42	42	42	36	30	24	24	24	24	24	30	30	24	18	15	12	12	12	12	12
50 / 34	40	40	40	36	30	24	24	24	24	24	24	24	24	18	15	12	12	12	12	12
60 / 41	36	36	36	36	30	24	24	24	24	24	18	18	18	15	12	12	12	12	12	12
70 / 47	32	32	32	32	30	24	24	24	24	24	15	15	15	15	12	12	12	12	12	12
80 / 54	30	30	30	30	30	24	24	24	24	24	12	12	12	12	12	12	12	12	12	12
90 / 61	24	24	24	24	24	24	24	24	24	24	12	12	12	12	12	12	12	12	12	12
30 / 20	54	46	42	36	30	24	24	24	24	24	54	46	42	36	30	24	24	24	24	24
40 / 27	42	42	42	36	30	24	24	24	24	24	42	42	36	30	24	24	24	24	24	24
50 / 34	40	40	40	36	30	24	24	24	24	24	40	40	36	30	24	24	24	24	24	24
60 / 41	36	36	36	36	30	24	24	24	24	24	36	36	36	30	24	24	24	24	24	24
70 / 47	32	32	32	32	30	24	24	24	24	24	32	32	32	30	24	24	24	24	24	24
80 / 54	32	32	32	32	30	24	24	24	24	24	32	32	32	30	24	24	24	24	24	24
90 / 61	30	30	30	30	30	24	24	24	24	24	30	30	30	30	24	24	24	24	24	24
30 / 20	54	46	42	36	30	24	24	24	24	24	54	46	42	36	30	24	24	24	24	24
40 / 27	42	42	42	36	30	24	24	24	24	24	42	42	36	30	24	24	24	24	24	24
50 / 34	40	40	40	36	30	24	24	24	24	24	40	40	36	30	24	24	24	24	24	24
60 / 41	36	36	36	36	30	24	24	24	24	24	36	36	36	30	24	24	24	24	24	24
70 / 47	32	32	32	32	30	24	24	24	24	24	32	32	32	30	24	24	24	24	24	24
80 / 54	32	32	32	32	30	24	24	24	24	24	32	32	32	30	24	24	24	24	24	24
90 / 61	30	30	30	30	30	24	24	24	24	24	30	30	30	30	24	24	24	24	24	24
30 / 20	54	46	42	36	30	24	24	24	24	24	54	46	42	36	30	24	24	24	24	24
40 / 27	42	42	42	36	30	24	24	24	24	24	42	42	36	30	24	24	24	24	24	24
50 / 34	40	40	40	36	30	24	24	24	24	24	40	40	36	30	24	24	24	24	24	24
60 / 41	36	36	36	36	30	24	24	24	24	24	36	36	36	30	24	24	24	24	24	24
70 / 47	32	32	32	32	30	24	24	24	24	24	32	32	32	30	24	24	24	24	24	24
80 / 54	32	32	32	32	30	24	24	24	24	24	32	32	32	30	24	24	24	24	24	24
90 / 61	30	30	30	30	30	24	24	24	24	24	30	30	30	30	24	24	24	24	24	24

NOTES:

- PURLIN SPACING UNITS ARE IN INCHES.
- FRAME SPACING NEEDS TO BE DETERMINED FROM TABLE 4.

IRREGULAR BUILDING NOTES:

- FIGURES A, B, C & D ON THE RIGHT INDICATE EXAMPLES OF IRREGULAR BUILDINGS.
- FOR IRREGULAR BUILDINGS, FRAME SPACING MUST BE REDUCED BY 6" FROM OPEN BUILDING SPACING TABLE. SEE SHEET 4 FOR OPEN BUILDING TABLE.
- SITE SPECIFICS MAY ALLOW FOR ALTERNATIVE SPACING.

TABLE 5.2: GIRT SPACING SCHEDULE

FRAME SPACING	WIND SPEED (MPH)									
	105	115	130	140	155	165	180	190	200	210
3'-0"	60	48	36	30	24	24	18	15	12	12
4'-6"	60	60	48	42	36	30	24	18	15	12
6'-0"	60	60	54	54	42	36	30	24	18	12
8'-0"	60	60	54	54	42	36	30	24	18	12
10'-0"	60	60	54	54	42	36	30	24	18	12

NOTES:

- GIRT SPACING UNITS ARE IN INCHES.
- THIS SCHEDULE IS TO BE USED FOR BOTH 18GA AND 16GA PURLINS.
- FRAME SPACING NEEDS TO BE DETERMINED FROM TABLE 4.

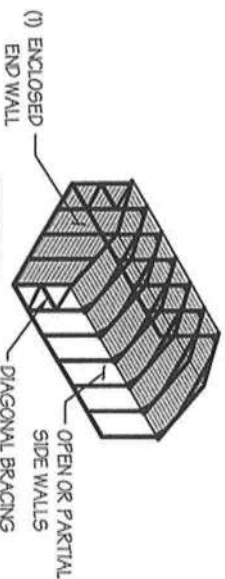

FIGURE A: OPEN OR PARTIAL SIDE WALLS AT ENCLOSED END WALL

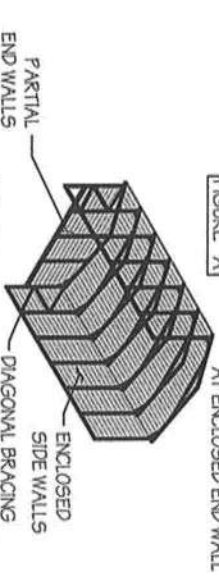

FIGURE B: ENCLOSED SIDE WALLS AT PARTIAL END WALL

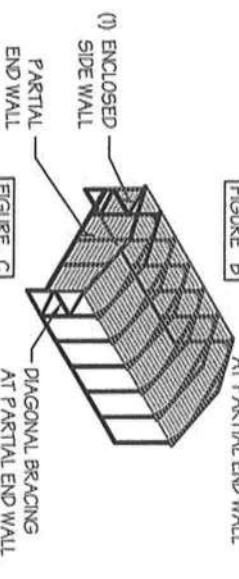

FIGURE C: ENCLOSED SIDE WALLS AT PARTIAL END WALL

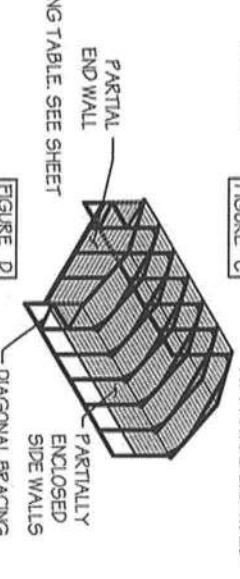

FIGURE D: PARTIALLY ENCLOSED SIDE WALLS AT PARTIAL END WALL

MANUFACTURED BY:

Marinez Carports LLC
3402 SW Cypress Lake Rd.,
Lake City, FL

ENGINEERED BY:

A&A ENGINEERING
CIVIL • STRUCTURAL
6036 Reservoir Pkwy., Toledo, OH 43623
Tel. 419-992-1983 • Fax. 419-992-0535
www.aandengineering.com

DRAWING INFORMATION

PROJECT: 30'-0" WIDE BUILDINGS

LOCATION: STATE OF FLORIDA

PROJECT NO.: 219-20-0922

SHEET TITLE:

PURLIN & GIRT
SPACING SCHEDULES

SHEET NO.: 5 / 11

DRAWN BY: A.W. DATE: 1/19/21

CHECKED BY: OAA DATE: 1/19/21

LEGAL INFORMATION

- ANY DUPLICATION OF THIS DRAWING IN WHOLE OR PART IS STRICTLY PROHIBITED. ANYONE DOING SO WILL BE PROSECUTED UNDER THE FULL EXTENT OF THE LAW.
- DRAWINGS ARE VALID UP TO DATE OF DEPARTURE.

SEAL:



STAMP EXPIRY: FEB 28, 2023
DATE SIGNED: JAN 20, 2021

MANUFACTURED BY:

Martinez Carports LLC
3402 SW Cypress Lake Rd.,
Lake City, FL

ENGINEERED BY:



A&A ENGINEERING
CIVIL-STRUCTURAL
6036 Resumineer Pkwy., Toledo, OH 43623
Tel. 419-592-1583 • Fax 419-592-0535
www.aandengineering.com

DRAWING INFORMATION

PROJECT: 30'-0" WIDE BUILDINGS

LOCATION: STATE OF FLORIDA

PROJECT NO.: 219-20-0922

SHEET TITLE:

**SIDE WALL FRAMING
& OPENINGS**

SHEET NO.: 7-A / 11

DRAWN BY: A.W. DATE: 1/19/21

CHECKED BY: OAA DATE: 1/19/21

LEGAL INFORMATION

- ANY DUPLICATION OF THIS DRAWING IN WHOLE OR
PART IS STRICTLY PROHIBITED. ANYONE DOING SO WILL
BE PROSECUTED UNDER THE FULL EXTENT OF THE LAW.
- DRAWINGS ARE VALID UP TO DATE OF EXPIRATION.

SEAL:



STAMP EXPIRY: FEB 28, 2023

DATE SIGNED: JAN 20, 2021

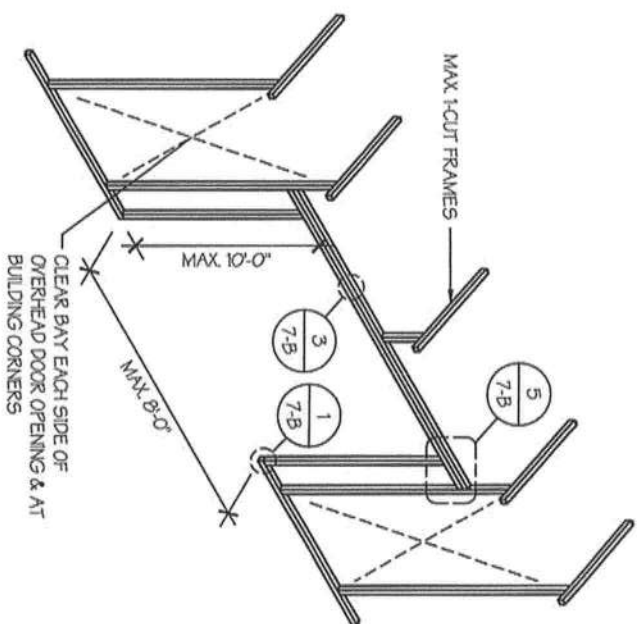

☐ **SIDE WALL OVERHEAD DOOR OPENINGS**

SCALE: NTS

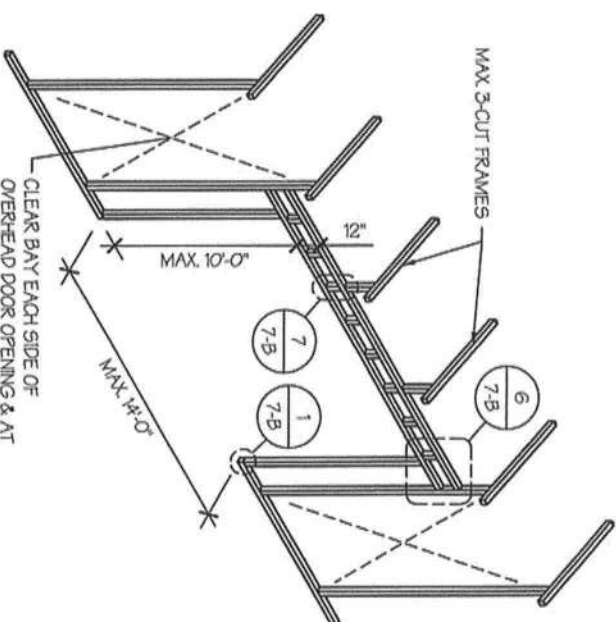

☐ **SIDE WALL OVERHEAD DOOR OPENINGS
WITH TRUSS STYLE HEADER**

SCALE: NTS

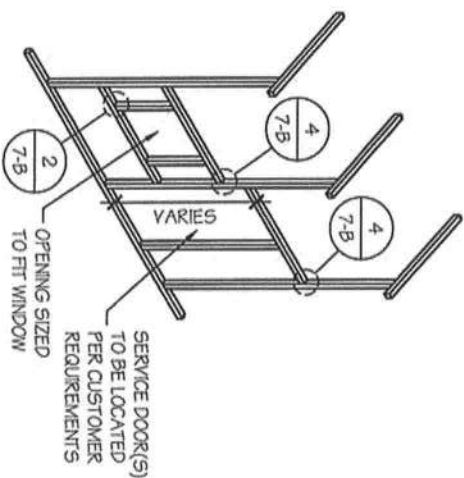

☐ **SIDE WALL SERVICE DOOR / WINDOW OPENINGS**

SCALE: NTS

SIDE WALL FRAMING NOTES:

1. TRUSS-STYLE HEADERS ARE REQUIRED FOR WHERE THE GROUND SNOW LOAD IS 40 PSF OR GREATER.
2. DESIGNS AND DETAILS SHOWN HERE ARE APPLICABLE TO BOTH REGULAR AND A-FRAME STYLE BUILDINGS.
3. MAX. HEIGHT OF SIDE WALL OVERHEAD DOOR OPENINGS IS 2 FT LESS THAN THE EAVE HEIGHT.
4. OVERHEAD DOOR OPENINGS CANNOT CUT THROUGH MORE THAN 2 FULL FRAMES.
5. MIN. 1 CLEAR BAY MUST BE MAINTAINED BETWEEN ANY 2 OVERHEAD DOOR OPENINGS. A CLEAR BAY IS A SPACE BETWEEN TWO FRAMES THAT HAS NO OVERHEAD DOOR OPENINGS.
6. MIN. 1 CLEAR BAY MUST ALSO BE MAINTAINED FROM THE BUILDING CORNERS.
7. SERVICE DOORS AND WINDOWS CAN BE PLACED IN CLEAR BAYS OR ANY WHERE ELSE AS NEEDED.

Martinez Carports LLC
3402 SW Cypress Lake Rd.,
Lake City, FL

ENGINEERED BY:



A&A ENGINEERING
CIVIL • STRUCTURAL
6036 Renaissance Place, Toledo, OH 43623
Tel. 419-529-1983 • Fax. 419-529-2655
www.aandengineering.com

DRAWING INFORMATION

PROJECT: 30'-0" WIDE BUILDINGS

LOCATION: STATE OF FLORIDA

PROJECT NO.: 219-20-0922

SHEET TITLE:

**SIDE WALL FRAMING
DETAILS**

SHEET NO.: 7-B / 11

DRAWN BY: A.W. DATE: 1/19/21

CHECKED BY: OAA DATE: 1/19/21

LEGAL INFORMATION

- ANY DUPLICATION OF THIS DRAWING IN WHOLE OR
PART IS STRICTLY PROHIBITED. ANYONE DOING SO SHALL
BE PROSECUTED UNDER THE FULL EXTENT OF THE LAW.
- DRAWINGS ARE VALID UP TO DATE OF DESTRUCTION.

SEAL:



STAMP EXPIRY: FEB 28, 2023

DATE SIGNED: JAN 20, 2021

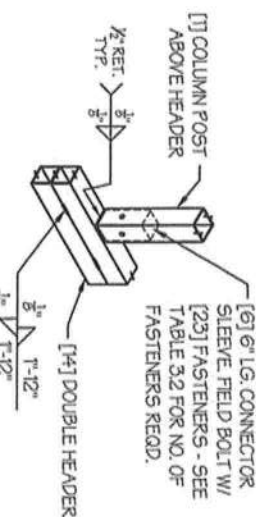

**COLUMN POST ABOVE DBL.
DOOR HEADER CONN. DETAIL** 3
SCALE: NTS

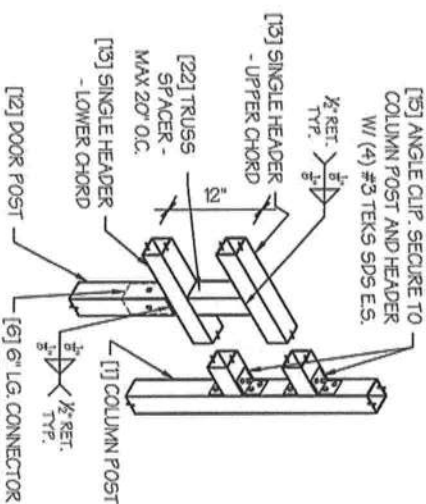

**COLUMN POST ABOVE TRUSS
DOOR HEADER CONN. DETAIL** 4
SCALE: NTS

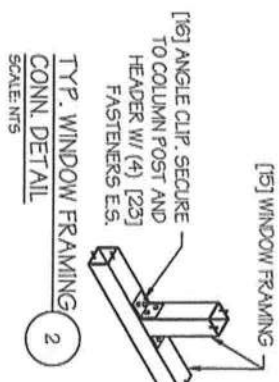

**TYP. WINDOW FRAMING
CONN. DETAIL** 5
SCALE: NTS

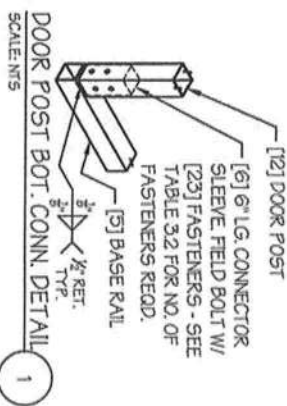

DOOR POST BOT. CONN. DETAIL 6
SCALE: NTS

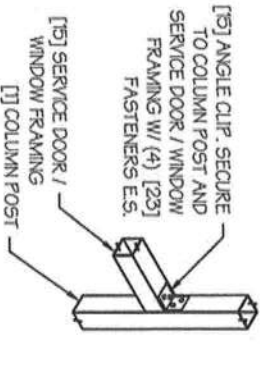

**TYP. SERVICE DOOR / WINDOW
FRAMING CONN. DETAIL** 7
SCALE: NTS

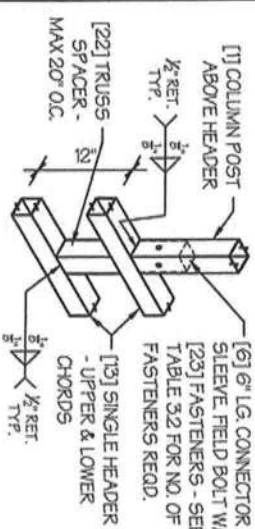

**COLUMN POST ABOVE TRUSS
DOOR HEADER CONN. DETAIL** 8
SCALE: NTS

Martinez Carports LLC
3402 SW Cypress Lake Rd.,
Lake City, FL



Tel. 419-292-1983 • Fax. 419-292-0955
WWW.AA-ENGINEERS.COM

PROJECT: 30'-0" WIDE BUILDINGS

LOCATION: STATE OF FLORIDA

PROJECT NO.: 219-20-0922

SHEET TITLE:

END WALL FRAMING

SHEET NO.: 8-A / 11

DRAWN BY: A.W. DATE: 1/19/21

CHECKED BY: OAA DATE: 1/19/21

LEGAL INFORMATION

- ANY DUPLICATION OF THIS DRAWING IN WHOLE OR PART IS STRICTLY FORBIDDEN. ANYONE DOING SO WILL BE PROSECUTED UNDER THE FULL EXTENT OF THE LAW.
- DRAWINGS ARE VALID UP TO DATE OF EXPIRATION.

SEAL:



STAMP EXPIRY: FEB 28, 2023

DATE SIGNED: **JAN 20, 2021**

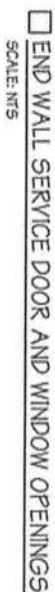

TABLE 8-A.1: END WALL POST
SPACING SCHEDULE

WIND SPEED (MPH)	EAVE HEIGHT		
	UP TO 7'	8 TO 9'	10 TO 12'
<input type="checkbox"/> 105	5'	5'	5'
<input type="checkbox"/> 115	5'	5'	4.5'
<input type="checkbox"/> 130	4.5'	4.5'	4'
<input type="checkbox"/> 140	4.5'	4.5'	3'
<input type="checkbox"/> 155	4'	4'	2.5'
<input type="checkbox"/> 165 - 180	3.5'	3'	2'

- END WALL FRAMING NOTES:**
1. DESIGNS AND DETAILS SHOWN HERE ARE APPLICABLE TO BOTH REGULAR AND A-FRAME STYLE BUILDINGS.
 2. MIN. 12" CLEARANCE MUST BE MAINTAINED BETWEEN ANY TWO OPENINGS (OVERHEAD DOOR OR SERVICE DOOR, AND FROM CORNERS).
 3. SERVICE DOORS AND WINDOWS CAN BE PLACED AS NEEDED.
 4. DIAGONAL BRACES NEED TO BE ADDED FOR PARTIAL END WALL ENCLOSURES. SEE SHEET 9 FOR DIAGONAL BRACE CONNECTION DETAILS.

MANUFACTURED BY:

Martinez Carports LLC
3402 SW Cypress Lake Rd.,
Lake City, FL

ENGINEERED BY:



A&A ENGINEERING
CIVIL • STRUCTURAL
6036 Renaissance Park, Toledo, OH 43623
Tel. 419-292-1583 • Fax. 419-292-0855
www.a-a-engineering.com

DRAWING INFORMATION

PROJECT: 30'-0" WIDE BUILDINGS

LOCATION: STATE OF FLORIDA

PROJECT NO.: 219-20-0922

SHEET TITLE:

**END WALL FRAMING
DETAILS**

SHEET NO.: 8-B / 11

DRAWN BY: A.W. DATE: 1/19/21

CHECKED BY: OAA DATE: 1/19/21

LEGAL INFORMATION

- ANY DUPLICATION OF THIS DRAWING IN WHOLE OR
PART WITHOUT THE WRITTEN PERMISSION OF THE
ENGINEER IS PROHIBITED. ANYONE DOING SO WILL
BE PROSECUTED TO THE FULL EXTENT OF THE LAW.
- DRAWINGS ARE VALID UP TO DATE OF DESTRUCTION.

SEAL:

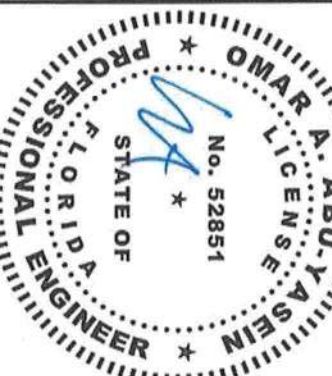

STAMP EXPIRY: FEB 28, 2023

DATE SIGNED: JAN 20, 2021

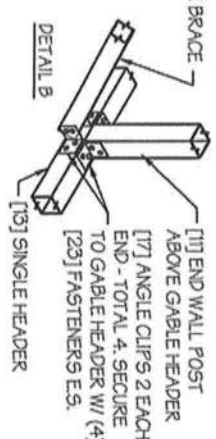
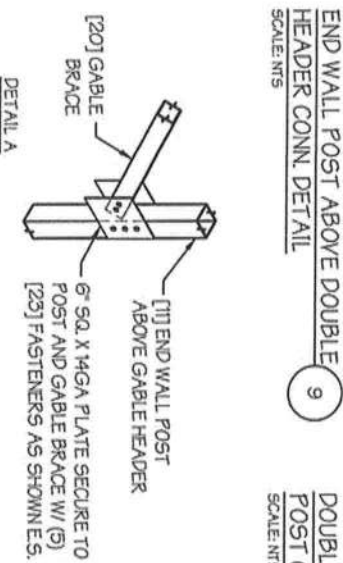
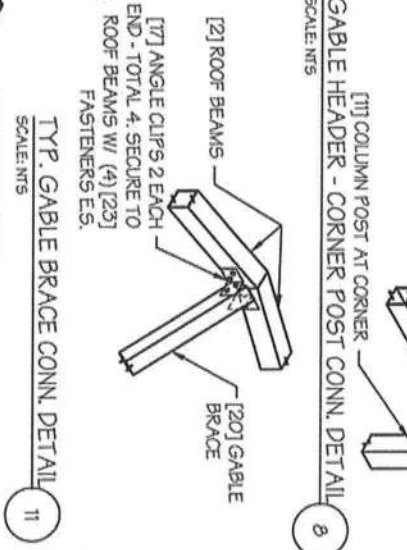
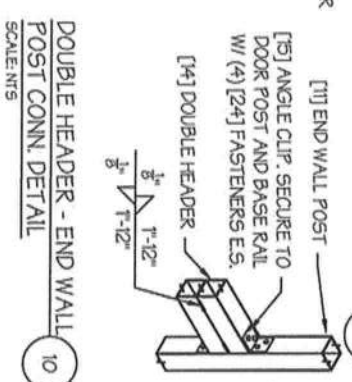
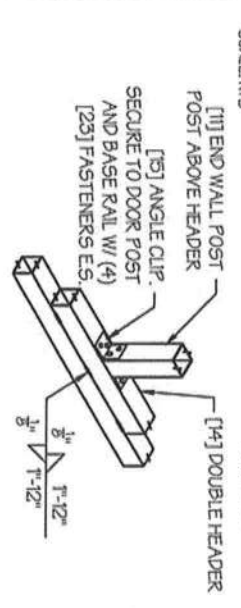
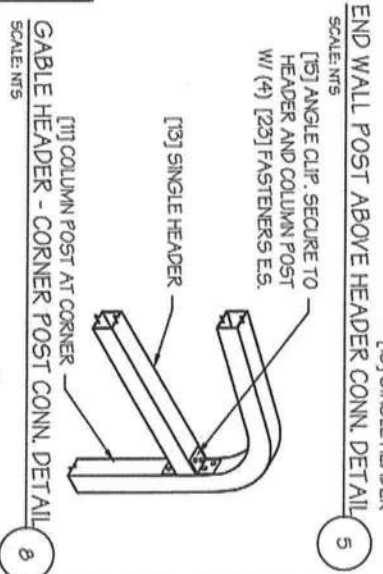
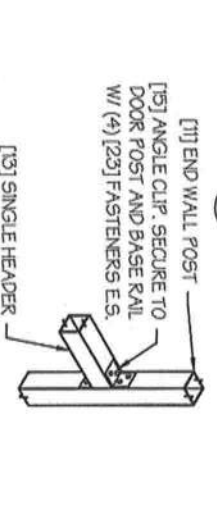
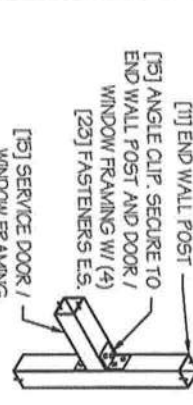
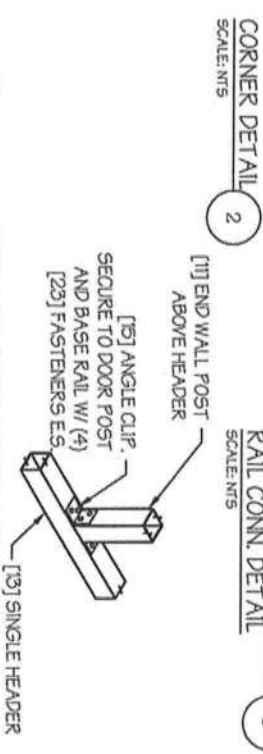
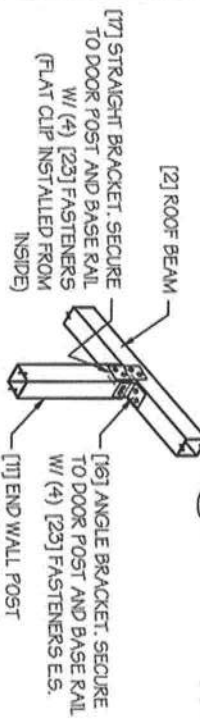
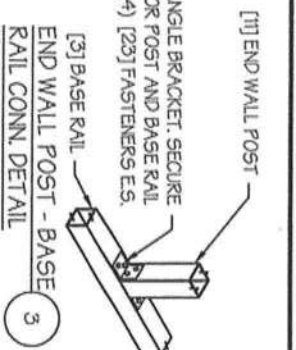
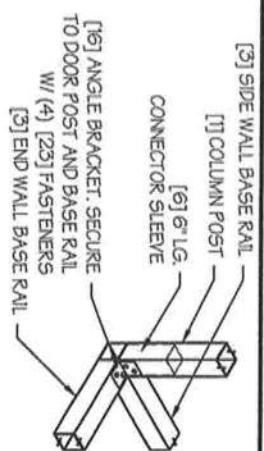
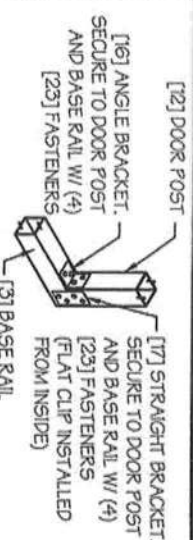

MANUFACTURED BY:

Martinez Carports LLC
3402 SW Cypress Lake Rd.,
Lake City, FL

ENGINEERED BY:



A&A ENGINEERING
CIVIL - STRUCTURAL
6036 Benthams Place, Toledo, OH 43623
Tel: 419-592-1983 • Fax: 419-592-0855
www.aandengineering.com

DRAWING INFORMATION

PROJECT: 30'-0" WIDE BUILDINGS
LOCATION: STATE OF FLORIDA
PROJECT NO.: 219-20-0922
SHEET TITLE:
CORNER BRACING
DETAILS

SHEET NO.: 9 / 11

DRAWN BY: A.W. DATE: 1/19/21

CHECKED BY: OAA DATE: 1/19/21

LEGAL INFORMATION

- ANY DUPLICATION OF THIS DRAWING IN WHOLE OR PART IS STRICTLY FORBIDDEN. ANYONE DOING SO WILL BE PROSECUTED UNDER THE FULL EXTENT OF THE LAW.
- DRAWINGS ARE VALID UP TO DATE OF DEPICTION.

SEAL:

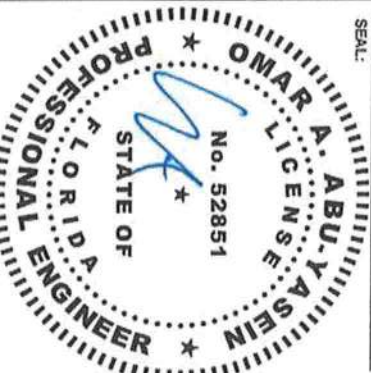

STAMP EXPIRY: FEB 28, 2023

DATE SIGNED: JAN 20, 2021

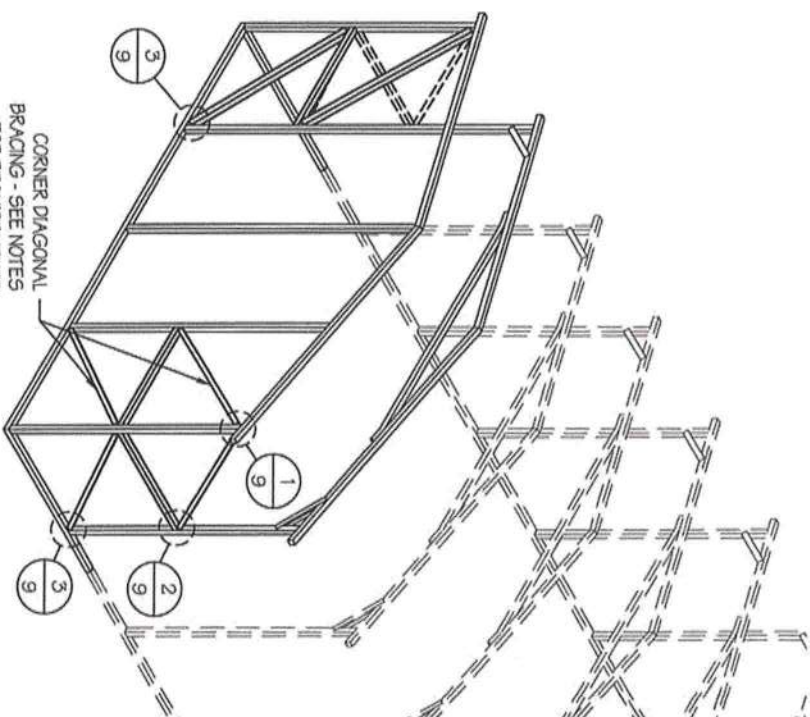

CORNER DIAGONAL
BRACING - SEE NOTES
FOR REQUIREMENTS

DIAGONAL BRACING AT CORNERS

SCALE: NTS

DIAGONAL BRACE TOP CORNER CONN. DETAIL*

SCALE: NTS

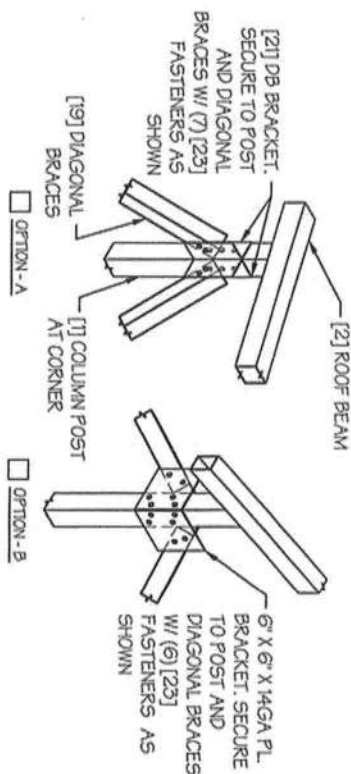

1

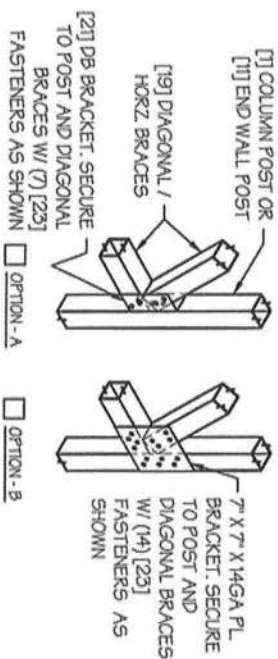

OPTION - A

OPTION - B

DIAGONAL BRACE - POST CONN. DETAIL*

SCALE: NTS

2

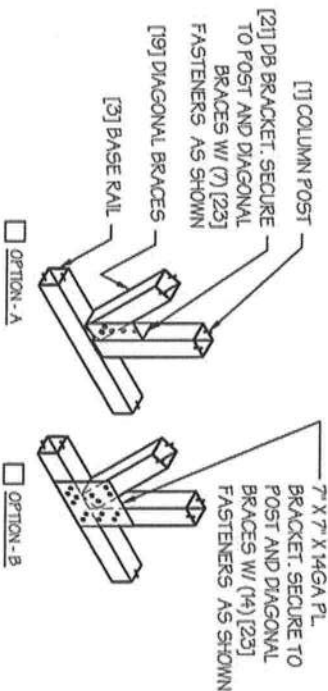

OPTION - A

OPTION - B

DIAGONAL BRACE BOT. CORNER CONN. DETAIL*

SCALE: NTS

3

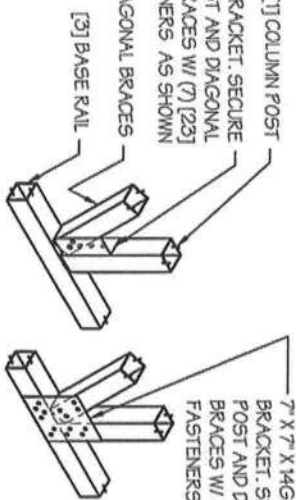

OPTION - A

OPTION - B

CORNER BRACING NOTES:

1. DIAGONAL BRACING AT BUILDING CORNERS IS REQUIRED FOR ALL BUILDINGS IN LOCATIONS WHERE WIND SPEED IS 140 MPH OR GREATER.
- FOR 3 SIDED ENCLOSED BUILDINGS, 140 MPH OR GREATER WIND SPEED
- THE BUILDING MUST BE DESIGNED WITH OPEN BUILDING SPACING AND DIAGONAL BRACING IS REQUIRED ON ALL ENCLOSED WALLS.
2. SIDE-WALL DIAGONAL BRACING IS REQUIRED WHEN THE ADJACENT END-WALL IS PARTIALLY ENCLOSED.
3. ALL BUILDINGS WITH IRREGULAR ENCLOSURE (SEE SHEET 5) WILL REQUIRE SIDE-WALL BRACING CLOSE TO THE PARTIALLY ENCLOSED END-WALL.

* INSIDE VIEW SHOWN FOR CLARITY

MANUFACTURED BY:

Martinez Carports LLC
3402 SW Cypress Lake Rd.,
Lake City, FL

ENGINEERED BY:



A&A ENGINEERING
CIVIL - STRUCTURAL
6006 Renaissance Pkwy., Toledo, OH 43623
Tel. 419-592-1583 • Fax. 419-592-0855
www.a-a-engineers.com

DRAWING INFORMATION

PROJECT: 30'-0" WIDE BUILDINGS
LOCATION: STATE OF FLORIDA
PROJECT NO.: 219-20-0922
SHEET TITLE:
OPTIONAL LEAN-TO
ADDITION

SHEET NO.: 10 / 11

DRAWN BY: A.W. DATE: 1/19/21

CHECKED BY: OAA DATE: 1/19/21

LEGAL INFORMATION

- ANY REPLICATION OF THIS DRAWING IN WHOLE OR
PART IS STRICTLY PROHIBITED. ANYONE DOING SO WILL
BE PROSECUTED UNDER THE PENALTIES OF THE LAW.
- DRAWINGS ARE VALID UP TO DATE OF EXPIRATION.

SEAL:



STAMP EXPIRY: FEB 28, 2023

DATE SIGNED: JAN 20, 2021

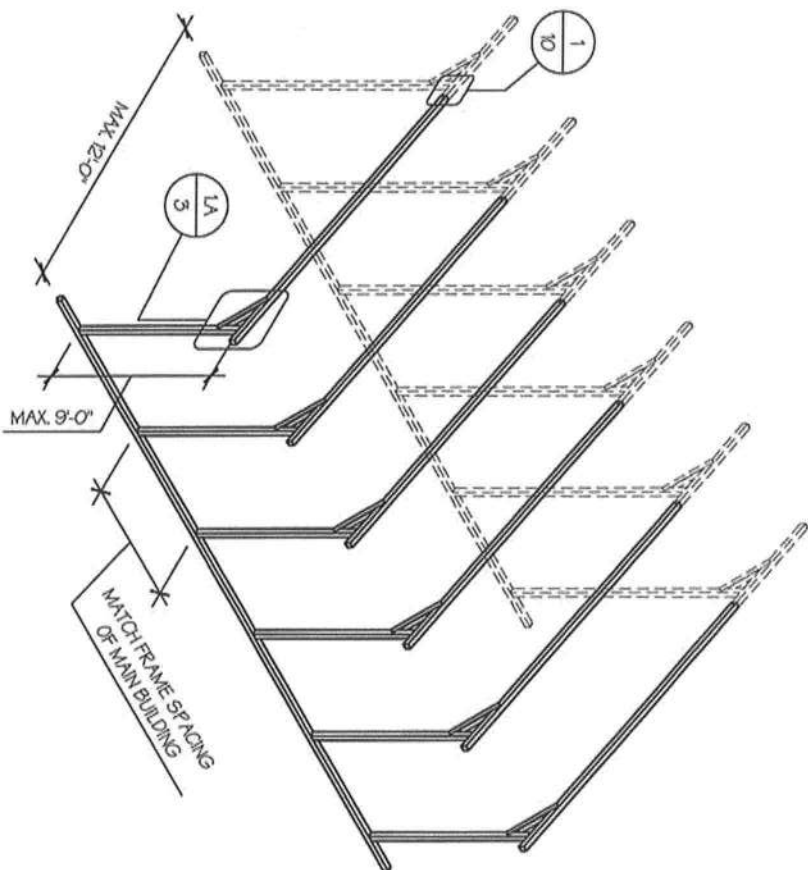

☐ OPTIONAL LEAN-TO ADDITION

SCALE: NTS

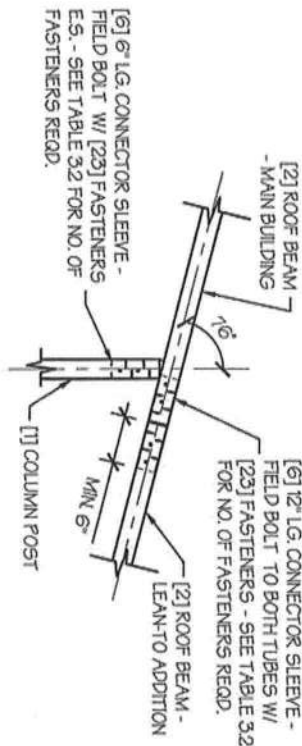

LEAN-TO ATTACHMENT DETAIL

SCALE: NTS

LEAN-TO ADDITION NOTES:

1. LEAN-TO ADDITIONS CAN BE ADDED ON EITHER OR BOTH SIDES OF THE BUILDING.
2. ROOF SLOPE, PURLIN, GIRT AND FRAME SPACING OF THE ADDITION HAVE TO MATCH THAT OF THE MAIN STRUCTURE.
3. IF THE LEAN-TO ADDITION IS "OPEN" (BOTH END WALLS OR SIDE WALL IS NOT ENCLOSED), THE DESIGN OF THE MAIN BUILDING HAS TO USE THE FRAME SPACING OF AN OPEN BUILDING FROM TABLE 4.

MANUFACTURED BY:

Martinez Carports LLC
3402 SW Cypress Lake Rd.,
Lake City, FL

ENGINEERED BY:



A&A ENGINEERING
CIVIL • STRUCTURAL
6005 Bendwood Place, Toledo, OH 43628
Tel. 419-292-1983 • Fax. 419-292-0535
www.a-a-engineers.com

DRAWING INFORMATION

PROJECT: 30'-0" WIDE BUILDINGS

LOCATION: STATE OF FLORIDA

PROJECT NO.: 219-20-0922

SHEET TITLE:

FOUNDATION OPTION 1:
CONCRETE SLAB

SHEET NO.: 11-A / 11

DRAWN BY: A.W. DATE: 1/19/21

CHECKED BY: OAA DATE: 1/19/21

LEGAL INFORMATION

- ANY REPRODUCTION OF THIS DRAWING IN WHOLE OR PART IS STRICTLY PROHIBITED. ANYONE DOING SO WILL BE PROSECUTED UNDER THE FULL EXTENT OF THE LAW.
- DRAWINGS ARE VALID UP TO DATE OF DESTRUCTION.

SEAL:

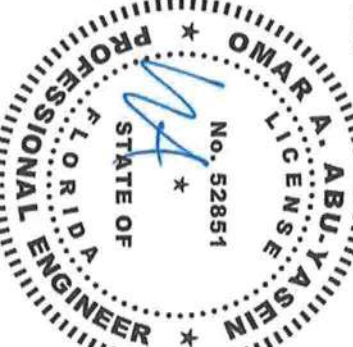

STAMP EXPIRY: FEB 28, 2023

DATE SIGNED: JAN 20, 2021

CONCRETE SLAB FOUNDATION NOTES:

- DESIGNS SHOWN ON THIS SHEET ARE FOR CONCRETE SLAB FOUNDATION. ANY OF THE FOUNDATIONS SHOWN ON SHEETS 11-A THRU D CAN BE USED.
- CONCRETE ANCHORS SHALL BE LOCATED NEXT TO EVERY POST AND ON EITHER SIDE OF OPENINGS. TWO ANCHORS SHALL BE INSTALLED AT CORNERS OF ENCLOSED BUILDINGS WITH END WALLS - ONE ON EACH BASE RAIL. IN LOCATIONS REQUIRING TWO ANCHORS DUE TO WIND, ONE ANCHOR IS TO BE ON EACH SIDE OF THE COLUMN POST.
- ANCHORS IN CLOSE PROXIMITY TO EACH OTHER MUST HAVE A MIN. 4" SPACING.
- MIN. NUMBER OF CONCRETE ANCHORS PER POST SHALL BE AS SHOWN IN TABLE 11-A.2.
- THE SIZE OF THE SLAB SHALL BE THE SIZE (WIDTH AND LENGTH) OF THE BUILDING PLUS 5" FOR 14GA MATERIAL AND 5" FOR 12GA MATERIAL.
- DEPTH OF SLAB TURN DOWN FOOTING SHALL BE GREATER THAN FROST DEPTH SPECIFIED PER LOCAL CODE.
- CONTROL JOINTS SHALL BE PLACED 50 AS TO LIMIT MAX. SLAB SPANS TO 20' IN EACH DIRECTION.
- ASSUMED SOIL BEARING CAPACITY IS TO BE A MIN. OF 1500 PSF.
- CONCRETE STRENGTH TO BE A MIN. OF 2500 PSI @ 28 DAYS.



TABLE 11-A.2: CONCRETE SLAB ANCHOR SCHEDULE

ENCLOSURE	WIND SPEED (MPH)	ANCHOR SIZE/NUMBER
ENCLOSED	105 TO 135	(1) 1/2" Ø X 7"
	136 TO 180	(2) 1/2" Ø X 7"
OPEN	105 TO 135	(1) 1/2" Ø X 7"
	136 TO 180	(2) 1/2" Ø X 7"

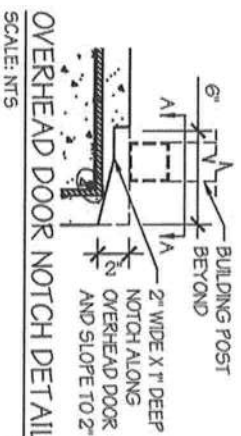

OVERHEAD DOOR NOTCH DETAIL
SCALE: NTS

TABLE 11-A.1: NOTCH WIDTH

HORIZONTAL/OPEN	VERTICAL
14GA	12GA
12GA	14GA
2 3/4"	2 7/8"
	1 3/4"
	1 7/8"

NOTE: DEPTH IS TO BE 1 1/2"

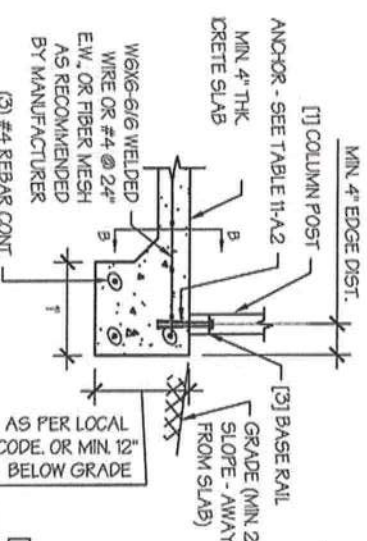

STANDARD EDGE DETAIL
SCALE: NTS

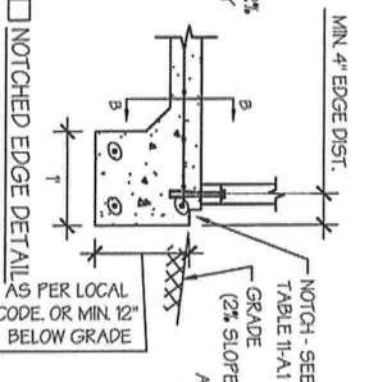

NOTCHED EDGE DETAIL
SCALE: NTS

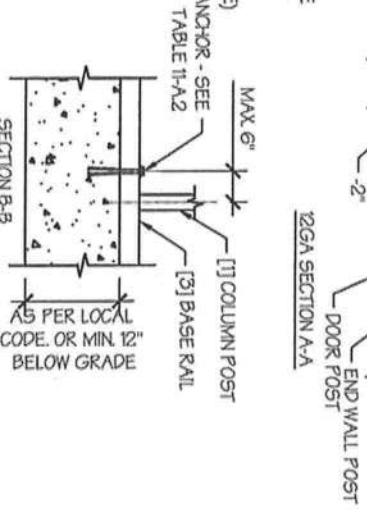

EDGE OFFSET DETAIL
SCALE: NTS

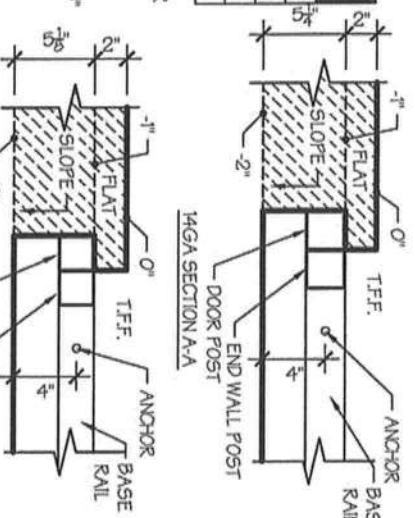

DOOR POST DETAIL
SCALE: NTS

MANUFACTURED BY:

Martinez Carports LLC
3402 SW Cypress Lake Rd.,
Lake City, FL



A&A ENGINEERING
CIVIL • STRUCTURAL
6006 Resonance Place, Toledo, OH 43623
Tel. 419-529-1583 • Fax. 419-529-0635
www.aandengineering.com

DRAWING INFORMATION

PROJECT: 30'-0" WIDE BUILDINGS

LOCATION: STATE OF FLORIDA

PROJECT NO.: 219-20-0922

SHEET TITLE:

FOUNDATION OPTION 1:
CONCRETE SLAB

SHEET NO.: 11-A / 11

DRAWN BY: A.W. DATE: 1/19/21

CHECKED BY: OAA DATE: 1/19/21

LEGAL INFORMATION

- ANY DUPLICATION OF THIS DRAWING IN WHOLE OR PART IS STRICTLY PROHIBITED AND WILL BE PROSECUTED UNDER THE FULL EXTENT OF THE LAW.
- DRAWINGS ARE VALID UP TO DATE OF DESTRUCTION.

SEAL:

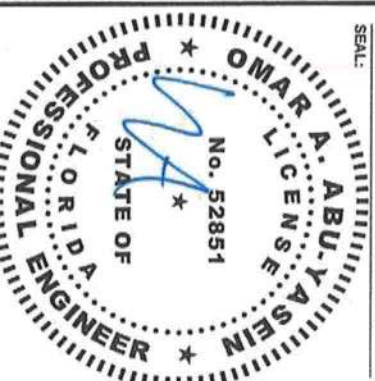

STAMP EXPIRY: FEB 28, 2023

DATE SIGNED: JAN 20, 2021

CONCRETE SLAB FOUNDATION NOTES:

- DESIGNS SHOWN ON THIS SHEET ARE FOR CONCRETE SLAB FOUNDATION. ANY OF THE FOUNDATIONS SHOWN ON SHEETS 11-A THRU C CAN BE USED.
- CONCRETE ANCHORS SHALL BE LOCATED NEXT TO EVERY POST AND ON EITHER SIDE OF OPENINGS. TWO ANCHORS SHALL BE INSTALLED AT CORNERS OF ENCLOSED BUILDINGS WITH END WALLS - ONE ON EACH BASE RAIL. IN LOCATIONS REQUIRING TWO ANCHORS DUE TO WIND, ONE ANCHOR IS TO BE ON EACH SIDE OF THE COLUMN POST. ANCHORS IN CLOSE PROXIMITY TO EACH OTHER MUST HAVE A MIN. 4" SPACING.
- MIN. NUMBER OF CONCRETE ANCHORS PER POST SHALL BE AS SHOWN IN TABLE 11-A.1.
- THE SIZE OF THE SLAB SHALL BE THE SIZE (WIDTH AND LENGTH) OF THE BUILDING PLUS 2" FOR 14GA MATERIAL AND 1" FOR 12GA MATERIAL.
- DEPTH OF SLAB TURN DOWN FOOTING SHALL BE GREATER THAN FROST DEPTH SPECIFIED PER LOCAL CODE.
- CONTROL JOINTS SHALL BE PLACED 50 AS TO LIMIT MAX. SLAB SPANS TO 20' IN EACH DIRECTION.
- ASSUMED SOIL BEARING CAPACITY IS TO BE A MIN. OF 1500 PSF.
- CONCRETE STRENGTH TO BE A MIN. OF 2500 PSI @ 28 DAYS.

CONCRETE SLAB FOUNDATION

SCALE: NTS

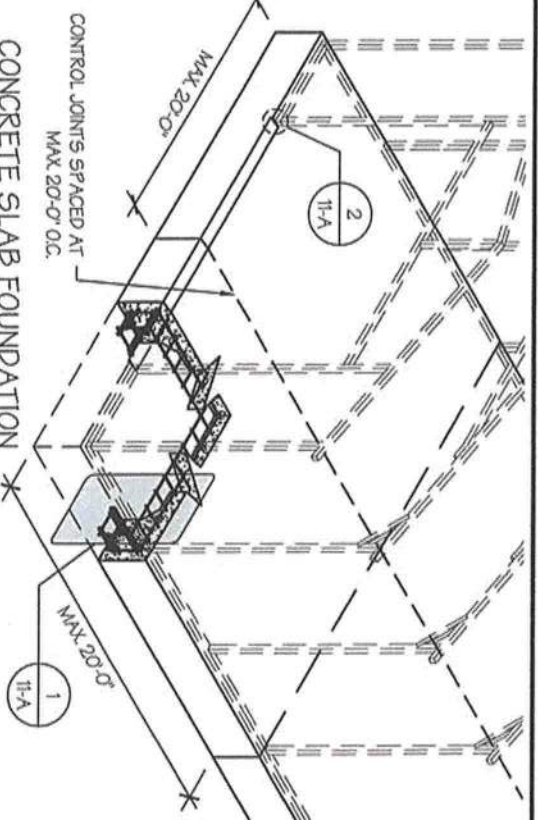
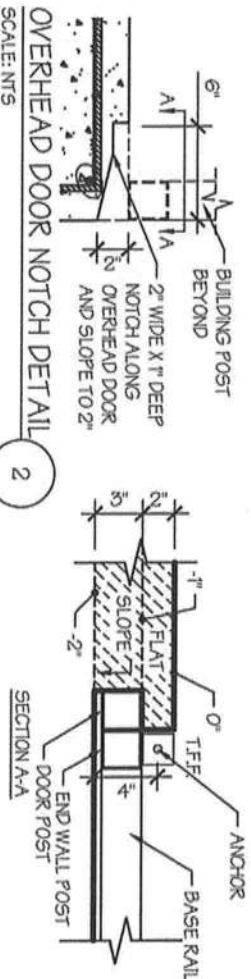

TABLE 11-A.1: CONCRETE
SLAB ANCHOR SCHEDULE

ENCLOSURE	WIND SPEED (MPH)	ANCHOR SIZE/NUMBER
ENCLOSED	105 TO 135	(1) 1/2" Ø X 7"
	136 TO 180	(2) 1/2" Ø X 7"
OPEN	105 TO 135	(1) 1/2" Ø X 7"
	136 TO 180	(2) 1/2" Ø X 7"

NOTES:

- ANCHORS ARE TO BE CONCRETE WEDGE OR EXP ANCHOR ANCHORS.
- MIN. EMBEDMENT DEPTH TO BE 2 $\frac{1}{2}$ ".
- ANCHORS TO BE SPACED NO MORE THAN 6" FROM POSTS.



OVERHEAD DOOR NOTCH DETAIL

SCALE: NTS

2

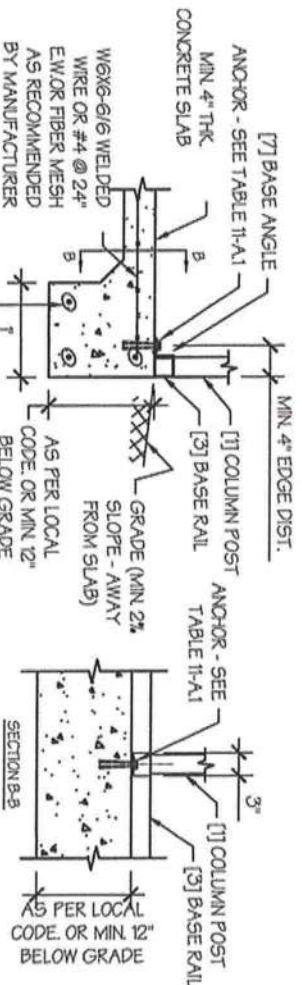

EDGE FLUSH DETAIL

SCALE: NTS

1

TABLE 11-B.1: ANCHOR SCHEDULE

ENCLOSURE	WIND SPEED (MPH)	ANCHOR SIZE/NUMBER
ENCLOSED	105 TO 135	(1) 1/2"Ø X 7"
	136 TO 180	(2) 1/2"Ø X 7"
OPEN	105 TO 135	(1) 1/2"Ø X 7"
	136 TO 180	(2) 1/2"Ø X 7"

NOTES:

1. ANCHORS ARE TO BE CONCRETE WEDGE OR EXPANSION ANCHORS.
2. MIN. EMBEDMENT DEPTH TO BE 2 $\frac{1}{2}$ ".
3. ANCHORS TO BE SPACED NO MORE THAN 6" FROM POSTS.

TABLE 11-B.2: CONC. STRIP SCHEDULE

WIND SPEED (MPH)	MIN. SIZE (MPH)
105 TO 130	3" X 12"
131 TO 155	2" X 12"
156 TO 180	2" X 15"

NOTES:

1. WIDTH AND DEPTH DIMENSIONS CAN BE INTERCHANGED.

FOOTING OPTIONAL AT OPEN
END WALLS AND OVERHEAD
DOOR OPENINGS

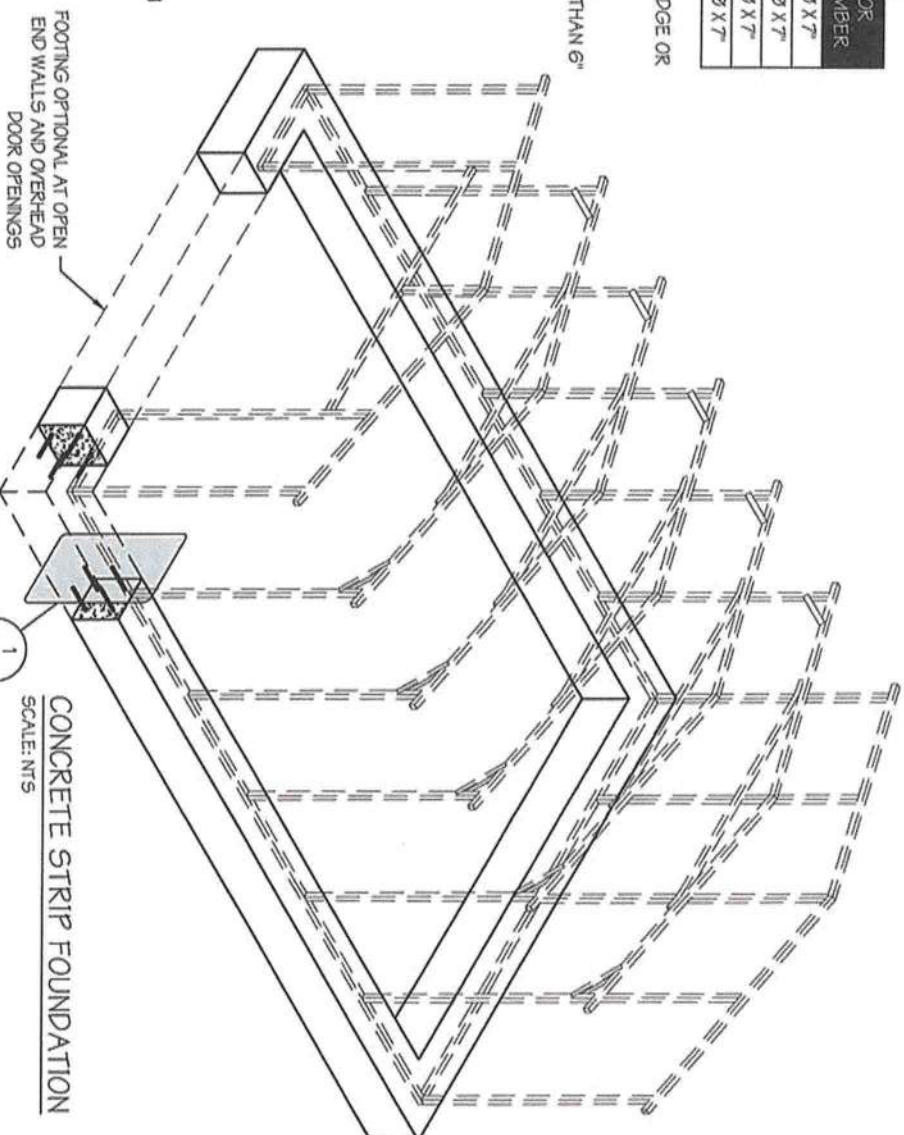

CONCRETE STRIP FOUNDATION NOTES:

1. DESIGNS SHOWN ON THIS SHEET ARE FOR CONCRETE STRIP FOUNDATION. ANY OF THE FOUNDATIONS SHOWN ON SHEETS 11-A THRU C CAN BE USED.
2. CONCRETE ANCHORS SHALL BE LOCATED NEXT TO EVERY POST AND ON EITHER SIDE OF OPENINGS. TWO ANCHORS SHALL BE INSTALLED AT CORNERS OF ENCLOSED BUILDINGS WITH END WALLS - ONE ON EACH BASE RAIL. IN LOCATIONS REQUIRING TWO ANCHORS DUE TO WIND, ONE ANCHOR IS TO BE ON EACH SIDE OF THE COLUMN POST.
3. MIN. NUMBER OF CONCRETE ANCHORS PER POST SHALL BE AS SHOWN IN TABLE 11-B.1.
4. DEPTH OF CONCRETE STRIP FOOTING SHALL BE GREATER THAN FROST DEPTH SPECIFIED PER LOCAL CODE.
5. ASSUMED SOIL BEARING CAPACITY IS TO BE A MIN. OF 1500 PSF.
6. CONCRETE STRENGTH TO BE A MIN. OF 2500 PSI @ 28 DAYS.
7. BUILDING IS TO BE MOUNTED ON THE CENTER OF THE STRIP FOUNDATION.

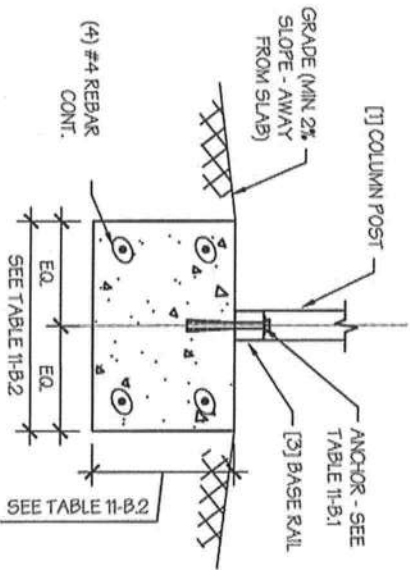

CONCRETE STRIP FOUNDATION DETAIL

SCALE: NTS

MANUFACTURED BY:

Martinez Carports LLC
3402 SW Cypress Lake Rd.,
Lake City, FL



A&A ENGINEERING
CIVIL - STRUCTURAL
6035 Resurgence Place, Toledo, OH 43623
Tel. 419.292.1883 • Fax. 419.292.4035
www.aandengineering.com

ENGINEERED BY:

DRAWING INFORMATION

PROJECT: 30'-0" WIDE BUILDINGS

LOCATION: STATE OF FLORIDA

PROJECT NO.: 219-20-0922

SHEET TITLE:

FOUNDATION OPTION 2:
CONCRETE STRIP

SHEET NO.: 11-B / 11

DRAWN BY: A.W. DATE: 1/19/21

CHECKED BY: OAA DATE: 1/19/21

LEGAL INFORMATION

- ANY DUPLICATION OF THIS DRAWING IN WHOLE OR PART IS STRICTLY FORBIDDEN. ANYONE DOING SO WILL BE PROSECUTED UNDER THE FULL PENALTIES OF THE LAW.
- DRAWINGS ARE VALID UP TO DATE OF EXPIRATION.

SEAL:



STAMP EXPIRY: FEB 28, 2023

DATE SIGNED: JAN 20, 2021

MANUFACTURED BY:

Martinez Carports LLC
3402 SW Cypress Lake Rd.,
Lake City, FL

ENGINEERED BY:



A&A ENGINEERING
CIVIL / STRUCTURAL
6036 Resurgence Place, Toledo, OH 43603
Tel. 419-292-1883 • Fax. 419-292-0535
www.a-a-engineers.com

DRAWING INFORMATION

PROJECT: 30'-0" WIDE BUILDINGS

LOCATION: STATE OF FLORIDA

PROJECT NO.: 219-20-0922

SHEET TITLE:

FOUNDATION OPTION 3:
CONCRETE PIERS

SHEET NO.: 11-C / 11

DRAWN BY: A.W. DATE: 1/19/21

CHECKED BY: OAA DATE: 1/19/21

LEGAL INFORMATION

- ANY DUPLICATION OF THIS DRAWING IN WHOLE OR
PART IS STRICTLY PROHIBITED. ANYONE DOING SO WILL
BE PROSECUTED UNDER THE FULL EXTENT OF THE LAW.
- DRAWINGS ARE VALID UP TO DATE OF EXPIRATION.

SEAL:

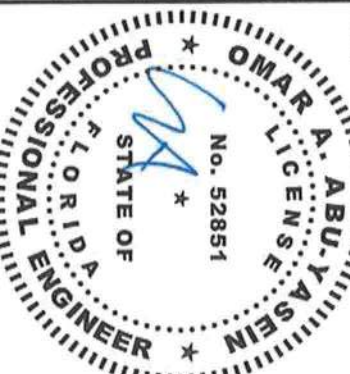

STAMP EXPIRY: FEB 28, 2023
DATE SIGNED: JAN 20, 2021

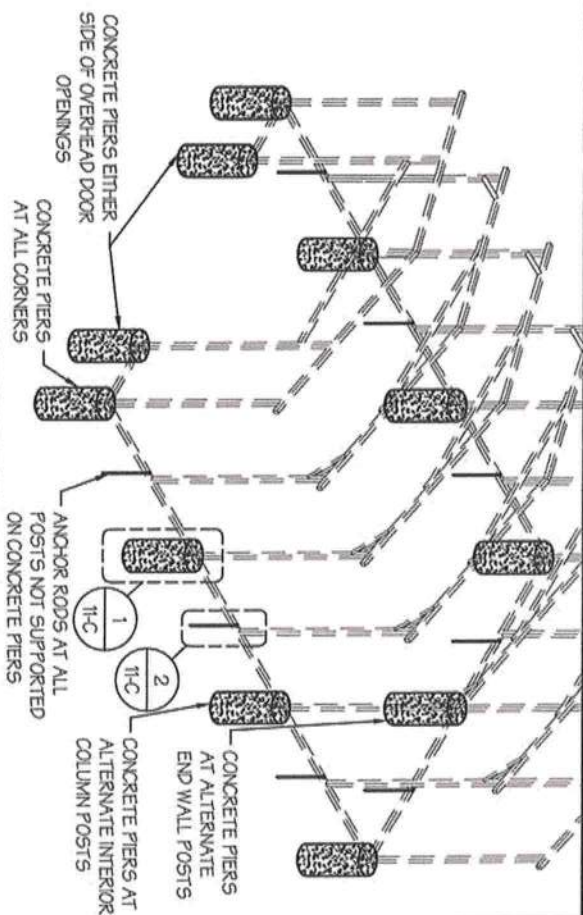

CONCRETE PIER FOUNDATION

SCALE: NTS

CONCRETE PIER FOUNDATION NOTES:

- DESIGNS SHOWN ON THIS SHEET ARE FOR CONCRETE PIER FOUNDATION. ANY OF THE FOUNDATIONS SHOWN ON SHEETS 11-A THRU C CAN BE USED.
- CONCRETE PIERS SHALL BE LOCATED AT ALL 4 CORNERS, ON EACH SIDE OF OVERHEAD DOOR OPENINGS AND ON ALTERNATE INTERIOR COLUMN POSTS AND END WALLS POSTS.
- TWO ANCHORS SHALL BE INSTALLED AT CORNERS OF ENCLOSED BUILDINGS WITH END WALLS - ONE ON EACH BASE RAIL. IN LOCATIONS REQUIRING TWO ANCHORS DUE TO WIND, ONE ANCHOR IS TO BE ON EACH SIDE OF THE COLUMN POST WITH A PIER.
- ANCHORS IN CLOSE PROXIMITY TO EACH OTHER MUST HAVE A MIN. 4" SPACING.
- MIN. NUMBER OF CONCRETE ANCHORS PER POST WITH A PIER SHALL BE AS SHOWN IN TABLE 11-A.2.
- TWO ANCHORS AND A PIER ARE REQUIRED AT DIAGONAL BRACING.
- ALL POSTS NOT SUPPORTED ON CONCRETE PIERS SHALL BE ANCHORED TO THE GROUND WITH A 1/2" X 30" LG. TREADED ROD. RODS WILL HAVE A PRE-FORMED HEAD AT THE TOP AND ONE COAT OF RUST PROOF MATERIAL.
- PIERS SHALL BE FORMED BY DIGGING A HOLE OF THE SAME SIZE AS THE PIER ON LEVEL GRADE AND FILLING IT WITH CONCRETE. THRD. ROD ANCHORS SHOULD BE DROPPED INTO THE PIERS PRIOR TO POURING THE CONCRETE.
- ASSUMED SOIL BEARING CAPACITY IS TO BE A MIN. OF 1500 PSF.
- CONCRETE STRENGTH TO BE A MIN OF 2500 PSI @ 28 DAYS.

TABLE 11-B.1: ANCHOR SCHEDULE

ENCLOSURE	WIND SPEED (MPH)	ANCHOR SIZE/NUMBER
ENCLOSED	105 TO 135	(1) 1/2" Ø X 7"
	136 TO 160	(2) 1/2" Ø X 7"
OPEN	105 TO 135	(1) 1/2" Ø X 7"
	136 TO 160	(2) 1/2" Ø X 7"

- NOTES:
- ANCHORS ARE TO BE CONCRETE WEDGE OR EXPANSION ANCHORS.
 - MIN. EMBEDMENT DEPTH TO BE 25".
 - ANCHORS TO BE SPACED NO MORE THAN 6" FROM POSTS.

CONCRETE PIER DETAIL

SCALE: NTS

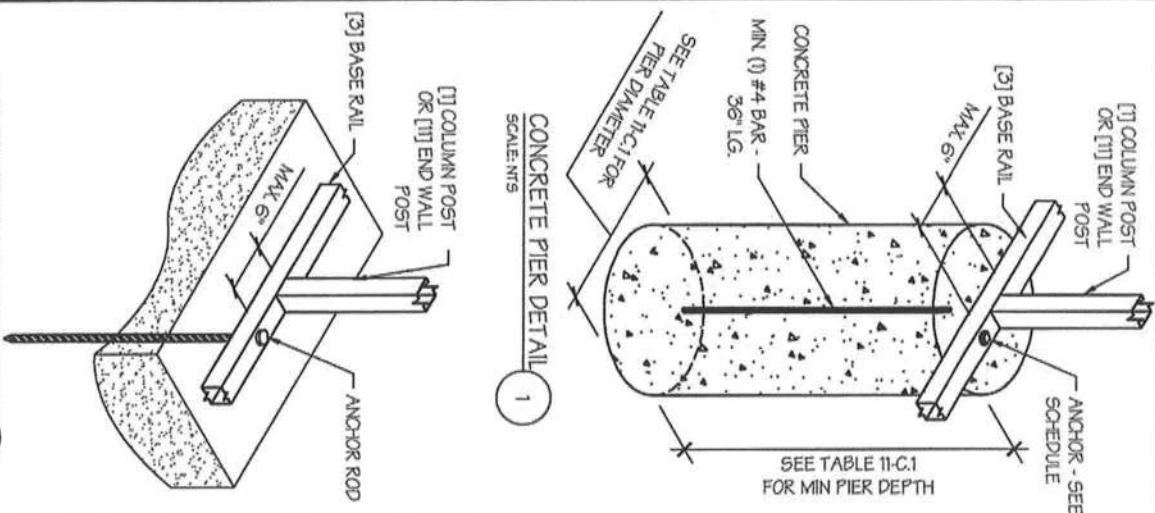

ANCHOR ROD INTO SOIL DETAIL

SCALE: NTS

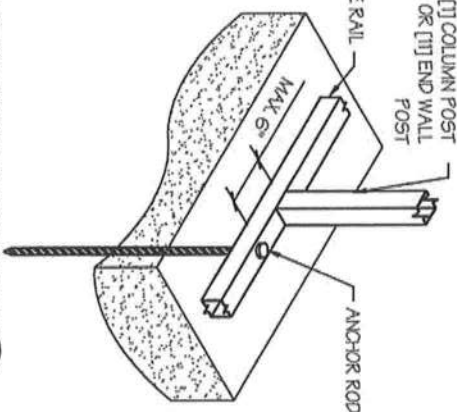

TABLE 11-C.1: CONC. PIER SCHEDULE

WIND SPEED (MPH)	MIN. SIZE REOD.
105 TO 130	24" Ø X 36"
140 TO 155	24" Ø X 42"
165 TO 180	24" Ø X 48"

Martinez Carports LLC
3402 SW Cypress Lake Rd.,
Lake City, FL

ENGINEERED BY:



A&A ENGINEERING
CIVIL - STRUCTURAL
6035 Bendwood Place, Tallahassee, FL 32303
TEL: 904-292-1983 • FAX: 904-292-0633
WWW.AA-ENGINEERING.COM

DRAWING INFORMATION

PROJECT: 30'-0" WIDE BUILDINGS

LOCATION: STATE OF FLORIDA

PROJECT NO.: 219-20-0922

SHEET TITLE:

FOUNDATION OPTION 4:
SOIL ANCHORS

SHEET NO.: 11-D / 11

DRAWN BY: A.W. DATE: 1/19/21

CHECKED BY: OAA DATE: 1/19/21

LEGAL INFORMATION

- ANY DUPLICATION OF THIS DRAWING IN WHOLE OR PART IS STRICTLY FORBIDDEN. ANYONE DOING SO WILL BE PROSECUTED UNDER THE FULL EXTENT OF THE LAW.
- DRAWINGS ARE VOID UP TO DATE OF DEVIATION.

SEAL:



STAMP EXPIRY: FEB 28, 2023

DATE SIGNED: JAN 20, 2021

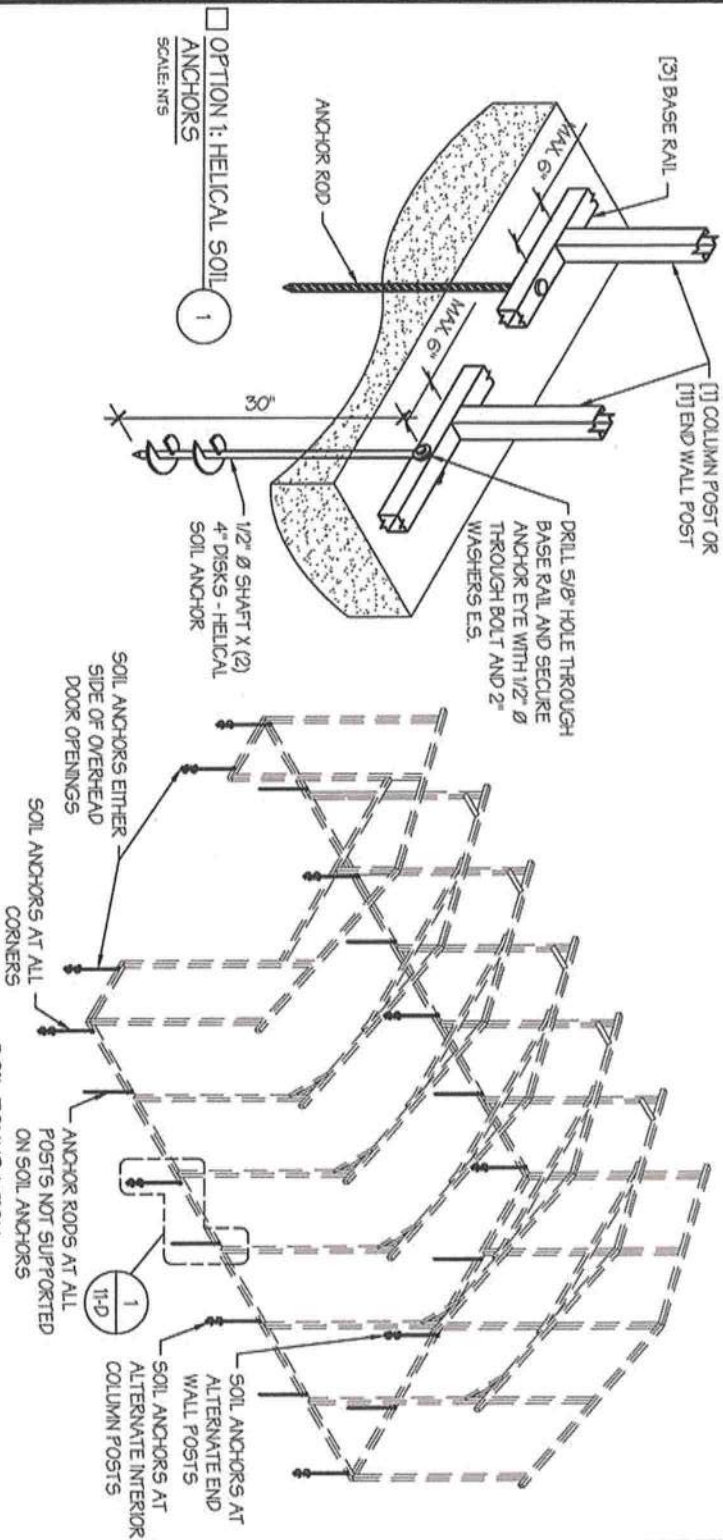

☐ **OPTION 1: HELICAL SOIL ANCHORS**
SCALE: NTS

SOIL FOUNDATION NOTES:

- DESIGNS SHOWN ON THIS SHEET ARE FOR SOIL ANCHOR FOUNDATION.
- SOIL ANCHORS (HELICAL OR ROCK/ASPHALT) SHALL BE LOCATED AT ALL 4 CORNERS, ON EACH SIDE OF OVERHEAD DOOR OPENINGS, ON POSTS WITH DIAGONAL BRACING IF REQUIRED, AND ON ALTERNATE INTERIOR COLUMN POSTS AND END WALLS POSTS.
- HELICAL ANCHORS ARE TO BE USED ONLY IF THE DRIVING TORQUE INTO THE GROUND IS 150 FT-LBS OR GREATER. MANUFACTURER IS NOT RESPONSIBLE FOR SOIL QUALITY AT SITE.
- HELICAL ANCHORS CAN ONLY BE USED FOR CLASS 2, 3 & 4 SOILS (SEE SOIL CLASSIFICATIONS THIS PAGE).
- ALL POSTS WITH NO ANCHORS ADJACENT SHALL BE ANCHORED TO THE GROUND WITH A 1/2" X 30" LG. ROD. RODS WILL HAVE A PRE-FORMED HEAD AT THE TOP AND ONE COAT OF RUST PROOF MATERIAL.
- ASSUMED SOIL BEARING CAPACITY IS TO BE A MIN. OF 1500 PSF.

SOIL CLASSIFICATIONS:

- | SOIL CLASS | DESCRIPTION |
|------------|---|
| 2 | SANDY GRAVEL AND GRAVEL, VERY THIN DENSE AND/OR CEMENTED SANDS, COARSE GRAVEL/CORBBLES, PRELOADED SILTS, CLAYS AND CORAL. |
| 3 | SAND, SILTY SAND, CLAYEY SAND, SILTY GRAVEL, MEDIUM DENSE COARSE SANDS, SANDY GRAVEL, VERY STIFF SILT AND SANDY CLAYS. |
| 4 | LOOSE TO MEDIUM DENSE SANDS, FIRM TO STIFF CLAYS AND SILTS AND ALLUVIAL FILLS. |

*FROM HUD "MODEL MANUFACTURED HOME INSTALLATION STANDARDS"

☐ **OPTION 2: ROCK / ASPHALT ANCHORS**
SCALE: NTS

