

ANCHOR TABLE
OBTAIN UPLIFT REQUIREMENTS FROM TRUSS MANUFACTURER'S ENGINEERING

TRUSS CONNECTOR	UPLIFT SYP	UPLIFT SPF	F1 SYP	F2 SYP	F1 SPF	F2 SPF	TO RAFTER/TRUSS	TO PLATES
H5	455	265	115	200	100	170	4-8d x 1 1/2"	4-8d x 1 1/2"
H3	415	290	125	160	105	140	4-8d x 1 1/2"	4-8d x 1 1/2"
H2.5	415	365	150	150	130	130	5-8d x 1 1/2"	5-8d x 1 1/2"
H2.5A	480	480	110	110	110	110	5-8d x 1 1/2"	5-8d x 1 1/2"
H6	950	820					8-8d	8-8d
H8	745	565					5-10d x 1 1/2"	5-10d x 1 1/2"
H14-1	1465	1050	515	265	480	245	12-8d x 1 1/2"	13-8d
H14-2	1465	1050	515	265	480	245	12-8d x 1 1/2"	15-8d
H10	990	850	585	525	505	450	8-8d x 1 1/2"	8-8d x 1 1/2"
H10-2	760	655	455	395	390	340	6-10d	6-10d
H16	1470	1265					2-10d x 1 1/2"	10-10d x 1 1/2"
H16-2	1470	1265					2-10d x 1 1/2"	10-10d x 1 1/2"
LTS12 - LTS20	1000	620					6-10d x 1 1/2"	6-10d x 1 1/2"
MTS12 - MTS30	1000	860					7-10d x 1 1/2"	7-10d x 1 1/2"
HTS16 - HTS30	1450	1245					12-10d x 1 1/2"	12-10d x 1 1/2"

HEAVY GIRDER TIEDOWNS

							TO FOUNDATION
LG72	2050	1785	700	170	700	170	14-16d
LG73-SDS2.5	3685	2655	795	410	795	410	12-SDS 1/4" x 2 1/2"
LG74-SDS3	4060	3660	2000	675	2000	675	12-SDS 1/4" x 3"
MG7	3965	3330					22-10d
HGT-2	10980	6485					16-10d
HGT-3	10530	9035					16-10d
HGT-4	9250	9250					16-10d

STUD STRAP CONNECTOR

							TO STUDS
SSP DOUBLE TOP PLATE	435	435					3-10d
SSP SINGLE SILL PLATE	455	420					1-10d
DSP DOUBLE TOP PLATE	825	825					6-10d
DSP SINGLE SILL PLATE	825	690					2-10d
SP1	585	535					4-10d
SP2	1065	605					6-10d
SP4	885	790					6-10d x 1 1/2"
SPH4	1240	1065					10-10d x 1 1/2"
SP6	885	790					6-10d x 1 1/2"
SPH6	1240	1065					10-10d x 1 1/2"
LSTA18	1235	1110					14-10d
LSTA21	1235	1235					16-10d
CS20	1030	1030					14-10d
CS16	1705	1705					22-10d

STUD ANCHORS

							TO STUDS	TO FOUNDATION
LTT19	1350	1305					8-16d	1/2" ANCHOR
LTT131	2310	2310					18-10d x 1 1/2"	5/8" ANCHOR
HD2A	2775	2570					2-5/8" BOLTS	5/8" ANCHOR
HTT16	4175	3695					18-16d	5/8" ANCHOR
HTT22	5280	5250					32-16d	5/8" ANCHOR
ABU44	2200	2200					12-16d	5/8" ANCHOR
ABU66	2300	2300					12-16d	5/8" ANCHOR
ABU88	2320	2320					18-16d	2-5/8" ANCHOR

(1) w/ INSTALLATION OF 4-16dS OPTIONAL NAIL HOLDS
(2) FOR SYP GIRDER & SPF STUDS

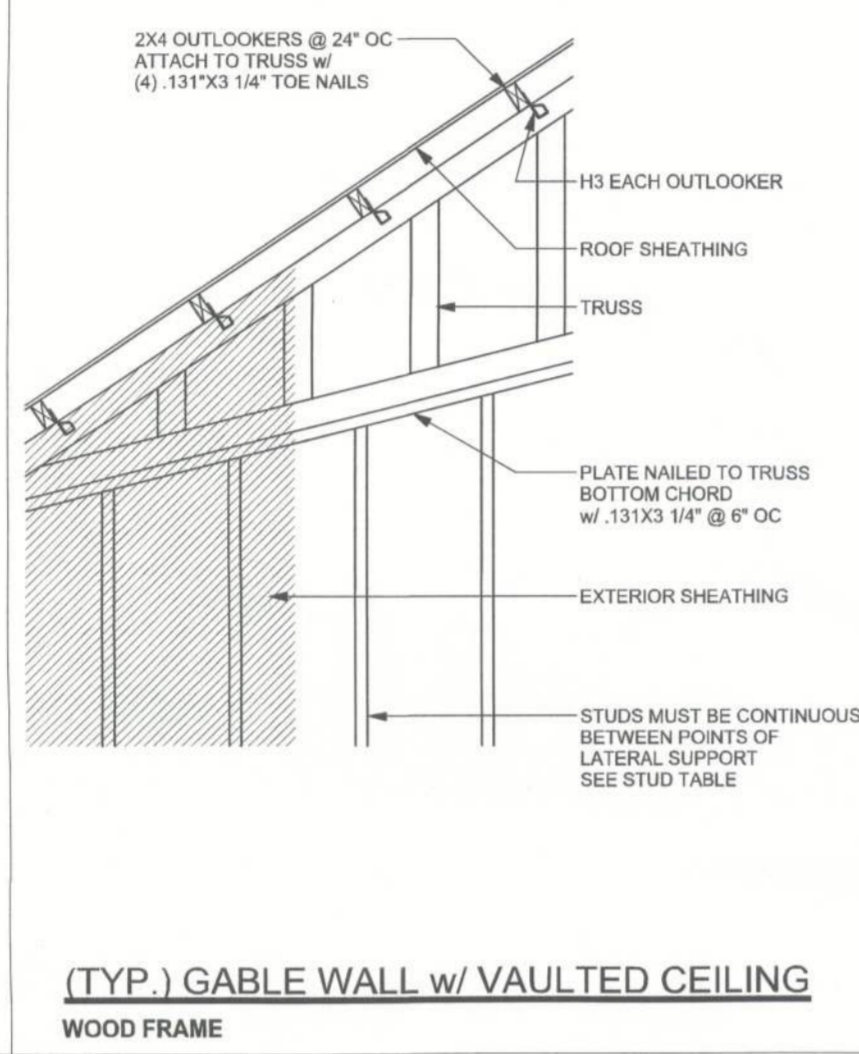
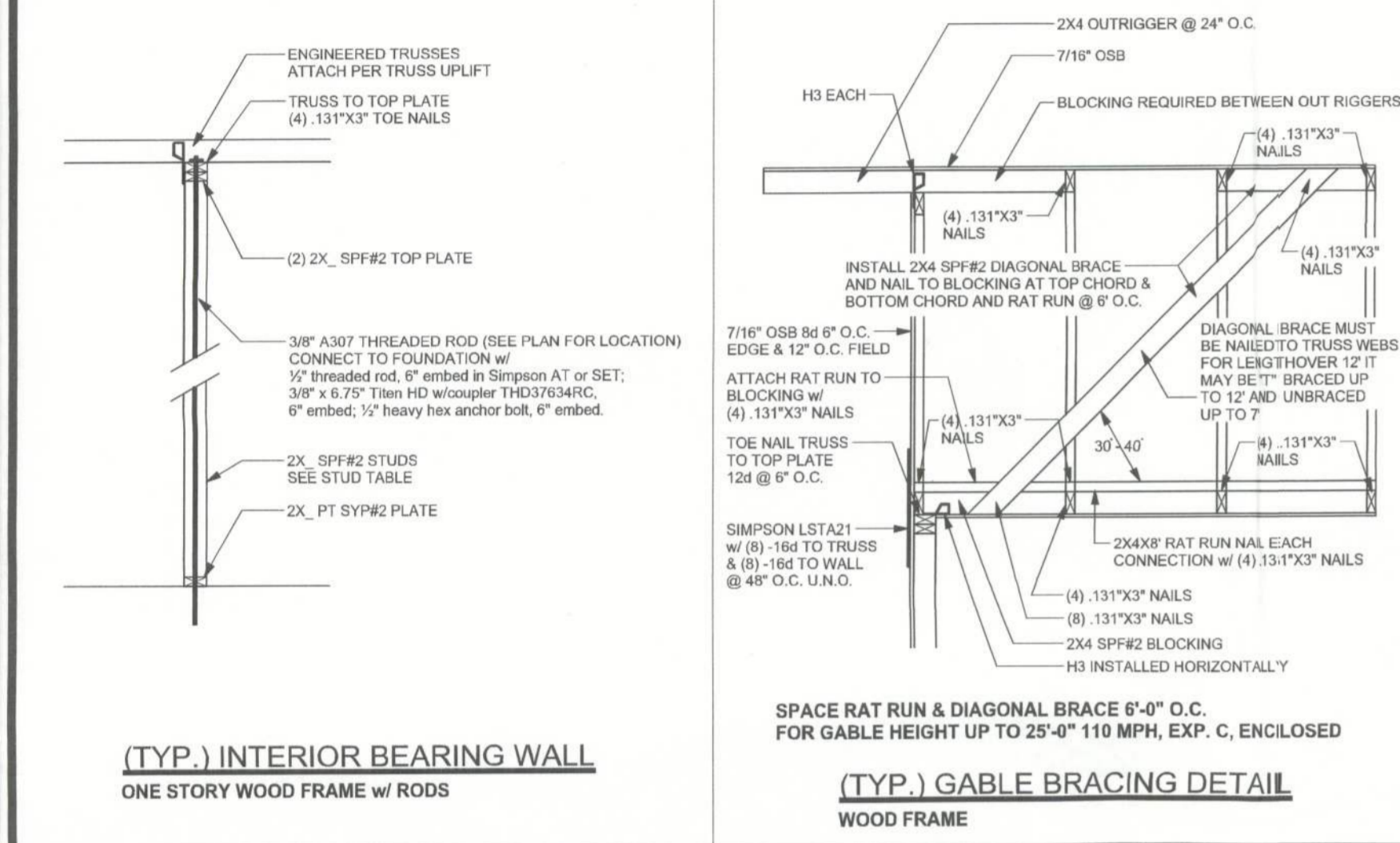

(1) w/ INSTALLATION OF 4-16dS OPTIONAL NAIL HOLDS
(2) FOR SYP GIRDER & SPF STUDS

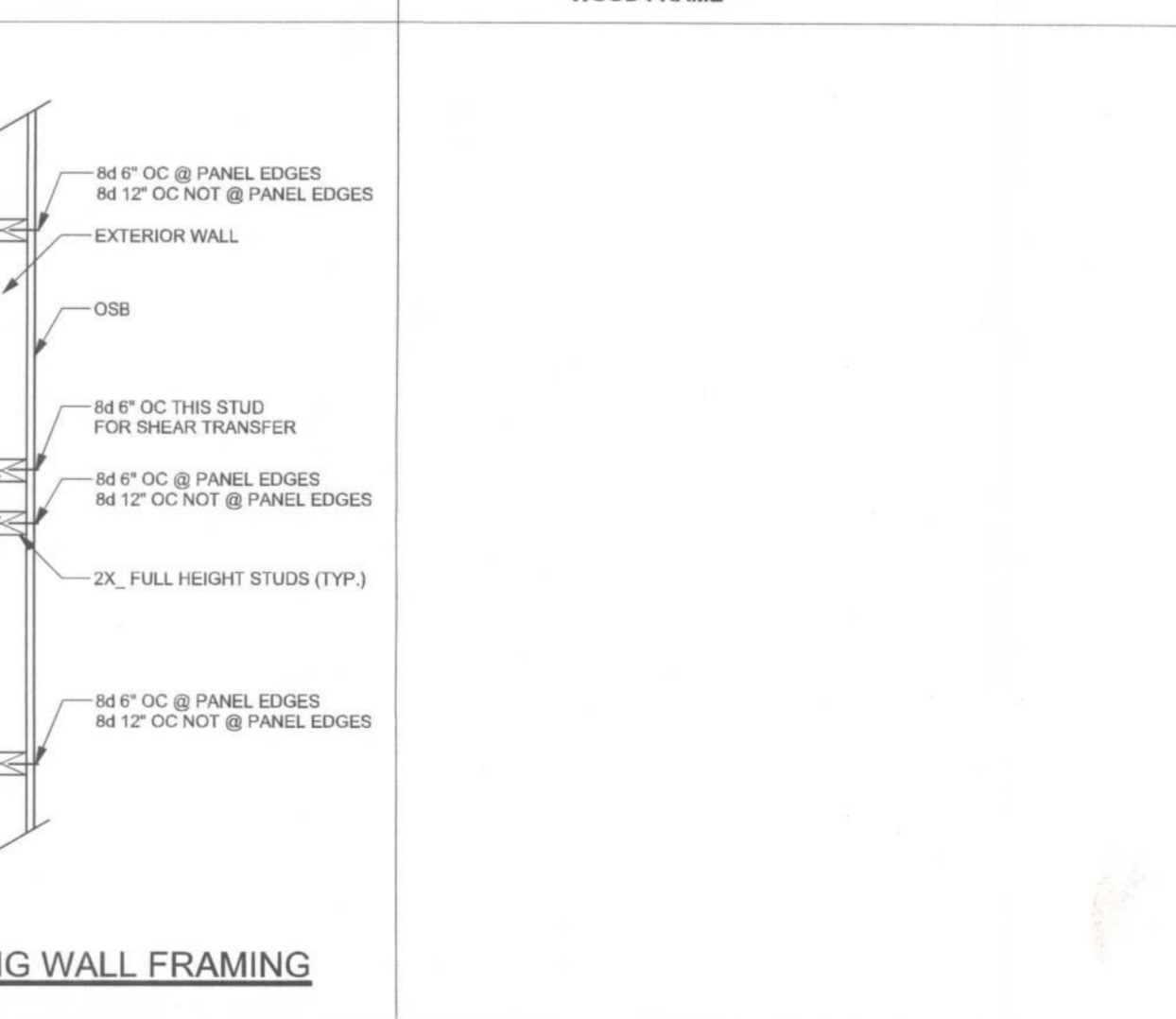
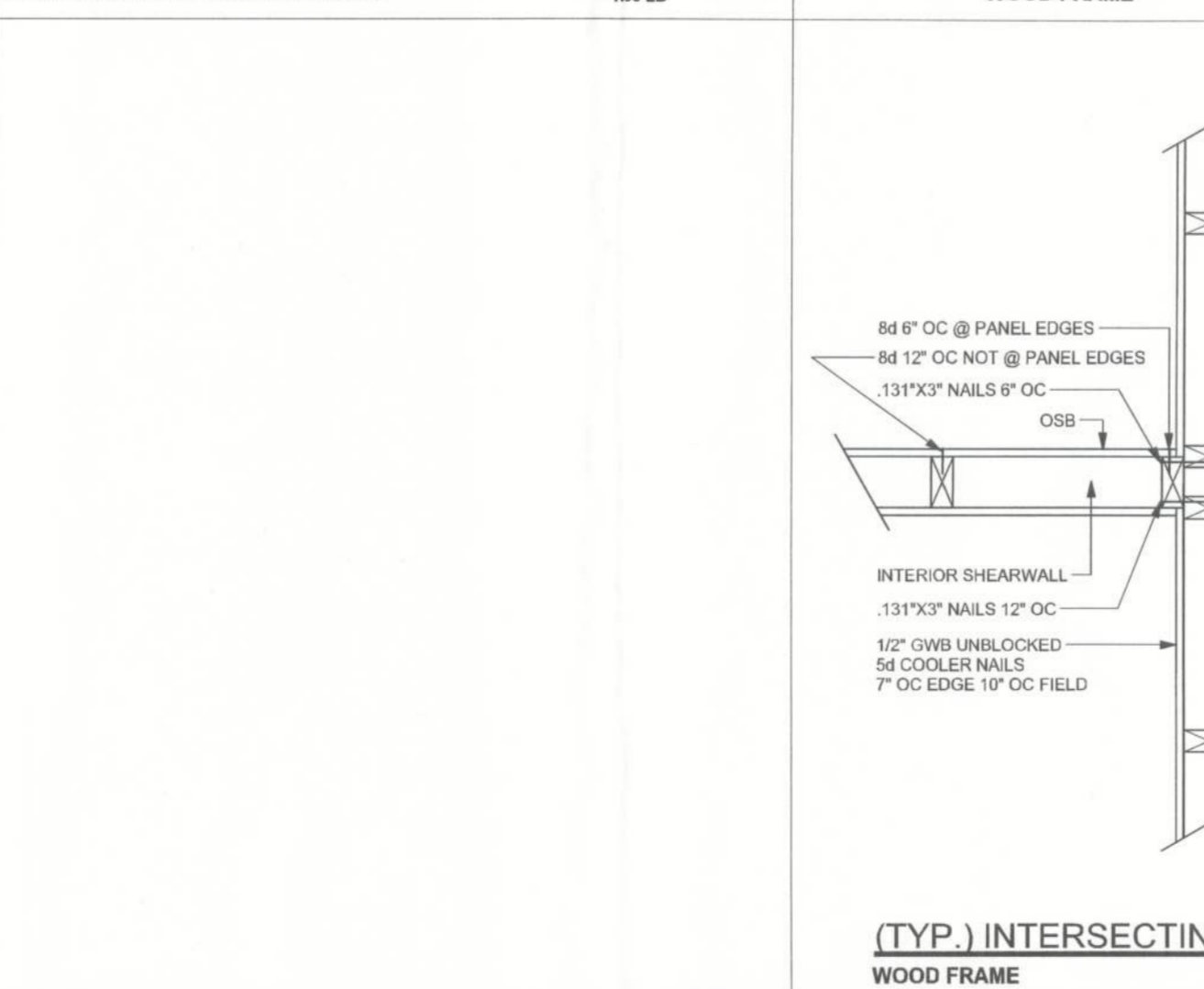
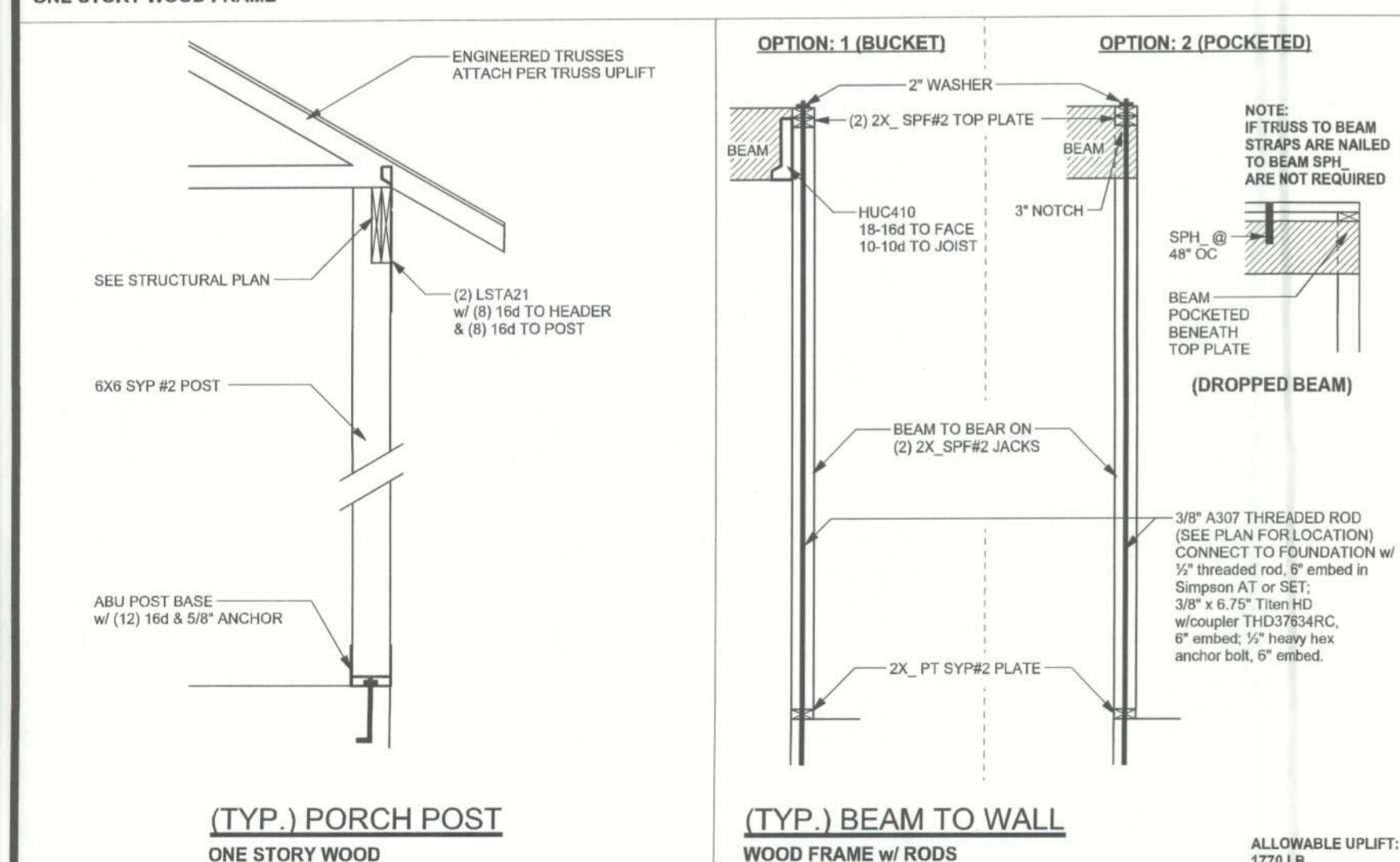
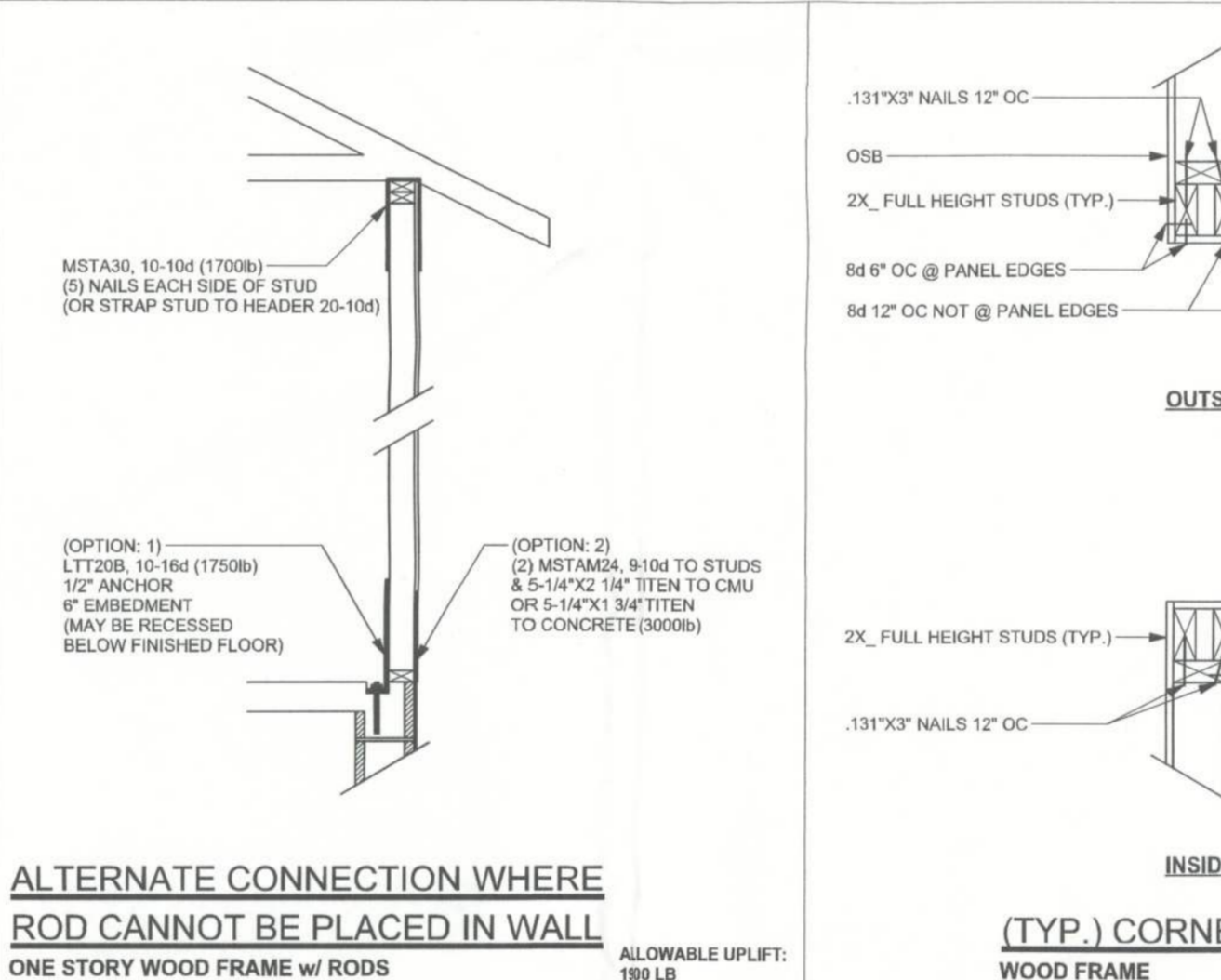
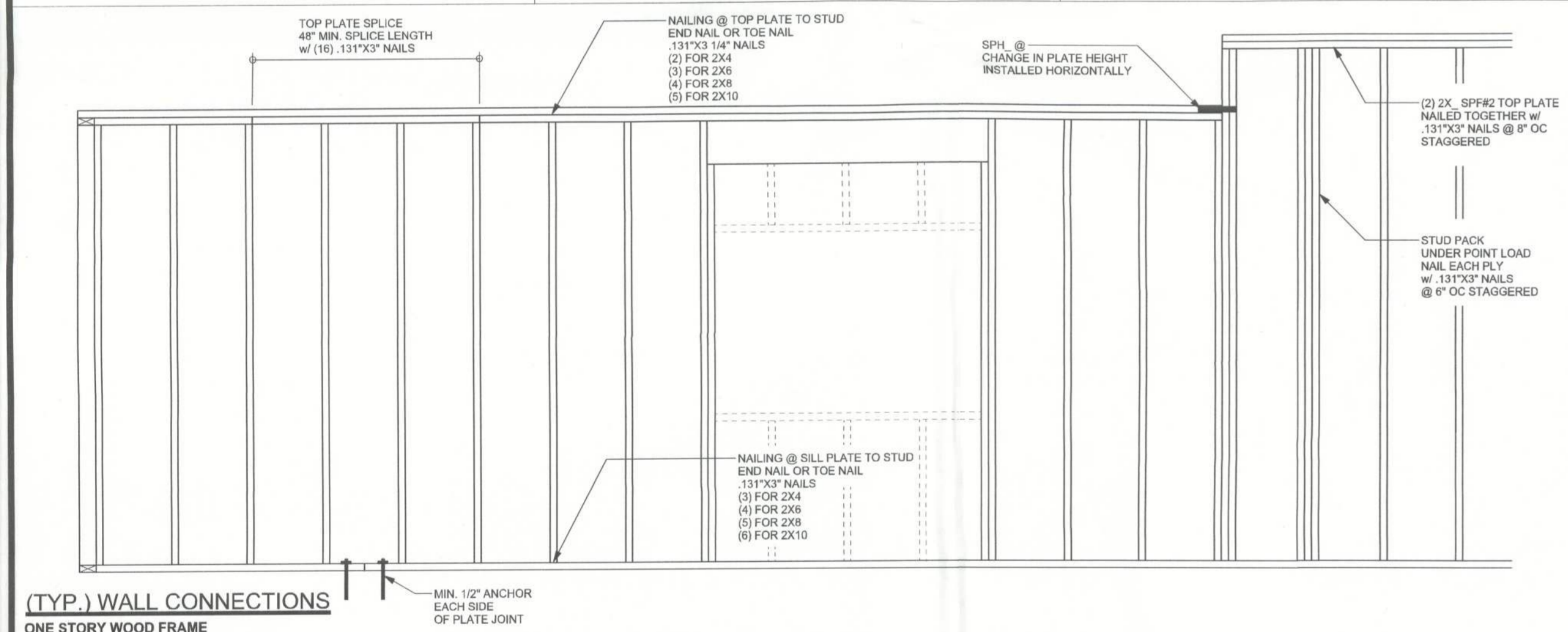

EXTERIOR WALL STUD TABLE FOR SPF #2 STUDS

(1) 2x4 @ 16" OC	TO 10'-1" STUD HEIGHT
(1) 2x4 @ 12" OC	TO 11'-2" STUD HEIGHT
(1) 2x6 @ 16" OC	TO 15'-7" STUD HEIGHT
(1) 2x6 @ 12" OC	TO 17'-3" STUD HEIGHT

THIS STUD HEIGHT TABLE IS PER 2012 WFCM, TABLE 3.20B4, EXTERIOR LOAD BEARING & NON LOAD BEARING STUD LENGTHS FOR WALLS WITH OSB EXTERIOR AND 1/2" SYP INTERIOR RESISTING INTERIOR ZONE WINDLOADS, 130 MPH EXPOSURE C, STUD DEFLECTION LIMIT H/400 NOT OK FOR SOME BRITTLE FINISH). STUD SPACINGS SHALL BE MULTIPLIED BY 0.8 FOR FRAMING LOCATED WITHIN 4 FEET OF CORNERS FOR END ZONE LOADING. (END ZONE EXAMPLE: 16" O.C. x 0.8 = 12.8" O.C.)

GRADE & SPECIES TABLE

		Fb (psi)	E (10 ⁶ psi)
2x8	SYP #2	1200	1.6
2x10	SYP #2	1050	1.6
2x12	SYP #2	975	1.6
GLB	24F-V3 SP	2400	1.8
LSL	TIMBERSTRAND	1700	1.7
LVL	MICROLAM	2900	2.0
PSL	PARALAM	2900	2.0

GENERAL NOTES:

TRUSSES: TRUSSES SHALL BE DESIGNED BY A FLORIDA LICENSED ENGINEER IN ACCORDANCE WITH THE 2010 FBCR. TRUSS ENGINEERING SHALL INCLUDE TRUSS DESIGN, PLACEMENT PLANS, TEMPORARY AND PERMANENT BRACING DETAILS, TRUSS-TO-TRUSS CONNECTIONS, AND UPLIFT AND REACTION LOADS FOR ALL BEARING LOCATIONS. TRUSS ENGINEERING IS THE RESPONSIBILITY OF THE TRUSS MANUFACTURER AND SHALL BE SIGNED & SEALED BY THE MANUFACTURER'S DESIGN ENGINEER. IT IS THE BUILDER'S RESPONSIBILITY TO VERIFY THE TRUSS DESIGNER'S FULLY SATISFIED ALL THE ABOVE REQUIREMENTS AND TO SELECT UPLIFT CONNECTIONS BASED ON TRUSS ENGINEERING UPLIFT AND PROVIDE FOOTINGS FOR INTERIOR BEARING WALLS. BUILDER IS TO FURNISH TRUSS ENGINEERING TO WIND LOAD ENGINEER FOR REVIEW OF TRUSS REACTIONS ON THE BUILDING STRUCTURE. STRAP 2X6 RAFTERS WITH MIN UPLIFT CONNECTION 415LB EACH END; 2X8 RAFTERS 70LB EACH END.

SITE PREPARATION: SITE ANALYSIS AND PREPARATION IS NOT PART OF THIS PLAN. FOUNDATION: CONFIRM THAT THE FOUNDATION DESIGN & SITE CONDITIONS MEET GRAVITY LOAD REQUIREMENTS (ASSUME 1000 PSF BEARING CAPACITY UNLESS VISUAL OBSERVATION OF SOILS TEST PROVES OTHERWISE).

CONCRETE: MINIMUM COMPRESSIVE STRENGTH OF CONCRETE AT 28 DAYS, $f'_c = 3000$ PSI.

WELDED WIRE REINFORCED SLAB: 6" x 6" W14 x W14, Fy = 85KSI, WELDED WIRE REINFORCEMENT FABRIC (W.W.R.) CONFORMING TO ASTM A185, LOCATED IN MIDDLE OF THE SLAB, SUPPORTED WITH APPROVED MATERIALS OR SUPPORTS AT SPACINGS NOT TO EXCEED 3'.

FIBER CONCRETE SLAB: CONCRETE SLABS ON GROUND CONTAINING SYNTHETIC FIBER REINFORCEMENT, FIBER LENGTH 1/2" TO 1" INCHES, DOSAGE AMOUNTS FROM 0.75 TO 1.5 POUNDS PER CUBIC YARD PER THE MANUFACTURER'S RECOMMENDATIONS. TRUSS MANUFACTURER SHALL BE SIGNED & SEALED BY THE MANUFACTURER'S DESIGN ENGINEER. IT IS THE BUILDER'S RESPONSIBILITY TO VERIFY THE TRUSS DESIGNER'S FULLY SATISFIED ALL THE ABOVE REQUIREMENTS AND TO SELECT UPLIFT CONNECTIONS BASED ON TRUSS ENGINEERING UPLIFT AND PROVIDE FOOTINGS FOR INTERIOR BEARING WALLS. BUILDER IS TO FURNISH TRUSS ENGINEERING TO WIND LOAD ENGINEER FOR REVIEW OF TRUSS REACTIONS ON THE BUILDING STRUCTURE. STRAP 2X6 RAFTERS WITH MIN UPLIFT CONNECTION 415LB EACH END; 2X8 RAFTERS 70LB EACH END.

CONTROL JOINTS: WHERE SPECIFIED, SAWN CONTROL JOINTS IN SLAB-ON-GRADE SHALL BE CUT IN ACCORDANCE WITH ACI 302. JOINTS SHALL BE CUT WITHIN 12 HOURS OF SLAB PLACEMENT. THE LENGTH/WIDTH RATIO OF SLAB AREAS SHALL NOT EXCEED 1.5 AND TYPICAL SPACING OF CUTS TO BE 12FT. DO NOT CUT W/W OR REINFORCING STEEL. (RECOMMENDED LOCATION OF CONTROL JOINTS IS SUBJECT TO OWNER AND CONTRACTOR'S APPROVAL. THE CONTROL JOINTS ARE NOT INTENDED TO PREVENT CRACKS BUT RATHER TO ENCOURAGE THE SLAB TO CRACK ON A GIVEN LINE.)

REBAR: ASTM A615, GRADE 60, DEFORMED BARS, Fy = 60 KSI. ALL LAP SPICES 40" DB (25" FOR #5 BARS). UNO. ALL REINFORCEMENT SHALL BE DETAILED AND PLACED IN ACCORDANCE WITH ACI 318-08, UNO.

GLULAM BEAMS: GLB, 24F-V3SP, Fb = 2400, E = 1800000 UNO. SUPPLIER MAY SUPPLY AN ALTERNATE BEAM WITH EQUAL PROPERTIES OR MAY SUBMIT THEIR OWN SIZING CALC.

ROOF SHEATHING: ALL ROOFS ARE HORIZONTAL DIAPHRAGMS; 7/16" OSB SHEATHING, UNLOCKED, APPLIED PERPENDICULAR TO FRAMING, OVER A MINIMUM OF 3 FRAMING MEMBERS, WITH PANEL EDGES STAGGERED, FASTENED WITH 8d COMMON NAILS (131), 6" OC PANEL EDGES, 12" OC INTERMEDIATE MEMBERS, GABLE ENDS AND DIAPHRAGM BOUNDARY, 4" OC, UNO.

STRUCTURAL CONNECTORS: MANUFACTURERS AND PRODUCT NUMBER FOR CONNECTORS, ANCHORS, AND REINFORCEMENT ARE LISTED FOR EXAMPLE NOT ENDORSEMENT. AN EQUIVALENT DEVICE OF THE SAME OR OTHER MANUFACTURER CAN BE SUBSTITUTED FOR ANY DEVICES LISTED IN THE EXAMPLE TABLES AS LONG AS IT MEETS THE REQUIRED LOAD CAPACITIES. MANUFACTURER'S INSTALLATION INSTRUCTIONS MUST BE FOLLOWED TO ACHIEVE RATED LOADS.

ANCHOR BOLTS: A-307 ANCHOR BOLTS WITH MINIMUM EMBEDMENT AS SPECIFIED IN DRAWINGS BUT NO LESS THAN 7" IN CONCRETE OR REINFORCED CONCRETE BEAM OR 15" IN GROUTED CMU.

WASHERS: WASHERS USED WITH 1/2" BOLTS TO BE 2" x 2" x 9/64"; WITH 5/8" BOLTS TO BE 3" x 3" x 9/64"; WITH 3/4" BOLTS TO BE 2" x 2" x 5/16" UNO.

NAILS: ALL NAILS ARE COMMON NAILS UNLESS OTHERWISE SPECIFIED OR ACCEPTED BY FBC TEST REPORTS AS HAVING EQUAL STRUCTURAL VALUES.

BUILDER'S RESPONSIBILITY

THE BUILDER AND OWNER ARE RESPONSIBLE FOR THE FOLLOWING, WHICH ARE SPECIFICALLY NOT PART OF THE WIND LOAD ENGINEER'S SCOPE OF WORK.

CONFIRM SITE CONDITIONS: FOUNDATION BEARING CAPACITY, GRADE AND BACKFILL HEIGHT, WIND SPEED AND DEBRIS ZONE, AND FLOOD ZONE.

PROVIDE MATERIALS AND CONSTRUCTION TECHNIQUES, WHICH COMPLY WITH 2010 FBCR REQUIREMENTS FOR THE STATED WIND VELOCITY AND DESIGN PRESSURES.

VERIFY THE TRUSS MANUFACTURER'S SEALED ENGINEERING INCLUDES TRUSS DESIGN, PLACEMENT PLANS, TEMPORARY AND PERMANENT BRACING DETAILS, TRUSS-TO-TRUSS CONNECTIONS, AND UPLIFT AND REACTION LOADS FOR ALL BEARING LOCATIONS.

ROOF SYSTEM DESIGN

THE SEAL ON THESE PLANS FOR COMPLIANCE WITH 2010 FBCR, SECTION R301.2.1 IS BASED ON REACTIONS, UPLIFTS, AND BEARING LOCATIONS IN TRUSS ENGINEERING SUBMITTED TO THE WIND LOAD ENGINEER. IT IS THE RESPONSIBILITY OF THE BUILDER TO CHECK ALL DETAILS OF THE COMPLETE ROOF SYSTEM DESIGN SUBMITTED BY THE TRUSS MANUFACTURER AND HAVE IT SIGNED AND SEALED BY A DESIGN PROFESSIONAL FOR CORRECT APPLICATION OF 2010 FBCR REQUIRED LOADS AND ANY SPECIAL LOADS. THE BUILDER IS RESPONSIBLE TO REVIEW EACH INDIVIDUAL TRUSS MEMBER AND THE TRUSS ROOF SYSTEM AS A WHOLE AND TO PROVIDE RESTRAINT FOR ANY LATERAL BRACING. THE BUILDER SHOULD USE CARE CHECKING THE ROOF DESIGN BECAUSE THE WIND LOAD ENGINEER IS SPECIFICALLY NOT RESPONSIBLE FOR THE TRUSS LAYOUT WHICH WAS CREATED BY THE TRUSS MANUFACTURER AND THE TRUSS DESIGNER ALSO DENIES RESPONSIBILITY FOR THE LAYOUT PER NOTES ON THEIR SEALED TRUSS SHEETS.

DESIGN DATA

WIND LOADS PER 2010 FLORIDA BUILDING CODE RESIDENTIAL, SECTION R301.2.1			
(ENCLOSED SIMPLE DIAPHRAGM BUILDINGS WITH FLAT, HIPPED, OR GABLE ROOFS, MEAN ROOF HEIGHT)			
BUILDING IS NOT IN THE HIGH VELOCITY HURRICANE ZONE			
BUILDING IS NOT IN THE WIND-BORNE DEBRIS REGION			
1.)	BASIC WIND SPEED =	130 MPH, (3 SEC GUST, 33 FT, EXP. C)	
2.)	WIND EXPOSURE =	C, BUILDER MUST FIELD VERIFY	
3.)	TOPOGRAPHIC FACTOR =	1.0, BUILDER MUST FIELD VERIFY	
4.)	RISK CATEGORY =	II (MRI = 700 YR)	
5.)	ROOF ANGLE =	7-45 DEGREES	
6.)	MEAN ROOF HEIGHT =	<30 FT	
7.)	INTERNAL PRESSURE COEFFICIENT =	N/A (ENCLOSED BUILDING)	
8.)	COMPONENTS AND CLADDING DESIGN WIND PRESSURES (TABLE R301.2(2))		

Zone	Effective Wind Area (ft ²)		
1	39	-43	
2	39	-68	
3	39	-100	
4	43	-46	
5	43	-57	

Garage Door		
2010 FBCR, Table R301.2 (4)		
8x7 Garage Door	37	42
16x7 Garage Door	36	40

DESIGN LOADS	
FLOOR	40 PSF (ALL OTHER DWELLING ROOMS)
	30 PSF (SLEEPING ROOMS)
	30 PSF (ATTICS WITH STORAGE)
	10 PSF (ATTICS WITHOUT STORAGE, <3.12)
ROOF	20 PSF (FLAT OR <4:12)
	16 PSF (4:12 TO <12:12)
	12 PSF (12:12 AND GREATER)
STAIRS	40 PSF (ONE & TWO FAMILY DWELLINGS)
SOIL BEARING CAPACITY	1000PSF
NOT IN FLOOD ZONE (BUILDER TO VERIFY)	

REVISIONS

NO.	DESCRIPTION
1	
2	
3	
4	
5	
6	
7	
8	
9	
10	

SOFTPLAN
ARCHITECTURAL DESIGN SOFTWARE

WINDLOAD ENGINEER: Mark Disoway, P.E. No. 53915, P.O. Box 868, Lake City, FL 32056, 386-754-5419

DIMENSIONS: Stated dimensions supersede scaled dimensions. Refer all questions to Mark Disoway, P.E. for resolution. Do not proceed without clarification.

COPYRIGHTS AND PROPERTY RIGHTS: Mark Disoway, P.E. hereby expressly reserves its common law copyrights and property right in these instruments of service. This document is not to be reproduced, altered or copied in any form or manner without first the express written permission and consent of Mark Disoway.

CERTIFICATION: I hereby certify that I have examined this plan, and that the applicable portions of the plan, relating to wind engineering, comply with section R301.2.1, 2010 Florida Building Code Residential to the best of my knowledge.

LIMITATION: This design is valid for one building, at specified location.



Bryan Zecher
Construction

Garrison Residence

ADDRESS:
Columbia County, Florida
Mark Disoway P.E.
P.O. Box 868
Lake City, Florida 32056
Phone: (386) 754 - 5419
Fax: (386) 269 - 4871

PRINTED DATE:
May 29, 2012
DRAWN BY: STRUCTURAL BY:
David Disoway

FINALS DATE:
29May12

JOB NUMBER:
1205051

DRAWING NUMBER
S-1
OF 3 SHEETS