

As required by Florida Statute 553.842 and Florida Administrative Code 9B-72, please provide the information and approval numbers on the building components listed below if they will be utilized on the construction project for which you are applying for a building permit. We recommend you contact your local product supplier should you not know the product approval number for any of the applicable listed products. Statewide approved products are listed online @ [www.floridabuilding.org](http://www.floridabuilding.org)

Category/Subcategory	Manufacturer	Product Description	Approval Number(s)
<b>1. EXTERIOR DOORS</b>			
A. SWINGING			
B. SLIDING			
C. SECTIONAL/ROLL UP			
D. OTHER			
<b>2. WINDOWS</b>			
A. SINGLE/DOUBLE HUNG	Andersen Corp	DG	FL27970.1
B. HORIZONTAL SLIDER			
C. CASEMENT			
D. FIXED	Andersen Corp	Picture	FL19562.4
E. MULLION			
F. SKYLIGHTS			
G. OTHER			
<b>3. PANEL WALL</b>			
A. SIDING			
B. SOFFITS			
C. STOREFRONTS			
D. GLASS BLOCK			
E. OTHER			
<b>4. ROOFING PRODUCTS</b>			
A. ASPHALT SHINGLES			
B. NON-STRUCTURAL METAL			
C. ROOFING TILES			
D. SINGLE PLY ROOF			
E. OTHER			
<b>5. STRUCTURAL COMPONENTS</b>			
A. WOOD CONNECTORS			
B. WOOD ANCHORS			
C. TRUSS PLATES			
D. INSULATION FORMS			
E. LINTELS			
F. OTHERS			
<b>6. NEW EXTERIOR ENVELOPE PRODUCTS</b>			

The products listed below did not demonstrate product approval at plan review. I understand that at the time of inspection of these products, the following information must be available to the inspector on the jobsite; 1) copy of the product approval, 2) performance characteristics which the product was tested and certified to comply with, 3) copy of the applicable manufacturers installation requirements.

Further, I understand these products may have to be removed if approval cannot be demonstrated during inspection.

9/20/21  
 Contractor OR Agent Signature Date

NOTES: Replacing 6 windows SZ  
 For SZ; FL27970.1  
 FL19562.4



# Order Summary

dba: RENEWAL BY ANDERSEN OF FLORIDA

Legal Name: JLM Windows, LLC | License # CGC1527613  
 997 West Kennedy Blvd. Ste A-18 | Orlando, FL 32810  
 Phone: 407-803-4723 | Fax: 407-386-8262 | concierge@rbafila.com  
 Measure Tech: Frank Dunning,

RENA & ALFRED MILLER

345 SE Rosewood Cir  
 Lake City, FL 32025  
 H: (702)277-1614 | C:

ID#	ROOM	SIZE		DETAILS
106	Bed 2	35"	58"	<b>Window:</b> Double-Hung (DG), 1:1, Flat Sill, Base Frame, Modern Checkrail, Exterior White, Interior White <b>Glass:</b> All Sash: High Performance SmartSun Glass, No Pattern <b>Hardware:</b> White <b>Screen:</b> Fiberglass, Full Screen <b>Grille Style:</b> Grilles Between Glass (GBG) <b>Grille Pattern:</b> All Sash: Colonial 3w x 2h <b>Misc:</b> Grids-Same as current <b>Construction:</b> None <b>Material:</b> Caulk - White Exterior (1), Interior Caulk- White (1), 2.25" x 5/8" L-Trim, (12 ft), White (2)
		34-1/2"	58-3/8"	

PRODUCTS: 6 WINDOWS: 6 PATIO DOORS: 0 SPECIALTY: 0 MISC: 0

Updated 7/13/21

## JOB NOTES

Exterior is vinyl siding, lower is brick on front only.

**Estimated Duration: 1 days**

## FLOORPLAN - 1ST FLOOR

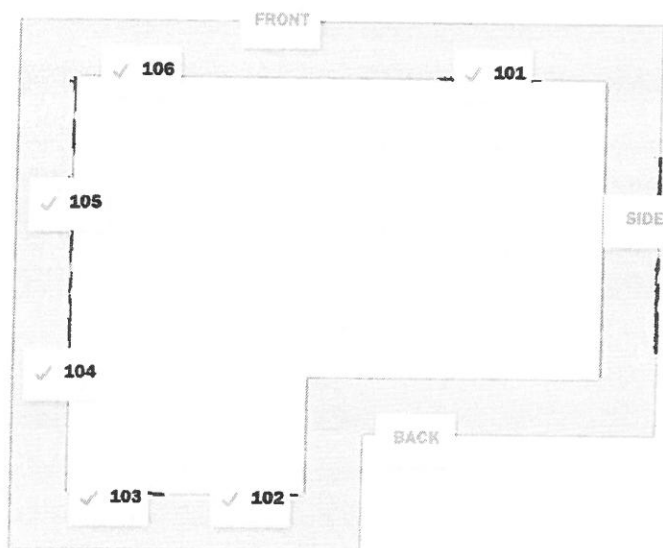

## UNIT NOTES

## JOB PHOTOS



# Order Summary

dba: RENEWAL BY ANDERSEN OF FLORIDA

Legal Name: JLM Windows, LLC | License # CGC1527613  
 997 West Kennedy Blvd. Ste A-18 | Orlando, FL 32810  
 Phone: 407-803-4723 | Fax: 407-386-8262 | concierge@rbafla.com  
 Measure Tech: Frank Dunning,

RENA & ALFRED MILLER

345 SE Rosewood Cir  
 Lake City, FL 32025  
 H: (702)277-1614 | C:

ID#	ROOM	SIZE		DETAILS
JOB				
101	Living	70" 69-1/2"	58" 58-1/4"	<b>Window:</b> Picture, Base Frame, Exterior White, Interior White <b>Glass:</b> All Sash: High Performance SmartSun Glass, No Pattern <b>Grille Style:</b> Grilles Between Glass (GBG) <b>Grille Pattern:</b> All Sash: Colonial 6w x 4h <b>Misc:</b> Grids-Same as current <b>Construction:</b> None <b>Material:</b> Caulk - White Exterior (1), Interior Caulk- White (1), 2.25" x 5/8" L-Trim, (12 ft), White (2)
102	Laundry	35" 34-5/8"	35" 34-1/2"	<b>Window:</b> Double-Hung (DG), 1:1, Flat Sill, Base Frame, Modern Checkrail, Exterior White, Interior White <b>Glass:</b> All Sash: High Performance SmartSun Glass, No Pattern <b>Hardware:</b> White <b>Screen:</b> Fiberglass, Full Screen <b>Grille Style:</b> No Grille <b>Misc:</b> None <b>Construction:</b> None <b>Material:</b> Caulk - White Exterior (1), Interior Caulk- White (1), 2.25" x 5/8" L-Trim, (12 ft), White (1)
103	Bath	23" 23"	35" 34-1/2"	<b>Window:</b> Double-Hung (DG), 1:1, Flat Sill, Base Frame, Modern Checkrail, Exterior White, Interior White <b>Glass:</b> All Sash: High Performance SmartSun Glass, Obscure, Tempered Glass <b>Hardware:</b> White <b>Screen:</b> Fiberglass, Full Screen <b>Grille Style:</b> No Grille <b>Misc:</b> None <b>Construction:</b> None <b>Material:</b> Caulk - White Exterior (1), Interior Caulk- White (1), 2.25" x 5/8" L-Trim, (12 ft), White (1)
104	Bed 1	35" 34-1/2"	58" 58-3/8"	<b>Window:</b> Double-Hung (DG), 1:1, Flat Sill, Base Frame, Modern Checkrail, Exterior White, Interior White <b>Glass:</b> All Sash: High Performance SmartSun Glass, No Pattern <b>Hardware:</b> White <b>Screen:</b> Fiberglass, Full Screen <b>Grille Style:</b> Grilles Between Glass (GBG) <b>Grille Pattern:</b> All Sash: Colonial 3w x 2h <b>Misc:</b> Grids-Same as current <b>Construction:</b> None <b>Material:</b> Caulk - White Exterior (1), Interior Caulk- White (1), 2.25" x 5/8" L-Trim, (12 ft), White (2)
105	Bed 1	35" 34-3/4"	58" 58-3/8"	<b>Window:</b> Double-Hung (DG), 1:1, Flat Sill, Base Frame, Modern Checkrail, Exterior White, Interior White <b>Glass:</b> All Sash: High Performance SmartSun Glass, No Pattern <b>Hardware:</b> White <b>Screen:</b> Fiberglass, Full Screen <b>Grille Style:</b> Grilles Between Glass (GBG) <b>Grille Pattern:</b> All Sash: Colonial 3w x 2h <b>Misc:</b> Grids-Same as current <b>Construction:</b> None <b>Material:</b> Caulk - White Exterior (1), Interior Caulk- White (1), 2.25" x 5/8" L-Trim, (12 ft), White (2)