

Columbia County Property Appraiser

Jeff Hampton

2022 Working Values

updated: 7/28/2022

Parcel: << 00-00-00-10846-103 (39213) >>

Aerial Viewer Pictometry Google Maps

Owner & Property Info

Result: 1 of 1

Owner	LIBIS PAUL P O BOX 8106 MISSION HILLS, CA 91346		
Site	404 NE MARTIN LUTHER KING St, LAKE CITY		
Description*	LOT 3 ABERDEEN CORNER. WD 1095-2670.		
Area	0.175 AC	S/T/R	29-3S-17
Use Code**	MODULAR HOME (0201)	Tax District	1

*The Description above is not to be used as the Legal Description for this parcel in any legal transaction.

**The Use Code is a FL Dept. of Revenue (DOR) code and is not maintained by the Property Appraiser's office. Please contact your city or county Planning & Zoning office for specific zoning information.

Property & Assessment Values

2021 Certified Values		2022 Working Values	
Mkt Land	\$3,819	Mkt Land	\$3,819
Ag Land	\$0	Ag Land	\$0
Building	\$53,165	Building	\$53,343
XFOB	\$864	XFOB	\$864
Just	\$57,848	Just	\$58,026
Class	\$0	Class	\$0
Appraised	\$57,848	Appraised	\$58,026
SOH Cap [?]	\$1,895	SOH Cap [?]	\$0
Assessed	\$57,848	Assessed	\$58,026
Exempt	\$0	Exempt	\$0
Total Taxable	county:\$55,953 city:\$55,953 other:\$0 school:\$57,848	Total Taxable	county:\$58,026 city:\$58,026 other:\$0 school:\$58,026

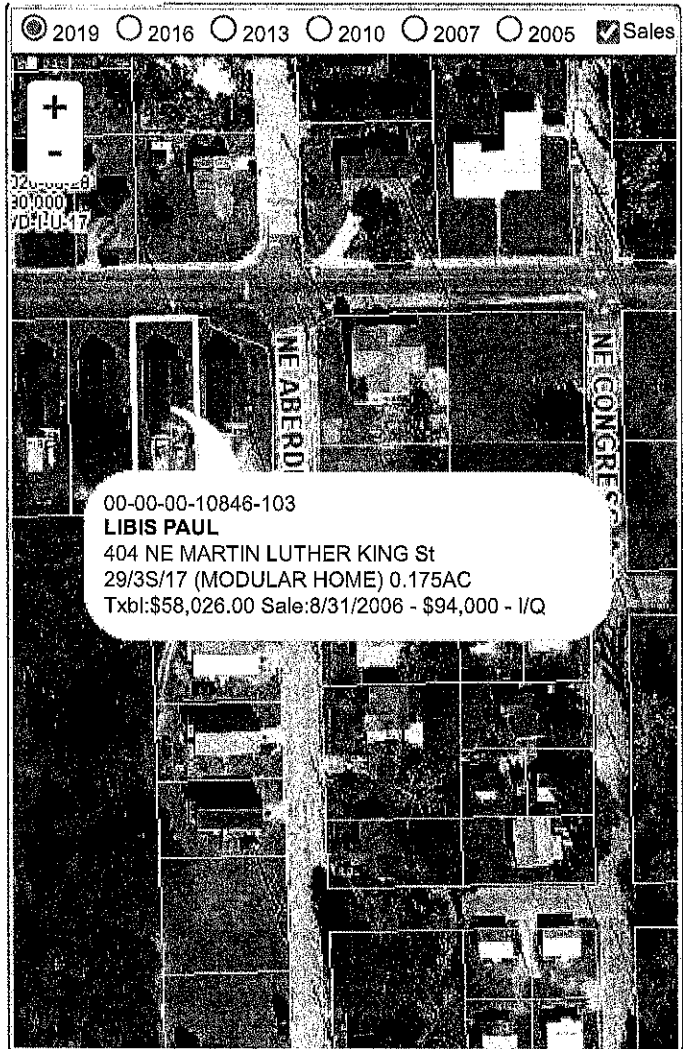

Sales History

Sale Date	Sale Price	Book/Page	Deed	V/I	Qualification (Codes)	RCode
8/31/2006	\$94,000	1095/2670	WD	I	Q	

Building Characteristics

Bldg Sketch	Description*	Year Blt	Base SF	Actual SF	Bldg Value
Sketch	MODULAR 1 (0210)	2007	1248	1356	\$53,343

*Bldg Desc determinations are used by the Property Appraisers office solely for the purpose of determining a property's Just Value for ad valorem tax purposes and should not be used for any other purpose.

Extra Features & Out Buildings (Codes)

Code	Desc	Year Blt	Value	Units	Dims
0166	CONC,PAVMT	2007	\$864.00	288.00	12 x 24

Land Breakdown

Code	Desc	Units	Adjustments	Eff Rate	Land Value
0201	MOD HOME (MKT)	7,638.000 SF (0.175 AC)	1.0000/1.0000 1.0000//	\$1 /SF	\$3,819

Search Result: 1 of 1