

DATE 06/16/2005

Columbia County Building Permit

PERMIT

This Permit Expires One Year From the Date of Issue

000023277

APPLICANT RON BRADTMUELLER PHONE 755.7443
ADDRESS POB 2331 LAKE CITY FL 32056
OWNER CENTRAL STATES ENTERPRISES, INC. PHONE 755.7443
ADDRESS 668 NW WALDO STREET LAKE CITY FL 32055
CONTRACTOR HAROLD STILL, FASCO INC. PHONE 229.724.8983
LOCATION OF PROPERTY 41-N TO WALDO ST, TR CROSS TRACKS, CENTRAL STATES ON R.

TYPE DEVELOPMENT GRAIN STORAGE BINS ESTIMATED COST OF CONSTRUCTION 200000.00
HEATED FLOOR AREA TOTAL AREA HEIGHT 65.00 STORIES
FOUNDATION WALLS ROOF PITCH FLOOR
LAND USE & ZONING I MAX. HEIGHT
Minimum Set Back Requirments: STREET-FRONT 20.00 REAR 15.00 SIDE 15.00
NO. EX.D.U. FLOOD ZONE DEVELOPMENT PERMIT NO.

PARCEL ID 19-3S-17-05139-001 SUBDIVISION
LOT BLOCK PHASE UNIT TOTAL ACRES 5.74

CGC012777
Culvert Permit No. Culvert Waiver Contractor's License Number Applicant/Owner/Contractor Ronald L. Bradtmueller
EXISTING X-05-0167 BLK N
Driveway Connection Septic Tank Number LU & Zoning checked by Approved for Issuance New Resident

COMMENTS: CLASSIFIED AS EQUIPMENT. NOC ON FILE

Check # or Cash 39652

FOR BUILDING & ZONING DEPARTMENT ONLY

(footer/Slab)

Temporary Power Foundation Monolithic
 date/app. by date/app. by date/app. by
Under slab rough-in plumbing Slab Sheathing/Nailing
 date/app. by date/app. by date/app. by
Framing Rough-in plumbing above slab and below wood floor
 date/app. by date/app. by
Electrical rough-in Heat & Air Duct Peri. beam (Lintel)
 date/app. by date/app. by date/app. by
Permanent power C.O. Final Culvert
 date/app. by date/app. by date/app. by
M/H tie downs, blocking, electricity and plumbing Pool
 date/app. by date/app. by
Reconnection Pump pole Utility Pole
 date/app. by date/app. by date/app. by
M/H Pole Travel Trailer Re-roof
 date/app. by date/app. by date/app. by

BUILDING PERMIT FEE \$ 1000.00 CERTIFICATION FEE \$.00 SURCHARGE FEE \$.00
MISC. FEES \$.00 ZONING CERT. FEE \$ 50.00 FIRE FEE \$ WASTE FEE \$
FLOOD ZONE DEVELOPMENT FEE \$ CULVERT FEE \$ TOTAL FEE 1050.00

INSPECTORS OFFICE CLERKS OFFICE

NOTICE: IN ADDITION TO THE REQUIREMENTS OF THIS PERMIT, THERE MAY BE ADDITIONAL RESTRICTIONS APPLICABLE TO THIS PROPERTY THAT MAY BE FOUND IN THE PUBLIC RECORDS OF THIS COUNTY. AND THERE MAY BE ADDITIONAL PERMITS REQUIRED FROM OTHER GOVERNMENTAL ENTITIES SUCH AS WATER MANAGEMENT DISTRICTS, STATE AGENCIES, OR FEDERAL AGENCIES.

"WARNING TO OWNER: YOUR FAILURE TO RECORD A NOTICE OF COMMENCEMENT MAY RESULT IN YOUR PAYING TWICE FOR IMPROVEMENTS TO YOUR PROPERTY. IF YOU INTEND TO OBTAIN FINANCING, CONSULT WITH YOUR LENDER OR AN ATTORNEY BEFORE RECORDING YOUR NOTICE OF COMMENCEMENT."

This Permit Must Be Prominently Posted on Premises During Construction

PLEASE NOTIFY THE COLUMBIA COUNTY BUILDING DEPARTMENT AT LEAST 24 HOURS IN ADVANCE OF EACH INSPECTION, IN ORDER THAT IT MAY BE MADE WITHOUT DELAY OR INCONVENIENCE, PHONE 758-1008. THIS PERMIT IS NOT VALID UNLESS THE WORK AUTHORIZED BY IT IS COMMENCED WITHIN 6 MONTHS AFTER ISSUANCE.

The Issuance of this Permit Does Not Waive Compliance by Permittee with Deed Restrictions.

Columbia County Building Permit Application

Revised 9-23-04

For Office Use Only Application # 0506-43 Date Received 6/15/05 By JW Permit # 23277
 Application Approved by - Zoning Official BLK Date 6-16-05 Plans Examiner OKJTH Date 6-16-05
 Flood Zone N/A Development Permit N/A Zoning I Land Use Plan Map Category INDUSTRIAL
 Comments Classified as Equipment (see note) with 1050.00

Applicants Name Harold W. Still, FASCO, Inc. Phone 386-755-7443
 Address P.O. Box 2331 Lake City, Florida 32056
 Owners Name Central States Enterprises, Inc. Phone 386-755-7443
 911 Address 668 NW Waldo Street Lake City, FL 32056
 Contractors Name HAROLD W. STILL, FASCO, Inc. Phone 229-724-8983
 Address 3615 E. 7th Ave, Tampa, FL 33675 Lic# C6C012777
 Fee Simple Owner Name & Address Central States Enterprises, Inc. Lake City, FL
 Bonding Co. Name & Address NA
 Architect/Engineer Name & Address Barkley Engineers 2804 Remington Green Circle, Tallahassee FL 32308
 Mortgage Lenders Name & Address NA
 Circle the correct power company - FL Power & Light - Clay Elec. - Suwannee Valley Elec. - Progressive Energy
 Property ID Number 19-35-17-05139-001 Estimated Cost of Construction \$200,000.00
 Subdivision Name _____ Lot _____ Block _____ Unit _____ Phase _____
 Driving Directions North on highway 41 to Waldo St. - turn right on Waldo, cross railroad tracks, Central States on right

Type of Construction Grain Storage Bins Number of Existing Dwellings on Property NA (Industrial)
 Total Acreage 5.74 Lot Size _____ Do you need a - Culvert Permit or Culvert Waiver or Have an Existing Drive
 Actual Distance of Structure from Property Lines - Front 100+ ft. Side 100+ ft. Side 100+ ft. Rear 30ft
 Total Building Height 65 ft. Number of Stories NA Heated Floor Area None Roof Pitch NA

Application is hereby made to obtain a permit to do work and installations as indicated. I certify that no work or installation has commenced prior to the issuance of a permit and that all work be performed to meet the standards of all laws regulating construction in this jurisdiction.

OWNERS AFFIDAVIT: I hereby certify that all the foregoing information is accurate and all work will be done in compliance with all applicable laws and regulating construction and zoning.

WARNING TO OWNER: YOUR FAILURE TO RECORD A NOTICE OF COMMENCEMENT MAY RESULT IN YOU PAYING TWICE FOR IMPROVEMENTS TO YOUR PROPERTY. IF YOU INTEND TO OBTAIN FINANCING, CONSULT WITH YOUR LENDER OR ATTORNEY BEFORE RECORDING YOUR NOTICE OF COMMENCEMENT.

Harold W. Still, V.P.
 Owner Builder or Agent (Including Contractor)

STATE OF FLORIDA GEORGIA
 COUNTY OF COLUMBIA EARLY

Sworn to (or affirmed) and subscribed before me
 this 10th day of JUNE 20 05.

Personally known ✓ or Produced Identification _____
 MY COMMISSION EXPIRES: 9-21-08

Harold W. Still
 Contractor Signature
 Contractors License Number C6C 012777
 Competency Card Number _____
 NOTARY STAMP/SEAL

Diana Craft
 Notary Signature

Called Ron 6-16-05

CENTRAL STATES ENTERPRISES INC

1	COMM NW COR OF SW1/4 OF SE1/4,	RUN E 471 FT TO E R/W OF RR,	2
3	SE ALONG RR 56.80 FT TO SW COR	GUERDON INDUSTRIES, CONT SE	4
5	345 FT TO INTERS S R/W WALDO	ST & E LINE OF SAID RR FOR	6
7	POB, RUN NE & E ALONG WALDO ST	898.37 FT, SE 351.12 FT TO N	8
9	R/W OF RR, NW ALONG R/W	1052.64 FT TO POB.	10
11	ORB 392-605, 656-093 THRU 095,		12
13			14
15			16
17			18
19			20
21			22
23			24
25			26
27			28

Mnt 12/14/2001 TERRY

F1=Task F3=Exit F4=Prompt F10=GoTo PgUp/PgDn F24=More

June 16, 2005

Columbia County Building Department
Lake City, Florida 32055

To Whom It May Concern:

I hereby authorize Columbia County Building Department to register my license and issue a permit for the addition of grain bins at Central States Enterprises in the name of Fasco, Inc. signed by Ron Bradtmueller who shall be my authorized agent.

License Holder: Harold W. Still
Certificate Number: CGC 012777



Signature of License Holder
Harold W. Still



Signature of Authorized Agent
Ron Bradtmueller

State of Georgia
County of Early
Subscribed and Sworn to before me,
this 16th day of June, 2005.

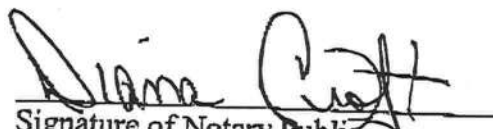

Signature of Notary Public
Notary Public, State of Georgia
My Commission Expires: 9-21-08



2804-1 Remington Green Circle
Tallahassee, Florida 32308
Phone: (850) 297-0440
Fax: (850) 297-0697

**BARKLEY
CONSULTING
ENGINEERS, INC**

Memo

To: Joe Halgiwanger
From: William Baldwin, P.E.
Date: June 15, 2005
Re: Bin at Central States

The bin foundations are designed for windloads using 120 mph Exposure "C" conditions.

Since the gravity loads are very high no additional foundation depth was required to resist windloads.

If you have any questions or concerns on the above, please do not hesitate to call.

NOTICE OF COMMENCEMENT FORM
COLUMBIA COUNTY, FLORIDA

***THIS DOCUMENT MUST BE RECORDED AT THE COUNTY
CLERKS OFFICE BEFORE YOUR FIRST INSPECTION.***

THE UNDERSIGNED hereby gives notice that improvement will be made to certain real property, and in accordance with Chapter 713, Florida Statutes, the following information is provided in this Notice of Commencement.

Tax Parcel ID Number 19-35-17-05139-001

1. Description of property: (legal description of the property and street address or 911 address)
Central States Enterprises, 668 NW Waldo St., Lake City, FL 32055
LEGAL: COMM NW COR OF SW 1/4 OF SE 1/4, RUN E 471 FT TO E R/W OF RR, SE ALONG RR 56.80 FT
TO SW COR GUERDON INDUSTRIES, CONT SE 345 FT TO INTERS S R/W WALDO ST
& E LINE OF SAID RR FOR POB, RUN NE & E ALONG WALDO ST
2. General description of improvement: Grain Storage Bins
3. Owner Name & Address Central States Enterprises P.O. Box 2331 Lake City, FL 32056
Interest in Property _____
4. Name & Address of Fee Simple Owner (if other than owner): _____
5. Contractor Name Harold W. Still, Fasco, Inc. Phone Number 229-724-8983
Address 3615 E. 7th Ave, Tampa FL 33675
6. Surety Holders Name NA
Address _____
Amount of Bond _____
Inst: 2005014072 Date: 06/16/2005 Time: 11:09
MK DC, P. Dewitt Cason, Columbia County B: 1049 P: 53
7. Lender Name NA
Address _____
8. Persons within the State of Florida designated by the Owner upon whom notices or other documents may be served as provided by section 718.13 (1)(a) 7; Florida Statutes:
Name Robert Nawrot Phone Number 407-357-4203
Address 300 International Parkway Suite 150 Heathrow, FL 32746
9. In addition to himself/herself the owner designates HARRY SMITH of _____
to receive a copy of the Lienor's Notice as provided in Section 713.13 (1) -
(a) 7. Phone Number of the designee 386-755-7443
10. Expiration date of the Notice of Commencement (the expiration date is 1 (one) year from the date of recording, (Unless a different date is specified) _____

NOTICE AS PER CHAPTER 713, Florida Statutes:

The owner must sign the notice of commencement and no one else may be permitted to sign in his/her stead.

Michael Brown, V.P.
Signature of Owner

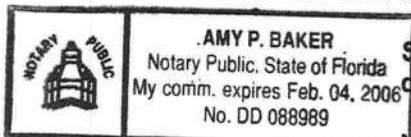

Sworn to (or affirmed) and subscribed before
day of June 15th, 2005

NOTARY STAMP/SEAL

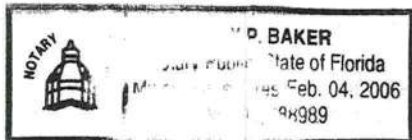

Amy P. Baker
Signature of Notary

**ENGINEERING & TESTING
LABORATORY**

P. O. Box 1625 ★ Lake City, Fla. 32056

(904) 755-3633

ORDER NO. CT-1363
LAB NO. 15545
REPORT NO. 1
DATE: 4-1-87

REPORT OF: Standard Penetration Test Borings
PROJECT: Proposed Elevated Silo Site, Waldo Street, Lake City, FL
REPORTED TO: Ron Bratmuller
P.O. Box 52
McAlpin, FL 32062

At your request, (8) Standard Penetration Borings (SPT) were performed on the above site. The SPT borings were taken to varying depths below the existing grade.

PURPOSES

The purposes of this investigation were to determine the general subsurface conditions, to analyze these conditions with respect to the proposed construction, and to provide engineering recommendations for foundation design and site preparation.

SUBSURFACE INVESTIGATION

The soil test borings were performed according to the procedures of the SPT (ASTM D-1586). In this test, a standard split-barrel sampler was advanced into the soil using a 140 pound hammer falling 30 inches. The number of blows required to drive the sampler one foot, after seating six inches, was designated the penetration resistance or "N" value; this value is an index to soil strength and density.

The boring locations and depths were chosen by Ron Bratmuller and marked in the field by CAL-TECH, INC. personnel. The log of borings and generalized boring location plan are attached.

SUBSURFACE CONDITIONS

Generally, the soils encountered in the soil test borings can be classified as loose to medium compacted silty fine sands within the top five feet. The water table was encountered at 1 3/4' to 2 1/2' below the existing grade.

Definite assurances against sinkhole formation can never be issued, but the site does not appear to be actively sinkhole prone. However, shifts in drainage patterns could affect this stability.

ORDER NO. CT-1363
LAB NO. 15545
REPORT NO. 1
DATE: 4-1-87

RECOMMENDATIONS

Due to the seasonly high groundwater table being @ 2' below the existing land surface and the subsoils being loose to moderately dense, two types of foundations are recommended for analysis:

- (1) Friction or bearing piling. An adequate number of piling may be driven to obtain the required bearing capacity by being set in limerock, the depth of which is not known at this point or friction piling may be placed to achieve the resistance to uplift and bearing as required by the structure.
- (2) Spread footer. A spread footer may be developed, however, this method will require dewatering the site of the foundation to a depth of 10' and then compacting the dried soils to a suitable density. This method may be achieved by opening a hole 34' square on each side and backfilling 1' layers of suitable soil material (already excavated) and compacting to 95% density.

Respectfully Submitted
CAL-TECH, INC.

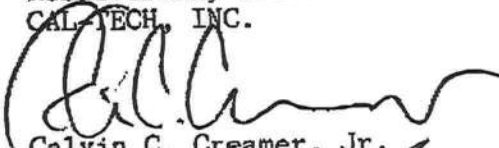

Calvin C. Creamer, Jr.
General Manager

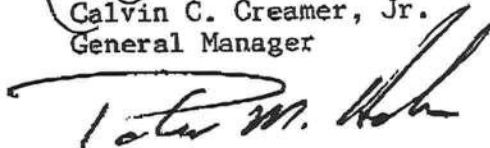

Peter M. Hahn, P.E.
Vice President

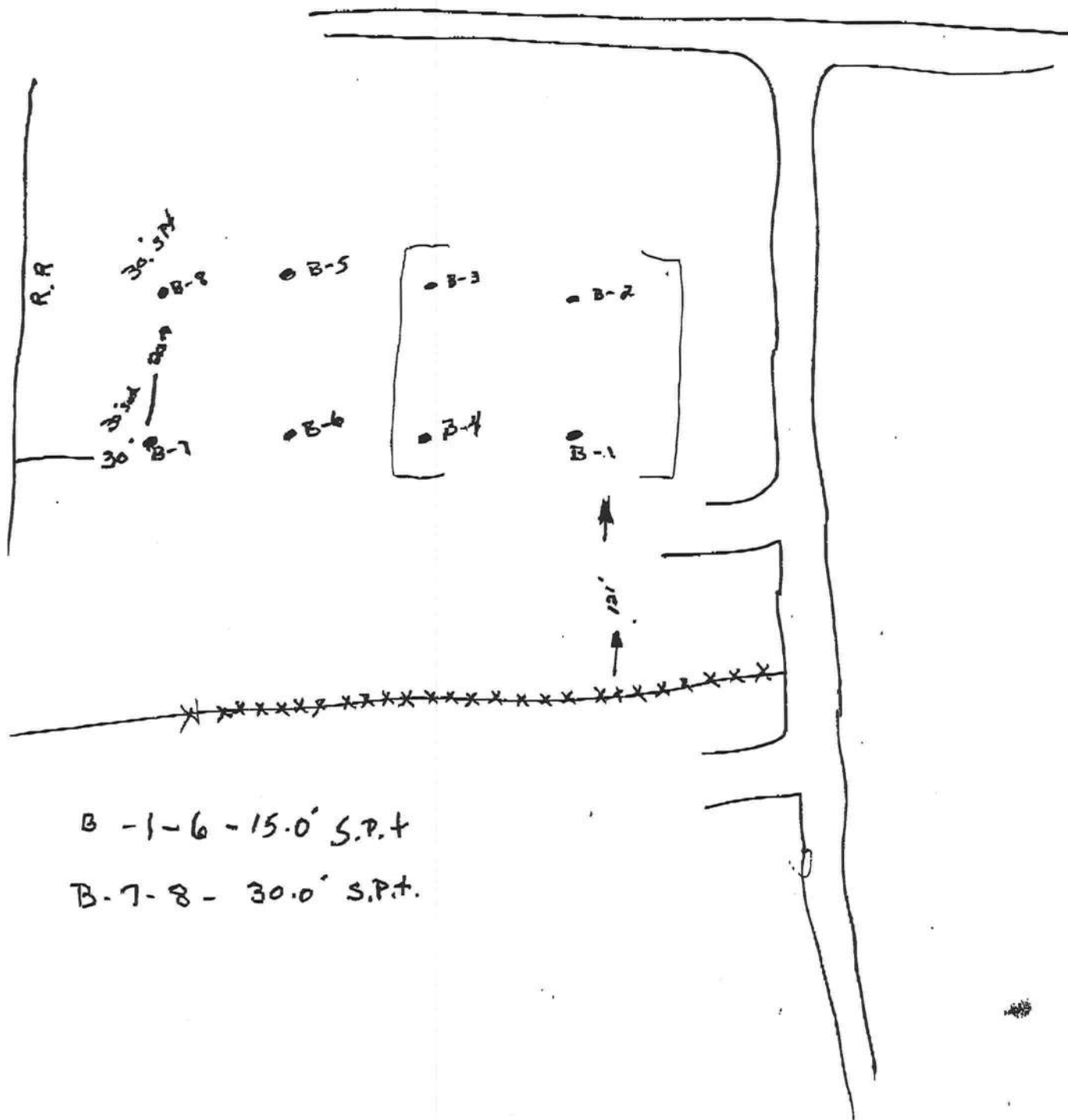

B - 1 - 6 - 15.0' S.P.t

B - 7 - 8 - 30.0' S.P.t.

PROJECT NO <u>CT-1363</u> CLIENT _____						BORING NO. <u>B-7</u> SHEET NO <u>1 of 2</u>	
PROJECT IDENTIFICATION <u>Storage Tank</u>						LOCATION OF BORING _____	
PROJECT LOCATION <u>Waldo Street, Lake City, FL</u>						Spoon data: inside dia. _____ Outside dia. _____	
DRILLED BY <u>C. Moody</u> Boring started on <u>3-21-87</u>						Hammer data: drop _____ weight _____	
Completed on <u>3-21-87</u>						Casing data: size _____ length _____	
						Engineer: Inst. by _____ Rev. by _____	

DEPTH	N Per 6"	N Asm	N Cons.	2 D 2 5"	% Rec.	Soil Tests	DESCRIPTION OF SOIL	REMARKS, OBSERVATIONS SUMMARY OF LAB. TEST
0	23			1			Light Brown Fine Sand w/some Gravel	
	13		36				2.2'	
	60			2			Light Brown & Dark Green Fine Sand w/some Silt	
	11		21				3.5'	
5	119			3			Light Brown Fine Sand	
	54		14				6.0'	
	45			4				
	69		11				Light Brown Fine Sand w/tr of Clay	
	39		17	5			Same	
10	81							
							12.2'	
	9			6			Light Brown Clayey Fine Sand	
15	101		21					
	10			7				
20	98		17				Same	
	13			8			25.4'	
25	95		14				Light Brown Fine Sand	
							Cont. on Sheet 2	

LEGEND FOR SOIL TESTS
1 MC Natural Water Contents
2 AL Atterberg Limits
3 GS Grain Size
4 Un Field UnCons. Comp.
5 Cu Laboratory UnCons. Comp.
6 Con Consolidation
7 Tr St Triaxial Stress

GROUND WATER TABLE LEVEL 2.7'
GROUND ELEVATION _____
BORING LOG

PROJECT NO CT-1363 CLIENT Storage Tank
PROJECT IDENTIFICATION Storage Tank
PROJECT LOCATION Waldo Street, Lake City, FL
DRILLED BY C. Moody Boring started on 3-21-87
Completed on 3-21-87

BORING NO. B-8 SHEET NO 1 of 2
LOCATION OF BORING _____
Spoon data: Inside dia. _____ Outside dia. _____
Hammer data: drop _____ weight _____
Casing data: size _____ length _____
Engineer: Inst. by _____ Rev. by _____

DEPTH	N per 6"	N Asm Cone's	N Cone's	2 in 2 in	% Rec.	Soil Tests	DESCRIPTION OF SOIL	REMARKS, OBSERVATIONS SUMMARY OF LAB. TEST
0	6.7			1			Brown Fine Sand w/tr of Roots	
1	9.10		16				1.8'	
2	5.9			2			Light Brown Fine Sand	
3	10.15		19				Same	
4	17.7			3			Same	
5	20.2		37				Same	
6	10.6			4			Same	
7	4.5		10				Same	
8	5.4			5			Same	
9	3.7		7				Same	
10							12.3'	
11							Light Brown Clayey Fine Sand	
12	8.8		20				Same	
13	9.1						Same	
14	6.6			7			Same	
15	8.8		16				Same	
16							24.0'	
17	14.1						Light Brown Fine Sand	
18	18.10		28				Cont. on Sheet 2	

LEGEND FOR SOIL TESTS

- 1 MC Natural Water Content
- 2 AL Atterberg Limits
- 3 GS Grain Size
- 4 UN Field Unconf. Comp.
- 5 CU Laboratory Unconf. Comp.
- 6 CCH Consolidation
- 7 TS Triaxial Stress

GROUND WATER TABLE LEVEL 2.6'
GROUND ELEVATION _____

BORING LOG

PROJECT NO <u>CT-1363</u> CLIENT <u> </u> PROJECT IDENTIFICATION <u>Storage Tank</u> PROJECT LOCATION <u>Waldo Street, Lake City, FL</u> DRILLED BY <u>C. Moody</u> Boring started on <u>3-21-87</u> Completed on <u>3-21-87</u>						BORING NO. <u>B-8</u> SHEET NO <u>2 of 2</u> LOCATION OF BORING <u> </u> Spoon data: Inside dia. <u> </u> Outside dia. <u> </u> Hammer data: drop <u> </u> weight <u> </u> Casing data: size <u> </u> length <u> </u> Engineer: Inst. by <u> </u> Rev. by <u> </u>																																																																																																																																																																																																																											
DEPTH	N per 6"	N 1/4	N 1/2	N 3/4	N 1	N 2	N 3	N 4	N 5	N 6	N 7	N 8	N 9	N 10	N 11	N 12	N 13	N 14	N 15	N 16	N 17	N 18	N 19	N 20	N 21	N 22	N 23	N 24	N 25	N 26	N 27	N 28	N 29	N 30	N 31	N 32	N 33	N 34	N 35	N 36	N 37	N 38	N 39	N 40	N 41	N 42	N 43	N 44	N 45	N 46	N 47	N 48	N 49	N 50	N 51	N 52	N 53	N 54	N 55	N 56	N 57	N 58	N 59	N 60	N 61	N 62	N 63	N 64	N 65	N 66	N 67	N 68	N 69	N 70	N 71	N 72	N 73	N 74	N 75	N 76	N 77	N 78	N 79	N 80	N 81	N 82	N 83	N 84	N 85	N 86	N 87	N 88	N 89	N 90	N 91	N 92	N 93	N 94	N 95	N 96	N 97	N 98	N 99	N 100	N 101	N 102	N 103	N 104	N 105	N 106	N 107	N 108	N 109	N 110	N 111	N 112	N 113	N 114	N 115	N 116	N 117	N 118	N 119	N 120	N 121	N 122	N 123	N 124	N 125	N 126	N 127	N 128	N 129	N 130	N 131	N 132	N 133	N 134	N 135	N 136	N 137	N 138	N 139	N 140	N 141	N 142	N 143	N 144	N 145	N 146	N 147	N 148	N 149	N 150	N 151	N 152	N 153	N 154	N 155	N 156	N 157	N 158	N 159	N 160	N 161	N 162	N 163	N 164	N 165	N 166	N 167	N 168	N 169	N 170	N 171	N 172	N 173	N 174	N 175	N 176	N 177	N 178	N 179	N 180	N 181	N 182	N 183	N 184	N 185	N 186	N 187	N 188	N 189	N 190	N 191	N 192	N 193	N 194	N 195	N 196	N 197	N 198	N 199	N 200	N 201	N 202	N 203	N 204	N 205	N 206	N 207	N 208	N 209	N 210	N 211	N 212	N 213	N 214	N 215	N 216	N 217	N 218	N 219	N 220	N 2



STATE OF FLORIDA
DEPARTMENT OF BUSINESS AND
PROFESSIONAL REGULATION

AC# 1505779

CGC012777 07/26/04 040084341

CERTIFIED GENERAL CONTRACTOR
STILL, HAROLD W
FASCO INC

IS CERTIFIED under the provisions of Ch.489 FS.
Expiration date: AUG 31, 2006 L04072601276

23277

**BARKLEY
CONSULTING
ENGINEERS, INC**

Memo

To: Joe Halgiwanger

From: William Baldwin, P.E.

William Baldwin

Date: June 15, 2005

Re: Bin at Central States

The bin foundations are designed for windloads using 120 mph Exposure "C" conditions.

Since the gravity loads are very high no additional foundation depth was required to resist windloads.

If you have any questions or concerns on the above, please do not hesitate to call.