



STATE OF FLORIDA
DEPARTMENT OF HEALTH
ONSITE SEWAGE TREATMENT AND DISPOSAL
SYSTEM

APPLICATION FOR PERMIT

APPLICATION FOR:

☐ New System ☒ Existing System ☐ Holding Tank ☐ Innovative
☐ Repair ☐ Abandonment ☐ Temporary ☐

APPLICANT: Kimberly Taylor Wilson

AGENT: me/owner

TELEPHONE: (386) 344-4095

MAILING ADDRESS: PO Box 1095, Lake City, FL 32056

* street address 445 SE Kingston Ln. LAKE CITY, FL 32055

TO BE COMPLETED BY APPLICANT OR APPLICANT'S AUTHORIZED AGENT. SYSTEMS MUST BE CONSTRUCTED BY A PERSON LICENSED PURSUANT TO 489.105(3)(m) OR 489.552, FLORIDA STATUTES. IT IS THE APPLICANT'S RESPONSIBILITY TO PROVIDE DOCUMENTATION OF THE DATE THE LOT WAS CREATED OR PLATTED (MM/DD/YY) IF REQUESTING CONSIDERATION OF STATUTORY GRANDFATHER PROVISIONS.

PROPERTY INFORMATION

LOT: See attached BLOCK: See attached SUBDIVISION: METES AND BOUNDS PLATTED: See attached

PROPERTY ID #: 35-55-17-87318-005 ZONING: RES I/M OR EQUIVALENT: ☐ NO ☐

PROPERTY SIZE: ACRES WATER SUPPLY: ☒ PRIVATE PUBLIC ☐ ☐ <2000GPD ☐ >2000GPD

IS SEWER AVAILABLE AS PER 381.0065, FS? ☐ DISTANCE TO SEWER: N/A FT

PROPERTY ADDRESS: 445 Kingston Ln

DIRECTIONS TO PROPERTY:

BUILDING INFORMATION ☒ RESIDENTIAL ☐ COMMERCIAL

Unit No.	Type of Establishment	No. of Bedrooms	Building Area Sqft	Commercial/Institutional System Design Table 1, Chapter 64E-6, FAC
1	replacement MOBILE HOME	3	1999	ORIGINAL ATTACHED
2				
3				
4				

☐ Floor/Equipment Drains ☐ Other (Specify)

SIGNATURE: Kimberly Taylor Wilson

DATE:

DM 4015, 08/09 (Obsoletes previous editions which may not be used),
Incorporated 64E-6.001, FAC

Page 1 of 4

47281

Permit Application Number _____

Permit Application Number _____

- PART II - SITEPLAN

Fig. 2. Each block represents 10 feet and 1 inch = 40 feet.

The diagram is a hand-drawn site plan on a grid background. A north arrow is located in the top left corner. The plan shows a property with a 'septic' tank and a 'well'. A '50 foot driveway' is indicated. Dimensions are given in feet: 105 ft (left street), 60 ft, 80 ft, 70 ft, 75 ft, 23 ft, 32 ft, and 5 ft (right street). The plan also shows a '210' road at the top and bottom. The grid lines are spaced at 10-foot intervals.

Notes:

Plan Approved

Not Approved

Date 9/25/20

By _____

County Health Department

ALL CHANGES MUST BE APPROVED BY THE COUNTY HEALTH DEPARTMENT

DIH 4015, 08/09 (Obsoletes previous editions which may not be used) Incorporated: 64E-6.001, FAC
(Stock Number: 5744-002-4015-6)

Page 2 of 4

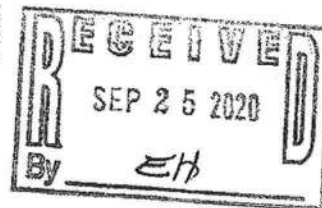

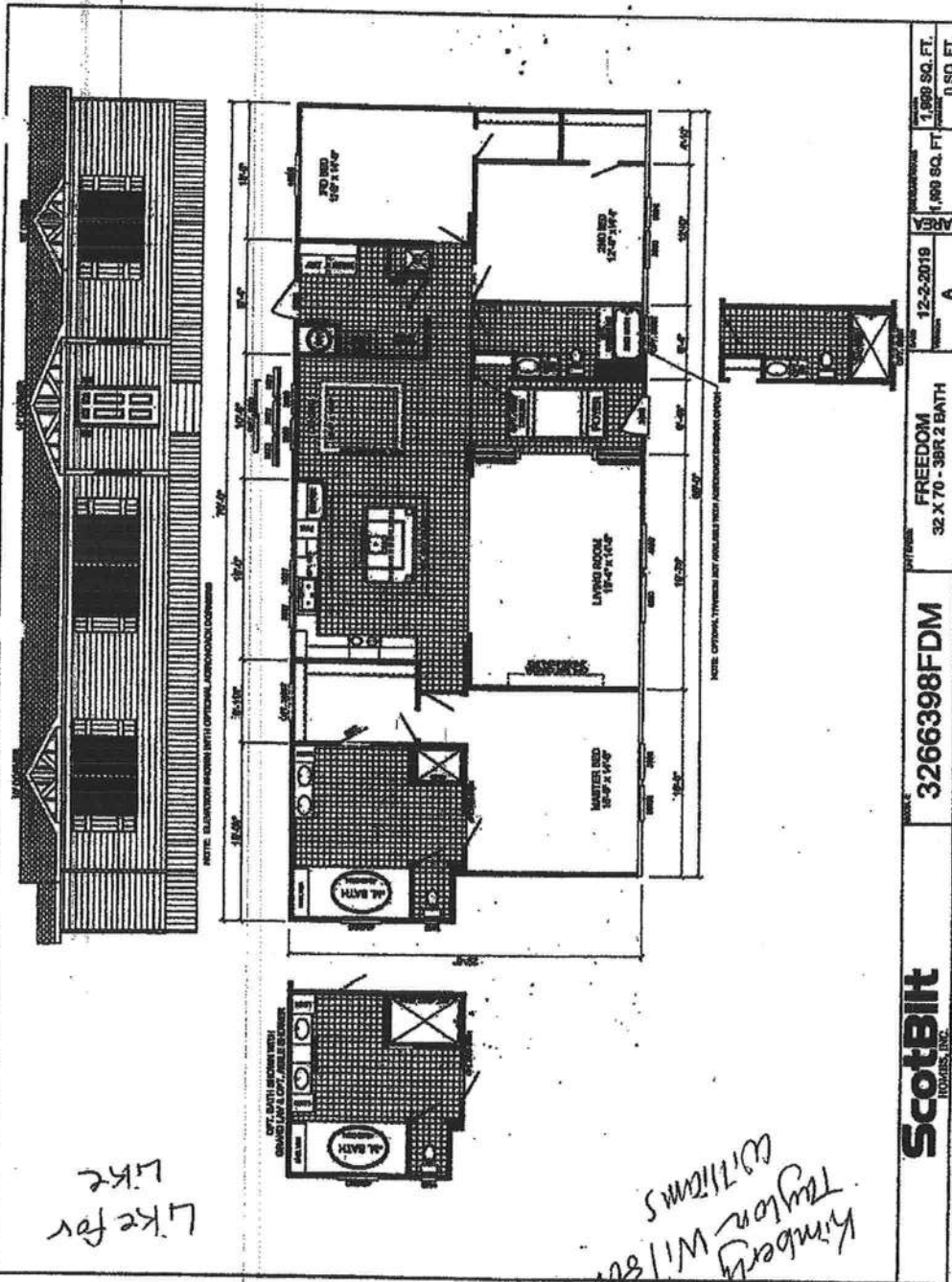

520-00 | LK2 for LK2

Kimberly Taylor Williams

Permit Application Number

----- PART II - SITEPLAN -----

Fig. 1. Each block represents 10' (vertical) and 10' (horizontal).

The diagram shows a frame structure on a grid. The structure consists of a central vertical column and two horizontal beams extending to the left and right. The total height of the structure is 105 units, and the total width is 160 units (80 units on each side of the central column). The central column has a height of 105 units and a width of 10 units. The horizontal beams have a height of 32 units and a width of 80 units. A 50 ft (5 units) horizontal load is applied to the right side of the structure. A 75 ft (7.5 units) horizontal load is applied to the left side of the structure. A 23 ft (2.3 units) vertical load is applied to the top of the central column. The diagram is labeled with dimensions and loads in feet and units.

Notes: _____

By [Signature] County Health Department

ALL CHANGES MUST BE APPROVED BY THE COUNTY HEALTH DEPARTMENT

Page 2 of 4

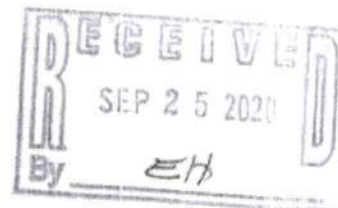

47281