

1-2 Andra plats

NOTES:

1. Specifications applicable to 26 gauge metal roof and wall panels fastened directly to 12 or 14 gauge steel tube framing, or 18 gauge hat channel roof purlins.
2. Specifications applicable only for mean roof height of 20 feet or less, and roof slopes of 7° to 27° (1.5:12 to 6:12 pitch). Spacing requirements for other roof heights and/or slopes may vary.

DETAILS 16 AND 17 SHOWN ON SHEET 3 OF 4

METAL CARPORT INSTALLATION PLANS AND DETAILS
AND
FRAMING AND FASTENER SPECIFICATIONS

FOR CONSTRUCTION IN THE
STATE OF FLORIDA

PREPARED FOR:
CARPORTS ANYWHERE
P.O. BOX 776
STARKE, FL 32091

PREPARED BY:
BECHTOL ENGINEERING AND TESTING, INC.
605 WEST NEW YORK AVE.

Certificate of Authorization No. 00005492

CONCRETE:
Concrete shall have a Minimum Specified Compressive Strength of 2500 PSI at 28 Days.

COVER OVER REINFORCING STEEL:
For foundations, minimum concrete cover over reinforcing bars shall be:
3 inches in foundations where the concrete is cast against and permanently in contact with the earth or exposed to the weather, and
1 1/2 inches elsewhere. Reinforcing bars embedded in grouted cells shall have a minimum clear distance of 1 1/2 inches from the bottom of the cell. Reinforcing bars used in foundations shall have a minimum cover of 1 1/2 inches. For foundations cast against earth, the minimum cover shall be 1 1/2 inches for masonry units not exposed to earth or weather, and 2 inches for masonry units not exposed to earth or weather.

REINFORCING STEEL:
The reinforcing steel shall be minimum Grade 60.

WALL PENETRATIONS:
All wall penetrations for use in exterior wall construction and roof directly exposed to the weather shall be gasketed in accordance with ASTM A 183, Class 2E. Metal flash connections, screws, bolts and nuts exposed directly to the weather shall be stainless steel or hot dipped galvanized.

WEATHERING:
All waterproofing and weathering shall be in accordance with the following:

WEATHERING/ENCLOSURE MAY BE BUILT IN THE SHOP OR ON THE FIELD PROVIDE:
1. All waterproofing to be hot cold.
2. All waterproofing to be applied, measured on the inside of the liner, to be uniform from top to bottom, and
3. All waterproofing to be properly embedded in concrete and steel and wall.

EXCEPTION:
When waterproofing is necessary to align down flow with a vertical wall, the waterproofing in concrete shall be permitted to be built as a slope of one foot from a vertical wall to a horizontal alignment to 5 inches of vertical low slope.

SIXTH EDITION (2017). THE PLANS ARE VALID UNTIL THE NEXT REVISION OF THE FLORIDA BUILDING CODE

100

R H BECK

DEPT. OF ENGINEERING AND BUILDINGS
605 WEST NEW YORK AVENUE
DEI AND-EL GRINA 3272

Certificate of Authorization No. 549238
No. 38538

[Handwritten signature]

Florida License No. 38538
STATE OF FLORIDA

OFFICE OF THE
FLORIDA
ENGINEER



BOBTE ANIMALHEALTH INC

... ..

RECEIVED DOWLING

DRUMS	MIK8	SCALE
PERCENT		WOL LAB

APPROVED TB	SHE
-------------	-----

CARPORTS ANYWHERE, INC.

ENCLOSED BUILDING



BECHTOL ENGINEERING
CONSULTING ENGINEERS, INC.
AND TESTING, INC.

CONSULTING ENGINEERS, ARCHITECTS, AND STRUCTURAL STEEL DESIGNERS
CORPORATION OF AMERICA, INC. 10000

DATE: 01/02/78

SCALE: NTS

PROJECT: G18002

SHEET 1 OF 4

BECHTOLD ENGINEERING AND TESTING, INC.
605 WEST CHANDLER AVENUE
CHANDLER, ARIZONA 85226
Certificate of Authorization No. 4493-28
Professional Engineer
State of Florida
Thomas Speduto, P.E.
Florida License No. 35856

TYPICAL SIDE ELEVATION
NOT TO SCALE

ROLL-UP DOOR
(As applicable)

SWINGING DOOR
(As applicable)

TYPICAL END ELEVATION

NOT TO SCALE

TYPICAL SIDE ELEVATION

NOT TO SCALE

Diagram illustrating the typical end elevation of a building. The structure features a gabled roof and a large roll-up door on the left side. A smaller swinging door is located on the right side. The diagram is labeled "TYPICAL END ELEVATION" and "NOT TO SCALE".

TYPICAL SIDE ELEVATION

NOT TO SCALE

TYPICAL SIDE ELEVATION
NOT TO SCALE

TYPICAL END ELEVATION

NOT TO SCALE

ROLL UP DOOR
(As applicable)

SWINGING DOOR
(As applicable)

TYPICAL END ELEVATION
NOT TO SCALE

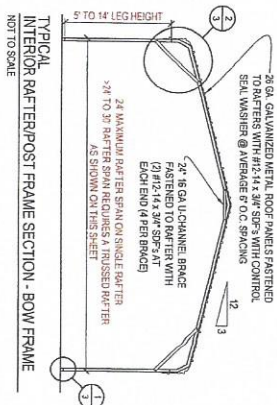

TYPICAL
INTERIOR RAFTER/POST FRAME SECTION - BOW FRAME
NOT TO SCALE

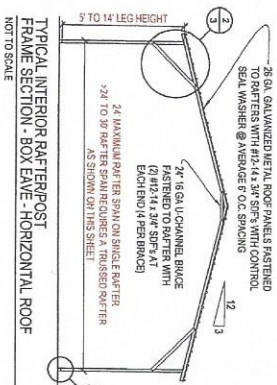

**TYPICAL INTERIOR RAFTER/POST
FRAME SECTION - BOX EAVE - HORIZONTAL ROOF**
NOT TO SCALE



TYPICAL INTERIOR
BATTERYPOST FRAME SECTION VERTICAL DOOR

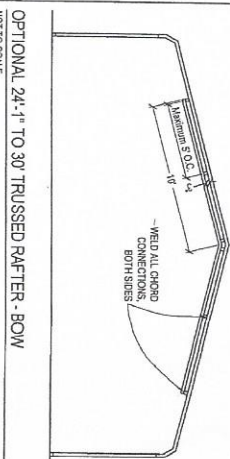

OPTIONAL 24'-1" TO 30' TRUSSED RAFTER - BOW

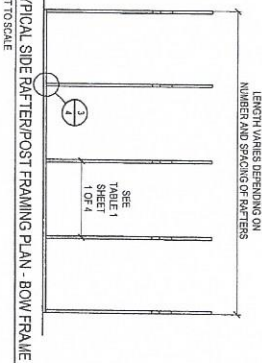

TYPICAL SIDE RAFTER/POST FRAMING PLAN - BOW FRAME
NOT TO SCALE

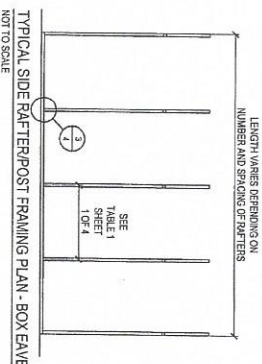

TYPICAL SIDE RAFTER/POST FRAMING PLAN - BOX EAVE
NOT TO SCALE

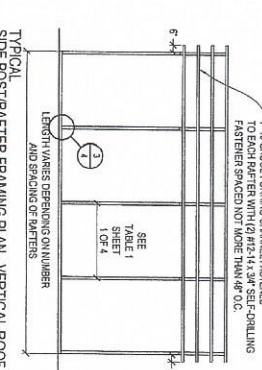

AND SPACING OF REINFORCING BARS

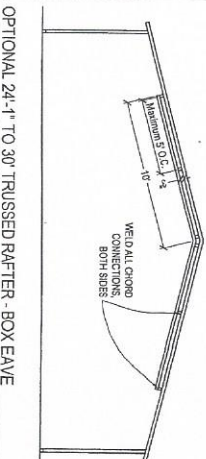

OPTIONAL 24'-1" TO 30' TRUSSED RAFTER - BOX EAVE

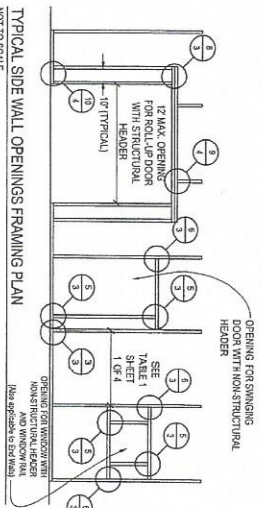

TYPICAL SIDE WALL OPENINGS FRAMING PLAN

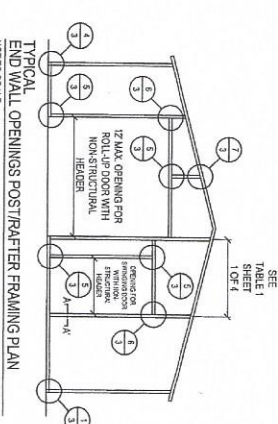

TYPICAL END WALL OPENINGS POST/RAFTER FRAMING PLAN

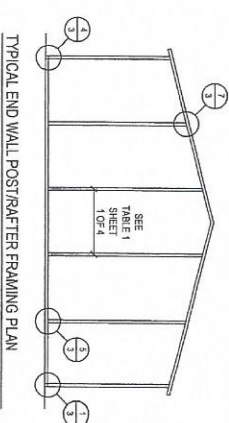

TYPICAL END WALL POST/RAFTER FRAMING PLAN

CARPORTS ANYWHERE INC.

ENCLOSED BUILDING

BECHTOL ENGINEERING

AND TESTING, Inc.
CONSULTING GEOTECHNICAL, ENVIRONMENTAL, AND MATERIALS TESTING DIVISION
Certificate of Accreditation No. 00000000

ORDER	78	PROVAL	G18002
AMOUNT	78		

CONSULTING SCIENTIFIC, ENGINEERING, AND LABORATORY TESTING SERVICES	10	G18002
Office of Acquisition Systems		

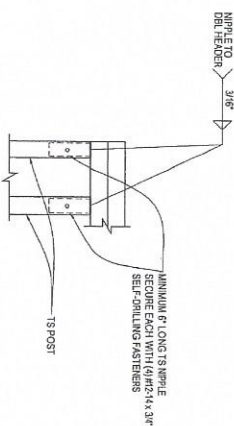
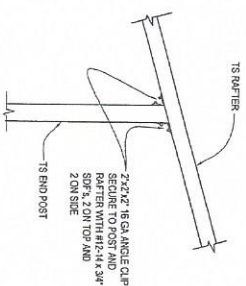
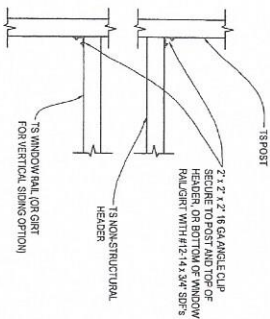
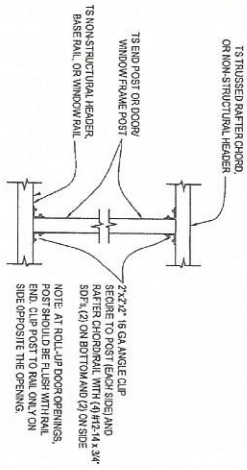
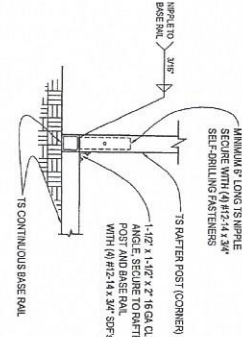
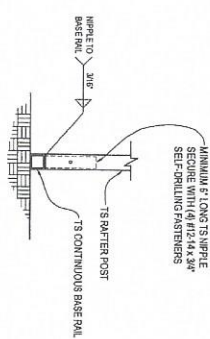
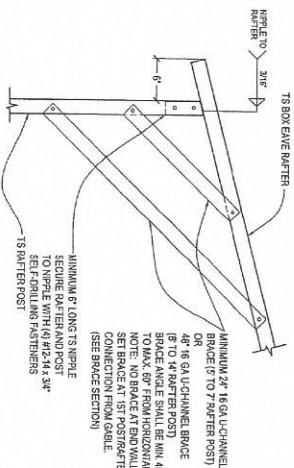
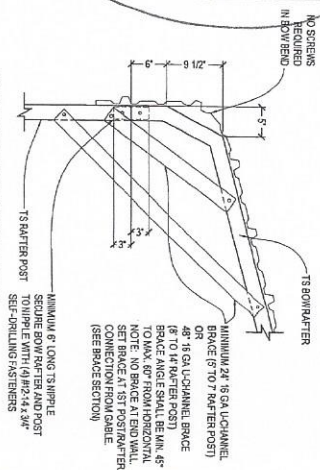
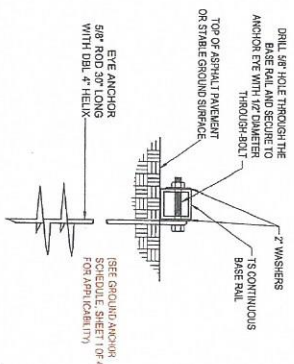
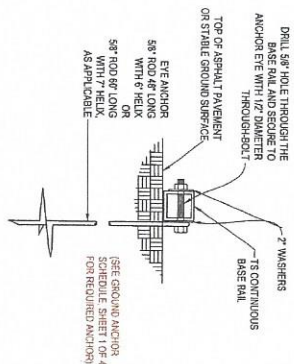
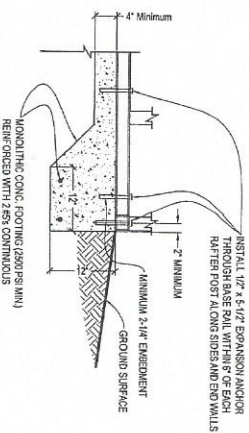

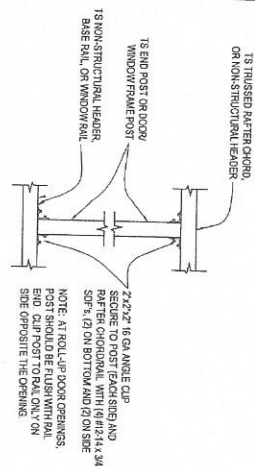

5
POST TO NON-STRUCTURAL HEADER, BASE RAIL, OR WINDOW RAIL CONNECTION DETAIL
Not To Scale

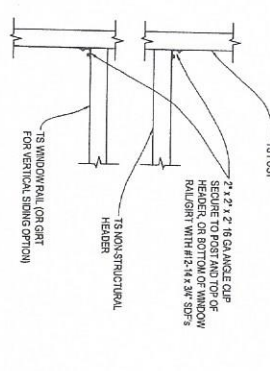

6
NON-STRUCTURAL HEADER OR WINDOW RAIL TO POST CONNECTION DETAIL
Not To Scale

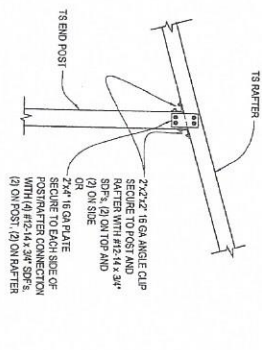

7
END POST/RAFTER CONNECTION DETAIL
Not To Scale

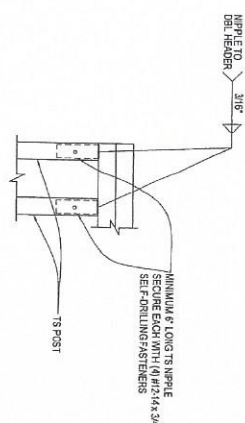

8
DBL HEADER/POST CONNECTION DETAIL
Not To Scale

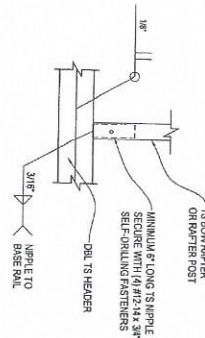

9
RAFTER POST/DBL HEADER CONNECTION DETAIL
Not To Scale

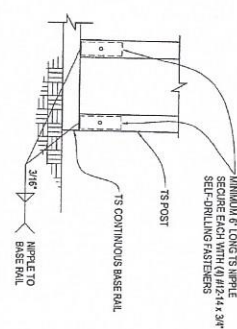

10
RAFTER POST/BASE RAIL CONNECTION DETAIL
Not To Scale

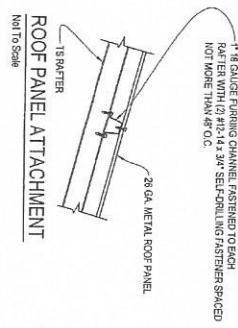
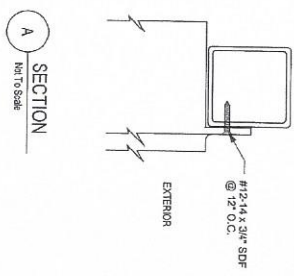
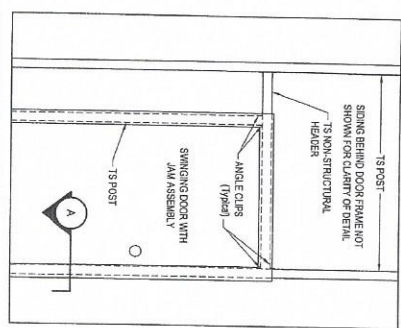

13
ROOF PANEL ATTACHMENT
Not To Scale

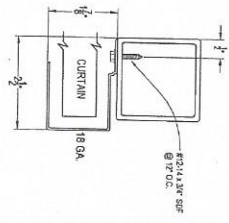

14
ROLL-UP DOOR GUIDE TO POST CONNECTION DETAIL
Not To Scale

CARPORTS ANYWHERE, INC.
ENCLOSED BUILDING

DATE	01/02/16
DESIGN	MDG
CHECK	NTS
PROJECT	TS
REVISION	TS
SHEET	4 OF 4

BECHTOL ENGINEERING AND TESTING, INC.
Professional Engineer
No. 38536
State of Florida
Professional Engineer

BOW FRAME RAFTER ENCLOSED BUILDING - HORIZONTAL ROOF

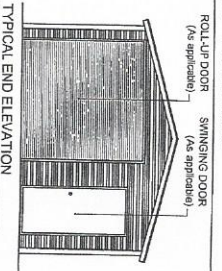
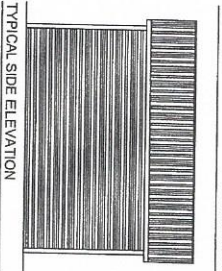
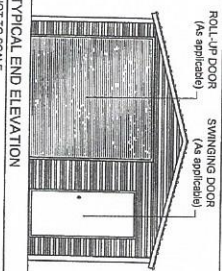
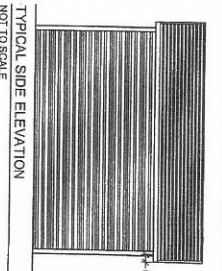
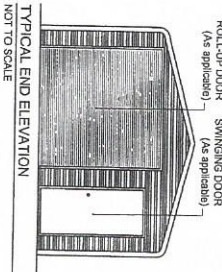
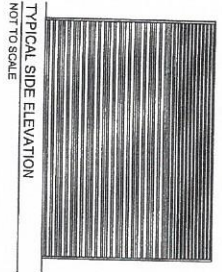

BOX EAVE FRAME RAFTER ENCLOSED BLDG - HORIZONTAL ROOF

BOX EAVE FRAME RAFTER ENCLOSED BLDG - VERTICAL ROOF

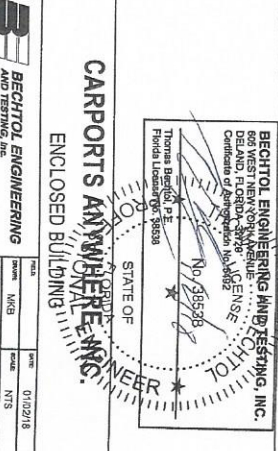
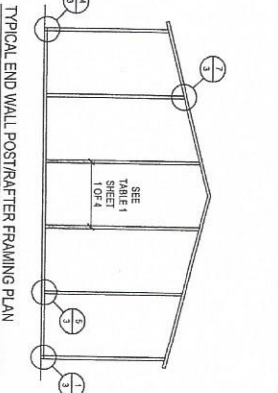
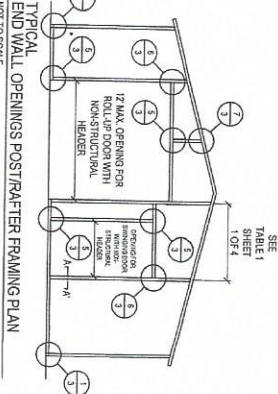
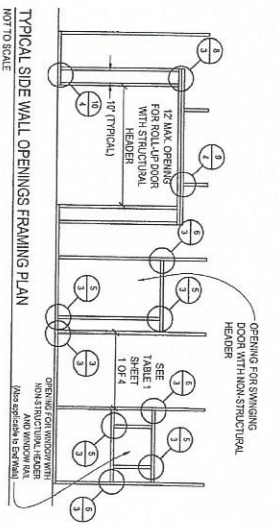
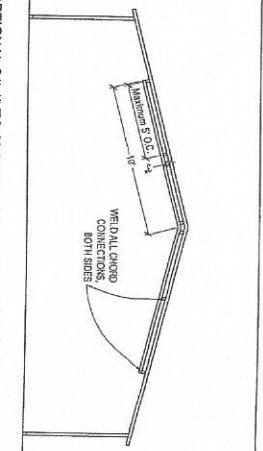
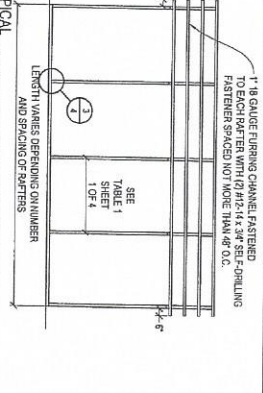
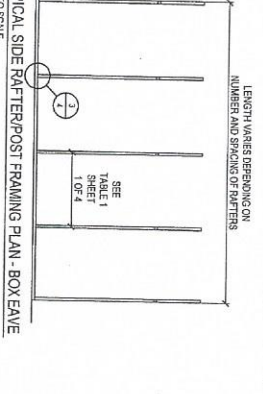
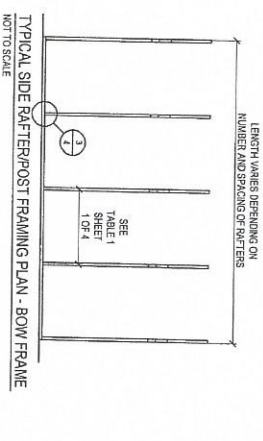
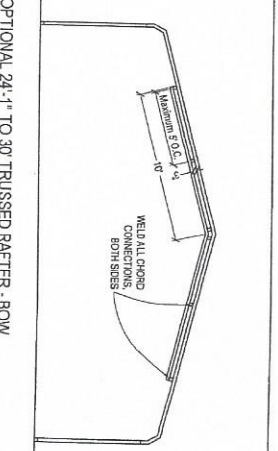
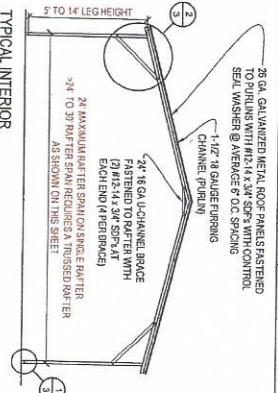
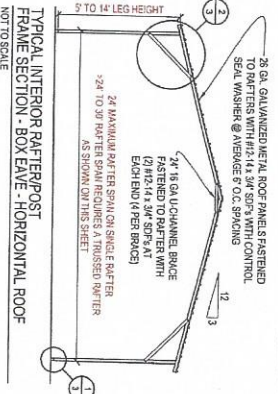
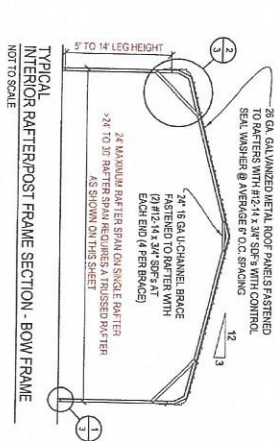

CARPORTS AND TRUCKS

ENCLOSED BUILDING

BECHTEL ENGINEERING AND TESTING, INC.

605 WEST MAIN STREET, SUITE 100
FARMINGTON, CT 06030
TEL: 860-671-1111
FAX: 860-671-1112
WWW.BECHTEL-ENGINEERING.COM

STATE OF

DESIGNED BY

NO. 385238

DATE 01/22/18

SCALE NTS

PROJECT TR

REV. Q1802

SHEET 2 OF 4

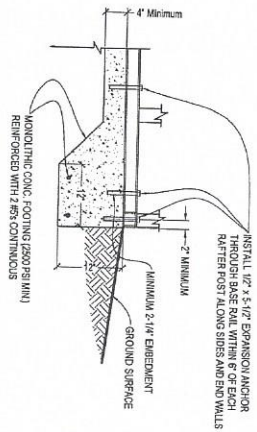

1A
Not To Scale
CONCRETE MONO SLAB BASE RAIL ANCHORAGE

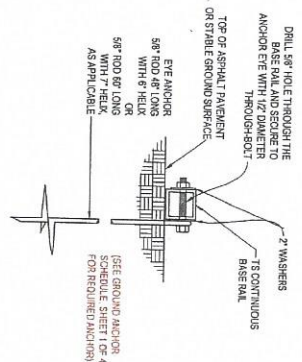

1B
Not To Scale
BASE RAIL DEEP ANCHORAGE

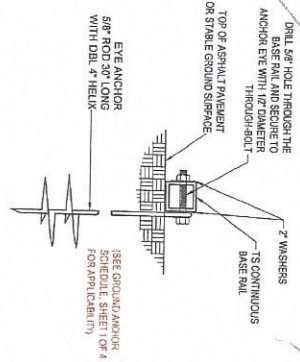

1C
Not To Scale
BASE RAIL ANCHORAGE

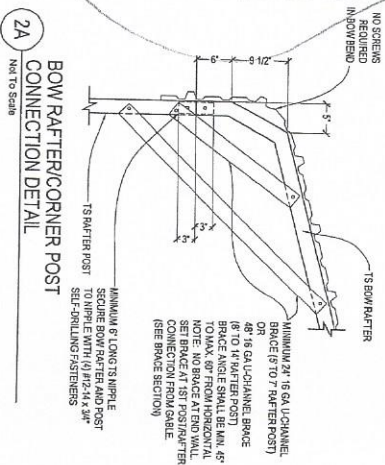

2A
Not To Scale
BOW RAFTER/CORNER POST CONNECTION DETAIL

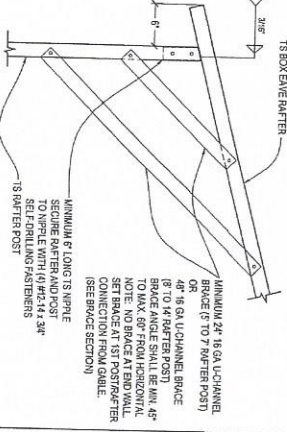

2B
Not To Scale
BOX EAVE RAFTER/CORNER POST CONNECTION DETAIL

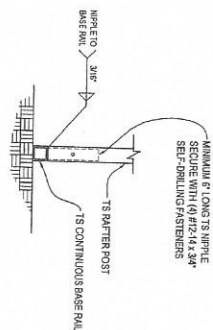

3
Not To Scale
RAFTER POST/ BASE RAIL CONNECTION DETAIL

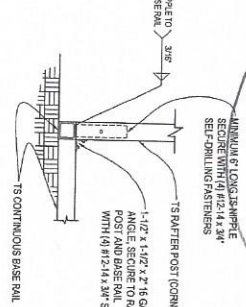

4
Not To Scale
END POST/BASE RAIL CONNECTION DETAIL

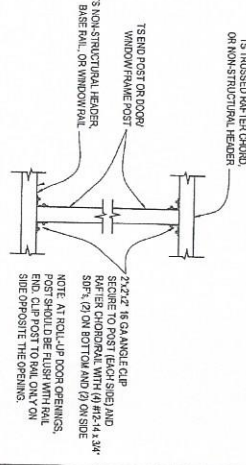

5
Not To Scale
POST TO NON-STRUCTURAL HEADER, BASE RAIL, OR WINDOW RAIL CONNECTION DETAIL

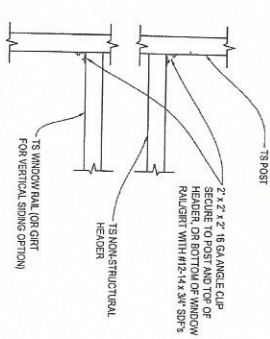

6
Not To Scale
NON-STRUCTURAL HEADER OR WINDOW RAIL TO POST CONNECTION DETAIL

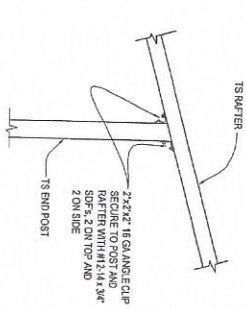

7
Not To Scale
END POST/RAFTER CONNECTION DETAIL

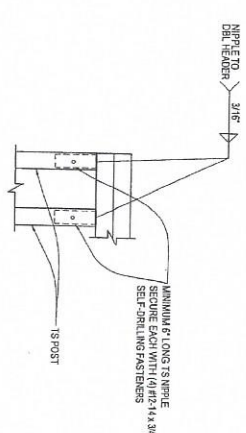

8
Not To Scale
DBL HEADER/POST CONNECTION DETAIL

CARPORTS ANYWHERE, INC.

ENCLOSED BUILDING

BECHTOL ENGINEERING AND TESTING, INC.

605 WEST NEW YORK AVENUE, 2ND FLOOR
CHICAGO, ILLINOIS 60610
TEL: 312.467.1100
FAX: 312.467.1101
WWW.BECHTOL.COM

DATE: 01/20/18

BY: MJD

CHKD: NTS

PROJECT: 010002

SHEET 3 OF 4

STATE OF FLORIDA

PROFESSIONAL ENGINEER

Thomas Bechtol, P.E.

Florida License No. 38538

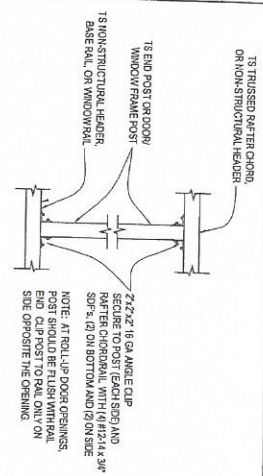

5
Not To Scale
POST TO NON-STRUCTURAL HEADER, BASE RAIL, OR WINDOW RAIL CONNECTION DETAIL

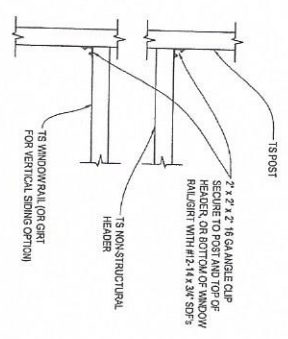

6
Not To Scale
NON-STRUCTURAL HEADER OR WINDOW RAIL TO POST CONNECTION DETAIL

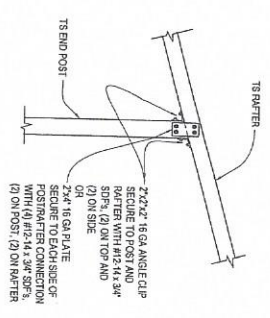

7
Not To Scale
END POST/RAFTER CONNECTION DETAIL

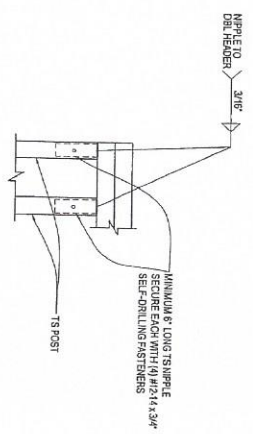

8
Not To Scale
DBL HEADER/POST CONNECTION DETAIL

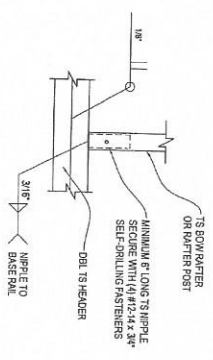

9
Not To Scale
RAFTER POST/DBL HEADER CONNECTION DETAIL

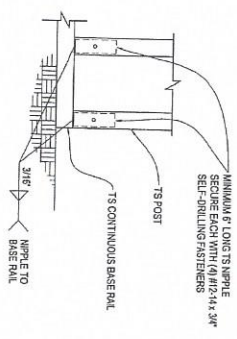

10
Not To Scale
RAFTER POST/BASE RAIL CONNECTION DETAIL

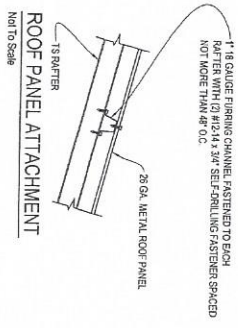
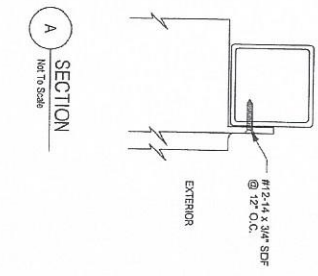
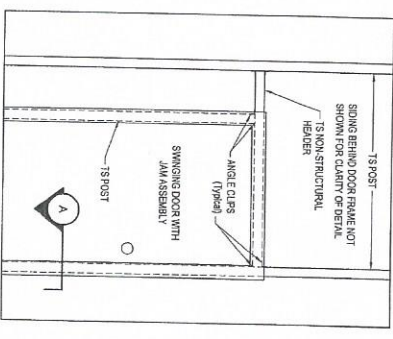

ROLL-UP DOOR GUIDE TO POST CONNECTION DETAIL

Not To Scale
CLIP: 26 GA. ENCLOSED DETAIL
based on epoxy primer & polyurethane top coat

CARPORTS ANYWHERE, INC.

ENCLOSED BUILDING

BECHTOL ENGINEERING AND TESTING, INC.

Professional Engineer

Florida License No. 38538

Thomas Bechtol, P.E.

BECHTOL ENGINEERING AND TESTING, INC.

Professional Engineer

Florida License No. 38538

Thomas Bechtol, P.E.

DATE	BY	REVISION
01/02/18	NTS	REVISION 1
01/02/18	NTS	REVISION 2
01/02/18	NTS	REVISION 3

SHEET 4 OF 4