

App#: 47353

Permit #: 40586

Columbia County Property Appraiser

Jeff Hampton

2020 Preliminary Certified

updated: 8/12/2020

Parcel: << **34-6S-16-04063-001** >>

Owner & Property Info

Owner	LISA'S LAND LLC 494 SW DORTCH ST FORT WHITE, FL 32038		
Site	6064 COUNTY ROAD 18, FORT WHITE		
Description*	COMM NE COR OF SE1/4, RUN S 613.75 FT FOR POB, RUN W 1700.78 FT, N 668.06 FT TO S R/W OF CR-18, W ALONG R/W 325.09 FT, S 672.99 FT, W 323.35 FT, N 677.89 FT TO S R/W OF CR-18, W ALONG R/W 146.63 FT TO PT ON CURVE, W ALONG CURVE 1006.92 FT, W STILL ALONG CU ...more>>>		
Area	97.39 AC	S/T/R	34-6S-16
Use Code**	IMPROVED A (005000)	Tax District	3

*The Description above is not to be used as the Legal Description for this parcel in any legal transaction.

**The Use Code is a FL Dept. of Revenue (DOR) code and is not maintained by the Property Appraiser's office. Please contact your city or county Planning & Zoning office for specific zoning information.

Property & Assessment Values

2019 Certified Values		2020 Preliminary Certified	
Mkt Land (0)	\$0	Mkt Land (0)	\$0
Ag Land (2)	\$23,448	Ag Land (2)	\$23,688
Building (0)	\$0	Building (0)	\$0
XFOB (0)	\$0	XFOB (0)	\$0
Just	\$286,109	Just	\$286,109
Class	\$23,448	Class	\$23,688
Appraised	\$23,448	Appraised	\$23,688
SOH Cap [?]	\$0	SOH Cap [?]	\$0
Assessed	\$23,448	Assessed	\$23,688
Exempt	\$0	Exempt	\$0
Total Taxable	county:\$23,448 city:\$23,448 other:\$23,448 school:\$23,448	Total Taxable	county:\$23,688 city:\$23,688 other:\$23,688 school:\$23,688

Aerial Viewer Pictometry Google Maps

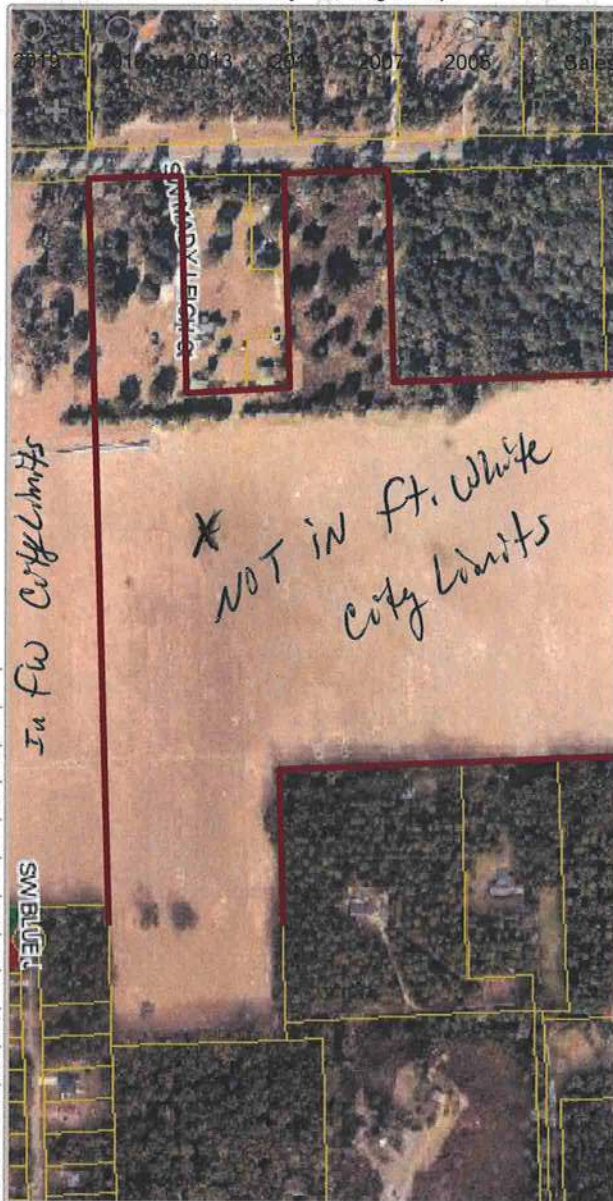

▼ Sales History

Sale Date	Sale Price	Book/Page	Deed	V/I	Quality (Codes)	RCode
7/12/2016	\$1,000	1318/1281	WD	V	Q	01
12/23/2015	\$0	1307/0039	PB	I	U	18
6/17/1997	\$100	841/0513	WD	I	U	01
11/1/1981	\$14,500	479/0082	WD	V	Q	

▼ Building Characteristics

Bldg Sketch	Bldg Item	Bldg Desc*	Year Blt	Base SF	Actual SF	Bldg Value
NONE						

▼ Extra Features & Out Buildings (Codes)