

56



STATE OF FLORIDA
DEPARTMENT OF ENVIRONMENTAL PROTECTION
ONSITE SEWAGE TREATMENT AND DISPOSAL
SYSTEM (OSTDS)

PERMIT NO. _____
DATE PAID: _____
FEE PAID: _____
RECEIPT #: _____

APPLICATION FOR CONSTRUCTION PERMIT

APPLICATION FOR:

[☒] New System [] Existing System [] Holding Tank [] Innovative
[] Repair [] Abandonment [] Temporary [] _____

APPLICANT: John Wayne Raulerson (Simgue Homes) EMAIL: _____

AGENT: Tommy Jones TELEPHONE: 352-221-4473

MAILING ADDRESS: 1490 NE 130th St. Trenton, FL. 32693

TO BE COMPLETED BY APPLICANT OR APPLICANT'S AUTHORIZED AGENT. SYSTEMS MUST BE CONSTRUCTED BY A PERSON LICENSED PURSUANT TO 489.105(3)(m) OR 489.552, FLORIDA STATUTES. IT IS THE APPLICANT'S RESPONSIBILITY TO PROVIDE DOCUMENTATION OF THE DATE THE LOT WAS CREATED OR PLATTED (MM/DD/YY) IF REQUESTING CONSIDERATION OF STATUTORY GRANDFATHER PROVISIONS.

PROPERTY INFORMATION

OSTDS REMEDIATION PLAN? [☒] / N]

LOT: 9 BLOCK: _____ SUBDIVISION: Forest Country 6th Ald. PLATTED: _____

PROPERTY ID #: 21-45-16-03087-109 ZONING: _____ I/M OR EQUIVALENT: [Y / ☒]

PROPERTY SIZE: .63 ACRES WATER SUPPLY: [☒] PRIVATE PUBLIC [] $\leq 2000\text{GPD}$ [] $> 2000\text{GPD}$

IS SEWER AVAILABLE AS PER 381.0065, FS? [Y / ☒] DISTANCE TO SEWER: _____ FT

PROPERTY ADDRESS: 369 SW Pinchurst Dr. Lake City 32024

DIRECTIONS TO PROPERTY: Take 247 S, TL on Monk, TR on Long Leaf
TL on Pinchurst to property on L.

BUILDING INFORMATION

[☒] RESIDENTIAL [] COMMERCIAL

Unit No	Type of Establishment	No. of Bedrooms	Building Area Sqft	Commercial/Institutional System Design Table I, Chapter 62-6, FAC
1	<u>SFR</u>	<u>4</u>	<u>1926</u>	
2				
3				
4				

[] Floor/Equipment Drains [] Other (Specify) _____

SIGNATURE: [Signature] DATE: 11-29-23



STATE OF FLORIDA
DEPARTMENT OF ENVIRONMENTAL PROTECTION
ON-SITE SEWAGE TREATMENT AND DISPOSAL SYSTEM

PERMIT NO. _____

SITE EVALUATION AND SYSTEM SPECIFICATIONS

APPLICANT: John Wayne Raulerson AGENT: Jones Plumbing
LOT: 9 BLOCK: _____ SUBDIVISION: Forest Country 6th Add
PROPERTY ID #: 03087-109 [Section/Township/Parcel No. or Tax ID Number]

TO BE COMPLETED BY ENGINEER, HEALTH DEPARTMENT EMPLOYEE, OR OTHER QUALIFIED PERSON. ENGINEERS MUST PROVIDE REGISTRATION NUMBER AND SIGN AND SEAL EACH PAGE OF SUBMITTAL. COMPLETE ALL ITEMS.

PROPERTY SIZE CONFORMS TO SITE PLAN: ☒ YES ☐ NO NET USABLE AREA AVAILABLE: .63 ACRES
TOTAL ESTIMATED SEWAGE FLOW: 400 GALLONS PER DAY (TABLE / OTHER)
AUTHORIZED SEWAGE FLOW: 945 GALLONS PER DAY (1500 GPD/ACRE OR 2500 GPD/ACRE)
UNOBSTRUCTED AREA AVAILABLE: 1500 SQFT UNOBSTRUCTED AREA REQUIRED: 563 SQFT

BENCHMARK/REFERENCE POINT LOCATION: Surveyors BM near site
ELEVATION OF PROPOSED SYSTEM SITE IS 27 (INCHES/FT) [ABOVE/BELOW] BENCHMARK/REFERENCE POINT

THE MINIMUM SETBACK WHICH CAN BE MAINTAINED FROM THE PROPOSED SYSTEM TO THE FOLLOWING FEATURES
SURFACE WATER: NA FT DITCHES/SWALES: 105 FT NORMALLY WET? ☐ YES ☒ NO
WELLS: PUBLIC: NA FT LIMITED USE: NA FT PRIVATE: 100 FT NON-POTABLE: NA FT
BUILDING FOUNDATIONS: 6 FT PROPERTY LINES: 10 FT POTABLE WATER LINES: 60 FT

SITE SUBJECT TO FREQUENT FLOODING: ☐ YES ☒ NO 10 YEAR FLOODING? ☐ YES ☒ NO
10 YEAR FLOOD ELEVATION FOR SITE: _____ FT MSL/NGVD SITE ELEVATION: _____ FT MSL/NGVD

SOIL PROFILE INFORMATION SITE 1

MUNSELL #/COLOR	TEXTURE	DEPTH
10YR 5/1	F3	0 TO 12
10YR 7/3	F3	12 TO 42
10YR 8/2	F3	42 TO 72
10YR		TO
		TO
		TO
		TO
		TO
		TO
USDA SOIL SERIES: <u>Bonneau</u>		

SOIL PROFILE INFORMATION SITE 2

MUNSELL #/COLOR	TEXTURE	DEPTH
10YR 5/1	F3	0 TO 12
10YR 7/3	F3	12 TO 36
10YR 8/2	F3	36 TO 60
10YR 7/4	SL	60 TO 72
		TO
		TO
		TO
		TO
		TO
		TO
USDA SOIL SERIES: <u>Bonneau</u>		

OBSERVED WATER TABLE: NA INCHES [ABOVE / BELOW] EXISTING GRADE. TYPE: [PERCHED / APPARENT]
ESTIMATED WET SEASON WATER TABLE ELEVATION: 27.2 INCHES [ABOVE / BELOW] EXISTING GRADE
HIGH WATER TABLE VEGETATION: ☐ YES ☒ NO WSWT INDICATOR: ☐ YES ☒ NO DEPTH: _____ INCHES

SOIL TEXTURE/LOADING RATE FOR SYSTEM SIZING: F3 (8) DEPTH OF EXCAVATION: NA INCHES
DRAINFIELD CONFIGURATION: ☒ TRENCH ☐ BED ☐ OTHER (SPECIFY) _____
REMARKS/ADDITIONAL CRITERIA: _____

SITE EVALUATED BY: Harmon Keen CEHP-23-2064 DATE: 11-29-23

DEP 4015, 06-21-2022 (Obsoletes previous editions which may not be used)

Incorporated: 62-6.004, FAC

Rauterson
369 SW Pinchurst
Lake City
(Singer)

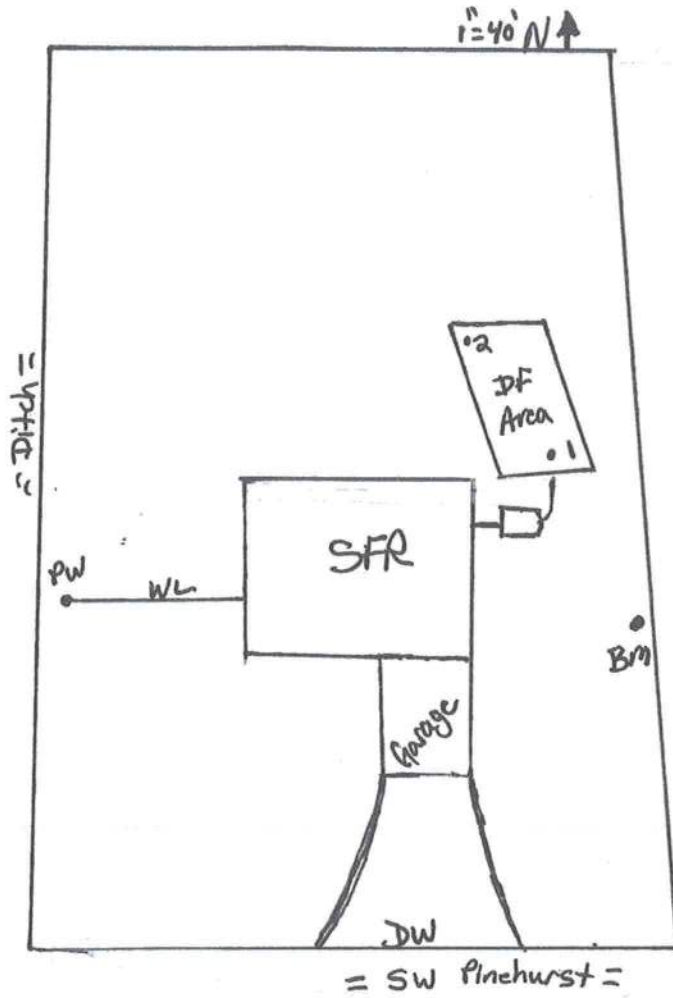

✓
11/17/03

Home on Keen
232064