

REVISIONS	

WINDLOAD ENGINEER:
Mark Disosway, P.E.
No. 53915, POB 868, Lake City, FL 32056,
386-754-5419

DIMENSIONS:
Stated dimensions supercede scaled
dimensions. Refer all questions to
Mark Disosway, P.E. for resolution.
Do not proceed without clarification.

COPYRIGHTS AND PROPERTY RIGHTS:
Mark Disosway, P.E. hereby expressly
reserves its common law copyrights and
property right in these instruments of service.
This document is not to be reproduced, altered
or copied in any form or manner without first
the express written permission and consent
of Mark Disosway.

CERTIFICATION: I hereby certify that I have
examined this plan, and that the applicable
portions of the plan, relating to
wind engineering comply with section
R301.2.1, Florida building code
residential 2007,
to the best of my knowledge.

LIMITATION: This design is valid for one
building, at location of project.



Bob Jordan
Residence

ADDRESS:
Hills of Windsor S/D
Lake City, Florida
Columbia County, FL

Mark Disosway P.E.
P.O. Box 868
Lake City, Florida 32056
Phone: (386) 754 - 5419
Fax: (386) 269 - 4871

PRINTED DATE:
May 04, 2012
DRAWN BY: STRUCTURAL BY:
Evan Beamsley

FINALS DATE:
2011-12-01

JOB NUMBER:
1111068
DRAWING NUMBER

S-3

OF 3 SHEETS

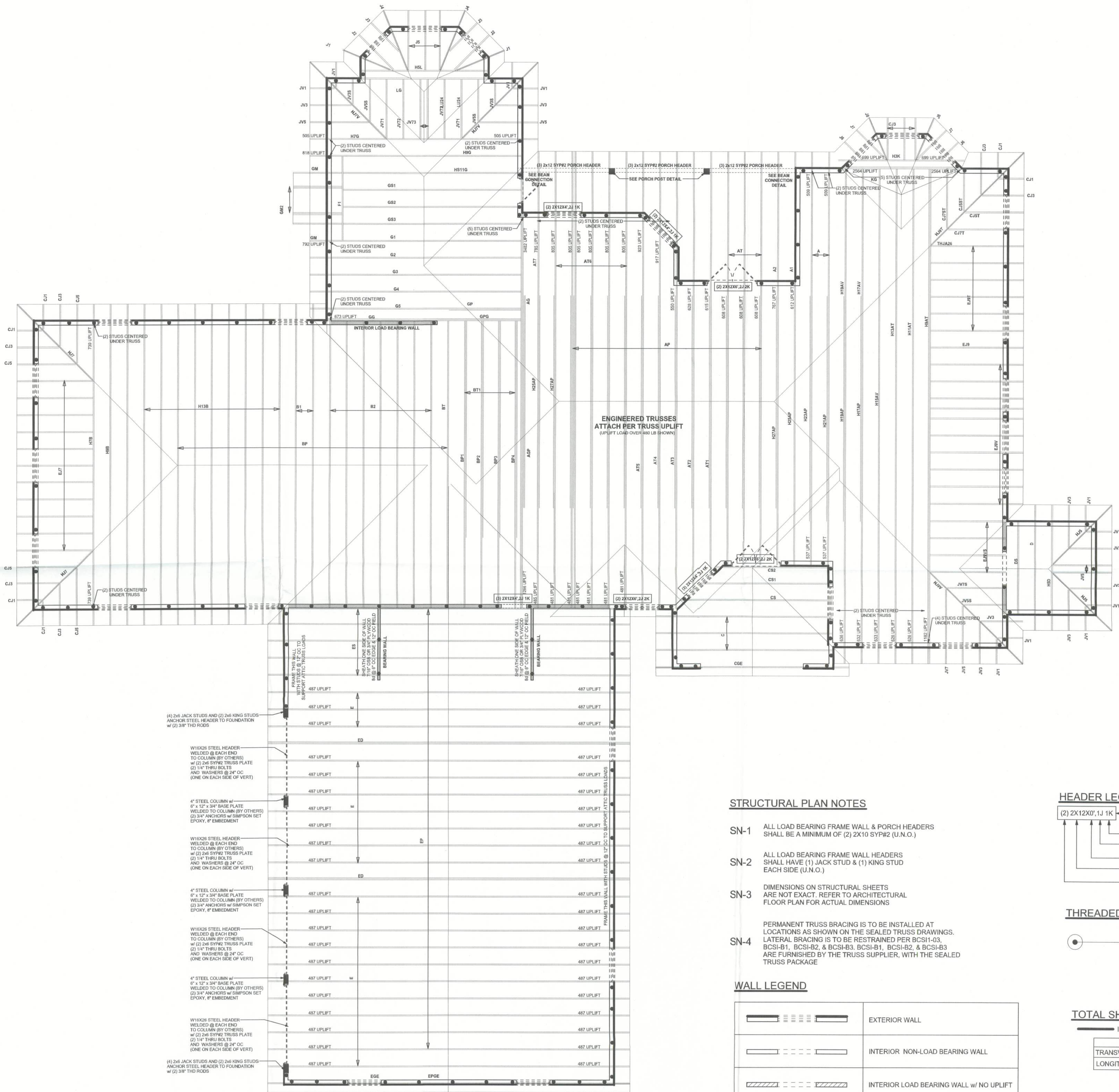

(4) 2x6 JACK STUDS AND (2) 2x6 KING STUDS
ANCHOR STEEL HEADER TO FOUNDATION
w/ (2) 3/8" THD RODS

W18X26 STEEL HEADER
WELDED @ EACH END
TO COLUMN (BY OTHERS)
w/ (2) 2x6 SYP#2 TRUSS PLATE
(2) 1/4" THRU BOLTS
AND WASHERS @ 24" OC
(ONE ON EACH SIDE OF VERT)

4" STEEL COLUMN w/
6" x 12" x 3/8" BASE PLATE
WELDED TO COLUMN (BY OTHERS)
(2) 3/4" ANCHORS w/ SHIMSON SET
EPOXY, 8" EMBEDMENT

W18X26 STEEL HEADER
WELDED @ EACH END
TO COLUMN (BY OTHERS)
w/ (2) 2x6 SYP#2 TRUSS PLATE
(2) 1/4" THRU BOLTS
AND WASHERS @ 24" OC
(ONE ON EACH SIDE OF VERT)

4" STEEL COLUMN w/
6" x 12" x 3/8" BASE PLATE
WELDED TO COLUMN (BY OTHERS)
(2) 3/4" ANCHORS w/ SHIMSON SET
EPOXY, 8" EMBEDMENT

W18X26 STEEL HEADER
WELDED @ EACH END
TO COLUMN (BY OTHERS)
w/ (2) 2x6 SYP#2 TRUSS PLATE
(2) 1/4" THRU BOLTS
AND WASHERS @ 24" OC
(ONE ON EACH SIDE OF VERT)

4" STEEL COLUMN w/
6" x 12" x 3/8" BASE PLATE
WELDED TO COLUMN (BY OTHERS)
(2) 3/4" ANCHORS w/ SHIMSON SET
EPOXY, 8" EMBEDMENT

W18X26 STEEL HEADER
WELDED @ EACH END
TO COLUMN (BY OTHERS)
w/ (2) 2x6 SYP#2 TRUSS PLATE
(2) 1/4" THRU BOLTS
AND WASHERS @ 24" OC
(ONE ON EACH SIDE OF VERT)

(4) 2x6 JACK STUDS AND (2) 2x6 KING STUDS
ANCHOR STEEL HEADER TO FOUNDATION
w/ (2) 3/8" THD RODS