

DATE 02/07/2012

Columbia County Building Permit

PERMIT

This Permit Must Be Prominently Posted on Premises During Construction

000029918

APPLICANT WILLET M. HAYS PHONE 352-372-6597
ADDRESS 186 SW FENNIGAN WAY LAKE CITY FL 32025
OWNER WILLET M. HAYS PHONE 352-372-6597
ADDRESS 186 SW FENNIGAN WAY LAKE CITY FL 32025
CONTRACTOR OWNER PHONE _____
LOCATION OF PROPERTY 90 W, L 341, L ON LOCKHEED LN (N ENTRANCE OF CANNON CREEK
AIRPARK) R FENNIGAN WAY, 1ST DRIVE ON RIGHT BACK TO SITE
TYPE DEVELOPMENT METAL STORAGE BLDG ESTIMATED COST OF CONSTRUCTION 9200.00
HEATED FLOOR AREA _____ TOTAL AREA _____ HEIGHT 12.00 STORIES 1
FOUNDATION SLAB WALLS METAL ROOF PITCH 3/12 FLOOR SLAB
LAND USE & ZONING RSF-2 MAX. HEIGHT 35
Minimum Set Back Requirments: STREET-FRONT 25.00 REAR 15.00 SIDE 10.00
NO. EX.D.U. 1 FLOOD ZONE X DEVELOPMENT PERMIT NO. _____

PARCEL ID 12-4S-16-02935-108 SUBDIVISION CANNON CREEK ESTATES
LOT 8-W BLOCK _____ PHASE _____ UNIT _____ TOTAL ACRES 3.20

Culvert Permit No. _____ Culvert Waiver _____ Contractor's License Number _____ Applicant/Owner/Contractor _____
EXISTING NA BK TC N
Driveway Connection _____ Septic Tank Number _____ LU & Zoning checked by _____ Approved for Issuance _____ New Resident _____

COMMENTS: NOC ON FILE

Check # or Cash 571

FOR BUILDING & ZONING DEPARTMENT ONLY

(footer/Slab)

Temporary Power _____ Foundation _____ Monolithic _____
date/app. by _____ date/app. by _____ date/app. by _____
Under slab rough-in plumbing _____ Slab _____ Sheathing/Nailing _____
date/app. by _____ date/app. by _____ date/app. by _____
Framing _____ Insulation _____
date/app. by _____ date/app. by _____
Rough-in plumbing above slab and below wood floor _____ Electrical rough-in _____
date/app. by _____ date/app. by _____
Heat & Air Duct _____ Peri. beam (Lintel) _____ Pool _____
date/app. by _____ date/app. by _____ date/app. by _____
Permanent power _____ C.O. Final _____ Culvert _____
date/app. by _____ date/app. by _____ date/app. by _____
Pump pole _____ Utility Pole _____ M/H tie downs, blocking, electricity and plumbing _____
date/app. by _____ date/app. by _____ date/app. by _____
Reconnection _____ RV _____ Re-roof _____
date/app. by _____ date/app. by _____ date/app. by _____

BUILDING PERMIT FEE \$ 50.00 CERTIFICATION FEE \$ 0.00 SURCHARGE FEE \$ 0.00
MISC. FEES \$ 0.00 ZONING CERT. FEE \$ 50.00 FIRE FEE \$ 0.00 WASTE FEE \$ _____
FLOOD DEVELOPMENT FEE \$ _____ FLOOD ZONE FEE \$ _____ CULVERT FEE \$ _____ TOTAL FEE 100.00
INSPECTORS OFFICE Z. H. CLERKS OFFICE CH

NOTICE: IN ADDITION TO THE REQUIREMENTS OF THIS PERMIT, THERE MAY BE ADDITIONAL RESTRICTIONS APPLICABLE TO THIS PROPERTY THAT MAY BE FOUND IN THE PUBLIC RECORDS OF THIS COUNTY. AND THERE MAY BE ADDITIONAL PERMITS REQUIRED FROM OTHER GOVERNMENTAL ENTITIES SUCH AS WATER MANAGEMENT DISTRICTS, STATE AGENCIES, OR FEDERAL AGENCIES.

"WARNING TO OWNER: YOUR FAILURE TO RECORD A NOTICE OF COMMENCEMENT MAY RESULT IN YOUR PAYING TWICE FOR IMPROVEMENTS TO YOUR PROPERTY. IF YOU INTEND TO OBTAIN FINANCING, CONSULT WITH YOUR LENDER OR AN ATTORNEY BEFORE RECORDING YOUR NOTICE OF COMMENCEMENT."

EVERY PERMIT ISSUED SHALL BECOME INVALID UNLESS THE WORK AUTHORIZED BY SUCH PERMIT IS COMMENCED WITHIN 180 DAYS AFTER ITS ISSUANCE, OR IF THE WORK AUTHORIZED BY SUCH PERMIT IS SUSPENDED OR ABANDONED FOR A PERIOD OF 180 DAYS AFTER THE TIME THE WORK IS COMMENCED. A VALID PERMIT RECIEVES AN APPROVED INSPECTION EVERY 180 DAYS. WORK SHALL BE CONSIDERED NOT SUSPENDED, ABANDONED OR INVALID WHEN THE PERMIT HAS RECIEVED AN APPROVED INSPECTION WITHIN 180 DAYS OT THE PREVIOUS INSPECTION.

The Issuance of this Permit Does Not Waive Compliance by Permittee with Deed Restrictions.

10.00
1,379.00
197,000.00

This Instrument Prepared by & return to:

Name: **TRISH LANG, an employee of
NORTH CENTRAL FLORIDA TITLE,
LLC**

Address: **343 NW COLE TERRACE, SUITE 101
LAKE CITY, FLORIDA 32055
File No. 10Y-10006TL**

Parcel I.D. #: **02935-108**

Inst:201012016657 Date:10/14/2010 Time:4:08 PM

Doc Stamp-Deed:1379.00

DC,P.DeWitt Cason,Columbia County Page 1 of 1 B:1203 P:252

SPACE ABOVE THIS LINE FOR PROCESSING DATA

SPACE ABOVE THIS LINE FOR RECORDING DATA

THIS WARRANTY DEED Made the **13th** day of **October, A.D. 2010**, by **DOROTHY B. BURROUGHS, A WIDOW**, hereinafter called the grantor, to **WILLET M. HAYS**, whose post office address is **6222 NW 24TH LANE, GAINESVILLE, FLORIDA 32606**, hereinafter called the grantee:

(Wherever used herein the terms "grantor" and "grantee" include all the parties to this instrument, singular and plural, the heirs, legal representatives and assigns of individuals, and the successors and assigns of corporations, wherever the context so admits or requires.)

Witnesseth: That the grantor, for and in consideration of the sum of \$10.00 and other valuable consideration, receipt whereof is hereby acknowledged, does hereby grant, bargain, sell, alien, remise, release, convey and confirm unto the grantee all that certain land situate in **Columbia County, State of Florida**, viz:

LOT 8 WEST:

COMMENCE AT THE SE CORNER OF LOT 8 "CANNON CREEK ESTATES" AS RECORDED IN PLAT BOOK 5, PAGE 60 AND 60A OF THE PUBLIC RECORDS OF COLUMBIA COUNTY, FLORIDA, THENCE S 87°32'28" W, ALONG THE SOUTH LINE OF SAID LOT 8, 275.49 FEET TO THE POINT OF BEGINNING, THENCE CONTINUE S 87°32'28" W, 385.73 FEET TO THE SW CORNER OF LOT 8, THENCE N 4° 50' 15" E ALONG THE WEST LINE OF SAID LOT 8, 350.0 FEET TO THE NW CORNER OF SAID LOT 8; THENCE N 86°36'53" E ALONG THE NORTH LINE OF SAID LOT 8, 607.32 FEET TO A POINT OF CURVE OF A CURVE TO THE RIGHT HAVING A RADIUS OF 289.00 FEET, AND AN INCLUDED ANGLE OF 12°13'47"; THENCE SOUTHERLY ALONG THE ARC OF SAID CURVE AN ARC DISTANCE OF 61.69 FEET; THENCE S 86° 36' 53" W, 312.00 FEET; THENCE S 8° 33' 22" E, 293.84 FEET TO THE POINT OF BEGINNING. COLUMBIA COUNTY, FLORIDA.

SUBJECT TO AN INGRESS AND EGRESS EASEMENT AND TAXIWAY OVER AND ACROSS THE NORTH 60.0 FEET AND THE WEST 60.0 FEET THEREOF.

Together with all the tenements, hereditaments and appurtenances thereto belonging or in anywise appertaining.

To Have and to Hold the same in fee simple forever.

And the grantor hereby covenants with said grantee that she is lawfully seized of said land in fee simple; that she has good right and lawful authority to sell and convey said land, and hereby fully warrants the title to said land and will defend the same against the lawful claims of all persons whomsoever, and that said land is free of all encumbrances, except taxes accruing subsequent to December 31, 2009.

In Witness Whereof, the said grantor has signed and sealed these presents, the day and year first above written.

Signed, sealed and delivered in the presence of:

Witness Signature
Brenda Styons
Printed Name

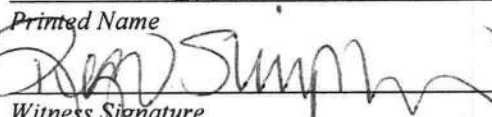
Witness Signature
Regine Simpkins
Printed Name

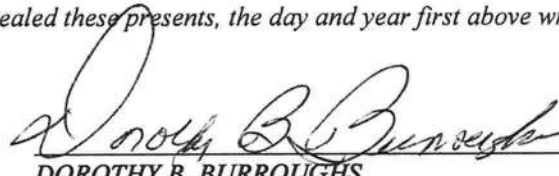
L.S.
DOROTHY B. BURROUGHS
Address:
**186 SW FENNIGAN WAY, LAKE CITY, FLORIDA
32025**

STATE OF FLORIDA
COUNTY OF COLUMBIA

The foregoing instrument was acknowledged before me this **13th** day of **October, 2010**, by **DOROTHY B. BURROUGHS**, who is known to me or who has produced _____ as identification.

Notary Public
My commission expires _____
Brenda Styons



BRENDA STYONS
MY COMMISSION # DD 745401
EXPIRES February 5, 2012
Bonded Thru Budget Notary Services

Columbia County Building Permit Application

For Office Use Only Application # 1201-45 Date Received 1-31-12 By LH Permit # 29918
 Zoning Official _____ Date 06 FEB 2012 Flood Zone X Land Use REIL-DEV Zoning RSF-2
 FEMA Map # N/A Elevation N/A MFE N/A River N/A Plans Examiner T.C. Date 2-2-12
 Comments _____
☒ NOC ☒ EH ☒ Deed or PA ☐ Site Plan ☐ State Road Info ☐ Well letter ☐ 911 Sheet ☐ Parent Parcel # _____
☐ Dev Permit # _____ ☐ In Floodway ☐ Letter of Auth. from Contractor ☐ F W Comp. letter
 IMPACT FEES: EMS _____ Fire _____ Corr _____ ☒ Sub VF Form
 Road/Code _____ School _____ = TOTAL (Suspended) ☒ App Fee Paid

Septic Permit No. NO septic Fax _____

Name Authorized Person Signing Permit Willet M. Hays Phone 352-372-6597

Address 186 SW Fennigan Way, Lake City, FL 32025

Owners Name Willet M. Hays Phone 352-372-6597

911 Address _____

Contractors Name N/A Phone _____

Address _____

Fee Simple Owner Name & Address N/A

Bonding Co. Name & Address N/A

Architect/Engineer Name & Address Omar Abu-Yasein (TNT Metal Buildings)

Mortgage Lenders Name & Address N/A

Circle the correct power company - FL Power & Light - Clay Elec. - Suwannee Valley Elec. - Progress Energy

Property ID Number 12-45-16-02935-108 Estimated Cost of Construction \$9200.00

Subdivision Name Cannon Creek Estates Lot 8W Block _____ Unit _____ Phase _____

Driving Directions Sisters Welcome Rd to N. entrance of Cannon Creek Airpark (Lockheed Ln).
Lockheed Lane to Fennigan Way. 1st driveway (P) - between trees

Number of Existing Dwellings on Property 2

Construction of Metal Storage Building Total Acreage 3.2 Lot Size _____

Do you need a - Culvert Permit or Culvert Waiver or Have an Existing Drive Total Building Height _____

Actual Distance of Structure from Property Lines - Front 280' Side 230' Side 110' Rear 43'

Number of Stories 1 Heated Floor Area 0 Total Floor Area 780 sf Roof Pitch 12/3

Application is hereby made to obtain a permit to do work and installations as indicated. I certify that no work or installation has commenced prior to the issuance of a permit and that all work be performed to meet the standards of all laws regulating construction in this jurisdiction. **CODE:** Florida Building Code 2007 with 2009 Supplements and the 2008 National Electrical Code. Page 1 of 2 (Both Pages must be submitted together.) Revised 1-11

ck# 571

Columbia County Building Permit Application

TIME LIMITATIONS OF APPLICATION : An application for a permit for any proposed work shall be deemed to have been abandoned 180 days after the date of filing, unless such application has been pursued in good faith or a permit has been issued; except that the building official is authorized to grant one or more extensions of time for additional periods not exceeding 90 days each. The extension shall be requested in writing and justifiable cause demonstrated.

TIME LIMITATIONS OF PERMITS: Every permit issued shall become invalid unless the work authorized by such permit is commenced within 180 days after its issuance, or if the work authorized by such permit is suspended or abandoned for a period of 180 days after the time work is commenced. A valid permit receives an approved inspection every 180 days. Work shall be considered not suspended, abandoned or invalid when the permit has received an approved inspection within 180 days of the previous approved inspection.

FLORIDA'S CONSTRUCTION LIEN LAW: Protect Yourself and Your Investment: According to Florida Law, those who work on your property or provide materials, and are not paid-in-full, have a right to enforce their claim for payment against your property. This claim is known as a construction lien. If your contractor fails to pay subcontractors or material suppliers or neglects to make other legally required payments, the people who are owed money may look to your property for payment, even if you have paid your contractor in full. This means if a lien is filed against your property, it could be sold against your will to pay for labor, materials or other services which your contractor may have failed to pay.

NOTICE OF RESPONSIBILITY TO BUILDING PERMITEE: **YOU ARE HEREBY NOTIFIED** as the recipient of a building permit from Columbia County, Florida, you will be held responsible to the County for any damage to sidewalks and/or road curbs and gutters, concrete features and structures, together with damage to drainage facilities, removal of sod, major changes to lot grades that result in ponding of water, or other damage to roadway and other public infrastructure facilities caused by you or your contractor, subcontractors, agents or representatives in the construction and/or improvement of the building and lot for which this permit is issued. No certificate of occupancy will be issued until all corrective work to these public infrastructures and facilities has been corrected.

WARNING TO OWNER: YOUR FAILURE TO RECORD A NOTICE OF COMMENCEMENT MAY RESULT IN YOU PAYING TWICE FOR IMPROVEMENTS TO YOUR PROPERTY. A NOTICE OF COMMENCEMENT MUST BE RECORDED AND POSTED ON THE JOB SITE BEFORE THE FIRST INSPECTION. IF YOU INTEND TO OBTAIN FINANCING, CONSULT WITH YOUR LENDER OR ATTORNEY BEFORE RECORDING YOUR NOTICE OF COMMENCEMENT.

OWNERS CERTIFICATION: I CERTIFY THAT ALL THE FOREGOING INFORMATION IS ACCURATE AND THAT ALL WORK WILL BE DONE IN COMPLIANCE WITH ALL APPLICABLE LAWS REGULATING CONSTRUCTION AND ZONING.

NOTICE TO OWNER: There are some properties that may have deed restrictions recorded upon them. These restrictions may limit or prohibit the work applied for in your building permit. You must verify if your property is encumbered by any restrictions or face possible litigation and or fines.

(Owners Must Sign All Applications Before Permit Issuance.)

 Willet Hays
Owners Signature

****OWNER BUILDERS MUST PERSONALLY APPEAR AND SIGN THE BUILDING PERMIT.**

CONTRACTORS AFFIDAVIT: By my signature I understand and agree that I have informed and provided this written statement to the owner of all the above written responsibilities in Columbia County for obtaining this Building Permit including all application and permit time limitations.

Contractor's Signature (Permitee) _____ Contractor's License Number _____
Columbia County
Competency Card Number _____

Affirmed under penalty of perjury to by the Contractor and subscribed before me this ____ day of _____ 20____.
Personally known _____ or Produced Identification _____

SEAL:

State of Florida Notary Signature (For the Contractor)



COLUMBIA COUNTY BUILDING DEPARTMENT

135 NE Hernando Ave., Suite B-21

Lake City, FL 32055

Office: 386-758-1008 Fax: 386-758-2160

OWNER BUILDER DISCLOSURE STATEMENT

I understand that state law requires construction to be done by a licensed contractor and have applied for an owner-builder permit under an exemption from the law. The exemption specifies that I, as the owner of the property listed, may act as my own contractor with certain restrictions even though I do not have a license.

I understand that building permits are not required to be signed by a property owner unless he or she is responsible for the construction and is not hiring a licensed contractor to assume responsibility.

I understand that, as an owner-builder, I am the responsible party of record on a permit. I understand that I may protect myself from potential financial risk by hiring a licensed contractor and having the permit filed in his or her name instead of my own name. I also understand that a contractor is required by law to be licensed and bonded in Florida and to list his or her license numbers on permits and contracts.

I understand that I may build or improve a one-family or two-family residence or farm outbuilding. I may also build or improve a commercial building if the costs do not exceed \$75,000. The building or residence must be for my own use or occupancy. It may not be built or substantially improved for sale or lease. If a building or residence that I have built or substantially improved myself is sold or leased within 1 year after the construction is complete, the law will presume that I built or substantially improved it for sale or lease, which violates the exemption.

I understand that, as the owner-builder, I must provide direct, onsite supervision of the construction.

I understand that I may not hire an unlicensed person to act as my contractor or to supervise persons working on my building or residence. It is my responsibility to ensure that the persons whom I employ have the licenses required by law and by county or municipal ordinance.

I understand that it is frequent practice of unlicensed persons to have the property owner obtain an owner-builder permit that erroneously implies that the property owner is providing his or her own labor and materials. I, as an owner-builder, may be held liable and subjected to serious financial risk for any injuries sustained by an unlicensed person or his or her employees while working on my property. My homeowner's insurance may not provide coverage for those injuries. I am willfully acting as an owner-builder and am aware of the limits of my insurance coverage for injuries to workers on my property.

I understand that I may not delegate the responsibility for supervising work to a licensed contractor who is not licensed to perform the work being done. Any person working on my building who is not licensed must work under my direct supervision and must be employed by me, which means that I must comply with laws requiring the withholding of federal income tax and social security contributions under the Federal Insurance Contributions Act (FICA) and must provide workers' compensation for the employee. I understand that my failure to follow these laws may subject me to serious financial risk.

I agree that, as the party legally and financially responsible for this proposed construction activity, I will abide by all applicable laws and requirements that govern owner-builders as well as employers. I also understand that the construction must comply with all applicable laws, ordinances, building codes, and zoning regulations.

I understand that I may obtain more information regarding my obligations as an employer from the Internal Revenue Service, the United States Small Business Administration, the Florida Department of Financial Services, and the Florida Department of Revenue. I also understand that I may contact the Florida Construction Industry Licensing Board at 850-487-1395 or Internet website address <http://www.myflorida.com/dbpr/pro/cilb/index.html> for more information about licensed contractors.

I am aware of, and consent to, an owner-builder building permit applied for in my name and understand that I am the party legally and financially responsible for the proposed construction activity at the following address:

186 SW Fennigan Way, Lake City FL 32025

I agree to notify Columbia County Building Department immediately of any additions, deletions, or changes to any of the information that I have provided on this disclosure. Licensed contractors are regulated by laws designed to protect the public. If you contract with a person who does not have a license, the Construction Industry Licensing Board and Department of Business and Professional Regulation may be unable to assist you with any financial loss that you sustain as a result of a complaint. Your only remedy against an unlicensed contractor may be in civil court. It is also important for you to understand that, if an unlicensed contractor or employee of an individual or firm is injured while working on your property, you may be held liable for damages. If you obtain an owner-builder permit and wish to hire a licensed contractor, you will be responsible for verifying whether the contractor is properly licensed and the status of the contractor's workers' compensation coverage.

I understand that if I hire subcontractors they must be licensed for that type of work in Columbia County, ex: framing, stucco, masonry, and state registered builders. Registered Contractors must have a minimum of \$300,000.00 in General Liability insurance coverage and the proper workers' compensation. Specialty Contractors must have a minimum of \$100,000.00 in General Liability insurance coverage and the proper workers' compensation coverage.

Before a building permit can be issued, this disclosure statement must be completed and signed by the property owner and returned to Columbia County Building Department.

TYPE OF CONSTRUCTION

- () Single Family Dwelling () Two-Family Residence () Farm Outbuilding
() Addition, Alteration, Modification or other Improvement
() Commercial, Cost of Construction _____ Construction of _____
☒ Other Metal Storage Building

I Willet M. Hays, have been advised of the above disclosure statement for exemption from contractor licensing as an owner/builder. I agree to comply with all requirements provided for in Florida Statutes allowing this exception for the construction permitted by Columbia County Building Permit.

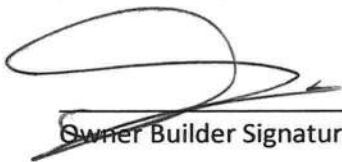
Owner Builder Signature

Jun 31, 2012
Date

NOTARY OF OWNER BUILDER SIGNATURE

The above signer is personally known to me or produced identification ADL

Notary Signature  Date 1-31-12



FOR BUILDING DEPARTMENT USE ONLY

I hereby certify that the above listed owner builder has been given notice of the restriction stated above.

Building Official/Representative 

NOTICE OF COMMENCEMENT

Tax Parcel Identification Number:

02935-108

Clerk's Office Stamp

Inst 201212001463 Date: 1/31/2012 Time: 2:20 PM
DC, P DeWitt Cason, Columbia County Page 1 of 1 B.1228 P.2619

THE UNDERSIGNED hereby gives notice that improvements will be made to certain real property, and in accordance with Section 713.13 of the Florida Statutes, the following information is provided in this NOTICE OF COMMENCEMENT.

1. Description of property (legal description): Cannon Creek Estates L88 West
a) Street (job) Address: 186 SW Fennigan Way, Lake City FL 32025
2. General description of improvements: Metal Storage Building
3. Owner Information
a) Name and address: Willet M. Hays
b) Name and address of fee simple titleholder (if other than owner):
c) Interest in property: Owner
4. Contractor Information
a) Name and address: Owner Builder
b) Telephone No.: Fax No. (Opt.)
5. Surety Information
a) Name and address:
b) Amount of Bond:
c) Telephone No.: Fax No. (Opt.)
6. Lender
a) Name and address: N/A
b) Phone No.:
7. Identity of person within the State of Florida designated by owner upon whom notices or other documents may be served:
a) Name and address:
b) Telephone No.: Fax No. (Opt.)
8. In addition to himself, owner designates the following person to receive a copy of the Lienor's Notice as provided in Section 713.13(l)(b), Florida Statutes:
a) Name and address:
b) Telephone No.: Fax No. (Opt.)
9. Expiration date of Notice of Commencement (the expiration date is one year from the date of recording unless a different date is specified):

WARNING TO OWNER: ANY PAYMENTS MADE BY THE OWNER AFTER THE EXPIRATION OF THE NOTICE OF COMMENCEMENT ARE CONSIDERED IMPROPER PAYMENTS UNDER CHAPTER 713, PART I, SECTION 713.13, FLORIDA STATUTES, AND CAN RESULT IN YOUR PAYING TWICE FOR IMPROVEMENTS TO YOUR PROPERTY; A NOTICE OF COMMENCEMENT MUST BE RECORDED AND POSTED ON THE JOB SITE BEFORE THE FIRST INSPECTION. IF YOU INTEND TO OBTAIN FINANCING, CONSULT YOUR LENDER OR AN ATTORNEY BEFORE COMMENCING WORK OR RECORDING YOUR NOTICE OF COMMENCEMENT.

STATE OF FLORIDA
COUNTY OF COLUMBIA

X 10. [Signature]
Signature of Owner or Owner's Authorized Officer/Director/Partner/Manager
Willet M. Hays
Printed Name

The foregoing instrument was acknowledged before me, a Florida Notary, this 31 day of Jan, 2012, by:
Willet Hays as Owner (type of authority, e.g. officer, trustee, attorney
fact) for Self (name of party on behalf of whom instrument was executed).

Personally Known OR Produced Identification ☒ Type PROD

Notary Signature [Signature] Notary Stamp or Seal:



11. Verification pursuant to Section 92.525, Florida Statutes. Under penalties of perjury, I declare that I have read the foregoing and that the facts stated in it are true to the best of my knowledge and belief.

X [Signature]
Signature of Natural Person Signing (in line #10 above.)

SUBCONTRACTOR VERIFICATION FORM

APPLICATION NUMBER _____ CONTRACTOR _____ PHONE _____

THIS FORM MUST BE SUBMITTED PRIOR TO THE ISSUANCE OF A PERMIT

In Columbia County one permit will cover all trades doing work at the permitted site. It is **REQUIRED** that we have records of the subcontractors who actually did the trade specific work under the permit. Per Florida Statute 440 and Ordinance 89-6, a contractor shall require all subcontractors to provide evidence of workers' compensation or exemption, general liability insurance and a valid Certificate of Competency license in Columbia County.

Any changes, the permitted contractor is responsible for the corrected form being submitted to this office prior to the start of that subcontractor beginning any work. Violations will result in stop work orders and/or fines.

ELECTRICAL	Print Name _____ License #: <u>NONE</u>	Signature _____ Phone #: _____
MECHANICAL/ A/C _____	Print Name _____ License #: _____	Signature _____ Phone #: _____
PLUMBING/ GAS	Print Name _____ License #: _____	Signature _____ Phone #: _____
ROOFING	Print Name _____ License #: _____	Signature _____ Phone #: _____
SHEET METAL	Print Name _____ License #: _____	Signature _____ Phone #: _____
FIRE SYSTEM/ SPRINKLER	Print Name _____ License #: _____	Signature _____ Phone #: _____
SOLAR	Print Name _____ License #: _____	Signature _____ Phone #: _____

Specialty License	License Number	Sub-Contractors Printed Name	Sub-Contractors Signature
MASON			
CONCRETE FINISHER			
FRAMING			
INSULATION			
STUCCO			
DRYWALL			
PLASTER			
CABINET INSTALLER			
PAINTING			
ACOUSTICAL CEILING			
GLASS			
CERAMIC TILE			
FLOOR COVERING			
ALUM/VINYL SIDING			
GARAGE DOOR			
METAL BLDG ERECTOR		<u>Willet M. Hays</u>	

F. S. 440.103 Building permits; identification of minimum premium policy.--Every employer shall, as a condition to applying for and receiving a building permit, show proof and certify to the permit issuer that it has secured compensation for its employees under this chapter as provided in ss. 440.10 and 440.38, and shall be presented each time the employer applies for a building permit.

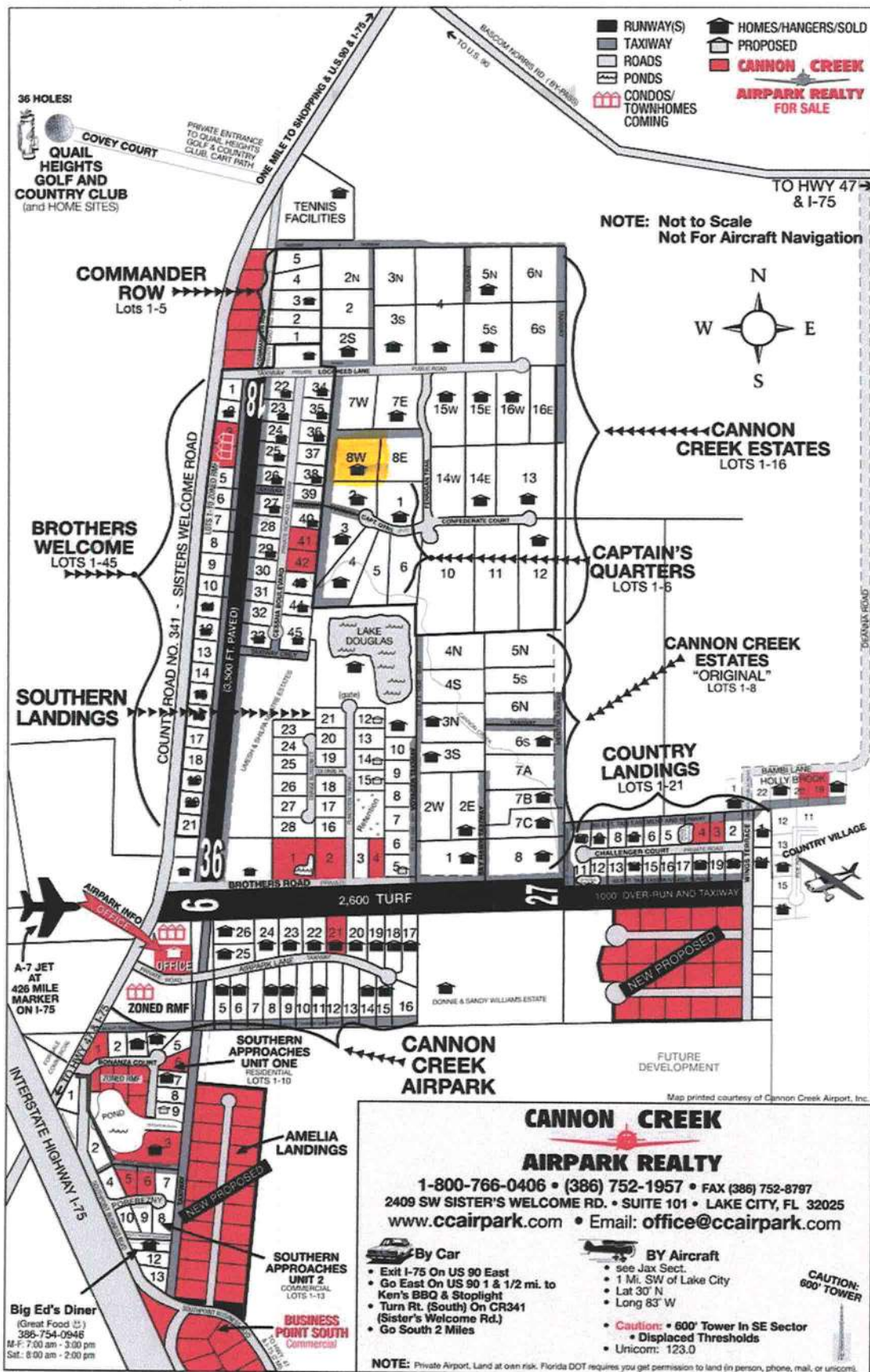

REGULAR / A-FRAME - VERTICAL / HORIZ.

12' THRU 30' CARPORTS
(STATE OF FLORIDA)
AS PER DESIGN CRITERIA

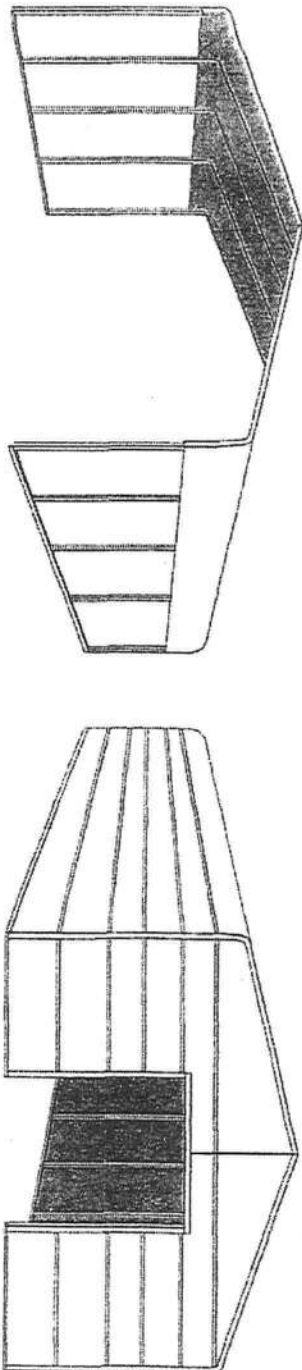

DESIGN NOTES

1. ALL CONSTRUCTION SHALL BE PROVIDED IN ACCORDANCE WITH IBC 2006, OSHA, AISC, ASCE 7-05, AWS D 1.1 CODES AND ALL APPLICABLE LOCAL REQUIREMENTS.
2. SHELTER BASE CONNECTIONS SHALL BE PROVIDED AS SHOWN ON SHEET 9
3. ALL MATERIALS IDENTIFIED BY MANUFACTURER NAME MAY BE SUBSTITUTED WITH MATERIAL EQUAL OR EXCEEDING ORIGINAL.
4. ALL SHOP CONNECTIONS SHALL BE WELDED CONNECTIONS.
5. ALL FIELD CONNECTIONS SHALL BE TIG WELDS #12 (1/4"x1/2").
6. STEEL SHEATHING SHALL BE 29GA. CORRUGATED GALV. OR PAINTED STEEL - MAIN RIB HT. 3/4" (P=60KSI) OR EQ. (FLORIDA APPROVAL #FL127941)
7. ALL STRUCTURAL LIGHT GAUGE TUBING AND CHANNELS SHALL BE GRADE 50 STEEL.
8. STRUCTURAL TUBE T52 1/2"x2 1/2" - 14GA. IS EQUIVALENT TO T52 1/4"x2 1/4" - 12GA.
9. STRUCTURAL TUBE T52 1/4"x2 1/4" - 12GA. SHOULD BE ACCEPTED IN LIEU OF T52 1/4"x2 1/4" - 14GA. FOR IT IS A BETTER STRUCTURAL TUBING.

DESIGN CRITERIA

PREVAILING CODE: FBC 2007 / 2009 AMENDMENTS
USE GROUP: U (CARPORTS, BARNY)
BASIC WIND VELOCITY: 90 TO 150 MPH (SEE SCHEDULE)
ROOF DEAD LOAD: 2.0 PSF
ROOF LIVE LOAD: AS PER GROUND SNOW MIN. 20 PSF
GROUND SNOW LOAD: 0 TO 30 PSF (SEE SCHEDULE)
IMPORTANCE FACTOR = SNOW 0.8
WIND 0.87
SEISMIC 1.0
SEISMIC DESIGN CATEGORY: A
LOAD COMBINATIONS:
DL + LL, 0.6DL + WL
DL + 0.75LL + 0.75WL

DRAWING INDEX

1. COVER SHEET
2. FLOOR PLAN
3. REGULAR / A-FRAME BLDG. SECTIONS
4. SIDE ELEVATIONS
5. SECTION DETAILS
6. END WALL DETAILS
7. OPENING DETAILS
8. LEAN-TO OPTION
9. ANCHORAGE

THE INFORMATION CONTAINED IN THESE DRAWINGS ARE THE SOLE PROPERTY OF A & A ENGINEERING. ANY REPRODUCTION IN PART OR WHOLE WITHOUT THE WRITTEN PERMISSION OF A & A ENGINEERING IS PROHIBITED.

A & A ENGINEERING
CIVIL • STRUCTURAL
SINCE 1976

3911 Remembrance Pl., Suite B
Toledo, Ohio 43623

Tel: (419) 292-1983
Fax: (419) 292-0955

TNT

Metal Buildings Inc.
170 Holly Springs Rd.
Mr. Airt, NC 27030

1-800-597-3397
MAIN - 1-336-789-3818
FAX - 1-336-789-4122

OWNER: TNT METAL BUILDING, INC.

LOCATION: FLORIDA

DRAWING NO.: TNT-FL

DATE: 3/24/2011

PROJECT NUMBER: 039-11-0221

DRAWN BY: JMS

CHECKED BY: OA

DRAWING TITLE: COVER

SHEET NO.: 1 OF 9

OMAR ABU-YASEIN
No. 52851
STATE OF FLORIDA
PROFESSIONAL ENGINEER

LICENSE EXPIRES: 02/28/2013

DATE SIGNED: 3/24/2011

A & A ENGINEERING
CIVIL • STRUCTURAL
SINCE 1976

5911 Renaissance Pl., Suite B
Tolledo, Ohio 43623

Tel: (419) 292-1981
Fax: (419) 292-0935

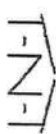

Metal Buildings Inc.

170 Holly Springs Rd.
Mt. Airy, NC 27030

1-800-697-3397
MADE IN - 1-336-789-3818
FAX - 1-336-789-4122

OWNER:

TNT METAL BUILDING, INC.

LOCATION: FLORIDA

DRAWING NO.: TNT-FL

DATE: 3/24/2011

PROJECT NUMBER:

039-11-0221

DRAWN BY: JMS

CHECKED BY: OA

DRAWING TITLE:

FLOOR PLAN

SHEET NO.: 2 OF 9

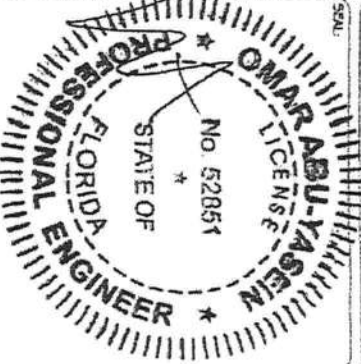

DATE SIGNED: 3/24/2011

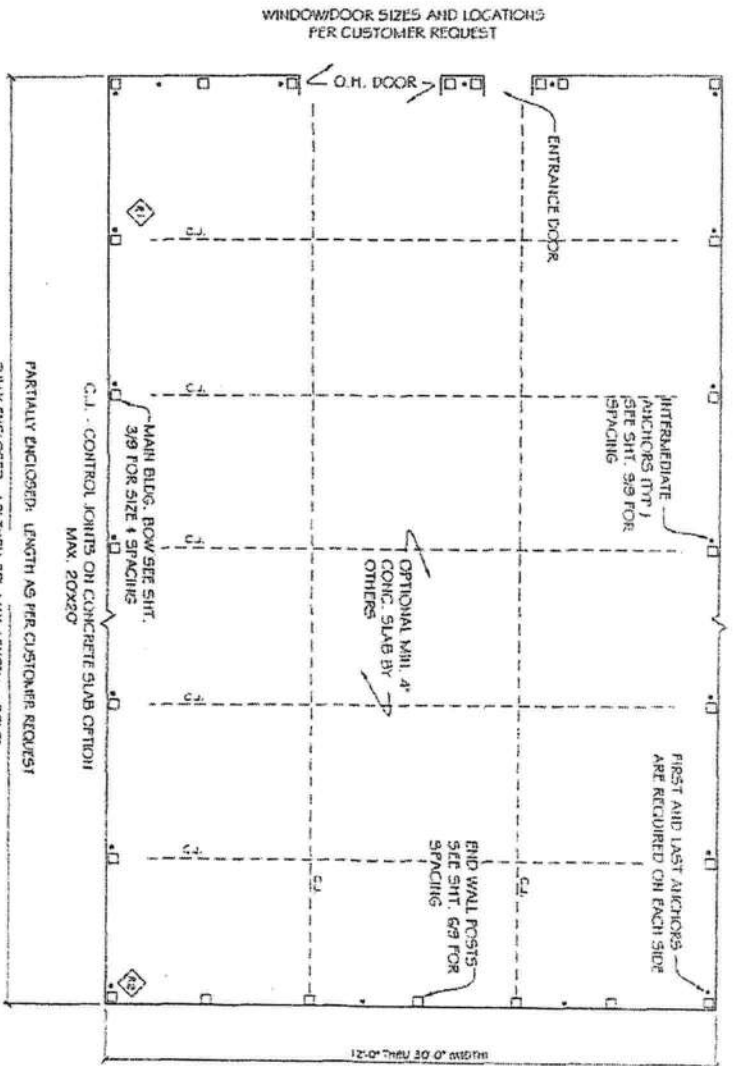

FLOOR PLAN

(SCALE: NTS)

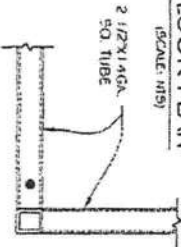

BASE CORNER ANCHOR

(SCALE: NTS)

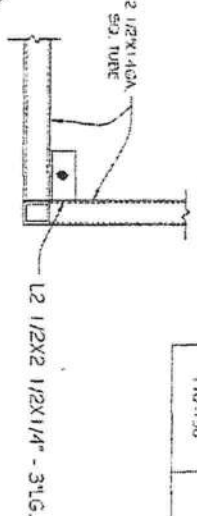

ALTERNATE CORNER ANCHOR

(SCALE: NTS)

BASE ANCHOR

(SCALE: NTS)

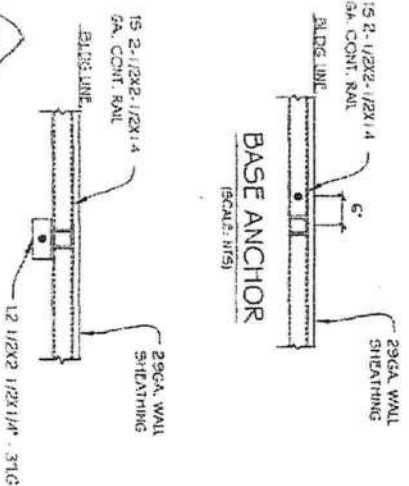

ALTERNATE ANCHOR

(SCALE: NTS)

ANCHOR SEE OPTIONS AND SPACING SHEET 9/8

FIRST AND LAST ANCHORS ARE REQUIRED IN EACH SIDE

WIND SPEED (MPH)	CARPORT WIDTH
90 - 110	12 THRU 20' BLDG.
110 - 150	22 THRU 30' BLDG.

ANCHOR SPACING

A & A ENGINEERING
CIVIL - STRUCTURAL
ENGINEER

5911 Renaissance Pl., Suite B
Toledo, Ohio 43623

Tel: (419) 292-1913
Fax: (419) 292-0935

TNT
Metal Buildings Inc.
170 Holly Springs Rd.
Mr. Alry, NC 27030

1-800-597-3597
MADE IN USA
FAX: 1-356-789-4122

OWNER:
TNT METAL BUILDING, INC.

LOCATION:
FLORIDA

DRAWING NO.:
TNT-FL

DATE:
3/24/2011

PROJECT NUMBER:
039-11-0221

DRAWN BY:
JMS

CHECKED BY:
OA

DRAWING TITLE:
TYP BLDG. SECTION

SHEET NO.:
3 OF 9



DATE SIGNED: 3/24/2011

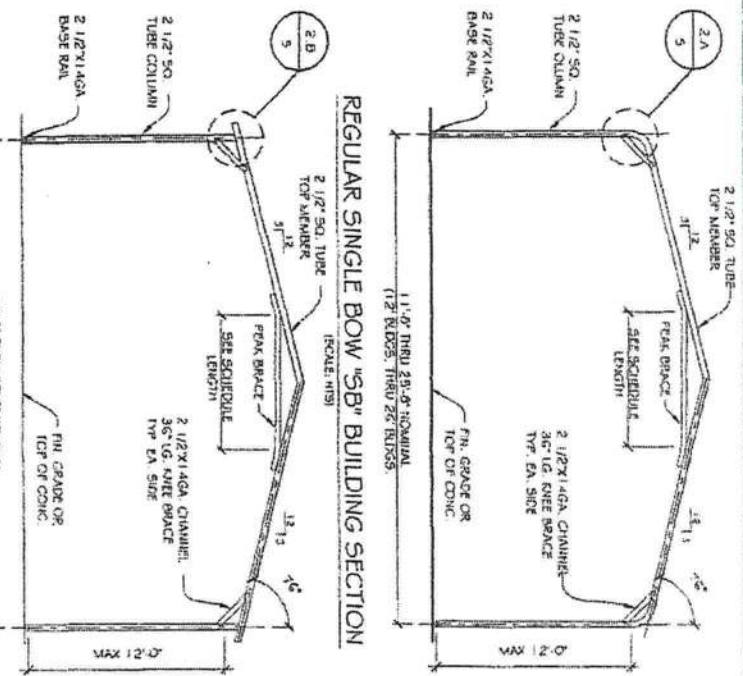
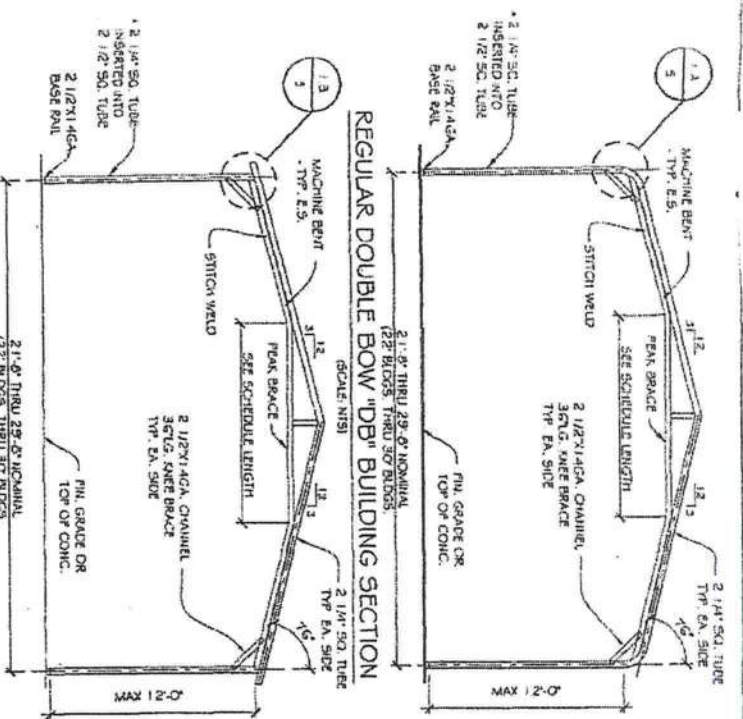

PEAK BRACE SCHEDULE

WIDTH	SIZE	LENGTH
12	2 1/2" X 1/4 GA. CHANNEL	2'-0"
14	2 1/2" X 1/4 GA. CHANNEL	4'-0"
16	2 1/2" X 1/4 GA. CHANNEL	6'-0"
18	2 1/2" X 1/4 GA. CHANNEL	8'-0"
20-22	2" X 1/4 GA. SQ. TUBE	10'-0"
24-26	2" X 1/4 GA. SQ. TUBE	14'-0"
28-30	2" X 1/4 GA. SQ. TUBE	18'-0"

PEAK BRACE SCHEDULE

WIDTH	SIZE	LENGTH
12	2 1/2" X 1/4 GA. CHANNEL	2'-0"
14	2 1/2" X 1/4 GA. CHANNEL	4'-0"
16	2 1/2" X 1/4 GA. CHANNEL	6'-0"
18	2 1/2" X 1/4 GA. CHANNEL	8'-0"
20-22	2" X 1/4 GA. SQ. TUBE	10'-0"
24-26	2" X 1/4 GA. SQ. TUBE	14'-0"
28-30	2" X 1/4 GA. SQ. TUBE	18'-0"

BOW SCHEDULE (TOP & COLUMN MEMBERS GAUGE AND SPACING)

WIND (MPH)	90 - 100		110 - 120		130 - 150	
	BLDG. & WIDTH	BLDG. & WIDTH	BLDG. & WIDTH	BLDG. & WIDTH	BLDG. & WIDTH	BLDG. & WIDTH
65 / 11	12-20	22-26	28-30	12-20	22-26	28-30
	F 14GA. 5.8 @ 54"	F 14GA. 5.8 @ 54"	F 14GA. 5.8 @ 54"	F 14GA. 5.8 @ 54"	F 14GA. 5.8 @ 54"	F 14GA. 5.8 @ 54"
20 / 20	F 14GA. 5.8 @ 54"	F 14GA. 5.8 @ 54"	F 14GA. 5.8 @ 54"	F 14GA. 5.8 @ 54"	F 14GA. 5.8 @ 54"	F 14GA. 5.8 @ 54"
	F 14GA. 5.8 @ 54"	F 14GA. 5.8 @ 54"	F 14GA. 5.8 @ 54"	F 14GA. 5.8 @ 54"	F 14GA. 5.8 @ 54"	F 14GA. 5.8 @ 54"
30 / 20	F 14GA. 5.8 @ 54"	F 14GA. 5.8 @ 54"	F 14GA. 5.8 @ 54"	F 14GA. 5.8 @ 54"	F 14GA. 5.8 @ 54"	F 14GA. 5.8 @ 54"
	F 14GA. 5.8 @ 54"	F 14GA. 5.8 @ 54"	F 14GA. 5.8 @ 54"	F 14GA. 5.8 @ 54"	F 14GA. 5.8 @ 54"	F 14GA. 5.8 @ 54"

S.B. = SINGLE BOW
D.B. = DOUBLE BOW
F = FULLY ENCLOSED (CLOSED)
P = PARTIALLY ENCLOSED (OPEN)
G.S. = GROUND SNOW
L.L. = LIVE LOAD

* INSERT TO BE FULL HEIGHT TIED BOLT W/ 18G
#12X1 @ 12" OC - STRAGGER OPPOSITE FACE

1. STEEL SHEATHING
2. 2" X 4" OR 2" X 6" STUDS
3. MAIN RIBS AT 24" ON CENTER
4. OPTIONAL SIDE PANELS FOR FULLY ENCLOSED

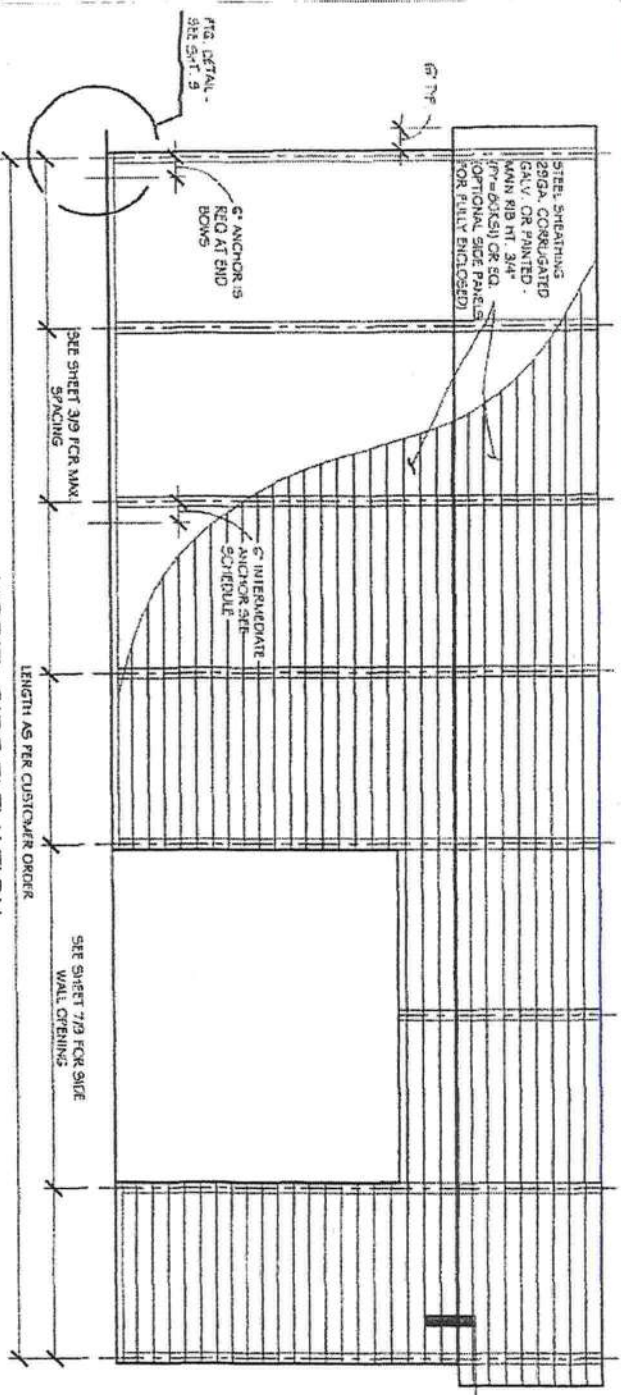

HORZ. SIDE ELEVATION
(SCALE: NTS)

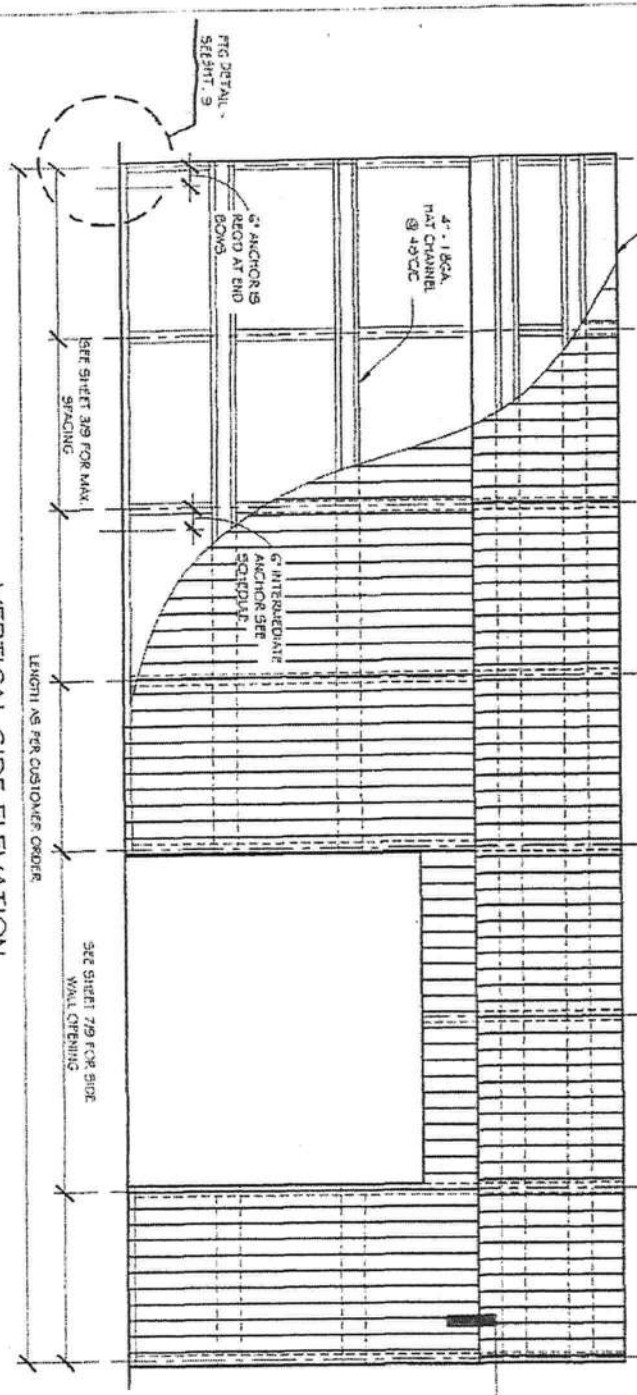

VERTICAL SIDE ELEVATION
(SCALE: NTS)

A & A ENGINEERING
CIVIL • STRUCTURAL
5911 Renaissance Pl., Suite B
Toldeo, Ohio 45623
Tel: (419) 292-1983
Fax: (419) 292-0555

TNT
Metal Buildings Inc.
170 Holly Springs Rd.
Mt. Airy, NC 27030
1-800-597-3597
MAIN - 1-336-789-3818
FAX - 1-336-789-4122

OWNER:
TNT METAL BUILDING, INC.
LOCATION: **FLORIDA**
DRAWING NO.: **TNT-FL**
DATE: **3/24/2011**
PROJECT NUMBER:
039-11-0221
DRAWN BY: **JMS**
CHECKED BY: **OA**
DRAWING TITLE:
SIDE ELEVATIONS
SHEET NO.: **4 OF 9**

OMAR ABU-YASEIN
LICENSE
No. 52851
STATE OF
FLORIDA
PROFESSIONAL ENGINEER
DATE SIGNED: **3/24/2011**

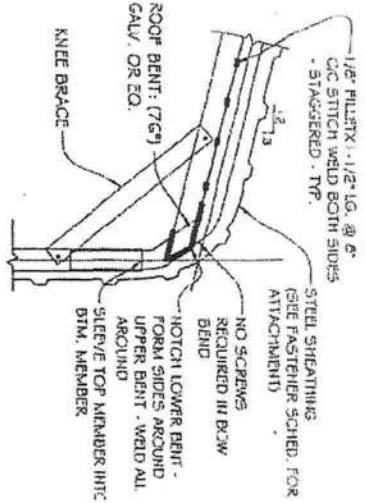

REGULAR DOUBLE BOW
SECTION DETAIL
(SCALE: NTS)

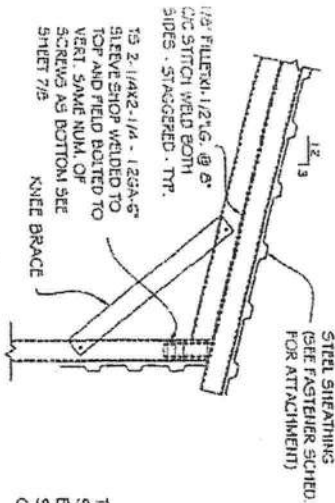

A-FRAME DOUBLE BOW
SECTION DETAIL
(SCALE: NTS)

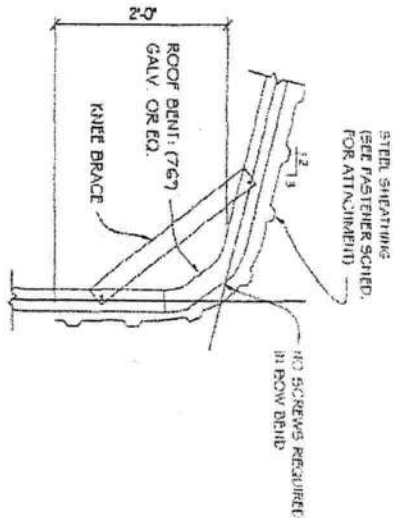

REGULAR SINGLE BOW
SECTION DETAIL
(SCALE: NTS)

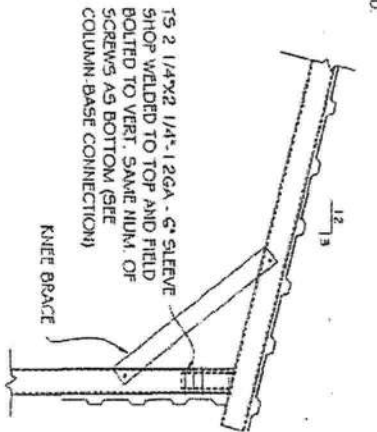

A-FRAME SINGLE BOW
SECTION DETAIL
(SCALE: NTS)

PURLIN SCHD.	
SNOW LOAD	HAT CHANNEL SPACING
20	48\" C/C

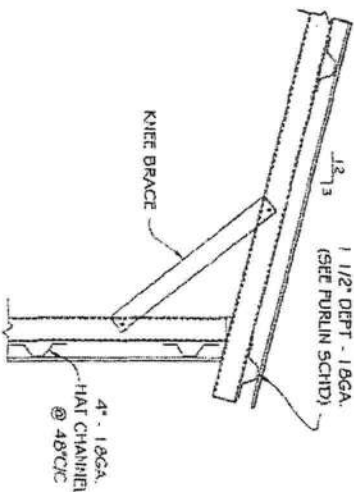

TYPICAL A-FRAME VERTICAL
SECTION DETAIL
(SCALE: NTS)

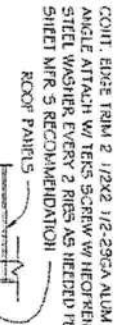

EDGE DETAIL
(SCALE: NTS)

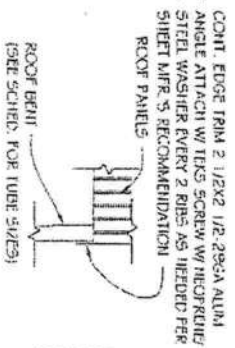

EDGE DETAIL
(SCALE: NTS)

COLUMN BASE RAIL DETAIL

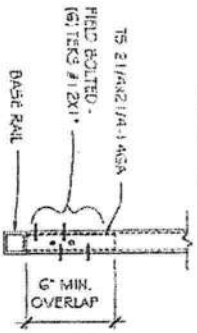

(SCALE: NTS)
FASTENER SCHED.
TYPE: TERS #12X1 1/2\"/>

A & A ENGINEERING
CIVIL • STRUCTURAL
SINCE 1966
5911 Renaissance Pl., Suite B
Toledo, Ohio 43623
Tel: (419) 292-1983
Fax: (419) 292-2955

T-N-T
Metal Buildings Inc.
170 Holly Springs Rd.
Mt. Airy, NC 27030
1-800-597-3397
MAIN - 1-336-789-3818
FAX - 1-336-789-4122

OWNER:
TNT METAL BUILDING, INC.
LOCATION: FLORIDA
DRAWING NO.: TNT-FL
DATE: 3/24/2011
PROJECT NUMBER: 039-11-0221
DRAWN BY: JMS
CHECKED BY: OA
DRAWING TITLE: SECTION DETAILS

SHEET NO.: 5 OF 9

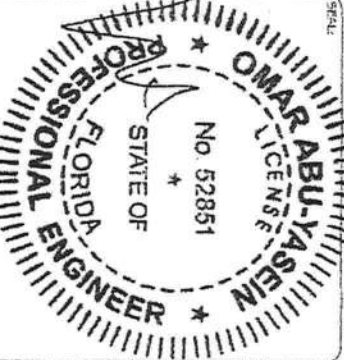

DATE SIGNED: 3/24/2011

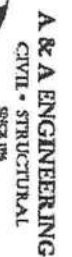

Tel (419) 292-1983
Fax (419) 292-0955

Tel (419) 292-1983
Fax (419) 292-0955

—

Metal Buildings Inc.

170 Holly Springs Rd.

Mr. Aity, NC 27030

1-800-597-3597
MAIN - 1-336-789-3818
FAX - 1-336-789-4122

OWNER:

TNT METAL BUILDING, INC.

LOCATION: FLORIDA

DRAWING NO.: TNT-FI

DATE: 3/24/2011

PROJECT NUMBER:

039-11-0221

DRAWN BY:

CHECKED BY: OA

DRAWING TITLE:

END WALL DETAILS

SHEET NO.:

SEAL:

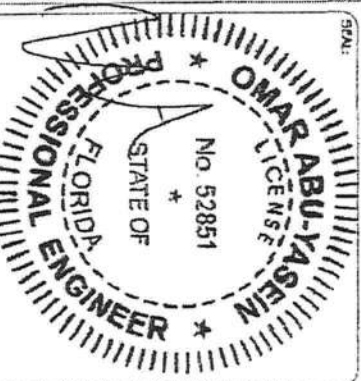

DATE SIGNED: 3/24/2011

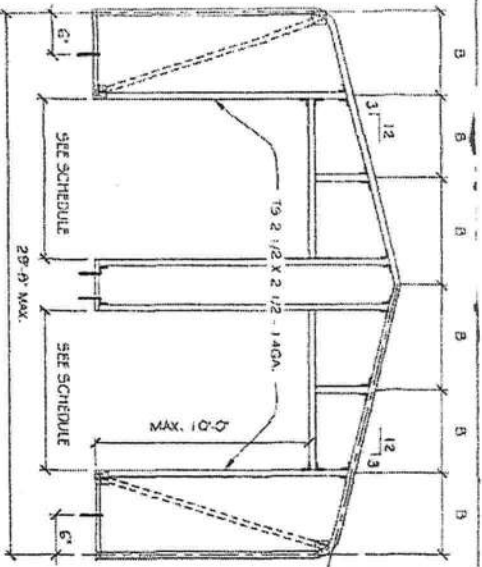

REGULAR END WALL

(5C:ALT: N15)

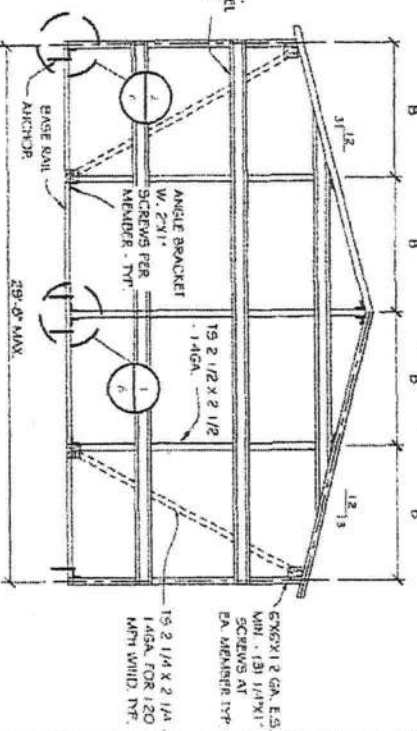

A-FRAME END WALL

(ISCALP, NIS)

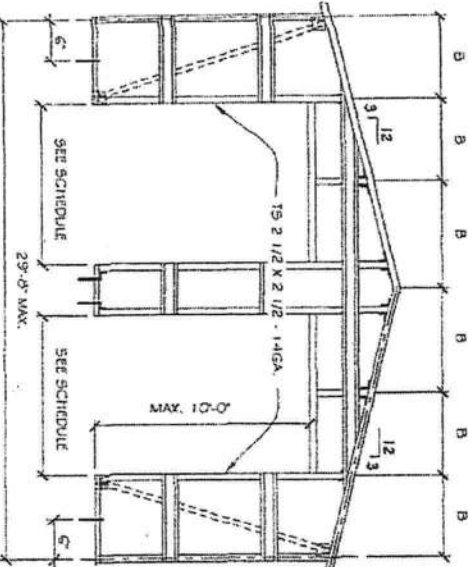

A-FRAME/END WALL W/ OPENING

(9CALLE: NT5)

CARPET WIDTH	MAX. DOOR WIDTH	HEADER SIZE
12-16'	8'	T5 2 I/X 2 I/A - 12GA.
18'	10'	T5 2 I/X 2 I/A - 12GA.
20-22'	12'	T5 2 I/X 2 I/A - 12GA.
24-30'	14'	DEL T5 2 I/X 2 I/A - 14GA.

MAX. POST SPACING "B"

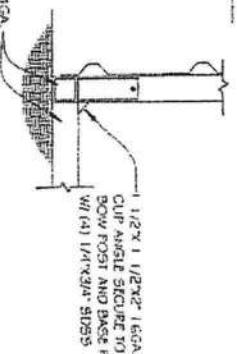

END BOW/BASE RAIL

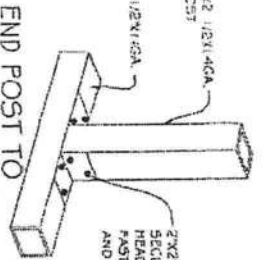

HEADER/RAIL CONN.

(5CANT:NT5)

FHD WALL SCHEDULE	
WALL	ANCHORS
50 - 120	5" C/C
130 - 150	4" C/C
	EVERY OTHER BAY 1"
	EVERY BAY 1"

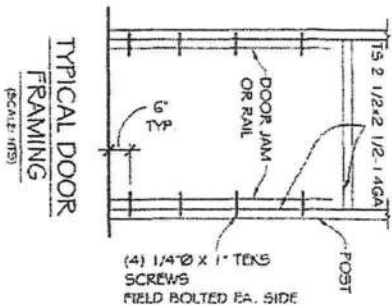
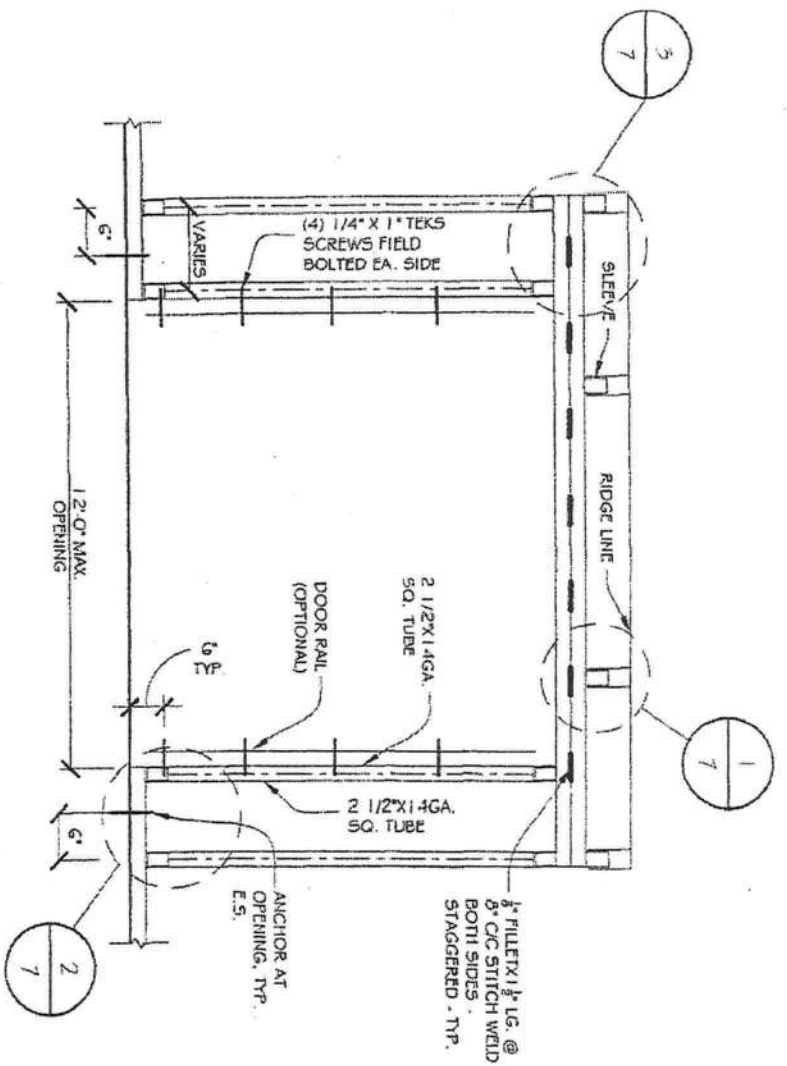

TYPICAL FRAMING AT SIDE OPENINGS

(SCALE: NTS)

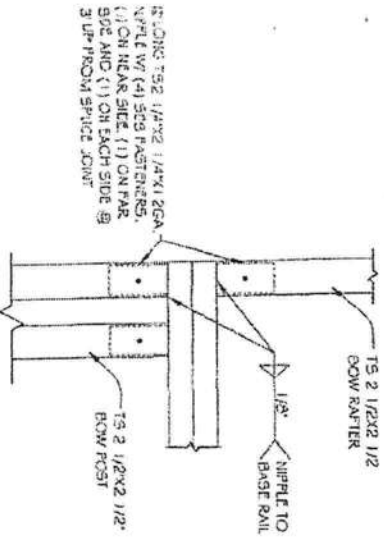

BOW/POST
DETAIL

(SCALE: NTS)

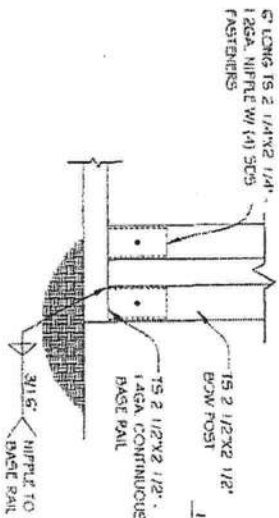

BOW/BASE RAIL
CONN. DETAIL

(SCALE: NTS)

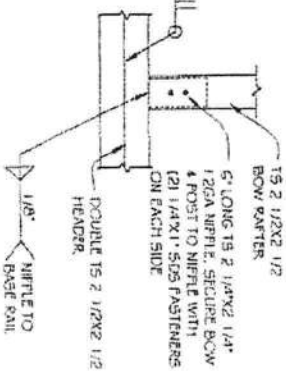

BOW/HEADER
DETAIL

(SCALE: NTS)

A & A ENGINEERING
CIVIL • STRUCTURAL
SINCE 1964
5911 Renaissance Pl., Suite B Tel: (419) 292-1983
Toledo, Ohio 43623 Fax: (419) 292-0935

T-N-T
Metal Buildings Inc.

170 Holly Springs Rd.
Mt. Airy, NC 27030

1-800-597-3197
MAIN - 1-336-781-3111
FAX - 1-336-781-4122

OWNER:

TNT METAL BUILDING, INC.

LOCATION: FLORIDA

DRAWING NO.: TNT-FL

DATE: 3/24/2011

PROJECT NUMBER:

039-11-0221

DRAWN BY:

JMS

CHECKED BY:

OA

DRAWING TITLE:

SIDE WALL
OPENNING DETAILS

SHEET NO.:

7 OF 9

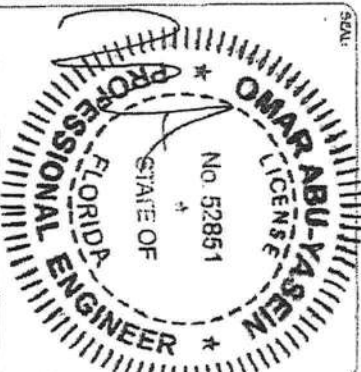

DATE SIGNED: 3/24/2011



TNT

Metal Buildings Inc.

170 Holly Springs Rd.
Mt. Airy, NC 27030

1-800-597-3577
MAIN - 1-336-789-3618
FAX - 1-336-789-4122

OWNER:

TNT METAL BUILDING, INC.

LOCATION: FLORIDA

DRAWING NO.: TNT-FL

DATE: 3/24/2011

PROJECT NUMBER:
039-11-0221

DRAWN BY: JMS

CHECKED BY: OA

DRAWING TITLE:

LEAN-TO OPTION

SHEET NO.: 8 OF 9

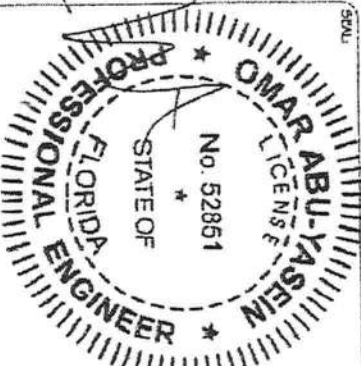

DATE SIGNED: 3/24/2011

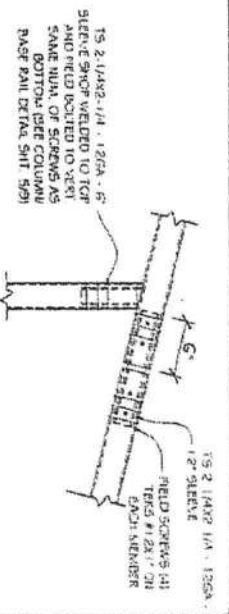

CONNECTION DETAIL
(SCALE: 1/8")

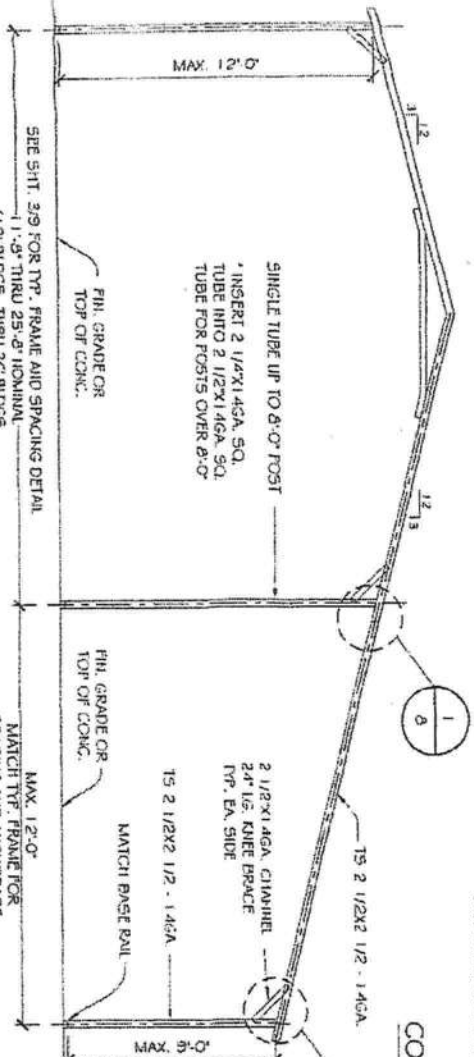

A-FRAME OR REGULAR "SB" LEAN-TO OPTION
(SCALE: 1/8")

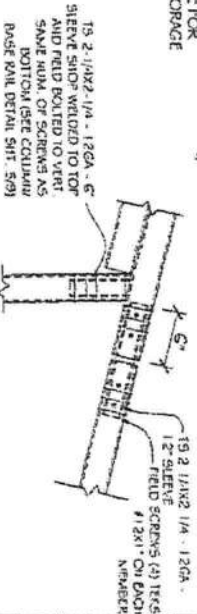

CONNECTION DETAIL
(SCALE: 1/8")

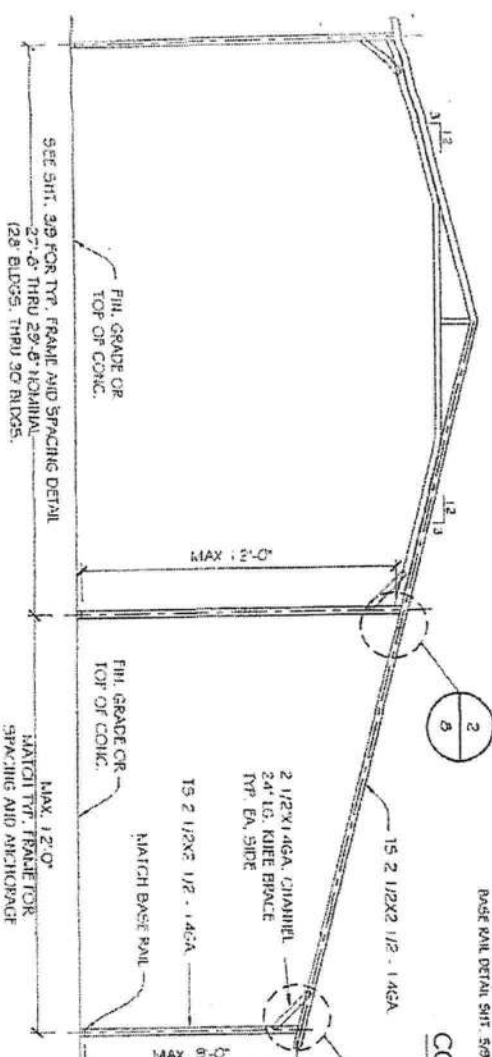

A-FRAME OR REGULAR "DB" LEAN-TO OPTION
(SCALE: 1/8")

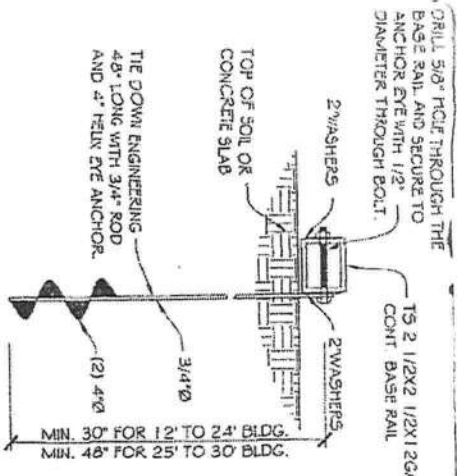

OPTIONAL MOBILE HOME ANCHOR FOR SAND/CLAY
(SCALE: NTS)

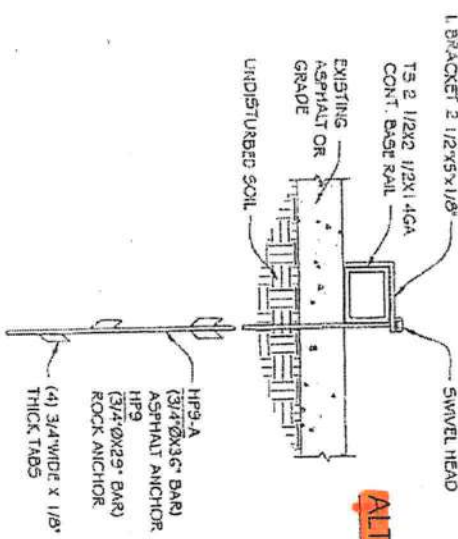

ALTERNATE, FRAME FLUSH W/ CONC.
(SCALE: NTS)

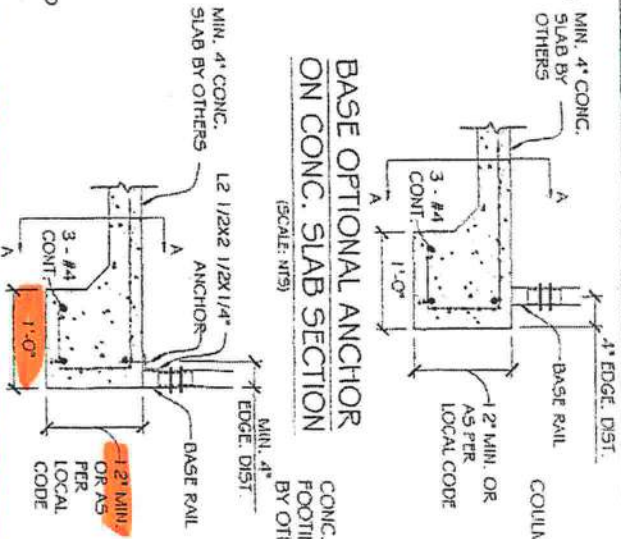

BASE OPTIONAL ANCHOR ON CONC. SLAB SECTION
(SCALE: NTS)

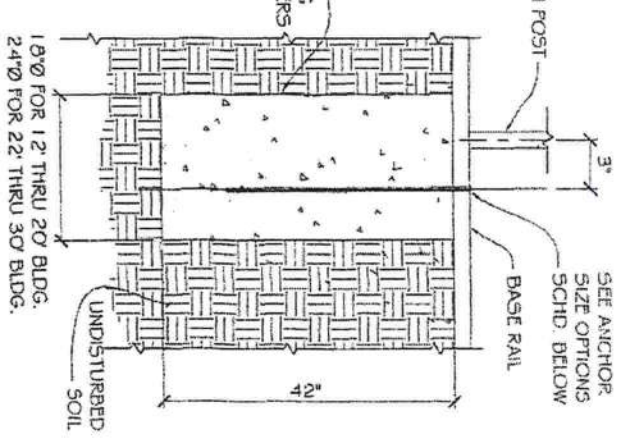

PIN ANCHOR DETAIL ON CONCRETE PIER FOOTING
(SCALE: NTS)

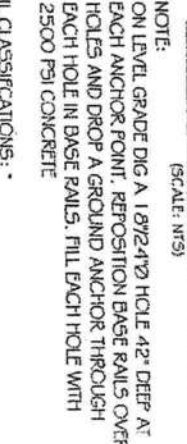

SOIL CLASSIFICATIONS:

SOIL CLASS	SOIL DESCRIPTION
1	VERY DENSE #7 OR CEMENTED SANDS, COARSE GRAVEL AND COBBLES, COLICHT, FRIELOAD SILT AND CLAYS
2	MEDIUM DENSE COARSE SANDS, SANDY GRAVELS, VERY STIFF SILTS, AND CLAYS
3	LOOSE TO MEDIUM DENSE SANDS, FIRM TO STIFF CLAYS AND SILTS
4	ALLUVIAL FILL AND VERY LOOSE TO MEDIUM DENSE SANDS, FIRM TO STIFF CLAYS AND SILTS, ALLUVIAL FILL

OPTIONAL ASPHALT/ ROCK ANCHOR DETAIL
(SCALE: NTS)

ANCHOR SIZE OPTIONS SCHEDULE

WIND SPEED (MPH)	REMARKS	CARPORT WIDTH
50 - 120		
130 - 150		
1	THIRD ROD EMBED IN CONC.	ALL SIZES
2	INSERT W/ EPOXY IN CONC.	ALL SIZES
3	EXPANSION BOLTS	ALL SIZES
4	WEDGE ANCHORS IN CONC.	ALL SIZES

NOTE:
1: SEE SHT. 2 AND 6 FOR ANCHOR REQUIREMENTS
2: ASSUMED SOIL BEARING CAPACITY IS 1500 PSF
3: CONCRETE STRENGTH TO BE 2500 PSI AT 28 DAYS

SECTION A-A
(SCALE: NTS)

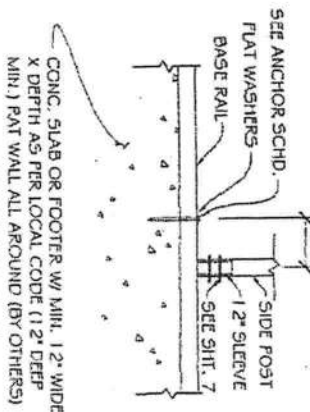

HELICAL ANCHOR SHALL BE APPROVED FOR USE IN SOIL CLASSIFICATIONS 2, 3, AND 4.

TAKEN FROM HUD STANDARD FOR INSTALLATION OF MOBILE HOMES

A & A ENGINEERING
CIVIL - STRUCTURAL
5911 Renaissance Pl., Suite B
Tallahassee, FL 32303
Tel: (904) 292-1983
Fax: (904) 292-0955

T-N-T
Metal Buildings Inc.
170 Holly Springs Rd.
Mr. Atty, NC 27030
1-800-597-3597
MAIN - 1-336-785-3818
FAX - 1-336-785-4122

OWNER: **TNT METAL BUILDING, INC.**
LOCATION: **FLORIDA**
DRAWING NO.: **TNT-FL**
DATE: **3/24/2011**
PROJECT NUMBER: **039-11-0221**
DRAWN BY: **JMS**
CHECKED BY: **OA**
DRAWING TITLE: **ANCHOR OPTIONS**
SHEET NO.: **9 OF 9**

OMAR ABU-YASEIN
FLORIDA PROFESSIONAL ENGINEER
No. 52851
STATE OF FLORIDA
DATE SIGNED: **3/24/2011**

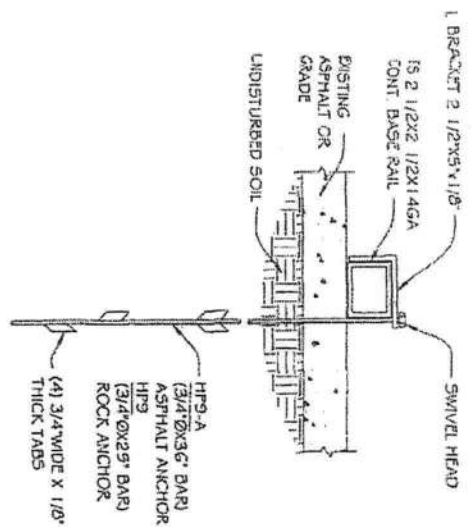

OPTIONAL ASPHALT/ ROCK ANCHOR DETAIL

(SCALE: NTS)

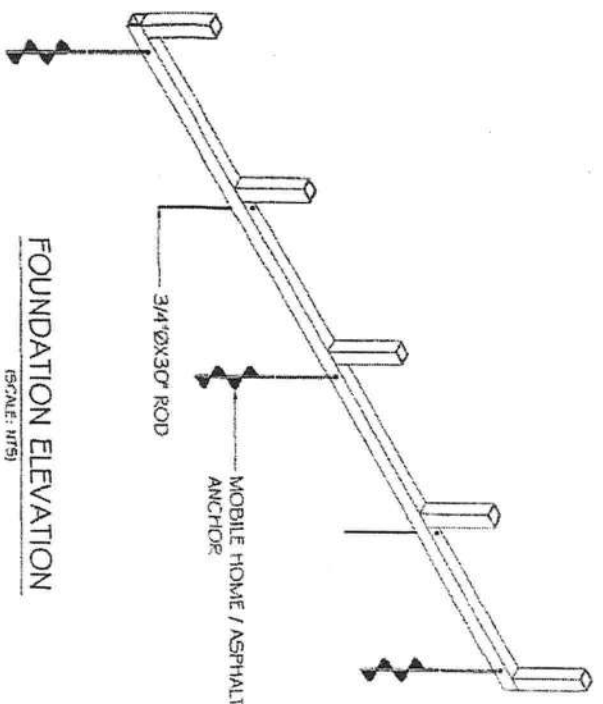

FOUNDATION ELEVATION

(SCALE: NTS)

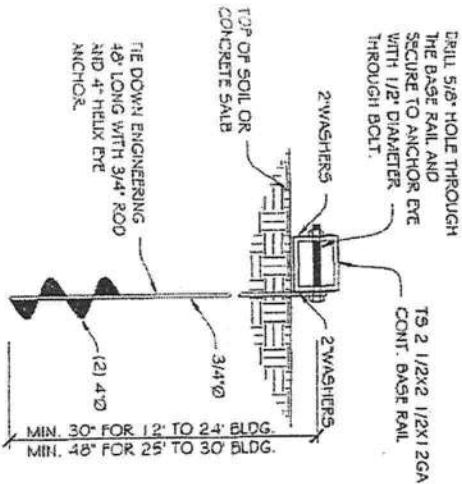

OPTIONAL MOBILE HOME ANCHOR FOR SAND/CLAY

(SCALE: NTS)

NOTE:
HELICAL ANCHORS ARE NOT TO BE USED IF DRIVING TORQUE INTO GROUND IS LESS THAN 150 FT-LBS OR DON'T MEET ONE OF THE FOLLOWING SOIL CLASSIFICATIONS.

- NOTES:
1. MOBILE HOME ANCHORS SHALL BE REQUIRED AT ALL CORNER POSTS AND AT EVERY OTHER POST BUT SHALL NOT EXCEED 10'-0" SPACING IN ANY DIRECTION.
 2. ALL OTHER POSTS WITH NO MOBILE HOME ANCHOR SHALL BE ANCHORED TO THE GROUND WITH 3/4x3/8" ROD. RODS SHALL HAVE A WELDED NUT AT TOP AND ONE COAT OF RUST PROVE PRIMER PAINT.
 3. ASSUMED SOIL BEARING CAPACITY IS TO BE A MIN. 1500 PSF CONCRETE STRENGTH TO BE A MIN. OF 2500 PSI AT 28 DAYS
 - 4.

SOIL CLASSIFICATIONS:

- | SOIL CLASS | SOIL DESCRIPTION |
|------------|------------------------------------------------------------------------------------------------|
| 2 | VERY DENSE & / OR CEMENTED SANDS, COARSE GRAVEL AND COBBLES, COLICHE, PRELOADED SILT AND CLAYS |
| 3 | MEDIUM DENSE COARSE SANDS, SANDY GRAVELS, VERY STIFF SILTS, AND CLAYS |
| 4 | LOOSE TO MEDIUM DENSE SANDS, FIRM TO STIFF CLAYS AND SILTS |

ALLUVIAL FILL AND VERY LOOSE TO MEDIUM DENSE SANDS, FIRM TO STIFF CLAYS AND SILTS, ALLUVIAL FILL.

HELICAL ANCHOR SHALL BE APPROVED FOR USE IN SOIL CLASSIFICATIONS 2, 3, AND 4.

TAKEN FROM ILLD STANDARD FOR INSTALLATION OF MOBILE HOMES

A & A ENGINEERING
CIVIL & STRUCTURAL
SINCE 1986

3911 Renaissance Pk., Suite B
Toledo, Ohio 43623

Tel: (419) 292-1983
Fax: (419) 292-0955

T-N-T
Metal Buildings Inc.
170 Holly Springs Rd.
Mt. Airy, NC 27030

1-800-597-3597
MAIN - 1-336-789-3518
FAX - 1-336-789-4122

OWNER: **TNT METAL BUILDING, INC.**

LOCATION: **FLORIDA**

DRAWING NO.: **TNT-FL**

DATE: **3/24/2011**

PROJECT NUMBER: **039-11-0221**

DRAWN BY: **JMS**

CHECKED BY: **OA**

DRAWING TITLE: **ANCHORAGE**

SHEET NO.: **9 OF 9**

OMAR ABU-YASEIN
No. 52861
STATE OF FLORIDA
PROFESSIONAL ENGINEER

DATE SIGNED: **3/24/2011**

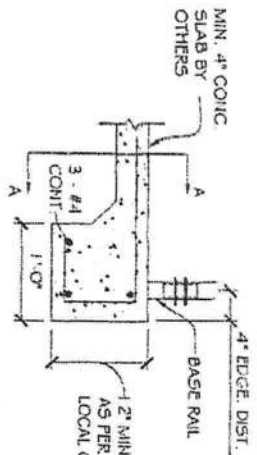

**BASE ANCHOR
ON CONC. SLAB SECTION**
(SCALE: NTS)

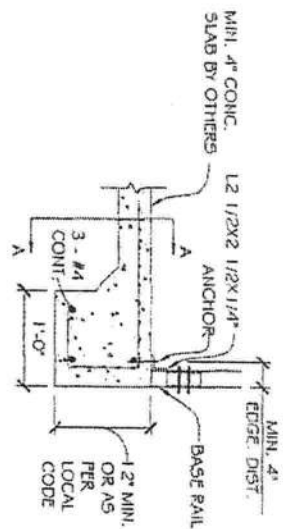

**ALTERNATE, FRAME
FLUSH W/ CONC.**
(SCALE: NTS)

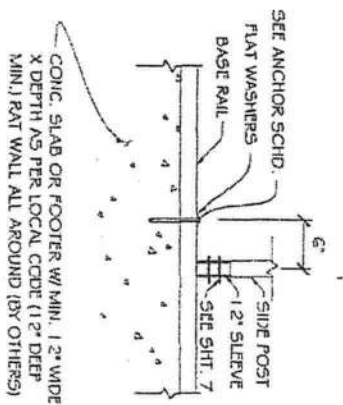

SECTION A-A
(SCALE: NTS)

ANCHOR SIZE OPTIONS SCHEDULE

	WIND SPEED (MPH)	BASE ANCHOR	ALTERNATE ANCHOR	REMARKS	CARPORT WIDTH
	90 - 120	130 - 150	90 - 120		
1	5/8"	3/4"	7"	INSERT W/ EPOXY IN CONC.	ALL SIZES
2	5/8"	3/4"	7"	EXPANSION BOLTS	ALL SIZES
3	5/8"	3/4"	7"	WEDGE ANCHORS IN CONC.	ALL SIZES

- NOTE:
1. PROVIDE A MIN. OF (1) ANCHOR AT ±6" FROM CENTER OF EACH POST
 2. ALL ANCHORS SHALL BE A307 OR BETTER
 3. ASSUMED SOIL BEARING CAPACITY IS TO BE A MIN. 1500 PSF
 4. CONCRETE STRENGTH TO BE A MIN. OF 2500 PSI AT 28 DAYS

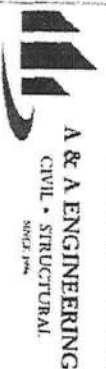

5911 Renaissance Pl., Suite B
Toledo, Ohio 43623
Tel: (419) 292-1983
Fax: (419) 292-0755

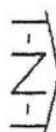

Metal Buildings Inc.
170 Holly Springs Rd.
Mr. Atry, NC 27030
1-800-597-3597
MAIN - 1-336-789-3818
FAX - 1-336-789-4122

OWNER:

TNT METAL BUILDING, INC.

LOCATION: FLORIDA

DRAWING NO.: TNT-FL

DATE: 3/24/2011

PROJECT NUMBER:

039-11-0221

DRAWN BY:

JMS

CHECKED BY:

OA

DRAWING TITLE:

**CONC. SLAB
ANCHORAGE**

SHEET NO.:

9 OF 9

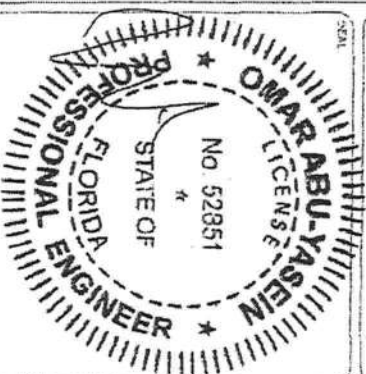

DATE SIGNED: 3/24/2011