

REVISIONS

SOFTPLAN  
ARCHITECTURAL DESIGN SOFTWARE

Electrical Plan Notes:

- E-1 Wire all appliances, HVAC units and other equipment per manufactures specifications.
- E-2 Consult the owner for the number or separate telephone lines to be installed. Owner is responsible for all overages not noted on plan.
- E-3 All installations shall be per national code 2008.
- E-4 All smoke detectors shall be 120v with battery back-up of the photoelectric type, and shall be interlocked together. Install inside and near all bedrooms.
- E-5 Telephone, television and other low voltage devices or outlets shall be as per the owners directions and in accordance with applicable sections of the National Electric Codes latest edition. Owner is responsible for all overages not noted on plan.
- E-6 Electrical contractor shall be responsible for the design and sizing of electrical service and circuits.
- E-7 Entry of service (underground or overhead) to be determined by contractor agreement.
- E-8 All outlets located in residential to be tamper-resistant per NEC.
- E-9 All outlets to be located above base flood elevation.
- E-10 All exterior GFI outlets shall be weatherproof.
- E-11 Overcurrent Protection device shall be installed on the exterior of structures on the load side of the meter to serve as a disconnecting means. Conductors used from the exterior disconnecting means to a panel or sub panel shall have four-wire conductors, of which one conductor shall be used as an equipment ground.
- E-12 All 120-VOLT, single phase, 15 and 20 ampere branch circuits supplying outlets installed in dwelling unit family rooms, dining rooms, living rooms, parlors, libraries, dens, bedrooms, sun rooms, recreation rooms, closets, hallways, or similar rooms or areas shall be protected by a listed arc-fault circuit interrupter, combination-type installed to provide protection of the branch circuit.
- E-13 Carbon Monoxide alarms shall be required within 10' of all rooms for sleeping purposes in buildings having a fossil-fuel burning heater or appliance, a fireplace or attached garage.

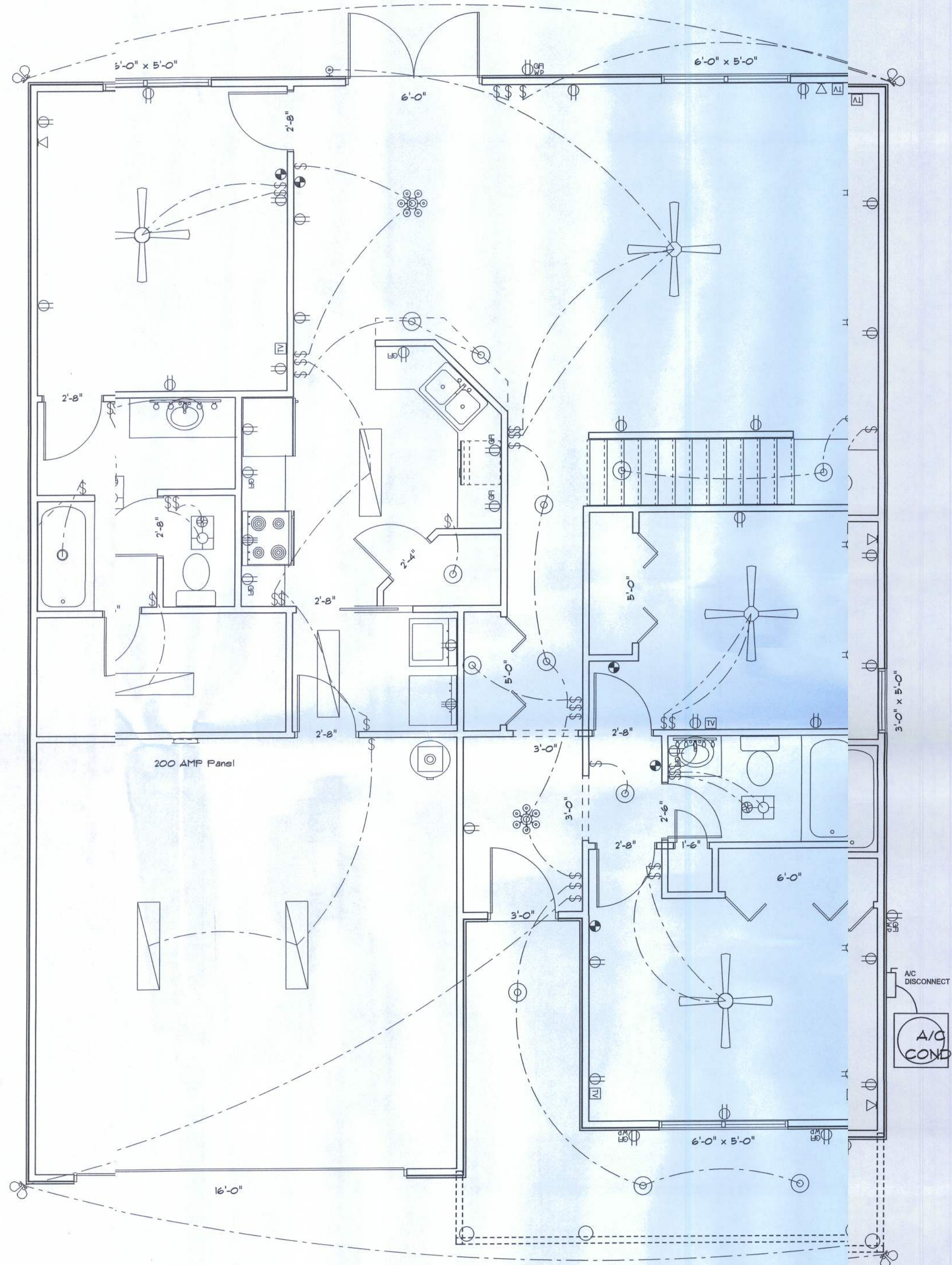

Electrical Plan

ELECTRICAL	SYMBOL
ceiling fan	
ceiling fan globe 1	
ceiling globe light	
chandelier	
double spotlight	
fluorescent fixture	
pot light	
vanity bar light	
wall sconce	
electrical panel	
AC Disconnect	
Outlet WP GFI	
cable tv outlet	
fan	
light	
outlet	
outlet 220v	
outlet gfi	
smoke detector	
switch	
telephone	

RESIDENCE

Blake Wright  
288 SW Deanna Terr.  
Lake City, FL 32025

ADDRESS:  
Columbia County, Florida

Woodman Park Builders, Inc.  
Lake City, Florida  
Phone: (386) 755 - 2411  
Fax: (386) 755-8684  
Email:

PRINTED DATE:

DRAWN BY: CHECKED BY:

DESIGNED BY:

Mark Haddock

FINALS DATE:

JOB NUMBER:

DRAWING NUMBER

A-2