

Scale: 1/32"=1'

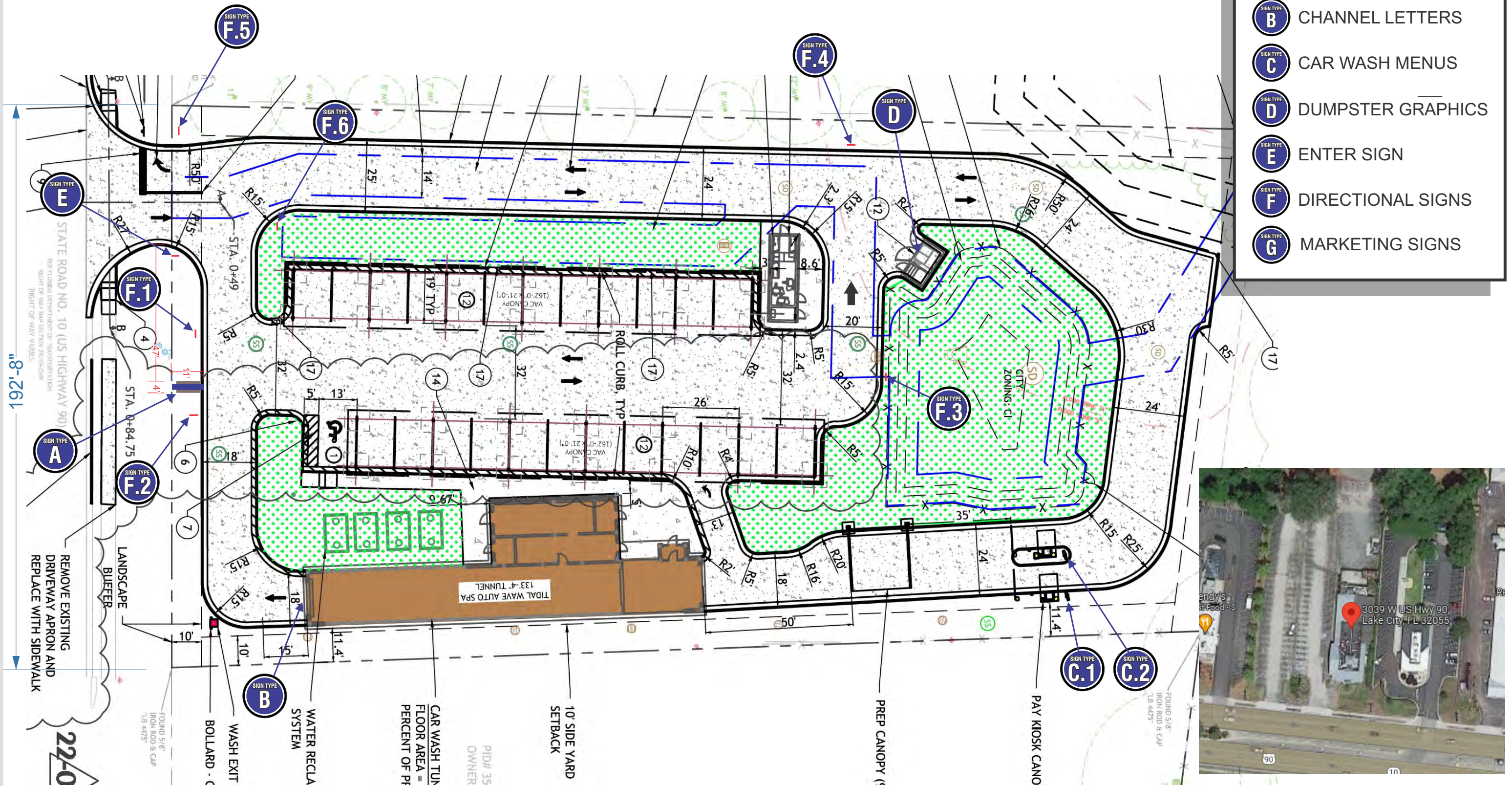

5198 NORTH LAKE DRIVE
LAKE CITY, GA 30260
404-361-3800
FAX 404-361-7038
WWW.CLAYTONSIGNS.COM

DATE - 7.22.22

SIGN TYPE

EXTERIOR SIGN PACKAGE

CLIENT
TIDAL WAVE
3039 WEST US 90
LAKE CITY, FL 32055

REVISIONS:

REVISION # - DATE

DESIGNER RYAN M
ACCOUNT REP. TODD WILLIS

SCALE: AS INDICATED

DRAWING FILE NAME

O:\RM\ TIDAL WAVE \ LAKE CITY FL
TIDAL WAVE LAKE CITY FL SIGN PACKAGE -
7.22.22 .CDR

DRAWING
STATUS:

THIS DRAWING IS AN ORIGINAL, UNPUBLISHED
DESIGN CREATED BY CLAYTON SIGNS, INC. IT IS
NOT TO BE REPRODUCED, CHANGED, OR
EXHIBITED TO ANYONE OUTSIDE OF YOUR
COMPANY IN WHOLE OR IN PART WITHOUT
WRITTEN PERMISSION FROM THE OWNER OF
CLAYTON SIGNS, INC. ANY SUCH ACTIONS MAY BE
SUBJECT TO LEGAL ACTION IN A COURT OF LAW.

©2019 ALL RIGHTS RESERVED

SITE PLAN NOTES

1. PROJECT ADDRESS: TIDAL WAVE - LAKE CITY, FL
3039 W US HWY 90, LAKE CITY, FL 32055, COLUMBIA COUNTY, FL

OWNER: TWAS PROPERTIES LLC
115 E MAIN ST
THOMASTON, GA 30286

ARCHITECT: KERN ARCHITECTS

ENGINEER: ATLAS TECHNICAL CONSULTANTS
8440 JEFFERSON HIGHWAY
BATON ROUGE, LA 70809
OFFICE: 225-369-6585

2. ZONING: C1 (LAKE CITY) & RSF-2 (COLUMBIA COUNTY)

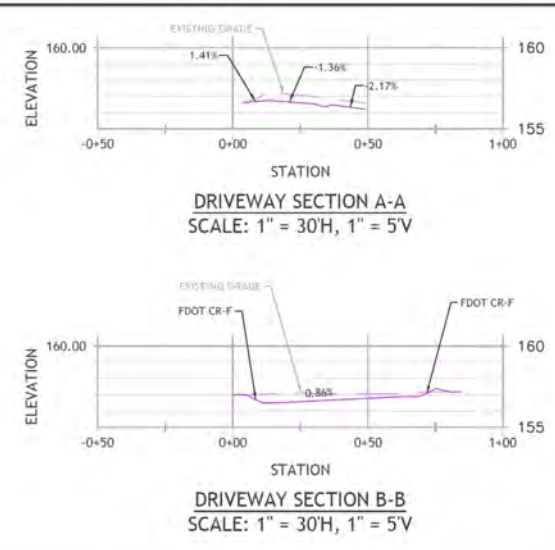
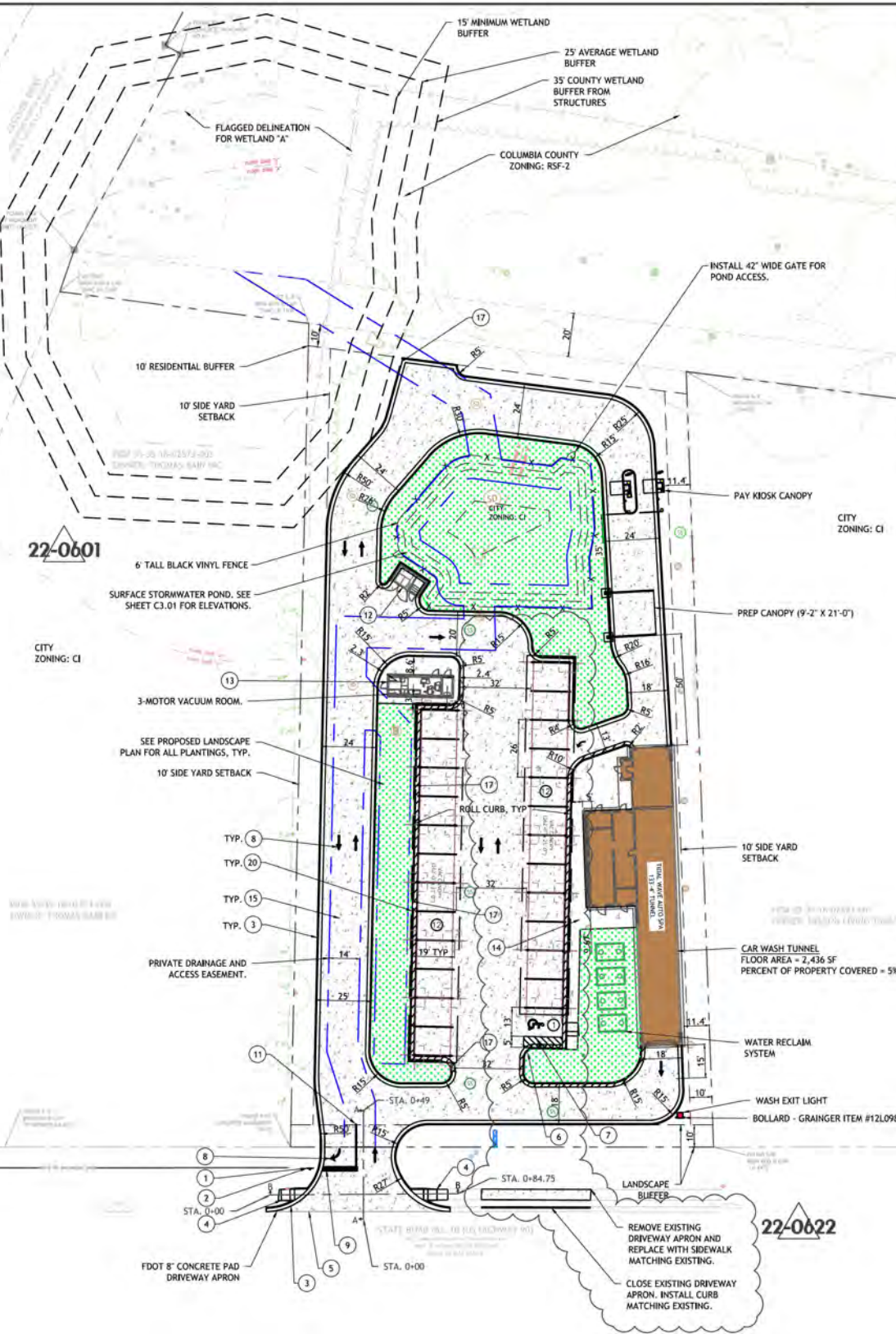

OLSON LAND PARTNERS, LLC
Real Estate Acquisition & Development
4300 Legacyway Drive, Suite 234
Deerfield, Florida 32541
T: 850/659-4353 F: 850/659-3061

PROJECT: **TIDAL WAVE**

TIDAL WAVE AUTO SPA
Highway 90
Lake City, FL

PROTOTYPE: 13302C
PROTOTYPE DATE: N/A
SETUP DATE:
SET NAME:
ISSUED FOR CONSTRUCTION
SET DATE: 06/23/2022
PROFESSIONAL OF RECORD:

ANDREW T. PANKOPP
LICENSE
No. 93545
6/23/2022
STATE OF
FLORIDA
PROFESSIONAL ENGINEER

DESIGNER'S INFORMATION

ATLAS
8440 JEFFERSON HIGHWAY, SUITE 400
BATON ROUGE, LA 70809
OFFICE: 225-369-6585

This item has been digitally signed and sealed by Andrew T. Pankopp, PE, on 06/23/2022.

Printed copies of this document are not considered signed and sealed and the signature must be verified on any electronic copies

- SITE KEY NOTES**
1. MUTCD R1-1 SIGN 36"
 2. MUTCD R3-5R SIGN
 3. FDOT TYPE F CURB AND GUTTER
 4. FDOT CR-F CURB RAMP
 5. FDOT TURNOUT APRON, 8" THICK
 6. 5" WIDE WHITE HANDICAP STRIPING
 7. HANDICAP SYMBOL
 8. DIRECTIONAL ARROW
 9. 24" WIDE WHITE STOP BAR
 10. 5" WIDE WHITE DRIVE STRIPING
 11. 6" WIDE DOUBLE YELLOW STRIPE-SOLID
 12. TRASH ENCLOSURE BY OTHERS
 13. VACUUM STATION
 14. CONCRETE SIDEWALK
 15. HEAVY DUTY CONCRETE
 16. FDOT CR 1 CURB RAMP
 17. 48" WIDE CURB CUT
 18. VACUUM CANOPY
 19. LANDSCAPING BY OTHERS
 20. ROLL CURB

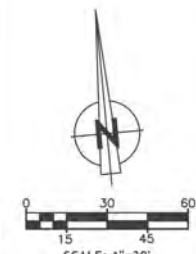

SHEET DATE: 06/23/2022	
SHEET REVISIONS:	
▲ DATE	DESCRIPTION
▲ 22-0601	SITE REVISION
▲ 22-0622	SITE REVIEW COMMENTS
DRAWN BY: RM, TD	
SHEET TITLE:	
SITE PLAN	
SHEET SCALE: SEE SCALE	
SHEET NUMBER: C2.01	

* NOTE: SCALE REPRESENTS FULL SIZE PLOTS ON 34" X 22" SHEET. HALF-SIZE PLOTS SHALL USE DOUBLE SCALE.

CLAYTON Signs
Since 1965

5198 NORTH LAKE DRIVE
LAKE CITY, GA 30260
404-361-3800
FAX 404-361-7038
WWW.CLAYTONSIGNS.COM

DATE - 7.22.22
SIGN TYPE
EXTERIOR SIGN PACKAGE

CLIENT
TIDAL WAVE
3039 WEST US 90
LAKE CITY, FL 32055

REVISIONS:
REVISION # - DATE

DESIGNER RYAN M
ACCOUNT REP TODD WILLIS

SCALE: AS INDICATED
DRAWING FILE NAME
O:\RM\TIDAL WAVE\LAKE CITY FL
TIDAL WAVE LAKE CITY FL SIGN PACKAGE -
7.22.22.CDR

DRAWING STATUS:

NF
NOT FINAL

THIS DRAWING IS AN ORIGINAL, UNPUBLISHED DESIGN CREATED BY CLAYTON SIGNS, INC. IT IS NOT TO BE REPRODUCED, CHANGED, OR EXHIBITED TO ANYONE OUTSIDE OF YOUR COMPANY IN WHOLE OR IN PART WITHOUT WRITTEN PERMISSION FROM THE OWNER OF CLAYTON SIGNS, INC. ANY SUCH ACTIONS MAY BE SUBJECT TO LEGAL ACTION IN A COURT OF LAW.

©2019 ALL RIGHTS RESERVED