



STATE OF FLORIDA
DEPARTMENT OF HEALTH
ONSITE SEWAGE TREATMENT AND DISPOSAL
SYSTEM
APPLICATION FOR CONSTRUCTION PERMIT

PERMIT NO. 20,0488
DATE PAID: 8/26/20
FEE PAID: 600.00
RECEIPT #: 1554503

APPLICATION FOR:

☐ New System ☐ Existing System ☐ Holding Tank ☐ Innovative
☐ Repair ☐ Abandonment ☐ Temporary ☒ Swimming Pool

APPLICANT: Raymond David Hackney

AGENT: Raymond or Alice Peden

TELEPHONE: 755-2848

MAILING ADDRESS: 158 SW Elk Hunter Glen Fort White FL

TO BE COMPLETED BY APPLICANT OR APPLICANT'S AUTHORIZED AGENT. SYSTEMS MUST BE CONSTRUCTED BY A PERSON LICENSED PURSUANT TO 489.105(3) (m) OR 489.552, FLORIDA STATUTES. IT IS THE APPLICANT'S RESPONSIBILITY TO PROVIDE DOCUMENTATION OF THE DATE THE LOT WAS CREATED OR PLATTED (MM/DD/YY) IF REQUESTING CONSIDERATION OF STATUTORY GRANDFATHER PROVISIONS.

PROPERTY INFORMATION

LOT: — BLOCK: — SUBDIVISION: — PLATTED: —

PROPERTY ID #: 05651709607203 ZONING: — I/M OR EQUIVALENT: ☒ Y ☐ N

PROPERTY SIZE: 5 ACRES WATER SUPPLY: ☒ PRIVATE PUBLIC ☐ ≤ 2000 GPD ☐ > 2000 GPD

IS SEWER AVAILABLE AS PER 381.0065, FS? ☒ Y ☐ N DISTANCE TO SEWER: 60' FT

PROPERTY ADDRESS: 159 SW Sydney Nicole Ct. Lake City

DIRECTIONS TO PROPERTY: SW Main Blvd - (R) Forest Lawn Way ->
(L) SW Hunter Leigh Place - (R) Sydney Nicole Ct.
#159

BUILDING INFORMATION

☐ RESIDENTIAL

☐ COMMERCIAL

Unit No	Type of Establishment	No. of Bedrooms	Building Area Sqft	Commercial/Institutional System Design Table 1, Chapter 64E-6, FAC
1	<u>Pool</u>	<u>—</u>	<u>—</u>	<u>—</u>
2	<u>—</u>	<u>—</u>	<u>—</u>	<u>—</u>
3	<u>—</u>	<u>—</u>	<u>—</u>	<u>—</u>
4	<u>—</u>	<u>—</u>	<u>—</u>	<u>—</u>

☐ Floor/Equipment Drains ☐ Other (Specify) —

SIGNATURE: [Signature] DATE: 8-20-20

47131

STATE OF FLORIDA
DEPARTMENT OF HEALTH
APPLICATION FOR CONSTRUCTION PERMIT

Permit Application Number 20-0688

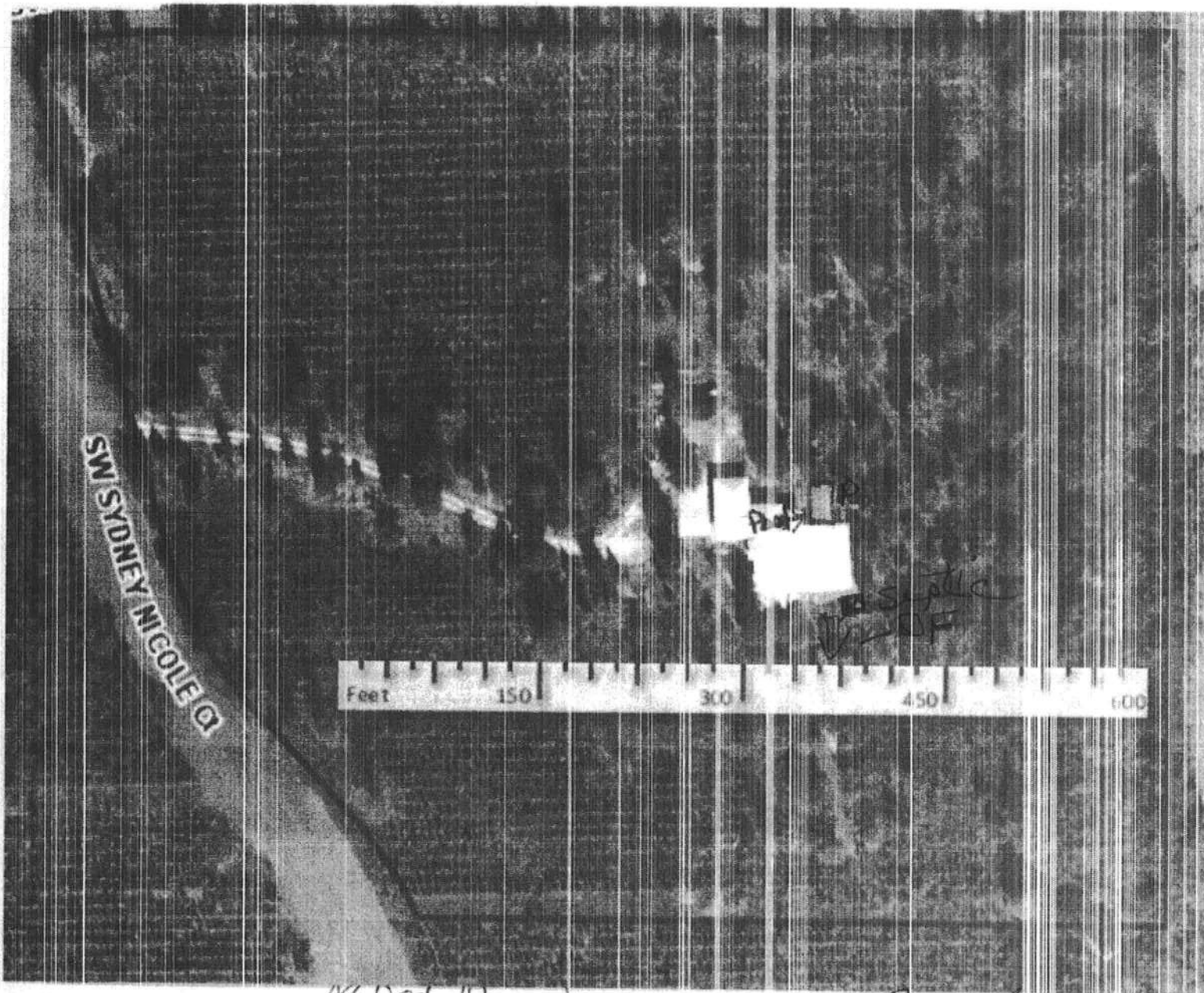

Site Plan submitted by [Signature] Agent [Signature]
Plan Approved ☒ Not Approved ☐ Date 8/27/16
By [Signature] Columbo County Health Department

ALL CHANGES MUST BE APPROVED BY THE COUNTY HEALTH DEPARTMENT