

DATE 07/19/2010

Columbia County Building Permit
This Permit Must Be Prominently Posted on Premises During Construction

PERMIT
000028728

APPLICANT ROBERT MINNELLA PHONE 352-472-6010
ADDRESS 5743 SW 22ND.PL NEWBERRY FL 32669
OWNER PAULINE & ORMAN GRAHAM PHONE 755-1746
ADDRESS 1725 SE CR 18 LAKE CITY FL 32024
CONTRACTOR DALE HOUSTON PHONE 386.752.7814
LOCATION OF PROPERTY 441-S TO C-18,TL GO 1.8 MILE TOGREEN FLAG ON L...FIRST
DRIVEWAY ON L PAST BAPTIST CHURCH.
TYPE DEVELOPMENT M/H/UTILITY ESTIMATED COST OF CONSTRUCTION 0.00
HEATED FLOOR AREA TOTAL AREA HEIGHT STORIES
FOUNDATION WALLS ROOF PITCH FLOOR
LAND USE & ZONING A-3 MAX. HEIGHT
Minimum Set Back Requirments: STREET-FRONT REAR SIDE
NO. EX.D.U. 1 FLOOD ZONE X DEVELOPMENT PERMIT NO.

PARCEL ID 23-6S-17-09747-001 SUBDIVISION
LOT BLOCK PHASE UNIT TOTAL ACRES 63.00

IH0000040
Culvert Permit No. Culvert Waiver Contractor's License Number Applicant/Owner/Contractor
EXISTING 10-0335-M BLK TC N
Driveway Connection Septic Tank Number LU & Zoning checked by Approved for Issuance New Resident

COMMENTS: REPLACING EXISTING M/H. 1 FOOT ABOVE ROAD.

Check # or Cash 5260

FOR BUILDING & ZONING DEPARTMENT ONLY

(footer/Slab)

Temporary Power Foundation Monolithic
 date/app. by date/app. by date/app. by
Under slab rough-in plumbing Slab Sheathing/Nailing
 date/app. by date/app. by date/app. by
Framing Insulation
 date/app. by date/app. by
Rough-in plumbing above slab and below wood floor Electrical rough-in
 date/app. by date/app. by
Heat & Air Duct Peri. beam (Lintel) Pool
 date/app. by date/app. by date/app. by
Permanent power C.O. Final Culvert
 date/app. by date/app. by date/app. by
Pump pole Utility Pole M/H tie downs, blocking, electricity and plumbing
 date/app. by date/app. by date/app. by
Reconnection RV Re-roof
 date/app. by date/app. by date/app. by

BUILDING PERMIT FEE \$ 0.00 CERTIFICATION FEE \$ 0.00 SURCHARGE FEE \$ 0.00
MISC. FEES \$ 300.00 ZONING CERT. FEE \$ 50.00 FIRE FEE \$ 0.00 WASTE FEE \$
FLOOD DEVELOPMENT FEE \$ FLOOD ZONE FEE \$ 25.00 CULVERT FEE \$ TOTAL FEE 375.00
INSPECTORS OFFICE CLERKS OFFICE

NOTICE: IN ADDITION TO THE REQUIREMENTS OF THIS PERMIT, THERE MAY BE ADDITIONAL RESTRICTIONS APPLICABLE TO THIS PROPERTY THAT MAY BE FOUND IN THE PUBLIC RECORDS OF THIS COUNTY. AND THERE MAY BE ADDITIONAL PERMITS REQUIRED FROM OTHER GOVERNMENTAL ENTITIES SUCH AS WATER MANAGEMENT DISTRICTS, STATE AGENCIES, OR FEDERAL AGENCIES.

"WARNING TO OWNER: YOUR FAILURE TO RECORD A NOTICE OF COMMENCEMENT MAY RESULT IN YOUR PAYING TWICE FOR IMPROVEMENTS TO YOUR PROPERTY. IF YOU INTEND TO OBTAIN FINANCING, CONSULT WITH YOUR LENDER OR AN ATTORNEY BEFORE RECORDING YOUR NOTICE OF COMMENCEMENT."

EVERY PERMIT ISSUED SHALL BECOME INVALID UNLESS THE WORK AUTHORIZED BY SUCH PERMIT IS COMMENCED WITHIN 180 DAYS AFTER ITS ISSUANCE, OR IF THE WORK AUTHORIZED BY SUCH PERMIT IS SUSPENDED OR ABANDONED FOR A PERIOD OF 180 DAYS AFTER THE TIME THE WORK IS COMMENCED. A VALID PERMIT RECIEVES AN APPROVED INSPECTION EVERY 180 DAYS. WORK SHALL BE CONSIDERED NOT SUSPENDED, ABANDONED OR INVALID WHEN THE PERMIT HAS RECIEVED AN APPROVED INSPECTION WITHIN 180 DAYS OT THE PREVIOUS INSPECTION.

The Issuance of this Permit Does Not Waive Compliance by Permittee with Deed Restrictions.

GERMAN ORMAN

M/H OCCUPANCY

COLUMBIA COUNTY, FLORIDA

Department of Building and Zoning Inspection

This Certificate of Occupancy is issued to the below named permit holder for the building and premises at the below named location, and certifies that the work has been completed in accordance with the Columbia County Building Code.

Parcel Number 23-6S-17-09747-001

Building permit No. 000028728

Permit Holder DALE HOUSTON

Owner of Building PAULINE & ORMAN GRAHAM

Location: 1725 SE CR 18, LAKE CITY, FL

Date: 07/26/2010

Jay C

Building Inspector

POST IN A CONSPICUOUS PLACE
(Business Places Only)



PERMIT APPLICATION / MANUFACTURED HOME INSTALLATION APPLICATION

For Office Use Only (Revised 1-10-08) Zoning Official BLK 07.07.10 Building Official J.C.

AP# 1007-03 Date Received 7-2-10 By LH Permit # 28728

Flood Zone X Development Permit N/A Zoning A-3 Land Use Plan Map Category A-3

Comments Replacing Existing MH

FEMA Map# N/A Elevation N/A Finished Floor 1' above RL River N/A In Floodway N/A

☒ Site Plan with Setbacks Shown ☒ EH # 0-0335-M ☐ EH Release ☐ Well letter ☒ Existing well

☒ Recorded Deed or Affidavit from land owner ☒ Letter of Auth. from installer In file ☒ State Road Access

☐ Parent Parcel # _____ ☐ STUP-MH _____ ☐ F W Comp. letter _____

IMPACT FEES: EMS _____ Fire _____ Corr _____ Road/Code _____

School _____ = TOTAL N/A Suspended ☒ App fee paid UF

Property ID # 23-65-17-09747-001 Subdivision _____

☒ **New Mobile Home** ☐ Used Mobile Home MH Size 28x76 Year 2008

Applicant Robert Minnella Phone # (352) 472-6010

Address 25743 SW 22 PL, Newberry, FL 32669

Name of Property Owner Pauline Graham Phone# (386) 755-1746

911 Address 1725 SE CR18, Lake City, FL 32024

Circle the correct power company - FL Power & Light - Clay Electric
 (Circle One) - Suwannee Valley Electric - Progress Energy

Name of Owner of Mobile Home Pauline Graham Phone # (386) 755-1746
 Address 1725 SE CR18, L.C. 31 32024

Relationship to Property Owner Same

Current Number of Dwellings on Property 1

Lot Size 1000x 2750 Total Acreage 63

Do you : Have Existing Drive or Private Drive or need Culvert Permit or Culvert Waiver (Circle one)
 (Currently using) (Blue Road Sign) (Putting in a Culvert) (Not existing but do not need a Culvert)

Is this Mobile Home Replacing an Existing Mobile Home Yes (pd)

Driving Directions to the Property 441 South to 618 (TL) Go 1.8 miles to green flag on left. First driveway on left past Baptist Church.

Name of Licensed Dealer/Installer Dale Houston Phone # (386) 752-7814

Installers Address 136 SW Barrs Glen Lake City, FL 32014

License Number TH0000040 Installation Decal # 1589

Spoke to Nancy 7/9/10

PERMIT WORKSHEET

page 1 of 2

Installer Dale Houston License # TH0000040
 Manufacturer Fleetwood Length x Width 26 x 76 Box
 Name of Owner of A this Mobile Home Pauline Graham
 Phone 386-755-1746
 Address 1725 SE CR18 Lake City, FL 32024

NOTE: If home is a single wide fill out one half of the blocking plan
 If home is a triple or quad wide sketch in remainder of home

I understand Lateral Arm Systems cannot be used on any home (new or used)
 where the sidewall ties exceed 5 ft 4 in.

Installer's initials DH

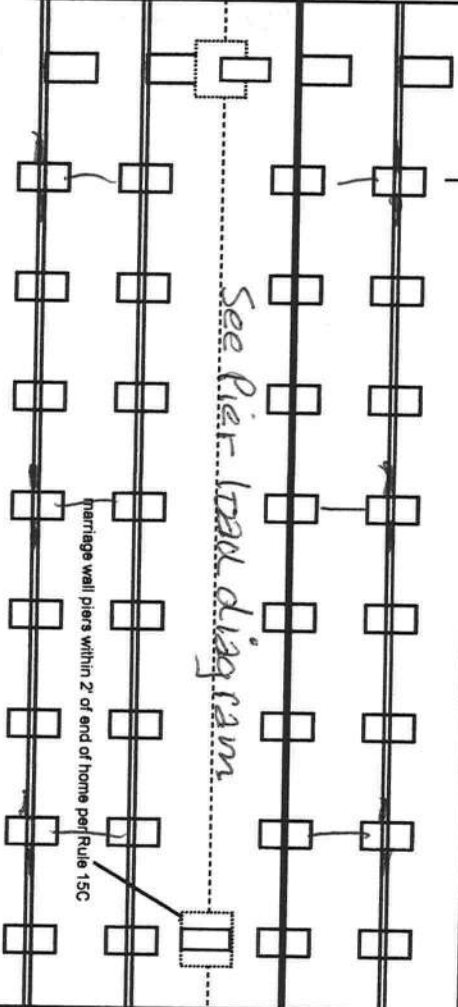

New Home ☒ Used Home ☐ Year 2008
 Home installed to the Manufacturer's Installation Manual ☒
 Home is installed in accordance with Rule 15-C
 Single wide ☐ Wind Zone II ☒ Wind Zone III ☐
 Double wide ☒ Installation Decal # 1589
 Triple/Quad ☐ Serial # 57686 A/B

PIER SPACING TABLE FOR USED HOMES 682 provided

Load bearing capacity (sq in)	16" x 16" (256)	18 1/2" x 18 1/2" (342)	20" x 20" (400)	22" x 22" (484)*	24" x 24" (576)*	26" x 26" (676)
1000 psf	3'	4'	5'	6'	7'	8'
1500 psf	4' 6"	6'	7'	8'	8'	8'
2000 psf	6'	8'	8'	8'	8'	8'
2500 psf	7' 6"	8'	8'	8'	8'	8'
3000 psf	8'	8'	8'	8'	8'	8'
3500 psf	8'	8'	8'	8'	8'	8'

* Interpolated from Rule 15C-1 pier spacing table.

PIER PAD SIZES

I-beam pier pad size

23" x 31"

Perimeter pier pad size

N/A

Other pier pad sizes (required by the mfg.)

16x16 Doors

Draw the approximate locations of marriage wall openings 4 foot or greater. Use this symbol to show the piers.

List all marriage wall openings greater than 4 foot and their pier pad sizes below.

POPULAR PAD SIZES

Pad Size	Sq In
16 x 16	256
16 x 18	288
18.5 x 18.5	342
16 x 22.5	360
17 x 22	374
13 1/4 x 26 1/4	348
20 x 20	400
17 3/16 x 25 3/16	441
17 1/2 x 25 1/2	446
24 x 24	576
26 x 26	676

ANCHORS

Opening Pier pad size

4 ft

5 ft

FRAME TIES

within 2' of end of home spaced at 5' 4" oc

TIEDOWN COMPONENTS

OTHER TIES

Longitudinal Stabilizing Device (LSD)
 Manufacturer Oliver 1101V

Sidewall N/A
 Longitudinal Marriage wall 6
 Shearwall N/A

PERMIT NUMBER

PERMIT WORKSHEET

POCKET PENETROMETER TEST

The pocket penetrometer tests are rounded down to _____ psf or check here to declare 1000 lb. soil _____ without testing.

X _____ X _____ X _____

POCKET PENETROMETER TESTING METHOD

1. Test the perimeter of the home at 6 locations.
2. Take the reading at the depth of the footer.
3. Using 500 lb. increments, take the lowest reading and round down to that increment.

X _____ X _____ X _____

TORQUE PROBE TEST

The results of the torque probe test is _____ inch pounds or check here if you are declaring 5' anchors without testing _____ A test showing 275 inch pounds or less will require 4 foot anchors.

Note: A state approved lateral arm system is being used and 4 ft. anchors are allowed at the sidewall locations. I understand 5 ft anchors are required at all centerline tie points where the torque test reading is 275 or less and where the mobile home manufacturer may require anchors with 4000 lb holding capacity.

Assume 1000 lb. Installer's initials DL

ALL TESTS MUST BE PERFORMED BY A LICENSED INSTALLER

Installer Name _____

Date Tested _____

Electrical

Connect electrical conductors between multi-wide units, but not to the main power source. This includes the bonding wire between multi-wide units. Pg. 23

Plumbing

Connect all sewer drains to an existing sewer tap or septic tank. Pg. 16

Connect all potable water supply piping to an existing water meter, water tap, or other independent water supply systems. Pg. 68

Site Preparation

Debris and organic material removed Yes Swale ✓ Pad ✓ Other _____

Fastening multi wide units

Floor: Type Fastener: Lag Length: 6" Spacing: 2'
Walls: Type Fastener: _____ Length: 6" Spacing: 2'
Roof: Type Fastener: _____ Length: 6" Spacing: 2'
For used homes a min. 30 gauge, 8" wide, galvanized metal strip will be centered over the peak of the roof and fastened with galv. roofing nails at 2" on center on both sides of the centerline.

Gasket (weatherproofing requirement)

I understand a properly installed gasket is a requirement of all new and used homes and that condensation, mold, mildew and buckled marriage walls are a result of a poorly installed or no gasket being installed. I understand a strip of tape will not serve as a gasket.

Installer's initials DL

Type gasket FOAM

Installed: Between Floors Yes
Between Walls Yes
Bottom of ridgebeam Yes

Weatherproofing

The bottomboard will be repaired and/or taped. Yes ✓ Pg. 3
Siding on units is installed to manufacturer's specifications. Yes ✓
Fireplace chimney installed so as not to allow intrusion of rain water. Yes ✓

Miscellaneous

Skirting to be installed. Yes ✓ No _____
Dryer vent installed outside of skirting. Yes ✓ N/A _____
Range downflow vent installed outside of skirting. Yes ✓ N/A _____
Drain lines supported at 4 foot intervals. Yes ✓ N/A _____
Electrical crossovers protected. Yes ✓ _____
Other: _____

Installer verifies all information given with this permit worksheet is accurate and true based on the

Installer Signature Dale Houser

Date 6-29-10

LEGEND



DE
INDEALATION
ANNUAL

3. FOOTING PADS & PLIMS ARE REQUIRED AT SUPPORT POSTS. SEE INSTALLATION MANUAL FOR REQUIREMENTS.

07

MODEL NO.

4764V

DRAWING TITLE

DRAWN BY:
MAY 5

DATE: 06/06/00

SP.1C.1

071ET4764V

Pads

16x16

$25 \frac{1}{2} \times 17 \frac{1}{2} \times 2$
" " "

$23 \times 31 \times 2$
" " "

$17 \times 22 \times 2$

17×22

Fleetwood
26' x 76' + Driftline = 28'
1976 sg. ft

Edward M. Smith
06-30-10

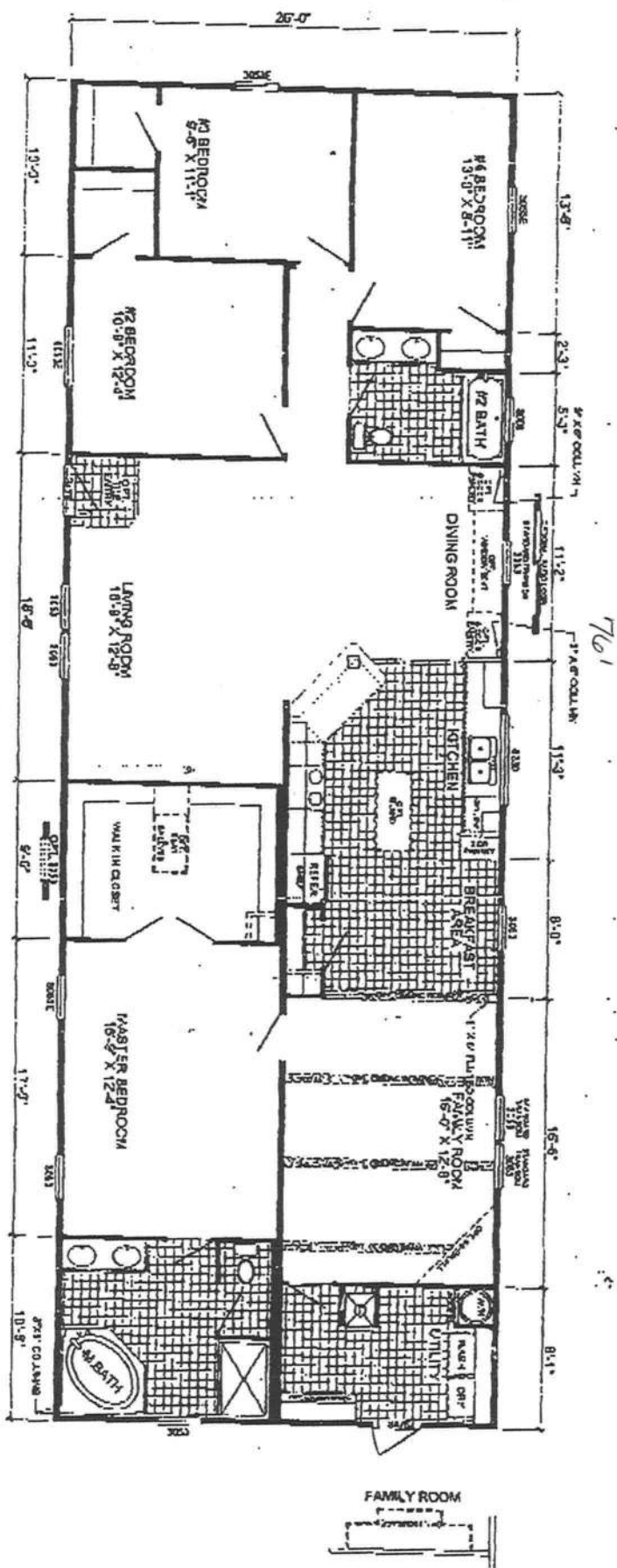

WARRANTY DEED
IMPROV. TO INDIVID

This Warranty Deed Made the 30th day of December

VERNON M. HILL, MARY LOU McFADDEN and SAMUEL C. MEANS,
hereinafter called the grantor, to

ORMAN A. GRAHAM and his wife, PAULINE T. GRAHAM,

whose postoffice address is Route #3, Box 189-H, Lake City, Florida 32055
hereinafter called the grantee:

(Wherever used herein the terms "grantor" and "grantee" include all the parties to this instrument and the heirs, legal representatives and assigns of individuals, and the successors and assigns of corporations)

Witnesseth: That the grantor, for and in consideration of the sum of \$ 10.00 and other valuable considerations, receipt whereof is hereby acknowledged, hereby grants, bargains, sells, alien, releases, conveys and confirms unto the grantee, all that certain land situate in Columbia County, Florida, viz:

DOCUMENTARY STAMP 284.50

INTANGIBLE TAX

MARY B. CHILDS, CLERK OF
COURTS, COLUMBIA COUNTYBY Mary Lou Walters S.C.

SEE ATTACHED

Together with all the tenements, hereditaments and appurtenances thereto belonging or in anywise appertaining.**To Have and to Hold,** the same in fee simple forever.**And** the grantor hereby covenants with said grantee that the grantor is lawfully seized of said land in fee simple; that the grantor has good right and lawful authority to sell and convey said land; that the grantor hereby fully warrants the title to said land and will defend the same against the lawful claims of all persons whomsoever; and that said land is free of all encumbrances, except taxes accruing subsequent to December 31, 10 85**In Witness Whereof,** the said grantor has signed and sealed these presents the day and year first above written.

Signed, sealed and delivered in our presence:

Mary Lou WaltersMary Lou Walters
Vernon M. Hill
Samuel C. MeansSTATE OF FLORIDA
COUNTY OF ALACHUA

I HEREBY CERTIFY that on this day, before me, an officer duly authorized in the State aforesaid and in the County aforesaid to take acknowledgments, personally appeared

VERNON M. HILL, MARY LOU McFADDEN, and
SAMUEL C. MEANS,

to me known to be the persons described in and who executed the foregoing instrument and they acknowledged before me that they executed the same.

WITNESS my hand and official seal in the County and State last aforesaid this 30th day of December, A. D. 19 85.

Mary Lou Walters

This instrument prepared by:

JONATHAN F. WERSHOW
P.O. BOX 1260
GAINESVILLE, FLORIDA 32602BOOK 5 182 100043
12. 10 85 by
OFFICIAL RECORDS

SPACE BELOW FOR RECORDERS USE

JAN - 8 1985
CLERK OF COURTS
COLUMBIA COUNTY, FLORIDA

That part of the NE $\frac{1}{4}$ of Section 23, Township 6 South, Range 17 East, Columbia County, Florida more particularly described as follows:

The East $\frac{1}{4}$ of said NE $\frac{1}{4}$ lying west of the westerly right-of-way line of Old Wire Road and North of the Northerly right-of-way line of State Road No. 18, and South of the Southerly right-of-way line of said State Road No. 18. Containing 63.24 acres, more or less.

SUBJECT TO:

That certain oil, gas and mineral lease dated July 14, 1982 by Mary Lou McFadden, single and Vernon M. Hill, widow and Samuel C. Means, Jr. to Edward F. Scholls, recorded August 26, 1982 in Official Record Book 495, Pages 479-480, which has been assigned by Assignment of Oil, Gas and Mineral Leases dated Sept. 6, 1982 by Edward F. Scholls and Nancy Bentley Scholls, his wife to Ernest H. Cockrell, recorded Dec. 6, 1982 in Official Record Book 501, Pages 715-717, which has been assigned by Assignment of Overriding Royalty by Ernest H. Cockrell to Hunter Yarborough and Tracey Yarborough Williams, recorded August 29, 1983 in Official Record Book 519, Pages 410A-419, all of the public records of Columbia County, Florida.

SUBJECT TO:

Purchase Money Mortgage of even date.

THIS IS NOT HOMESTEAD PROPERTY

COLUMBIA COUNTY 9-1-1 ADDRESSING

P. O. Box 1787, Lake City, FL 32056-1787
PHONE: (386) 758-1125 * FAX: (386) 758-1365 * Email: ron_croft@columbiacountyfla.com

Addressing Maintenance

To maintain the Countywide Addressing Policy you must make application for a 9-1-1 Address at the time you apply for a building permit. The established standards for assigning and posting numbers to all principal buildings, dwellings, businesses and industries are contained in Columbia County Ordinance 2001-9. The addressing system is to enable Emergency Service Agencies to locate you in an emergency, and to assist the United States Postal Service and the public in the timely and efficient provision of services to residents and businesses of Columbia County.

DATE REQUESTED: 4/12/2007 DATE ISSUED: 4/16/2007

ENHANCED 9-1-1 ADDRESS:

1725 SE COUNTY ROAD 18
LAKE CITY FL 32024
PROPERTY APPRAISER PARCEL NUMBER:
23-6S-17-09747-001

Remarks:

Address Issued By:

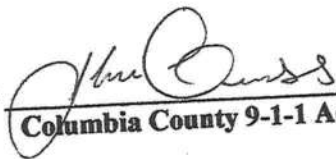
Columbia County 9-1-1 Addressing / GIS Department

NOTICE: THIS ADDRESS WAS ISSUED BASED ON LOCATION INFORMATION RECEIVED FROM THE REQUESTER. SHOULD, AT A LATER DATE, THE LOCATION INFORMATION BE FOUND TO BE IN ERROR, THIS ADDRESS IS SUBJECT TO CHANGE.

717

Approved Address

APR 16 2007

911Addressing/GIS Dept

SUBCONTRACTOR VERIFICATION FORM

APPLICATION NUMBER 207-003CONTRACTOR Dale HoustonPHONE (386) 752-7814

THIS FORM MUST BE SUBMITTED PRIOR TO THE ISSUANCE OF A PERMIT

In Columbia County one permit will cover all trades doing work at the permitted site. It is **REQUIRED** that we have records of the subcontractors who actually did the trade specific work under the permit. Per Florida Statute 440 and Ordinance B9-6, a contractor shall require all subcontractors to provide evidence of workers' compensation or exemption, general liability insurance and a valid Certificate of Competency license in Columbia County.

Any changes, the permitted contractor is responsible for the corrected form being submitted to this office prior to the start of that subcontractor beginning any work. Violations will result in stop work orders and/or fines.

ELECTRICAL 62684	Print Name <u>Wayne J. Plazona</u> License #: <u>EC0002157</u>	Signature <u>Wayne J. Plazona</u> Phone #: <u>386-737-3007</u>
MECHANICAL/A/C 0901	Print Name <u>Robert Grant</u> License #: <u>CAC1814931</u>	Signature <u>Robert Grant</u> Phone #: <u>800-859-3708</u>
PLUMBING/GAS 06673	Print Name <u>Dale Houston</u> License #: <u>IH000040</u>	Signature <u>Dale Houston</u> Phone #: <u>(386) 752-7814</u>
ROOFING	Print Name _____ License #: _____	Signature _____ Phone #: _____
SHEET METAL	Print Name _____ License #: _____	Signature _____ Phone #: _____
FIRE SYSTEM/SPRINKLER	Print Name _____ License #: _____	Signature _____ Phone #: _____
SOLAR	Print Name _____ License #: _____	Signature _____ Phone #: _____

Specialty License	License Number	Subcontractor Printed Name	Sub-Contractor's Signature
MASON			
CONCRETE FINISHER			
FRAMING			
INSULATION			
STUCCO			
DRYWALL			
PLASTER			
CABINET INSTALLER			
PAINTING			
ACOUSTICAL CEILING			
GLASS			
CERAMIC TILE			
FLOOR COVERING			
ALUM/VINYL SIDING			
GARAGE DOOR			
METAL BLDG ERECTOR			

F. S. 440.103 Building permits; identification of minimum premium policy.—Every employer shall, as a condition to applying for and receiving a building permit, show proof and certify to the permit issuer that it has secured compensation for its employees under this chapter as provided in ss. 440.10 and 440.38, and shall be presented each time the employer applies for a building permit.

Graham

Contractor Form 1 (Subcontractor Form 2)



STATE OF FLORIDA
DEPARTMENT OF HEALTH
APPLICATION FOR ONSITE SEWAGE DISPOSAL SYSTEM CONSTRUCTION PERMIT.

Permit Application Number 10-0335M

Graham, Pauline ----- PART II - SITEPLAN -----

Scale: Each block represents ~~10~~ feet and 1 inch = ⁵⁰~~40~~ feet.

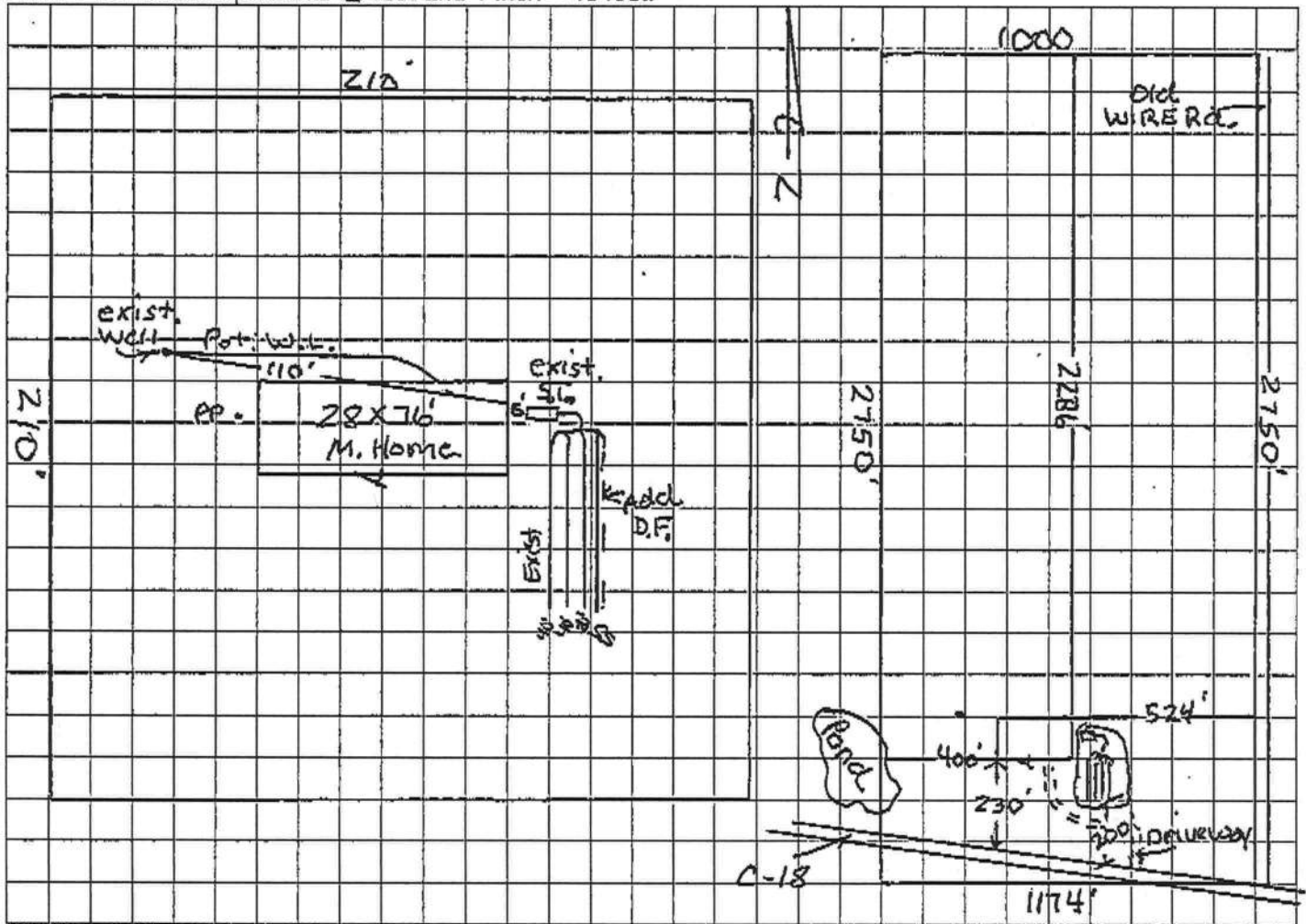

Notes: Existing well & septic

Add. 164ft² (one SS' line) to existing.

Site Plan submitted by: Pauline Graham 06-30-10

Plan Approved Y Signature Not Approved

Agent
Title

Date

By

Columbia CHD

County Health Department

ALL CHANGES MUST BE APPROVED BY THE COUNTY HEALTH DEPARTMENT



Old Permit # 07-0339

5501900588

10-0325M

STATE OF FLORIDA
DEPARTMENT OF HEALTH
ON-SITE SEWAGE DISPOSAL SYSTEM
APPLICATION FOR CONSTRUCTION PERMIT

Call Ahead 386-755-1746
"Dogs" Cell 365-5927

PERMIT NO. 921521
DATE PAID: 7/7/10
FEE PAID: 2500.00
RECEIPT #: 192248

APPLICATION FOR:

☐ New System ☐ Existing System ☐ Holding Tank ☐ Innovative
☐ Repair ☐ Abandonment ☐ Temporary ☒ Modification
Going to 4 bedroom

APPLICANT: Graham, Pauline

AGENT: Robert Minnella

TELEPHONE: (352) 472-6010

MAILING ADDRESS: 25743 SW 22 PL, Newberry, FL 32669

TO BE COMPLETED BY APPLICANT OR APPLICANT'S AUTHORIZED AGENT. SYSTEMS MUST BE CONSTRUCTED BY A PERSON LICENSED PURSUANT TO 489.105(3) (m) OR 489.552, FLORIDA STATUTES.

PROPERTY INFORMATION

LOT: BLOCK: SUBDIVISION: PLATTED:

PROPERTY ID #: 23-65-17-09747-001 ZONING: I/M OR EQUIVALENT: (Y/N)

PROPERTY SIZE: 63 ACRES WATER SUPPLY: ☒ PRIVATE PUBLIC ☐ ≤ 2000 GPD ☐ > 2000 GPDIS SEWER AVAILABLE AS PER 381.0065, FS? ☒ Y ☐ N DISTANCE TO SEWER: FT

PROPERTY ADDRESS: 1725 SE CR 18, Lake City, FL 32024

DIRECTIONS TO PROPERTY: 441 south to C-18 (TL) Go 1.8 miles to
green flag on left. First driveway on left past Baptist
church. (old SW m. home)

BUILDING INFORMATION

☒ RESIDENTIAL☐ COMMERCIAL

Unit No	Type of Establishment	No. of Bedrooms	Building Area Sq Ft	Commercial/Institutional System Design Table 1, Chapter 64E-6, FAC
1	m/H	4	1976	3 people
2				
3				ORIGINAL ATTACHED
4				

☐ Floor/Equipment Drains ☐ Other (Specify)

SIGNATURE: Robert Minnella

DH 4015, 10/97 - Page 1 (Previous editions may be used)
Stock Number: 5744-001-4015-1

RECEIVED

JUL 06 2010

BY: PKC

DATE: 06-30-10

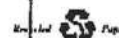

Page 1 of 3