



# FW

STATE OF FLORIDA  
DEPARTMENT OF ENVIRONMENTAL PROTECTION  
ONSITE SEWAGE TREATMENT AND DISPOSAL  
SYSTEM (OSTDS)

PERMIT NO. 23-0837  
DATE PAID: 12/12/23  
FEE PAID: 210.00  
RECEIPT #: 2026882

### APPLICATION FOR CONSTRUCTION PERMIT

APPLICATION FOR:

☒ New System ☐ Existing System ☐ Holding Tank ☐ Innovative  
☐ Repair ☐ Abandonment ☐ Temporary ☐

APPLICANT: Deep Paula G + Daniel Burke

AGENT: Jeff Hardee

EMAIL: jeffhardeehep@aol.com

TELEPHONE: 3562-949-0592

MAILING ADDRESS: 6450 NW 72 Lane Chiefland, FL 32626

TO BE COMPLETED BY APPLICANT OR APPLICANT'S AUTHORIZED AGENT. SYSTEMS MUST BE CONSTRUCTED BY A PERSON LICENSED PURSUANT TO 489.105(3) (m) OR 489.552, FLORIDA STATUTES. IT IS THE APPLICANT'S RESPONSIBILITY TO PROVIDE DOCUMENTATION OF THE DATE THE LOT WAS CREATED OR PLATTED (MM/DD/YY) IF REQUESTING CONSIDERATION OF STATUTORY GRANDFATHER PROVISIONS.

#### PROPERTY INFORMATION

LOT: NA BLOCK: NA SUBDIVISION: NA OSTDS REMEDIATION PLAN? [ Y / N ]  
PLATTED: \_\_\_\_\_

PROPERTY ID #: 10-73-17-09969-004 ZONING: \_\_\_\_\_ I/M OR EQUIVALENT: [ Y / N ]

PROPERTY SIZE: 1.9 ACRES WATER SUPPLY: ☒ PRIVATE PUBLIC [ ] ☐ ≤2000GPD [ ] ☐ >2000GPD

IS SEWER AVAILABLE AS PER 381.0065, FS? [ Y / ☒ N ] DISTANCE TO SEWER: NA FT

PROPERTY ADDRESS: 692 SE Maid Marion LN High Springs, FL

DIRECTIONS TO PROPERTY: 41 South + 1/2 SE Maid Marion LN  
to lot on Right on just after Perimeter ends

#### BUILDING INFORMATION

☒ RESIDENTIAL ☐ COMMERCIAL

Unit No.	Type of Establishment	No. of Bedrooms	Building Area Sqft	Commercial/Institutional System Design Table I, Chapter 62-6, FAC
----------	-----------------------	-----------------	--------------------	---

1	<u>Mobile Home</u>	<u>3</u>	<u>1216</u>	
2				
3				
4				

[ ] Floor/Equipment Drains [ ] Other (Specify) \_\_\_\_\_

SIGNATURE: Jeff Hardee DATE: 12-8-23



STATE OF FLORIDA  
DEPARTMENT OF ENVIRONMENTAL PROTECTION  
APPLICATION FOR CONSTRUCTION PERMIT

Permit Application Number

23-0837

PART II - SITEPLAN

Paula DexP

Scale: Each block represents 10 feet and 1 inch = 40 feet.

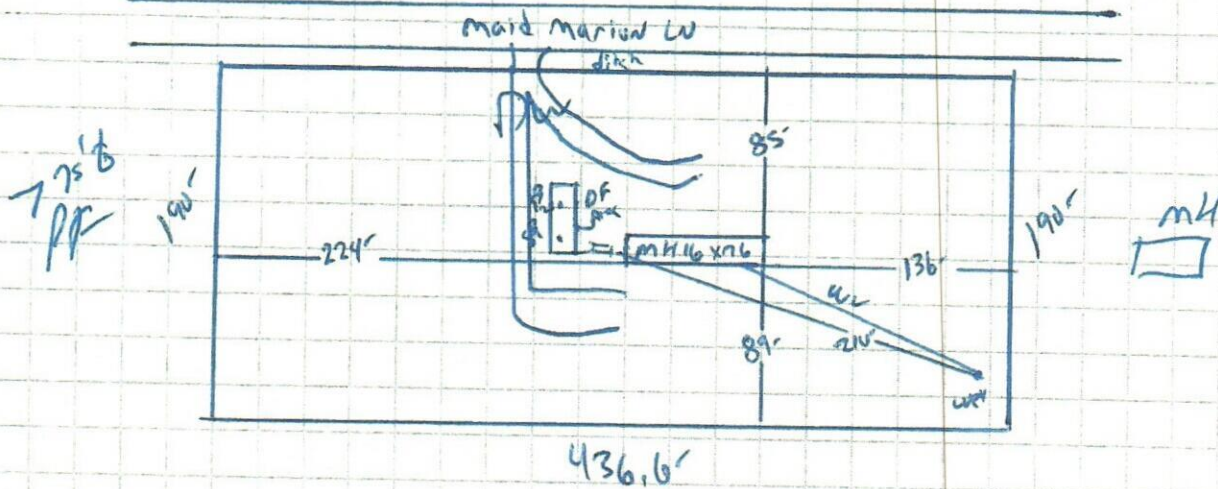

Notes: Limestone & Clay Present in other areas of lot. Install DF at minimum 18" Below Grade.

Site Plan submitted by:

Plan Approved

By

Not Approved

Date 12/19/23

County Health Department

ALL CHANGES MUST BE APPROVED BY THE COUNTY HEALTH DEPARTMENT

DEP 4015, 06-21-2022 (Obsoletes previous editions which may not be used)

Incorporated: 62-6.004, F.A.C.