



STATE OF FLORIDA  
DEPARTMENT OF ENVIRONMENTAL PROTECTION  
ONSITE SEWAGE TREATMENT AND DISPOSAL  
SYSTEM (OSTDS)

PERMIT NO. 25-0537  
DATE PAID: 7-7-25  
FEE PAID: \$60.00  
RECEIPT #: 2238143

APPLICATION FOR CONSTRUCTION PERMIT

APPLICATION FOR:

[ ] New System [x] Existing System [ ] Holding Tank [ ] Innovative  
[ ] Repair [ ] Abandonment [ ] Temporary [ ]

APPLICANT: Michael Cousins EMAIL: lillian@eliteoutdoorbuildings.com

AGENT: Lizzie Brooks TELEPHONE: 847-774-9445

MAILING ADDRESS: 18015 S US Hwy 441, Lake City FL 32024

TO BE COMPLETED BY APPLICANT OR APPLICANT'S AUTHORIZED AGENT. SYSTEMS MUST BE CONSTRUCTED BY A PERSON LICENSED PURSUANT TO 489.105(3) (m) OR 489.552, FLORIDA STATUTES. IT IS THE APPLICANT'S RESPONSIBILITY TO PROVIDE DOCUMENTATION OF THE DATE THE LOT WAS CREATED OR PLATTED (MM/DD/YY) IF REQUESTING CONSIDERATION OF STATUTORY GRANDFATHER PROVISIONS.

PROPERTY INFORMATION

OSTDS REMEDIATION PLAN? [ Y / N ]

LOT: 55 BLOCK: \_\_\_\_\_ SUBDIVISION: Shadow Wood PLATTED: \_\_\_\_\_

PROPERTY ID #: 27-65-17-09787-000 ZONING: \_\_\_\_\_ I/M OR EQUIVALENT: [ Y / N ]

PROPERTY SIZE: 7.83 ACRES WATER SUPPLY: [ ] PRIVATE PUBLIC [ ] <=2000GPD [ ] >2000GPD

IS SEWER AVAILABLE AS PER 381.0065, FS? [ Y / N ] DISTANCE TO SEWER: \_\_\_\_\_ FT

PROPERTY ADDRESS: 18015 S US Hwy 441, Lake City FL 32024

DIRECTIONS TO PROPERTY: \_\_\_\_\_

BUILDING INFORMATION

[x] RESIDENTIAL [ ] COMMERCIAL

Unit No.	Type of Establishment	No. of Bedrooms	Building Area Sqft	Commercial/Institutional System Design Table I, Chapter 62-6, FAC
1	<u>Accessory structure</u>	<u>0</u>	<u>1260</u>	<u>ORIGINAL ATTACHED</u>
2	_____	_____	_____	_____
3	_____	_____	_____	_____
4	_____	_____	_____	_____

[ ] Floor/Equipment Drains [ ] Other (Specify) \_\_\_\_\_

SIGNATURE: [Signature] DATE: 6-30-25

DEP 4015, 06-21-2022 (Obsoletes previous editions which may not be used)

Incorporated 62-6.004, FAC



STATE OF FLORIDA  
DEPARTMENT OF ENVIRONMENTAL PROTECTION  
APPLICATION FOR CONSTRUCTION PERMIT

Permit Application Number 25-0537

----- PART II - SITEPLAN -----

Scale: Each block represents 10 feet and 1 inch = 40 feet.

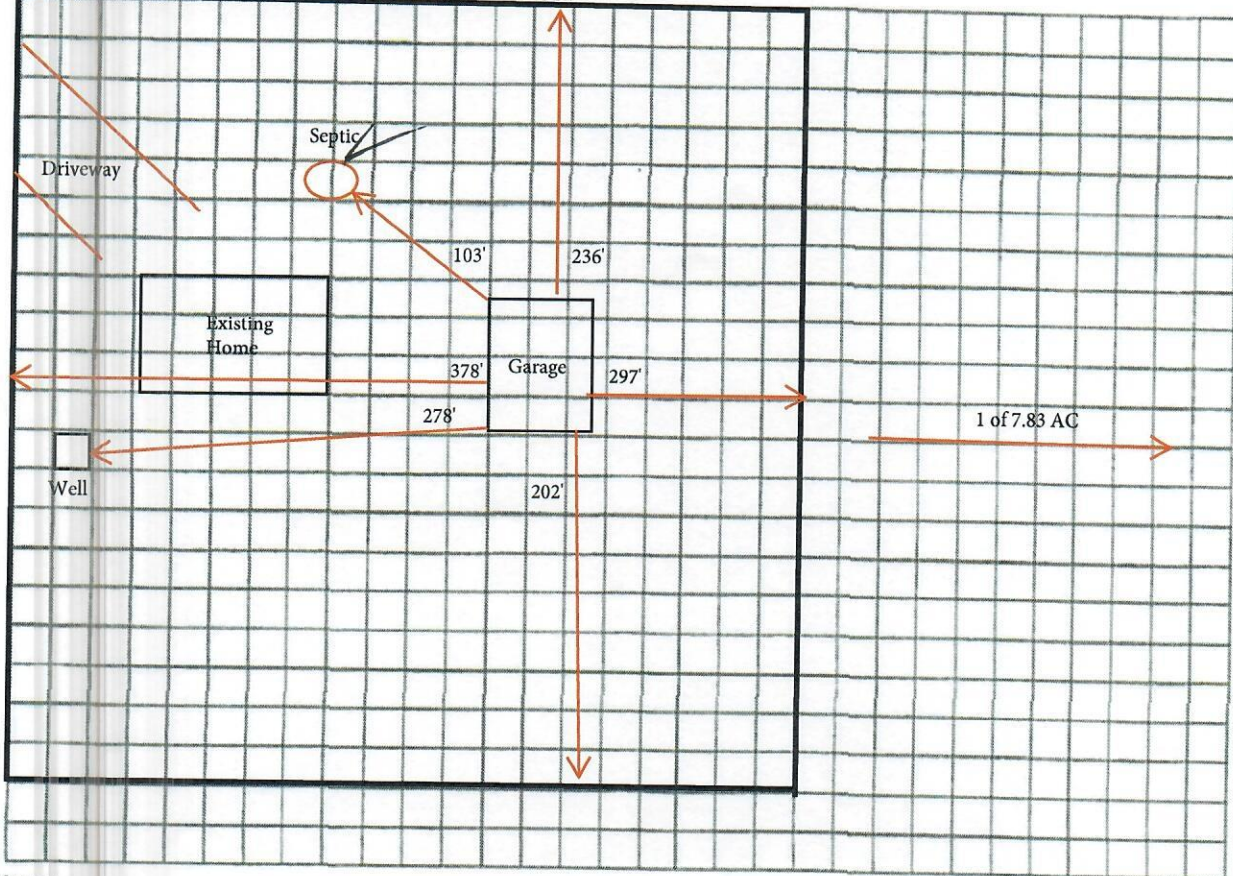

Notes: \_\_\_\_\_ 1 of 7.83 AC

Site Plan submitted by: [Signature]

Plan Approved [Signature] Not Approved \_\_\_\_\_ Date 7/14/25

By \_\_\_\_\_ County Health Department

ALL CHANGES MUST BE APPROVED BY THE COUNTY HEALTH DEPARTMENT

DEP 4015, 06-21-2022 (Obsoletes previous editions which may not be used)  
Incorporated: 62-6.004, F.A.C.