

B CONTINUOUS LATERAL TRUSS BRACING DETAIL

SCALE: 1"=1'-0"

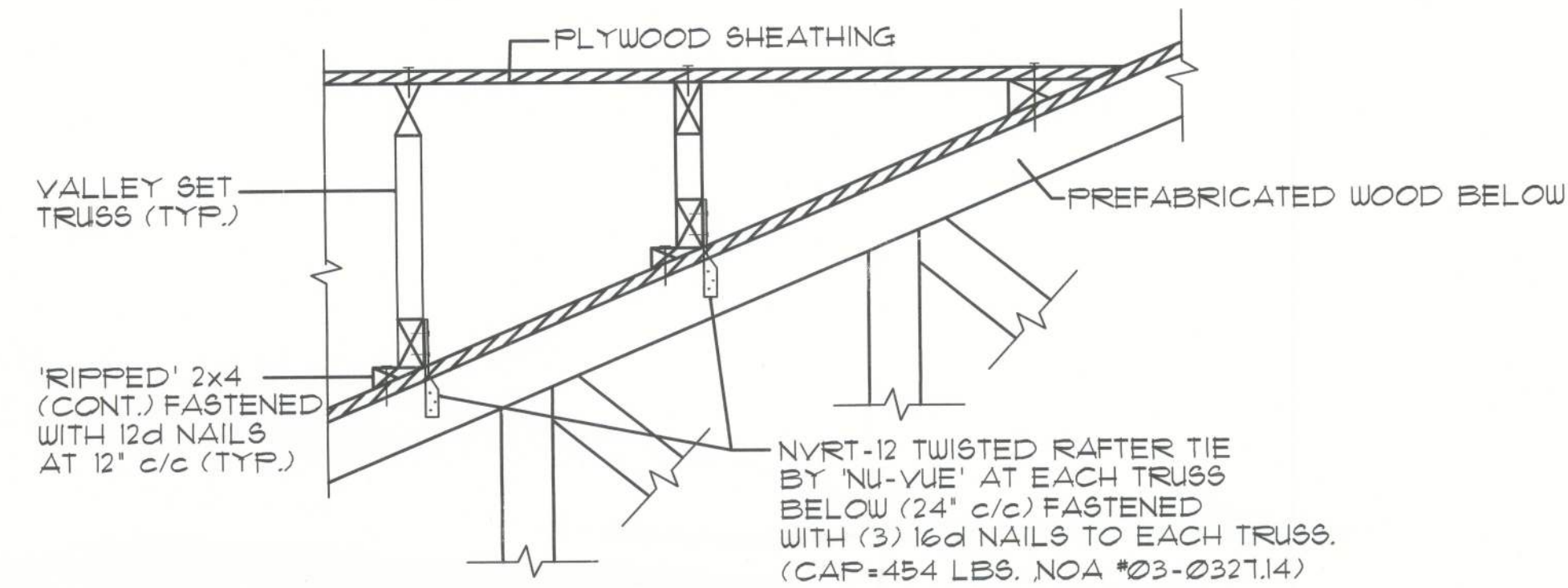

B TYPICAL VALLEY SET ("PIGGYBACK")
TRUSS TIE-DOWN DETAIL

SCALE: 1"=1'-0"

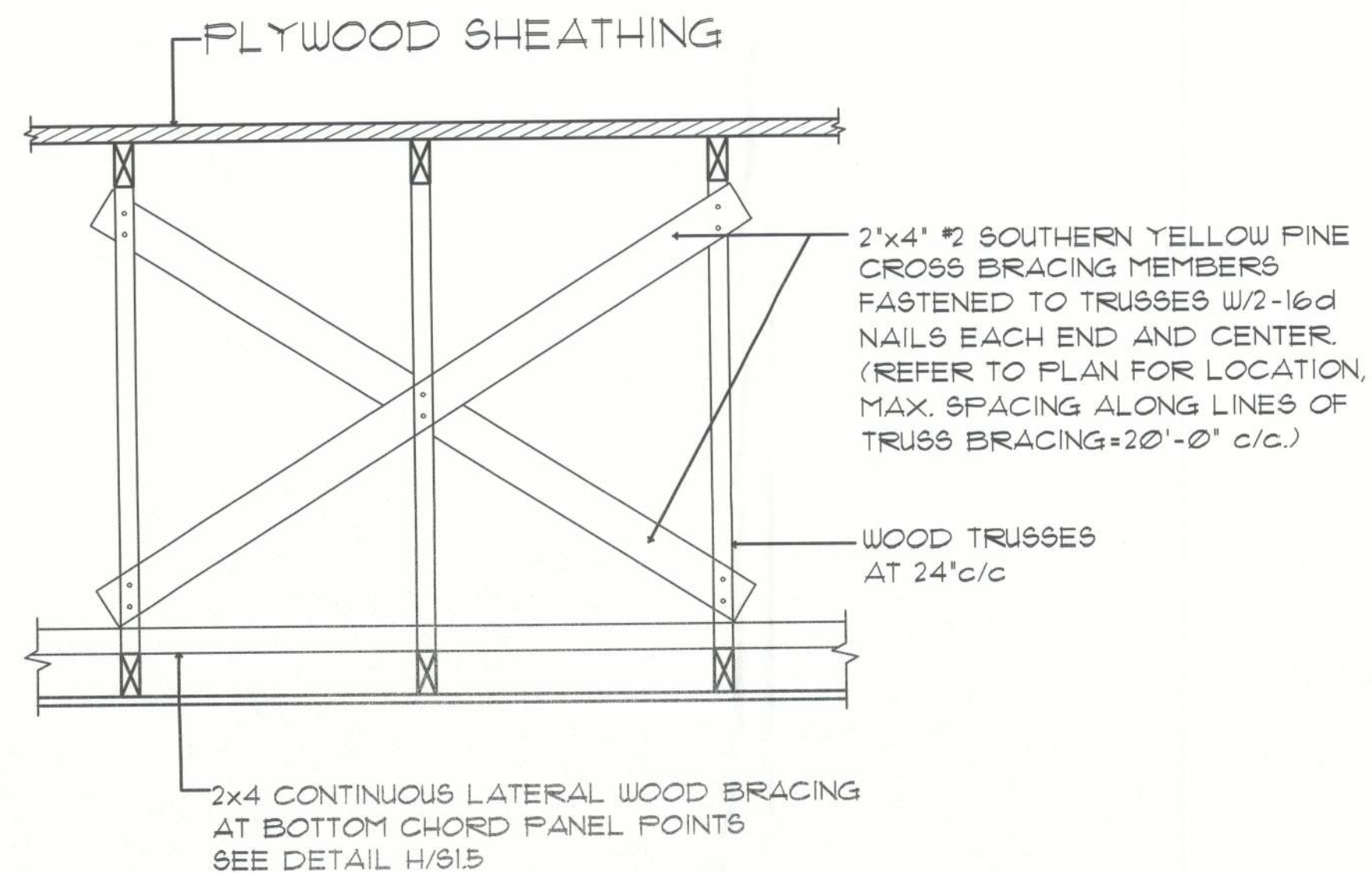

B TYPICAL TRUSS X-BRACING DETAIL

SCALE: 1"=1'-0"

Date: July 14, 2011

Project no.

Drawn: JRFP

Checked: JRFP

Revisions:

Sheet title:

FRAMING DETAILS

Sheet no.

S201