

PERMIT APPLICATION / MANUFACTURED HOME INSTALLATION APPLICATION

DATA SHEET
PILON TO POWER

For Office Use Only

(Revised 7-1-15)

Zoning Official

Building Official

AP# 1807-40

Date Received 7/13

By

Permit # 37075

Flood Zone X

Development Permit

Zoning A3

Land Use Plan Map Category A

Comments

FEMA Map#

Elevation

Finished Floor 1' above road

River

In Floodway

☒ Recorded Deed or ☒ Property Appraiser PO ☒ Site Plan ☒ EH # 18-0470 ☒ Well letter OR

☐ Existing well ☐ Land Owner Affidavit ☒ Installer Authorization ☐ FW Comp. letter ☒ App Fee Paid

☐ DOT Approval ☐ Parent Parcel # ☐ STUP-MH ☒ 911 App

☐ Ellisville Water Sys ☐ Assessment ☒ Out County ☒ In County ☒ Sub VF Form

Property ID # 32-25-16-01807-004 Subdivision Lot#

New Mobile Home Used Mobile Home ☒ MH Size Year 1983

Applicant Willie B. Allen Phone # 386.397.0917

Address 377 NW SENIOR CT, LAKE CITY, FL 32055

Name of Property Owner Willie B. Allen Phone# 386.397.0917

911 Address 272 NW SENIOR CT, LAKE CITY, FL 32055

Circle the correct power company - FL Power & Light - Clay Electric
(Circle One) - Suwannee Valley Electric - Duke Energy

Name of Owner of Mobile Home Willie B. Allen Phone # 386.397.0917

Address 377 NW SENIOR CT, LAKE CITY, FL 32055

Relationship to Property Owner Self

Current Number of Dwellings on Property 0

Lot Size Total Acreage 2.95

Do you : Have ☒ Existing Drive or ☐ Private Drive or need ☐ Culvert Permit or ☐ Culvert Waiver (Circle one)
(Currently using) (Blue Road Sign) (Putting in a Culvert) (Not existing but do not need a Culvert)

Is this Mobile Home Replacing an Existing Mobile Home NO

Driving Directions to the Property 4th N to Clinfield, TL TO QUEEN, TR TO 3 Way Stop @ SENIOR, TL - 200 yds ON R.

Cell: 352-318-4711

Name of Licensed Dealer/Installer Fermon Jones Phone # 352-318-4734

Installers Address 6795 SW 71st Ave Lake Butler, FL 32054

License Number IH1025418 Installation Decal # 50317

to speak w/mr
- Willie B. - 8.6.18

Andrew Ross looked
at Blocking Diagram
for completeness.

LH- Tried to leave Fermon a message -
- Mailbox full 7-19-18
LH- Spoke to Fermon 7-18-18

Mobile Home Permit Worksheet

Application Number: _____

Date: _____

Installer: Fernon Jones License # IH1025418

Address of home being installed: X377 NW Senior Ct., Lake City, FL.

Manufacturer: ALLA Length x width: 28x60

NOTE: If home is a single wide fill out one half of the blocking plan. If home is a triple or quad wide sketch in remainder of home. I understand Lateral Arm Systems cannot be used on any home (new or used) where the sidewall ties exceed 5 ft 4 in.

Installer's initials: FJ

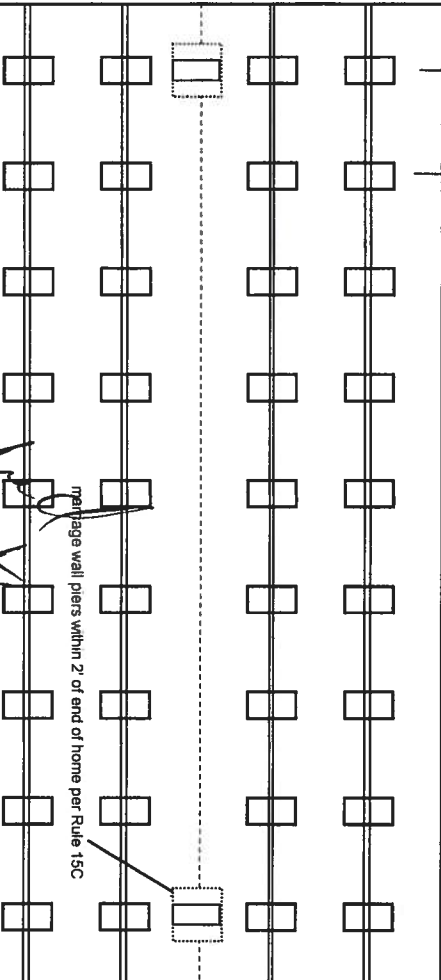

New Home ☐ Used Home ☒

Home installed to the Manufacturer's Installation Manual ☐

Home is installed in accordance with Rule 15-C ☐

Single wide ☐ Wind Zone II ☒ Wind Zone III ☐

Double wide ☒ Installation Decal # X50317

Triple/Quad ☐ Serial # AAFLA 2586 ALB

PIER SPACING TABLE FOR USED HOMES

Load bearing capacity (sq in)	Footer size (256)	18 1/2" x 18 (342)	20" x 20" (400)	22" x 22" (484)*	24" x 24" (576)*	26" x 26" (676)
1000 psf	3'	4'	5'	6'	7'	8'
1500 psf	4'6"	6'	7'	8'	8'	8'
2000 psf	6'	8'	8'	8'	8'	8'
2500 psf	7'6"	8'	8'	8'	8'	8'
3000 psf	8'	8'	8'	8'	8'	8'
3500 psf	8'	8'	8'	8'	8'	8'

* Interpolated from Rule 15C-1 pier spacing table.

PIER PAD SIZES

I-beam pier pad size: 17x25

Perimeter pier pad size: 16x16

Other pier pad sizes (required by the mfg.): —

Draw the approximate locations of marriage wall openings 4 foot or greater. Use this symbol to show the piers.

List all marriage wall openings greater than 4 foot and their pier pad sizes below.

Opening: — Pier pad size: 17x25

— —

— —

POPULAR PAD SIZES

Pad Size	Sq In
16 x 16	256
16 x 18	288
18.5 x 18.5	342
16 x 22.5	360
17 x 22	374
13 1/4 x 26 1/4	348
20 x 20	400
17 3/16 x 25 3/16	441
17 1/2 x 25 1/2	446
24 x 24	576
26 x 26	676

ANCHORS

4 ft — 5 ft —

FRAME TIES

within 2' of end of home spaced at 5' 4" oc

OTHER TIES

TIEDOWN COMPONENTS

Longitudinal Stabilizing Device (LSD)

Manufacturer: Oliver Tech

Longitudinal Stabilizing Device w/ Lateral Arms

Manufacturer: Oliver Tech

Sidewall Longitudinal Marriage wall Shearwall

Number: M+9

Mobile Home Permit Worksheet

Application Number: _____

Date: _____

POCKET PENETROMETER TEST

The pocket penetrometer tests are rounded down to _____ psf or check here to declare 1000 lb. soil _____ without testing.

X 1500 X 1000 X 1000

POCKET PENETROMETER TESTING METHOD

1. Test the perimeter of the home at 6 locations.
2. Take the reading at the depth of the footer.
3. Using 500 lb. increments, take the lowest reading and round down to that increment.

X 1200 X 1000 X 1000

TORQUE PROBE TEST

The results of the torque probe test is 270 inch pounds or check here if you are declaring 5' anchors without testing. A test showing 275 inch pounds or less will require 5 foot anchors.

Note: A state approved lateral arm system is being used and 4 ft. anchors are allowed at the sidewall locations. I understand 5 ft anchors are required at all centerline tie points where the torque test reading is 275 or less and where the mobile home manufacturer may requires anchors with 4000 lb. holding capacity.

F.D.S. Installer's initials

ALL TESTS MUST BE PERFORMED BY A LICENSED INSTALLER

Installer Name

Date Tested

Electrical

Connect electrical conductors between multi-wide units, but not to the main power source. This includes the bonding wire between multi-wide units. Pg. 15

Plumbing

Connect all sewer drains to an existing sewer tap or septic tank. Pg. 15

Connect all potable water supply piping to an existing water meter, water tap, or other independent water supply systems. Pg. 15

Site Preparation

Debris and organic material removed _____
Water drainage: Natural _____ Swale _____ Pad ☒ Other _____

Fastening multi wide units

Floor: Type Fastener: 1095 Length: 6" Spacing: 24"
Walls: Type Fastener: 1095 Length: 6" Spacing: 24"
Roof: Type Fastener: 1095 Length: 6" Spacing: 24"
For used homes a min 30 gauge, 8" wide, galvanized metal strip will be centered over the peak of the roof and fastened with galv. roofing nails at 2" on center on both sides of the centerline.

Gasket (weatherproofing requirement)

I understand a properly installed gasket is a requirement of all new and used homes and that condensation, mold, mildew and buckled marriage walls are a result of a poorly installed or no gasket being installed. I understand a strip of tape will not serve as a gasket.

Installer's initials F.D.S.

Type gasket rolled foam

Pg. 17 Installed: Between Floors ☒ Yes
Between Walls ☒ Yes
Bottom of ridgebeam ☒ Yes

Weatherproofing

The bottomboard will be repaired and/or taped. Yes ☒ Pg. 17
Siding on units is installed to manufacturer's specifications. Yes ☒
Fireplace chimney installed so as not to allow intrusion of rain water. Yes ☒

Miscellaneous

Skirting to be installed. Yes ☒ No _____
Dryer vent installed outside of skirting. Yes ☒ N/A _____
Range downflow vent installed outside of skirting. Yes ☒ N/A _____
Drain lines supported at 4 foot intervals. Yes ☒ _____
Electrical crossovers protected. Yes ☒ _____
Other: _____

Installer verifies all information given with this permit worksheet is accurate and true based on the manufacturer's installation instructions and or Rule 15C-1 & 2

Installer Signature

Date

Applicant shall provide layout from manufacturer specific to the model installed. This form may be used if the layout from the manufacturer is not available.

SINGLE WIDE MANUFACTURED HOME

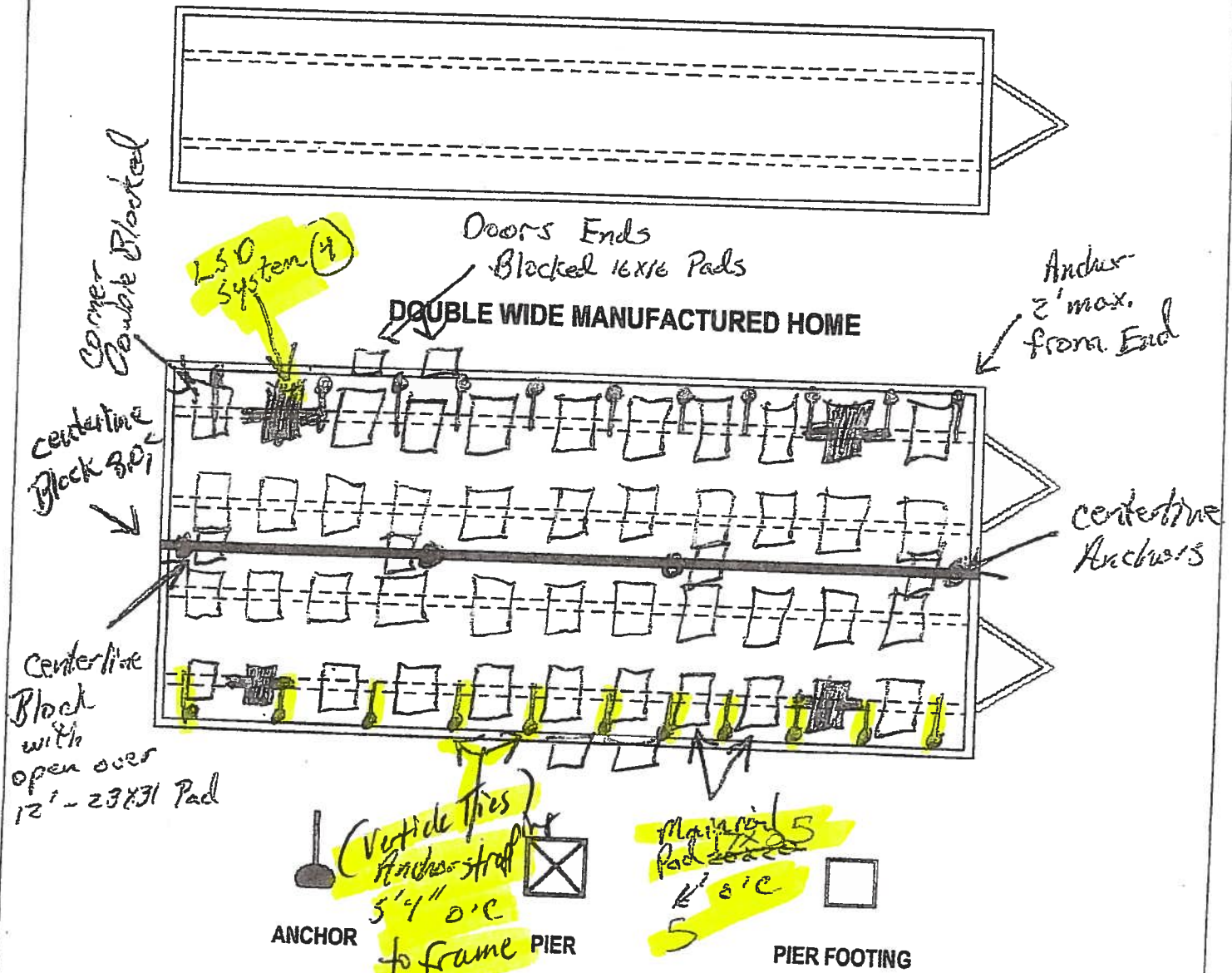

Show all pier (with size of piers & pads) and anchor location, with maximum spacing and distance from end walls, as required in the manufacturer's specifications. Any special pier footing required (over 16 x 16 inches) shall be noted separately with required dimensions per the manufacturer's specifications. To determine footing size and spacing, a soil bearing capacity test shall be used. Pier footings to be poured-in-place, whether required by manufacturer's specifications or by preference, must be inspected by the Building Department prior to pouring.

ANCHORS AND TIE-DOWNS

Longitudinal protection, continued

Other approved longitudinal stabilization are these types of steel mechanical systems called longitudinal stabilizing devices.

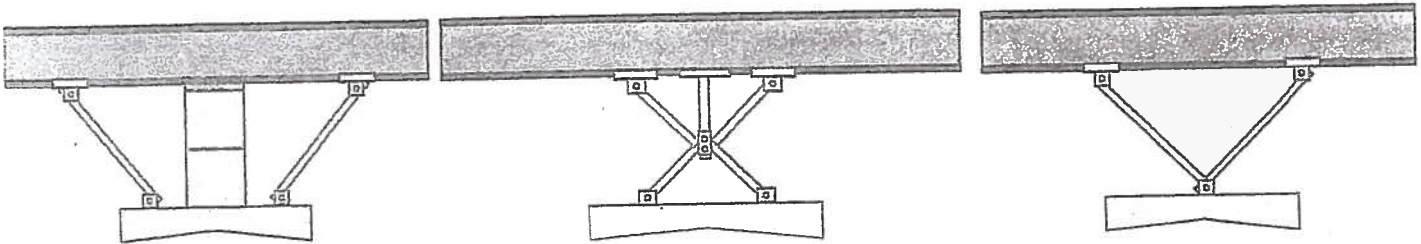

Longitudinal Protection using approved
Longitudinal Stabilizing Devices
(LSDs)

LSD systems may be used in place of the required longitudinal straps, anchors and stabilizer plates. Two systems are required per section of home. A single wide will get two LSDs and a double wide will require four and a triple wide will require six. For the correct placement of these systems see the diagram below.

Commonly found violations when using the lateral arm systems:

- The required self tapping screws were not installed or another type of screw was used.
- The LSD arms were not properly connected to the I-beam or galvanized pan.
- Five foot anchors were required by the home manufacturer and 4 foot anchors were installed.
- The LSD arms are installed at too steep an angle.
- The galvanized pan is not fully embedded into the soil.

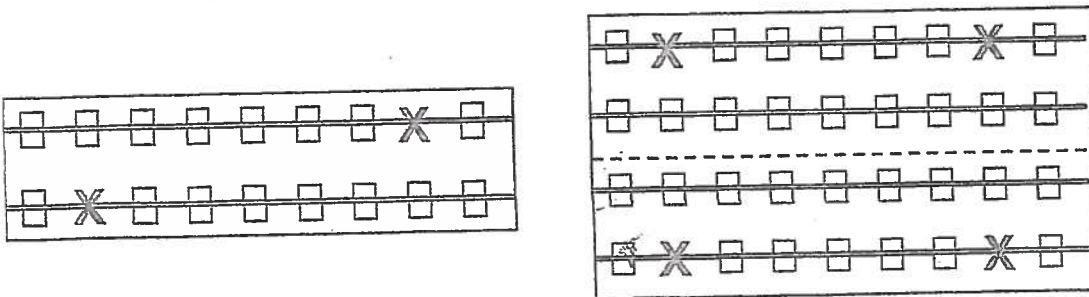

Longitudinal Stabilizing Devices shown on typical blocking plans.

ANCHORS AND TIE-DOWNS

Lateral Arm Systems

Lateral arms are square galvanized steel telescoping square tubes that are attached at one end to the longitudinal stabilizing device's (LSD) galvanized pan (in some cases concrete). The other end is attached to the top of the far I-beam. The telescoping arms require 4 self tapping screws to be installed (two on each side). Lateral arms are totally independent from the longitudinal stabilizing devices, but just happen to share the same galvanized pan.

An advantage, in some cases, is that an installer may leave off the required frame ties every 5' 4". However, one frame tie, anchor and stabilizer is required at every lateral arm location.

One requirement of the lateral arm system is the use of vertical ties spaced at 5' 4" on center. If a used home does not have vertical ties spaced at 5' 4" the lateral arm systems cannot be used. An installer cannot add vertical ties to the sidewalls.

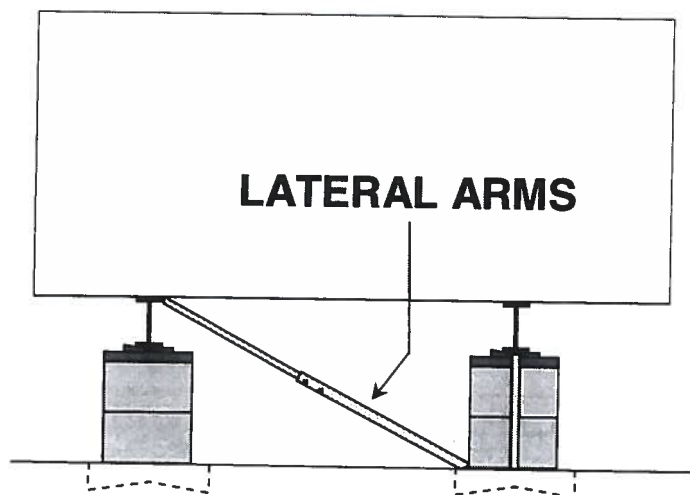

Manufacturer's installation instructions must contain the following prescriptive requirements.

1. The use of this system requires sidewall vertical ties at no greater than 5' 4" on center and allows for the use of 4 foot anchors.
2. Centerline anchors to be sized according to soil torque conditions. Any manufacturer's specifications for sidewall anchor loads in excess of 4000 pounds requires a 5 foot anchor.
3. Each system is required to have a frame tie and stabilizer plate attached at each lateral arm location.
4. Four lateral arms are required for homes up to 52 feet in length. Six lateral arm systems are required for homes 52 feet in length and longer.
5. For homes with roof pitches of 5/12 or greater: Six (6) lateral arms up to 52 feet in length and eight (8) lateral arms 52 to 80 feet in length.

OLIVER TECHNOLOGIES, INC.
FLORIDA INSTALLATION INSTRUCTIONS FOR THE
MODEL 1101 "V" SERIES ALL STEEL FOUNDATION SYSTEM
MODEL 1101"V" (STEPS 1-15)
LONGITUDINAL ONLY: FOLLOW STEPS 1-9
FOR ADDING LATERAL ARM : Follow Steps 10-15
FOR CONCRETE APPLICATIONS: Follow Steps 16-19

ENGINEERS STAMP

ENGINEERS STAMP

1. SPECIAL CIRCUMSTANCES: If the following conditions occur - **STOP! Contact Oliver Technologies at 1-800-284-7437** :
- a) Pier height exceeds 48"
 - b) Length of home exceeds 76'
 - c) Roof eaves exceed 16"
 - d) Sidewall height exceed 96"
 - e) Location is within 1500 feet of coast

INSTALLATION OF GROUND PAN

2. Remove weeds and debris in an approximate two foot square to expose firm soil for each ground pan (C) .
3. Place ground pan (C) directly below chassis I-beam . Press or drive pan firmly into soil until flush with or below soil.
- SPECIAL NOTE:** The longitudinal "V" brace system serves as a pier under the home and should be loaded as any other pier. It is recommended that after leveling piers, and one-third inch (1/3") before home is lowered completely on to piers, complete steps 4 through 9 below then remove jacks.

INSTALLATION OF LONGITUDINAL "V" BRACE SYSTEM

NOTE: WHEN INSTALLING THE LONGITUDINAL SYSTEM ONLY, A MINIMUM OF 2 SYSTEMS PER FLOOR SECTION IS REQUIRED. SOIL TEST PROBE SHOULD BE USED TO DETERMINE CORRECT TYPE OF ANCHOR PER SOIL CLASSIFICATION. IF PROBE TEST READINGS ARE BETWEEN 175 & 275 A 5 FOOT ANCHOR MUST BE USED. IF PROBE TEST READINGS ARE BETWEEN 276 & 350 A 4 FOOT ANCHOR MAY BE USED. USE GROUND ANCHORS WITH DIAGONAL TIES AND STABILIZER PLATES EVERY 5'4" . VERTICAL TIES ARE ALSO REQUIRED ON HOMES SUPPLIED WITH VERTICAL TIE CONNECTION POINTS (PER FLORIDA REG.) .

4. Select the correct square tube brace (E) length for set - up (pier) height at support location. (The 18" tube is always used as the bottom part of the longitudinal arm). Note: Either tube can be used by itself, cut and drilled to length as long as a 40 to 45 degree angle is maintained.

PIER HEIGHT
(Approx. 45 degrees Max.)

1.25" ADJUSTABLE
Tube Length

1.50" ADJUSTABLE
Tube Length

7 3/4" to 25"	22"	18"
24 3/4" to 32 1/4"	32"	18"
33" to 41"	44"	18"
40" to 48"	54"	18"

5. Install (2) of the 1.50" square tubes (E {18" tube}) into the "U" bracket (J), insert carriage bolt and leave nut loose for final adjustment.
6. Place I-beam connector (F) loosely on the bottom flange of the I-beam.
7. Slide the selected 1.25" tube (E) into a 1.50" tube (E) and attach to I-beam connectors (F) and fasten loosely with bolt and nut.
8. Repeat steps 6 through 7 to create the "V" pattern of the square tubes loosely in place. The angle is not to exceed 45 degree and not below 40 degrees.
9. After all bolts are tightened, secure 1.25" and 1.50" tubes using four(4) 1/4"-14 x 3/4" self-tapping screws in pre-drilled holes.

INSTALLATION OF LATERAL TELESCOPING TRANSVERSE ARM SYSTEM

THE MODEL 1101 "V" (LONGITUDINAL & LATERAL PROTECTION) ELIMINATES THE NEED FOR MOST STABILIZER PLATES & FRAME TIES.

NOTE: THE USE OF THIS SYSTEM REQUIRES VERTICAL TIES SPACED AT 5'4".

FOUR FOOT (4') GROUND ANCHOR MAY BE USED EXCEPT WHERE THE HOME MANUFACTURER SPECIFIES DIFFERENT.

10. Install remaining vertical tie-down straps and 4' ground anchors per home manufacturer's instructions. **NOTE:** Centerline anchors to be sized according to soil torque condition. Any manufacturer's specifications for sidewall anchor loads in excess of 4,000 lbs. require a 5' anchor per Florida Code.
11. **NOTE:** Each system is required to have a frame tie and stabilizer attached at each lateral arm stabilizing location. This frame tie & stabilizer plate needs to be located within 18" from of center ground pan.
12. Select the correct square tube brace (H) length for set-up lateral transverse at support location. The lengths come in either 60" or 72" lengths. (With the 1.50" tube as the bottom tube, and the 1.25" tube as the inserted tube.)
13. Install the 1.50 transverse brace (H) to the ground pan connector (D) with bolt and nut.
14. Slide 1.25" transverse brace into the 1.50" brace and attach to adjacent I-beam connector (I) with bolt and nut.
15. Secure 1.50" transverse arm to 1.25" transverse arm using four (4) 1/4" - 14 x 3/4" self-tapping screws in pre-drilled holes.



OLIVER TECHNOLOGIES, INC.
1-800-284-7437

Telephone 931-796-4555
Fax 931-796-8811
www.olivertechnologies.com

INSTALLATION USING CONCRETE RUNNER / FOOTER

16. A concrete runner, footer or slab may be used in place of the steel ground pan.
- The concrete shall be minimum 2500 psi mix
 - A concrete runner may be either longitudinal or transverse, and must be a minimum of 8" deep with a minimum width of 16 inches longitudinally or 18 inches transverse to allow proper distance between the concrete bolt and the edge of the concrete (see below).
 - Footers must have minimum surface area of 441 sq. in. (i.e. 21" square), and must be a minimum of 8" deep.
 - If a full slab is used, the depth must be a 4" minimum at system bracket location, all other specifications must be per local jurisdiction. Special inspection of the system bracket installation is not required.. Footers must allow for at least 4" from the concrete bolt to the edge of the concrete.

NOTE: The bottom of all footings, pads, slabs and runners must be per local jurisdiction.

LONGITUDINAL: (Model 1101 LC "V")

17. When using Part # 1101-W-CPCA (wetset), simply install the bracket in runner/footer **OR** When installing in cured concrete use Part # 101-D-CPCA (dryset). The 1101 (dryset) CA bracket is attached to the concrete using (2) 5/8"x3" concrete wedge bolts (Simpson part # S162300H 5/8" X 3" or Powers equivalent). Place the CA bracket in desired location. Mark bolt hole locations, then using a 5/8" diameter masonry bit, drill a hole to a minimum depth of 3". Make sure all dust and concrete is blown out of the holes. Place wedge bolts into drilled holes, then place 1101 (dry set) CA bracket onto wedge bolts and start wedge bolt nuts. Take a hammer and lightly drive the wedge bolts down by hitting the nut (making sure not to hit the top of threads on bolt). The sleeve of concrete wedge bolt needs to be at or below the top of concrete. Complete by tightening nuts.

LATERAL: (Model 1101 TC "V")

18. For wet set (part # 1101-W-TACA) installation simply install the anchor bolt into runner/footer. For dry set installation (part # 1101-D-TACA) mark bolt hole locations, then using a 5/8" diam. masonry bit, drill a hole to a minimum depth of 3". Make sure all dust and concrete is blown out of the hole. Place wedge bolts (Simpson part #S162300H 5/8" X 3" or Powers equivalent) into (D) concrete dry transverse connector and into drilled hole. If needed, take a hammer and lightly drive the wedge bolts down by hitting the nut (making sure not to hit the top of threads on bolt), then remove the nut. The sleeve of concrete wedge bolt needs to be at or below the top of concrete.
19. When using part # 1101 CVW (wetset) or 1101 CVD (dryset), install per steps 17 & 18.

Notes:

- LENGTH OF HOUSE IS THE ACTUAL BOX SIZE
- = STABILIZER PLATE AND FRAME TIE LOCATION (needs to be located within 18 inches of center of ground pan or concrete)
- ☐ = LOCATION OF LONGITUDINAL BRACING ONLY
- ☐ = TRANSVERSE & LONGITUDINAL LOCATIONS

REQUIRED NUMBER AND LOCATION OF MODEL 1101 "V" OR 1101 C "V" BRACES FOR UP TO 4/12 ROOF PITCH

ALL WIDTHS; AND LENGTHS UP TO 52'

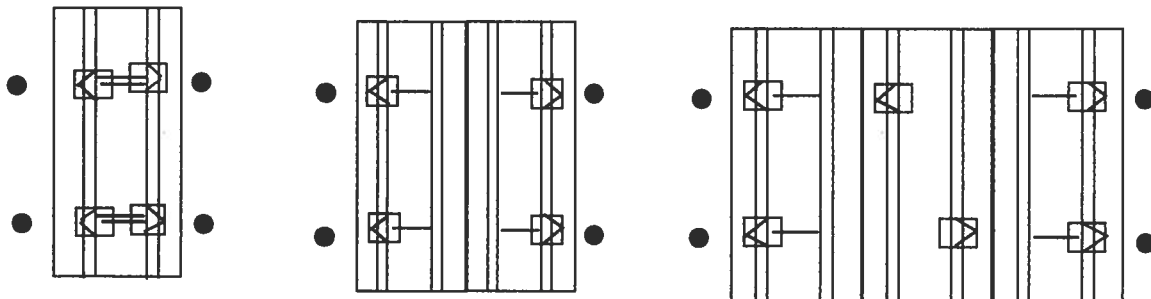

ALL WIDTHS; AND LENGTHS OVER 52' TO 80'

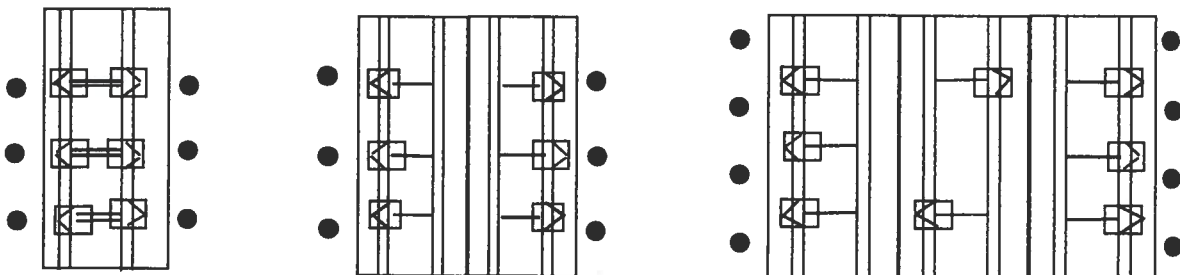

HOMES WITH 5/12 ROOF PITCH REQUIRE: PER FLORIDA REGULATIONS

6 systems for home lengths up to 52' and 8 systems for homes over 52' and up to 80'. One stabilizer plate and frame tie required at each lateral bracing system.

Florida approved 4" ground anchors may be used in all locations except where home manufacturers specifications for sidewall straps are in excess of 4,000 lbs. These locations require a 5" anchor. Per Florida Code.

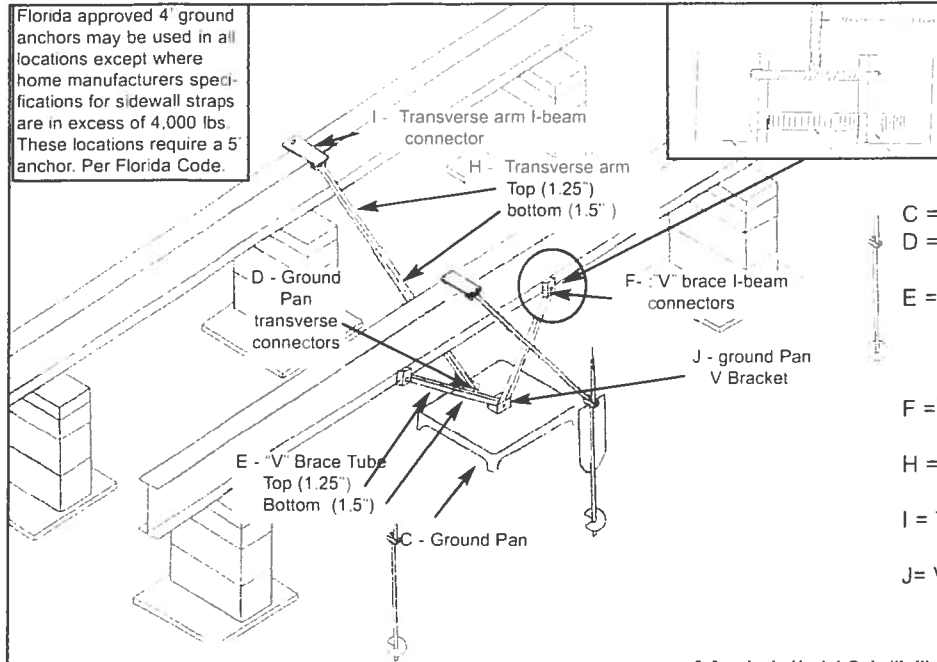

- C = GROUND PAN
- D = GROUND PAN CONNECTOR
- U BRACKETS TRANSVERSE
- E = TELESOPING V BRACE TUBE ASSEMBLY W/ 1.5 BOT-TOM TUBE AND 1.25 TUBE INSERT
- F = "V" BRACE I-BEAM CONNEC-TORS ASSEMBLY
- H = TELESOPING TRANSVERSE ARM ASSEMBLY
- I = TRANSVERSE ARM I-BEAM CONNECTOR
- J= V PAN BRACKET

Model # 1101 "V"

Longitude dry concrete bracket part # 1101 D-CPCA

Wet bracket part # 1101 W-CPCA not shown

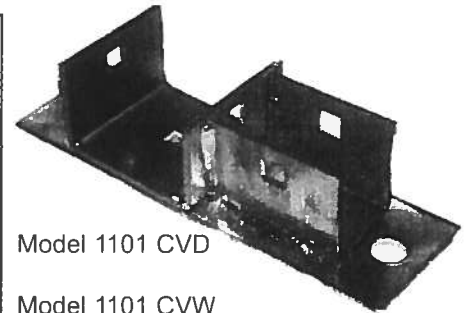
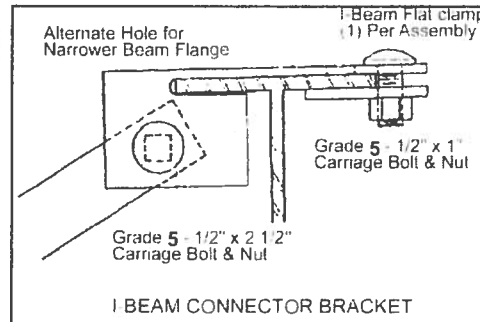
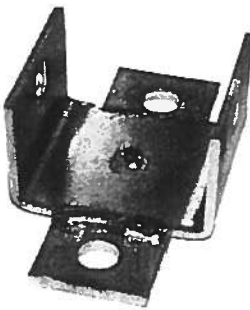

Model 1101 CVD

Model 1101 CVW not shown

Florida approved 4" ground anchors may be used in all locations except where home manufacturers specifications for sidewall straps are in excess of 4,000 lbs. These locations require a 5" anchor. Per Florida Code.

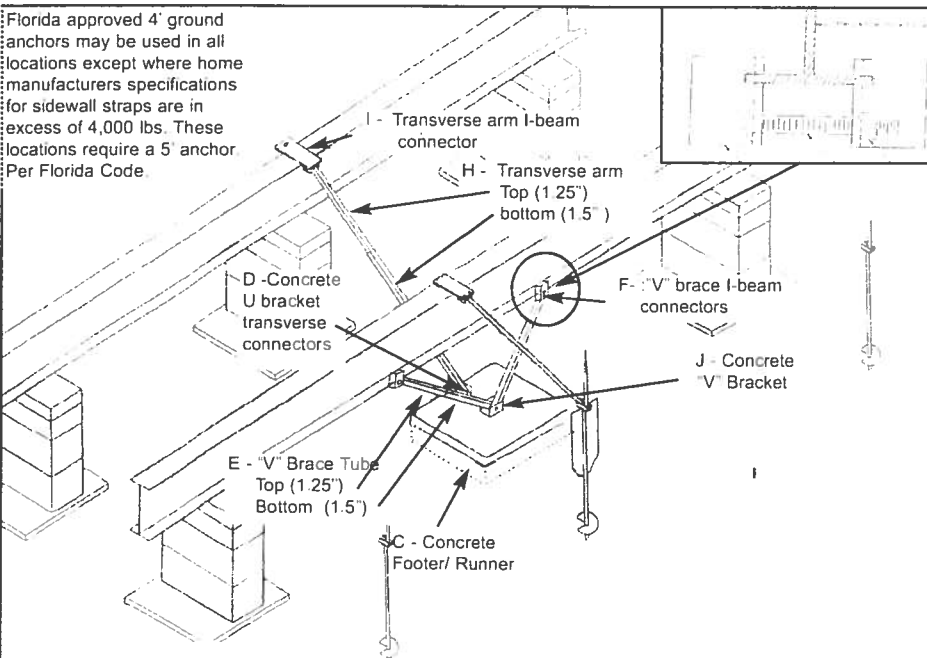

- C = CONCRETE FOOTER/RUNNER
- D = CONCRETE U BRACKET TRANSVERSE CONNECTOR (connects with grade 5 -1/2" x 2 1/2" carriage bolt & nut)
- E = TELESOPING V BRACE TUBE ASSEMBLY W/ 1.5 BOT-TOM TUBE AND 1.25 TUBE INSERT
- F = "V" BRACE I-BEAM CONNECTOR ASSEMBLY (connects with grade 5 - 1/2" x 4" carriage bolt & nut)
- H = TELESOPING TRANSVERSE ARM ASSEMBLY
- I = TRANSVERSE ARM I-BEAM CONNECTOR (connects with grade 5 -1/2" x 2 1/2" carriage bolt & nut)
- J= CONCRETE "V" BRACKET (connects with grade 5 - 1/2" x 4" carriage bolt & nut)

Model # 1101 C "V"



OLIVER TECHNOLOGIES, INC.
1-800-284-7437

Telephone: 931-796-4555
Fax: 931-796-8811
www.olivertechnologies.com

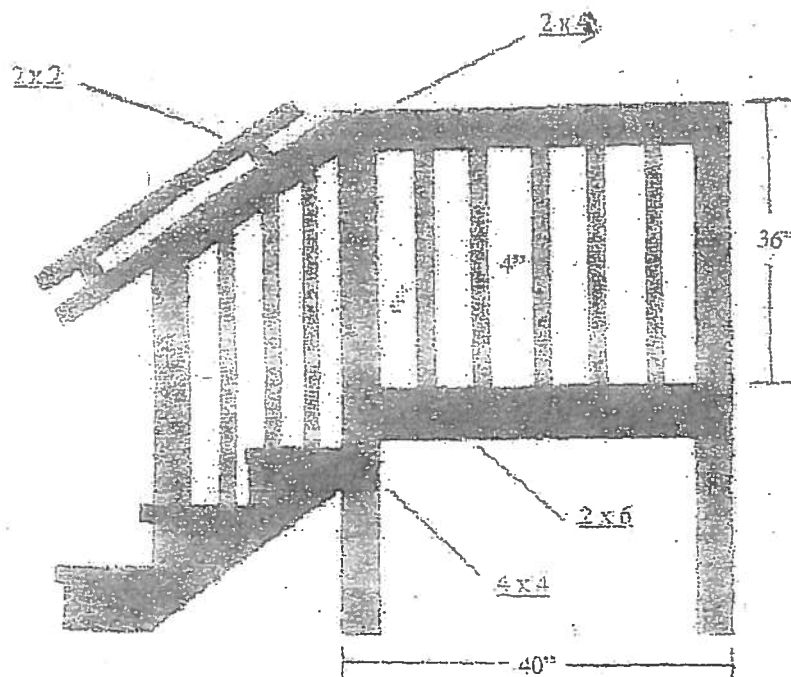

SUBMITTED BY HALL SERVICES, INC.

ALL STEPS ARE CONSTRUCTED FROM PRESSURE TREATED PINE.
 STEP PLATFORM IS 40" X 40".
 PICKETS ARE NO MORE THAN 4" APART.
 THE SUM OF 1 TREAD AND 2 RISERS ARE BETWEEN 24" AND 25".

FASTENERS USED:

#8X3" GAL. DECK SCREWS
 #10X4" GAL. DECK SCREWS
 #8 GAL. RING SHANK NAILS

License Number: IH / 1025418 / 1 Name: FERMON JONES

Order #: 3257	Label #: 50317	Manufacturer:	(Check Size of Home)
Homeowner: Willie B. Allen	Year Model: 1983		Single _____
Address: 377 NW Senior Ct.	Length & Width: 24x60		Double <input checked="" type="checkbox"/> _____
City/State/Zip: Lake City, FL	Type Longitudinal System:		Triple _____
Phone #:	Type Lateral Arm System:		HUD Label #:
Date Installed:	New Home: _____ Used Home: <input checked="" type="checkbox"/>		Soil Bearing / PSF: 1000
Installed Wind Zone:	Data Plate Wind Zone:		Torque Probe / in-lbs: 276
			Permit #:

Note:

STATE OF FLORIDA
INSTALLATION CERTIFICATION LABEL

50317

LABEL #

DATE OF INSTALLATION

FERMON JONES

NAME

IH / 1025418 / 1

3257

LICENSE #

ORDER #

CERTIFIES THAT THE INSTALLATION OF THIS MOBILE HOME IS
IN ACCORDANCE WITH FLORIDA STATUTES 320.8249, 320.8325
AND RULES OF THE HIGHWAY SAFETY AND MOTOR VEHICLES.

INSTRUCTIONS

PLEASE WRITE DATE OF
INSTALLATION AND AFFIX
LABEL NEXT TO HUD LABEL.

PERMANENT INK PEN
OR MARKER ONLY.

CONFIRM INFORMATION
ABOVE AND KEEP ON FILE
FOR A MINIMUM OF 2 YEARS.
YOU ARE REQUIRED TO
PROVIDE COPIES WHEN
REQUESTED.

Prepared by:
Branden Strickland
Abstract Trust Title, LLC
283 NW Cole Terrace / PO Box 7175
Lake City, FL 32055

Inst: 201612017284 Date: 10/26/2016 Time: 9:13AM
Page 1 of 2 B: 1324 P: 1084 P.DeWitt Cason, Clerk of Court
Columbia County, By: BD
Deputy Clerk Doc Stamp Deed: 73.50

ATS# 4-7383

Warranty Deed

Individual to Individual

THIS WARRANTY DEED made the 11th day of October, 2016, **Joseph Franklin Wynn**, hereinafter called the grantor, to **Willie B. Allen** whose post office address is: 377 NW Senior Court, Lake City, FL 32055 hereinafter called the grantee:

(Wherever used herein the terms "grantor" and "grantee" include all the parties to this instrument and the heirs, legal representatives and assigns of individuals, and the successors and assigns of corporation)

Witnesseth: That the grantor, for and in consideration of the sum of \$10.00 and other valuable considerations, receipt whereof is hereby acknowledged, hereby grants, bargains, sells, aliens, remises, releases, conveys, and confirms unto the grantee, all that certain land situate in COLUMBIA County, Florida, viz:

See Exhibit "A" Attached Hereto and by this Reference Made a Part Hereof

TOGETHER with all tenements, hereditaments and appurtenances thereto belonging or in anywise appertaining.

TO HAVE AND TO HOLD, the same in fee simple forever.

AND the grantor hereby covenants with said grantee that the grantor is lawfully seized of said land in fee simple; that the grantor has good right and lawful authority to sell and convey said land; that the grantor hereby fully warrants the title to said land and will defend the same against the lawful claims of all persons whomsoever; and that said land is free of all encumbrances, except taxes accruing subsequent to December 31, 2015.

IN WITNESS WHEREOF, the said grantor has signed and sealed these presents the day and year first above written.

Signed, sealed and delivered in our presence:

Mary Jane Rush
Witness:
MARY JANE RUSH
Printed Name:
Kelly Caisenski
Witness:
Kelly Caisenski
Printed Name:

Joseph Franklin Wynn
Joseph Franklin Wynn

STATE OF FLORIDA
COUNTY OF Brevard

The foregoing instrument was acknowledged before me this 11th day of October, 2016 by JOSEPH FRANKLIN WYNN personally known to me or, if not personally known to me, who produced Personally known for identification and who did not take an oath.

Anna Barnhill
Notary Public

(Notary Seal)



ATT: 4-7383

EXHIBIT"A"

A part of the NE 1/4 of the SE 1/4 of Section 32, Township 2 South, Range 16 East, Columbia County, Florida, more particularly described as follows: Commence at the NE corner of said NE 1/4 of SE 1/4 and run S. 00°31'33" E., along the East line of said NE 1/4 of SE 1/4, 1057.02 feet to the Point of Beginning; thence S. 88°09'37" W., 492.37 feet; thence N. 00°36'03" W., 261.41 feet; thence N. 88°15'58" E., 492.70 to the East line of said NE 1/4 of SE 1/4; thence S. 00°31'33" E., along said East line, 260.51 feet to the Point of Beginning.



STATE OF FLORIDA
DEPARTMENT OF HEALTH
APPLICATION FOR CONSTRUCTION PERMIT

Permit Application Number

18-0470

PART II - SITEPLAN

Scale: Each block represents ^{20'} feet and 1 inch = ^{80'} feet.

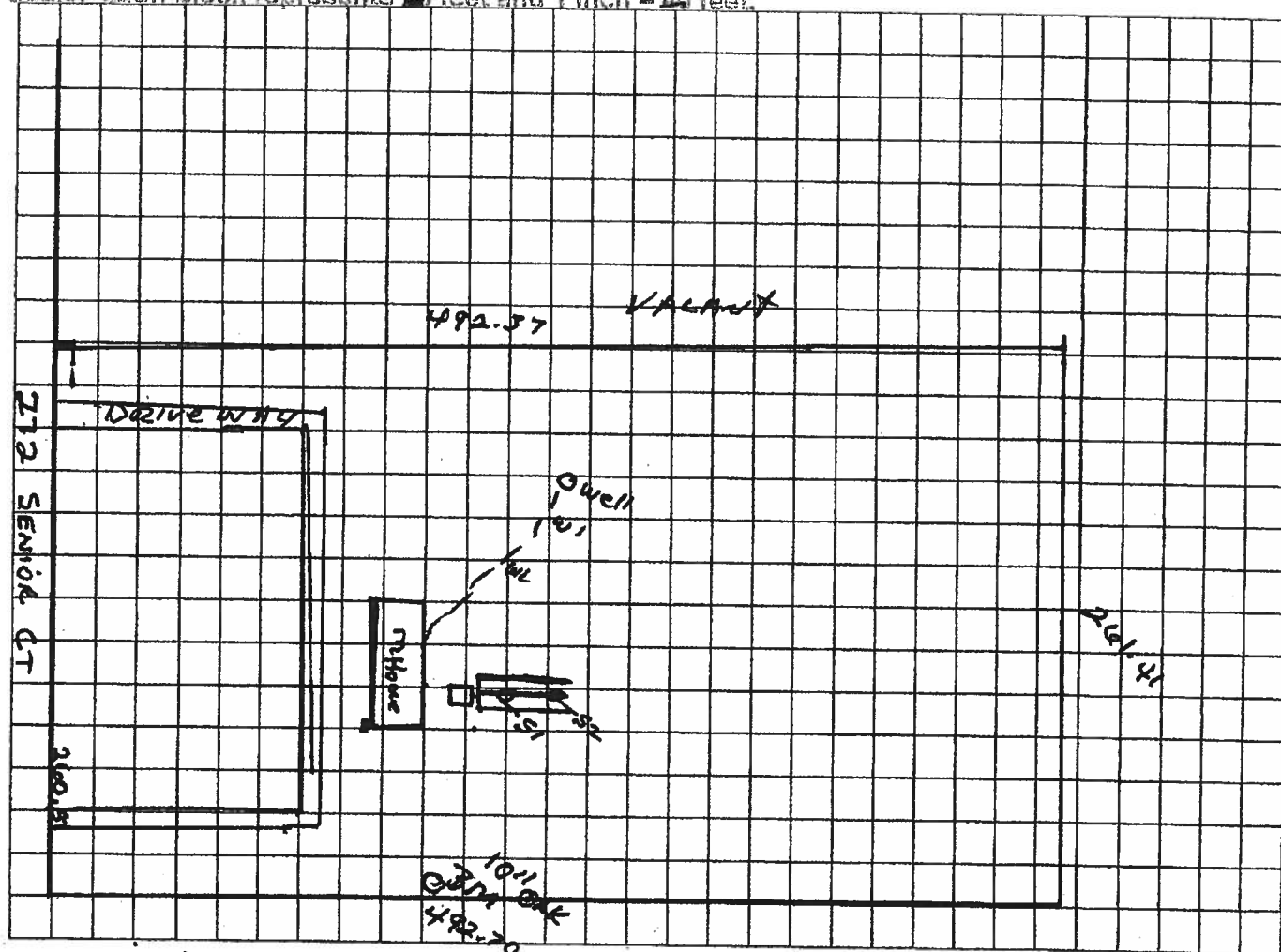

Notes: Willie B Allen

2.950 Acres

32-25-16-01807-004

Site Plan submitted by: Robert W. Jendryak DATE: 6/11/18

Plan Approved ☒ Not Approved ☐

By: [Signature]

EBI

Columbia

Date: 6/13/18 County Health Department

ALL CHANGES MUST BE APPROVED BY THE COUNTY HEALTH DEPARTMENT

NEW COLUMBIA



STATE OF FLORIDA
DEPARTMENT OF HEALTH
ONSITE SEWAGE TREATMENT AND DISPOSAL
SYSTEM
APPLICATION FOR CONSTRUCTION PERMIT

PERMIT NO. 18-0470
DATE PAID: 6/12/18
FEE PAID: 310.00
RECEIPT #: 1349282

APPLICATION FOR:

☒ New System ☐ Existing System ☐ Holding Tank ☐ Innovative
☐ Repair ☐ Abandonment ☐ Temporary ☐

APPLICANT: Willie B Allen (Estate of Willie B Allen)AGENT: Robert W. Ford Jr. NFST, INCTELEPHONE: 386-755-6372MAILING ADDRESS: 741 SE State Rd 100 Lake City, FL 32025

TO BE COMPLETED BY APPLICANT OR APPLICANT'S AUTHORIZED AGENT. SYSTEMS MUST BE CONSTRUCTED BY A PERSON LICENSED PURSUANT TO 489.105(3)(m) OR 489.552, FLORIDA STATUTES. IT IS THE APPLICANT'S RESPONSIBILITY TO PROVIDE DOCUMENTATION OF THE DATE THE LOT WAS CREATED OR PLATTED (MM/DD/YY) IF REQUESTING CONSIDERATION OF STATUTORY GRANDFATHER PROVISIONS.

PROPERTY INFORMATION

LOT: BLOCK: 16 SUBDIVISION: meets & bonds PLATTED: PROPERTY ID #: 32-25-01807-004 ZONING: MH I/M OR EQUIVALENT: ☐ Y ☒ NPROPERTY SIZE: 2.95 ACRES WATER SUPPLY: ☒ PRIVATE PUBLIC ☐ ≤ 2000 GPD ☐ > 2000 GPDIS SEWER AVAILABLE AS PER 381.0065, FS? ☐ Y ☒ NDISTANCE TO SEWER: NA FTPROPERTY ADDRESS: 272 NW Senior Ct.

DIRECTIONS TO PROPERTY: Hwy 41 N to Winfield St (L) on Queen Rd
R for approx 1.1 miles, 3 way stop - (L) on Senior Ct
Approx 150 yds property on Right

BUILDING INFORMATION

☒ RESIDENTIAL ☐ COMMERCIAL

Unit No	Type of Establishment	No. of Bedrooms	Building Area Sqft	Commercial/Institutional System Design Table 1, Chapter 64E-6, FAC
1	mobile home	4	1440	
2				
3				
4				

☐ Floor/Equipment Drains ☐ Other (Specify)

SIGNATURE: Robert W. Ford Jr.DATE: 6/11/18

Columbia County Property Appraiser

updated: 6/4/2018

2017 Tax Year

Parcel: 32-2S-16-01807-004

<< Next Lower Parcel Next Higher Parcel >>

Tax Collector

Tax Estimator

Property Card

Parcel List Generator

2017 TRIM (pdf)

Interactive GIS Map

Print

<< Prev

Search Result: 74 of 84

Next >>

Owner & Property Info

Owner's Name	ALLEN WILLIE B		
Mailing Address	377 NW SENIOR CT LAKE CITY, FL 32055		
Site Address			
Use Desc. (code)	VACANT (000000)		
Tax District	3 (County)	Neighborhood	32216
Land Area	2.950 ACRES	Market Area	03
Description	NOTE: This description is not to be used as the Legal Description for this parcel in any legal transaction.		
COMM NE COR OF SE1/4, RUN S 1057.02 FT FOR POB, RUN W 492.37 FT, N 261.41 FT, E 492.70 FT, S 260.51 FT TO POB. (PARCEL 4) CS #01-258-CA, ORB 943-1677, TR 1205-771, TR 1207-1896, CORR TR 1210-417 TR 1216-1593, WD 1324-1084,			

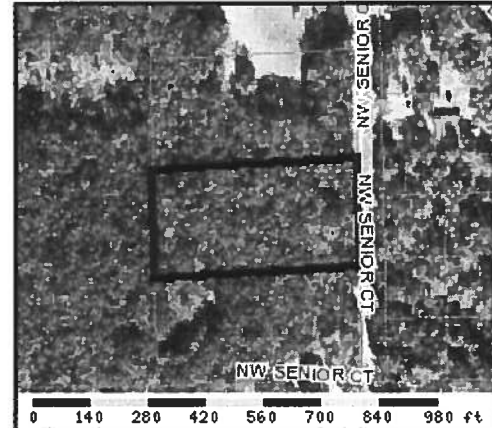

Property & Assessment Values

2017 Certified Values		
Mkt Land Value	cnt: (0)	\$8,968.00
Ag Land Value	cnt: (1)	\$0.00
Building Value	cnt: (0)	\$0.00
XFOB Value	cnt: (0)	\$0.00
Total Appraised Value		\$8,968.00
Just Value		\$8,968.00
Class Value		\$0.00
Assessed Value		\$8,968.00
Exempt Value		\$0.00
Total Taxable Value	Cnty: \$8,968 Other: \$8,968 Schl: \$8,968	

2018 Working Values (Hide Values)		
Mkt Land Value	cnt: (0)	\$9,864.00
Ag Land Value	cnt: (1)	\$0.00
Building Value	cnt: (0)	\$0.00
XFOB Value	cnt: (0)	\$0.00
Total Appraised Value		\$9,864.00
Just Value		\$9,864.00
Class Value		\$0.00
Assessed Value		\$9,864.00
Exempt Value		\$0.00
Total Taxable Value	Cnty: \$9,864 Other: \$9,864 Schl: \$9,864	

NOTE: 2018 Working Values are NOT certified values and therefore are subject to change before being finalized for ad valorem assessment purposes.

Sales History

Show Similar Sales within 1/2 mile

Sale Date	OR Book/Page	OR Code	Vacant / Improved	Qualified Sale	Sale RCode	Sale Price
10/11/2016	1324/1084	WD	V	Q	01	\$10,500.00
5/25/2011	1216/1593	TR	V	U	11	\$0.00
2/21/2011	1210/417	TR	V	U	11	\$0.00
1/5/2011	1207/1896	TD	V	U	11	\$0.00
10/28/2010	1205/771	TR	V	U	19	\$6,300.00
1/4/2002	943/1677	RE	V	U	01	\$0.00

Building Characteristics

Bldg Item	Bldg Desc	Year Blt	Ext. Walls	Heated S.F.	Actual S.F.	Bldg Value
-----------	-----------	----------	------------	-------------	-------------	------------



COLUMBIA COUNTY BUILDING DEPARTMENT
135 NE Hernando Ave, Suite B-21, Lake City, FL 32055
Phone: 386-758-1008 Fax: 386-758-2160

MOBILE HOME INSTALLERS LETTER OF AUTHORIZATION

I, Fermon Jones, give this authority for the job address show below
Installer License Holder Name

only, NW Senior Ct. Lake city, FL, and I do certify that
Job Address

the below referenced person(s) listed on this form is/are under my direct supervision and control and is/are authorized to purchase permits, call for inspections and sign on my behalf.

Printed Name of Authorized Person	Signature of Authorized Person	Authorized Person is... (Check one)
Willie B. Allen	W.B. Allen	<input checked="" type="checkbox"/> Agent <input type="checkbox"/> Officer <input checked="" type="checkbox"/> Property Owner
		<input type="checkbox"/> Agent <input type="checkbox"/> Officer <input type="checkbox"/> Property Owner
		<input type="checkbox"/> Agent <input type="checkbox"/> Officer <input type="checkbox"/> Property Owner

I, the license holder, realize that I am responsible for all permits purchased, and all work done under my license and I am fully responsible for compliance with all Florida Statutes, Codes, and Local Ordinances.

I understand that the State Licensing Board has the power and authority to discipline a license holder for violations committed by him/her or by his/her authorized person(s) through this document and that I have full responsibility for compliance granted by issuance of such permits.

[Signature]
License Holders Signature (Notarized)

TH1025418
License Number

7-2-18
Date

NOTARY INFORMATION:

STATE OF: Florida COUNTY OF: Union

The above license holder, whose name is Fermon Jones, personally appeared before me and is known by me or has produced identification (type of I.D.) personally known on this 2 day of July, 2018.

[Signature]
NOTARY'S SIGNATURE

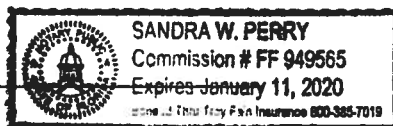

(Seal/Stamp)



MOBILE HOME INSTALLATION SUBCONTRACTOR VERIFICATION FORM

APPLICATION NUMBER 1807-40 CONTRACTOR Feamon Jones PHONE 352.318.4734

THIS FORM MUST BE SUBMITTED PRIOR TO THE ISSUANCE OF A PERMIT

In Columbia County one permit will cover all trades doing work at the permitted site. It is REQUIRED that we have records of the subcontractors who actually did the trade specific work under the permit. Per Florida Statute 440 and Ordinance 89-6, a contractor shall require all subcontractors to provide evidence of workers' compensation or exemption, general liability insurance and a valid Certificate of Competency license in Columbia County.

Any changes, the permitted contractor is responsible for the corrected form being submitted to this office prior to the start of that subcontractor beginning any work. Violations will result in stop work orders and/or fines.

ELECTRICAL 	Print Name <u>Willie B. Allen</u> Signature <u>3B. Allen</u> License #: <u> </u> Phone #: <u>386.397.0917</u> <p align="center">Qualifier Form Attached <input type="checkbox"/></p>
MECHANICAL/ A/C 	Print Name <u>Willie B. Allen</u> Signature <u>3B Allen</u> License #: <u> </u> Phone #: <u>386.397.0917</u> <p align="center">Qualifier Form Attached <input type="checkbox"/></p>

F. S. 440.103 Building permits; identification of minimum premium policy.--Every employer shall, as a condition to applying for and receiving a building permit, show proof and certify to the permit issuer that it has secured compensation for its employees under this chapter as provided in ss. 440.10 and 440.38, and shall be presented each time the employer applies for a building permit.



Hall's Pump and Well Services, Inc.

904 NW Main Blvd.
Lake City, FL 32055

halls.pumpandwell@bellsouth.net

Contractor #

1503

Submitted By

Benjamin D. Dicks

3/23/2018

Well Letter of Compliance

Contractor: Property Owners: William B. Allen

Columbia County Co., ²⁷²377 NW Senior Ct., Lake City, FL

Parcel ID 32-2S-16-01807-004

- Please be advised that due to the building codes our minimum well size will be 4" in diameter
- Pump size 1 1/2 hp, 230 volt, single ph, pump and motor
- Drop pipe size, 1-1/4" inch
- 4 Inch black steel well casing, 235mm wall thickness
- Tank sized, PC 244, 81 gallon, will supply a 23.9 gal. draw down at 40/60 pressure setting.
- All wells will have a pump and tank combination that will be sufficient enough for each situation.

If you have any questions please call our office @ 386-752-1854

Thanks,

Benjamin Dicks,

Office Coordinator,

Hall's Pump and Well Services, Inc.

904 NW Main Blvd.

Lake City, FL 32055

(P): (386)752-1854



District No. 1 - Ronald Williams
District No. 2 - Rusty DePratter
District No. 3 - Bucky Nash
District No. 4 - Everett Phillips
District No. 5 - Tim Murphy



BOARD OF COUNTY COMMISSIONERS • COLUMBIA COUNTY

Address Assignment and Maintenance Document

To maintain the county wide Addressing Policy you must make application for a 9-1-1 Address at the time you apply for a building permit. The established standards for addressing and posting numbers to all principal buildings, dwellings, businesses and industries are contained in Columbia County Ordinance 2001-9. The addressing system is to enable Emergency Services Agencies to locate you in an emergency, and to assist the United States Postal Service and the public in the timely and efficient provision of services to residents and businesses of Columbia County

Date/Time Issued: **7/13/2018 10:58:24 AM**

Address: **272 NW SENIOR Ct**

City: **LAKE CITY**

State: **FL**

Zip Code **32055**

Parcel ID **01807-004**

REMARKS: Address Verification.

NOTICE: THIS ADDRESS WAS ISSUED BASED ON LOCATION AND ACCESS INFORMATION RECEIVED FROM THE REQUESTER. SHOULD, AT A LATER DATE, THE LOCATION AND/OR ACCESS INFORMATION BE FOUND TO BE IN ERROR OR CHANGED, THIS ADDRESS IS SUBJECT TO CHANGE.

Address Issued By: **Signed:/ Matt Crews**

Columbia County GIS/911 Addressing Coordinator

**COLUMBIA COUNTY
911 ADDRESSING / GIS DEPARTMENT**

263 NW Lake City Ave., Lake City, FL 32055 Telephone: (386) 758-1125
Email: gis@columbiacountyfla.com

CODE ENFORCEMENT DEPARTMENT
COLUMBIA COUNTY, FLORIDA
OUT OF COUNTY MOBILE HOME INSPECTION REPORT

COUNTY THE MOBILE HOME IS BEING MOVED FROM Clay County
OWNERS NAME Willie Allen PHONE _____ CELL 386-397-0917
INSTALLER Fernon Jones PHONE 352-318-4734 CELL 352-318-4711
INSTALLERS ADDRESS 6795 SW 71st Ave Lake Butler, FL 32054

MOBILE HOME INFORMATION

✓ MAKE ALLA YEAR 1983 SIZE 24 x 60 x _____
COLOR Brown + Tan SERIAL No. AAFLA2586 A/B
WIND ZONE II SMOKE DETECTOR _____

INTERIOR:

FLOORS O.K.
DOORS O.K.
WALLS O.K.
CABINETS O.K.
ELECTRICAL (FIXTURES/OUTLETS) O.K.

EXTERIOR:

WALLS / SIDING O.K.
WINDOWS O.K.
DOORS O.K.

INSTALLER: APPROVED ☒ NOT APPROVED _____

INSTALLER OR INSPECTORS PRINTED NAME _____

Installer/Inspector Signature _____ License No. IH1025418 Date 7-6-18

NOTES: _____

ONLY THE ACTUAL LICENSE HOLDER OR A BUILDING INSPECTOR CAN SIGN THIS FORM.

NO WIND ZONE ONE MOBILE HOMES WILL BE PERMITTED. MOBILE HOMES PRIOR TO 1977 ARE PRE-HUD AND THE WIND ZONE MUST BE PROVEN TO BE PERMITTED.

BEFORE THE MOBILE HOME CAN BE MOVED INTO COLUMBIA COUNTY THIS FORM MUST BE COMPLETED AND RETURNED TO THE COLUMBIA COUNTY BUILDING DEPARTMENT.

ONCE MOVED INTO COLUMBIA COUNTY AN INSPECTOR MUST COMPLETE A PRELIMINARY INSPECTION ON THE MOBILE HOME. CALL 386-758-1008 TO SET UP THIS INSPECTION. NO PERMIT WILL BE ISSUED BEFORE THIS IS DONE.

signed in relay Spot 11
Code Enforcement Approval Signature Fernon Jones Date 7/6/18
BUILDING DEPT SIGNATURE [Signature] DATE 7-19-18

Mobile Home

Applicant: WILLIE B. ALLEN (386.397.0917) Application Date: 8/6/2018

Action ▼

1. JOB LOCATION

Completed Inspections

Add Inspection Release Power

2. CONTRACTOR

[Schedule Inspection](#) (ScheduleInspection.aspx?Id=39231)

3. MOBILE HOME DETAILS

Inspection	Date	By	Notes
Passed: Mobile Home - In County Pre-Mobile Home before set-up	8/7/2018	TROY CREWS	P E

*DATA PLATE
DID NOT LOCATE!!*

4. APPLICANT

5. REVIEW

The completion date must be set To release Certifications to the public.

6. FEES/PAYMENT

Permit Completion Date
(Releases Occupancy and Completion Forms)

7. DOCUMENTS/REPORTS

Incomplete Requested Inspections

8. NOTES/DIRECTIONS

Inspection	Date	By	Notes
------------	------	----	-------

9. INSPECTIONS (1)

DHSV-V-MH8
(9-82)

MANUFACTURER DATA REPORT

HUD LABEL # FLA 211833 & 211834

M.R. ID# AA-FLA-2586AB

DATE MANUFACTURED 3/18/83

MAKE OF MODEL All American YEAR: 1983

MFR. NAME

DESTINATION (SPRTE) FL

STATE OF FLORIDA
DIVISION OF MOTOR VEHICLES
DEPARTMENT OF HIGHWAY SAFETY AND MOTOR VEHICLES
ROOM A 119, NRI KIRKMAN BLVD., 2900 APLACHEE PKWY.
TALLAHASSEE, FLORIDA 32301

DEALER'S NAME Callahan Mobile Homes

ADDRESS 935 S. Lane Avenue

Jacksonville, FL

City / State / Zip

DAPIA NAME

ADDRESS

City / State / Zip

ADDRESS

City / State / Zip

City / State / Zip

() SINGLE () TRIPLE
SIZE: 60 x 12 60 x 12
UNIT A / UNIT B / UNIT C

City / State / Zip

STRUCTURAL DESIGN BASIS CERTIFICATE

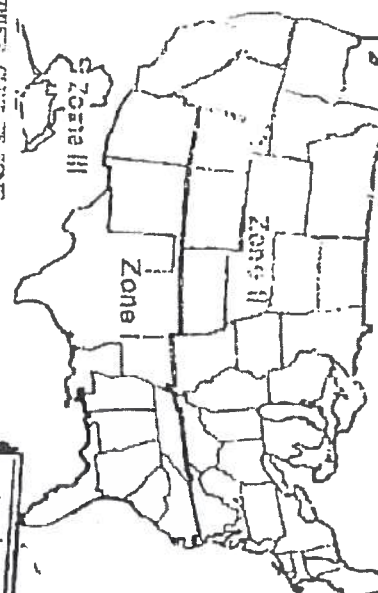
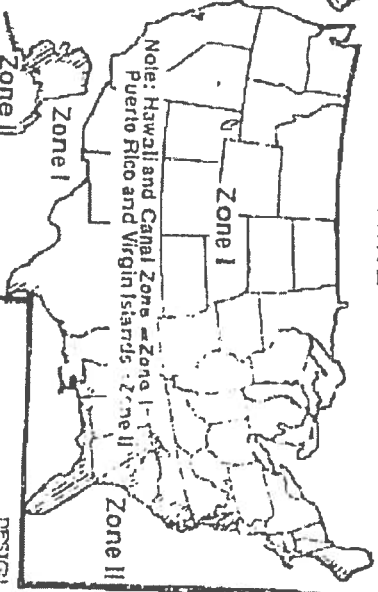
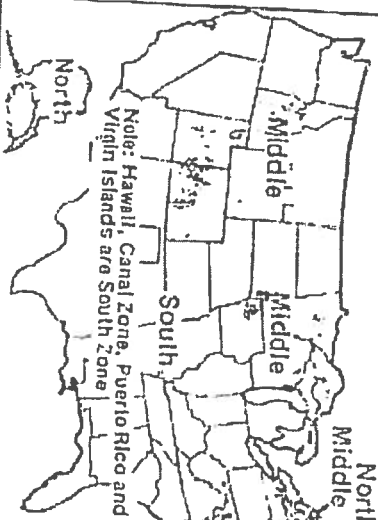

ROOF LOAD

- ☐ North 40 PSF
☐ Middle 30 PSF
☒ South 20 PSF
☐ Other

WIND LOAD

- ☐ Zone I 15 Psf Horizontal & 9 Psf Uplift
☒ Zone II (Hurricane)-25 Psf Horizontal & 15 Psf Uplift
☐ Zone III Other

EQUIPMENT

Air Conditioning (BTU/hr.)
Comfort Heating (53,800 BTU/hr.)
Cooking Range
Built-in Oven
Counter-Top Cooking Unit
Refrigerator
Water Heater
Clothes Dryer
Dishwasher
Food Waste
Smoke Detector

MANUFACTURER

MODEL

HO55A

UTICA-8W

RBT-2A

ZHER325TRV

1769ACT

THIS MOBILE HOME IS DESIGNED TO COMPLY WITH THE FEDERAL MOBILE HOME CONSTRUCTION AND SAFETY STANDARDS IN FORCE AT THE TIME OF MANUFACTURE.

SIGNED:

3/18/83

DATE

Author: J. K. ...

Type of Print Name

MAR 28 1983

DESIGN BASIS CERTIFICATE

This mobile home has been designed to comply with the requirements of the Federal Mobile Home Construction and Safety Standards for all locations within the State of Florida.

The design equipment has been designed to meet the requirements of the Federal Mobile Home Construction and Safety Standards for all locations within the State of Florida.

The design equipment has been designed to meet the requirements of the Federal Mobile Home Construction and Safety Standards for all locations within the State of Florida.

The design equipment has been designed to meet the requirements of the Federal Mobile Home Construction and Safety Standards for all locations within the State of Florida.

COMPLAINANT'S NAME

COMPLAINANT'S ADDRESS

City / State / Zip

FORM 9-70-108
(9-62)

SUD LABEL # FLA 211833 & 211834

M.N. ID# AN-FLA-2586AB

DATE MANUFACTURED 3/18/83

NAME OF MODEL ALL AMERICAN YEAR 1983

MFR. NAME

ADDRESS

City / State / Zip

City / State / Zip

MANUFACTURER DATA REPORT

STATE OF FLORIDA
DIVISION OF MOTOR VEHICLES
DEPARTMENT OF HIGHWAY SAFETY AND MOTOR VEHICLES
ROOM A 119, WILKINSON BLDG., 2900 APALACHE PARK,
TALLAHASSEE, FLORIDA 32301

DESTINATION (STATE) FL

() SINGLE () TRIPLE

SIZE: 60 x 12 60 x 12

() EXCLUDING SITES (X) INCLUDING SITES

STRUCTURAL DESIGN BASIS CERTIFICATE

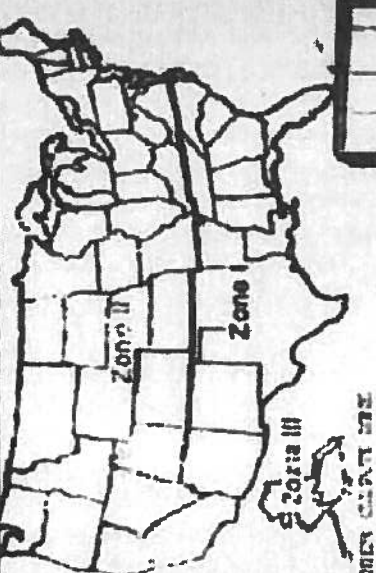
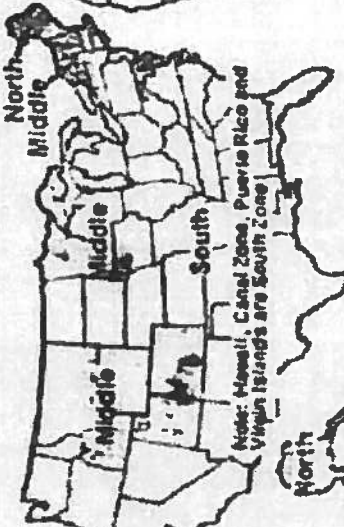

WIND LOAD
North 40 PSF
Middle 30 PSF
South 20 PSF
Other
Zone I 15 PSF Horizontal & 9 PSF Uplift
Zone II (Hurricane)-25 PSF Horizontal & 15 PSF Uplift
Zone III Other

DESIGN NUMBER 100-100-100
This mobile home has been designed to conform with the requirements of the Federal Mobile Home Construction and Safety Standards for all locations within a seismic zone I, II, or III.
The building equipment has the capacity to sustain a design wind velocity of 115 mph at standard atmospheric pressure.
The above information has been calculated assuming a standard wind velocity of 115 mph at standard atmospheric pressure.
The supply air distribution system installed in this home is sized () by Design for A/C (X) A/C Ready () A/C installed.
The supply air distribution system installed in this home is sized () by Design for A/C (X) A/C Ready () A/C installed.
The supply air distribution system installed in this home is sized () by Design for A/C (X) A/C Ready () A/C installed.

EXHIBIT	MANUFACTURER	DESCRIPTION
Air Conditioning	BTU/hr.	BTU/hr.
Comfort Heating	BTU/hr.	BTU/hr.
Cooking Range	Electric	Electric
Built-In Oven	Electric	Electric
Counter-Top Cooking Unit	Electric	Electric
Refrigerator	Electric	Electric
Water Heater	Electric	Electric
Clothes Dryer	Electric	Electric
Dishwasher	Electric	Electric
Food Waste	Electric	Electric
Smoke Detector	Electric	Electric

Color of Walls	White
Color of Ceiling	White
Color of Floor	White
Color of Trim	White
Color of Doors	White
Color of Windows	White
Color of Siding	White
Color of Foundation	White
Color of Skirting	White
Color of Stairs	White
Color of Railing	White
Color of Handrail	White
Color of Balustrade	White
Color of Fencing	White
Color of Gate	White
Color of Driveway	White
Color of Garage	White
Color of Porch	White
Color of Deck	White
Color of Patio	White
Color of Walkway	White
Color of Driveway	White
Color of Garage	White
Color of Porch	White
Color of Deck	White
Color of Patio	White
Color of Walkway	White

THIS MOBILE HOME IS DESIGNED TO COMPLY WITH THE FEDERAL MOBILE HOME CONSTRUCTION AND SAFETY STANDARDS IN FORCE AT THE TIME OF MANUFACTURE.

3/18/83

DATE

SIGNED

Author Representative

Manufacturer

Model

Year

City

State

Zip

Model

Year

City

State

Zip