



COLUMBIA COUNTY BUILDING DEPARTMENT

135 NE Hernando Ave., Suite B-21

Lake City, FL 32055

Office: 386-758-1008 Fax: 386-758-2160

Application Number _____

NOTICE TO SWIMMING POOL OWNERS

I Roger or Ann Elliott have been informed and I understand that prior to the final inspection approval and use of my pool, I will need all the inspections approved and the required fencing installed in accordance with applicable regulations. The Florida Building Code requires private residential swimming pools, hot tubs, or non-portable spas containing water over 24 inches deep to meet the following pool barrier safety feature requirements:

- The pool access must be isolated by a barrier at least 4 feet high and installed around the perimeter of the pool. Unless the pool is equipped with a safety cover complying with the specifications of American Society for Testing and Materials standard F-1346-91.
- The barrier shall not have any gaps or openings which would allow a child to crawl under, squeeze through or climb over and must be placed no less than 20 inches from the water's edge.
- Gates located in the pool barrier must open outward away from the pool and be both self-closing and self latching, with a release mechanism not less than 54" above the standing surface at the gate.
- The barrier must be separate from any other fence, wall, or other enclosure surrounding the yard unless the fence, wall or other enclosure or portion thereof is situated on the perimeter of the pool and meets the pool barrier requirements.
- Where a wall of a dwelling serves as part of the barrier **one** of the following shall apply:
 - 1) All doors and first floor windows with a sill height of less than 48 inches providing direct access from the home to the pool must be equipped with an alarm that has a minimum sound pressure rating of 85 decibels at 10 feet. The alarm shall sound immediately upon opening the window or door unless the temporary bypass mechanism is activated.
 - 2) **Or;** all doors providing direct access from the home to the pool must be equipped with a self-closing, self-latching device with a release mechanism located at least 54 inches above the floor.

According to Florida statutes chapter 0515: Residential Swimming Pool Safety Act, failure to comply with these requirements is a misdemeanor of the second degree, punishable by imprisonment for up to 60 days or a fine of up to \$500, except that no penalty shall be imposed if within 45 days after arrest or issuance of a summons or notice to appear, the pool is equipped with the aforementioned safety features and the responsible person attends a drowning prevention education program developed by the Florida Department of Health. I also understand that there are several inspections required in addition to a final inspection for my swimming pool.

Roger C. Elliott 9/10/12
Owner Signature / Date

Address: 636 NW Country Lake Drive Lake City FL

[Signature]
Contractor Signature / Date

CP057105
License Number



PEELER POOLS CERTIFIED POOL PLANS

2010 IBCS RESIDENTIAL BUILDING CODE
2010 IBCS RESIDENTIAL ELECTRICAL CODE
2010 IBCS RESIDENTIAL MECHANICAL CODE
2010 IBCS RESIDENTIAL PLUMBING CODE
2010 IBCS RESIDENTIAL FIRE PROTECTION CODE
2010 IBCS RESIDENTIAL SAFETY CODE

THE CONTRACTOR'S RESPONSIBILITY FOR OBTAINING THE REQUIRED SETS OF CONSTRUCTION DOCUMENTS TO BE REVIEWED BY THE BUILDING DEPARTMENT IS THE CONTRACTOR'S RESPONSIBILITY. THE CONTRACTOR SHALL OBTAIN THE REQUIRED SETS OF CONSTRUCTION DOCUMENTS FROM THE ARCHITECT OR ENGINEER OF RECORD. THE CONTRACTOR SHALL OBTAIN THE REQUIRED SETS OF CONSTRUCTION DOCUMENTS FROM THE ARCHITECT OR ENGINEER OF RECORD. THE CONTRACTOR SHALL OBTAIN THE REQUIRED SETS OF CONSTRUCTION DOCUMENTS FROM THE ARCHITECT OR ENGINEER OF RECORD.

LEGEND

SYMBOL	DESCRIPTION
	ELEVATION MARK
	SECTION MARK
	DETAIL CALLOUT
	ELEVATION INDICATOR
	DOOR TAG
	WINDOW TAG
	ROOM TAG
	REVISION CLOUD w/ TAG

DRAWING INDEX - BUILDING PACKAGE

SHEET #	SHEET TITLE	REV. #	REV. DATE
T-1.0	TITLE SHEET	0	05-18-10
S-1.0	SECTIONS	0	05-18-10
A-1.0	PLAN VIEW	0	05-18-10

- GENERAL DESIGN REQUIREMENTS:**
- DESIGN DIMENSIONS SHALL COMPLY WITH SPECIFICATIONS IN ANSI/NSPI 5 RESIDENTIAL IN-GROUND POOLS BASED ON THE POOL TYPE AND NSPI 3 PERMANENTLY INSTALLED RESIDENTIAL SPAS.
 - SEE ANSI/NSPI 5 FOR DIVING WATER ENVELOPES.
 - SLIDES SHALL MEET MANUFACTURER'S INSTALLATION REQUIREMENTS.
 - ENTRY/EXIT: SHALL COMPLY WITH ANSI/NSPI 5 AND NSPI 3 LADDERS, UNDERWATER SEATS AND SWIM OUTS (MAX. 20" BELOW WATER).
 - CIRCULATION SYSTEMS, COMPONENTS & EQUIPMENT SHALL COMPLY W/ NSF 50.
 - THE MAXIMUM TURNOVER RATE IS 12 HOURS.
 - FILTERS SHALL HAVE AN AIR RELIEF AND PRESSURE GAUGE PUMPS 3 HP AND LESS SHALL MEET ANSI/UL 1081, CORROSION RESISTANT STRAINER AND MEET THE REQUIRED FLOW.
 - SURFACE SKIMMERS SHALL MEET NSF 50 AND THERE SHALL BE ONE FOR EVERY 800 SQUARE FEET OF SURFACE AREA.
 - RETURN INLETS SHALL BE A MINIMUM OF ONE FOR EVERY 800 SQ. FT.
 - HEATERS SHALL MEET ANSI-Z21.56 OR UL1261 OR UL559.
 - DISINFECTANT EQUIPMENT SHALL COMPLY WITH NSF 50.
 - PRESSURE TEST PIPING AT 35 PSI FOR 15 MINUTES OR MEET LOCAL CODE IF GREATER.
 - POOL SHAPE IS FREE FORM, ABOVE SHAPE AND DIMENSION ARE APPROXIMATE.
 - ASSUMED SOIL BEARING = 1.5 KSF.
 - INSTALL CONTROL JOINTS @ 20'-0" O.C. IN POOL DECKING.
 - CONCRETE STAIRS ARE 12" TREAD WITH AND 10" MAX. HEIGHT.
 - LIGHTING IF INSTALLED WILL BE FIBER OPTIC OR LED.
 - ALL EQUIPMENTAL BONDING SHALL BE INSTALLED PER 2008 NEC 680.26.
 - SLAB AND FOOTING : 2500 PSI CONCRETE, GRADE 40 STEEL.
 - REBAR

- SPECIAL SPA REQUIREMENTS:**
- MAXIMUM WATER DEPTH 4'; MAXIMUM SEAT DEPTH 28".
 - MAXIMUM FLOOR SLOPE 1:12.
 - STEPS: MINIMUM TREAD = 10"x12", MINIMUM RISER=7" MAXIMUM RISER=12" EXCEPT THE BOTTOM STEP MAY BE 14" IF IT IS THE SEAT. INTERMEDIATE TREADS AND RISERS TO BE UNIFORM.
 - SLIDES SHALL MEET MANUFACTURER'S INSTALLATION REQUIREMENTS.
 - IF THE SPA IS OPERATED INTERMITTENTLY IT SHALL HAVE A ONE HOUR TURNOVER.
 - MAXIMUM TEMPERATURE IS 104° FAHRENHEIT.
 - MEET ANSI/NSPI ARTICLE XVII SAFETY INSTRUCTION/SAFETY SIGN.
 - PRESSURE TEST PIPING AT 35 PSI FOR 15 MINUTES OR MEET LOCAL CODE IF GREATER.
 - ELECTRICAL REQUIREMENTS
 - WIRING AND BONDING AND ALL ELECTRICAL TO NEC ARTICLE 680 OR LOCAL CODE.
 - NO OUTLET OR OVERHEAD POWER WITHIN 10' IF WITHIN 15' PROTECT BY GFI TRANSFORMER MINIMUM 10' FROM POOL.
 - 8" ABOVE WATER J BOX 4" FROM POOL, BRASS TO J BOX OR TRANSFORMER WHICH EVER IS FIRST EXCEPT WHERE PVC IS APPROVED.
 - EQUIPMENTAL BONDING GRID TO BE ACCOMPLISHED PER THE NEC, SECTION 650.26 (C)(3)b.

- ADDITIONAL NOTES:**
- POOL INSTALLATION SHALL BE BY A QUALIFIED AND LICENSED (APPROVED BY LOCAL BUILDING DEPARTMENT) POOL CONTRACTOR. THE INSTALLATION SHALL CONFORM TO ALL LOCAL BUILDING CODES, IE, PERMITS, SPECIFICATIONS, CODES, RULES, INSPECTIONS, WORKMANSHIP, ETC.
 - POOL SHELL SHALL BEAR ON UNDISTURBED SOIL, FREE OF PEAT, MUCK, OR OTHER DELETERIOUS MATERIAL OF ANY SIGNIFICANT AMOUNT.
 - BACKFILL MATERIAL MUST NOT CONTAIN ROCKS OR OTHER MATERIALS THAT COULD DAMAGE POOL WALLS.
 - POOL TURNOVER SHALL BE 12 HOURS, MAXIMUM WITH CARTRIDGE FILTER, APPROVED PUMP (MIN 1 HP WITH 29 GPM 60 TDH).
 - STEPS SHALL BE PROVIDED AT THE SHALLOW END OF THE POOL.
 - LADDERS ARE TO BE PROVIDED IN POOLS WITH GREATER THAN 5' DEPTH WITHOUT SWIMOUTS.
 - INSTALL LOW VOLTAGE LIGHT PER NEC 680.
 - DURING HURRICANE WARNING OR ALERT, THIS POOL SHALL BE FILLED WITH WATER.
 - ALL GLASS WITHIN 5' OF WATERS EDGE SHALL COMPLY WITH R308.4(9) FOR SAFETY GLAZING.

11/26/12

REV.	DATE	DESCRIPTION
0	05-18-10	ISSUED FOR CONSTRUCTION

P.O. BOX 187
 130 W. HOWARD STREET
 LEE CHAN, FL 32064
 PHONE (904) 362-9078
 FAX (904) 362-9133
 GARY J. GILL PE 51942
 PROFESSIONAL ENGINEER
 ALTHA 9641



PEELER POOLS
 CERTIFIED POOL PLANS
 FLORIDA

PEELER POOLS 1212-022 F. VALETTICH G.J.G. S-1.0 2 OF 3

PIPE SIZING CHART (MAX.)			
PIPE	SUCTION	PRESSURE	
1 1/2"	35 GPM	60 GPM	
2"	60 GPM	100 GPM	

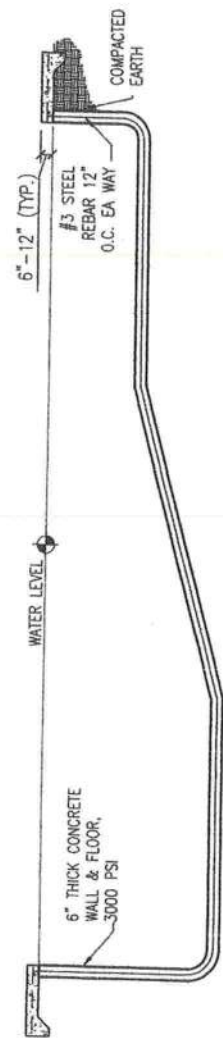

SECTION
 3/16" = 1"

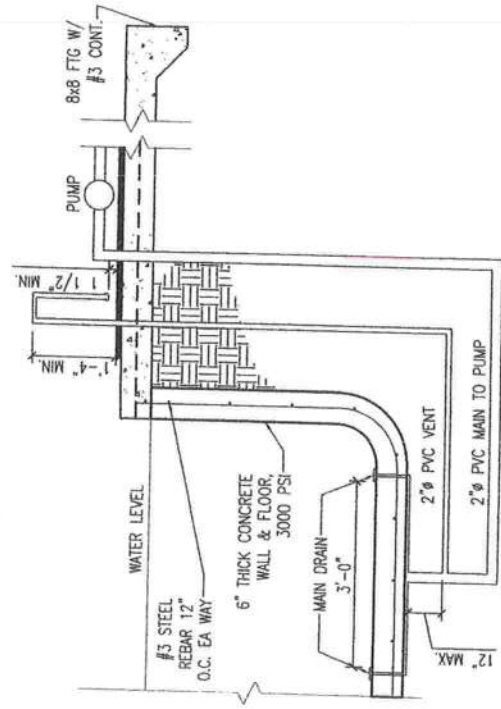

- NOTES:
1. MAIN SUCTION LINE IS TO BE 2"Ø
 2. VENT LINE IS TO BE 2"Ø
 3. LABEL VENT "HANDS-OFF; POOL SAFETY DEVICE"
 4. MAXIMUM UNDERWATER LENGTH OF VENT PIPE IS 30'. 90° BENDS SHOULD BE COUNTED AS 3' OF PIPE, 45° BENDS AS 2'.
 5. MINIMUM PUMP FLOW REQUIRED IS 42 GPM; TEST FLOW RATE OF 60 GPM CLEARED VENT LINE IN LESS THAN 3 SECONDS

MAIN DRAIN WITH AIR VENT
 1/2" = 1'

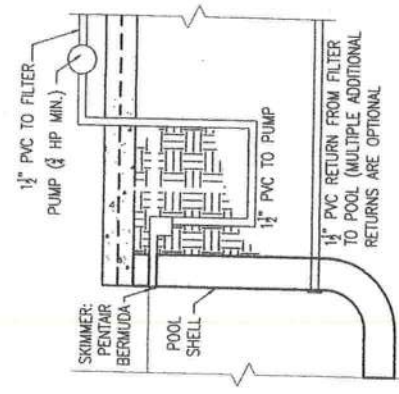
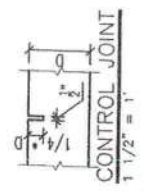
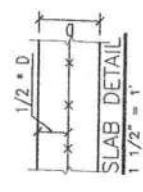
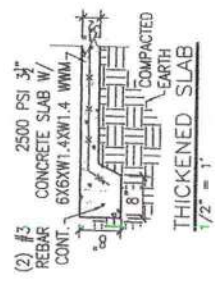

SKIMMER MAIN RETURN SYSTEM
 SUCTION PIPEWORK DIAGRAM
 1/8" = 1'-0"

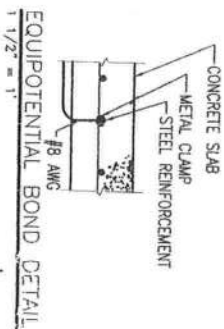

REV #	DATE	REVISION NOTES
0	05-18-10	ISSUED FOR CONSTRUCTION

Raised Planter 18" high

3 ft 6 in

36 Waterfall

7 ft 0 in

15 ft

32 ft 0 in

R

7 ft 0 in

Vac

12 ft 6 in

6 ft

R

16 ft 10 in

11 ft 8 in

7 ft 5 in

30 ft 4 in

13 ft 9 in

29 ft 0 in

19 ft 4 in

Umbrella anchor

22 ft 2 in

Kooldeck 228 sf Porch

1207 sf Deck
551 sf Pool
228 sf Porch

rogerelliott@cfl.rr.com
annelliott@cfl.rr.com

Construction, Renovation and Design
Peeler Pools
www.peelerpools.com

Good plan
accepted
X Roger C. Elliott
signature

Set back
25'
100' side
100' side
100' Front

SCALE: 1/8" = 1'

Peeler Pools	Phone: 386-755-2848	Designed by:	Elliott, Roger & Ann
9878 S U.S. Hwy 441		Designed	
Lake City	Fax: 386-755-5577	for:	Lake City
FL 32026			FL 32055