

3/8" DIA. FASTENERS
(SEE SCHEDULE FOR
OPTIONAL ATTACHMENT
FOR VARIOUS SITE
CONDITIONS)



- NOTE:
1. DESIGN WIND PRESSURE IN CONFORMANCE W/ ASCE 7-22, 140 MPH Vult, PER 2023 8TH EDITION
 2. BOLTS: ASTM A307
 3. CONTRACTOR SHALL BE RESPONSIBLE FOR WATERPROOFING.
 4. ALUM: 6061-T6
 5. ELECTRICAL: NEC 2020

WIND DESIGN CRITERIA	
RISK CATEGORY	I
WIND VELOCITY	140 MPH Vult
EXPOSURE CATEGORY (MMRF)	B
COMPONENT & CLADDING PRESSURES	31.4
FORCE COEFFICIENT C_f	1.2



THIS ITEM HAS BEEN
DIGITALLY SIGNED &
SEALED BY ENRIQUE A.
TORRENS, P.E. ON THE
DATE ADJACENT TO
THE SEAL. PRINTED
COPIES OF THIS
DOCUMENT ARE NOT
CONSIDERED SIGNED &
SEALED AND THE
SIGNATURE MUST BE
VERIFIED ON ANY
ELECTRONIC COPIES.

Digitally signed by
ENRIQUE A TORRENS
DN: c=US, o=Florida,
dnQualifier=A01410D0000
01818D0B2B8800016175,
cn=ENRIQUE A TORRENS
Date: 2024.06.24 14:43:35
-04'00'

SIGN ELEVATION
SCALE: 3/4"=1'-0"

SIGN CABINET

(1) EXTERNAL DISCONNECT
SWITCH PER NEC 600

60W REMOTE POWER
SUPPLY (120V-77V
AC-12V DC

18 AWG SUPPLY
WIRE

CONDUIT PASS THRU

EXISTING WALL

3/8" DIA. FASTENERS
(SEE SCHEDULE FOR
OPTIONAL ATTACHMENT FOR
VARIOUS WALL TYPES)

1/4" DIA. DRAIN

SECTION

N.T.S.

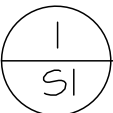

TYP WALL TYPE ATTACHMENT
SCHEDULE

3/8" DIA. x 4" POWER WEDGE



3/8" DIA. x 4" TAPCONS

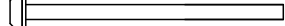

MASONRY

3/8" DIA. x 4" EXPANSION ANCHOR

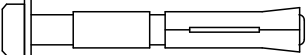

3/8" DIA. ALL THREAD x LENGTH AS REQ'D.
W/ ANGLE STRINGER

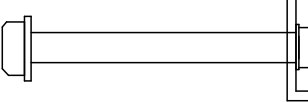

STUCCO / FOAM / LATH
& STUD

3/8" DIA. TOGGLE BOLT

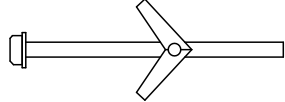

STUCCO / FOAM / LATH
& STUD
WHEN STRINGER NOT REQ'D

3/8" DIA. Non Drill Point Metal Roof Screws to the fasteners



ACM / METAL

3/8" DIA. x 4" LAG BOLT



STUCCO / WOOD LATH
& STUD

1. THIS SIGN IS INTENDED TO BE INSTALLED
IN ACCORDANCE WITH THE REQUIREMENTS
OF ARTICLE 600 OF THE NATIONAL
ELECTRICAL CODE AND/OR OTHER
APPLICABLE LOCAL CODES.

2. THIS INCLUDES PROPER GROUNDING AND
BONDING OF THE SIGN.

3. WET RATED EXTERNAL DISCONNECT
BOX/SWITCH TO BE PROVIDED AS PER
NATIONAL ELECTRICAL CODE (NEC) 600.6

4. EXISTING BRANCH CIRCUIT IN COMPLIANCE W/
NEC 600.5 NOT TO EXCEED 20 AMPS

UL LISTED

ENGINEER

ENRIQUE A. TORRENS, P.E. # 33379
624 BUCKINGHAM DR.
OVIEDO, FLORIDA 32765
PH/FAX (407) 765-6130

CLIENT: PETROGROUP

PROJECT: 2024-0480

PROJECT: TEXACO
3479 US 441 Lake City, FL

DATE: 06-24-2024

SHEET: OF 1

SI