

# COLUMBIA COUNTY Property Appraiser

**Parcel 30-4S-17-08889-000**

## Owners

RIMA OF LAKE CITY INC  
115 SW ENCHANTED CT  
LAKE CITY, FL 32024

## Parcel Summary

Location	3974 SW STATE ROAD 47
Use Code	1126: CONV STORE/GAS
Tax District	2: COUNTY
Acreage	.6650
Section	30
Township	4S
Range	17
Subdivision	DIST 2

## Legal Description

COMM NW COR OF NW1/4 OF NW1/4, E 1020.15 FT TO W  
R/W I-75, SE ALONG R/W 1195.87 FT FOR POB, W  
196.16 FT, S 150 FT, E 150 FT, NE 157.11 FT  
TO POB. (PARCEL B).

303-565, TALLAHASSEE ORB 79-288,  
931-2244, 938-767, 966-2277,

## Working Values

	2025
Total Building	\$134,048
Total Extra Features	\$17,344
Total Market Land	\$90,638
Total Ag Land	\$0



	2025
Total Market	\$242,030
Total Assessed	\$242,030
Total Exempt	\$0
Total Taxable	\$242,030
SOH Diff	\$0

## Value History

	2024	2023	2022	2021	2020	2019
Total Building	\$128,688	\$125,115	\$117,057	\$117,671	\$106,968	\$105,200
Total Extra Features	\$17,344	\$17,344	\$17,344	\$17,344	\$17,344	\$17,344
Total Market Land	\$90,638	\$90,638	\$90,638	\$90,638	\$90,638	\$90,638
Total Ag Land	\$0	\$0	\$0	\$0	\$0	\$0
Total Market	\$236,670	\$233,097	\$225,039	\$225,653	\$214,950	\$213,182
Total Assessed	\$236,670	\$233,097	\$225,039	\$225,653	\$214,950	\$213,182
Total Exempt	\$0	\$0	\$0	\$0	\$0	\$0
Total Taxable	\$236,670	\$233,097	\$225,039	\$225,653	\$214,950	\$213,182
SOH Diff	\$0	\$0	\$0	\$0	\$0	\$0

## Document/Transfer/Sales History

Instrument / Official Record	Date	Q/U .....	Reason	Type	V/I .....	Sale Price	Ownership
WD 0966/2277	2002-10-11	Q	03	WARRANTY DEED	Improved	\$100	Grantor: SOUTHERN RELOAD INC (BY CORRECTIVE WD) Grantee: RIMA OF LAKE CITY INC
WD 0938/0767	2001-10-22	Q	03	WARRANTY DEED	Improved	\$400,000	Grantor: SOUTHERN RELOAD INC Grantee: RIMA OF LAKE CITY INC
WD 0931/2244	2001-07-23	Q	03	WARRANTY DEED	Improved	\$150,000	Grantor: RISSER PETROLEUM INC Grantee: SOUTHERN RELOAD INC

## Buildings

**Building # 1, Section # 1, 106968, COMMERCIAL BLDGS**

Type	Model	Heated Area	Gross Area	Repl Cost New	YrBlit	Year Eff	Other % Dpr	Normal % Dpr	% Cond	Value
4300	04	2722	5993	\$268,096	1965	1985	0.00%	50.00%	50.00%	\$134,048

## Structural Elements

Type	Description	Code	Details
EW	Exterior Wall	17	MSNRY STUC
RS	Roof Structure	04	WOOD TRUSS
RC	Roof Cover	14	PREFIN MT
IW	Interior Wall	05	DRYWALL
IF	Interior Flooring	07	CORK/VTILE
CE	Ceiling	01	FIN.SUSPD
AC	Air Conditioning	06	ENG CENTRL
HT	Heating Type	09	ENG F AIR
FIX	Fixtures	7.00	
FR	Frame	03	MASONRY
SH	Story Height	10.00	
RMS	RMS	2.00	
STR	Stories	1.	1.
COND	Condition Adjustment	03	03

## Sub Areas

Type	Gross Area	Percent of Base	Adjusted Area
BAS	2,722	100%	2,722
CAN	240	30%	72
CAN	840	30%	252
CAN	2,000	30%	600
UST	75	40%	30
UST	116	40%	46

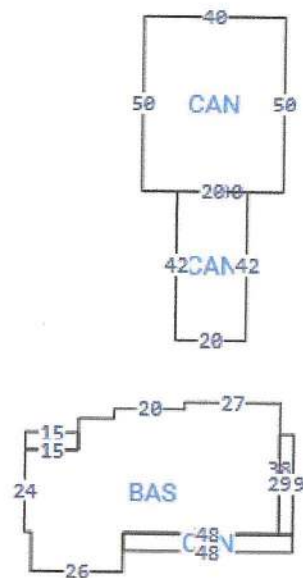

## Extra Features



Code	Description	Length	Width	Units	Unit Price	AYB	% Good Condition	Final Value
0260	PAVEMENT- ASPHALT			1.00	\$12,344.40	0	100%	\$12,344
0166	CONC,PAVMT	40	50	2000.00	\$1.40	0	100%	\$2,800
0253	LIGHTING			3.00	\$500.00	2003	100%	\$1,500
0070	CARPORT UF			1.00	\$0.00	2017	100%	\$400
0296	SHED METAL			1.00	\$0.00	2017	100%	\$300

## Land Lines

Code	Description	Zone	Front	Depth	Units	Rate/Unit	Acreage	Total Adj	Value
1410	CONV STORE	CHI	157.00	173.00	29,004.25	\$2.50/SF	0.67	1.25	\$90,638

## Personal Property

Account	Secured/ Unsecured	Owner	Description
12680-000	Unsecured	KWIK FILL MART INC	B - BUSINESS

## Permits

Date	Permit	Type	Status	Description
Oct 16, 2007	25617	MAINT/ALTR	COMPLETED	MAINT/ALTR
	20690	ADDN COMM	COMPLETED	ADDN COMM

## TRIM Notices

2024  
2023  
2022

## Disclaimer

All parcel data on this page is for use by the Columbia County Assessor for assessment purposes only. The summary data on this page may not be a complete representation of the parcel or of the improvements thereon. Building information, including unit counts and number of permitted units, should be verified with the appropriate building and planning agencies. Zoning information should be verified with the appropriate planning agency. All parcels are reappraised each year. This is a true and accurate copy of the records of the Columbia County Assessor's Office as of June 18, 2025.