

DATE 01/15/2004

Columbia County Building Permit

PERMIT

This Permit Expires One Year From the Date of Issue

000021424

APPLICANT ROCKY FORD PHONE 497-2311  
ADDRESS P.O. BOX 39 LAKE CITY FL 32038  
OWNER PAUL SWEET PHONE 850 554-1937  
ADDRESS 397 SW NUGGET WAY LAKE CITY FL 32024  
CONTRACTOR CHESTER KNOWLES PHONE 755-6441  
LOCATION OF PROPERTY 90W, PINEMOUNT RD, TL ON NUGGET ROAD,

TYPE DEVELOPMENT MH,UTILITY ESTIMATED COST OF CONSTRUCTION .00  
HEATED FLOOR AREA TOTAL AREA HEIGHT .00 STORIES  
FOUNDATION WALLS ROOF PITCH FLOOR  
LAND USE & ZONING A-3 MAX. HEIGHT  
Minimum Set Back Requirments: STREET-FRONT 30.00 REAR 25.00 SIDE 25.00  
NO. EX.D.U. 0 FLOOD ZONE X DEVELOPMENT PERMIT NO.

PARCEL ID 11-4S-15-00337-003 SUBDIVISION  
LOT BLOCK PHASE UNIT TOTAL ACRES 18.00

IH0000509  
Culvert Permit No. Culvert Waiver Contractor's License Number Applicant/Owner/Contractor  
EXISTING 04-0005-N BK RJ  
Driveway Connection Septic Tank Number LU & Zoning checked by Approved for Issuance New Resident

COMMENTS: PART OF THIS PROPERTY IS IN ZONE A, THE MH WILL BE LOCATED OUT OF THE  
FLOOD ZONE AS INDICATED ON SITE PLAN

Check # or Cash 8474

FOR BUILDING & ZONING DEPARTMENT ONLY

(footer/Slab)

Temporary Power date/app. by Foundation date/app. by Monolithic date/app. by  
Under slab rough-in plumbing date/app. by Slab date/app. by Sheathing/Nailing date/app. by  
Framing date/app. by Rough-in plumbing above slab and below wood floor date/app. by  
Electrical rough-in date/app. by Heat & Air Duct date/app. by Peri. beam (Lintel) date/app. by  
Permanent power date/app. by C.O. Final date/app. by Culvert date/app. by  
M/H tie downs, blocking, electricity and plumbing date/app. by Pool date/app. by  
Reconnection date/app. by Pump pole date/app. by Utility Pole date/app. by  
M/H Pole date/app. by Travel Trailer date/app. by Re-roof date/app. by

BUILDING PERMIT FEE \$ .00 CERTIFICATION FEE \$ .00 SURCHARGE FEE \$ .00  
MISC. FEES \$ 200.00 ZONING CERT. FEE \$ 50.00 FIRE FEE \$ 51.03 WASTE FEE \$ 110.25  
FLOOD ZONE DEVELOPMENT FEE \$ CULVERT FEE \$ TOTAL FEE 411.28

INSPECTORS OFFICE CLERKS OFFICE

NOTICE: IN ADDITION TO THE REQUIREMENTS OF THIS PERMIT, THERE MAY BE ADDITIONAL RESTRICTIONS APPLICABLE TO THIS  
PROPERTY THAT MAY BE FOUND IN THE PUBLIC RECORDS OF THIS COUNTY. AND THERE MAY BE ADDITIONAL PERMITS REQUIRED  
FROM OTHER GOVERNMENTAL ENTITIES SUCH AS WATER MANAGEMENT DISTRICTS, STATE AGENCIES, OR FEDERAL AGENCIES.

"WARNING TO OWNER: YOUR FAILURE TO RECORD A NOTICE OF COMMENCEMENT MAY RESULT IN YOUR PAYING TWICE FOR  
IMPROVEMENTS TO YOUR PROPERTY. IF YOU INTEND TO OBTAIN FINANCING, CONSULT WITH YOUR LENDER OR AN ATTORNEY  
BEFORE RECORDING YOUR NOTICE OF COMMENCEMENT."

This Permit Must Be Prominently Posted on Premises During Construction

PLEASE NOTIFY THE COLUMBIA COUNTY BUILDING DEPARTMENT AT LEAST 24 HOURS IN ADVANCE OF EACH INSPECTION, IN ORDER  
THAT IT MAY BE MADE WITHOUT DELAY OR INCONVIENCE, PHONE 758-1008. THIS PERMIT IS NOT VALID UNLESS THE WORK  
AUTHORIZED BY IT IS COMMENCED WITHIN 6 MONTHS AFTER ISSUANCE.

The Issuance of this Permit Does Not Waive Compliance by Permittee with Deed Restrictions.



\*\*\* The well affidavit, from the well driller, is required before the permit can be issued.\*\*\*

\*\*\*This application must be completely filled out to be accepted. Incomplete applications will not be accepted.\*\*\*

For Office Use Only

Zoning Official RF

Building Official RF

AP# 1401-12

Date Received 1-7-04

By G

Permit # 21424

Flood Zone A

Development Permit \_\_\_\_\_

Zoning A-3

Land Use Plan Map Category A-3

Comments \_\_\_\_\_

Property ID # PARCEL T.S. 4 South Range 15 EAST 00337-003 (Must have a copy of the property dec

New Mobile Home ☒

Used Mobile Home \_\_\_\_\_

Year 04

Applicant (Paul L. Sweet) Rocky Ford

Phone # (497-2311) 850-554-1937

Address 6894

Nugget Road

Name of Property Owner SAME

Phone# 850-554-1937

Address \_\_\_\_\_

Name of Owner of Mobile Home Paul L. Sweet

Phone # 850-554-1937

Address \_\_\_\_\_

Relationship to Property Owner NA

Current Number of Dwellings on Property 0

Lot Size 18 acres

Total Acreage 18 Acres

Current Driveway connection is Existing

Is this Mobile Home Replacing an Existing Mobile Home No

Name of Licensed Dealer/Installer Jessie L. Chester Knowles Phone # 386-755-6441

Installers Address PO Box 328 LAKE CITY FL 32056

License Number IH 0000509

Installation Decal # 215393

\*\*\*The Permit Worksheet (2 pages) must be submitted with this application.\*\*\*

\*\*\*Installers Affidavit and Letter of Authorization must be notarized when submitted.\*\*\*



ERMIT NUMBER

staller Jessie C. Chester License # Nugget Road

Address of home Nugget Road

ing installed \_\_\_\_\_

manufacturer Skyline Length x width 76 x 32

NOTE: if home is a single wide fill out one half of the blocking plan  
if home is a triple or quad wide sketch in remainder of home

I understand Lateral Arm Systems cannot be used on any home (new or used)  
where the sidewall lies exceed 5 ft 4 in.

Installer's initials JKK

New Home ☒ Used Home ☐

Home installed to the Manufacturer's Installation Manual ☒

Home is installed in accordance with Rule 15-C ☐

Single wide ☐ Wind Zone II ☒ Wind Zone III ☐

Double wide ☒ Installation Decal # 215393

Triple/Quad ☐ Serial # \_\_\_\_\_

PIER SPACING TABLE FOR USED HOMES

Load bearing capacity	Footer size (sq in)	16" x 16" (256)	18 1/2" x 18 1/2" (342)	20" x 20" (400)	22" x 22" (484)	24" x 24" (576)	26" x 26" (676)
1000 psf	3'	4'	4'	5'	6'	7'	8'
1500 psf	4' 6"	6'	6'	7'	8'	8'	8'
2000 psf	6'	8'	8'	8'	8'	8'	8'
2500 psf	7' 6"	8'	8'	8'	8'	8'	8'
3000 psf	8'	8'	8'	8'	8'	8'	8'
3500 psf	8'	8'	8'	8'	8'	8'	8'

Interpolated from Rule 15C-1 pier spacing table.

PIER PAD SIZES

POPULAR PAD SIZES

Pad Size	Sq Ft
16 x 16	256
16 x 18	288
18 5/8 x 18 5/8	342
16 x 22 5/8	360
17 x 22	374
13 1/4 x 26 1/4	348
20 x 20	400
17 3/16 x 25 3/16	441
17 1/2 x 25 1/2	446
24 x 24	576
26 x 26	676

PIER PAD SIZES

23 1/2 x 31 1/2

I-beam pier pad size 23 1/2 x 31 1/2

N/A

Perimeter pier pad size

Other pier pad sizes (required by the mfg.) 16 x 16 Doors

Draw the approximate locations of marriage wall openings 4 foot or greater. Use this symbol to show the piers.

List all marriage wall openings greater than 4 foot and their pier pad sizes below.

Opening Pier pad size 23 1/2 x 31 1/2

4 ft 5 ft

FRAME TIES

within 2' of end of home spaced at 5' 4" oc

TIEDOWN COMPONENTS

OTHER TIES

Longitudinal Stabilizing Device (LSD)  
Manufacturer \_\_\_\_\_  
Longitudinal Stabilizing Device w/ Lateral Arms  
Manufacturer Oliver Technology

Sidewall \_\_\_\_\_  
Longitudinal \_\_\_\_\_  
Marriage wall 6  
Shearwall N/A



POCKET PENETROMETER TEST

The pocket penetrometer tests are rounded down to  
or check here to declare 1000 lb. soil. ☒ without testing.

X 1.0 Assumed X 1.0

POCKET PENETROMETER TESTING METHOD

1. Test the perimeter of the home at 6 locations
2. Take the reading at the depth of the footer
3. Using 500 lb. increments, take the lowest reading and round down to that increment.

X 1.0 X 1.0 X 1.0

TORQUE PROBE TEST

The results of the torque probe test is N/A due to VSS system  
here if you are declaring 5 anchors without testing. A test  
showing 275 inch pounds or less will require 4 foot anchors.

Note: A slate approved lateral arm system is being used and 4 ft.  
anchors are allowed at the sidewall locations. 1 understand 5 ft  
anchors are required at all centerline tie points where the torque test  
reading is 275 or less and where the mobile home manufacturer may  
requires anchors with 4000 lb. holding capacity.

JFK Installer's initials

ALL TESTS MUST BE PERFORMED BY A LICENSED INSTALLER

Installer Name Jessie L. Chester Knudsen

Date Tested 1-5-04

Electrical

Direct electrical conductors between multi-wide units, but not to the main power  
service. This includes the bonding wire between multi-wide units. Pg. 15C-1

Plumbing

Direct all sewer drains to an existing sewer tap or septic tank. Pg. 15C-1 (Stub Only)

Direct all potable water supply piping to an existing water meter, water tap, or other  
dependent water supply systems. Pg. N/A

Site Preparation

Debris and organic material removed ☒ Compacted fill ☐  
Water drainage: Natural ☒ Swale ☐ Pad ☐ Other ☐

Fastering multi wide units

Floor: Type Fastener: LAG Length: 6" Spacing: 24"  
Walls: Type Fastener: SCWD Length: 4" Spacing: 24"  
Roof: Type Fastener: LAG Length: 6" Spacing: 24"  
For used homes a min. 30 gauge, 8" wide, galvanized metal strip  
will be centered over the peak of the roof and fastened with galv.  
roofing nails at 2" on center on both sides of the centerline

Gasket (weatherproofing requirement)

I understand a properly installed gasket is a requirement of all new and used  
homes and that condensation, mold, mildew and buckled marriage walls are  
a result of a poorly installed or no gasket being installed. I understand a strip  
of tape will not serve as a gasket.

Installer's initials: JFK

Installed:

Type Gasket Pg. 15C-1  
Between Floors ☒ Yes  
Between Walls ☒ Yes  
Bottom of ridgebeam ☒ Yes

Weatherproofing

The bottomboard will be repaired and/or taped. Yes ☒ Pg. 15C-1  
Siding on units is installed to manufacturer's specifications. ☒ Yes  
Fireplace chimney installed so as not to allow intrusion of rain water. ☒ Yes

Miscellaneous

Skirting to be installed. Yes ☒ No ☐  
Dryer vent installed outside of skirting. Yes ☐ N/A  
Range downflow vent installed outside of skirting. Yes ☐ N/A  
Drain lines supported at 4 foot intervals. ☒ Yes  
Electrical crossovers protected. ☒ Yes  
Other: ☐

Installer verifies all information given with this permit worksheet  
is accurate and true based on the

manufacturer's installation instructions and or Rule 15C-1 & 2

Installer Signature Jessie L. Chester Knudsen Date 1-6-04





KEE-10-50  
DUE-01-50  
250.00

Prepared by Marlin M. Feagle  
Attorney at Law  
Post Office Box 1653  
Lake City, Florida 32055  
(as to form only)

## WARRANTY DEED

BK 772 PG 123

THIS WARRANTY DEED, made this 10th day of March,  
1993, between LUCILLE M. COATS, Social Security  
Number: 261-48-9220, of the County of Columbia, in the State  
of Florida, party of the first part, Grantor, and KENNETH N.  
SWEET and his wife, SUSAN R. SWEET, Social Security  
Number: 265-90-0675, whose post-office address is Route 4,  
Box 325, Lake City, Florida 32055, parties of the second  
part, Grantee,

## W I T N E S S E T H:

That said grantor, for and in consideration of the sum  
of TEN AND NO/100 (\$10.00) Dollars, and other good and  
valuable considerations to said grantor in hand paid by said  
grantee, the receipt whereof is hereby acknowledged, has  
granted, bargained and sold to the said grantee, and  
grantee's heirs, successors and assigns forever, the  
following described land, situate, lying and being in  
Columbia County, Florida, to-wit:

TOWNSHIP 4 SOUTH, RANGE 15 EAST

West 759 feet of the Southeast 1/4 of Northwest 1/4  
of Section 11, Township 4 South, Range 15 East.  
Less and except the West 198 feet of the South 1/2  
of said parcel. Containing 20.00 acres more or  
less.

N.B. SUBJECT TO taxes after December 31, 1992;  
easements of record; road rights-of-way;  
reservations and restrictions of record, if any;  
visible easements; and applicable zoning and land  
use regulations.

Property Appraisers Parcel Identification Number:  
114S1500337000

DOCUMENTARY STAMP \$ 210.00  
INTANGIBLE TAX 0  
P. DEWITT CASON, CLERK OF  
COURTS, COLUMBIA COUNTY  
BY Marlin M. Feagle

and said grantor does hereby fully warrant the title to said land, and will defend the same against the lawful claims of all persons whatsoever.

IN WITNESS WHEREOF, Grantor has hereunto set grantor's hand and seal the day and year first above written.

SIGNED, SEALED AND DELIVERED  
IN OUR PRESENCE:

Lisa Butler  
Lisa Butler  
Printed Name

Lucille M. Coats (SEAL)  
LUCILLE M. COATS  
Rt. 4, Box 225  
Lake City, FL 32055

Suzanna Barrs  
Suzanna Barrs  
Printed Name

STATE OF FLORIDA  
COUNTY OF COLUMBIA

I HEREBY CERTIFY that on this day before me, an officer duly qualified to take acknowledgements, personally appeared LUCILLE M. COATS, who is personally known to me or who has produced N/A as identification and who did (did not) take an oath.

WITNESS my hand and official seal in the County and State last aforesaid this 15<sup>th</sup> day of March, 1993.

Suzanna S. Barrs  
NOTARY PUBLIC

MY COMMISSION EXPIRES:

(NOTARIAL)



OFFICIAL SEAL  
SUZANNA S. BARRS  
My Commission Expires  
March 3, 1994  
Comm. No. AA 746976

93-07983

FILED AND RECORDED IN PUBLIC  
RECORDS OF COLUMBIA COUNTY, FL

1993 MAR 15 PM 4:27

RECORD CLERK

P. Robert Cannon  
CLERK OF COURTS  
COLUMBIA COUNTY, FLORIDA  
Michael Barr

BK 0772 PG 0724

OFFICIAL RECORDS



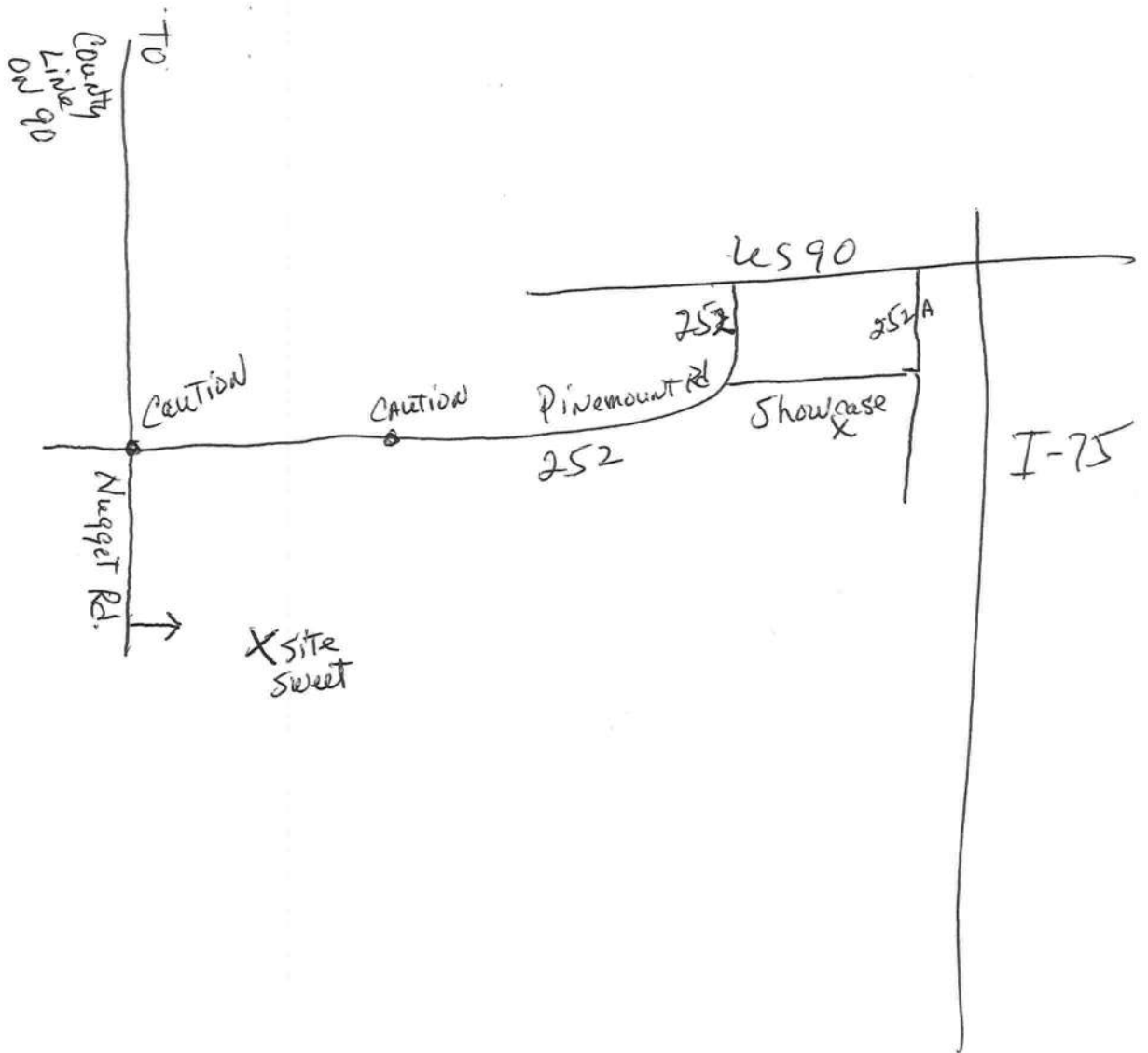

Sweet  
32x80 Skyline  
LOT model  
Site Sweet  
Phone 152-0455



# LIMITED POWER OF ATTORNEY

I, Jessie L. Chester Knowles DO HEREBY AUTHORIZE Mr/Mrs Paul Sweet on Rocke  
Fort  
TO PULL MY PERMITS AND ACT ON MY BEHALF IN ALL ASPECTS OF APPLYING  
FOR A MOBILE HOME PERMIT.

Jessie L. Chester Knowles  
SIGNATURE

1-6-04  
DATE

SWORN TO AND SUBSCRIBED BEFORE ME ON THIS 6th DAY OF Jan 2004.

Robin D. King Harris  
NOTARY PUBLIC



MY COMMISSION EXPIRES: 09-07-07  
COMMISSION NO. DD295355  
PERSONALLY KNOWN: ✓  
PRODUCED ID (TYPE): \_\_\_\_\_

## COLUMBIA COUNTY 9-1-1 ADDRESSING

263 NW Lake City Ave. \* P. O. Box 2949 \* Lake City, FL 32056-2949  
PHONE: (386) 752-8787 \* FAX: (386) 758-1365 \* Email: ron\_croft@columbiacountyfla.com

ATTN: Gail

### Addressing Maintenance

SWEET

To maintain the Countywide addressing Policy you must make application for a 9-1-1 Address at the time you apply for a building permit. The established standards for assigning and posting numbers to all principal buildings, dwellings, businesses and industries are contained in Columbia County Ordinance 2001-9. The addressing system is to enable Emergency Service Agencies to locate you in an emergency, and to assist the United States Postal Service and the public in the timely and efficient provision of services to residents and businesses of Columbia County.

DATE ISSUED: January 9, 2004

ENHANCED 9-1-1 ADDRESS:

397 SW NUGGET WAY (LAKE CITY, FL 32024)

Addressed Location 911 Phone Number: NOT AVAIL.

OCCUPANT NAME: NOT AVAIL.

OCCUPANT CURRENT MAILING ADDRESS: \_\_\_\_\_

PROPERTY APPRAISER MAP SHEET NUMBER: 11

PROPERTY APPRAISER PARCEL NUMBER: 11-4S-15-003375-003

Other Contact Phone Number (If any): \_\_\_\_\_

Building Permit Number (If known): \_\_\_\_\_

Remarks: \_\_\_\_\_

Address Issued By: \_\_\_\_\_

Shelly A. Messner  
Columbia County 9-1-1 Addressing Department

COMPLETED



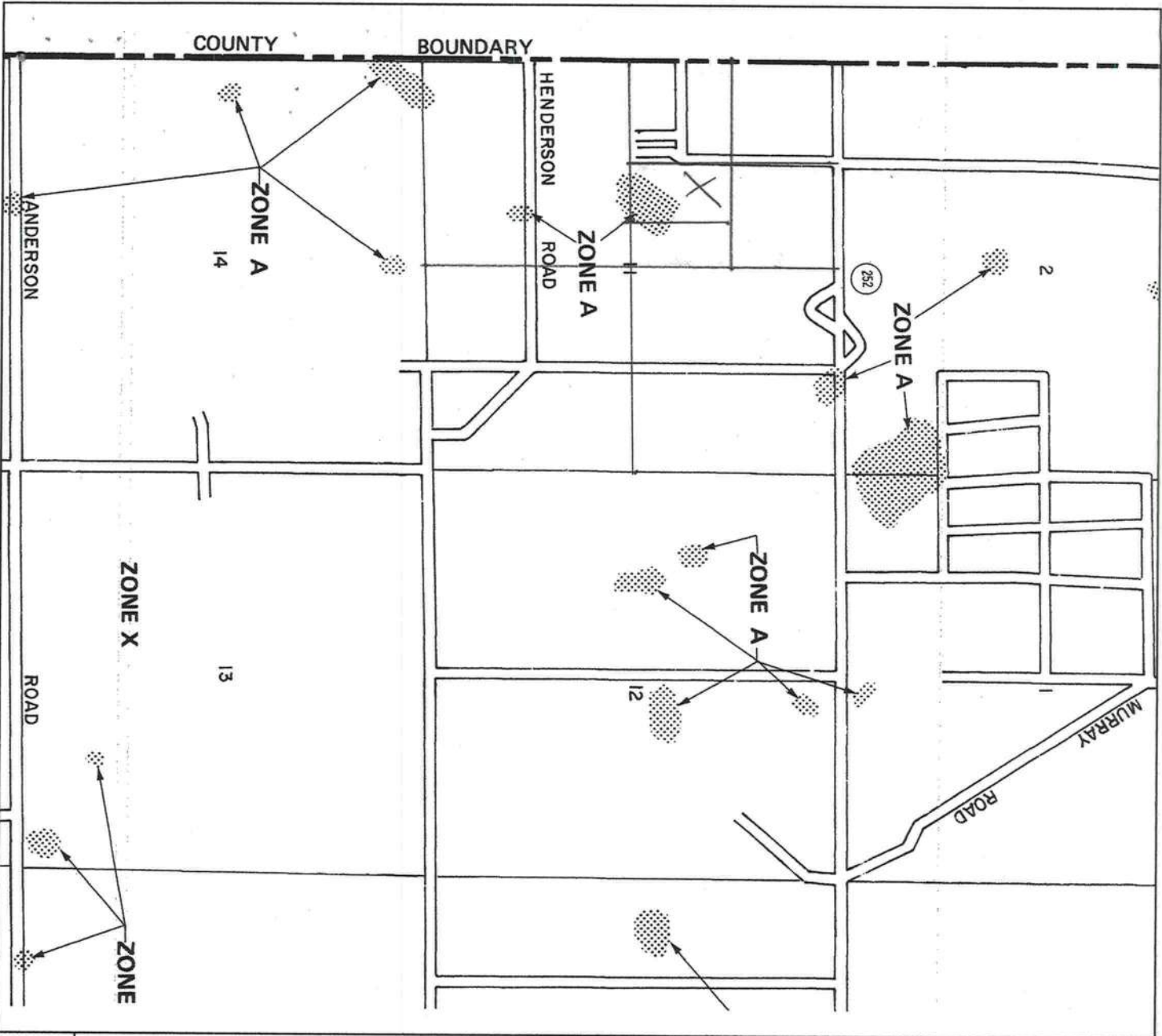

NATIONAL FLOOD INSURANCE PROGRAM

# FIRM FLOOD INSURANCE RATE MAP

COLUMBIA  
COUNTY,  
FLORIDA  
(UNINCORPORATED AREAS)

PANEL 175 OF 290

PANEL LOCATION

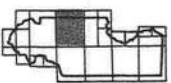

COMMUNITY-PANEL NUMBER  
120070 0175 B  
EFFECTIVE DATE:  
JANUARY 6, 1988

Federal Emergency Management Agency



This is an official copy of a portion of the above referenced flood map. It was extracted using F-MIT Version 1.0. This map does not reflect changes or amendments which may have been made subsequent to the date on the title block. Further information about National Flood Insurance Program flood hazard maps is available at [www.fema.gov/nflisid](http://www.fema.gov/nflisid).





STATE OF FLORIDA  
DEPARTMENT OF HEALTH

APPLICATION FOR ONSITE SEWAGE DISPOSAL SYSTEM CONSTRUCTION PERMIT

Permit Application Number 04-0005N

PART II - SITE PLAN

Scale: Each block represents 5 feet and 1 inch = 50 feet.

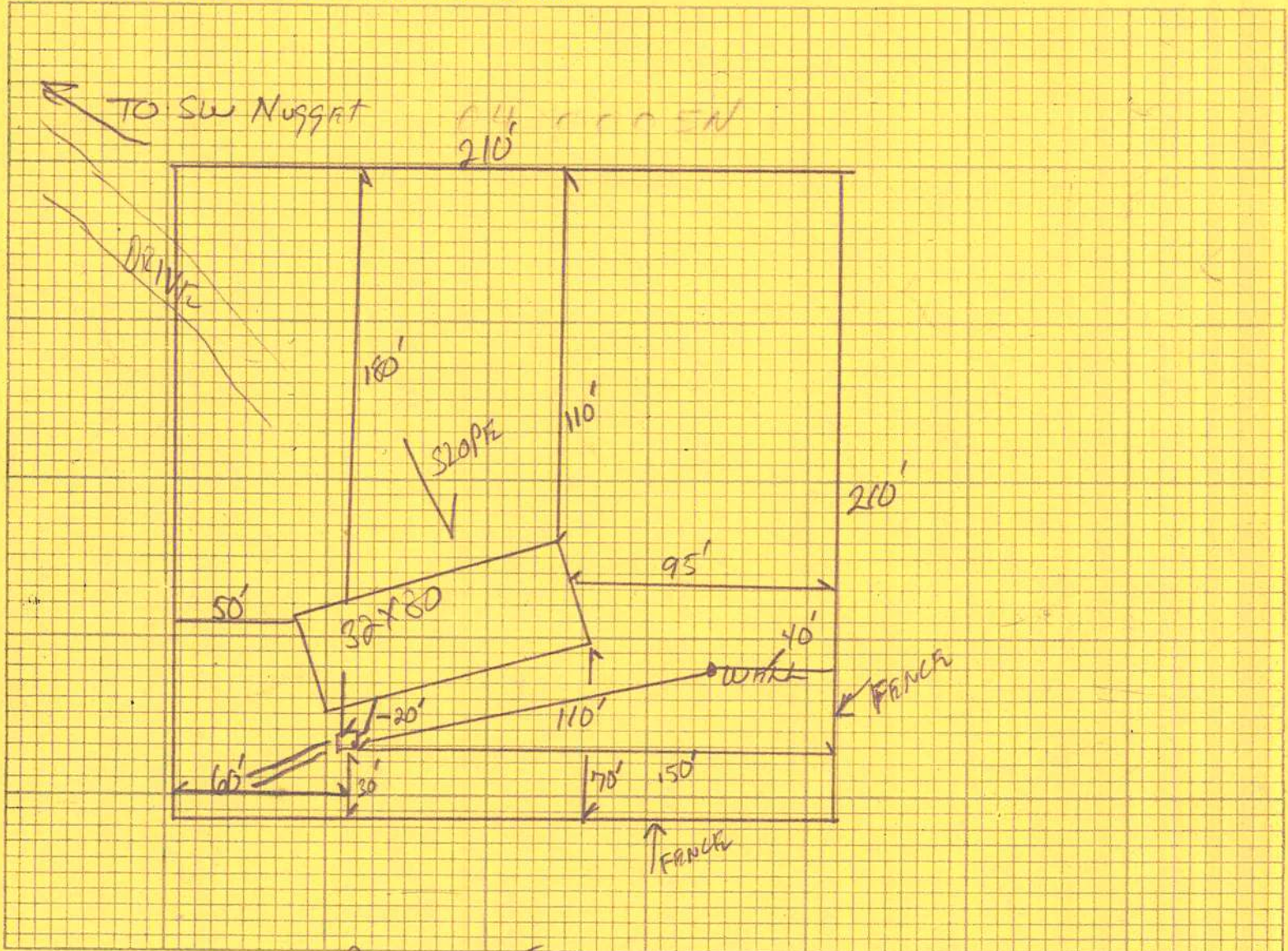

Notes: 1 Acre of 18.5 Acres

Site Plan submitted by: Rock D Z

Signature

Plan Approved ☒

Not Approved ☐

Title

Date 1-8-03

By Mr. Rock D Z

County Health Department

ALL CHANGES MUST BE APPROVED BY THE COUNTY HEALTH DEPARTMENT



RECEIVED  
1-28-04  
G  
COLUMBIA COUNTY  
FLORIDA  
OFFICE  
OF THE  
CLERK

M/H OCCUPANCY

COLUMBIA COUNTY, FLORIDA

## Department of Building and Zoning Inspection

*This Certificate of Occupancy is issued to the below named permit holder for the building and premises at the below named location, and certifies that the work has been completed in accordance with the Columbia County Building Code.*

Parcel Number 11-4S-15-00337-003

Building permit No. 000021424

Permit Holder CHESTER KNOWLES

Owner of Building PAUL SWEET

Location: 397 SW NUGGET WAY

Date: 01/29/2004



*Paul Sweet*

Building Inspector

POST IN A CONSPICUOUS PLACE  
(Business Places Only)