

DESIGN SPECIFICATIONS

- DESIGN CODES:
2020 FLORIDA BUILDING CODE (FBC)
- DESIGN LOADS:
ROOF CONVENTIONAL FRAMING:
LL 20 PSF RAFTERS
LL 20 PSF CEILING JOISTS
DL 10 PSF RAFTERS
DL 10 PSF CEILING JOISTS
WIND ZONE INFORMATION
BUILDING: ENCLOSED STRUCTURE
ULTIMATE DESIGN WIND SPEED: 130 MPH
NOMINAL DESIGN WIND SPEED: 110 MPH
BUILDING RISK CATEGORY: II
WIND EXPOSURE CATEGORY: C
INTERNAL PRESSURE COEFFICIENT: 0.18 C_{gp} ±

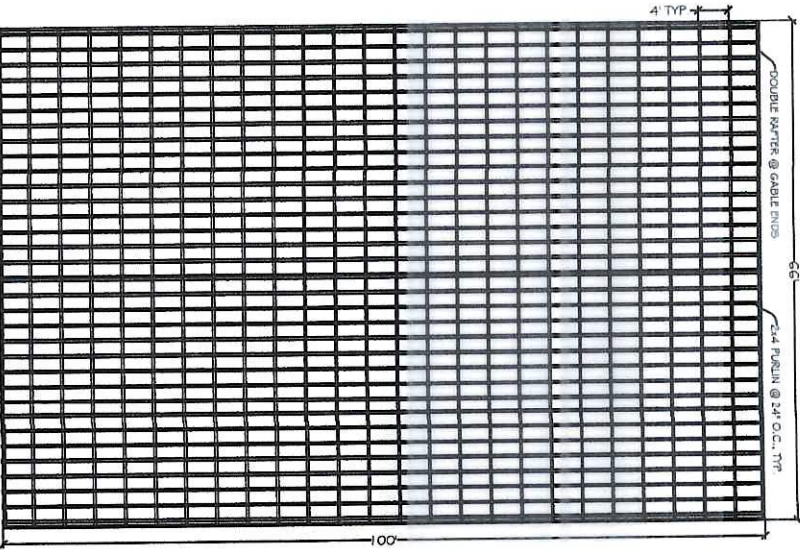
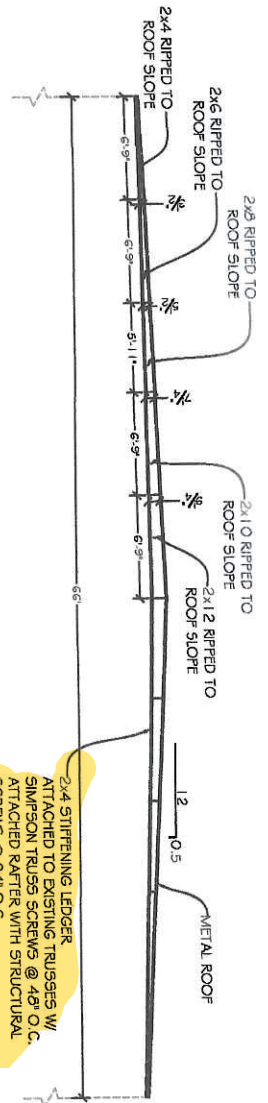

NOTE:
CONTRACTOR TO VERIFY ALL DIMENSIONS
PRIOR TO CONSTRUCTION

Printed copies of this document are provided
to the contractor and the engineer. The engineer will be notified
of any electronic copies.

PROJECT NO.	F233307
DATE	JULY 13, 2023
REVISION DATE	
SHEET	S-1

HAECO
ROOF FRAMING PLAN
LAKE CITY, FL

PREPARED FOR
PLUMB LEVEL CONSTRUCTION
KEVIN BEDONBAUGH, JR.
356 365 5264

DATE	REVISION DESCRIPTION

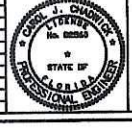

CAROL CHADWICK, P.E.
Civil Engineer
204 S.W. Palm Court
Lake City, FL 32829
813.442.1212
carolchadwick@gmail.com
www.carolchadwick.com
FLORIDA & VARIOUS OTHER STATES
DIVISION OF CALIFORNIA & N.C.E.E.S.