

FLORIDA DEPARTMENT OF
Business & Professional Regulation



[BCIS Home](#) | [Log In](#) | [User Registration](#) | [Hot Topics](#) | [Submit Surcharge](#) | [Stats & Facts](#) | [Publications](#) | [Contact Us](#) | [BCIS Site Map](#) | [Links](#) | [Search](#)



Product Approval
USER: Public User

[Product Approval Menu](#) > [Product or Application Search](#) > [Application List](#)

OFFICE OF THE
SECRETARY

Search Criteria

Code Version	2017	FL#	25829.2
Application Type	ALL	Product Manufacturer	ALL
Category	ALL	Subcategory	ALL
Application Status	ALL	Compliance Method	ALL
Quality Assurance Entity	ALL	Quality Assurance Entity Contract Expired	ALL
Product Model, Number or Name	ALL	Product Description	ALL
Approved for use in HVHZ	ALL	Approved for use outside HVHZ	ALL
Impact Resistant	ALL	Design Pressure	ALL
Other	ALL		



[Refine Search](#)

Search Results - Applications

FL#	Type	Manufacturer	Validated By	Status
FL25829	New	Morton Buildings, Inc FL#: FL25829.2 Model: Hi-Rib Wall Panels Description: Hi-Rib Steel Wall Panels Category: Panel Walls Subcategory: Siding	Berman, Theodore (305) 205-7809	Approved

*Approved by DBPR. Approvals by DBPR shall be reviewed and ratified by the POC and/or the Commission if necessary.

[Contact Us](#) :: 2601 Blair Stone Road, Tallahassee FL 32399 Phone: 850-487-1824

The State of Florida is an AA/EEO employer. Copyright 2007-2013 State of Florida, :: [Privacy Statement](#) :: [Accessibility Statement](#) :: [Refund Statement](#)

Under Florida law, email addresses are public records. If you do not want your e-mail address released in response to a public-records request, do not send electronic mail to this entity. Instead, contact the office by phone or by traditional mail. If you have any questions, please contact 850.487.1395. *Pursuant to Section 455.275(1), Florida Statutes, effective October 1, 2012, licensees licensed under Chapter 455, F.S. must provide the Department with an email address if they have one. The emails provided may be used for official communication with the licensee. However email addresses are public record. If you do not wish to supply a personal address, please provide the Department with an email address which can be made available to the public. To determine if you are a licensee under Chapter 455, F.S., please click [here](#).

Product Approval Accepts:



Credit Card
Safe

securityMETRICS

FASTENING HI-RIB WALL PANELS

FASTEN APPROX. 1/2" - 1" BELOW
TOP OF THE BEVELED PURLIN

#9x2" S.S.I.D. SCREWS
AT EACH HI-RIB & #9x1" S.S.I.D.
SCREWS CENTERED IN FLATS

CENTER RIB ON EDGE OF NAILERS

#9x1" S.S.I.D. SCREW AT
EACH NAILER UNDER
CORNER TRIM

*NAIL T#167 OR T#168 AT HEIGHT
DETERMINED FROM LENGTHS OF
PANELS UNDER 3x4 TRACKBOARD
(APPROX. 5" ABOVE GRADE).
NAIL WITH 1-1/2" R.S. NAILS
(3 PER 12' PIECE). SEE CORNER
NOTCHING DETAILS AT BASE OR AT
WAINSCOT ON A FOLLOWING PAGE.

FASTENING END
STEEL AT END TRUSS
(WITHOUT OVERHANG)

FASTEN WITH #9x1"
S.S.I.D. SCREWS
CENTERED IN FLATS
& NEXT TO RIBS
FACING SIPHON
GROOVE

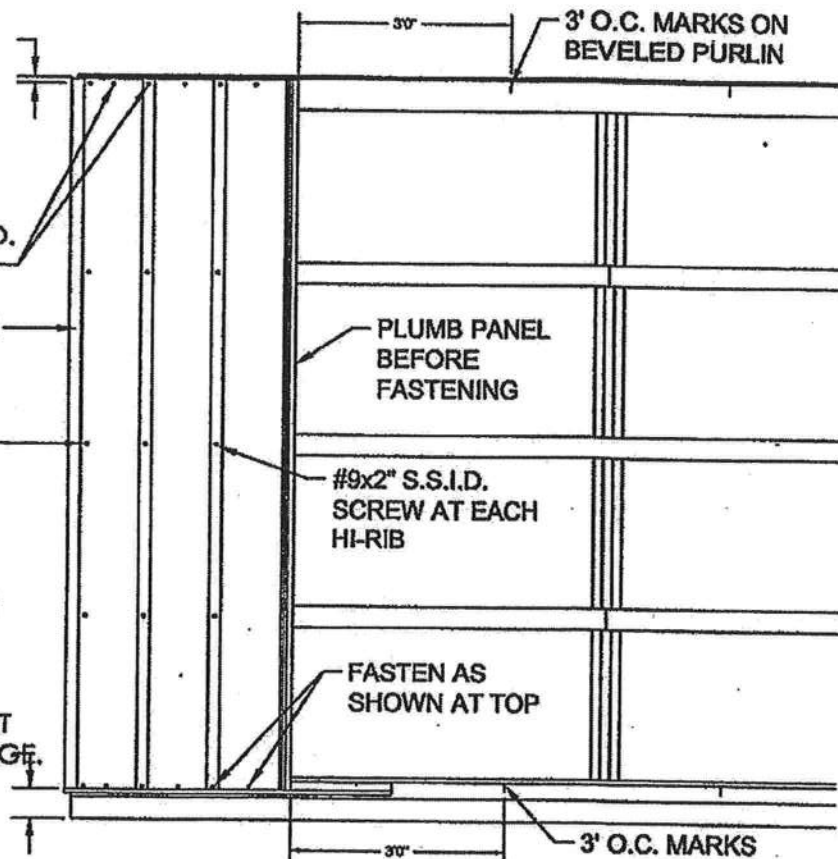
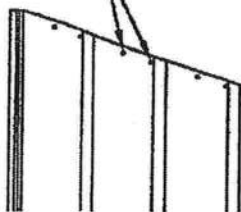

FASTENING SIDE OR END
STEEL AT OVERHANG

#9x1" S.S.I.D. SCREWS
CENTERED IN FLATS

SOFFIT & SOFFIT/
HI-RIB CAP
#9x2" S.S.I.D. SCREW
AT EACH HI-RIB

Allen N. Reeves
26 DEC. 2017

Allen N. Reeves, P.E., SECB
Structural Engineer
Florida License No. 19354



MORTON BUILDINGS, INC.



FLORIDA DEPARTMENT OF Business & Professional Regulation

[BCIS Home](#) |
 [Log In](#) |
 [User Registration](#) |
 [Hot Topics](#) |
 [Submit Surcharge](#) |
 [Stats & Facts](#) |
 [Publications](#) |
 [Contact Us](#) |
 [BCIS Site Map](#) |
 [Links](#) |
 [Search](#)



Product Approval
USER: Public User

[Product Approval Menu](#) > [Product or Application Search](#) > [Application List](#)

OFFICE OF THE
SECRETARY

Search Criteria

[Refine Search](#)

Code Version	2017	FL#	25577.2
Application Type	ALL	Product Manufacturer	ALL
Category	ALL	Subcategory	ALL
Application Status	ALL	Compliance Method	ALL
Quality Assurance Entity	ALL	Quality Assurance Entity Contract Expired	ALL
Product Model, Number or Name	ALL	Product Description	ALL
Approved for use in HVHZ	ALL	Approved for use outside HVHZ	ALL
Impact Resistant	ALL	Design Pressure	ALL
Other	ALL		

Search Results - Applications

FL#	Type	Manufacturer	Validated By	Status
FL25577	New	Morton Buildings, Inc FL#: FL25577.2 Model: Hi-Rib Steel Roof Panels Description: Hi-Rib Steel Roof Panels Category: Roofing Subcategory: Metal Roofing	Berman, Theodore (305) 205-7809	Approved

*Approved by DBPR. Approvals by DBPR shall be reviewed and ratified by the POC and/or the Commission if necessary.

[Contact Us](#) :: 2601 Blair Stone Road, Tallahassee FL 32399 Phone: 850-487-1824

The State of Florida is an AA/EEO employer. [Copyright 2007-2013 State of Florida](#), :: [Privacy Statement](#) :: [Accessibility Statement](#) :: [Refund Statement](#)

Under Florida law, email addresses are public records. If you do not want your e-mail address released in response to a public-records request, do not send electronic mail to this entity. Instead, contact the office by phone or by traditional mail. If you have any questions, please contact 850.487.1395. *Pursuant to Section 455.275(1), Florida Statutes, effective October 1, 2012, licensees licensed under Chapter 455, F.S. must provide the Department with an email address if they have one. The emails provided may be used for official communication with the licensee. However email addresses are public record. If you do not wish to supply a personal address, please provide the Department with an email address which can be made available to the public. To determine if you are a licensee under Chapter 455, F.S., please click [here](#).

Product Approval Accepts:



Credit Card
Safe

securityMETRICS

FASTENING HI-RIB ROOF PANELS

TO KEEP STEEL PROPERLY ALIGNED, MARK 1 PEAK PURLIN 3' O.C. (LENGTH OF BUILDING), & BOTH BEVELED FASCIA, IF BUILDING INCLUDES OVERHANGS. IF BUILDING REQUIRES A 2-PIECE PANEL, MARK PURLIN AT SPLICE ALSO.

NOTE: INSTALL SCREWS ON PANELS AS EACH PANEL IS INSTALLED.

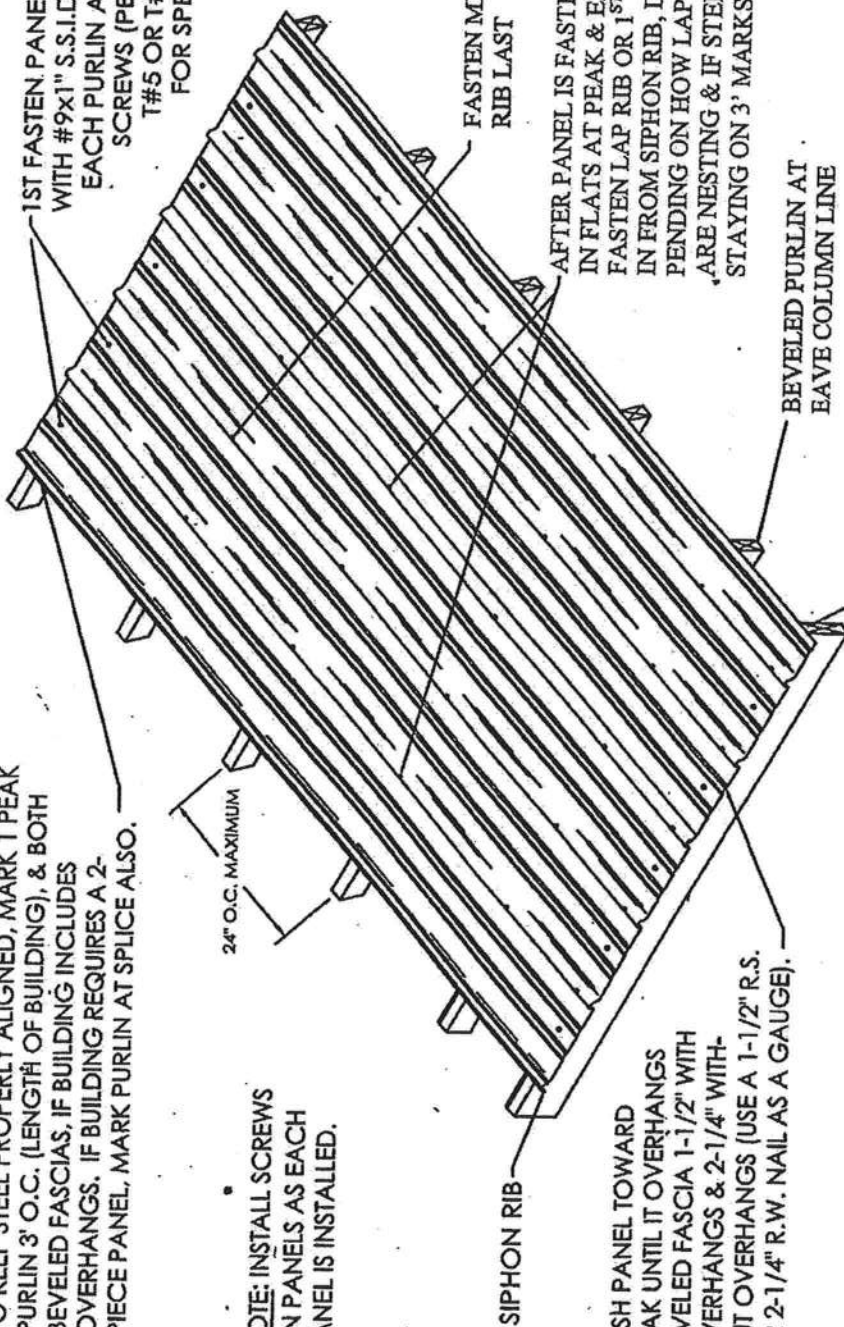

NOTE: FASTEN ROOF STEEL IN FLAT UNDER GABLE TRIM AT EACH PURLIN WITH #9x1" S.S.I.D. SCREWS.

NOTE: BEFORE FASTENING EACH PANEL, SIGHT LAP RIB FOR ANY FLARES AND ADJUST FOR A PROPER FIT.

NOTE: LONGER SCREWS ARE REQUIRED FOR THERMAX INSULATION.

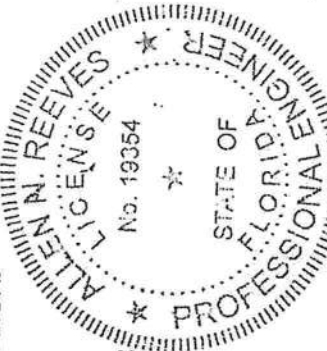

Allen N. Reeves
13 DEC. 2017

Allen N. Reeves, P.E., SECB
Structural Engineer
Florida License No. 19354

SERIES:	DATE: 2/23/2006
PART#:	REVISED:
WEIGHT:	TOLERANCES
SCALE: NTS	DECIMAL: 2 PLACE ±.03
SHEET 1 OF 1	FRACTIONAL: 3/32
	ANGULAR: ±1/2°
MORTON BUILDINGS, INC.	
THE INFORMATION HEREON IS THE PROPERTY OF MORTON BUILDINGS, INC. WITHOUT WRITTEN PERMISSION, ANY COPYING, TRANSMITTAL TO OTHERS, AND ANY USE EXCEPT THAT FOR WHICH IT IS LOANED, IS PROHIBITED.	
ROOF PANEL INSTALLATION	

#	PART NO.	QTY.	DESCRIPTION

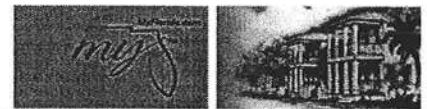

FLORIDA DEPARTMENT OF Business & Professional Regulation

[BCIS Home](#) |
 [Log In](#) |
 [User Registration](#) |
 [Hot Topics](#) |
 [Submit Surcharge](#) |
 [Stats & Facts](#) |
 [Publications](#) |
 [Contact Us](#) |
 [BCIS Site Map](#) |
 [Links](#) |
 [Search](#)



Product Approval
USER: Public User

[Product Approval Menu](#) > [Product or Application Search](#) > [Application List](#)

OFFICE OF THE
SECRETARY

Search Criteria

[Refine Search](#)

Code Version	2017	FL#	25872.2
Application Type	ALL	Product Manufacturer	ALL
Category	ALL	Subcategory	ALL
Application Status	ALL	Compliance Method	ALL
Quality Assurance Entity	ALL	Quality Assurance Entity Contract Expired	ALL
Product Model, Number or Name	ALL	Product Description	ALL
Approved for use in HVHZ	ALL	Approved for use outside HVHZ	ALL
Impact Resistant	ALL	Design Pressure	ALL
Other	ALL		

Search Results - Applications

FL#	Type	Manufacturer	Validated By	Status
FL25872	New	Morton Buildings, Inc FL#: FL25872.2 Model: MB-910 Door System Description: swinging steel entry door Category: Exterior Doors Subcategory: Swinging Exterior Door Assemblies	Berman, Theodore (305) 205-7809	Approved

*Approved by DBPR. Approvals by DBPR shall be reviewed and ratified by the POC and/or the Commission if necessary.

[Contact Us](#) :: 2601 Blair Stone Road, Tallahassee FL 32399 Phone: 850-487-1824

The State of Florida is an AA/EEO employer. [Copyright 2007-2013 State of Florida](#), :: [Privacy Statement](#) :: [Accessibility Statement](#) :: [Refund Statement](#)

Under Florida law, email addresses are public records. If you do not want your e-mail address released in response to a public-records request, do not send electronic mail to this entity. Instead, contact the office by phone or by traditional mail. If you have any questions, please contact 850.487.1395. *Pursuant to Section 455.275(1), Florida Statutes, effective October 1, 2012, licensees licensed under Chapter 455, F.S. must provide the Department with an email address if they have one. The emails provided may be used for official communication with the licensee. However email addresses are public record. If you do not wish to supply a personal address, please provide the Department with an email address which can be made available to the public. To determine if you are a licensee under Chapter 455, F.S., please click [here](#).

Product Approval Accepts:



Credit Card
Safe

securityMETRICS



MB 910 ENTRY DOOR
INSTALLATION INSTRUCTIONS



Allen N. Reeves
2 JAN. 2018

Allen N. Reeves, P.E., SECB
Structural Engineer
Florida License No. 19354



MB 910 ENTRY DOOR (STEEL SIDING)

(FOR 7'6" O.C. & 10'0" O.C. BUILDINGS)

STEP 1: FRAME OPENING. LOCATE CENTER OF A 3' DOOR TO LINE UP WITH A HI-RIB. FRAMING MUST BE PLUMB OR LEVEL. DO NOT LOCATED OUTSWING DOOR IN SLIDING DOOR PATH.

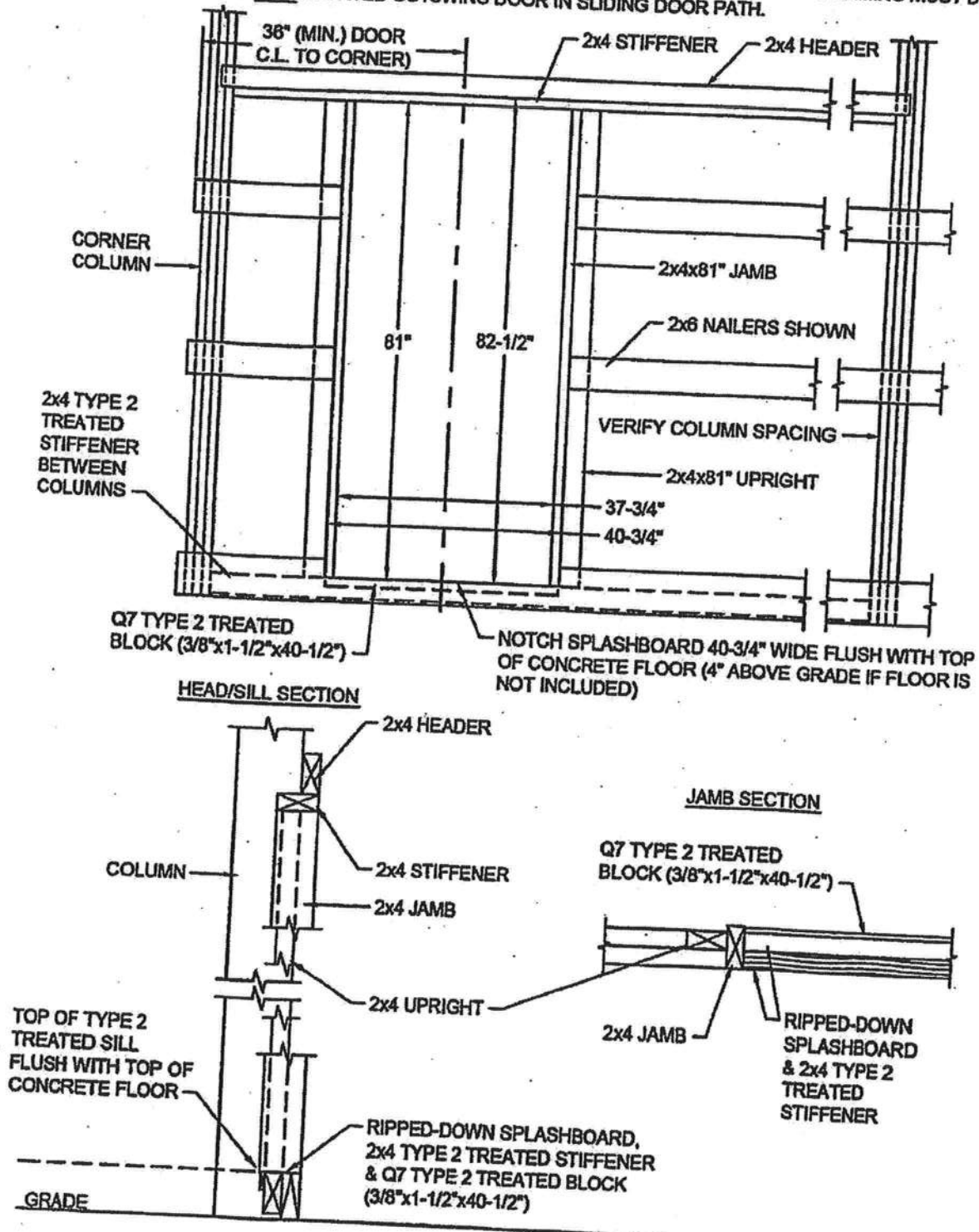



MB 910 ENTRY DOOR (STEEL SIDING)

STEP 2: CUT STEEL FOR OPENING. AT HEADER, CUT STEEL 1" ABOVE BOTTOM OF 2x4 FLAT HEADER & ANGLE-CUT RIBS 1/4" TO ALLOW FOR DRAINAGE. AT JAMBS, LEAVE 1/4" OF STEEL TO INSIDE OF OPENING; BEND THIS STEEL AROUND JAMBS TO EASE FRAME INSTALLATION.

STEP 3: CUT A PIECE OF T#11 TO 41" (DO NOT INSTALL AT THIS TIME).

STEP 4: PLACE ALUMINUM SILL OVER TREATED SILL. TURN ALLEN SCREWS BACK FLUSH AGAINST JAMB FRAMES. PLACE JAMB FRAMES OVER 2x4 JAMBS & SLIDE SILL TABS INTO SLOTS AT BOTTOM OF FRAMES.
NOTE: FRAMES ARE NOT HANDED -- HANDING CAN BE CHANGED ON-SITE.

STEP 5: SLIDE T#11 UP INTO PLACE. PLACE HEAD FRAME OVER 2x4 STIFFENER & SLIDE TABS INTO JAMB FRAMES. **NOTE:** DUE TO INSULATION DRAFT STOP IN FRAMES, IT WILL HELP ASSEMBLY PROCESS IF A 2x4x37" BLOCK IS WEDGED BETWEEN JAMB FRAMES TO HOLD THEM APART UNTIL HEAD FRAME IS IN POSITION.

STEP 6: ADJUST ALLEN SCREWS TO PLUMB JAMB FRAMES. KEEP FRAME CENTERED IN ROUGH OPENING. FASTEN SILL TO FRAMING WITH (4) #8x1-1/4" S.S. F.H. SCREWS (IN FRAME PACK). IF DOOR IS OUTSWING, INSTALL SILL INSERT PRIOR TO FASTENING (SEE SEE A FOLLOWING PAGE). SLIDE T#11 DOWN TIGHT TO HEAD FRAME & FASTEN PER STANDARD PROCEDURE. CAULK NOTCHES IN STEEL AT EACH END OF T#11.

STEP 7: CAREFULLY CAULK ALONG JOINT AT SILL TO JAMB CONNECTION.

STEP 8: INSTALL WEATHERSEAL INTO JAMB FRAMES. START AT SILL END OF EACH JAMB FRAME & WORK UP TO TOP. MAKE SURE WEATHERSEAL MAKES CONTACT WITH SILL. INSTALL WEATHERSEAL INTO HEAD FRAME -- KEEP IT CENTERED BETWEEN JAMB FRAMES (TRIMMING JAMB WEATHERSTRIPPING WILL BE REQUIRED WITH SILL INSERT ON OUTSWING DOORS). INSERT SWEEP BEFORE HANGING DOOR. FASTEN WITH (1) #8x3/4" PPA STL/ZN/CCD SCREW INCLUDED IN FRAME PACK.

STEP 9: HANG DOOR PANEL WITH (9) #12-24x3/4" F.H. SCREWS PACKAGED WITH FRAME SET. DO NOT FULLY TIGHTEN ANY HINGE SCREWS UNTIL ALL 9 HAVE BEEN STARTED. CHECK FIT & ADJUST ALLEN SCREWS IF REQUIRED. SEE STEP 10 & DETAILS BELOW FOR 3 REMAINING HOLES.

STEP 10: 1 HOLE AT EACH HINGE LOCATION ON HINGE JAMB FRAME HAS BEEN DRILLED OUT FOR #10x2-1/2" F.H. WOOD SCREWS (INSTALL 3 SCREWS -- DO NOT OVERTIGHTEN).

STEP 11: WITH ALL ADJUSTMENTS MADE TO INSURE PROPER OPERATION OF DOOR, SECURE JAMB FRAMES TO 2x4 FRAMING WITH (16) #9x2" S.S.I.D. SCREWS (REMOVE WASHERS) AT INSTALLATION HOLES IN FRAME.

STEP 12: INSERT PLASTIC CAPS IN (4) ALLEN SCREW HOLES.

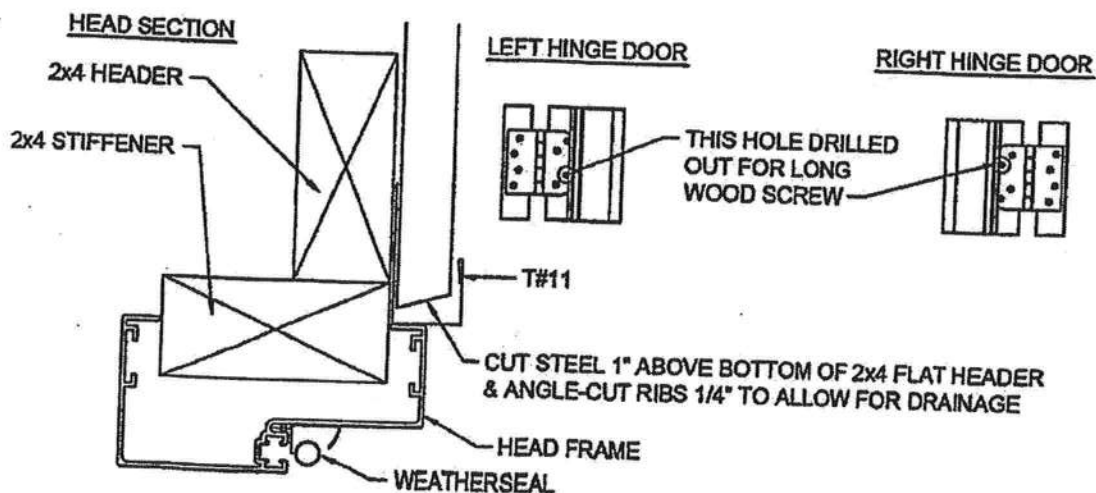

MB 910 ENTRY DOOR (STEEL SIDING)

NOTE: FRAMING MUST BE PLUMB OR LEVEL.

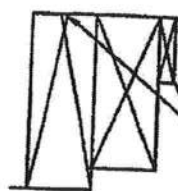
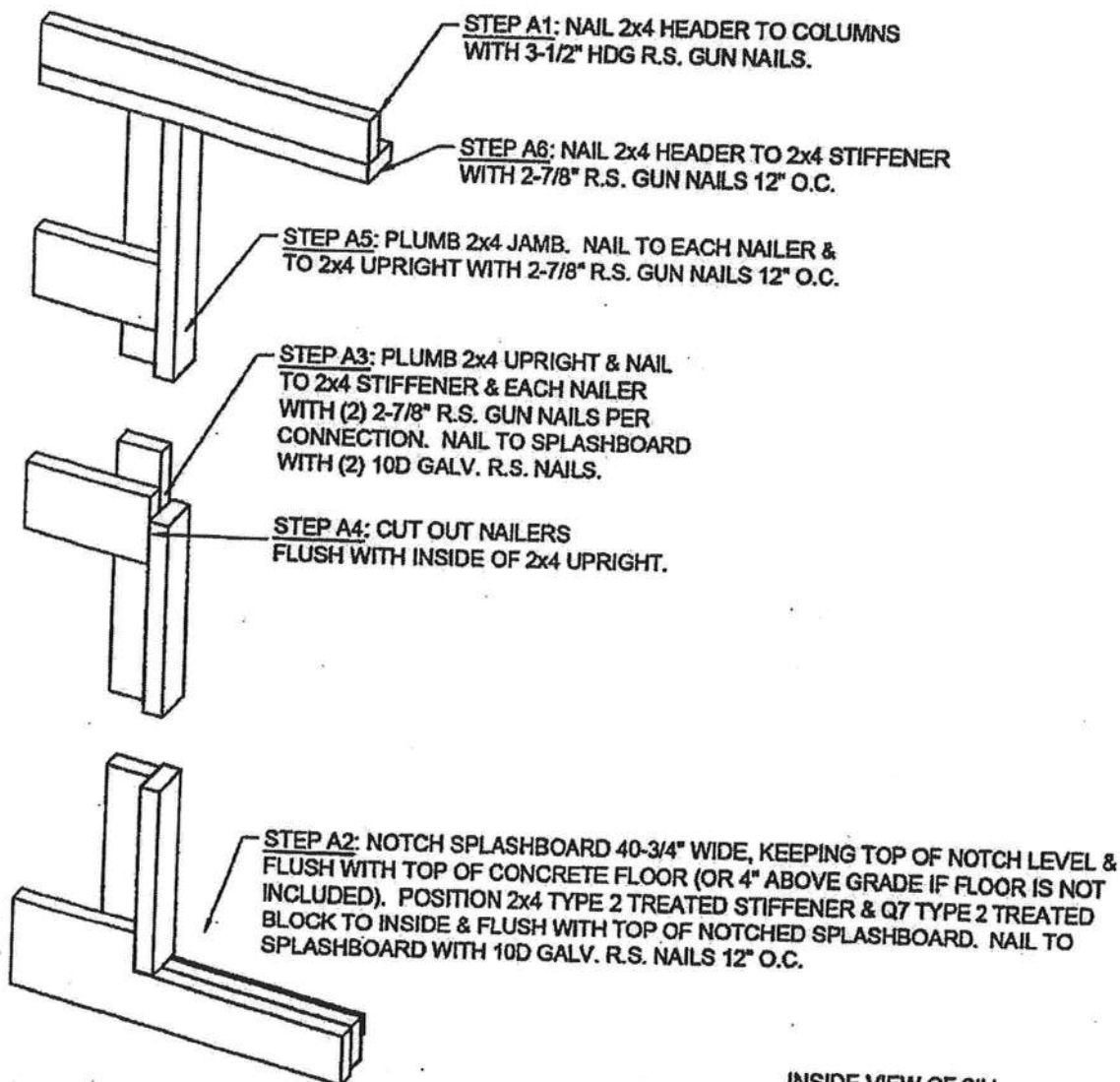

RIPPED-DOWN SPLASHBOARD, 2x4 TREATED TYPE 2 STIFFENER & Q7 3/8"x1-1/2"x40-1/2" TYPE 2 TREATED BLOCK

INSIDE VIEW OF SILL

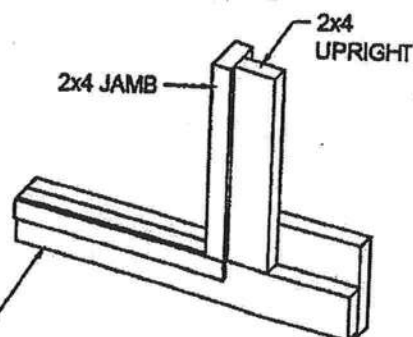

MB 910 STEEL ENTRY DOOR (STEEL SIDING)

(T#167 TRIM AT MB 910 ENTRY DOOR)

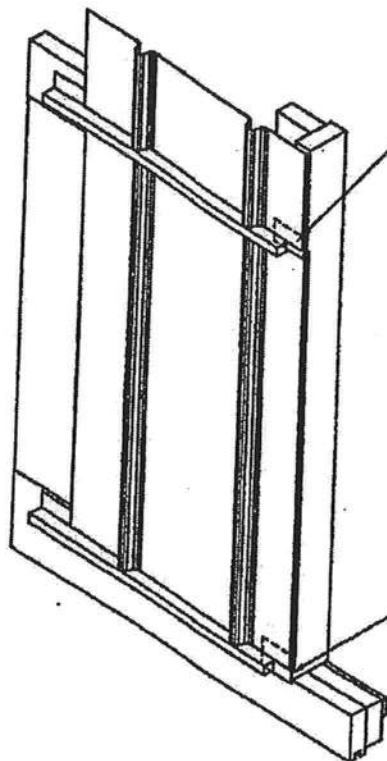

HOLD CAPPED END OF T#167 (SEE DETAILS BELOW) 1-3/8" BACK FROM EDGE OF 2x4 JAMB TO ALLOW FOR DOOR FRAME INSTALLATION*. TO PREVENT WATER FROM GETTING BEHIND WAINSCOT STEEL & TO COVER EXPOSED WOOD, SLIP A SMALL PIECE OF FLAT STEEL BEHIND T#167 & UPPER STEEL. LAP FLAT STEEL OVER WAINSCOT STEEL WITH BOTTOM POSITIONED FLUSH WITH CRIMPED EDGE OF T#167. MAKE FLAT STEEL SAME COLOR AS T#167 (MAY BE CUT FROM A PIECE OF T#167).

HOLD CAPPED END OF T#167 (SEE DETAILS BELOW) 1-3/8" BACK FROM EDGE OF 2x4 JAMB TO ALLOW FOR DOOR FRAME INSTALLATION*. TO COVER EXPOSED NON-TREATED WOOD, SLIP A SMALL PIECE OF FLAT STEEL BEHIND T#167 & WAINSCOT STEEL. LAP FLAT STEEL OVER TREATED WOOD. MAKE FLAT STEEL SAME COLOR AS T#167 (MAY BE CUT FROM A PIECE OF T#167).

*NOTE: WITH DOOR CENTERED IN OPENING, THERE WILL BE APPROX. A 7/16" GAP BETWEEN T#167 & DOOR FRAME TO ALLOW FOR DOOR FRAME INSTALLATION.

T#167 CUTTING & BENDING DETAILS

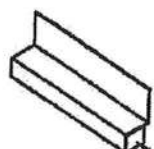
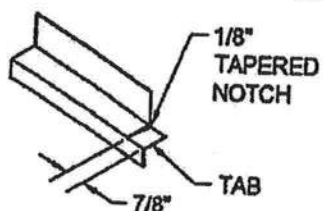

FOLD TAB UNDER HORIZONTAL LEG TO CAP END OF T#167 AT 910 FRAME



MB 910 ENTRY DOOR (STEEL SIDING)

JAMB SECTION

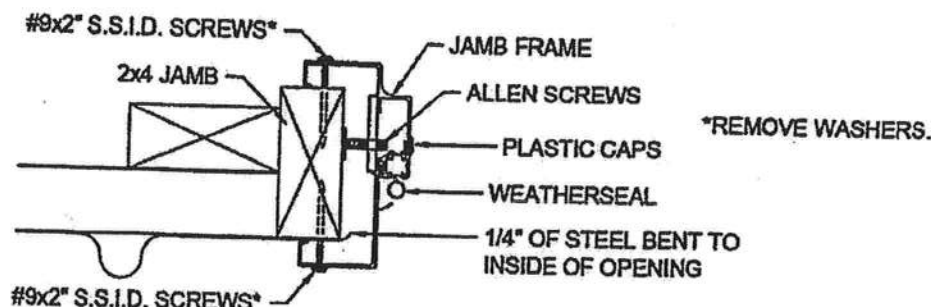

MB 910 ENTRY DOOR (SWEEP POSITION)

STEP 1: FASTEN ALUMINUM SILL WITH (4) #8x1-1/4" S.S. F.H. SCREWS (T-20 TORX DRIVE) IN PRE-PUNCHED HOLES (CAULK HOLES 1ST). AN OUTSWING DOOR REQUIRES A SILL INSERT AS SHOWN BELOW – TRIM WEATHER STRIPPING FOR INSERT. IF BUILDING IS ON CONCRETE, USE CONCRETE INSERTS FOR SCREWS.

OUTSWING DOOR SILL

INSWING DOOR SILL

SHORT LEG OF SWEEP ALWAYS TO SAME SIDE OF DOOR THAT CLOSES AGAINST JAMB STOP

OUTSWING SILL INSERT



APPLY CAULKING HERE

#8x1-1/4" S.S. F.H. SCREWS

LONG LEG OF SWEEP ALWAYS TO SAME SIDE OF DOOR AS HINGE PINS

SHORT LEG OF SWEEP ALWAYS TO SAME SIDE OF DOOR THAT CLOSES AGAINST JAMB STOP

*BULB SIDE OF SWEEP ALWAYS TO SAME SIDE OF DOOR THAT CLOSES AGAINST JAMB STOP

STEP 2: APPLY A SMALL AMOUNT OF CAULKING AT EACH END OF SWEEP.

MB 910 ENTRY DOOR (FRAME PACKAGING)

MB 910 JAMB SET:

- (1) HINGE JAMB WITH HINGES ATTACHED.
- (1) LATCH JAMB WITH DEADBOLT MORTISE CAPS INSTALLED.
- (2) PIECES OF JAMB WEATHERSTRIPPING.
- (1) FRAME PACK – TO INCLUDE:
 - (3) #10x2-1/2" FLAT HEAD WOOD SCREWS (HINGE TO FRAME)
 - (12) #12x3/4" FLAT HEAD UNDERCUT SCREWS (HINGE TO DOOR SLAB)
 - (4) U-NUTS (STRIKE PLATE TO FRAME ATTACHMENT)
 - (1) LOCKSET MORTISE CAP
 - (4) JACK SCREW HOLE PLUGS
 - (4) #8x1-1/4" S.S.I.D. FLAT HEAD SCREWS (SILL TO FRAMING)
 - (1) LOCKSET STRIKE PLATE
- (2) LATCH SPACER USE BETWEEN LATCH PLATE OF LOCKSET DEADBOLT & DOOR EDGE
- (1) SMS #8x3/4" PPA STLZN/CCD SCREW (MB320 SWEEP NOT USED FOR MB910)
- (1) HEX KEY

MB 910 HEAD PACKAGING:

- (1) HEAD
- (1) HEAD WEATHER STRIPPING
- (1) SWEEP

MB 910 ENTRY DOOR WITH EXTERIOR SHEATHING

(FOR BUILDINGS WITH THERMAX, SHEETROCK OR OSB SHEATHING)

HEAD SECTION (1/2" OR 1" SHEATHING)

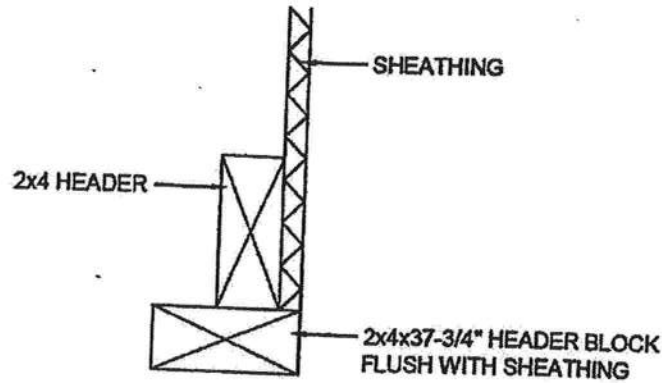

JAMB SECTION (1/2" OR 1" SHEATHING)

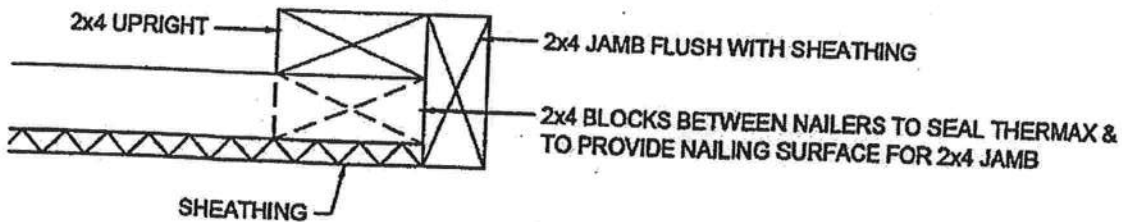

SILL SECTIONS

1/2" SHEATHING

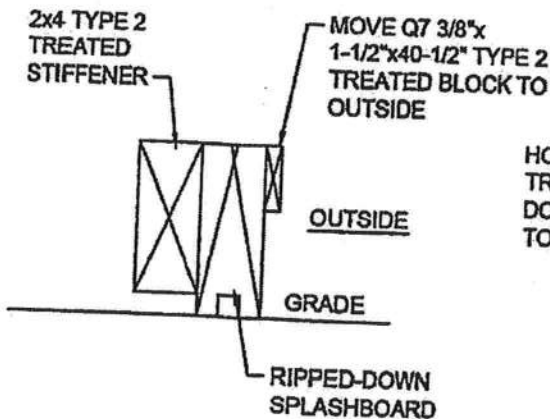

1" SHEATHING

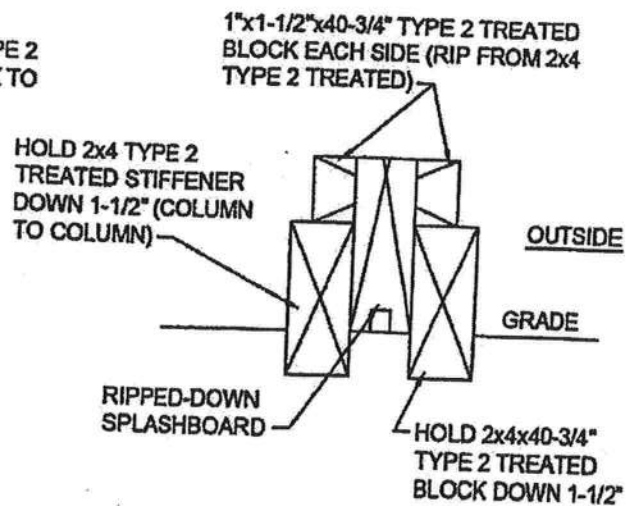



MB 910 ENTRY DOOR HARDWARE

(STRIKE PLATES & HOLE COVERS)

LOCKSET PREP

1. SLIDE (1) U-NUT (INCLUDED IN FRAME PACK) OVER EACH SCREW HOLE (SEE DETAIL TO RIGHT).

2. INSTALL STRIKE PLATE (INCLUDED WITH FRAME PACK). FASTEN WITH (2) COMBINATION SCREWS (PACKED WITH LOCKSET).

3. COVER OTHER LOCKSET HOLE WITH MORTISE COVER (INCLUDED IN FRAME PACK).

DEADBOLT PREP:

1. REMOVE APPROPRIATE MORTISE COVER FROM DEADBOLT HOLE.

2. SLIDE (1) U-NUT (INCLUDED IN FRAME PACK) OVER EACH SCREW HOLE (SEE DETAIL TO RIGHT).

3. INSTALL STRIKE PLATE, PACKED WITH DEADBOLT. FASTEN WITH (2) COMBINATION SCREWS (PACKED WITH DEADBOLT).

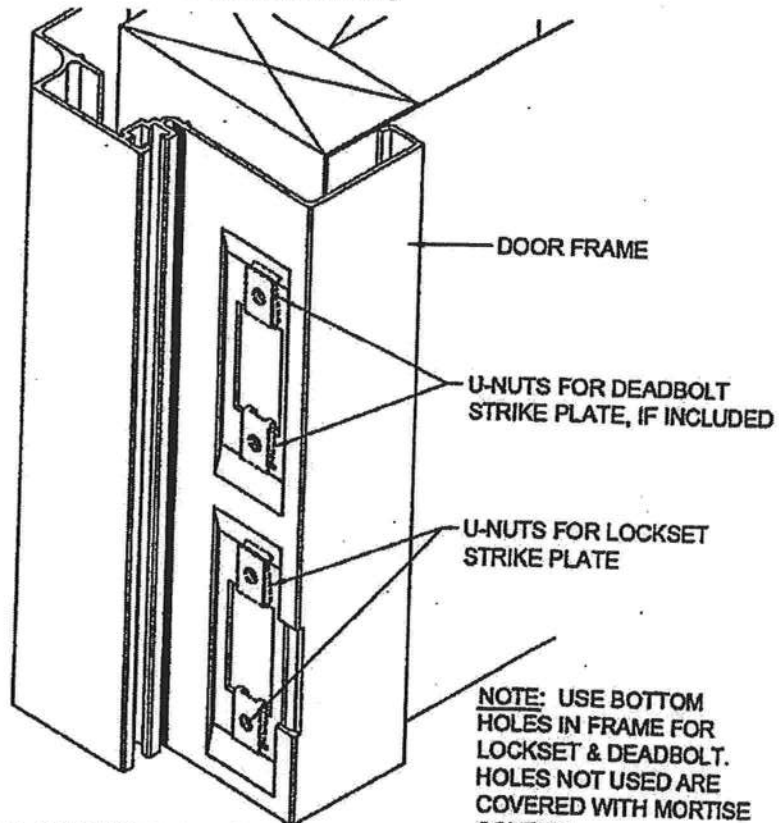

NOTE: WEATHERSEAL NOT SHOWN.

LOCKSET & DEADBOLT STRIKE PLATES

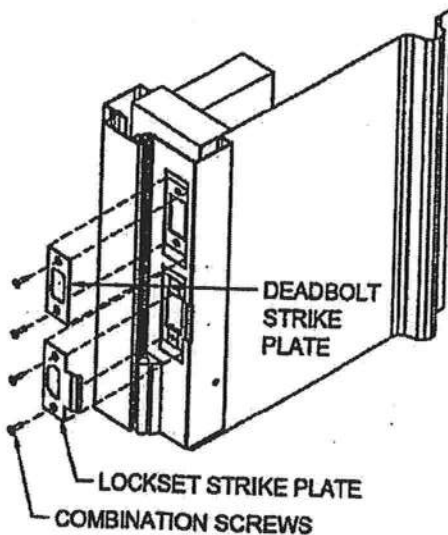

LOCKSET & DEADBOLT MORTISE COVERS

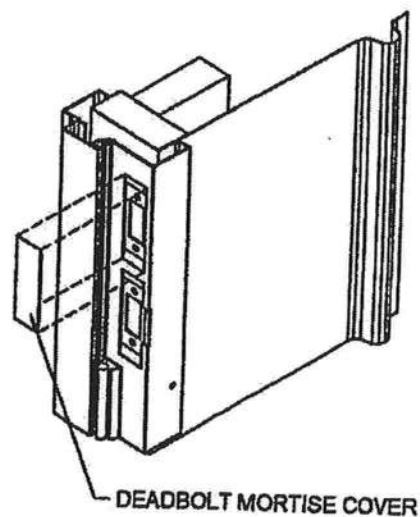

FLORIDA DEPARTMENT OF Business & Professional Regulation

[DBPR HOME](#) / [ABOUT DBPR](#) / [DBPR DIVISIONS](#) / [CONTACT DBPR](#)
[BCIS Home](#) | [Log In](#) | [User Registration](#) | [Hot Topics](#) | [Submit Surcharge](#) | [Stats & Facts](#) | [Publications](#) | [Contact Us](#) | [BCIS Site Map](#) | [Links](#) | [Search](#)

Product Approval
 USER: Public User

[Product Approval Menu](#) > [Product or Application Search](#) > [Application List](#)

 OFFICE OF THE
 SECRETARY

Search Criteria

[Refine Search](#)

Code Version	2017	FL#	11865
Application Type	ALL	Product Manufacturer	ALL
Category	ALL	Subcategory	ALL
Application Status	ALL	Compliance Method	ALL
Quality Assurance Entity	ALL	Quality Assurance Entity Contract Expired	ALL
Product Model, Number or Name	ALL	Product Description	ALL
Approved for use in HVHZ	ALL	Approved for use outside HVHZ	ALL
Impact Resistant	ALL	Design Pressure	ALL
Other	ALL		

Search Results - Applications

FL#	Type	Manufacturer	Validated By	Status
FL11865-R7 History	Revision	Pella Corporation Category: Windows Subcategory: Casement	James L. Buckner, P.E. @ CBUCK Engineering (561) 491-9927	Approved *

*Approved by DBPR. Approvals by DBPR shall be reviewed and ratified by the POC and/or the Commission if necessary.

[Contact Us](#) :: 2601 Blair Stone Road, Tallahassee FL 32399 Phone: 850-487-1824

The State of Florida is an AA/EEO employer. [Copyright 2007-2013 State of Florida](#). :: [Privacy Statement](#) :: [Accessibility Statement](#) :: [Refund Statement](#)

Under Florida law, email addresses are public records. If you do not want your e-mail address released in response to a public-records request, do not send electronic mail to this entity. Instead, contact the office by phone or by traditional mail. If you have any questions, please contact 850.487.1395. *Pursuant to Section 455.275(1), Florida Statutes, effective October 1, 2012, licensees licensed under Chapter 455, F.S. must provide the Department with an email address if they have one. The emails provided may be used for official communication with the licensee. However email addresses are public record. If you do not wish to supply a personal address, please provide the Department with an email address which can be made available to the public. To determine if you are a licensee under Chapter 455, F.S., please click [here](#).

Product Approval Accepts:



Credit Card
Safe

securityMETRICS