

STATE OF FLORIDA  
DEPARTMENT OF HEALTH  
APPLICATION FOR CONSTRUCTION PERMIT

Permit Application Number

14-8892E

## ----- PART II - SITEPLAN -----

Scale: Each block represents 10 feet and 1 inch = 40 feet

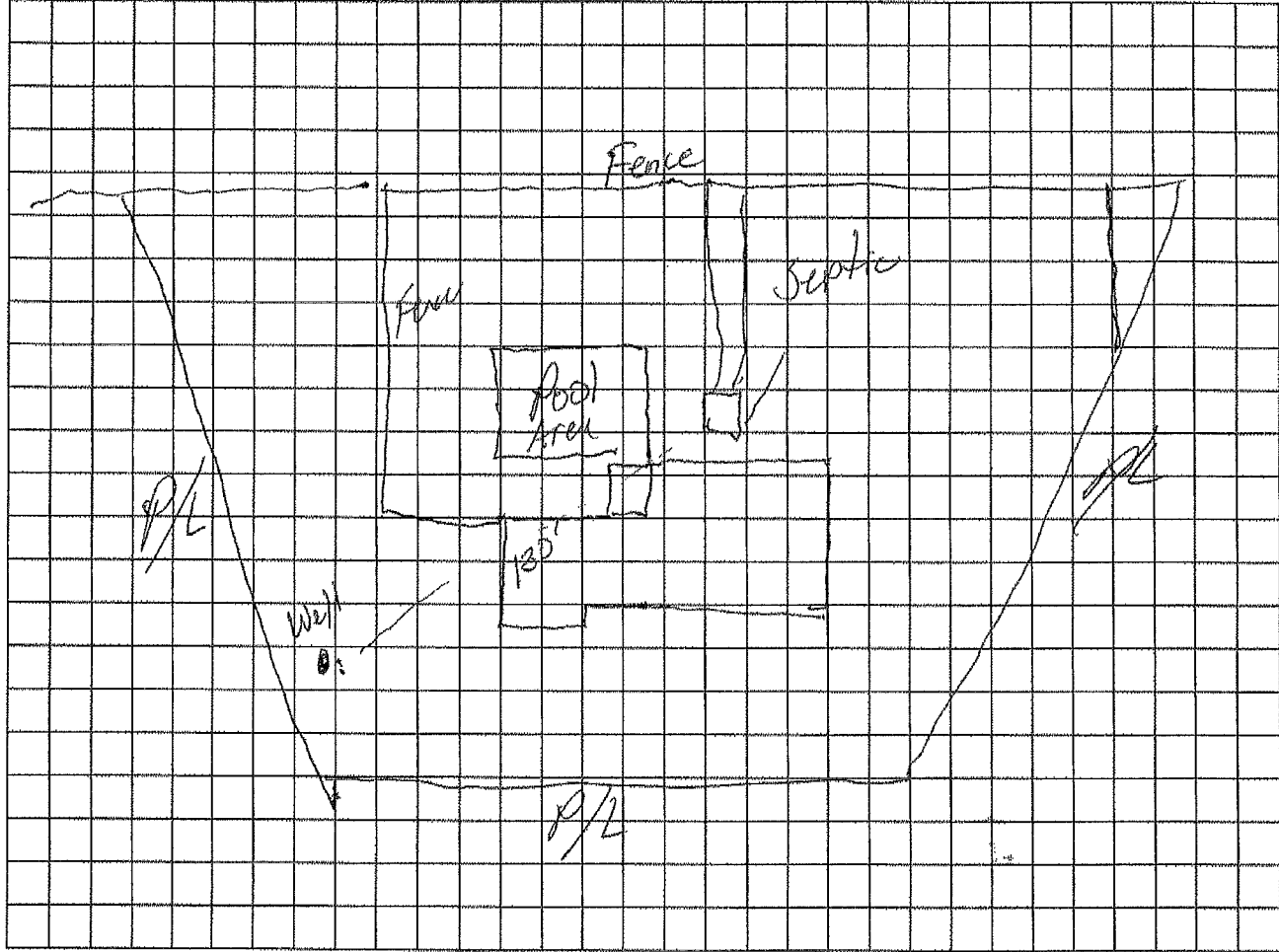

Notes

Site Plan submitted by: Raymond ReiterPlan Approved ✓

Not Approved \_\_\_\_\_

Date 3/31/14By [Signature]C. [Signature]

County Health Department

**ALL CHANGES MUST BE APPROVED BY THE COUNTY HEALTH DEPARTMENT**



STATE OF FLORIDA  
DEPARTMENT OF HEALTH  
ONSITE SEWAGE TREATMENT AND DISPOSAL  
SYSTEM  
APPLICATION FOR CONSTRUCTION PERMIT

PERMIT NO. 14-8897E  
DATE PAID: 2/25/14  
FEE PAID: 200.00  
RECEIPT #: 1186467

## APPLICATION FOR:

[ ] New System [ ☒ ] Existing System [ ] Holding Tank [ ] Innovative  
[ ] Repair [ ] Abandonment [ ] Temporary [ ] Swimming Pool

APPLICANT: Zach & Linda GranoffAGENT: Raymond or Alice (Granoff) TELEPHONE: 386 755 2848MAILING ADDRESS: 9878 S US Hwy 441 Lake City 32025

TO BE COMPLETED BY APPLICANT OR APPLICANT'S AUTHORIZED AGENT. SYSTEMS MUST BE CONSTRUCTED BY A PERSON LICENSED PURSUANT TO 489.105(3)(m) OR 489.552, FLORIDA STATUTES. IT IS THE APPLICANT'S RESPONSIBILITY TO PROVIDE DOCUMENTATION OF THE DATE THE LOT WAS CREATED OR PLATTED (MM/DD/YY) IF REQUESTING CONSIDERATION OF STATUTORY GRANDFATHER PROVISIONS.

## PROPERTY INFORMATION

LOT: 21 BLOCK: \_\_\_\_\_ SUBDIVISION: Cannon Creek Place PLATTED: 1/1/06PROPERTY ID #: 23451603095121 ZONING: \_\_\_\_\_ I/M OR EQUIVALENT: [ Y / N ]PROPERTY SIZE: .8 ACRES WATER SUPPLY: [ ☒ ] PRIVATE PUBLIC [ ]  $\leq 2000$  GPD [ ]  $> 2000$  GPD

IS SEWER AVAILABLE AS PER 381.0065, FS? [ Y / N ] DISTANCE TO SEWER: \_\_\_\_\_ FT

PROPERTY ADDRESS: 194 S.W. Joshua Court Lake City FLDIRECTIONS TO PROPERTY: 90 W - (L) Sisters welcome (L) Kicklighter  
(L) SW Herald Corner (L) SW Joshua Ct #194

## BUILDING INFORMATION

[ ☒ ] RESIDENTIAL [ ] COMMERCIAL

Unit No	Type of Establishment	No. of Bedrooms	Building Area Sqft	Commercial/Institutional System Design Table 1, Chapter 64E-6, FAC
1	<u>Swimming Pool</u>		<u>4275f</u>	
2				
3				
4				

[ ] Floor/Equipment Drains [ ] Other (Specify) \_\_\_\_\_

SIGNATURE: \_\_\_\_\_

DATE: 02/18/14