

All-Thread Shear Wall DETAILS

SCALE: NONE

C

SHEARWALL NOTES:

- ALL SHEARWALLS SHALL BE TYPE 2 SHEARWALLS AS DEFINED BY STD 10-91 BECCI 305.4.3.
- THE WALL SHALL BE ENTIRELY SHEATHED WITH 1/16" O.S.B. INCLUDING AREAS ABOVE AND BELOW OPENINGS.
- ALL SHEATHING SHALL BE ATTACHED TO FRAMING ALONG ALL FOUR EDGES WITH JOINTS FOR ADJACENT PANELS OCCURRING OVER COMMON FRAMING MEMBERS OR ALONG BLOCKING.
- NAIL SPACING SHALL BE 4" O.C. EDGES AND 8" O.C. IN THE FIELD.
- TYPE 2 SHEARWALLS ARE DESIGNED FOR THE OPENING IT CONTAINS. MAXIMUM HEIGHT OF OPENING SHALL BE 5/6 TIMES THE WALL HEIGHT. THE MINIMUM DISTANCE BETWEEN OPENINGS SHALL BE THE WALL HEIGHT/3.5 FOR 8'-0" WALLS (2'-3").

OPENING WIDTH	SILL PLATES	16d TOE NAILS EACH END
UP TO 6'-0"	(1) 2x4 OR (1) 2x6	1
> 6' TO 9'-0"	(3) 2x4 OR (1) 2x6	2
> 9' TO 12'-0"	(5) 2x4 OR (2) 2x6	3

All-Thread Wall Tie-Down PLAN

SCALE: NONE

D

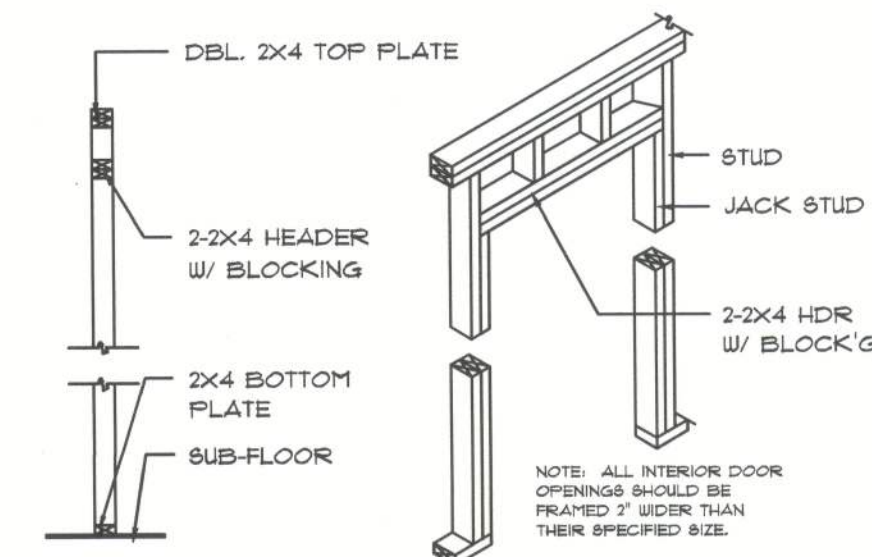
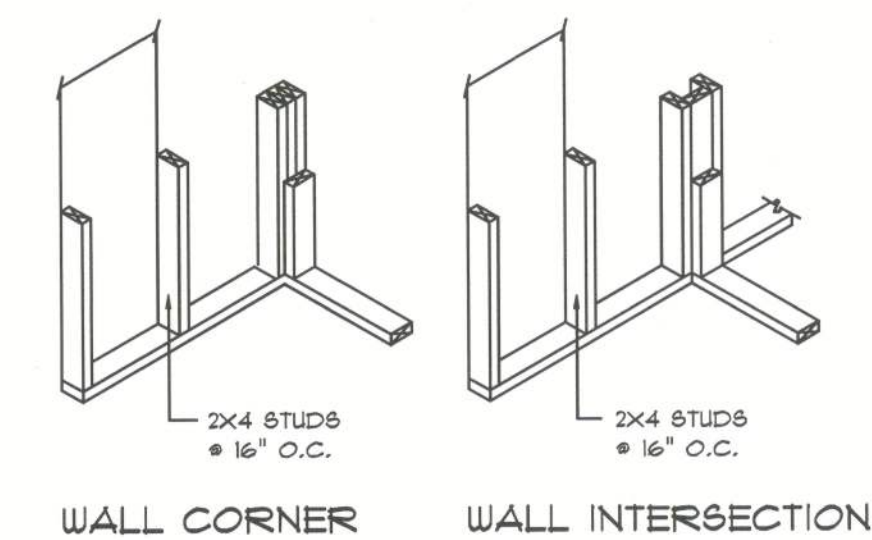

BEARING WALL HEADER

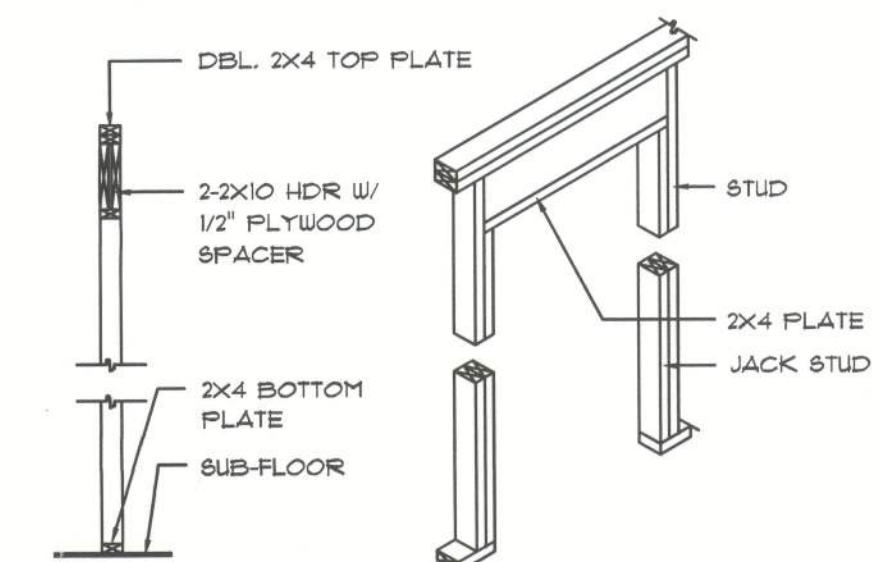

TYPICAL WINDOW HEADER

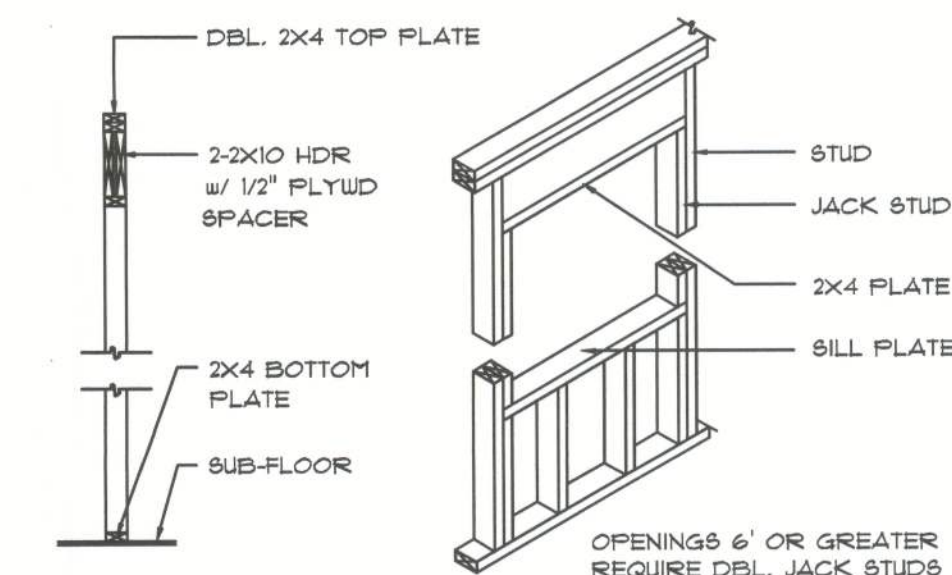

Framing DETAILS

SCALE: 1/4" = 1'-0"

G

EXTERIOR WALL SHEATHING:
APPLY VERTICALLY, "Windstorm" 1/16" OSB 48" X 91", 108", 121" OR 145"
SHEATHING. FASTEN TO THE TOP PLATE AND THE SILL PLATE WITH EITHER
6d COMMON NAILS @ 3" O.C. OR 8d COMMON NAILS @ 4" O.C. FASTEN TO
EACH STUD WITH EITHER 6d COMMON NAILS @ 6" O.C. OR 8d COMMON
NAILS @ 8" O.C.

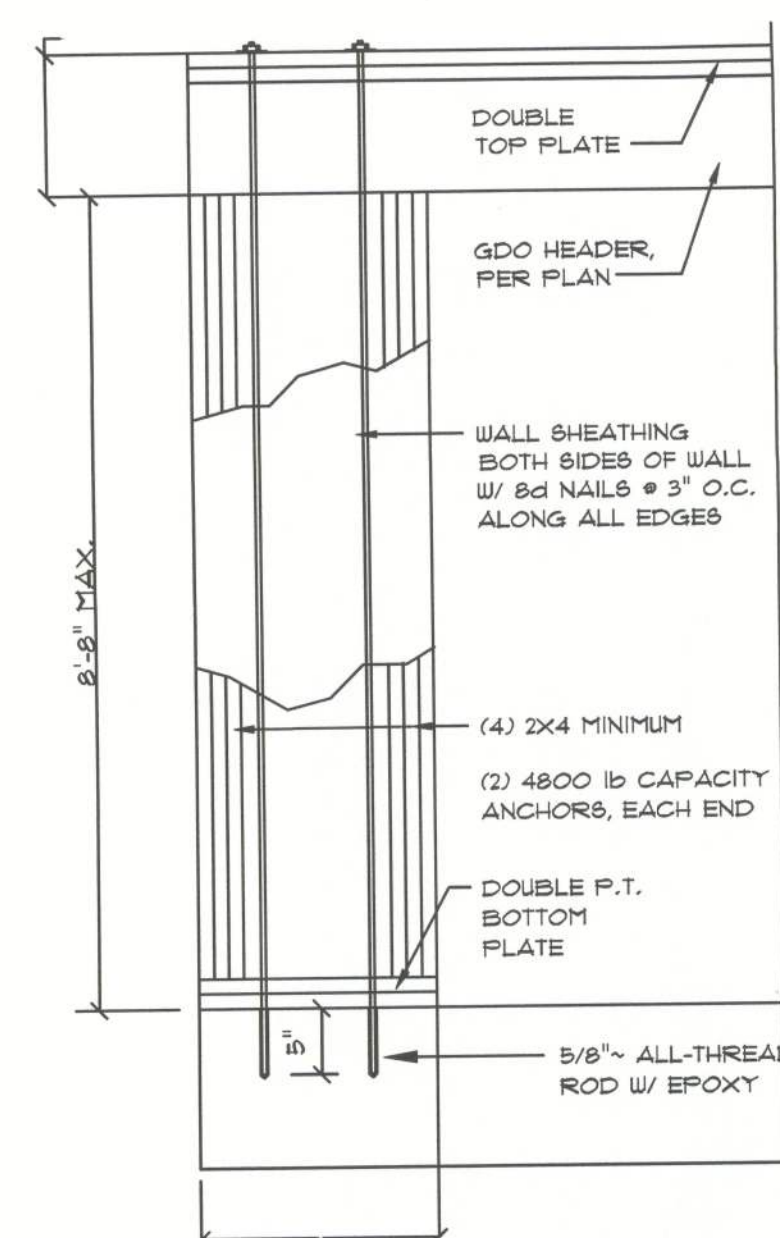

Garage End Wall DETAILS

SCALE: 1/2" = 1'-0"

E

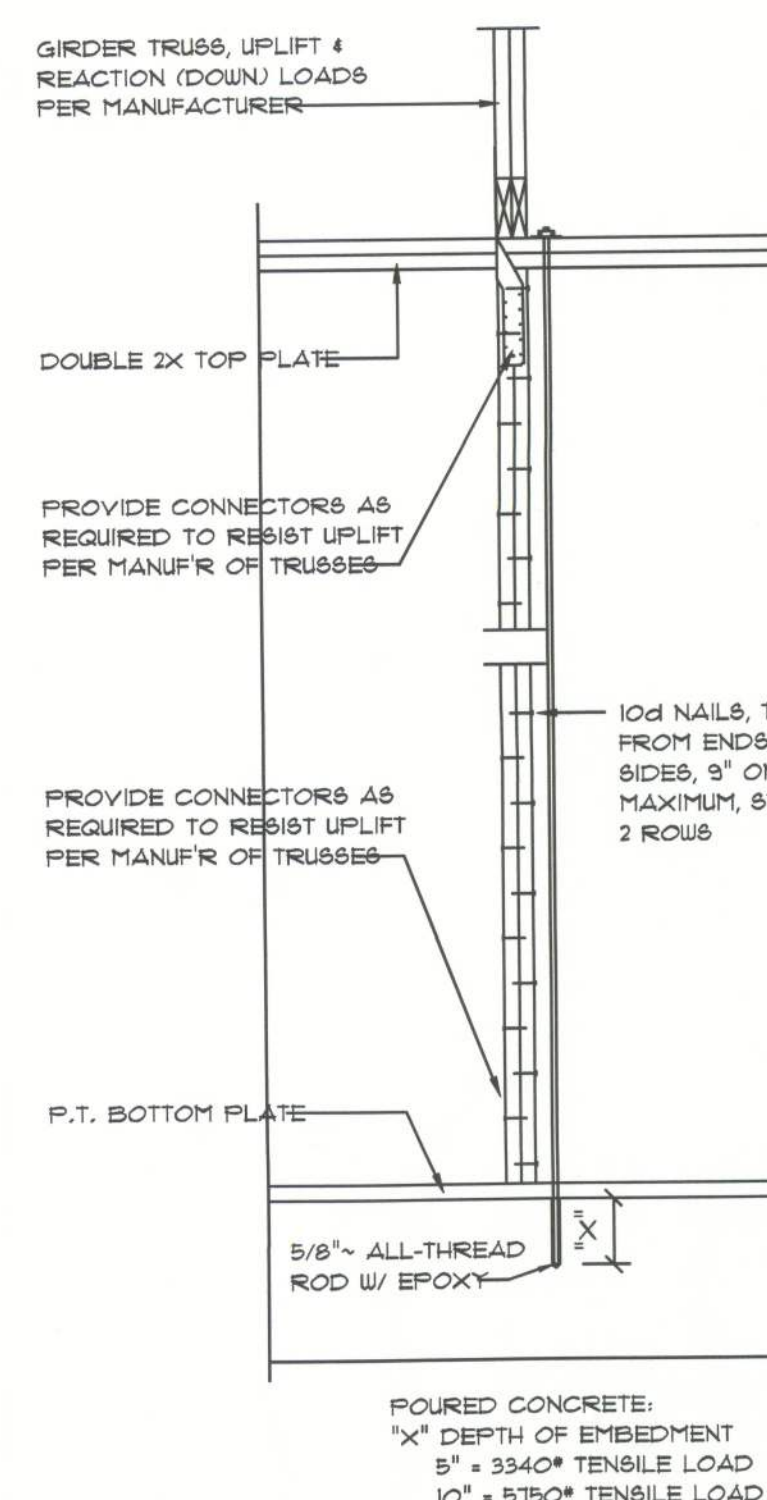

Girder Truss Column DET.

SCALE: 1/2" = 1'-0"

F

CONSTRUCTION NOTES

- FIELD VERIFY ALL DIMENSIONS AND MATERIALS. ALL OUTSIDE DIMENSIONS ARE TO FACE OF STEELWALL.
- ALL NAILING CONSTRUCTION MATERIALS SHALL BE AS PER 2004 FBC - SEE SD.1
- PROVIDE EXTERIOR COMBUSTION AIR TO GAS FIRED H.V.A.C. EQUIPMENT, WOOD BURNING STOVES, AND FIREPLACES.
- VENT CLOTHES DRYER, BATH, AND COOKING FANS TO EXTERIOR AS REQUIRED.
- CONTRACTOR SHALL CALL ATTENTION TO THE DESIGNER ANY DISCREPANCIES IN DRAWINGS AND/OR SPECIFICATIONS AND SHALL RECEIVE INSTRUCTIONS OR CLARIFICATIONS BEFORE PROCEEDING WITH THE PORTION OF THE WORK IN QUESTION.
- ROOF & FLOOR TRUSS FRAMING PLANS ARE FOR GENERAL INFORMATION ONLY. THE TRUSS MANUFACTURER SHALL PROVIDE A DETAILED LAYOUT FOR TRUSS AND FRAMING MEMBERS.
- SHOULD CONDITIONS AT THE SITE BE FOUND MATERIALLY DIFFERENT FROM THOSE INDICATED BY THE DRAWINGS AND/OR SPECIFICATIONS, AND THE CONDITIONS USUALLY INHERENT IN THE WORK OF THE CHARACTER SHOWN AND SPECIFIED BE DIFFERENT FROM THE DESIGNER'S RECOMMENDED BUILDING PROCEDURES, CALL IMMEDIATE ATTENTION TO SUCH CONDITIONS BEFORE PROCEEDING.
- LP GAS-BURNING APPLIANCES ARE NOT PERMITTED IN BASEMENTS OR CRAWLSPACES.
- DO NOT SCALE DRAWINGS. USE PRINTED DIMENSIONS ONLY.

HEADER SPANS FOR EXTERIOR BEARING WALLS

HEADERS SUPPORTING:	HEADER SIZE	BUILDING WIDTH (FT)					
		20'		28'		36'	
ROOF, CEILING	2-2x4	3'-6"	1	3'-2"	1	2'-10"	1
	2-2x6	5'-5"	1	4'-8"	1	4'-2"	1
	2-2x8	6'-10"	1	5'-11"	2	5'-4"	1
	2-2x10	8'-5"	2	7'-3"	2	6'-6"	2
	2-2x12	9'-9"	2	8'-5"	2	7'-6"	2
	3-2x8	8'-4"	1	7'-5"	1	6'-8"	1
	3-2x10	10'-6"	1	9'-1"	2	8'-2"	1
	3-2x12	12'-2"	2	10'-1"	2	9'-5"	2
	4-2x8	9'-2"	1	8'-4"	1	8'-2"	1
	4-2x10	11'-8"	1	10'-6"	1	9'-5"	1
	4-2x12	14'-1"	1	12'-2"	2	10'-11"	1

REVISIONS

NO.	DESCRIPTION	DATE

SOFTPLAN
ARCHITECTURAL DESIGN SOFTWARE

NICHOLAS
FALL
GEBLER
ARCHITECT
1738 NW 17th Ave
33607-2225
305.725.1022

CASTANGA
CONSTRUCTION

WILLIAM
HUBBARD RES.

ADDRESS:
PEACOCK ROAD
COLUMBIA COUNTY

PRINTED DATE: March 30, 2010
FINALS DATE: 03 / Mar / 10

DRAWN BY: JFB
CHECKED BY: JFB

DESIGNED BY: CASTANGA CONST.

JOHN F BENZ
DRAFTING SERVICE
386-266-0746

JOB NUMBER:
031010

DRAWING NUMBER

S1 -
FRAMING DETAILS

OF 3 SHEETS