

REVISIONS

SOFTPLAN
ARCHITECTURAL DESIGN SOFTWARE

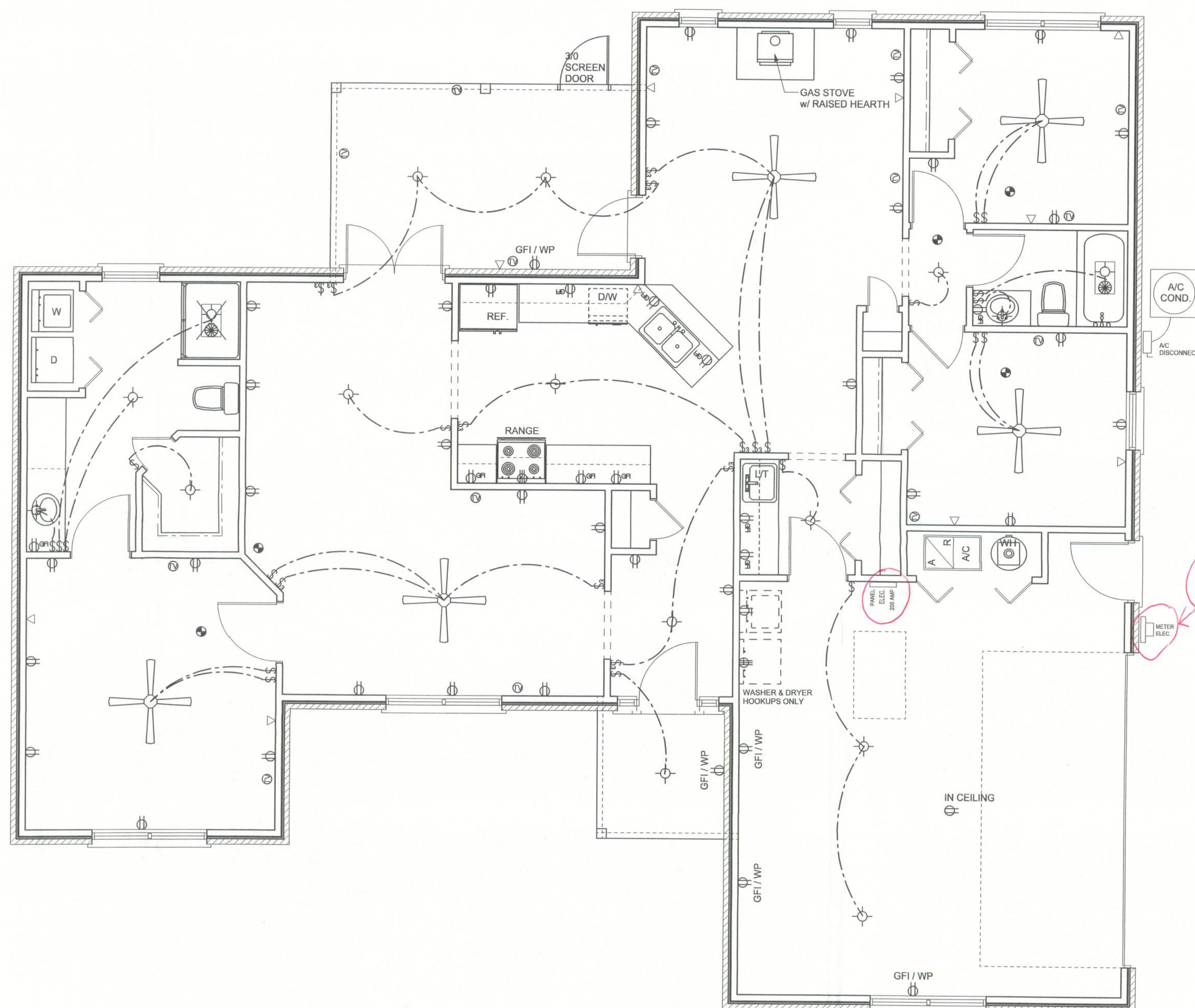

ELECTRICAL PLAN NOTES

- E -1 WIRE ALL APPLIANCES, HVAC UNITS AND OTHER EQUIPMENT PER MANUF. SPECIFICATIONS.
- E -2 CONSULT THE OWNER FOR THE NUMBER OF SEPERATE TELEPHONE LINES TO BE INSTALLED.
- E -3 ALL INSTALLATIONS SHALL BE PER NAT'L. ELECTRIC CODE.
- E -4 ALL SMOKE DETECTORS SHALL BE 120V W/ BATTERY BACKUP OF THE PHOTOELECTRIC TYPE, AND SHALL BE INTERLOCKED TOGETHER. INSTALL INSIDE AND NEAR ALL BEDROOMS.
- E -5 TELEPHONE, TELEVISION AND OTHER LOW VOLTAGE DEVICES OR OUTLETS SHALL BE AS PER THE OWNER'S DIRECTIONS, & IN ACCORDANCE W/ APPLICABLE SECTIONS OF NEC-LATEST EDITION.
- E -6 ELECTRICAL CONTR SHALL BE RESPONSIBLE FOR THE DESIGN & SIZING OF ELECTRICAL SERVICE AND CIRCUITS.
- E -7 ENTRY OF SERVICE (UNDERGROUND OR OVERHEAD) TO BE DETERMINED BY POWER COMPANY.
- E -8 ALL BEDROOM RECEPTACLES SHALL BE AFCI (ARC FAULT CIRCUIT INTERRUPT)
- E -9 ALL OUTLETS TO BE LOCATED ABOVE BASE FLOOD ELEVATION

ELECTRICAL LEGEND

	CEILING FAN (PRE-WIRE FOR LIGHT KIT)
	DOUBLE SECURITY LIGHT
	2X4 FLUORESCENT LIGHT FIXTURE
	RECESSED CAN LIGHT
	BATH EXHAUST FAN WITH LIGHT
	BATH EXHAUST FAN
	LIGHT FIXTURE
	DUPLEX OUTLET
	220v OUTLET
	GFI DUPLEX OUTLET
	SMOKE DETECTOR
	WALL SWITCH
	3 WAY WALL SWITCH
	4 WAY WALL SWITCH
	WATER PROOF GFI OUTLET
	PHONE JACK
	TELEVISION JACK
	GARAGE DOOR OPENER
	WALL HEATER

ELECTRICAL PLAN

SCALE: 1/4" = 1'-0"

WINDLOAD ENGINEER: Mark Disosway,
PE No. 53915, POB 868, Lake City, FL
32056, 386-754-5419

DIMENSIONS:
Stated dimensions supersede scaled dimensions. Refer all questions to Mark Disosway, P.E. for resolution. Do not proceed without clarification.

COPYRIGHTS AND PROPERTY RIGHTS:
Mark Disosway, P.E. hereby expressly reserves its common law copyrights and property right in these instruments of service. This document is not to be reproduced, altered or copied in any form or manner without first the express written permission and consent of Mark Disosway.

CERTIFICATION: These plans and "Windload Engineering", Sheet S-1, attached, comply with Florida Building Code 2001, Section 1606 wind loads, to the best of my knowledge.

LIMITATION: This design is valid for one building at specified location. In case of conflict, structural requirements, scope of work, and builder responsibilities on sheet S-1 control.

MARK DISOSWAY
P.E. 53915

Mark Disosway
SEAL

EDGLEY
CONSTRUCTION, INC.

INLOW
RESIDENCE

ADDRESS:
Columbia County, Florida

Mark Disosway P.E.
P.O. Box 868
Lake City, Florida 32056
Phone: (386) 754 - 5419
Fax: (386) 754 - 6749
Email: mdpe@bellsouth.net

PRINTED DATE:
November 24, 2004

DRAWN BY: David Disosway

CHECKED BY:
David Disosway

DESIGNED BY:
David Disosway

FINALS DATE:
24 / Nov / 04

JOB NUMBER:
408095

DRAWING NUMBER
A-3

OF 5 SHEETS