

FLORIDA BUILDING CODE R4501

THE POOL CONTRACTOR IS RESPONSIBLE FOR FURNISHING ALL DETAIL DESIGN REQUIREMENTS FOR EACH INDIVIDUAL POOL IN ACCORDANCE WITH THE FLORIDA BUILDING CODE, AND ALL CONSTRUCTION SHALL MEET ALL APPLICABLE CODES INCLUDING PLUMBING, ELECTRICAL AND GAS. PIPING SHALL BE SCH. 40 PVC, NSFPAW, MAX. PRESSURE VELOCITY 10 FPS, SUCTION 6 FPS. THE POOL PLANS SHALL SHOW THE DESIGN PLUMBING AS PER THE SAMPLE WITH THE INFORMATION REQUIRED SHOWN. MAIN DRAIN PLUMBING SHALL BE TWO DRAINS SEPARATED BY 3' WITH APPROVED ANS/ASME A112.19.8 2009 COVERS. AS AN ALTERNATE THE APPROVED DRAINS MAY BE PLACED ON DIFFERENT PLANES. THE TWO DRAINS SHALL HAVE A COMMON SUCTION LINE. SUCTION GRATES MAY BE USED IF APPROVED AT A MAXIMUM OF 1 1/2\"/>

SPECIAL SPA REQUIREMENTS:

- MAXIMUM WATER DEPTH 4'. MAXIMUM SEAT DEPTH 28" MAX.
- FLOOR SLOPE 1:12
- RISER EXCEPT THE BOTTOM STEP MAY BE 14" IF IT IS BE UNIFORM. IF THE SPA IS OPERATED INTERMITTENTLY IT SHALL HAVE A ONE HOUR TURNOVER. IF CONTINUOUS A SIX HOUR TURNOVER.
- MAXIMUM TEMPERATURE 104 DEGREES.
- MEET ANS/NSP ARTICLE XVII, SAFETY INSTRUCTIONS/SAFETY SIGNS.
- PRESSURE TEST PIPING AT 35 PSI FOR 15 MINUTES OR MEET LOCAL CODE IF GREATER.

GENERAL DESIGN REQUIREMENTS

- DESIGN, CONSTRUCTION AND WORKMANSHIP SHALL BE IN CONFORMANCE WITH THE REQUIREMENTS OF APS/ICC 3, APS/ICC 4, APS/ICC 5, AND APS/ICC 6 AND APS/ICC 7 BASED ON THE POOL TYPE.
- SEE NSPI FOR DIVING WATER ENVELOPES.
- SLIDES SHALL MEET THE MANUFACTURER'S INSTALLATION REQUIREMENTS.
- ALL POOLS WHETHER PUBLIC OR PRIVATE SHALL BE PROVIDED WITH A LADDER OR STEPS IN THE SHALLOW END WHERE THE WATER DEPTH EXCEEDS 24 INCHES (610 MM). IN PRIVATE POOLS WHERE WATER DEPTH EXCEEDS 5 FEET (1524 MM) THERE SHALL BE LADDERS, STAIRS OR UNDERWATER BENCHES. SWIM-OUTS IN THE DEEP END WHERE MANUFACTURED DIVING EQUIPMENT IS TO BE USED, BENCHES OR SWIM-OUTS SHALL BE RECESSED OR LOCATED IN A CORNER.
- CIRCULATION SYSTEMS, COMPONENTS AND EQUIPMENT SHALL COMPLY WITH NSF 50.
- THE MAXIMUM TURNOVER RATE IS 12 HOURS.
- FILTERS SHALL HAVE AN AIR RELEASE AND PRESSURE GAGE.
- PUMPS 3 HP AND LESS SHALL MEET ANS/DUL1081 CORROSION RESISTANT WITH STRAINER AND MEET THE REQUIRED FLOW.
- SURE AGE SKIMMERS SHALL MEET NSF 50 AND THERE SHALL BE ONE FOR EVERY 800 SQUARE FEET OF SURFACE AREA.
- APPROVED MANUFACTURED INLET FITTINGS FOR THE RETURN OF RECIRCULATED POOL WATER SHALL BE PROVIDED ON THE BASIS OF AT LEAST ONE PER 300 SQUARE FEET (28 m2) OF SURFACE AREA. SUCH INLET FITTINGS SHALL BE DESIGNED AND CONSTRUCTED TO INSURE AN ADEQUATE SEAL TO THE POOL STRUCTURE AND SHALL INCORPORATE A CONVENIENT MEANS OF SEALING FOR PRESSURE TESTING OF THE POOL.
- CIRCULATION PIPING, WHEN MORE THAN ONE INLET IS REQUIRED, THE SHORTEST DISTANCE BETWEEN ANY TWO REQUIRED INLETS SHALL BE AT LEAST 10 FEET (3048 MM).
- HEATER SHALL MEET ANS/221.56 OR UL 1261 OR UL 559.
- DISINFECTANT EQUIPMENT SHALL COMPLY WITH NSF 50.
- PRESSURE TEST PIPING AT 35 PSI FOR 15 MINUTES OR MEET LOCAL CODE IF GREATER.
- RESIDENTIAL SWIMMING BARRIER REQUIREMENTS TO MEET SECTIONS 454.2.17
- WASTE DISPOSAL TO COMPLY WITH SECTION 454.2.10

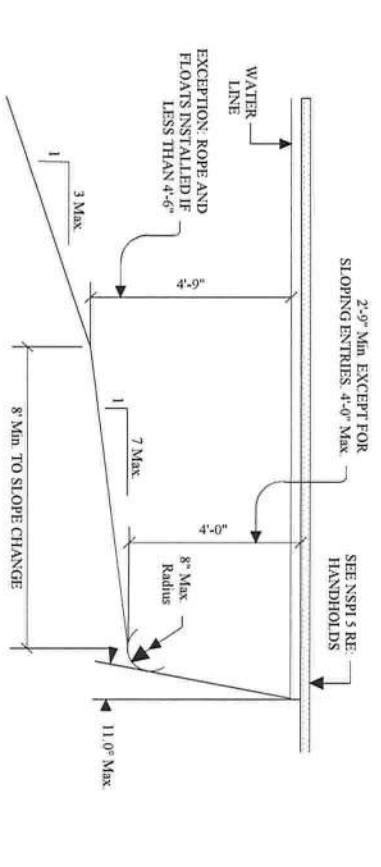

ELECTRICAL REQUIREMENTS:

- WIRING AND BONDING AND ALL ELECTRICAL TO COMPLY WITH CHAPTER 42, FLORIDA BUILDING CODE 7TH EDITION-RESIDENTIAL AND NEC 2017
- NO OUTLET OR OVERHEAD POWER WITHIN 10' IF WITHIN 15' PROTECT BY GFI, TRANSFORMER MIN. 10' FROM POOL, 8" ABOVE WATER, 1 BOX 4' FROM POOL, BRASS TO 1 BOX OR TRANSFORMER WHICH EVER IS FIRST EXCEPT WHERE PVC IS APPROVED.

GENERAL DESIGN REQUIREMENTS

- DESIGN, CONSTRUCTION AND WORKMANSHIP SHALL BE IN CONFORMANCE WITH THE REQUIREMENTS OF APS/ICC 3, APS/ICC 4, APS/ICC 5, AND APS/ICC 6 AND APS/ICC 7 BASED ON THE POOL TYPE.
- SEE NSPI FOR DIVING WATER ENVELOPES.
- SLIDES SHALL MEET THE MANUFACTURER'S INSTALLATION REQUIREMENTS.
- ALL POOLS WHETHER PUBLIC OR PRIVATE SHALL BE PROVIDED WITH A LADDER OR STEPS IN THE SHALLOW END WHERE THE WATER DEPTH EXCEEDS 24 INCHES (610 MM). IN PRIVATE POOLS WHERE WATER DEPTH EXCEEDS 5 FEET (1524 MM) THERE SHALL BE LADDERS, STAIRS OR UNDERWATER BENCHES. SWIM-OUTS IN THE DEEP END WHERE MANUFACTURED DIVING EQUIPMENT IS TO BE USED, BENCHES OR SWIM-OUTS SHALL BE RECESSED OR LOCATED IN A CORNER.
- CIRCULATION SYSTEMS, COMPONENTS AND EQUIPMENT SHALL COMPLY WITH NSF 50.
- THE MAXIMUM TURNOVER RATE IS 12 HOURS.
- FILTERS SHALL HAVE AN AIR RELEASE AND PRESSURE GAGE.
- PUMPS 3 HP AND LESS SHALL MEET ANS/DUL1081 CORROSION RESISTANT WITH STRAINER AND MEET THE REQUIRED FLOW.
- SURE AGE SKIMMERS SHALL MEET NSF 50 AND THERE SHALL BE ONE FOR EVERY 800 SQUARE FEET OF SURFACE AREA.
- APPROVED MANUFACTURED INLET FITTINGS FOR THE RETURN OF RECIRCULATED POOL WATER SHALL BE PROVIDED ON THE BASIS OF AT LEAST ONE PER 300 SQUARE FEET (28 m2) OF SURFACE AREA. SUCH INLET FITTINGS SHALL BE DESIGNED AND CONSTRUCTED TO INSURE AN ADEQUATE SEAL TO THE POOL STRUCTURE AND SHALL INCORPORATE A CONVENIENT MEANS OF SEALING FOR PRESSURE TESTING OF THE POOL.
- CIRCULATION PIPING, WHEN MORE THAN ONE INLET IS REQUIRED, THE SHORTEST DISTANCE BETWEEN ANY TWO REQUIRED INLETS SHALL BE AT LEAST 10 FEET (3048 MM).
- HEATER SHALL MEET ANS/221.56 OR UL 1261 OR UL 559.
- DISINFECTANT EQUIPMENT SHALL COMPLY WITH NSF 50.
- PRESSURE TEST PIPING AT 35 PSI FOR 15 MINUTES OR MEET LOCAL CODE IF GREATER.
- RESIDENTIAL SWIMMING BARRIER REQUIREMENTS TO MEET SECTIONS 454.2.17
- WASTE DISPOSAL TO COMPLY WITH SECTION 454.2.10

GENERAL DESIGN REQUIREMENTS

- DESIGN, CONSTRUCTION AND WORKMANSHIP SHALL BE IN CONFORMANCE WITH THE REQUIREMENTS OF APS/ICC 3, APS/ICC 4, APS/ICC 5, AND APS/ICC 6 AND APS/ICC 7 BASED ON THE POOL TYPE.
- SEE NSPI FOR DIVING WATER ENVELOPES.
- SLIDES SHALL MEET THE MANUFACTURER'S INSTALLATION REQUIREMENTS.
- ALL POOLS WHETHER PUBLIC OR PRIVATE SHALL BE PROVIDED WITH A LADDER OR STEPS IN THE SHALLOW END WHERE THE WATER DEPTH EXCEEDS 24 INCHES (610 MM). IN PRIVATE POOLS WHERE WATER DEPTH EXCEEDS 5 FEET (1524 MM) THERE SHALL BE LADDERS, STAIRS OR UNDERWATER BENCHES. SWIM-OUTS IN THE DEEP END WHERE MANUFACTURED DIVING EQUIPMENT IS TO BE USED, BENCHES OR SWIM-OUTS SHALL BE RECESSED OR LOCATED IN A CORNER.
- CIRCULATION SYSTEMS, COMPONENTS AND EQUIPMENT SHALL COMPLY WITH NSF 50.
- THE MAXIMUM TURNOVER RATE IS 12 HOURS.
- FILTERS SHALL HAVE AN AIR RELEASE AND PRESSURE GAGE.
- PUMPS 3 HP AND LESS SHALL MEET ANS/DUL1081 CORROSION RESISTANT WITH STRAINER AND MEET THE REQUIRED FLOW.
- SURE AGE SKIMMERS SHALL MEET NSF 50 AND THERE SHALL BE ONE FOR EVERY 800 SQUARE FEET OF SURFACE AREA.
- APPROVED MANUFACTURED INLET FITTINGS FOR THE RETURN OF RECIRCULATED POOL WATER SHALL BE PROVIDED ON THE BASIS OF AT LEAST ONE PER 300 SQUARE FEET (28 m2) OF SURFACE AREA. SUCH INLET FITTINGS SHALL BE DESIGNED AND CONSTRUCTED TO INSURE AN ADEQUATE SEAL TO THE POOL STRUCTURE AND SHALL INCORPORATE A CONVENIENT MEANS OF SEALING FOR PRESSURE TESTING OF THE POOL.
- CIRCULATION PIPING, WHEN MORE THAN ONE INLET IS REQUIRED, THE SHORTEST DISTANCE BETWEEN ANY TWO REQUIRED INLETS SHALL BE AT LEAST 10 FEET (3048 MM).
- HEATER SHALL MEET ANS/221.56 OR UL 1261 OR UL 559.
- DISINFECTANT EQUIPMENT SHALL COMPLY WITH NSF 50.
- PRESSURE TEST PIPING AT 35 PSI FOR 15 MINUTES OR MEET LOCAL CODE IF GREATER.
- RESIDENTIAL SWIMMING BARRIER REQUIREMENTS TO MEET SECTIONS 454.2.17
- WASTE DISPOSAL TO COMPLY WITH SECTION 454.2.10

POOL SECTION DETAIL

N.T.S.

SB836, 6-20-07

FOR BONDING AND GROUNDING SYSTEMS FOR SWIMMING POOLS, THE USE OF AN UNDERGROUND BONDING CONDUCTOR MADE OF #8 AWG. BARE SOLID COPPER WIRE BURIED TO A MINIMUM DEPTH OF 4 INCHES TO 6 INCHES BELOW SUBGRADE, AND 18 TO 24 INCHES FROM INSIDE WALL OF A SWIMMING POOL OR SPA, IS DEEMED A PERMISSIBLE ALTERNATIVE OR EQUIVALENT TO COMPLIANCE WITH S. 680.26(c) OF THE NATIONAL ELECTRICAL CODE.

Determine System Flow Rate:
Minimum Flow Rate Required: 35gpm per skimmer (Required: 1 Skimmer per 800 sq)

Pool Volume: $\frac{500}{\text{sq ft} \times \frac{4}{\text{ave depth} \times 7.481 \text{ gal/cf}}} = \frac{15,000}{\text{gallons}}$

Turnover Time in Hours: $\frac{6}{\text{hours} \times 60 \text{ min/hr}} = \frac{360}{\text{minutes}}$

Flow Rate: $\frac{15,000}{\text{gallons}} / \frac{360}{\text{minutes}} = \frac{42}{\text{gpm}}$

PIPE	SUCTION	PRESSURE
1 1/2"	35 GPM	65 GPM
2"	60	105
2 1/2"	90	147
3"	135	230
4"	235	396

FOR POOLS WITH VOLUME = 15,000 GALS
PUMP: STARTE PRE60L OR HAYWARD SUPERII
1/2 HP 42 GPM 60' TURN

TURNOVER RATE = 6 HOURS = 360 MINS

FILTER: STARTE PTM 50, 50 GPM OR HAYWARD C751, 75 GPM CAPACITY

MAIN DRAIN: HAYWARD W61048E

CLEANER: HAYWARD VAC LOC

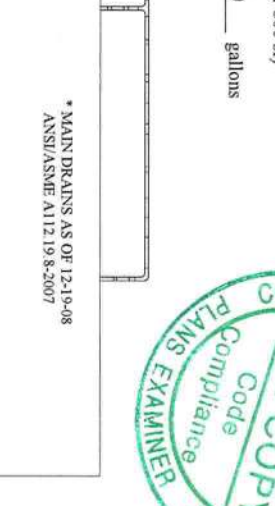

PIPE SIZING CHART (MAXIMUM)

PIPE	SUCTION	PRESSURE
1 1/2"	35 GPM	65 GPM
2"	60	105
2 1/2"	90	147
3"	135	230
4"	235	396

FOR POOLS WITH VOLUME = 15,000 GALS
PUMP: STARTE PRE60L OR HAYWARD SUPERII
1/2 HP 42 GPM 60' TURN

TURNOVER RATE = 6 HOURS = 360 MINS

FILTER: STARTE PTM 50, 50 GPM OR HAYWARD C751, 75 GPM CAPACITY

MAIN DRAIN: HAYWARD W61048E

CLEANER: HAYWARD VAC LOC

POOL/SPA, DECK, BEAM, WALL, FLOOR

N.T.S.

PAVERS OR 4" DECK 3,000 psi (Min) CONC. W/ #3 BAR, 30" O.C.

DECK FINISH PER CONTRACT (NON-SLIP)

BEAM & 7" BAR OPTIONAL

POOL FINISH PER CONTRACT

FINISH 3/4" MARCITE OR EXPOSED AGGREGATE

6" Min. WALL & FLOOR THICKNESS 3,000 psi (Min) CONC. #3 BARS ON 12" CENTERS EITHER WAY. THE ALT INTERSECTIONS 15" MIN. OVERLAP. 2" MIN. COVERAGE ON STEEL W/CONC. TO ASTM A15, A16, ASTM A30-5.

Structural subject to suitable soil conditions.

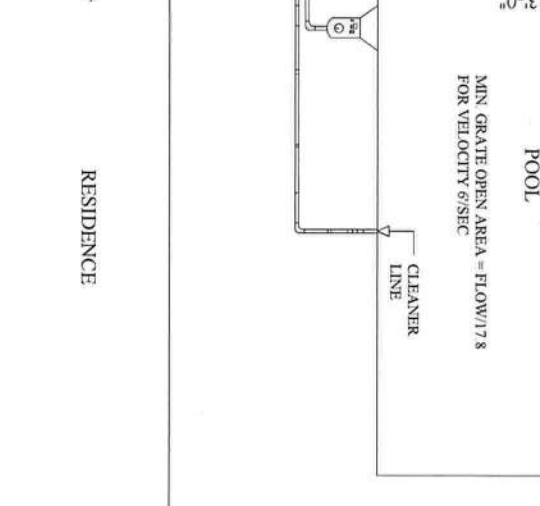
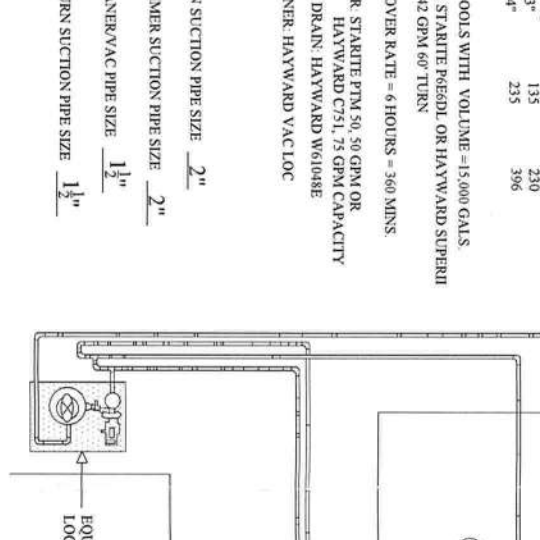
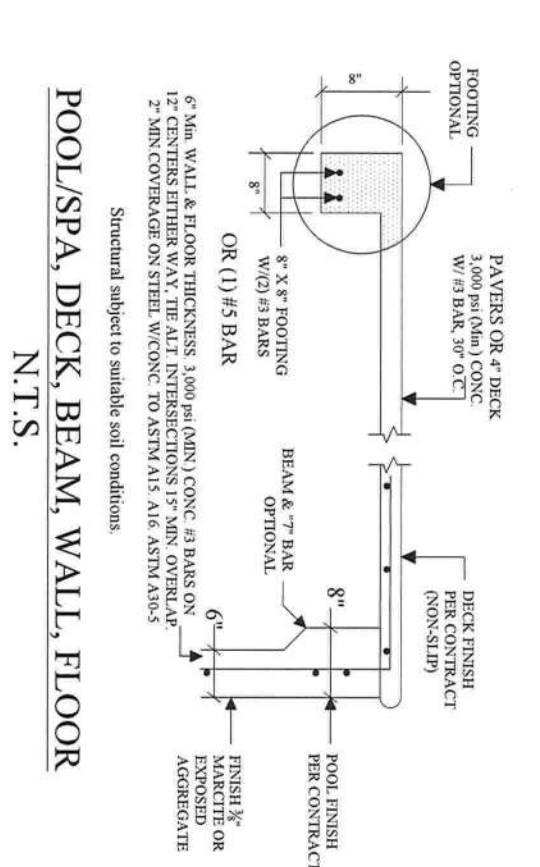

POOL/SPA, DECK, BEAM, WALL, FLOOR

N.T.S.

PAVERS OR 4" DECK 3,000 psi (Min) CONC. W/ #3 BAR, 30" O.C.

DECK FINISH PER CONTRACT (NON-SLIP)

BEAM & 7" BAR OPTIONAL

POOL FINISH PER CONTRACT

FINISH 3/4" MARCITE OR EXPOSED AGGREGATE

6" Min. WALL & FLOOR THICKNESS 3,000 psi (Min) CONC. #3 BARS ON 12" CENTERS EITHER WAY. THE ALT INTERSECTIONS 15" MIN. OVERLAP. 2" MIN. COVERAGE ON STEEL W/CONC. TO ASTM A15, A16, ASTM A30-5.

Structural subject to suitable soil conditions.

POOL/SPA, DECK, BEAM, WALL, FLOOR

N.T.S.

PAVERS OR 4" DECK 3,000 psi (Min) CONC. W/ #3 BAR, 30" O.C.

DECK FINISH PER CONTRACT (NON-SLIP)

BEAM & 7" BAR OPTIONAL

POOL FINISH PER CONTRACT

FINISH 3/4" MARCITE OR EXPOSED AGGREGATE

6" Min. WALL & FLOOR THICKNESS 3,000 psi (Min) CONC. #3 BARS ON 12" CENTERS EITHER WAY. THE ALT INTERSECTIONS 15" MIN. OVERLAP. 2" MIN. COVERAGE ON STEEL W/CONC. TO ASTM A15, A16, ASTM A30-5.

Structural subject to suitable soil conditions.