

Columbia County Property Appraiser

Jeff Hampton

2023 Working Values

updated: 12/15/2022

Retrieve Tax Record

2022 TRIM (pdf)

Property Card

Parcel List Generator

Show on GIS Map

Print

Parcel: << 13-3S-16-02097-000 (6878) >>

Aerial Viewer Pictometry Google Maps

Owner & Property Info

<< Result: 2 of 3 >>

Owner	HILL & SMITH INC 987 BUCKEYE PARK RD COLUMBIS, OH 43207		
Site	2118 NW COUNTY ROAD 25A, LAKE CITY 2120 NW COUNTY ROAD 25A		
Description*	COMM NE COR SEC, RUN S 1848.68 FT TO SW'RLY R/W LINE CR-25A FOR POB, RUN SE ALONG R/W 1057.92 FT TO S LINE OF NW1/4 OF SEC 18-3S-17E, W 709.27 FT TO SW COR OF NW1/4, CONT W ALONG S LINE OF NE1/4 SEC 13, 697.68 FT TO NE'RLY R/W GS & F RR, RUN N 32 DG W ALON ...more>>		
Area	20.83 AC	S/T/R	13-3S-16
Use Code**	LIGHT MANUFACTURE (4100)	Tax District	3

*The Description above is not to be used as the Legal Description for this parcel in any legal transaction.

**The Use Code is a FL Dept. of Revenue (DOR) code and is not maintained by the Property Appraiser's office. Please contact your city or county Planning & Zoning office for specific zoning information.

Property & Assessment Values

2022 Certified Values		2023 Working Values	
Mkt Land	\$132,455	Mkt Land	\$132,455
Ag Land	\$0	Ag Land	\$0
Building	\$351,141	Building	\$351,141
XFOB	\$30,120	XFOB	\$30,120
Just	\$513,716	Just	\$513,716
Class	\$0	Class	\$0
Appraised	\$513,716	Appraised	\$513,716
SOH Cap [?]	\$3,651	SOH Cap [?]	\$0
Assessed	\$513,716	Assessed	\$513,716
Exempt	\$0	Exempt	\$0
Total Taxable	county:\$510,065 city:\$0 other:\$0 school:\$513,716	Total Taxable	county:\$513,716 city:\$0 other:\$0 school:\$513,716

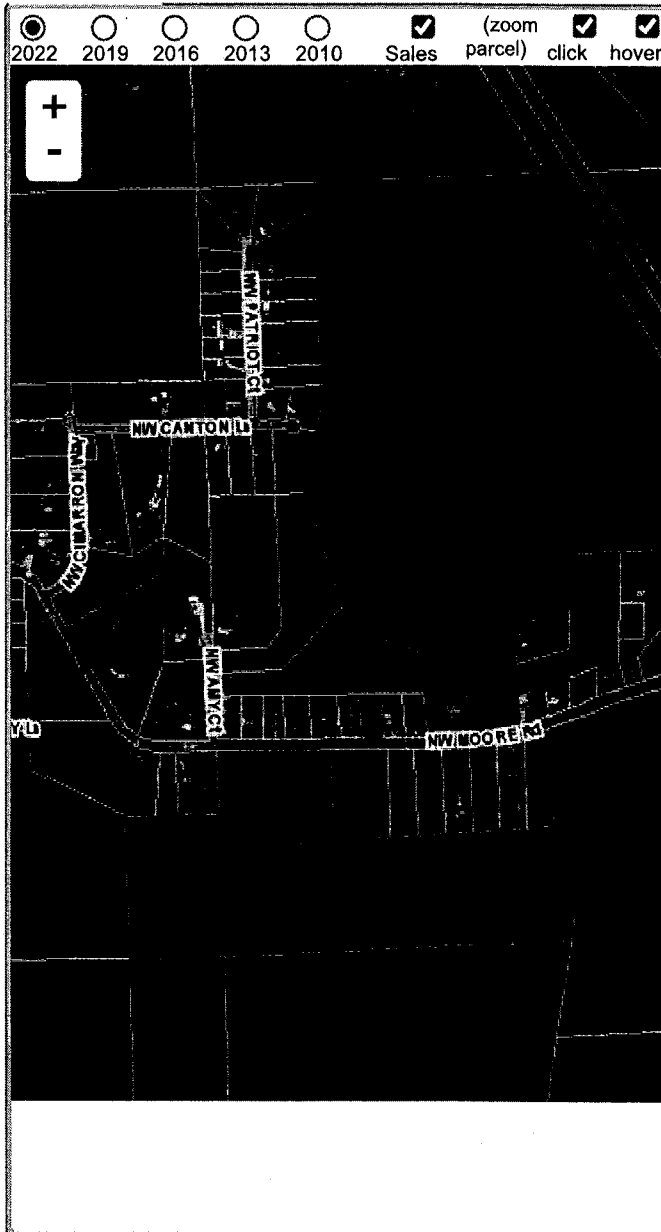

Sales History

Show Similar Sales within 1/2 mile

Fill out Sales Questionnaire

Sale Date	Sale Price	Book/Page	Deed	V/I	Qualification (Codes)	RCode
5/2/2018	\$1,050,000	1359/1352	WD	I	U	30
6/29/2016	\$1,050,000	1318/1107	WD	I	U	30
3/26/2010	\$460,000	1191/1967	TR	I	U	19

Building Characteristics

Bldg Sketch	Description*	Year Blt	Base SF	Actual SF	Bldg Value
Sketch	MANUF LGHT (8000)	1974	27400	28632	\$351,141

*Bldg Desc determinations are used by the Property Appraisers office solely for the purpose of determining a property's Just Value for ad valorem tax purposes and should not be used for any other purpose.