



PARKING CALCULATIONS

FLOOR AREA
RESTAURANT= 640 SF
SHIPPING CONTAINER BAR= 320 SF
GAME ROOM= 1,600 SF
PAVILION= 3,801 SF
FLOOR AREA= 6,061 ÷ 150= 40.4 (41)

GROUND AREA
VENUE= 22,806 SF
GROUND AREA= 22,806 ÷ 1,000= 22.8 (23)

REQUIRED PARKING= 64 PARKING SPACES
PROPOSED PARKING= 62 PAVED PARKING SPACES
51 GRASSED PARKING SPACES

-  STORAGE CONTAINERS
-  GRAVEL PARKING AREA
(SEE DETAIL MS30)

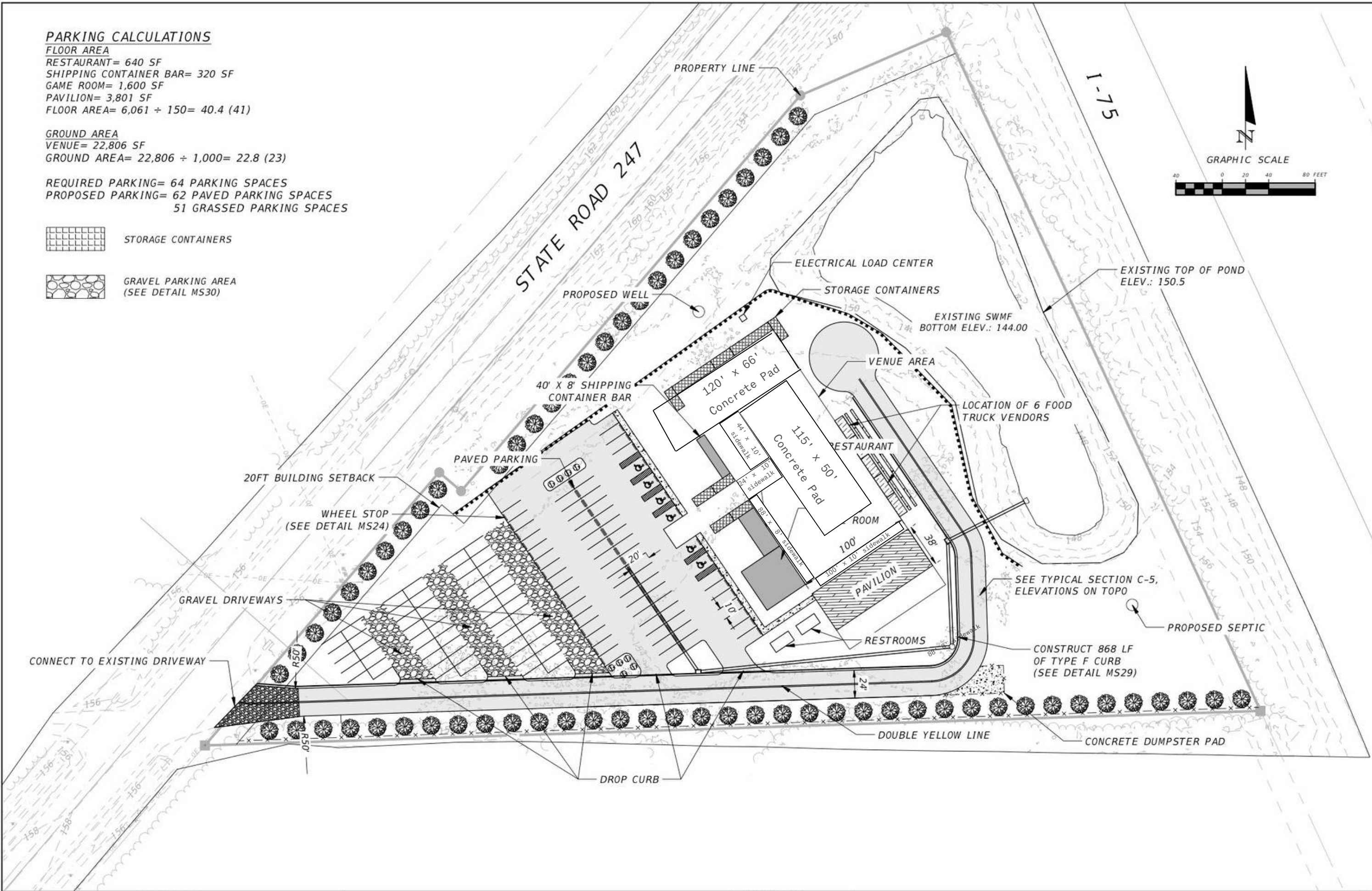

REVISIONS	
DATE	DESCRIPTION



NORTH FLORIDA PROFESSIONAL SERVICES, INC.
P.O. BOX 3823
LAKE CITY, FL 32056
PH. 386-752-4675
LIC NO. LB8356
2551 BLAIRSTONE PINES DR.
TALLAHASSEE, FL 32301
WWW.NFPS.NET
CA# 29011

JOB NUMBER:
L210802SPA
EOR:
ROBERT PHILLIP
BISHOP JR.
P.E. NO.:
38546

SITE PLAN
THE WOODS
COLUMBIA COUNTY, FLORIDA

SHEET
NO.
C-6

THE OFFICIAL RECORD OF THIS SHEET IS THE ELECTRONIC FILE DIGITALLY SIGNED AND SEALED UNDER RULE 61G15-23.004, F.A.C.