

Avis Budget  
Push Through

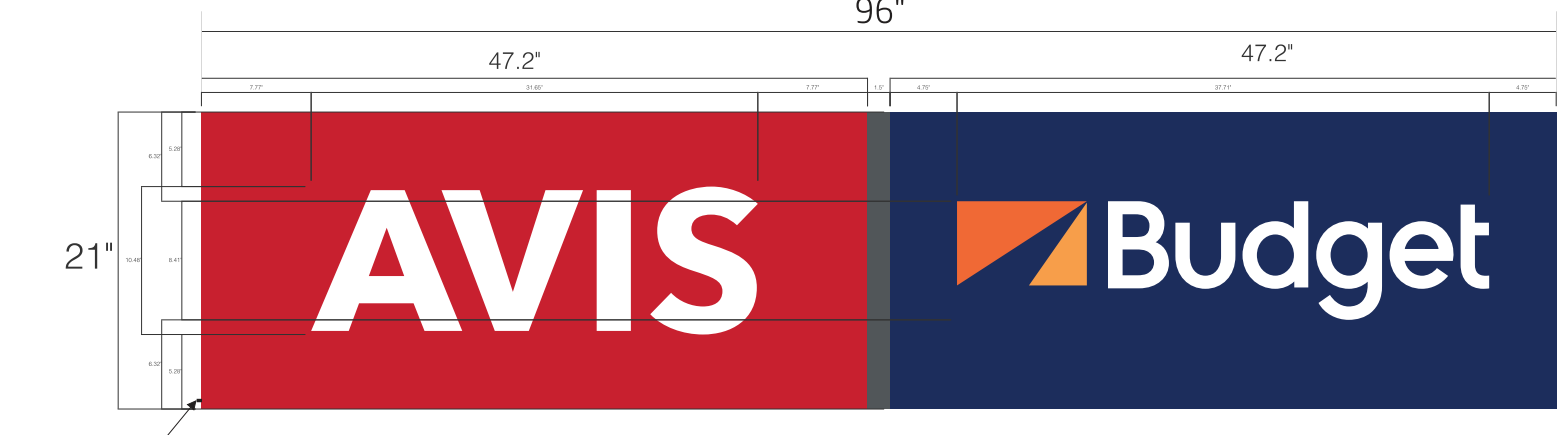

DISCONNECT  
SWITCH

COPY AREA: 14 SF

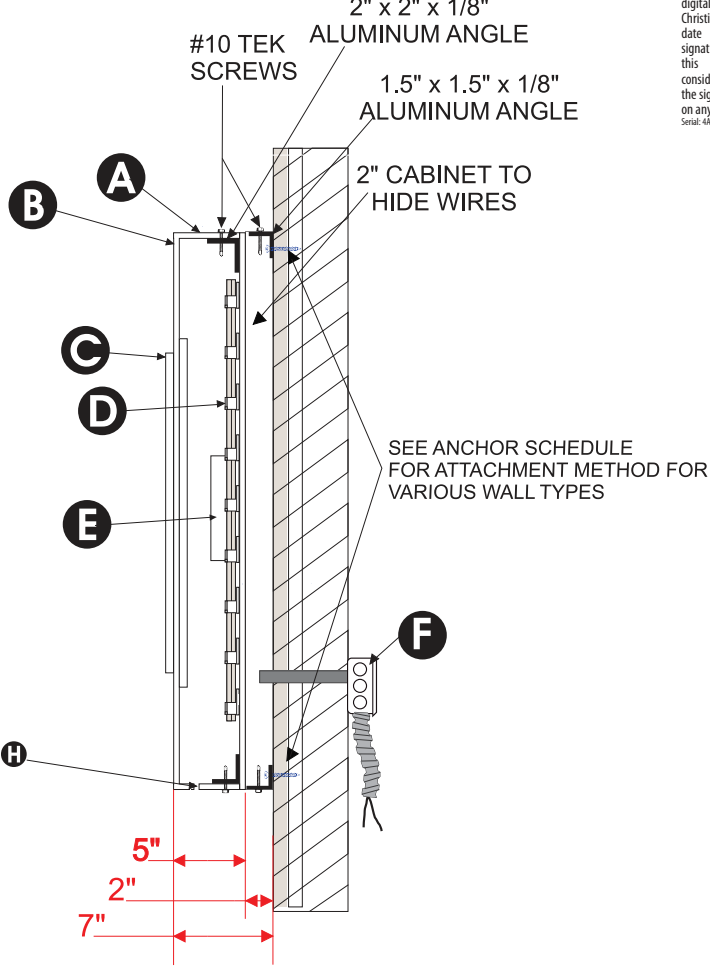

- A. 5" .080 ALUMINUM RETURN PAINTED AVIS RED AND BUDGET BLUE
- B. .125" ALUMINUM FACE PAINTED AVIS RED AND BUDGET BLUE
- C. 3/4" WHITE PUSH-THRU ACRYLIC
- D. WHITE LED LIGHTING
- E. SELF CONTAINED POWER SUPPLY
- F. LETTER INTERIOR PAINTED WHITE
- G. ELECTRICAL PRIMARY THRU 1/2" SEALTITE AND WHIPS AS REQUIRED
- H. 1/4" WEEP HOLES AT LOWEST POINTS

ALL WALL PENETRATIONS PROPERLY SEALED

ANCHOR SCHEDULE		**ALL FASTENERS SHALL BE SPACED EVENLY**
WALL MATERIAL	ANCHOR TYPE	QTY or SPACING
CONCRETE (3ksi) or HOLLOW MASONRY	1/4" THREADED RODS WITH MIN 2" EMBED IN ADHESIVE	--NOT APPLICABLE--
	1/4" TAPCONS (OR EQUIV) WITH 1.75" EMBED	MIN (6) TOTAL
	1/4" EXPANSION ANCHORS WITH 2.5" EMBED	MIN (6) TOTAL
1/2" PLYWOOD (NO ACCESS BEHIND)	1/4" TOGGLE BOLTS	MIN (6) TOTAL
	1/4" WOOD SCREWS, FULL EMBED	MIN (6) TOTAL
METAL STUDS / PANELS	#14 METAL SCREWS TO MIN 18ga STEEL OR 0.090" ALUM	MIN (6) TOTAL
HOLLOW WALL + BLOCKING	1/4" THRU BOLTS OR LAGS TO SOLID BLOCKING BEHIND	MIN (6) TOTAL

**ELECTRICAL NOTES**  
TOTAL AMPS: 1.1  
1-120V / 20 AMP CIRCUIT REQUIRED

**GENERAL NOTES:**  
THIS SIGN IS TO BE INSTALLED IN ACCORDANCE WITH THE REQUIREMENTS OF ARTICLE 600 OF THE CURRENT NATIONAL ELECTRICAL CODE.  
1. GROUNDED AND BONDED PER NEC 600.7 / NEC 250  
2. EXISTING BRANCH CIRCUIT IN COMPLIANCE WITH NEC 600.5 NOT TO EXCEED 20 AMPS  
3. SIGN IS TO BE UL LISTED PER NEC 600.3  
4. UL DISCONNECT SWITCH PER NEC 600.6 - REQUIRED PER SIGN COMPONENT BEFORE LEAVING MANUFACTURER.

**UL LISTED**  
E319113

**WHITE SIGN CO.**  
www.WhiteSignCompany.com

JOB#: 6707  
CLIENT:  
AVIS BUDGET GROUP  
2941 W US WHY 90 STE 105  
LAKE CITY, FL 32055

PROJECT:  
ILLUMINATED CABINET W/  
PUSH THROUGH LETTERING

DATE: 03/01/22  
REVISIONS:

DESIGNER: MG  
SHEET NO: 1

This document has been digitally signed and sealed by Christian Langley, PE on the date noted in this digital signature. Printed copies of this document are not considered signed & sealed, & the signature must be verified on any electronic copies.  
Serial: 44 49 9F 53 22 18 30 10 22 9D 96 67

Digitally signed by  
Christian Langley  
Date: 2022.03.10  
13:59:35 -05'00'

**CHRISTIAN LANGLEY**  
LICENSE  
No. 67382  
STATE OF FLORIDA  
PROFESSIONAL ENGINEER

**Easy Seals**  
www.easysign.com

ASCE 7-16 • V=130 mph  
WIND LOADS: • Exposure 'C'  
• Risk Category 2 Struct.  
• ASD Load Coeff = 0.6  
• Sign Height = 30 ft max  
• Kzt=1.0, Kd=0.85, G=0.85  
• Zone 4: ± 23.8 psf  
• Zone 5: ± 30.3 psf  
Wall components & cladding:

1200 N Federal Hwy, #200  
Boca Raton, FL 33432  
1-888-371-3113  
Christian Langley  
Florida PE #67382  
Cert of Auth #31124  
MAR 02 2022  
PE SIGNATURE