

SSO 344 105 407



STATE OF FLORIDA  
DEPARTMENT OF HEALTH  
ONSITE SEWAGE TREATMENT AND DISPOSAL  
SYSTEM  
APPLICATION FOR CONSTRUCTION PERMIT

PERMIT NO. 21-0997  
DATE PAID: 12/31  
FEE PAID: 320.05  
RECEIPT #: 1768072

APPLICATION FOR:

☒ New System ☐ Existing System ☐ Holding Tank ☐ Innovative  
☒ Repair ☐ Abandonment ☐ Temporary ☒ MODIFICATION

APPLICANT: Lori Creasey

AGENT: Amika Builders

TELEPHONE: 352-215-7048

MAILING ADDRESS: \_\_\_\_\_

=====

TO BE COMPLETED BY APPLICANT OR APPLICANT'S AUTHORIZED AGENT. SYSTEMS MUST BE CONSTRUCTED BY A PERSON LICENSED PURSUANT TO 489.105(3) (m) OR 489.552, FLORIDA STATUTES. IT IS THE APPLICANT'S RESPONSIBILITY TO PROVIDE DOCUMENTATION OF THE DATE THE LOT WAS CREATED OR PLATTED (MM/DD/YY) IF REQUESTING CONSIDERATION OF STATUTORY GRANDFATHER PROVISIONS.

=====

PROPERTY INFORMATION

LOT: 6 BLOCK: \_\_\_\_\_ SUBDIVISION: SOOTHLAND TRAILS PLATTED: \_\_\_\_\_

PROPERTY ID #: 02-65-15-00504-106 ZONING: RES I/M OR EQUIVALENT: ☒ (Y/N)

PROPERTY SIZE: 10.13 ACRES WATER SUPPLY: ☒ PRIVATE PUBLIC ☐  $\leq 2000$  GPD ☐  $> 2000$  GPD

IS SEWER AVAILABLE AS PER 381.0065, FS? ☐ Y/N ☐ DISTANCE TO SEWER: \_\_\_\_\_ FT

PROPERTY ADDRESS: 146 SW SUGAR BEAR GLEN

DIRECTIONS TO PROPERTY: FEW MILES PAST THE TCHETUCKNEE NORTH ENTRANCE WHEN ROAD FORKS GO RIGHT TO SW KINSEY SPRINGER TERRACE AT END MAKE LEFT PROPERLY ON LEFT CORNER

BUILDING INFORMATION

☒ RESIDENTIAL ☐ COMMERCIAL

Unit No	Type of Establishment	No. of Bedrooms	Building Area Sqft	Commercial/Institutional System Design Table 1, Chapter 64E-6, FAC
1	<u>ROS</u>	<u>3</u>	<u>2028</u>	<u>NO</u>
2	_____	_____	_____	_____
3	_____	_____	_____	_____
4	_____	_____	_____	_____

12/3/2021

STATE OF FLORIDA  
DEPARTMENT OF HEALTH  
APPLICATION FOR CONSTRUCTION PERMIT

Permit Application Number 21-0997

----- PART II - SITEPLAN -----

Scale: Each block represents 10 feet and 1 inch = 40 feet.

See attached																																							
--------------	--	--	--	--	--	--	--	--	--	--	--	--	--	--	--	--	--	--	--	--	--	--	--	--	--	--	--	--	--	--	--	--	--	--	--	--	--	--	--

Notes: \_\_\_\_\_

Site Plan submitted by: \_\_\_\_\_ Agent: \_\_\_\_\_ Owner: \_\_\_\_\_ Date: 12/3/2024

Plan Approved X Not Approved \_\_\_\_\_ Date 12/22/24

By \_\_\_\_\_ COLUMBIA County Health Department

**ALL CHANGES MUST BE APPROVED BY THE COUNTY HEALTH DEPARTMENT**



21-0997



TAX PARCEL: 02-65-15-00504-105  
OWNER: DOMBROSKI, JAY M.  
O.R. 1106, PAGE 1613

N01° 05' 11" W 662.96'

N88° 31' 14" E 662.95'

10.0' UTILITY EASEMENT  
PER DEED

60.0'  
INGRESS/EGRESS  
& UTILITY  
EASEMENT  
PER DEED

10.0' UTILITY EASEMENT  
PER DEED

TAX PARCEL: 02-65-15-00504-000  
OWNER: DEMAS, THOMAS T.  
O.R. 985, PAGE 470

N88° 31' 14" E 666.06'

**SUBJECT PARCEL**  
TAX PARCEL: 02-65-15-00504-106  
OWNER: CREASEY, LORI  
O.R. 1433, PAGE 2252  
AREA=10.137 ACRES±

PROPOSED HOUSE  
SEE HOUSE DETAIL

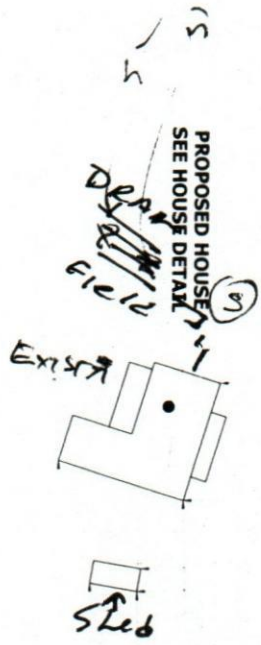

291.1'

311.0'

DIRT DRIVEWAY

333.0'

335.3'

**SW SUGAR BEAR GLEN**  
PRIVATE 60' EASEMENT

**POINT OF BEGINNING**  
SUBJECT PARCEL

TELEPHONE  
PEDESTAL

30.0'  
30.0'

STAKES

TAX PARCEL: 02-65-15-00504-102  
OWNER: BACARDI, LUIS L.  
O.R. 1028, PAGE 902

**POINT OF COMM**  
NE CORNER OF 1/4 1/2 OF  
TOWNSHIP 6 SOUTH, 104  
SUBJECT PARCEL AND INCH  
& UTILITY

S01° 05' 11" E 662.96'

**SW KINSEY SPRINGER TERRACE**  
PRIVATE 60' EASEMENT

60.0' INGRESS/EGRESS  
& UTILITY EASEMENT  
PER DEED

TAX PARCEL: 02-65-15-00504-107  
OWNER: NIMS, JOHN R. & RUBY  
O.R. 1395, PAGE 1708

10.0' UTILITY EASEMENT  
PER DEED

222.7'

280.0'

218.5'

214.0'

259.2'

WELL WITH  
TANK

231.2'

10' ± DIRT ROAD