

ELECTRICAL	COUNT	SYMBOL
ceiling globe light	6	⊙
ceiling lamp globe	3	○
ceiling light vent square	2	□
chandelier	2	⊛
wall mount 1	3	⊙
AC Disconnect	1	
FLOURSCENT 2-48IN.	2	
Fan - Ceiling	5	
Note	1	<div><p><b>ELECTRICAL PLAN NOTES</b></p><p>E -1 WIRE ALL APPLIANCES, HVAC UNITS AND OTHER EQUIPMENT PER MANUF. SPECIFICATIONS.</p><p>E -2 CONSULT THE OWNER FOR THE NUMBER OF SEPERATE TELEPHONE LINES TO BE INSTALLED.</p><p>E -3 ALL INSTALLATIONS SHALL BE PER NAT'L. ELECTRIC CODE.</p><p>E -4 ALL SMOKE DETECTORS SHALL BE 120V W/ BATTERY BACKUP OF THE PHOTOELECTRIC TYPE, AND SHALL BE INTERLOCKED TOGETHER. INSTALL INSIDE AND NEAR ALL BEDROOMS.</p><p>E -5 TELEPHONE, TELEVISION AND OTHER LOW VOLTAGE DEVICES OR OUTLETS SHALL BE AS PER THE OWNER'S DIRECTIONS, &amp; IN ACCORDANCE W/ APPLICABLE SECTIONS OF NEC-LATEST EDITION.</p><p>E -6 ELECTRICAL CONTR SHALL BE RESPONSIBLE FOR THE DESIGN &amp; SIZING OF ELECTRICAL SERVICE AND CIRCUITS.</p><p>E -7 ENTRY OF SERVICE ( UNDERGROUND OR OVERHEAD ) TO BE DETERMINED BY POWER COMPANY.</p><p>E -8 ALL BEDROOM RECEPTACLES SHALL BE AFCI (ARC FAULT CIRCUIT INTERRUPT)</p><p>E -9 ALL OUTLETS TO BE LOCATED ABOVE BASE FLOOD ELEVATION</p><p>E -10 A SERVICE DISCONNECT WITH OVER CURRENT PROTECTION SHALL BE INSTALLED OUTSIDE OF THE BUILDING, ON THE LOAD SIDE OF THE METER, AT THE PLACE ELECTRIC CONDUCTORS ENTER THE BUILDING. SERVICE ENTRANCE CONDUCTORS MAY NOT BE LOCATED INSIDE OF THE OF THE BUILDING WITHOUT SPECIAL APPROVAL OF THE BUILDING OFFICIAL.</p></div>
PANEL METER	1	
outlet	25	⌚
outlet 220v	4	⌚
outlet gfi	9	⌚
outlet wp gfi	3	⌚
smoke detector	4	⊙
switch	12	⌚

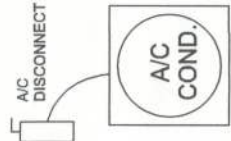
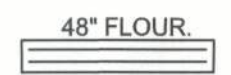
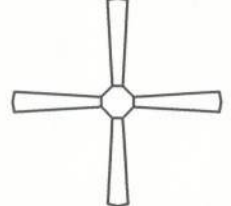
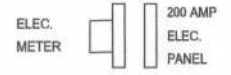
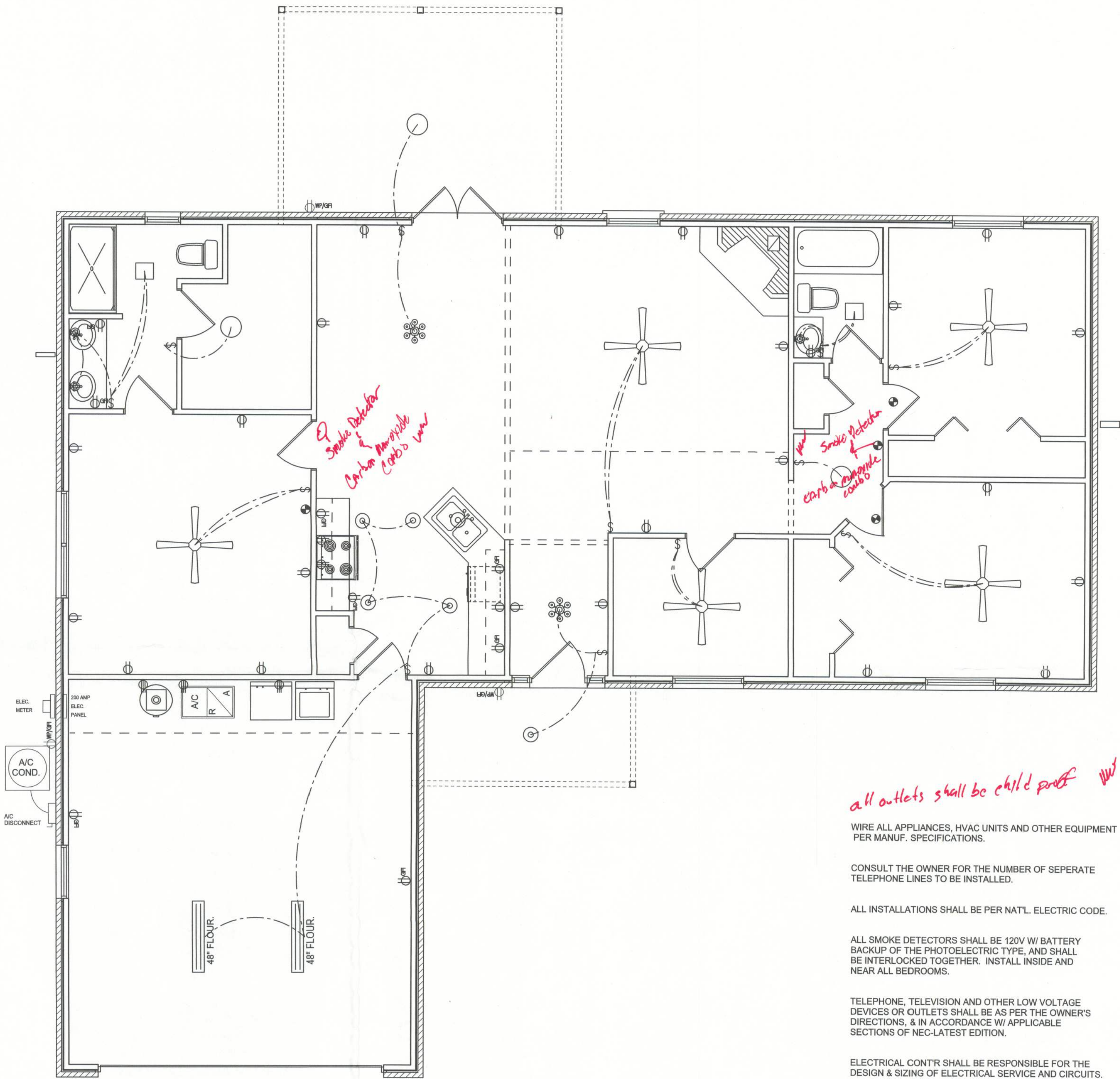

- all outlets shall be child proof w/*
- WIRE ALL APPLIANCES, HVAC UNITS AND OTHER EQUIPMENT PER MANUF. SPECIFICATIONS.
- CONSULT THE OWNER FOR THE NUMBER OF SEPERATE TELEPHONE LINES TO BE INSTALLED.
- ALL INSTALLATIONS SHALL BE PER NAT'L. ELECTRIC CODE.
- ALL SMOKE DETECTORS SHALL BE 120V W/ BATTERY BACKUP OF THE PHOTOELECTRIC TYPE, AND SHALL BE INTERLOCKED TOGETHER. INSTALL INSIDE AND NEAR ALL BEDROOMS.
- TELEPHONE, TELEVISION AND OTHER LOW VOLTAGE DEVICES OR OUTLETS SHALL BE AS PER THE OWNER'S DIRECTIONS, & IN ACCORDANCE W/ APPLICABLE SECTIONS OF NEC-LATEST EDITION.
- ELECTRICAL CONTR SHALL BE RESPONSIBLE FOR THE DESIGN & SIZING OF ELECTRICAL SERVICE AND CIRCUITS.
- ENTRY OF SERVICE ( UNDERGROUND OR OVERHEAD ) TO BE DETERMINED BY POWER COMPANY.
- ALL ~~BEDROOM~~ RECEPTACLES SHALL BE AFCI (ARC FAULT CIRCUIT INTERRUPT) *According to 2008 NEC*
- ALL OUTLETS TO BE LOCATED ABOVE BASE FLOOD ELEVATION
- A SERVICE DISCONNECT WITH OVER CURRENT PROTECTION SHALL BE INSTALLED OUTSIDE OF THE BUILDING, ON THE LOAD SIDE OF THE METER, AT THE PLACE ELECTRIC CONDUCTORS ENTER THE BUILDING. SERVICE ENTRANCE CONDUCTORS MAY NOT BE LOCATED INSIDE OF THE OF THE BUILDING WITHOUT SPECIAL APPROVAL OF THE BUILDING OFFICIAL.
- E -10
- E -9
- E -8
- E -7
- E -6
- E -5
- E -4
- E -3
- E -2
- E -1

ELECTRICAL PLAN NOTES

Drafted By:  
Chuck Wood  
386-755-8699

Wind Tech Contracting Corp.  
2747 S. W. Main Blvd.  
Lake City, Fla. 32025

Mike Roberts Custom Home  
Columbia County, Florida

Electrical Plan

Sheet Number  
3

*W. Wood*