

ELECTRICAL LEGEND	
	CEILING FAN (PRE-WIRE FOR LIGHT KIT)
	DOUBLE SECURITY LIGHT
	RECESSED CAN LIGHT
	BATH EXHAUST FAN
	LIGHT FIXTURE
	DUPLEX OUTLET
	220v OUTLET
	GFI DUPLEX OUTLET
	TELEVISION JACK
	TELEPHONE JACK
	SMOKE DETECTOR (see note below)
	WALL SWITCH
	3 WAY WALL SWITCH
	WATER PROOF GFI OUTLET
	2 OR 4 TUB FLUORESCENT FIXTURE

NOTE:
ALL BEDROOM RECEPTACLES SHALL BE AFCI
(ARC FAULT CIRCUIT INTERRUPT)

ALL SMOKE DETECTORS SHALL HAVE BATTERY BACKUP POWER
AND ALL WIRED TOGETHER SO IF ANY ONE UNIT IS ACTUATED THEY
ALL ACTIVATE.

THE ELECTRICAL SERVICE OVERCURRENT PROTECTION DEVICE SHALL BE
INSTALLED ON THE EXTERIOR OF STRUCTURES TO SERVE AS A DISCONNECT MEANS.
CONDUCTORS USED FROM THE EXTERIOR DISCONNECTING MEANS TO A PANEL OR SUB
PANEL SHALL HAVE FOUR-WIRE CONDUCTORS, OF WHICH ONE CONDUCTOR
SHALL BE USED AS AN EQUIPMENT GROUND.

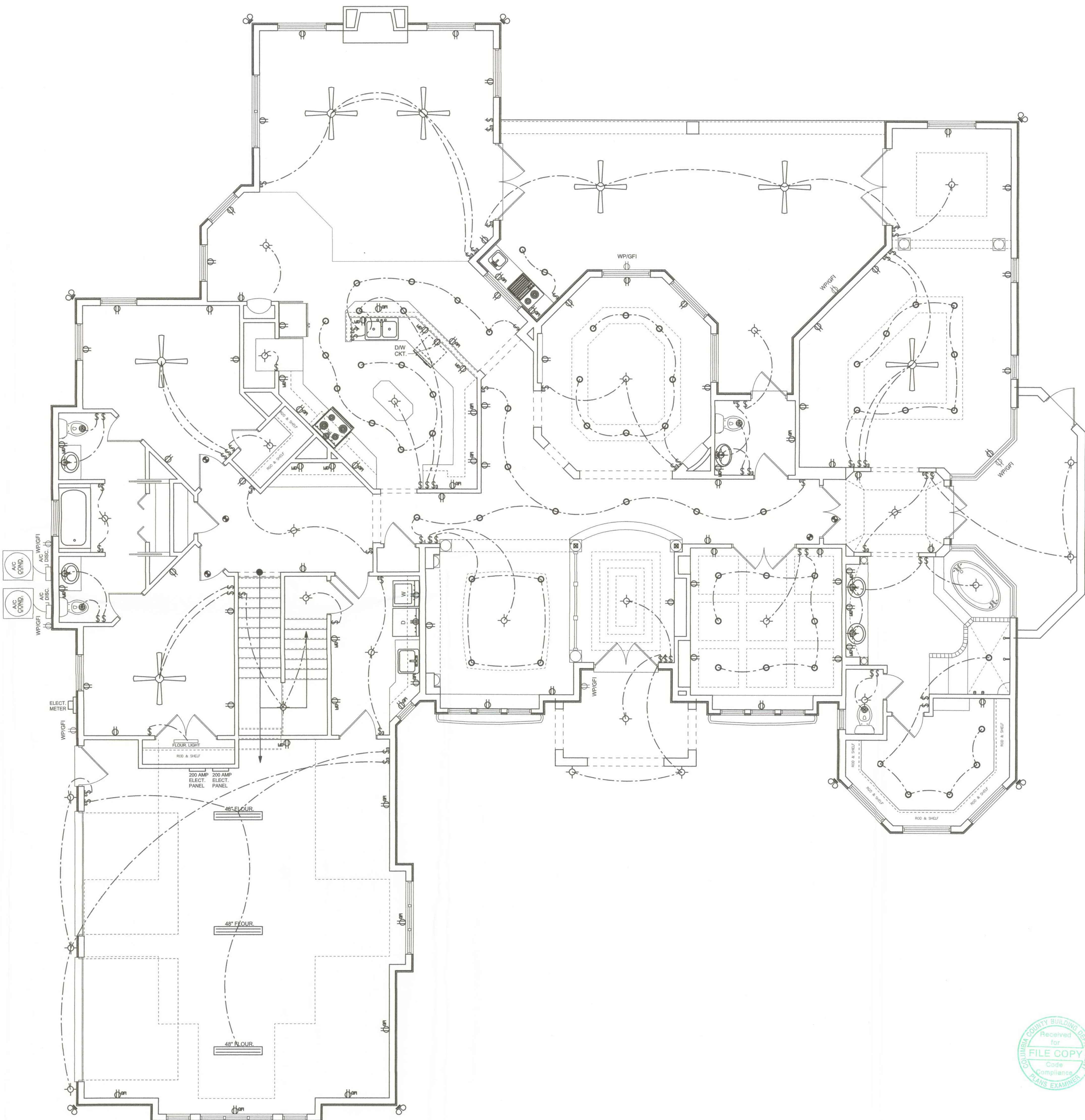

ELECTRICAL PLAN
SCALE: 1/4" = 1'-0"



Wm Myers

REVISIONS
September 15, 2008

SOFTWARE
ARCHITECTURAL DESIGN SOFTWARE

ELECTRICAL PLAN
1/4" = 1'-0"
SCALE:

A HOME DESIGN FOR:
CHARLES & MARLENE MEADE
PROJECT ADDRESS: LOT 1 COLUMBIA MEADOWS S.D. COLUMBIA COUNTY, FL

©WILLIAM MYERS
P.E. 1513
P.O. BOX 1513
LAKE CITY, FL 32056
(386) 758-8406
will@willmyers.net

JOB NUMBER
080707

SHEET NUMBER
A.4
OF 5 SHEETS