

POOL GENERAL NOTES:

- ALL POOL GUNITE OR CONCRETE SHALL ATTAIN 3000 PSI COMPRESSIVE STRENGTH WITH 28 DAYS.
- REINFORCING SHALL BE NEW BILLET STEEL CONFORMING TO ASTM A615, GRADE 60
- ALL PIPING SHALL BE PVC SCHEDULE 40, APPROVED FOR USE IN POTABLE WATER
- INSTALLATION OF LIGHTS, JUNCTION BOXES, GROUNDS, ETC., SHALL BE IN ACCORDANCE WITH THE REQUIREMENTS OF SECTION 680 OF THE NATIONAL ELECTRIC CODE.
- THE OWNER SHALL FURNISH ADEQUATE ELECTRICAL SERVICE FOR THE OPERATION OF THE MOTORS, HEATERS, LIGHTS, ETC. THE OWNER SHALL PROVIDE A DISCONNECT SWITCH AT THE POOL EQUIPMENT LOCATION IF IT IS NOT WITHIN 50 FEET OF THE FUSED SWITCH SERVICE POINT.
- THE POOL PUMP MOTOR, LIGHT, HANDRAILS AND LADDER OR GRAB RAILS SHALL BE BONDED TO THE POOL STEEL WITH A #8 SOLID COPPER WIRE IN A 1" NON CORROSIVE CONDUIT.
- PUMP EQUIPMENT, INCLUDING FILTER AND/OR HEATER SHALL BE LOCATED ABOVE THE REQUIRED BASED FLOOD ELEVATION OR FLOOD-PROOFED.
- ON SITE INSPECTION INDICATES SAND AND ROCK WITH A BEARING CAPACITY OF 2.0 KSF. THE CONTRACTOR SHALL NOTIFY THE ARCHITECT IF OTHER CONDITION ARE ENCOUNTERED.
- ALL PATIO CONCRETE SHALL ATTAIN 3000 PSI COMPRESSIVE STRENGTH WITHIN 28 DAYS.
- POOL WATER DISPOSAL SHALL BE IN ACCORDANCE WITH LOCAL CODES.
- THE OWNER SHALL PROVIDE A SCREEN ENCLOSURE, FENCE, OR WALL WITH SELF-CLOSING AND SELF-LATCHING GATE IN ACCORDANCE WITH LOCAL ZONING CODES REQUIREMENTS. (NSPI APPENDIX)
- OWNER AND BUILDER SHALL BE RESPONSIBLE FOR ACQUIRING RELEASES FROM UTILITY COMPANIES FOR ALL PROPOSED CONSTRUCTION WITHIN ANY UTILITY EASEMENT OR RIGHT OF WAY.

PROVIDE CHILD PROOF POOL MESH

A mesh safety barrier meeting the requirements of Section R4501.1.1 and the following minimum requirements shall be considered a barrier as defined in this section

-THE MESH UTILIZED IN THE BARRIER SHALL HAVE A MINIMUM TENSILE STRENGTH ACCORDING TO ASTM D5034 OF 100 POUNDS PER FOOT, AND A MINIMUM BALL BURST STRENGTH ACCORDING TO ASTM D3181 OF 150 POUNDS PER FOOT. THE MESH SHALL NOT BE CAPABLE OF DEFORMATION SUCH THAT A 1/4-INCH (6.4 MM) ROUND OBJECT COULD PASS THROUGH THE MESH.

-THE MESH SHALL RECEIVE A DESCRIPTIVE PERFORMANCE RATING OF NO LESS THAN "TRACE DISCOLORATION" OR "SLIGHT DISCOLORATION" WHEN TESTED ACCORDING TO ASTM G53 (WEATHERABILITY, 1200 HOURS).

-WHEN USING A MOLDING STRIP TO ATTACH THE MESH TO THE VERTICAL POSTS, THIS STRIP SHALL CONTAIN, AT A MINIMUM, #8 BY 1/2-INCH (12.1 MM) SCREWS WITH A MINIMUM OF TWO SCREWS AT THE TOP AND TWO AT THE BOTTOM WITH THE REMAINING SCREWS SPACED A MAXIMUM OF 6 INCHES (152 MM) APART ON CENTER

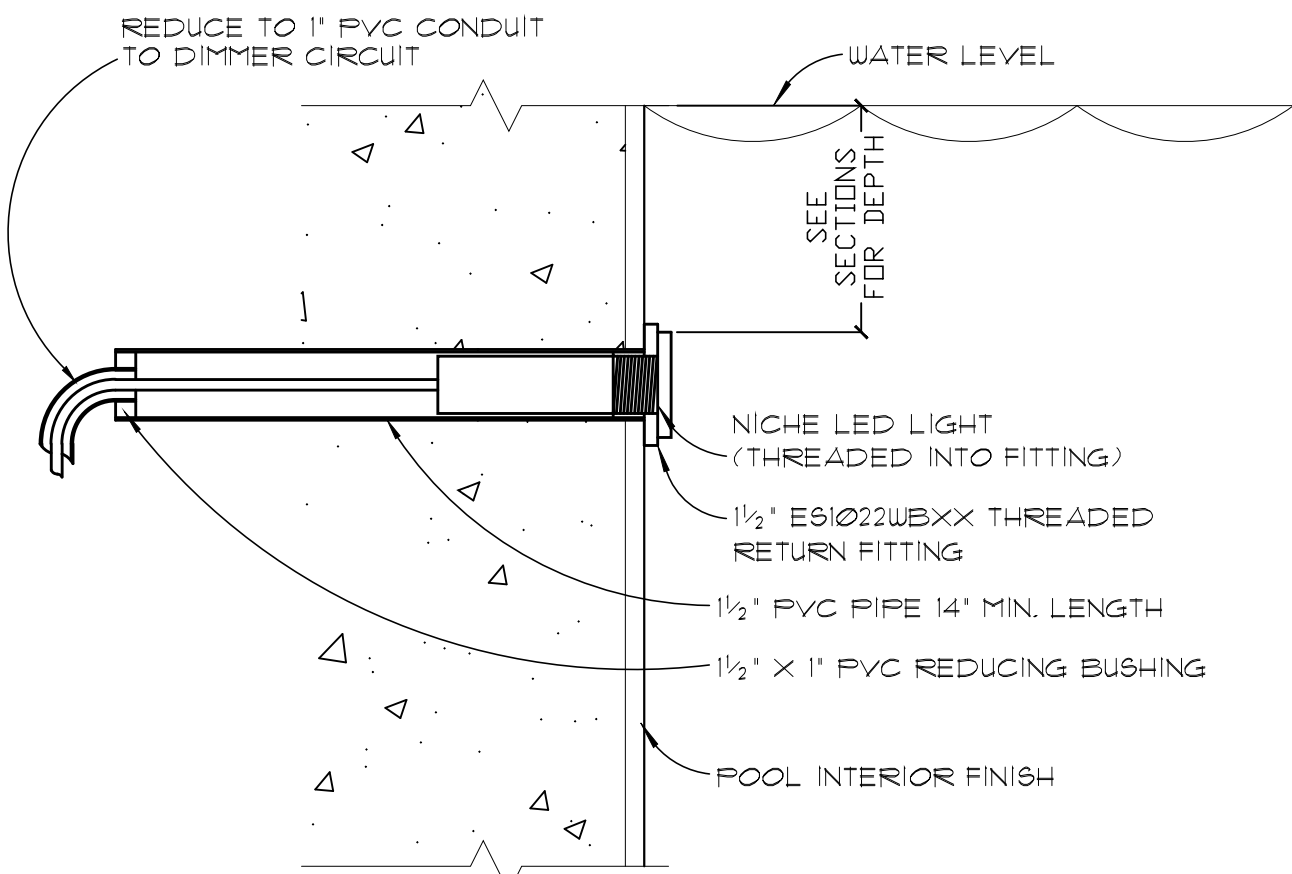

LED LIGHT DETAIL

NOT TO SCALE

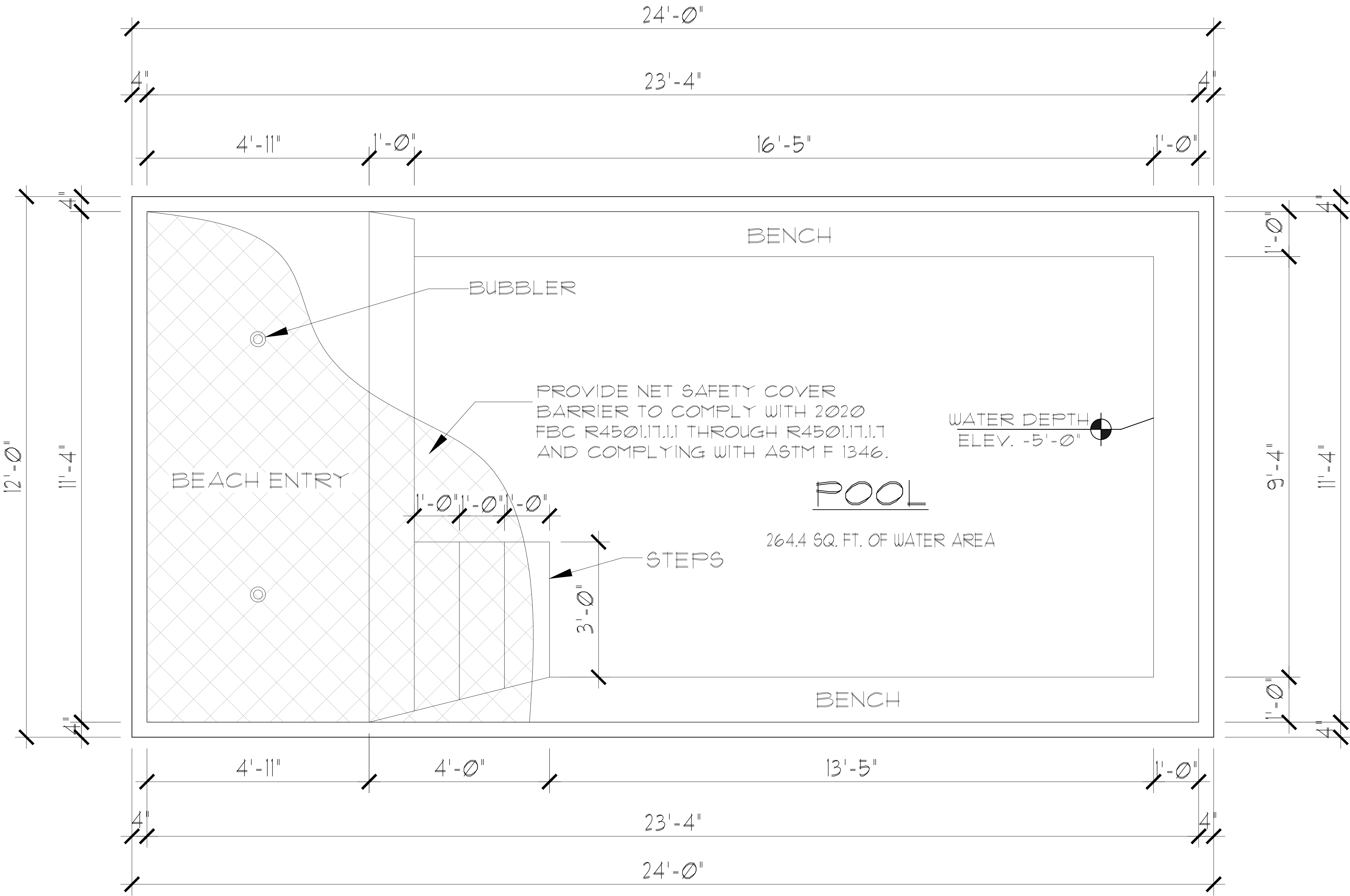

POOL PLAN

SCALE: 3/8"=1'-0"

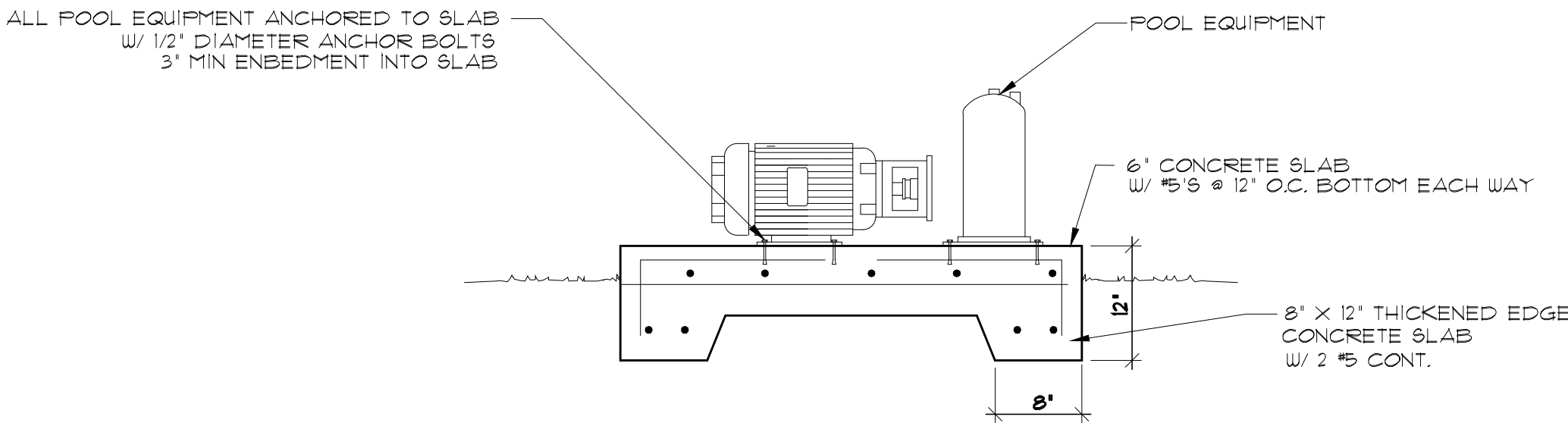

POOL EQUIPMENT MOUNTING DETAIL

SCALE: N.T.S.

BOND SYSTEM NOTES BY NEC 2017:

- 680.26(B)(1) - PERIMETER BONDING IS REQUIRED FOR PERMANENT POOLS. A MINIMUM #8 AWG COPPER WIRE (GROUND RING) MUST BE INSTALLED AROUND THE POOL 4" TO 6" BELOW GRADE, 18" TO 24" FROM THE POOL AND CONNECT TO THE PUMP MOTOR, HEATER AND THE POOL WATER BONDING
- 680.26(B) - 4 POINT BONDING IS NOT REQUIRED TO THE VERTICAL UPRIGHTS OF POOLS WITH VINYL LINERS AS IT IS CONSIDERED A NONCONDUCTIVE MATERIAL. FOR NONCONDUCTIVE POOL SHELLS, BONDING AT 4 POINTS SHALL NOT BE REQUIRED.
- 680.26(C) - THE POOL WATER MUST BE BONDED TO AT LEAST 9 SQ' OF METAL.
- THIS MAY BE ACCOMPLISHED BY:
- BONDING TO A POOL WATER HEATER THAT HAS METALLIC COMPONENTS
 - INSTALLING A METAL PIPE NIPPLE IN THE WATER CIRCULATION SYSTEM SO A GROUND STRAP MAY BE ATTACHED TO IT.
 - OTHER APPROVED METHODS

DRAWN BY:	DATE:
REV. No.	REVISION DESCRIPTION

OPJR Architect, LLC
ORLANDO PEREZ JR. - ARCHITECT
13054 SW 133 CT, MIAMI, FL 33186
305-911-0052
e-mail: architectopjra@yahoo.com

ORLANDO PEREZ JR
Digitally signed by ORLANDO PEREZ JR
Date: 2023.10.06 10:56:20 -0400

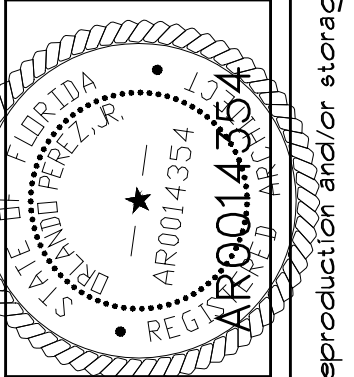

A SWIMMING POOL FOR
MELISSA THOMAS
6129 SW COUNTY RD 18 FORT WHITE
COLUMBIA COUNTY, FL 32038
RE: 00-00-00 14330-116

DRAW BY: YFF

DATE: 10/03/23

POOL-01

©COPYRIGHT - All rights reserved, these plans are the property of Orlando Perez, Jr., reproduction and/or storage by any means, whole or in part, is prohibited without our written permission.